



 @Afinia3DPrint

 @Afinia

 @Afinia3DPrint

Support: [support@afinia.com](mailto:support@afinia.com) Web: <http://www.afinia.com>

Support Phone: 952-279-2643

# **H440**

## Quick Start Guide

V1.0

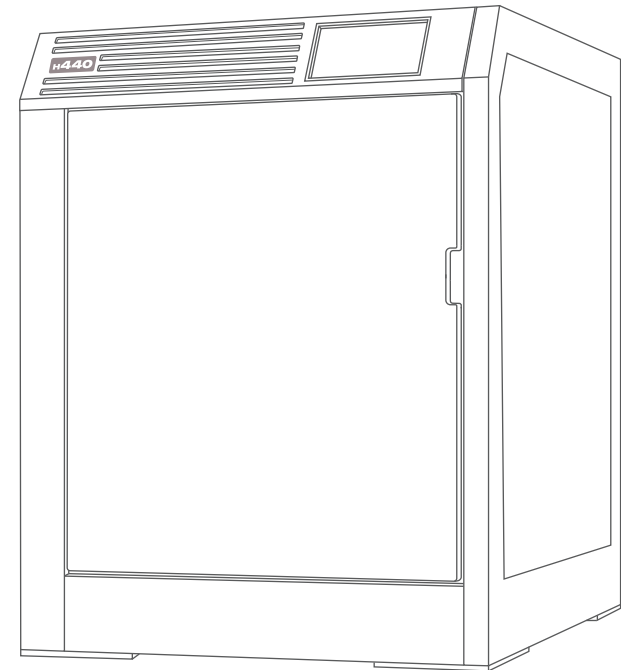

Visit "[www.afinia.com/support/manuals-guides/](http://www.afinia.com/support/manuals-guides/)" to download the latest user manuals.

## Table of Contents

Machine Structure .....	1
Unboxing .....	2
Software and Connect Printer .....	3
Install Filament Spool .....	4
Load and Print Models .....	5/6
WiFi Setup Guide .....	7



**WARNING:** This 3D printer - when used with styrene filament (ABS / HIPS / PC-ABS) - can expose you and others in the same room to styrene, a chemical known to the State of California to cause cancer.

[www.P65Warnings.ca.gov](http://www.P65Warnings.ca.gov)

**ALWAYS OPERATE THIS PRODUCT IN A WELL-VENTILATED AREA.**

## Machine Structure

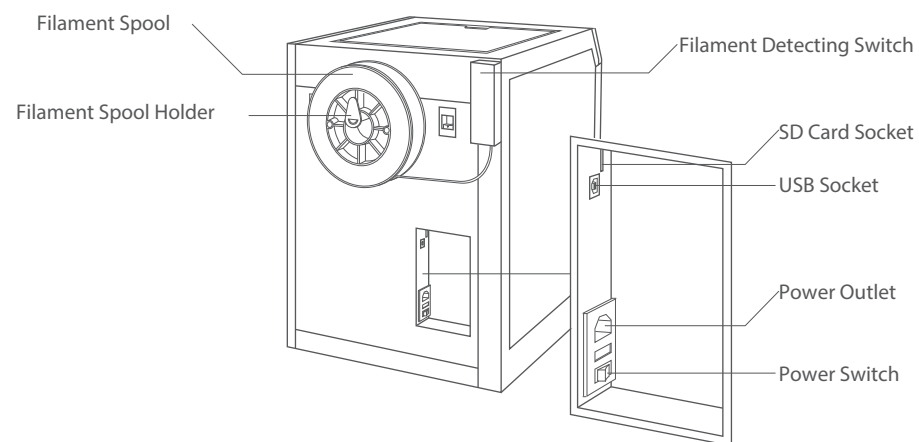
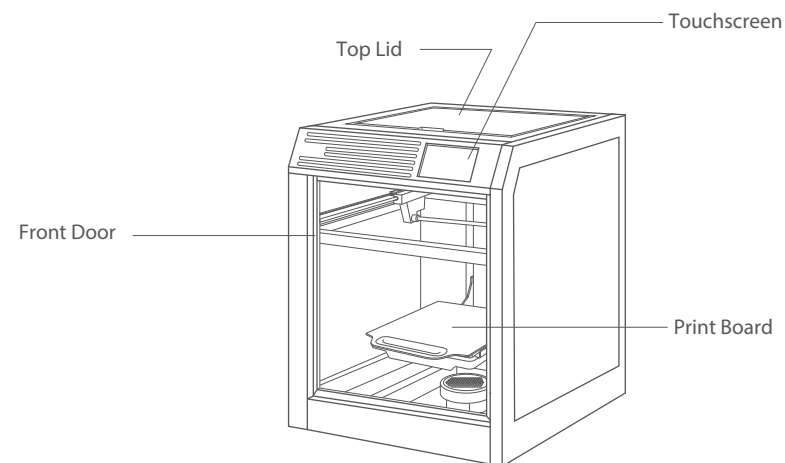

## Unboxing

- 1\ Open the package and remove the printer and accessories. Remove the foams and zip tights in the machine. Check whether the accessories are complete.

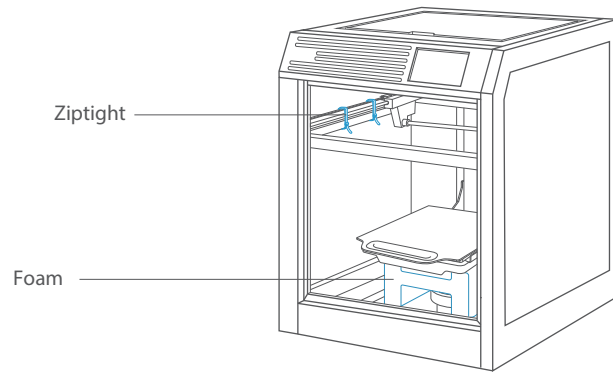

- 2\ Insert the filament spool holder into the spool bracket on the back of the machine.

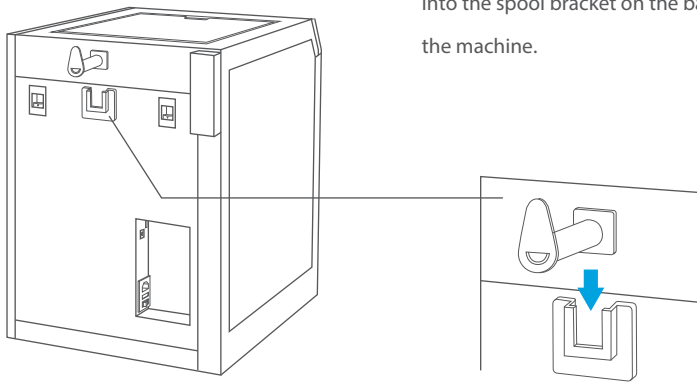

## Software and Connect Printer

- 1\ Download the operation software Afinia Studio 2.X from <https://www.afinia.com/support/downloads/choose-product/> and install it on your computer.

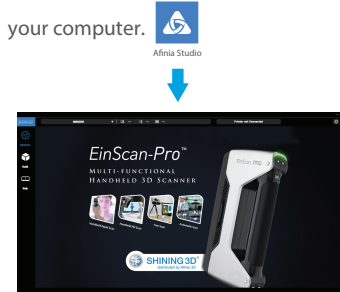

- 3\ Install the print plate, close the top lid and close the front door.

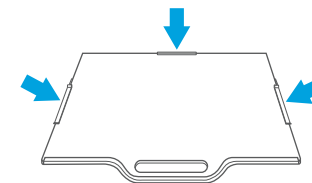
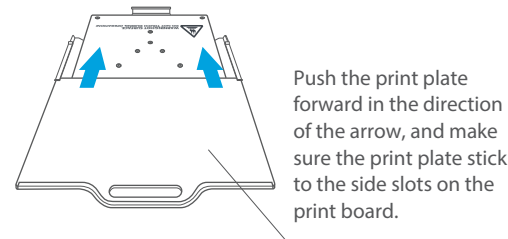

- 2\ Turn on the power switch at the back of the printer.

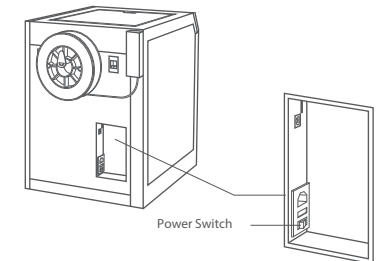

- 4\ Perform an automatic Calibration.

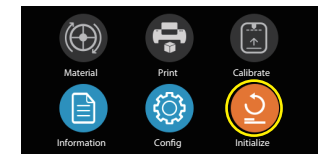

- 1\ Click the Initialize button to initialize the printer.

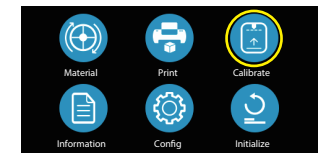

- 2\ Click the calibration button to enter the nozzle calibration interface.

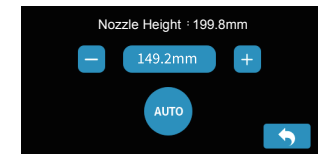

- 3\ Click the Auto button to start the automatic nozzle height calibration.

## Install Filament Spool

- 1\ Put one spool of filament on the spool holder ① at the back of the printer.

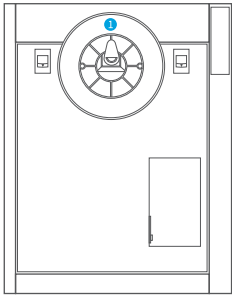

- 2\ Pull one end of the filament, feed the filament through the filament feeding system ② on the upper right at the back of the printer, and pull the filament close to the extruder.

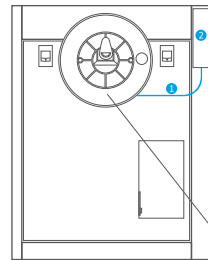

Note : When pulling the wire, make sure that the filament spool turns counterclockwise.

- 3\ In the "Material" interface of the touchscreen, click the material button in the circle switching among different types of Filaments. Choose the filament that you would like to use.

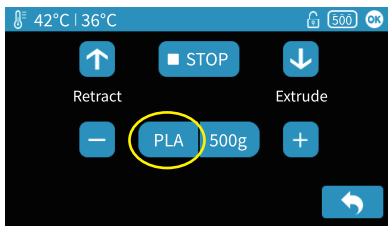

- 4\ After material selection, click the Extrude button in the Material interface. The nozzle starts being heated, and the heating progress will be displayed on the upper left of the status bar.

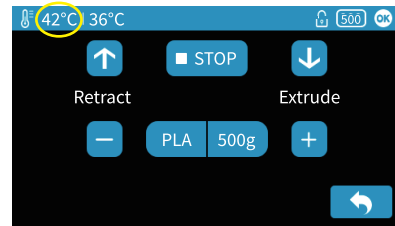

- 5\ Gently press the end of the filament into the extruder inlet and push it to the end. When the temperature of the nozzle reaches the preset temperature, the printer will beep and the extruder will automatically grab the filament, and pull it in and extrude it through the nozzle.

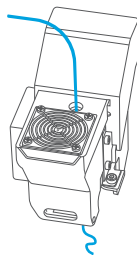

## Load and Print Models

- 1\ Connect the printer to a computer via USB.

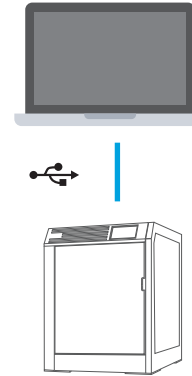

Connect the power cord and turn on the power switch on the back of the printer.

- 3\ Click the "Build" button on the main menu to open the print interface, then click **+** to load the STL.

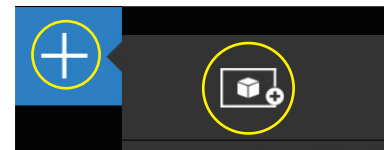

- 2\ Start the Afinia Studio2.X software. 

One the top area, the software shows the Serial Number of the machine, nozzle temperature, print bed temperature, and material type.



- 4\ Use the Print Navigator to adjust the 3D model.

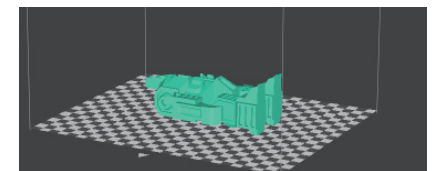

5\ Click the "Print" button and set print parameters.

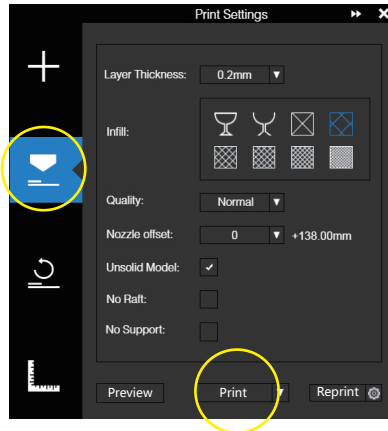

6\ Click "Print" to start transferring the model data to the printer. Once the transmission finishes, the software will prompt the estimated printing time and material consumption. At this time, the printer can be disconnected from the computer.

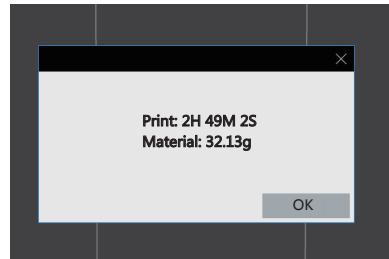

7\ After the data transmission is completed, the nozzle starts to heat up, and the model starts to print after the nozzle reaches the system set temperature.



## WIFI Setup Guide

1\ Click the "Config" button.

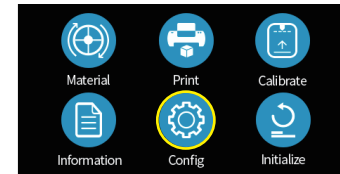

3\ Click the search button on the top right corner, and search for Wi-Fi.



5\ Click the Password field to enter a Wi-Fi password.

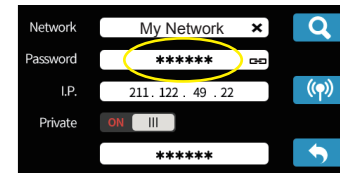

7\ Click the "Connect" button to finish. If successful, the disconnected Wifi icon on the top status bar will change to connected.

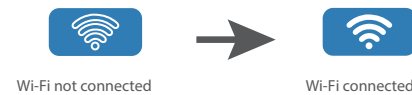
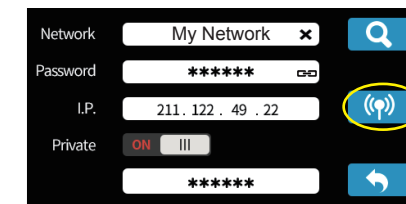

2\ Make sure the Wi-Fi option is "ON", then click the Wi-Fi button in the upper right corner.

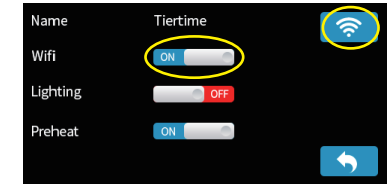

4\ In the network list, choose the Wi-Fi network that your computer is on.

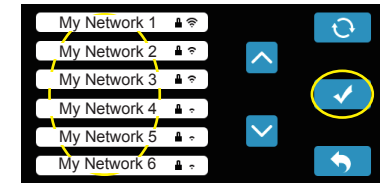

6\ Input the password, then press "return".



8\ Users can turn the toggle button "Private" on and set a password for the printer to prevent unauthorized access to the printer.

