

# H400+

## Quick Start Guide

V 0.1



Afinia 3D  
8150 Mallory Court, PO BOX 846  
Chanhassen, MN 55317

[youtube.com/afinia3dprint](https://www.youtube.com/afinia3dprint)

Phone Support: 952-279-2643

Support: [support@afinia.com](mailto:support@afinia.com) Web: [www.afinia.com](http://www.afinia.com)

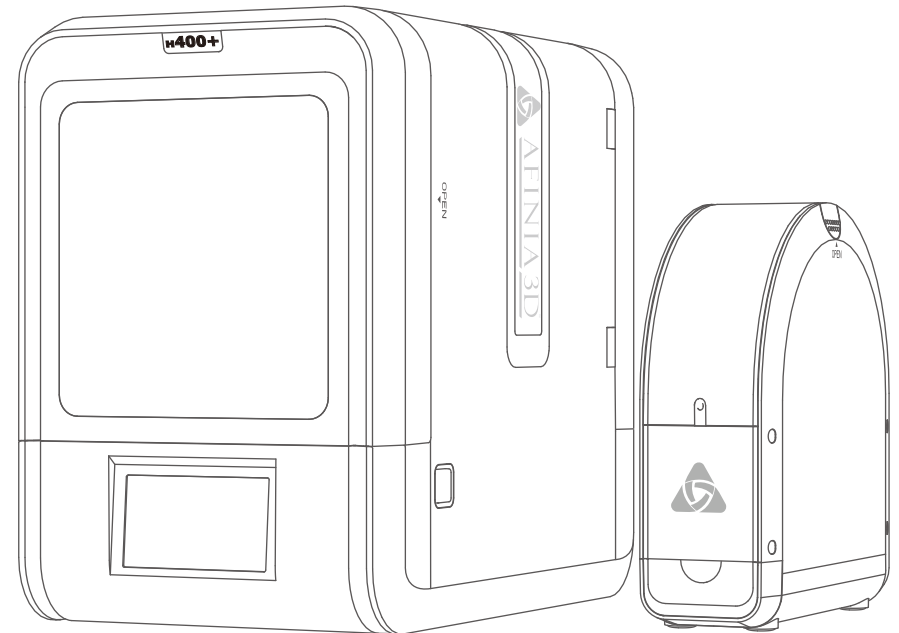

Download full user manual at [www.afinia.com/support](http://www.afinia.com/support)

# Index

Unpacking	1
Install Printer	2
Install Software	3
Load Filament	4/5
Network Setup	6
Load and Print Model	7

## Unpacking

1. After unboxing the machine, remove the cushions inside the printer.

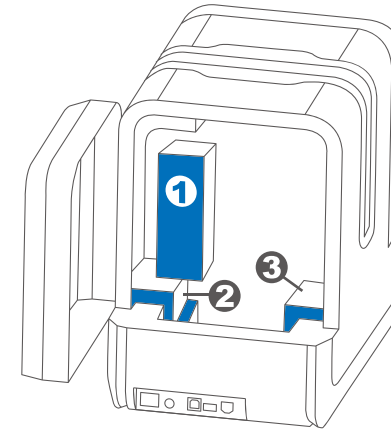

2. Open the front door and remove the top lids.

3. Find the print head in the accessory box.

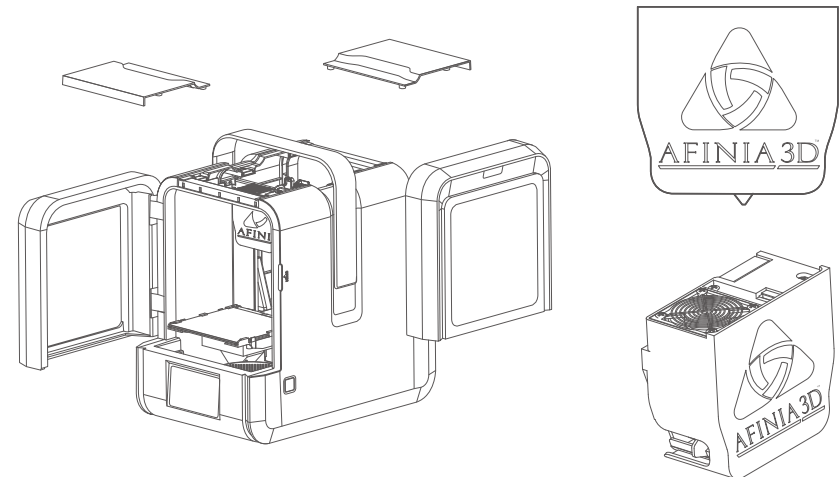

**WARNING:** This 3D Printer - when used with styrene filament (ABS / HIPS / PC-ABS) - can expose you and others in the same room to styrene, a chemical known to the State of California to cause cancer.  
[www.P65Warnings.ca.gov](http://www.P65Warnings.ca.gov)

**ALWAYS OPERATE THIS PRODUCT IN A WELL-VENTILATED AREA.**

## Install Printer

4.1 Align the extruder mount to the extruder mount slots, then press down on the extruder until it locks into position.

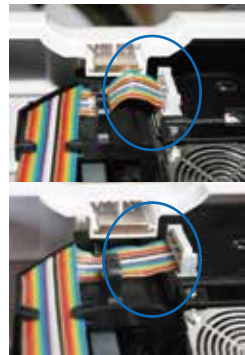
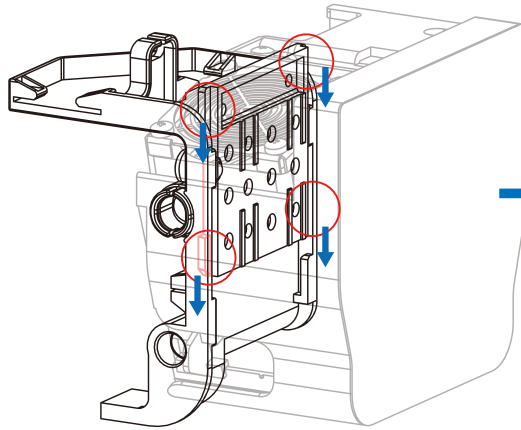
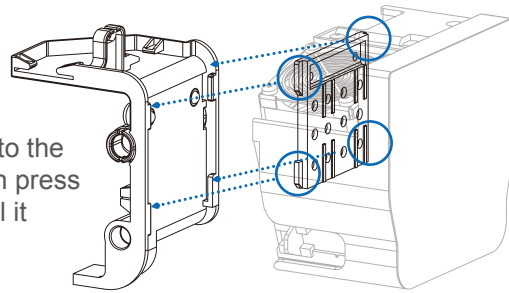

4.2 Install the FFC cable as shown above.

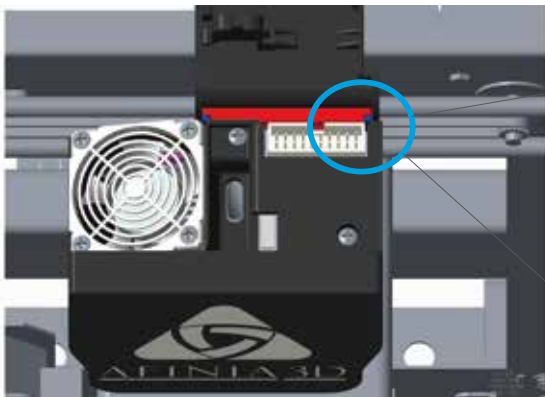

4.3 The extruder needs to be pressed down to the bottom of the mount.

**Notice:** When installed correctly, the red and blue shaded parts should be at the same level.

## Install Software and Connect the Printer

1. Please go to [www.afinia.com/support/downloads](http://www.afinia.com/support/downloads) to download the Studio software and install it on your computer.

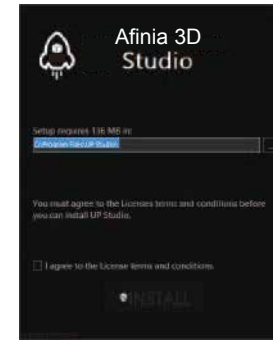

2. Connect the printer to your computer.

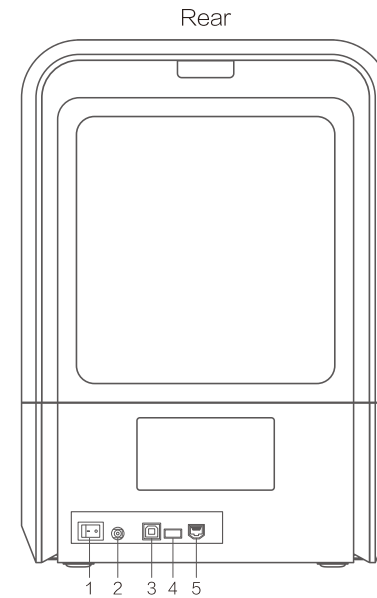

1. Power Switch
2. Power Connector
3. USB-B for Computer
4. USB-A for USB Drive
5. Ethernet Port

3. Detect your nozzle height.



a. Click the Initialize button to initialize the printer.



b. Click the Calibrate button.



c. Click the Auto button to begin auto nozzle height detection.

## Load Filament

- Put filament into the external spool holder and insert filament into the guiding tube.

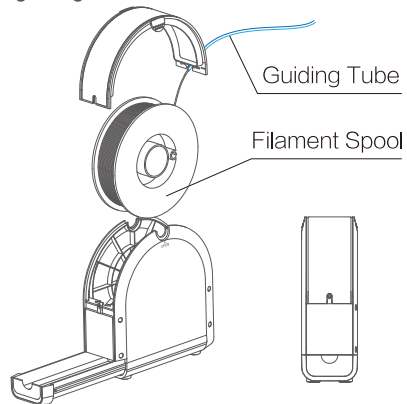

- Put the guiding tube into the rubber ring.

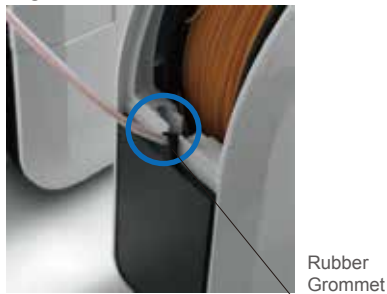

Rubber Grommet

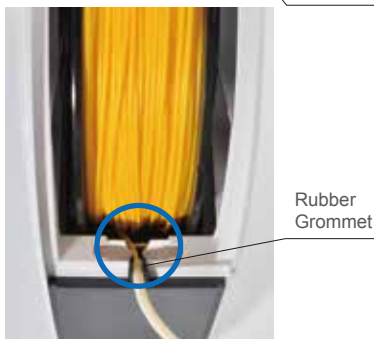

Rubber Grommet

- Insert filament and guiding tube into the machine through the hole on the back door.

Make sure the section of guiding tube inside the machine is no less than 28 cm.

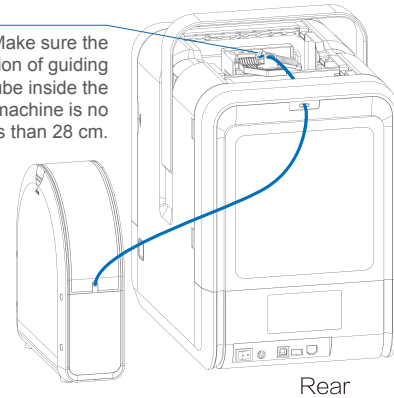

- In the material page, press the circular material button to switch between different materials.



- After selecting the right material, click "Extrude". The print head temperature will be displayed on the status bar on top.

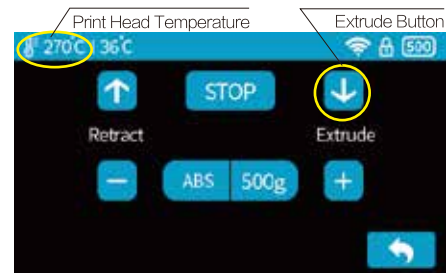

- Gently push the filament into the filament entrance and down until it stops. After reaching the print temperature, the printer will beep and start extruding filament.

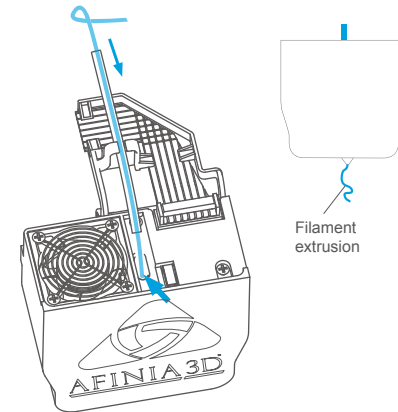

- Close the top covers and doors.

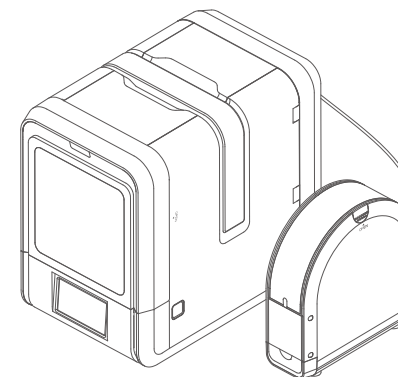

- Push the guiding tube into the filament entrance and insert the tube into the holding clip on the mount.

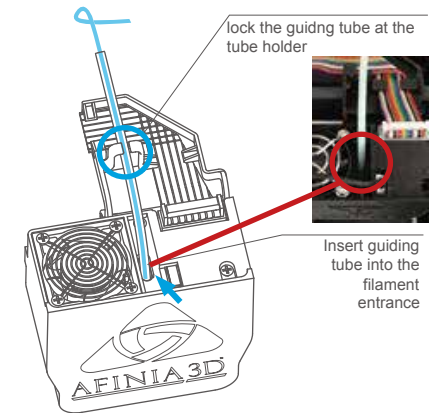

- Please note that the external spool holder can only be placed at the following positions. Other locations could adversely affect printing performance.

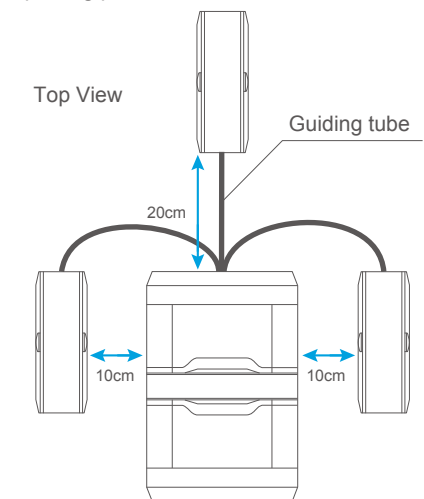

# Network Setup

The H400+ can be connected to your network either via ethernet or Wi-Fi. For ethernet connection, follow instructions 1, 2, 3. For Wi-Fi connections, follow instructions 1, 2, 4, 5, 6.

1. Click the "Config" button.



2. Click the  button.



3. Plug the network cable into the back of the machine. If the printer successfully connects to the network, the ethernet connection icon will appear on the top right of the status bar as shown below.



4. To use a WiFi connection, toggle the WiFi option to ON, and choose the Wi-Fi network that your computer is connected to.

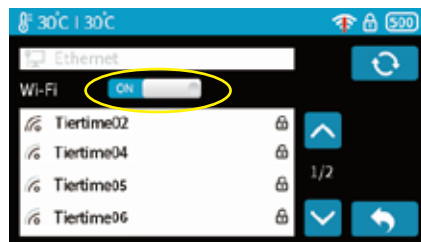

5. Input the Wi-Fi password, then press Return.



6. If the printer is successfully connected to the Wi-Fi network, the Wi-Fi connection icon will appear in the top right of the status bar as shown below.

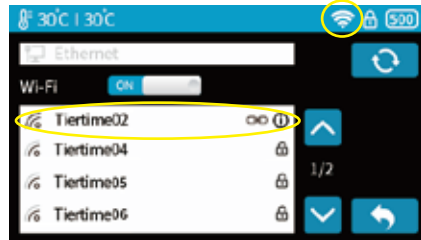

# Load and Print 3D Models

1\ Connect the printer to the computer via USB, ethernet or Wi-Fi.



2\ Click the "Build" button at the main menu to enter the print setup interface, click "+" button to load a file (image or STL/UP3 file).

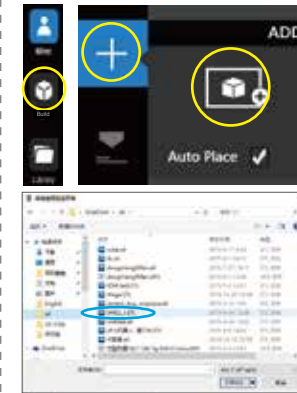

3\ Use the adjustment wheel to setup the print job.

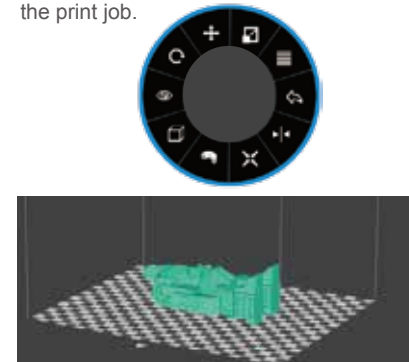

4\ Click "Print".

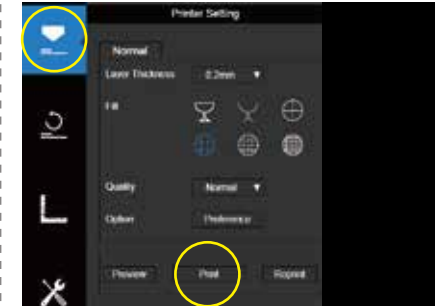

5\ Slicing and data transmission progress will be shown on the status bar.

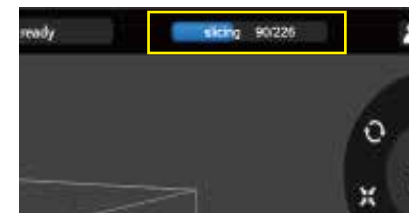

6\ When the data transmission completes, the amount of time and material needed for the print job will be shown. After this point, the user can safely disconnect from the printer.

