

H400

Quick Start Guide

V 0.1

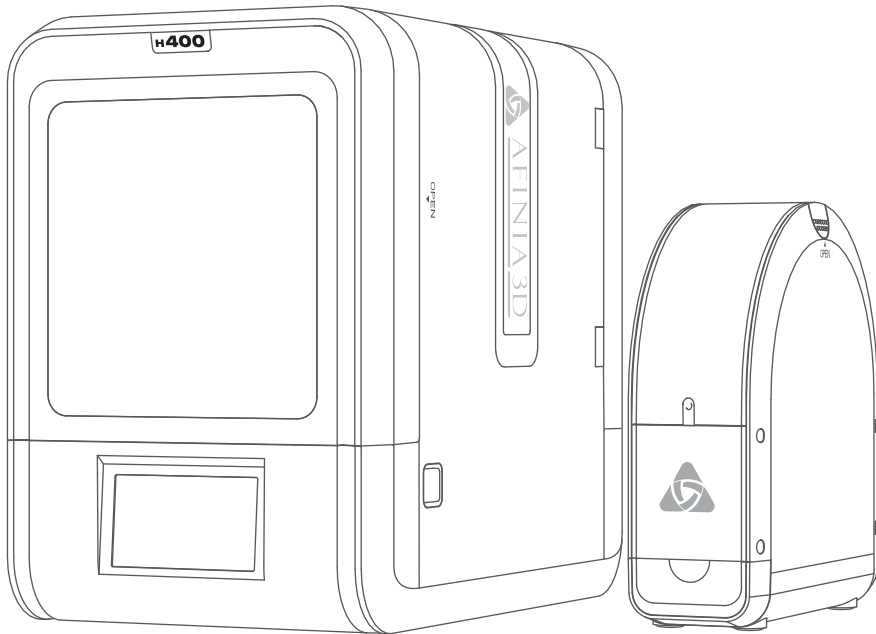

Download full user manual at www.afia.com/support

Index

Unpacking	1
Install Printer and External Spool Holder	2
Install Software	3
Load Filament	4\5
Setup Wi-Fi	6
Load and Print Model	7

Unpacking

- 1\ After unboxing the machine, remove the cushions inside the printer.

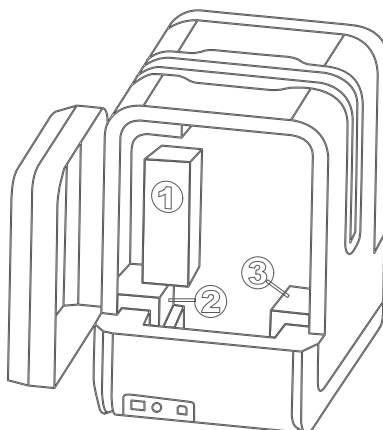

- 2\ Open the front door and remove the top lids.

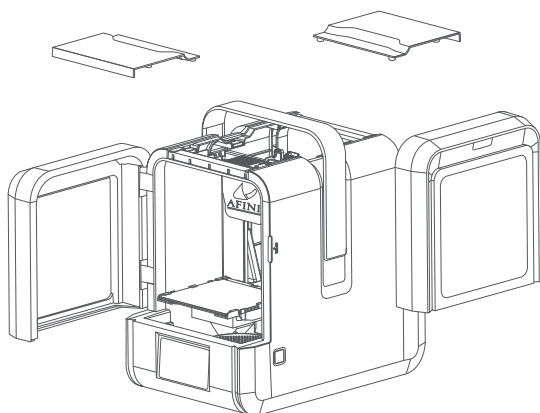

- 3\ Find the print head in the accessory box.

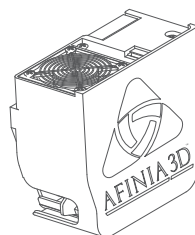

Install Printer and External Spool Holder

1\ Align the print head to the slots in the print head mount.

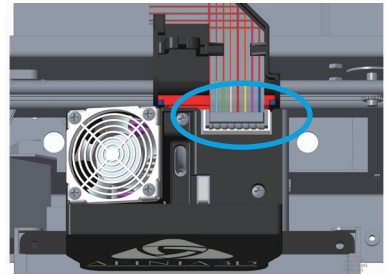
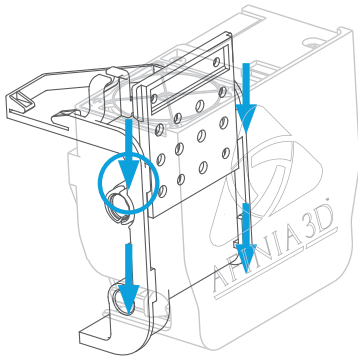
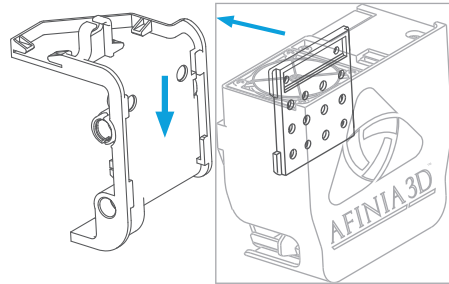

2\ Slide the mounting plate into the slots and plug in the rainbow cable.

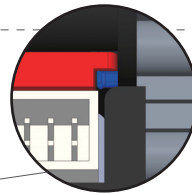
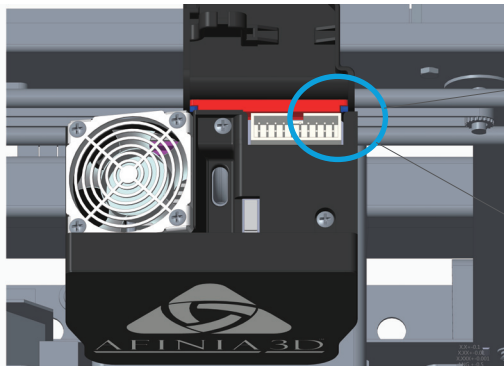

3\ The print head must be pushed to the bottom of the mount.

Notice: When installed correctly, the red and blue shaded parts should be at the same level.

Install Software and Connect to Printer

1\ Please go to www.afinia.com/support/downloads to download the Studio software and install it on your computer.

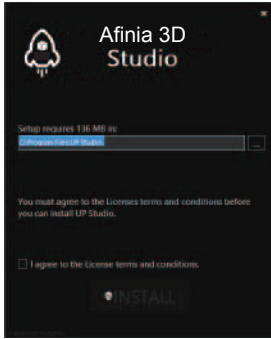

2\ Connect the printer to your computer.

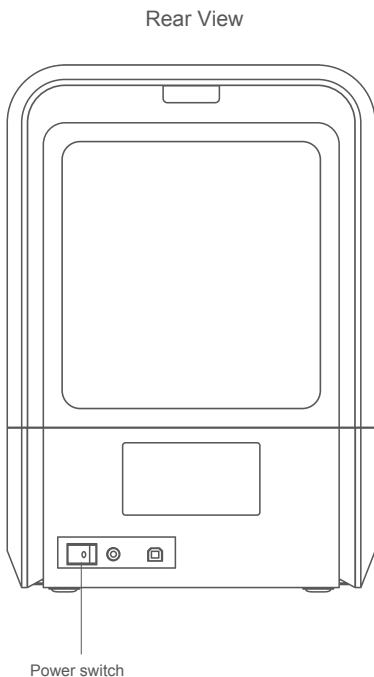

3\ Automatic nozzle height detection.

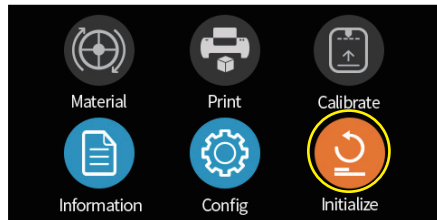

① Click the "Initialize" button to initialize the printer.

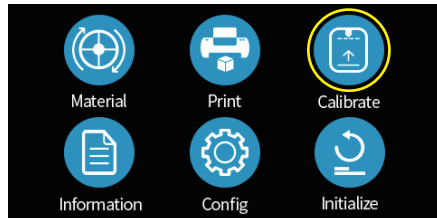

② Click the "Calibrate" button.

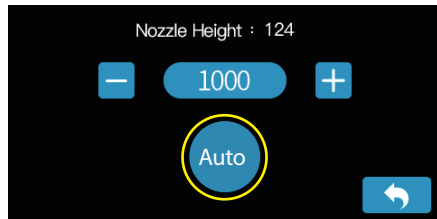

③ Click "Auto" to automatically detect the nozzle height.

Load Filament

1\ Put filament into the external spool holder and insert filament into the guiding tube.

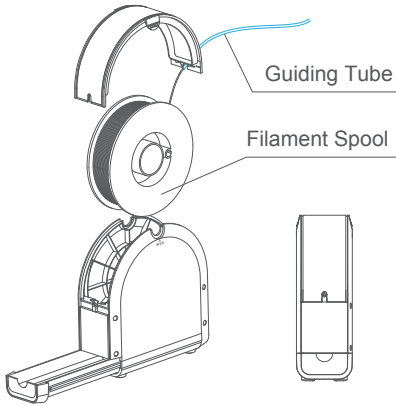

2\ Put the guiding tube into the rubber ring.

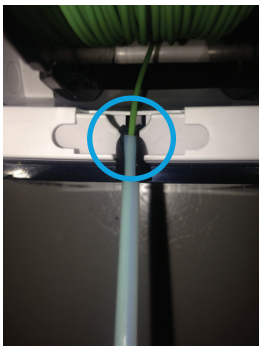
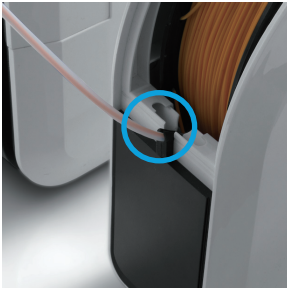

3\ Insert filament and guiding tube into the machine through the hole on the back door.

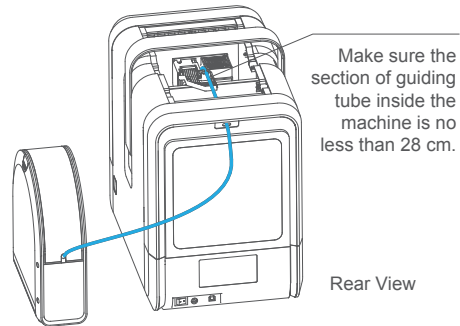

4\ In the material page, press the circular material button to switch between different materials.

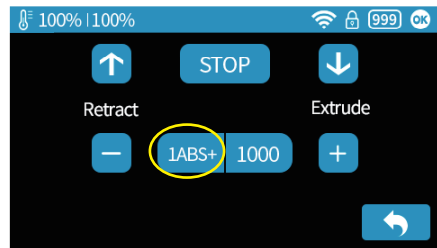

5\ After selecting the right material, click "Extrude". The print head temperature will be displayed on the status bar on top.

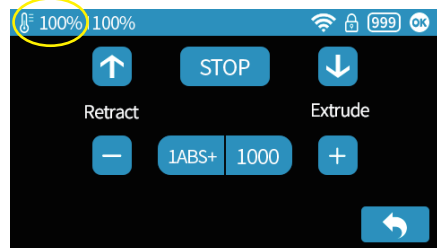

6\ Gently push the filament into the filament entrance and down until it stops. After reaching the print temperature, the printer will beep and start extruding filament.

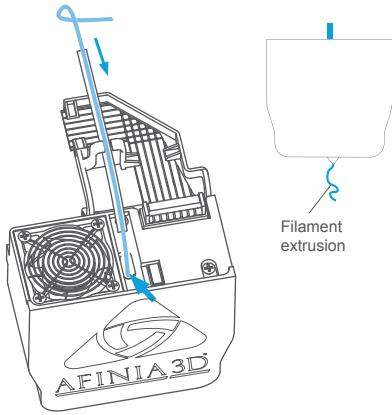

8\ Close the top covers and doors.

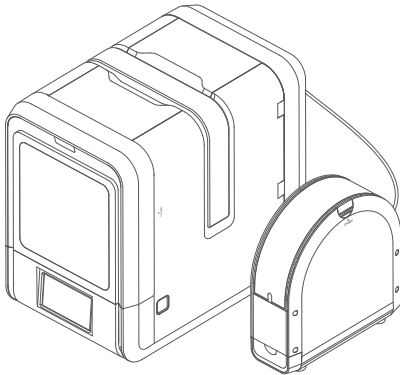

7\ Push the guiding tube into the filament entrance and insert the tube into the holding clip on the mount.

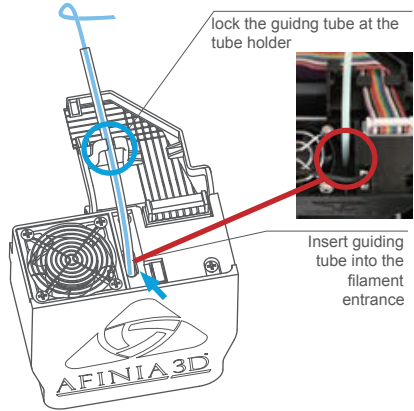

9\ Please note that the external spool holder can only be placed at the following positions. other locations could adversely affect printing performance.

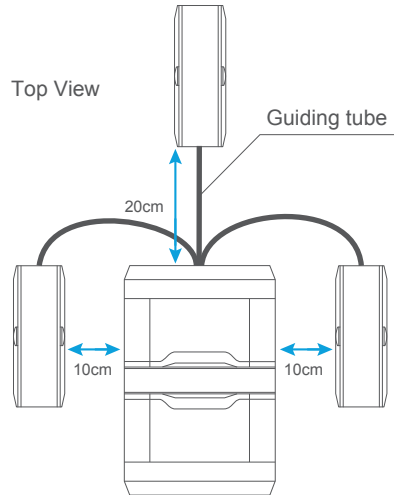

Setup Wi-Fi

1\ Click the “Config” button.

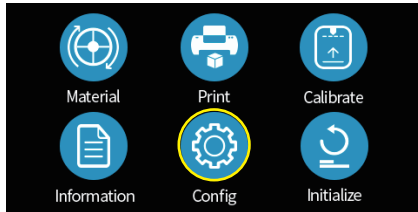

3\ Click on the top right corner of the search key to search for your Wi-Fi network.

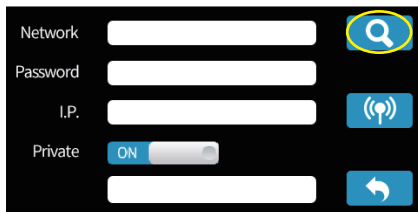

5\ Click the password field to input your Wi-Fi password.

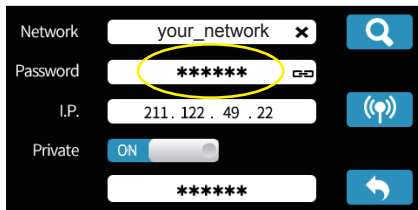

7\ Click the “connect” button. If connected successfully, the Wi-Fi symbol will change from empty to filled.

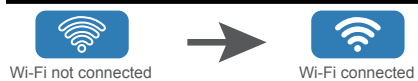
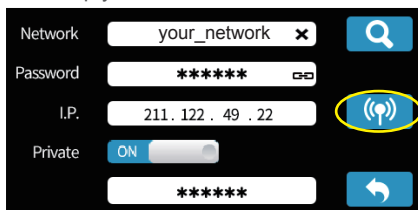

2\ Make sure the Wi-Fi field option is “ON”, then click the Wi-Fi button in the upper right corner.



4\ Choose a Wi-Fi network in the list. It needs to be the same as your computer's network.

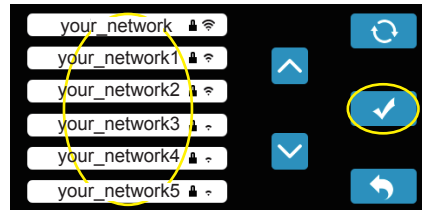

6\ Input the password, then press “return”.



8\ The “Private” option allows users to set a password for the machine to prevent unauthorized Wi-Fi access.

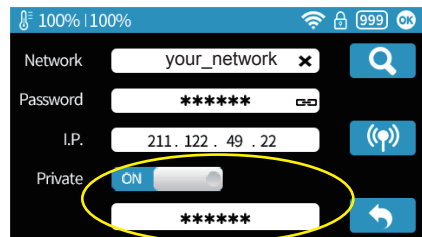

Load and Print 3D Models

1\ Connect the printer to the computer via USB or Wi-Fi.



3\ Use the adjustment wheel to setup the print job.

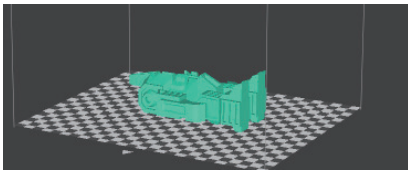

5\ Slicing and data transmission progress will be shown on the status bar.

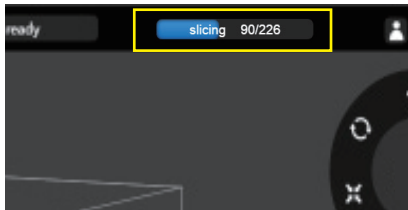

2\ Click the “Build” button at the main menu to enter the print setup interface, click “+” button to load a file (image or STL/UP3 file).

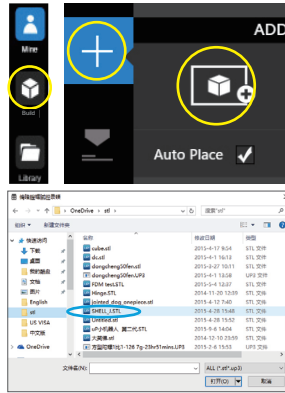

4\ Click “Print”.

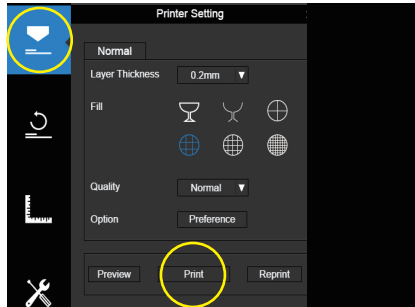

6\ When the data transmission completes, the amount of time and material needed for the print job will be shown. After this point, the user can safely disconnect from the printer.

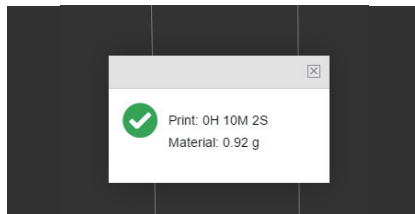



Afinia 3D

8150 Mallory Court, PO BOX 846
Chanhassen, MN 55317

[youtube.com/afinia3dprint](https://www.youtube.com/afinia3dprint)

Phone Support: 952-279-2643

Support: support@afinia.com Web: www.afinia.com