



GrimmSpeed Install Guide Series
Installing the GrimmSpeed 02-07 Subaru Hood Strut Kit
Updated 12/12/13

Introduction: This guide will illustrate the installation of the GrimmSpeed Subaru Hood Strut Kit. The difficulty here is relatively low, so take your time and enjoy the job!

Tools: The tools listed below are suggested for this task (figure 1). Optional tools are noted.

- 1/2in wrench
- 13mm wrench
- 10mm, 12mm, 13mm sockets
- Ratchet and extension
- Flathead screwdriver



Figure 1: Tools

Tips: Be careful not to drop the hood on yourself or your fingers during installation!

Procedure:

1. Begin by collecting your tools and popping your hood. This'll be quick!
2. *Prop your hood open using your OEM hood prop. A second set of hands can help make 'hood management' a little easier.*
3. Begin by releasing the clips on the 'empty' end of each strut. This can be a little bit tricky, but if you can get your screwdriver (or other prying tool) under the clip, you should have no trouble. Do not remove the clip, only slide it a bit as shown.



Figure 2: Release socket clips

4. Next, install the machined brackets on the end of each strut containing the ball stud. Not that the ball threads into the flat side of the bracket. Use a 1/2in wrench to tighten firmly into bracket.



Figure 3: Installing rubber bumper

5. Now we'll begin remove the 12mm fender bolt that's just forward of the strut tower on each side. We won't be reusing this bolt, so put it someplace safe.



Figure 4: Remove fender bolts

6. Next, install the stainless steel ball studs into these holes. Tighten them snug with a 1/2in wrench, but do not over-tighten.



Figure 5: Install ball studs

7. Continue installation by removing the upper hinge bolt using a 12mm socket and wrench. Set this bolt aside. We'll be replacing it with a new bolt, but you may want it in the future.

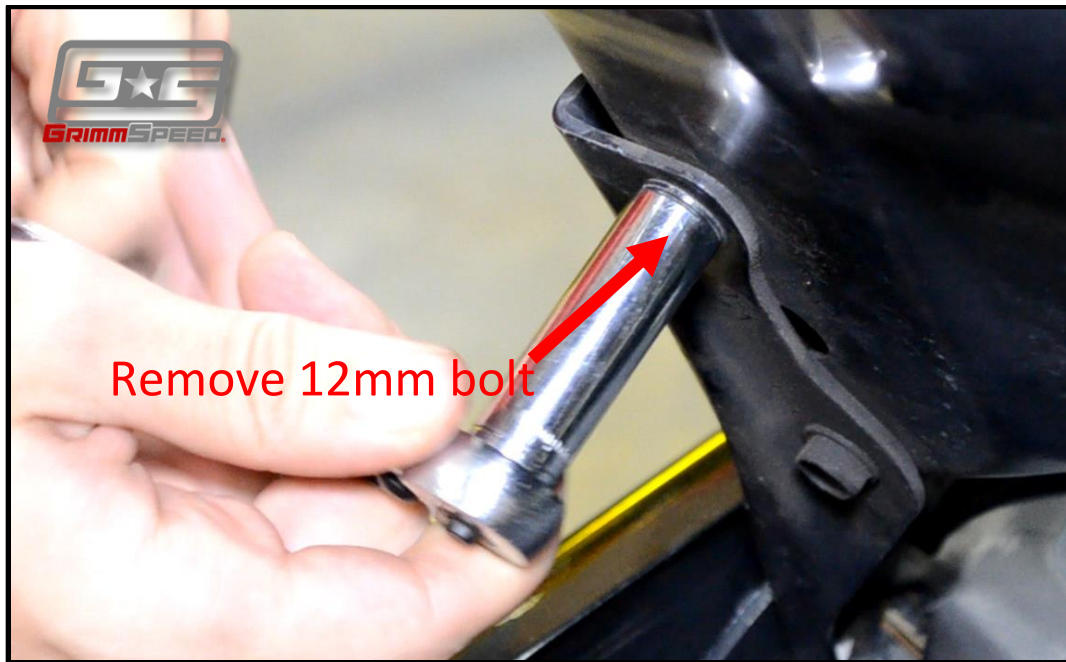

Figure 6: Remove upper hinge bolt

8. Finally, we'll install the strut/bracket that we assembled earlier. Use the provided 13mm bolt to pass through the bracket and into the hood. Note that the ball stud points away from the vehicle. Repeat on both sides. BE VERY CAREFUL TO NOTE THE OREINTATION OF THE BRACKET IN THE PHOTO.

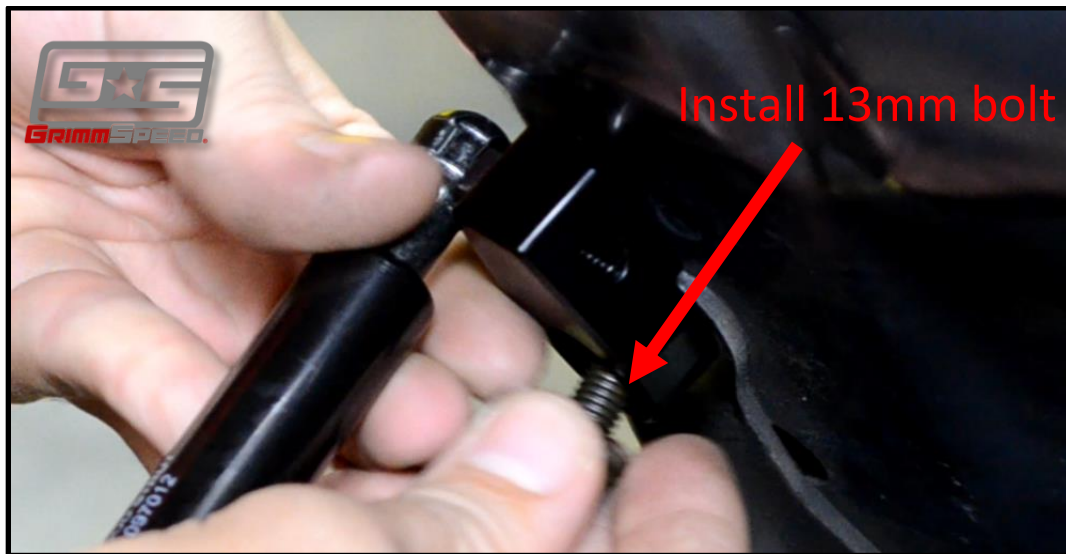

Figure 7: Install hinge brackets.

9. Lastly, lift your hood off of its prop and push the empty end of the strut down onto the stainless ball stud. With a little bit of pressure, it should pop right on. After it's fully seated, push the small metal clip back into its original position. Repeat on both sides.

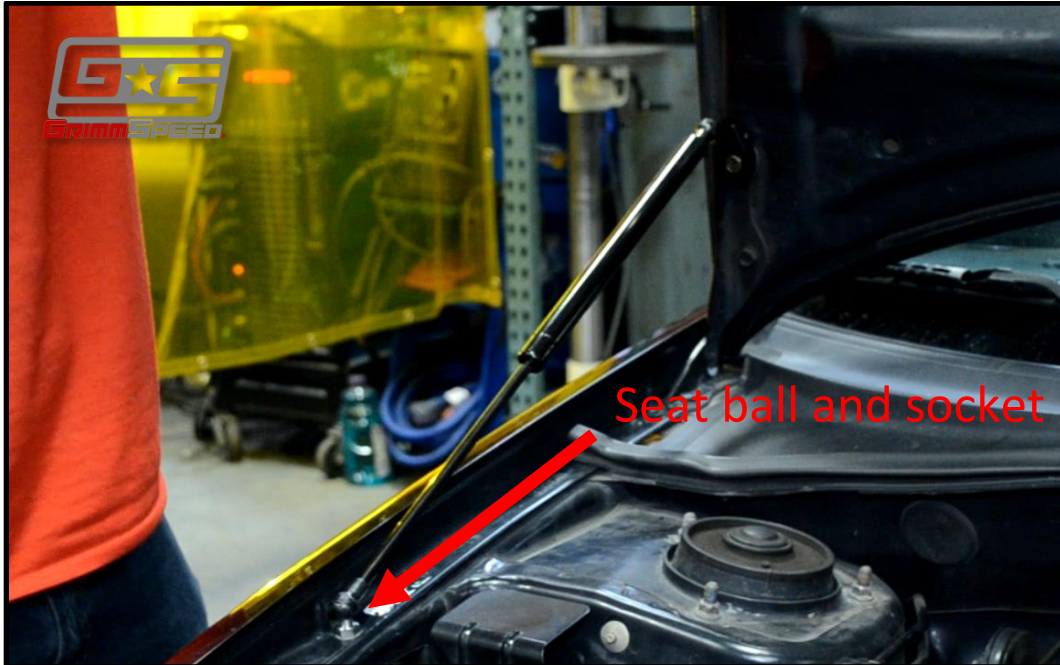

Figure 9: Complete installation.

10. Now go ahead and install the GrimmSpeed branding tags in your desired location! Simply removing the backing and apply with firm pressure.



Figure 13: Loosen lower hood hinge bolt.

That's it! You should be all set to go! Double check your installation, verify proper operation and enjoy. If you have any questions, please feel free to contact us!