

LIFAN SS3 150CC & LIFAN KP-MINI RS EFI 150CC PARTS CATALOG

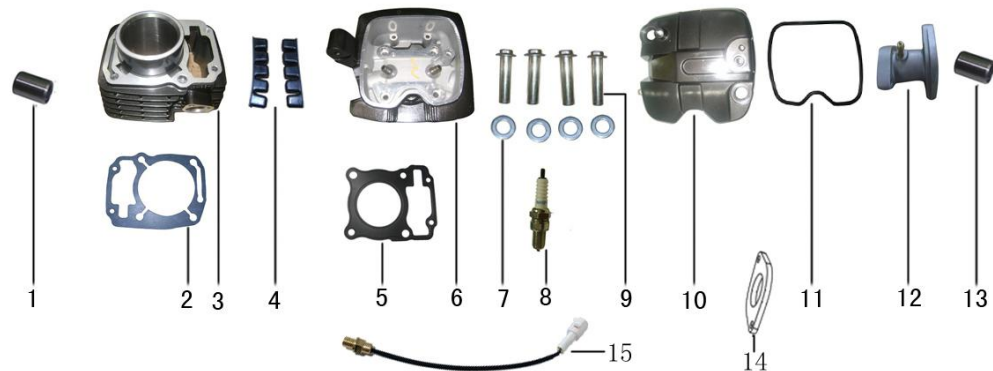

*Please refer to the Remarks Section for EFI Version Part #s

E-01 气缸 气缸头 CYLINDER BLOCK & CYLINDER HEAD



S/N	PartNo	Description	Unit	Qty	Remark
1	157FMJE01-01	Dowel pin (Φ 10×12)	PC	4	
2	157FMJE01-02	Gasket, Cylinder Block	PC	1	
3	157FMJE01-03	Cylinder Block	PC	1	
4	157FMJE01-04	Pad, cylinder head damping	PC	3	
5	157FMJE01-05	Gasket, Cylinder head	PC	1	
6	157FMJE01-06	Cylinder Head Assy	PC	1	
	157FMJE01-06-1	Cylinder Head Assy(EFI)	PC	1	EFI Version
7	157FMJE01-07	Washer, Cylinder head	PC	4	
8	157FMJE01-08	Spark Plug B8RC	PC	1	
9	157FMJE01-09	Cap Nut	PC	4	
10	157FMJE01-10	Cover comp., cylinder head	PC	1	
11	157FMJE01-11	Gasket, cylinder head cover	PC	1	
12	157FMJE01-12	Inlet Pipe Set	PC	1	
	157FMJE01-12-1	Manifold comp, intake	PC	1	EFI Version
13	157FMJE01-13	Dowel pin (Φ 8×14)	PC	3	
14	157FMJE01-14	Insulator, Inlet Pipe	PC	1	EFI Version
15	157FMJE01-15	Cylinder temperature sensor	PC	1	EFI Version

E-09 曲轴 活塞 CRANKSHAFT-PISTON

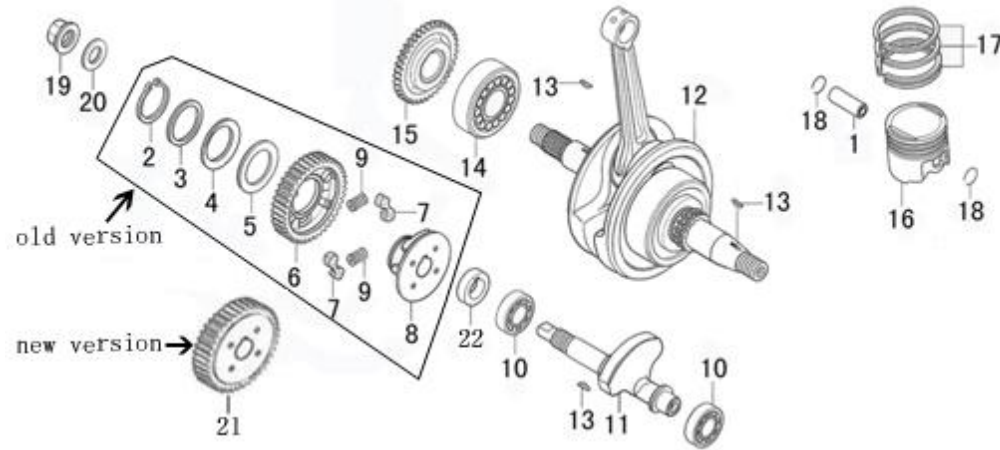

S/N	PartNo	Description	Unit	Qty	Remark
1	157FMJE09-01	Piston Pin	PC	1	
2	157FMJE09-02	Retainer, ϕ 28	PC	1	
3	157FMJE09-03	Balanced Shaft Washer, I	PC	1	
4	157FMJE09-04	Washer	PC	1	
5	157FMJE09-05	Balanced Shaft Washer, II	PC	1	
6	157FMJE09-06	Gear, balanced shaft driven	PC	1	
7	157FMJE09-07	Rubber	PC	2	
8	157FMJE09-08	Plate, balanced driven gear	PC	1	
9	157FMJE09-09	Spring, balanced shaft	PC	2	
10	157FMJE09-10	Bearing, 6202	PC	2	
11	157FMJE09-11	Shaft, balanced	PC	1	
12	157FMJE09-12	Crankshaft Assy	PC	1	
	157FMJE09-12-1	Crankshaft Assy	PC	1	EFI Version
13	157FMJE09-13	Woodruff Key	PC	2	
14	157FMJE09-14	Bearing	PC	1	
	157FMJE09-14-1	Bearing, 28 \times 68 \times 17	PC	1	EFI Version
15	157FMJE09-15	Gear, balanced shaft driven	PC	1	
16	157FMJE09-16	Piston	PC	1	
17	157FMJE09-17	Piston Ring Set	SET	1	
18	157FMJE09-18	Circlip	PC	2	

F-01 灯具 LIGHTS

F-01 灯具 LIGHTS



S/N	PartNo	Description	Unit	Qty	Remark
1	KPMINI150F01-01	Headlight Hood	PC	1	
2	KPMINI150F01-02	Headlight Assy	PC	1	
3	KPMINI150F01-03	Front Winker, LH II	PC	1	
4	KPMINI150F01-04	Front Winker, RH II	PC	1	
5	KPMINI150F01-05	Rear Licence Light	PC	1	
6	KPMINI150F01-06	Taillight Assy	PC	1	
7	KPMINI150F01-07	Bulb HS1	PC	1	
8	KPMINI150F01-08	Bulb, Rear Licence Light	PC	1	
9	KPMINI150F01-09	Meter Case	PC	1	
10	KPMINI150F01-10	Front Winker Holder, RH	PC	1	
11	KPMINI150F01-11	Front Winker Holder, LH	PC	1	
12	KPMINI150F01-12	Front Winker, RH	PC	1	
13	KPMINI150F01-13	Front Winker, LH	PC	1	
14	KPMINI150F01-14	Rear Winker, RH	PC	1	
15	KPMINI150F01-15	Rear Winker, LH	PC	1	

F-09 搁脚组合 FOOTREST

F-09 搁脚组合 FOOTREST

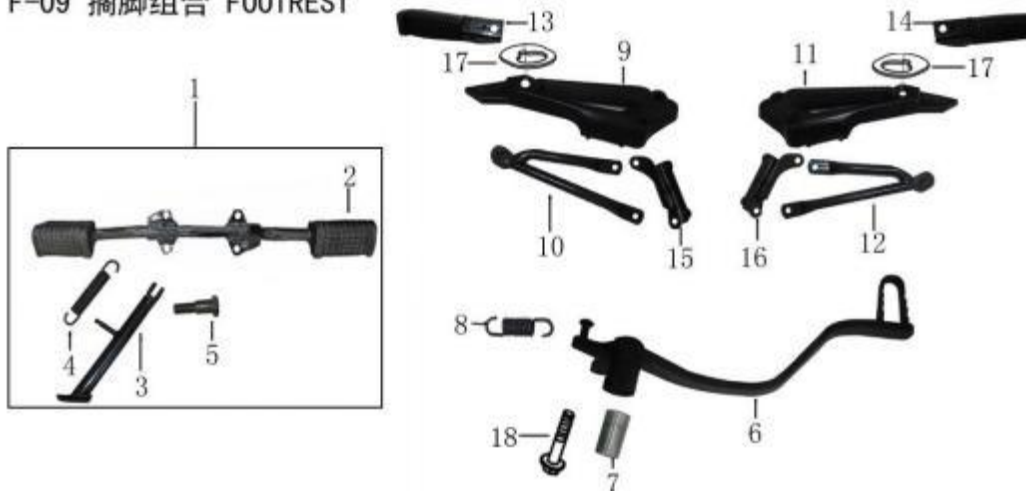

S/N	PartNo	Description	Unit	Qty	Remark
1	KPMINI150F09-01	Rider Footrest Assy	SET	1	
2	KPMINI150F09-02	Front Footrest Rubber Sleeve	PC	2	
3	KPMINI150F09-03	Side Stand Comp.	PC	1	
4	KPMINI150F09-04	Spring, Side Stand	PC	1	
5	KPMINI150F09-05	Shoulder Bolt	PC	1	
6	KPMINI150F09-06	Rear Brake Pedal Comp.	PC	1	
7	KPMINI150F09-07	Rear Brake Pedal Bush	PC	1	
8	KPMINI150F09-08	Rear Brake Pedal Torsion Spring	PC	1	
9	KPMINI150F09-09-N	Passenger Footrest Ornament Comp., RH	PC	1	
10	KPMINI150F09-10	Passenger Footrest Stay Comp., RH	PC	1	
11	KPMINI150F09-11	Passenger Footrest Ornament Comp., LH	PC	1	
12	KPMINI150F09-12	Passenger Footrest Stay Comp., LH	PC	1	
13	KPMINI150F09-13	Passenger Footrest Comp., RH	PC	1	
14	KPMINI150F09-14	Passenger Footrest Comp., LH	PC	1	
15	KPMINI150F09-15	Rear Footrest Bracket, Comp RH	PC	1	
16	KPMINI150F09-16	Rear Footrest Bracket, Comp LH	PC	1	
17	KPMINI150F09-17	Foot pad, pillion footrest bracket	PC	2	
18	KPMINI150F09-18	Bolt, M10×1.25×60	PC	1	

F-11 油箱总成 FUEL TANK ASSY

F-11 油箱总成 FUEL TANK ASSY

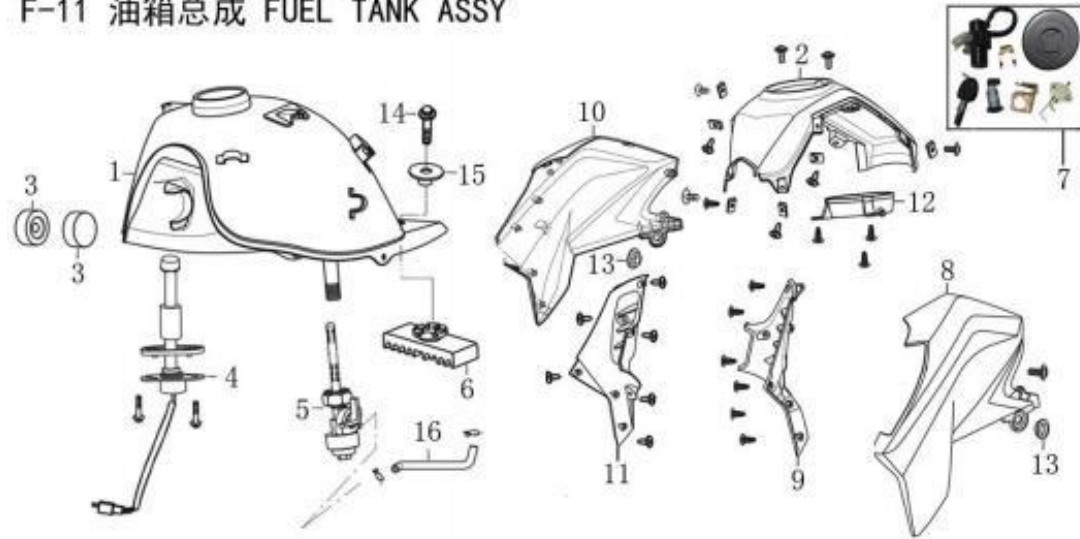

S/N	PartNo	Description	Unit	Qty	Remark
1	KPMINI150F11-01	Fuel Tank Weldment	PC	1	
	KPMINI150F11-01-1	Fuel Tank Weldment (EFI)	PC	1	EFI Version
2	KPMINI150F11-02	Fuel Tank Ornament, ON	PC	1	
3	KPMINI150F11-03	Front Cushion, Fuel Tank	PC	2	
4	KPMINI150F11-04	Fuel Sensor	PC	1	
5	KPMINI150F11-05	Fuel Cock Comp.	PC	1	
6	KPMINI150F11-06	Fuel Tank Rear Cushion	PC	1	
7	KPMINI150F11-07	Lock Assy	SET	1	
	KPMINI150F11-07-1	Lock Assy (EFI)	SET	1	EFI Version
8	KPMINI150F11-08	Fuel Tank Ornament, LH	PC	1	
9	KPMINI150F11-09	Fuel Tank Inner Ornament, LH	PC	1	
10	KPMINI150F11-10	Fuel Tank Ornament, RH	PC	1	
11	KPMINI150F11-11	Fuel Tank Inner Ornament, RH	PC	1	
12	KPMINI150F11-12	Cover, fuel tank	PC	1	
13	KPMINI150F11-13	Grommet, side cover	PC	2	
14	KPMINI150F11-14	Bolt, M8×30	PC	1	
15	KPMINI150F11-15	Collar, Φ 8.5×Φ 30-20	PC	1	
16	KPMINI150F11-16	Hose, Fuel Tank	PC	1	

