

**LIFAN LYCAN V-TWIN 250CC
PARTS CATALOG**

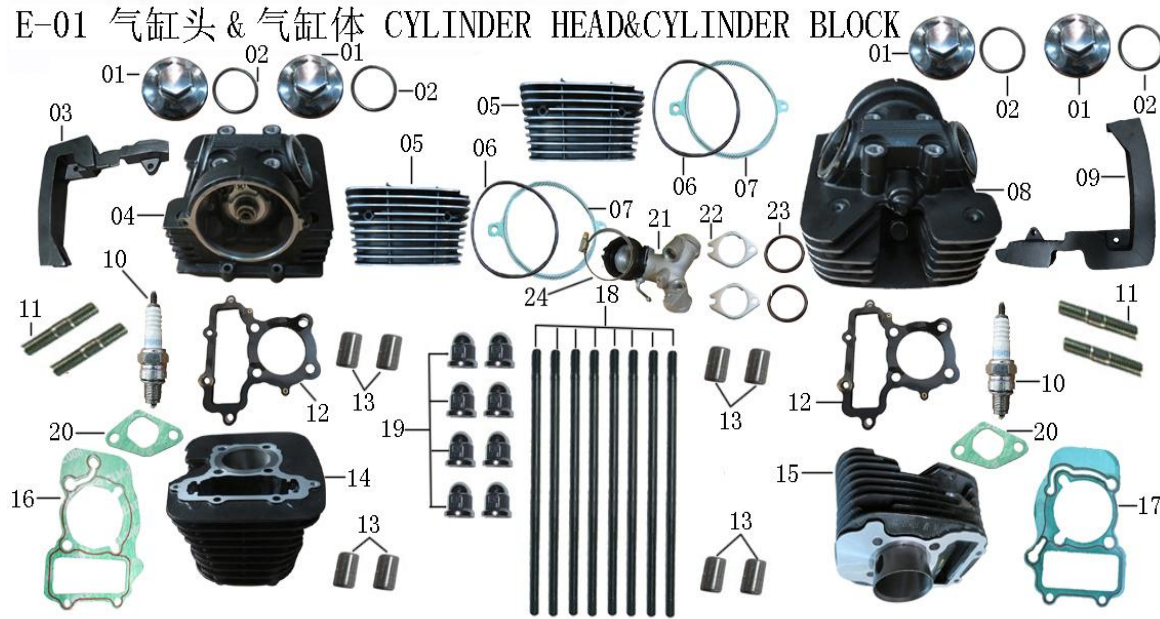

2V49FMM-P E-01 气缸头&气缸体 CYLINDER HEAD & CYLINDER BLOCK



PartNo	Description	Unit
VMPE01-01	Valve Cover	PCS
VMPE01-02	Valve Cover O-Ring 44.5x3.1	PCS
VMPE01-03	Ornament,Cylinder Head Comp. I	PCS
VMPE01-04	Cylinder Head Comp. I	PCS
VMPE01-05	Cylinder Head Cover, LH	PCS
VMPE01-06	Cylinder Head Cover O-Ring, LH 79x2.9	PCS
VMPE01-07	Cylinder Head Cover Gasket, LH	PCS
VMPE01-08	Cylinder Head Comp. II	PCS
VMPE01-09	Ornament,Cylinder Head Comp. II	PCS
VMPE01-10	Spark Plug	PCS
VMPE01-11	Stud M6x42	PCS
VMPE01-12	Cylinder Head Gasket	PCS
VMPE01-13	Cylinder Head Dowel Pin 10x14	PCS
VMPE01-14	Cylinder Block Comp. I	PCS
VMPE01-15	Cylinder Block Comp. II	PCS
VMPE01-16	Cylinder Block Gasket	PCS

2V49FMM-P E-03 配气机构 VALVE TRAIN

E-03 配气机构 VALVE TRAIN

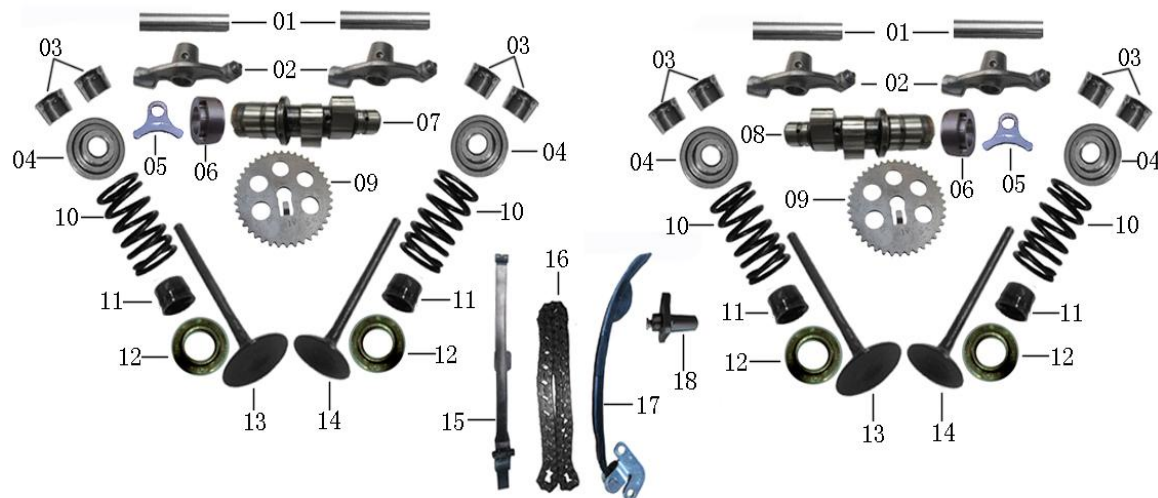

PartNo	Description	Unit
VMPE03-01	Rocker Arm Shaft	PCS
VMPE03-02	Valve Rocker Arm	PCS
VMPE03-03	Valve Split Cone	PCS
VMPE03-04	Valve Spring Upper Seat	PCS
VMPE03-05	Camshaft Bush Clamping Plate	PCS
VMPE03-06	Camshaft Bush	PCS
VMPE03-07	Camshaft	PCS
VMPE03-08	Camshaft II	PCS
VMPE03-09	Timing Driven Sprocket	PCS
VMPE03-10	Valve Outer Spring	PCS
VMPE03-11	Valve Stem Oil Seal	PCS
VMPE03-12	Valve Outer Spring Seat	PCS
VMPE03-13	Intake Valve	PCS
VMPE03-14	Exhaust Valve	PCS
VMPE03-15	Guide Wheel	PCS
VMPE03-16	Timing Chain	PCS

2V49FMM-P E-04 曲柄连杆 & 活塞总成 CRANKSHAFT & PISTON SAAY

E-04 曲柄连杆 & 活塞总成 CRANKSHAFT & PISTON ASSY



PartNo	Description	Unit
VMPE04-01	Piston Ring Set	SET
VMPE04-02	Piston	PCS
VMPE04-03	Piston Pin Circlip	PCS
VMPE04-04	Piston Pin	PCS
VMPE04-05	Crankshaft Woodruff Key	PCS
VMPE04-06	Crankshaft & Connecting Rod	PCS
VMPE04-07	Pin, Crankshaft RH	PCS
VMPE04-08	Timing Drive Sprocket	PCS
VMPE04-09	Primary Drive Gear	PCS
VMPE04-10	Timing Drive Sprocket Hub	PCS
VMPE04-11	Starting Shaft Snap Ring II	PCS
VMPE04-12	Primary Drive Gear Thrust Washer	PCS
VMPE04-13	Primary Drive Gear Locknut	PCS

2V49FMM-P E-05 机油泵 OIL PUMP

E-05 机油泵 OIL PUMP

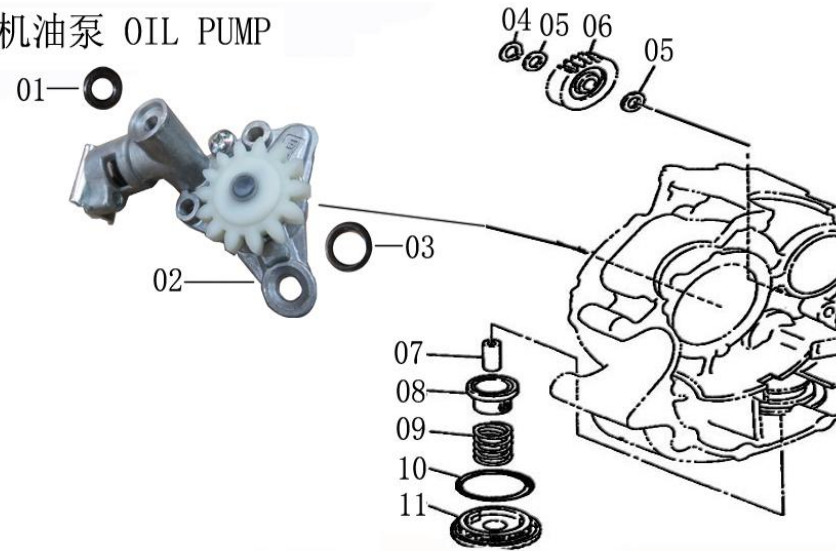

PartNo	Description	Unit
VMPE05-01	Seal 6x3	PCS
VMPE05-02	Oil Pump Assy	PCS
VMPE05-03	O-ring, oil Pump	PCS
VMPE05-04	Circllet 10-Ct 0 BU	PCS
VMPE05-05	Washer 10	PCS
VMPE05-06	Oil Pump Driving Gear	PCS
VMPE05-07	Pass-By Pipe	NO
VMPE05-08	Oil Filter Screen	PCS
VMPE05-09	Oil Filter Screen Spring	PCS
VMPE05-10	Oil Filter Screen Cover O-Ring	PCS
VMPE05-11	Oil Filter Screen Cover	PCS

2V49FMM-P E-06 左曲轴箱盖 & 磁电机 LEFT COVER & MAGNETO

E-06 左曲轴箱盖 & 磁电机 LEFT COVER & MAGNETO

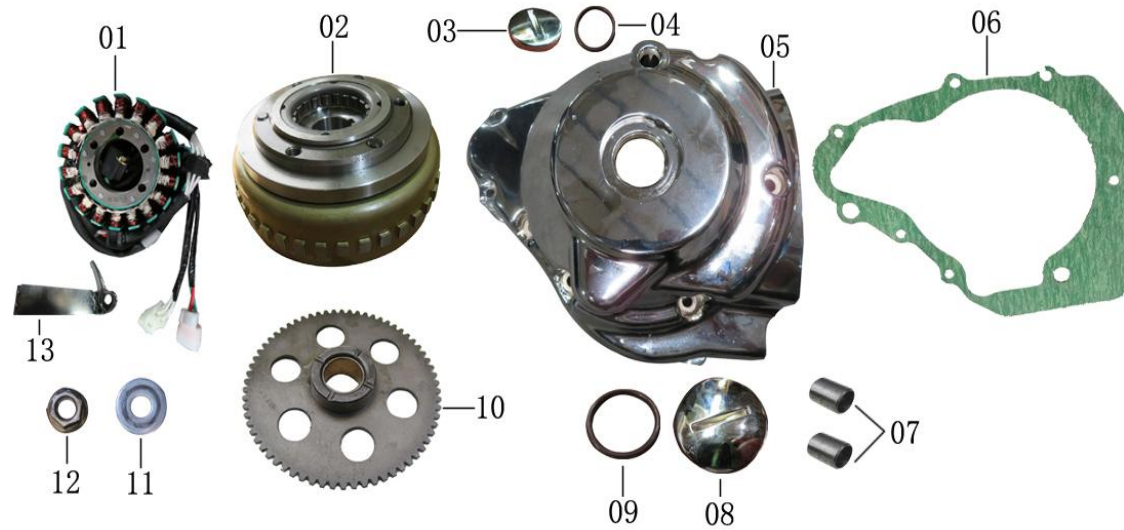

PartNo	Description	Unit
VMPE06-01	Magneto Stator Comp.	PCS
VMPE06-02	Magneto Rotor Comp.	PCS
VMPE06-03	View Hole Plug	PCS
VMPE06-04	Watch Hole Plug O-Ring	PCS
VMPE06-05	Crankcase Cover, LH	PCS
VMPE06-06	Crankcase Cover Gasket, LH	PCS
VMPE06-07	Crankcase Dowel Pin	PCS
VMPE06-08	Plug	PCS
VMPE06-09	O - Ring 22.7x3.1	PCS
VMPE06-10	Starting Clutch Gear Comp.	PCS
VMPE06-11	Thrust Washer	PCS
VMPE06-12	Magneto Locknut	PCS
VMPE06-13	Magneto Wire Clamp	PCS

2V49FMM-P E-07 右曲轴箱盖 RIGHT CRANKCASE COVER

E-07 右曲轴箱盖 RIGHT CRANKCASE COVER



PartNo	Description	Unit
VMPE07-01	Stay, Clutch Cable	PCS
VMPE07-02	Crankcase Cover, RH	PCS
VMPE07-03	Sight Glass	PCS
VMPE07-04	Crankcase Cover Gasket, RH	PCS
VMPE07-05	Oil Filter	PCS
VMPE07-06	O - Ring 63x3	PCS
VMPE07-07	Oil Filter Cover	PCS
VMPE07-08	Crankshaft Oil Seal, LH	PCS
VMPE07-09	Circllet 26	PCS
VMPE07-10	Crankcase Dowel Pin	PCS
VMPE07-11	Dipstick	PCS
VMPE07-12	O-Ring 3x18x3.8	PCS

2V49FMM-P E-08 曲轴箱 CRANKCASE

E-08 曲轴箱 CRANKCASE

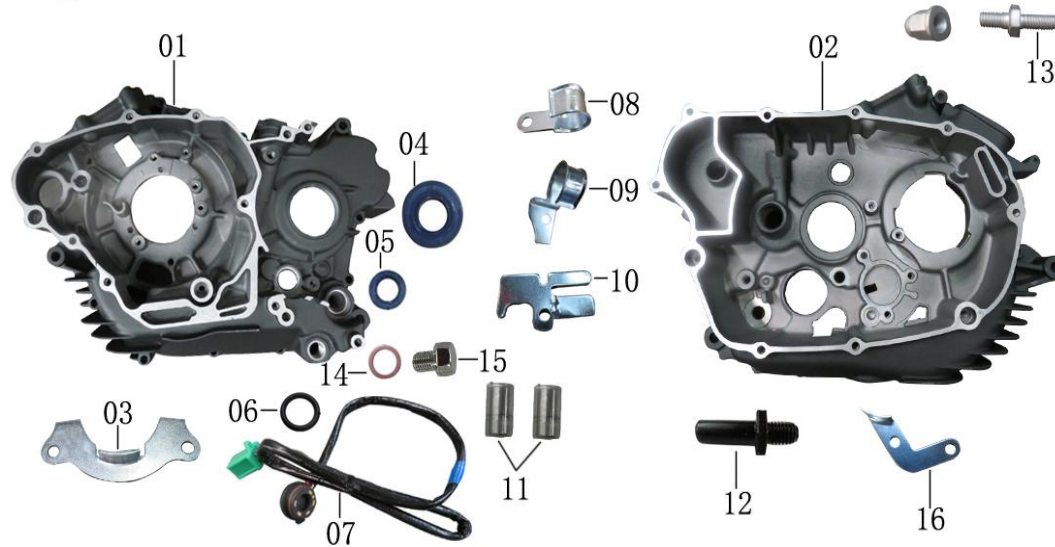

PartNo	Description	Unit
VMPE08-01	Crankcase Comp., LH	PCS
VMPE08-02	Crankcase Comp, RH	PCS
VMPE08-03	Timing Chain Limiting Plate	PCS
VMPE08-04	Countershaft Oil Seal	PCS
VMPE08-05	Clutch Lever Oil Seal	PCS
VMPE08-06	O-Ring, Gear Indicator	PCS
VMPE08-07	Gear Indicator	PCS
VMPE08-08	Ignition Coil Wire Clamp	PCS
VMPE08-09	Magneto Wire Clamp III	PCS
VMPE08-10	Magneto Wire Clamp II	PCS
VMPE08-11	Crankcase Dowel Pin	PCS
VMPE08-12	Return Spring Set Screw	PCS
VMPE08-13	Right Crankcase Plug	PCS
VMPE08-14	Drain Plug Washer	PCS
VMPE08-15	Drain Plug	PCS
VMPE08-16	Timing Chain Limiting Plate II	PCS

2V49FMM-P E-09 离合器 CLUTCH

E-09 离合器 CLUTCH

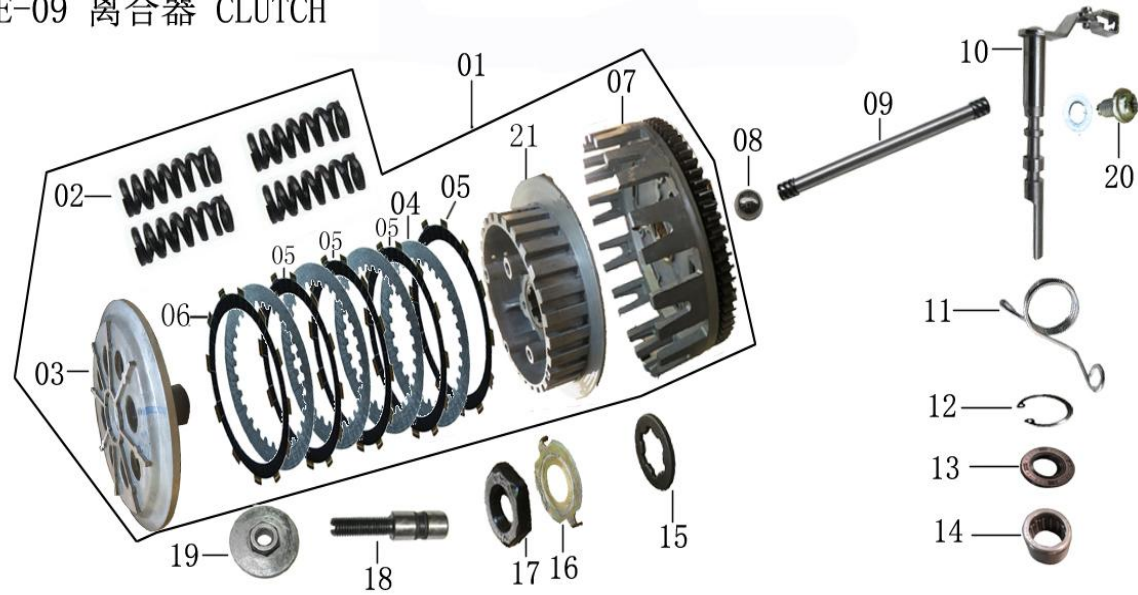

PartNo	Description	Unit
VMPE09-01	Clutch Main Body	PCS
VMPE09-02	Clutch Spring	PCS
VMPE09-03	Clutch Pressure Plate	PCS
VMPE09-04	Driven Plates	PCS
VMPE09-05	Drive Plates	PCS
VMPE09-06	Drive Plates II	PCS
VMPE09-07	Drive Disc Set	PCS
VMPE09-08	Steel Ball 8.731	PCS
VMPE09-09	Clutch Pusher Comp.	PCS
VMPE09-10	Clutch Lever Comp.	PCS
VMPE09-11	Clutch Lever Spring	PCS
VMPE09-12	Circlip 28	PCS
VMPE09-13	Clutch Lever Oil Seal	PCS
VMPE09-14	Needle Bearing	PCS
VMPE09-15	Clutch Spline Washer	PCS
VMPE09-16	Washer	PCS

2V49FMM-P E-10 变速机构 TRANSMISSION

E-10 变速机构 TRANSMISSION

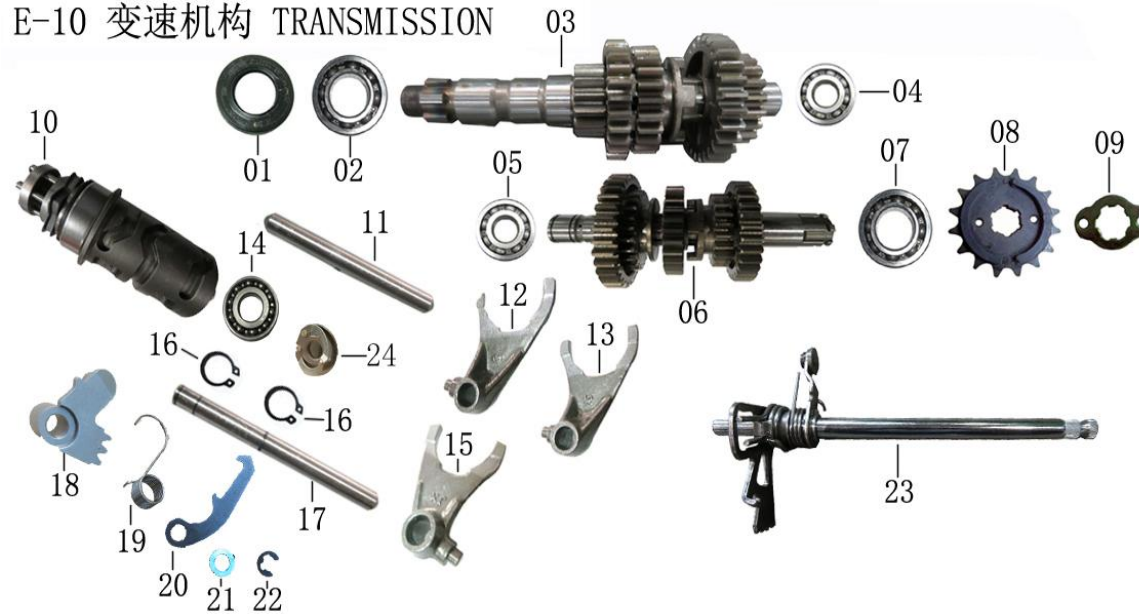

PartNo	Description	Unit
VMPE10-01	Oil Seal 17x28x3.5	PCS
VMPE10-02	Bearing 6205P5	PCS
VMPE10-03	Mainshaft Assy	PCS
VMPE10-04	Bearing 6003	PCS
VMPE10-05	Bearing 6004	PCS
VMPE10-06	Countershaft Assy	PCS
VMPE10-07	Bearing 6305	PCS
VMPE10-08	Output Sprocket	PCS
VMPE10-09	Output Sprocket Locating Plate	PCS
VMPE10-10	Gearshift Drum Assy	PCS
VMPE10-11	Fork Shaft	PCS
VMPE10-12	Fork III	PCS
VMPE10-13	Fork I	PCS
VMPE10-14	Bearing 16001-RS	PCS
VMPE10-15	Fork II	PCS
VMPE10-16	Circllet 10	PCS

2V49FMM-P E-12 电器 ELECTRIC ELEMENT

E-12 电器 ELECTRIC ELEMENT

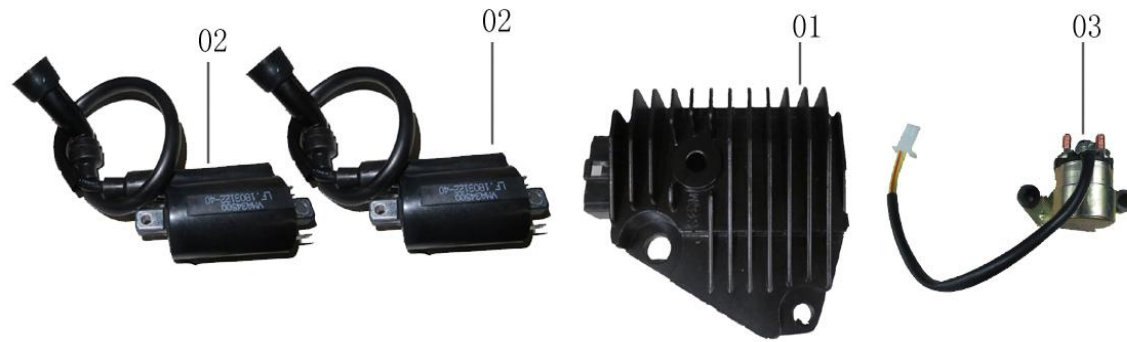

PartNo	Description	Unit
VMPE12-01	Voltage Regulator	PCS
VMPE12-02	Ignition Coil	PCS
VMPE12-03	Starting Relay	PCS

LF250-D F-03 手把开关 HANDLEBAR SWITCH

F-03 手把开关 HANDLEBAR SWITCH

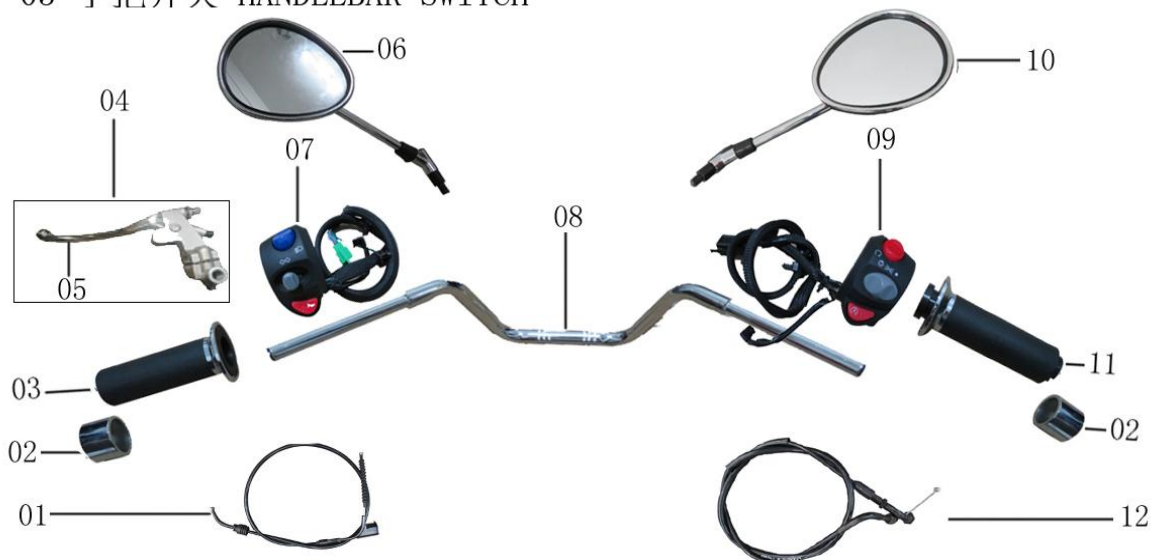

Part No.	Description		Unit
ZMDF03-01	Clutch Cable		PC
ZMDF03-02	Steering Bar Weight Set		PC
ZMDF03-03	Grip Comp., LH		PC
ZMDF03-04	Clutch Lever Holder Set		PC
ZMDF03-05	Clutch Lever		PC
ZMDF03-06	Rearview Mirror		PC
ZMDF03-07	Handlebar Switch, LH		PC
ZMDF03-08	Steering Bar Pipe Comp.		PC
ZMDF03-09	Handlebar Switch, RH		PC
ZMDF03-10	Rearview Mirror		PC
ZMDF03-11	Throttle Grip Comp.		PC
ZMDF03-12	Throttle Cable		PC

LF250-D F-04 方向柱 STEERING STEM

F-04 方向柱 STEERING STEM

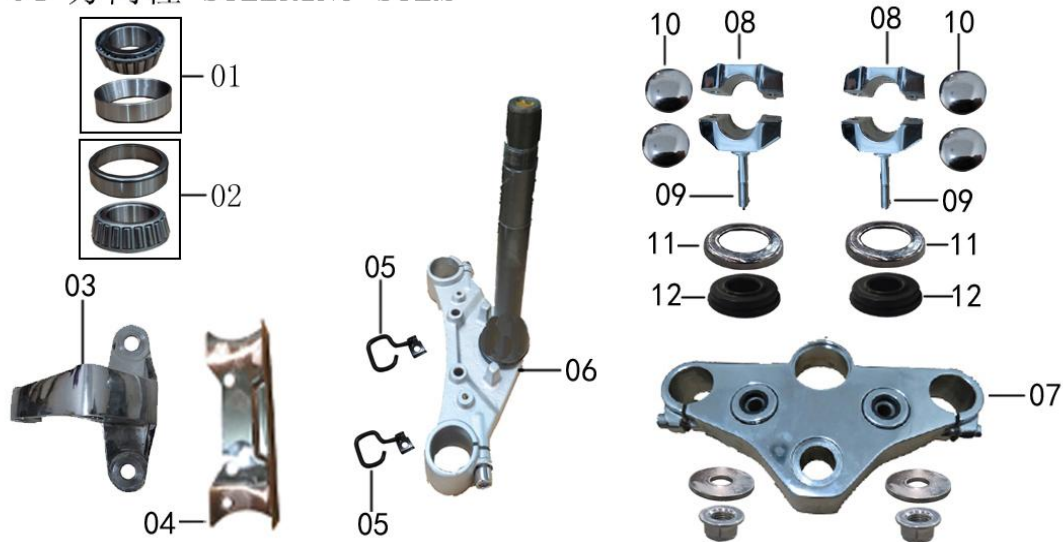

Part No.	Description		Unit
ZMDF04-01	Bearing Set, Upper, steering		PC
ZMDF04-02	Bearing Set, lower, steering		PC
ZMDF04-03	Stay, headlight		PC
ZMDF04-04	Plate, headlight stay		PC
ZMDF04-05	Clamp II, hose		PC
ZMDF04-06	Steering Stem Assy		PC
ZMDF04-07	Top Steering Stem Connection Board		PC
ZMDF04-08	Holder Cap		PC
ZMDF04-09	Steering Bar Holder		PC
ZMDF04-10	Steering Bar Pipe Holder Ornament		PC
ZMDF04-11	Cushion Cover, Steering Stem		PC
ZMDF04-12	Upper Cushion, Steering Stem		PC

LF250-D F-05 前挡泥板 减震器 FRONT FENDER & SHOCK ABSORBER

F-05 前挡泥板 减震器 FRONT FENDER & SHOCK ABSORBER

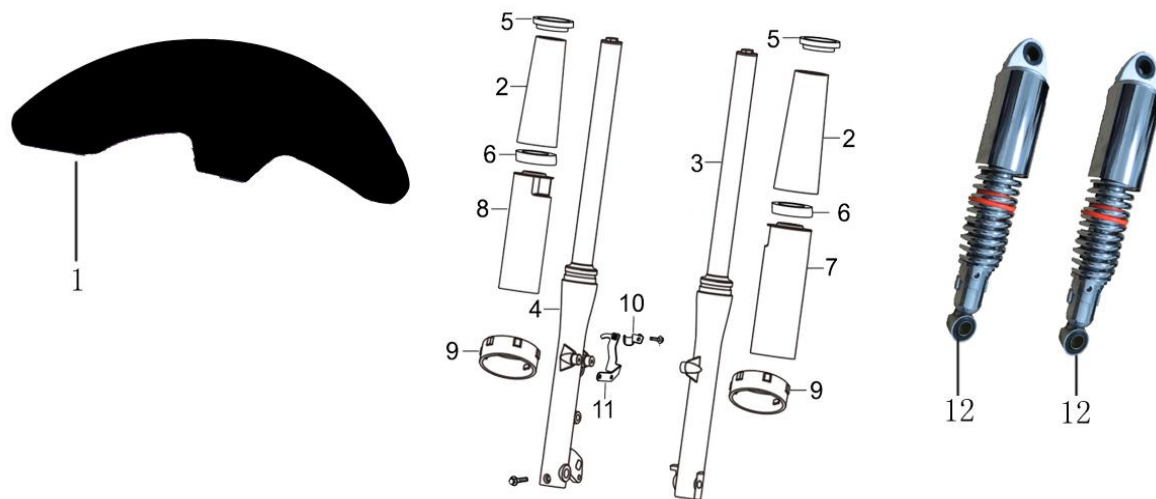

Part No.	Description		Unit
ZMDF05-01	Front Fender		PC
ZMDF05-02	Guide Sleeve, upper, front shock absorber		PC
ZMDF05-03	Front Shock Absorber, LH		PC
ZMDF05-04	Front Shock Absorber, RH		PC
ZMDF05-05	Rubber, upper guide tube top		PC
ZMDF05-06	Rubber, lower, upper guide		PC
ZMDF05-07	Guide Sleeve Set, lower, front shock absorber LH		PC
ZMDF05-08	Guide Sleeve Set, lower, front shock absorber RH		PC
ZMDF05-09	Dust Cover		PC
ZMDF05-10	Front Shock Absorber Oil Seal		PC
ZMDF05-11	Stay set II, front brake hose		PC
ZMDF05-12	Rear Shock Absorber Assy		PC

LF250-D F-06 护板 侧盖 GUARD & SIDE COVER

F-6 护板 侧盖 GUARD & SIDE COVER

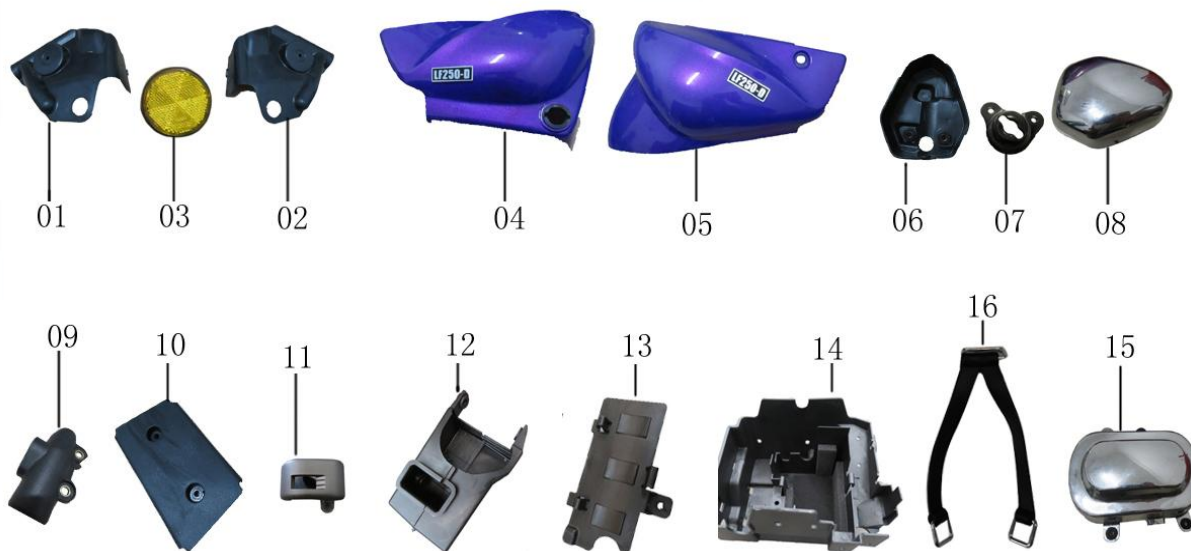

Part No.	Description	Unit
ZMDF06-01	Guard, LH	PC
ZMDF06-02	Guard, RH	PC
ZMDF06-03	Reflector, side	PC
ZMDF06-04	Cover, side, RH	PC
ZMDF06-05	Cover, side, LH	PC
ZMDF06-06	Support, ornament, engine LH	PC
ZMDF06-07	Seat, side cover lock	PC
ZMDF06-08	Ornament, engine, LH	PC
ZMDF06-09	Cover set, rear brake	PC
ZMDF06-10	Guard, lower	PC
ZMDF06-11	Oil Sight Glass, brake reservoir	PC
ZMDF06-12	Trunk, mid	PC
ZMDF06-13	Cover, tool box	PC
ZMDF06-14	Box, tool	PC
ZMDF06-15	Ornamental Cover, RH	PC
ZMDF06-16	Band set, tool	PC

LF250-D F-08 油箱 FUEL TANK

F-08 油箱 FUEL TANK

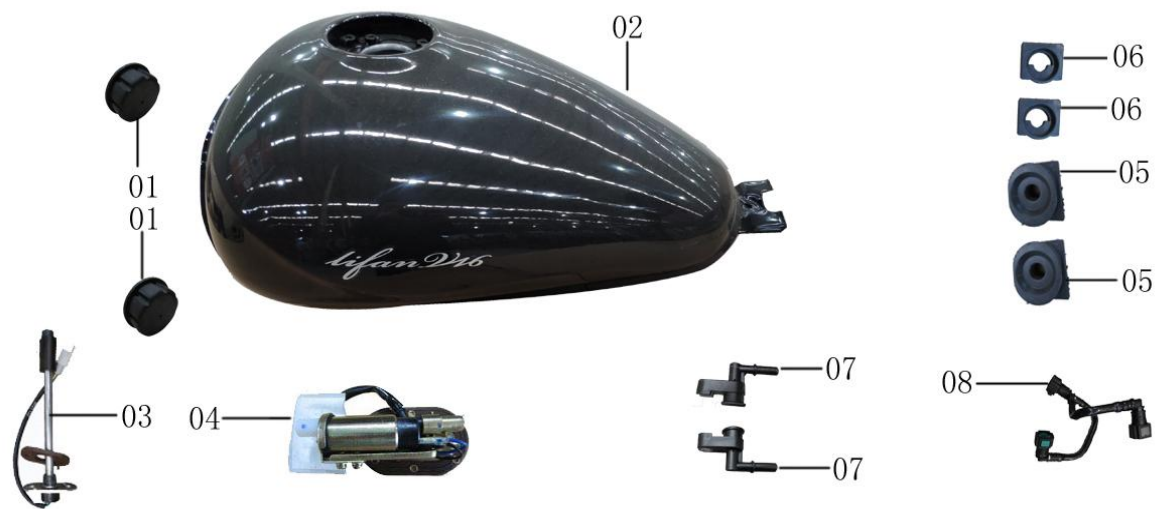

Part No.	Description		Unit
ZMDF08-01	Fuel Tank Front Cushion		PC
ZMDF08-02	Fuel Tank Weldment		PC
ZMDF08-03	Sensor, fuel		PC
ZMDF08-04	Pump, oil		PC
ZMDF08-05	Fuel Tank Rear Cushion		PC
ZMDF08-06	Grommet, upper, rear fuel tank		PC
ZMDF08-07	Fuel Rail		PC
ZMDF08-08	Pipe Tee Comp., hose		PC

LF250-D F-10 后轮 REAR WHEEL

F-10 后轮 REAR WHEEL



Part No.	Description		Unit
ZMDF10-01	Disc, rear brake		PC
ZMDF10-02	Buffer, rear wheel		PC
ZMDF10-03	Tyre, rear		PC
ZMDF10-04	Hub, rear wheel		PC
ZMDF10-05	Ring Gear, front		PC
ZMDF10-06	Rear Wheel Bush, LH		PC
ZMDF10-07	Axle, rear		PC
ZMDF10-08	Rear Wheel Bush, RH		PC
ZMDF10-09	Nut		PC
ZMDF10-10	Hub Assy, sprocket		PC
ZMDF10-11	Sprocket		PC
ZMDF10-12	Inner bush, Sprocket Hub		PC

LF250-D F-12 后挡泥板 REAR FENDER

F-12 后挡泥板 REAR FENDER



Part No.	Description		Unit
ZMDF12-01	Ornament, rear, LH		PC
ZMDF12-02	Fender, rear		PC
ZMDF12-03	Ornament, rear, RH		PC
ZMDF12-04	Tail, rear fender		PC
ZMDF12-05	Cushion, rear license plate		PC
ZMDF12-06	Rear License Bracket Comp.		PC
ZMDF12-07	Bracket set, rear fender rear body		PC
ZMDF12-08	Pad, rear reflector		PC
ZMDF12-09	Water retaining rubber		PC

LF250-D F-13 后制动器 REAR BRAKE

F-13 后制动器 REAR BRAKE

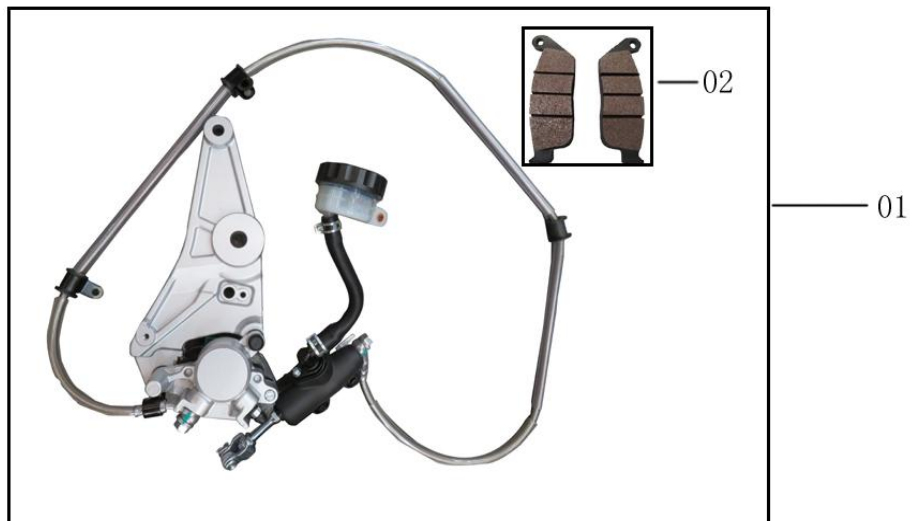

Part No.	Description		Unit
ZMDF13-01	Rear Hydraulic Disc Brake		PC
ZMDF13-02	Rear Brake Shoe Set		PC

LF250-D F-16 空气滤清器总成 AIR CLEANER ASSY

F-16 空气滤清器总成 AIR CLEANER ASSY

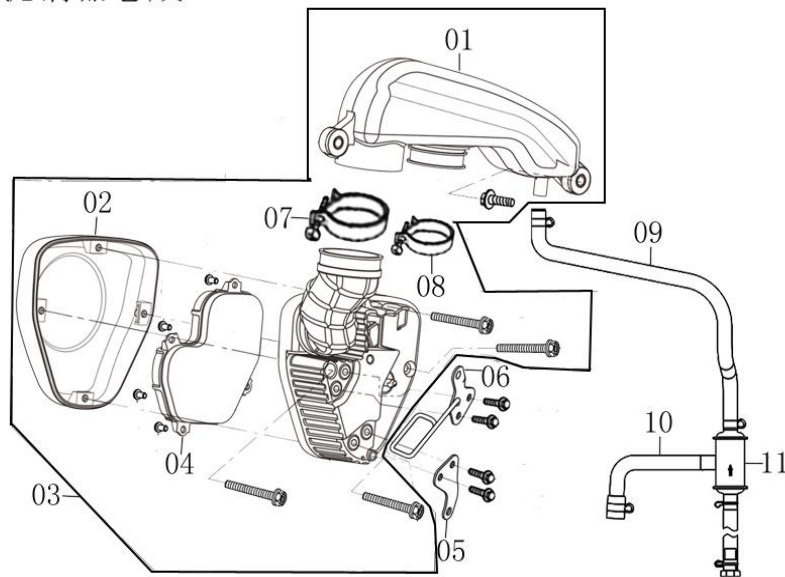

Part No.	Description		Unit
ZMDF16-01	Chamber comp., air cleaner		PC
ZMDF16-02	Air cleaner cover		PC
ZMDF16-03	Air cleaner		PC
ZMDF16-04	Element, air cleaner		PC
ZMDF16-05	Plate, air cleaner connecting		PC
ZMDF16-06	Bracket, air cleaner element		PC
ZMDF16-07	Clamp, 76		PC
ZMDF16-08	Clamp, 64		PC
ZMDF16-09	Crankcase		PC
ZMDF16-10	Crankcase Waste Pipe		PC
ZMDF16-11	Separator, oil/gas		PC

LF250-D F-17 车架总成 FRAME BODY

F-17 车架总成 FRAME BODY

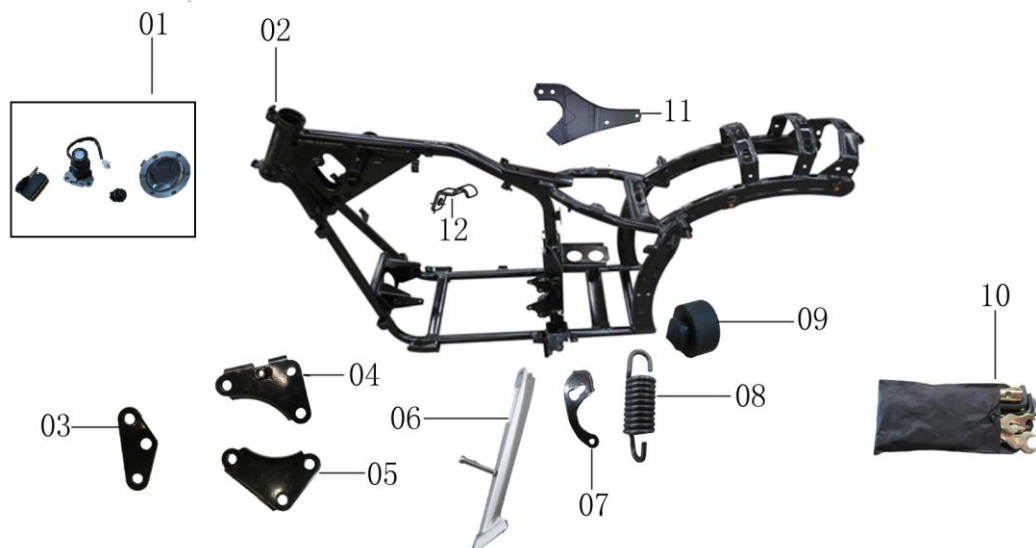

Part No.	Description		Unit
ZMDF17-01	Lock Assy		SET
ZMDF17-02	Body weldment, frame		PC
ZMDF17-03	Plate, engine front connecting		PC
ZMDF17-04	Plate comp., engine rear top connecting		PC
ZMDF17-05	Plate II, rear top connecting		PC
ZMDF17-06	Stand, side		PC
ZMDF17-07	Side Stand Spring Latch		PC
ZMDF17-08	Spring, side stand		PC
ZMDF17-09	Rubber, side stand		PC
ZMDF17-10	Tool kit		PC
ZMDF17-11	Plate set II, muffler fitting		PC
ZMDF17-12	Clamp II , rear brake hose		PC

LF250-D F-18 排气消声器总成 EXHAUST MUFFLER ASSY

F-18 排气消声器总成 EXHAUST MUFFLER ASSY

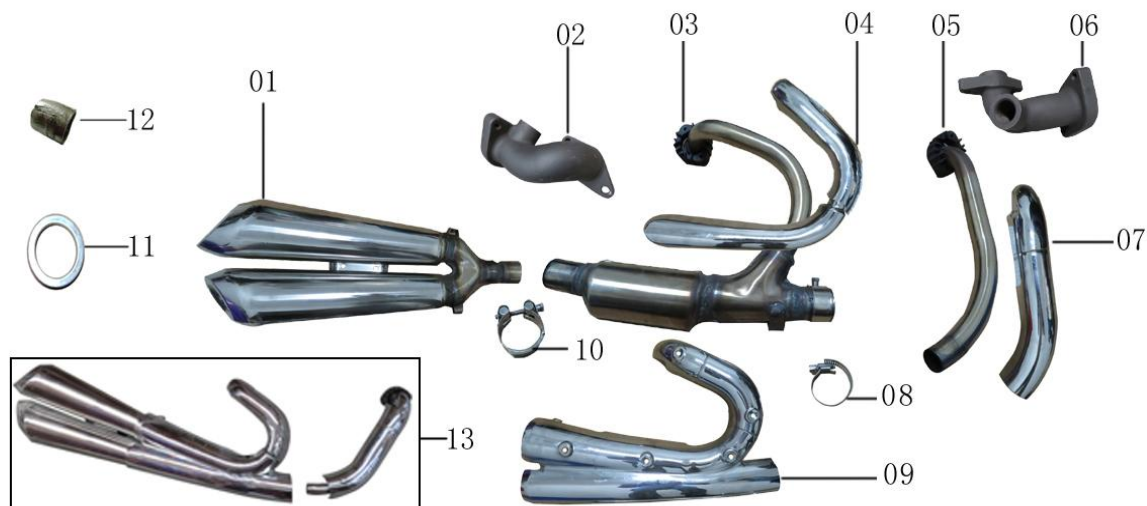

Part No.	Description		Unit
ZMDF18-01	Tailpipe comp., muffler		PC
ZMDF18-02	Exhaust Pipe Set		PC
ZMDF18-03	Pipe comp., exhaust, LH		PC
ZMDF18-04	Ornament set, muffler rear		PC
ZMDF18-05	Pipe set, exhaust		PC
ZMDF18-06	Pipe set, exhaust		PC
ZMDF18-07	Hood set, exhaust pipe		PC
ZMDF18-08	Clamp set, muffler		PC
ZMDF18-09	Ornament set, muffler		PC
ZMDF18-10	Clamp set, muffler		PC
ZMDF18-11	Gasket set, muffler		PC
ZMDF18-12	Muffler Connect Gasket		PC
ZMDF18-13	Exhaust Muffler Assy		PC

LF250-D F-19 电器 ELECTRICAL ELEMENTS

F-19 电器 ELECTRICAL ELEMENTS

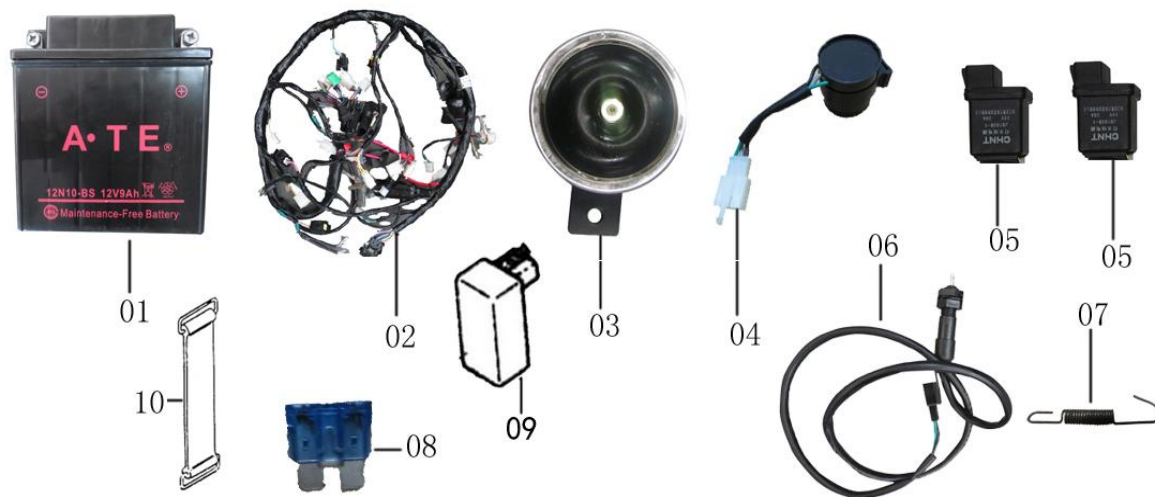

Part No.	Description		Unit
ZMDF19-01	Battery 12N10-BS		PC
ZMDF19-02	Cable, main		PC
ZMDF19-03	Horn		PC
ZMDF19-04	Relay, flashing		PC
ZMDF19-05	EFI Relay		PC
ZMDF19-06	Rear Brake Switch		PC
ZMDF19-07	Spring, Rear Brake Switch		PC
ZMDF19-08	Fus Comp.		PC
ZMDF19-09	Light Controller, Headlight		PC
ZMDF19-10	Band set, Battery		PC

LF250-D F-20 燃油蒸发系统 FUEL EVAPORATING SYSTEM

F-20 燃油蒸发系统 FUEL EVAPORATING SYSTEM

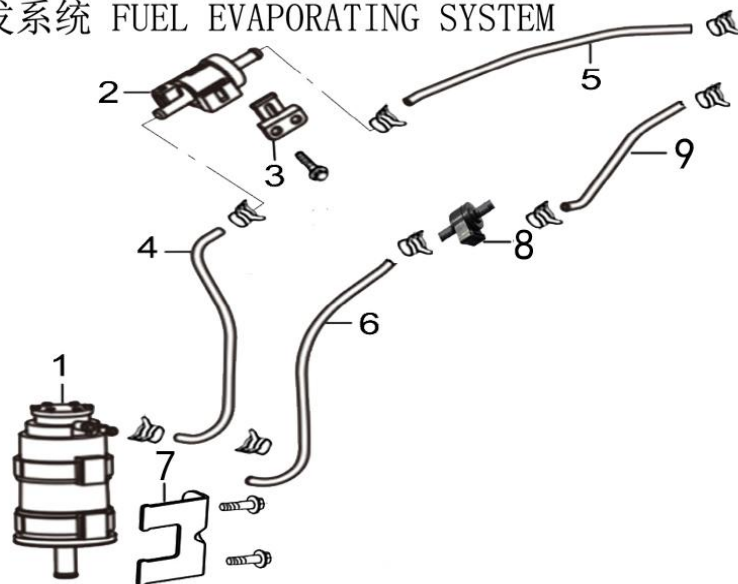

Part No.	Description		Unit
ZMDF20-01	Fuel Evaporating System		PC
ZMDF20-02	Aeration comp., idle control valve		PC
ZMDF20-03	Stay, carbon canister valve		PC
ZMDF20-04	Tube, desorption		PC
ZMDF20-05	Vacuum Pipe		PC
ZMDF20-06	Tube, absorption		PC
ZMDF20-07	Stay, carbon canister		PC
ZMDF20-08	Valve comp., one-way		PC
ZMDF20-09	Pipe, oil/gas delivery		PC

