

# LIFAN KPX 250 DUAL SPORT PARTS CATALOG





LF250GY-3(II) F-02 方向手把 STEERING BAR

F-02 方向手把 STEERING BAR



Parts Code	Description	Unit	Remark
KPXF02-01	Grip comp., throttle	PC	
KPXF02-02	Seat, throttle cable	PC	
KPXF02-03	Switch, handlebar, RH	PC	
KPXF02-04	Cable comp., throttle	PC	
KPXF02-05	Mirror, rearview	PC	
KPXF02-06	Pipe set, steering bar	PC	
KPXF02-07	Cable, clutch	PC	
KPXF02-08	Lever set, clutch	PC	
KPXF02-09	Switch, handlebar, LH	PC	
KPXF02-10	Grip, LH	PC	

LF250GY-3(II) F-03 方向柱、仪表 STEERING STEM & METER

F-03 方向柱、仪表 STEERING STEM & METER



Parts Code	Description	Unit	Remark
KPXF03-01	Meter Assy	PC	
KPXF03-02	Bracket comp., headlight	PC	
KPXF03-03	Boot, headlight stay lower	PC	
KPXF03-04	Stay, headlight Bracket	PC	
KPXF03-05	Beering, Steering stem	SET	
KPXF03-06	BrPARTS CODEge comp., top	PC	
KPXF03-07	Stem comp., steering	SET	
KPXF03-08	Front reflector	PC	
KPXF03-09	Stay, front reflector, LH	PC	
KPXF03-10	Stay, front reflector, RH	PC	











LF250GY-3(II) F-08 后轮总成 REAR WHEEL ASSY

F-08 后轮总成 REAR WHEEL ASSY



Parts Code	Description	Unit	Remark
KPXF08-01	Disc, rear brake	PC	
KPXF08-02	Tyre, rear	PC	
KPXF08-03	Tube, rear	PC	
KPXF08-04	Bush, rear wheel, RH	PC	
KPXF08-05	Rim comp., rear wheel	PC	
KPXF08-06	Bush, rear wheel, LH	PC	
KPXF08-07	Sprocket	PC	
KPXF08-08	Axle, rear wheel	PC	



LF250GY-3(II) F-10 前、后液压制动器 FRONT & REAR HYDRAULIC BRAKE

F-10 前、后液压制动器 FRONT & REAR HYDRAULIC BRAKE

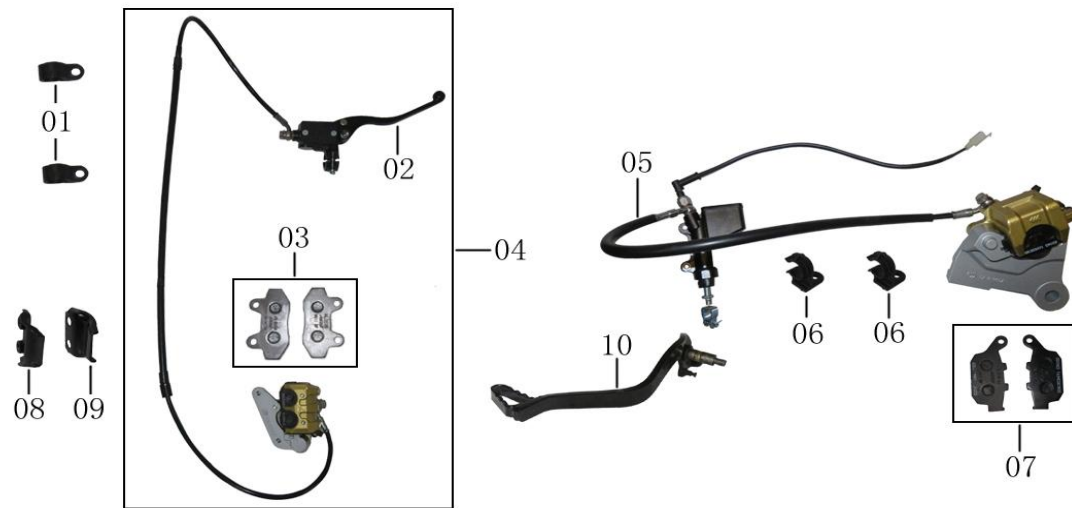

Parts Code	Description	Unit	Remark
KPXF10-01	Circlip, hose, front Brake	PC	
KPXF10-02	Front brake Lever	PC	
KPXF10-03	Front brake Pad	SET	
KPXF10-04	Brake comp., front hydraulic	PC	
KPXF10-05	Brake comp., rear hydraulic	PC	
KPXF10-06	Circlip, hose, Rear Brake	PC	
KPXF10-07	Rear brake Pad	SET	
KPXF10-08	Circlip II, hose, front Brake	PC	
KPXF10-09	Circlip, hose, front Brake	PC	
KPXF10-10	Pedal, Rear brake	PC	

LF250GY-3(II) F-11 后叉焊接组合 REAR FORK

F-11 后叉焊接组合 REAR FORK

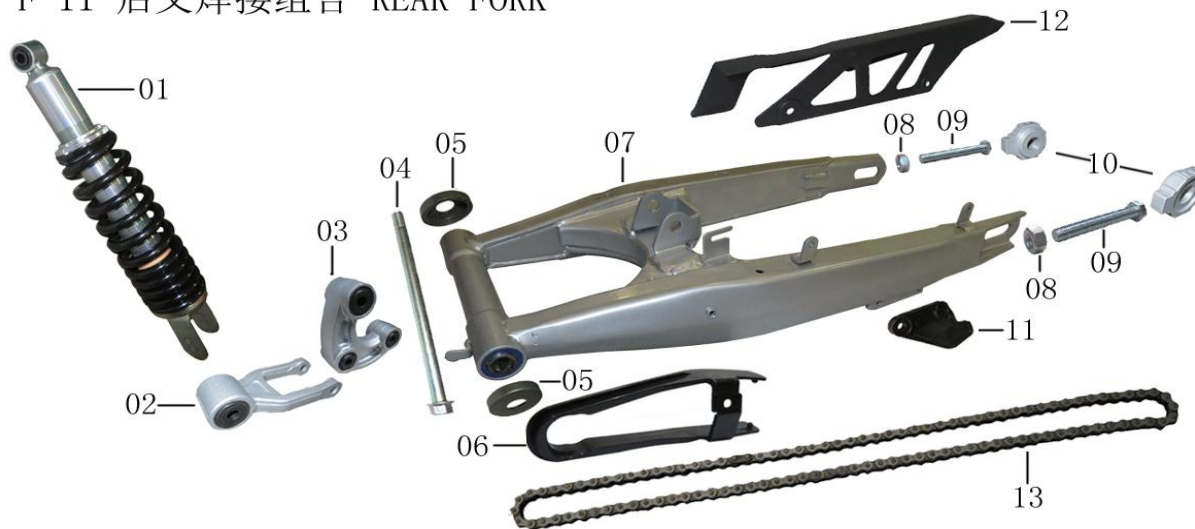

Parts Code	Description	Unit	Remark
KPXF11-01	Shock absorber Assy, rear	PC	
KPXF11-02	Connecting Rod Comp., rear shock absorber	PC	
KPXF11-03	Rocker comp., rear shock absorber	PC	
KPXF11-04	Axle, Rear Fork	PC	
KPXF11-05	Dust cover set, rear fork shaft	PC	
KPXF11-06	GuPARTS CODEE, chain	PC	
KPXF11-07	Fork comp., rear	PC	
KPXF11-08	Nut, M8-Zn c2C (SJ)	PC	
KPXF11-09	Bolt, M8×60-Zn c2C (SJ)	PC	
KPXF11-10	Plate, chain adjuster setting	PC	
KPXF11-11	Stopper, chaincase	PC	
KPXF11-12	Chaincase	PC	
KPXF11-13	Chain 520H×108	PC	

LF250GY-3(II) F-12 搁脚组合 FOOTRESTS

F-12 搁脚组合 FOOTRESTS

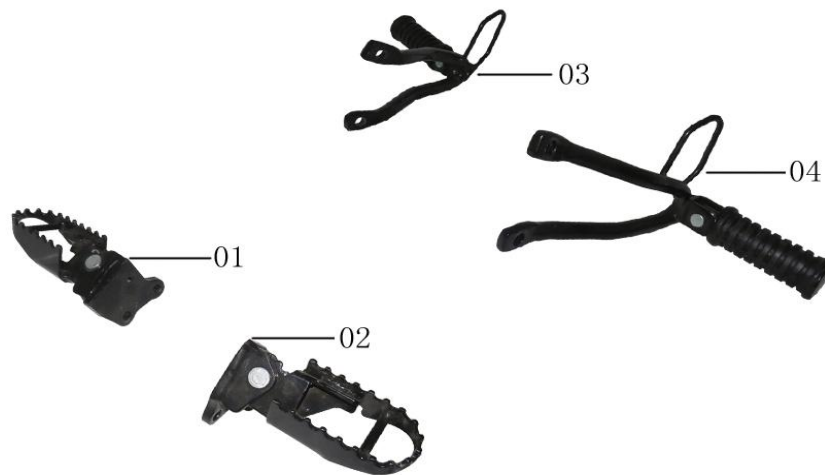

Parts Code	Description	Unit	Remark
KPXF12-01	Footrest comp., rPARTS CODEer, RH	PC	
KPXF12-02	Footrest comp., rPARTS CODEer, LH	PC	
KPXF12-03	Footrest Assy, pillion, RH	PC	
KPXF12-04	Footrest Assy, pillion, LH	PC	



LF250GY-3(II) F-14 座墊、后挡泥板 SEAT & REAR FENDER

F-14 座墊、后挡泥板 SEAT & REAR FENDER



Parts Code	Description	Unit	Remark
KPXF14-01	Seat Assy	PC	
KPXF14-02	Fender, rear	PC	
KPXF14-03	Stay set, rear winker, RH	PC	
KPXF14-04	Stay set, rear winker, LH	PC	
KPXF14-05	Reflector, rear	PC	
KPXF14-06	Rubber, rear fender	PC	
KPXF14-07	SPARTS CODEe reflector	PC	
KPXF14-08	Bracket, Rear license plate	PC	





LF250GY-3(II) F-16 车架焊接总成 FRAME WELDMENT

F-16 车架焊接总成 FRAME WELDMENT

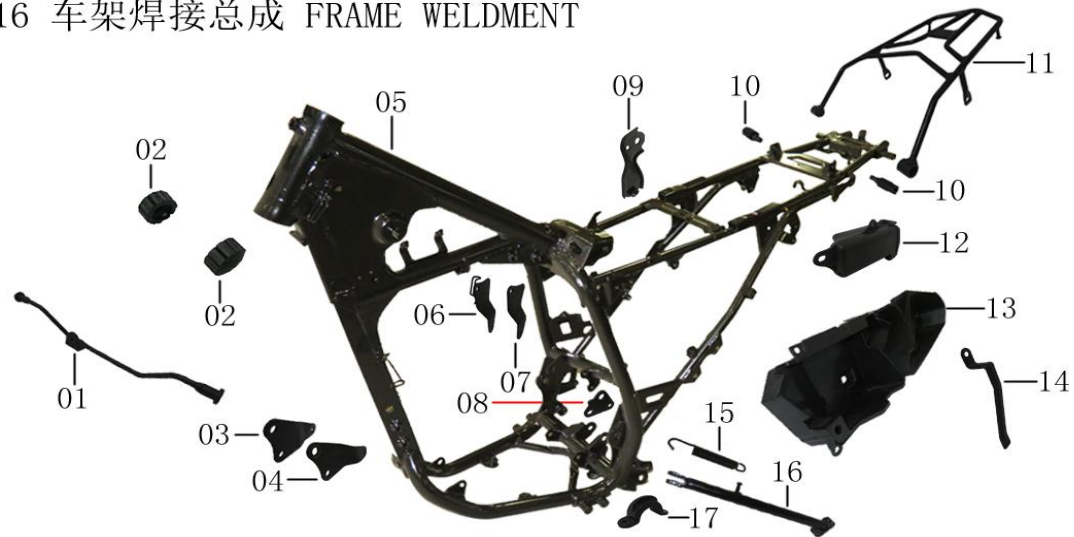

Parts Code	Description	Unit	Remark
KPXF16-01	Stay comp., front fairing	PC	
KPXF16-02	Cushion, fuel tank front	PC	
KPXF16-03	Plate, engine front connecting, RH	PC	
KPXF16-04	Plate, engine front connecting, LH	PC	
KPXF16-05	Frame weldment	PC	
KPXF16-06	Plate comp., engine top connecting, RH	PC	
KPXF16-07	Plate, engine top connecting, RH	PC	
KPXF16-08	Plate, rear top connecting	PC	
KPXF16-09	Bracket set, sPARTS CODEe cover, RH	PC	
KPXF16-10	Rod, rear carrier connecting	PC	
KPXF16-11	Carrier weldment, rear	PC	
KPXF16-12	Box set, tool	PC	
KPXF16-13	Case, battery	PC	
KPXF16-14	Plate, battery pressing	PC	



LF250GY-3(II) F-17 电喷系统 EFI SYSTEM

F-17 电喷系统 EFI SYSTEM



Parts Code	Description	Unit	Remark
KPXF17-01	Sensor, intake air temperature	PC	
KPXF17-02	ECU	PC	
KPXF17-03	Sensor, oxygen	PC	
KPXF17-04	Throttle valve Assy.	PC	
KPXF17-05	Rail, fuel	PC	
KPXF17-06	Nozzle	PC	
KPXF17-07	Sensor, intake air pressure	PC	
KPXF17-08	Manifold, intake	PC	
KPXF17-09	Insulator, intake pipe	PC	

# 172FMM-2P E-01 气缸、气缸头 CYLINDER HEAD & CYLINDER BLOCK

## E-01 气缸头、气缸 CYLINDER HEAD & CYLINDER BLOCK



Part code	Description	QTY	Unit	Remark
172FMME01-01	Cover, valve	2	PC	
172FMME01-02	O-ring, Cover valve	2	PC	
172FMME01-03	Cap nut M8-18	4	PC	
172FMME01-04	Copper washer, bolt, cylinder	4	PC	
172FMME01-05	Plug, spark	1	PC	
172FMME01-06	Stud, M8×45	2	PC	
172FMME01-07	Cover, cylinder head, LH	1	PC	
172FMME01-08	O-ring, cylinder head cover, LH	1	PC	
172FMME01-09	Retainer, camshaft	1	PC	
172FMME01-10	Cylinder Head	1	PC	
172FMME01-11	Sensor, cylinder temperature	1	PC	
172FMME01-12	Dowel pin, cylinder headΦ10×20	2	PC	
172FMME01-13	Gasket, cylinder head	1	PC	
172FMME01-14	Block unit, cylinder	1	PC	
172FMME01-15	Gasket, cylinder block	1	PC	
172FMME01-16	Gasket, tensioner	1	PC	
172FMME01-17	Tensioner Assy	1	PC	
172FMME01-18	Casting tubing bolt	2	PC	
172FMME01-19	Box tubing bolt washer	4	PC	
172FMME01-20	Oil pipe set, outer	1	PC	

# 172FMM-2P E-02 配气机构 VALVE TRAIN

## 172FMM-2 E-02 配气机构 VALVE TRAIN

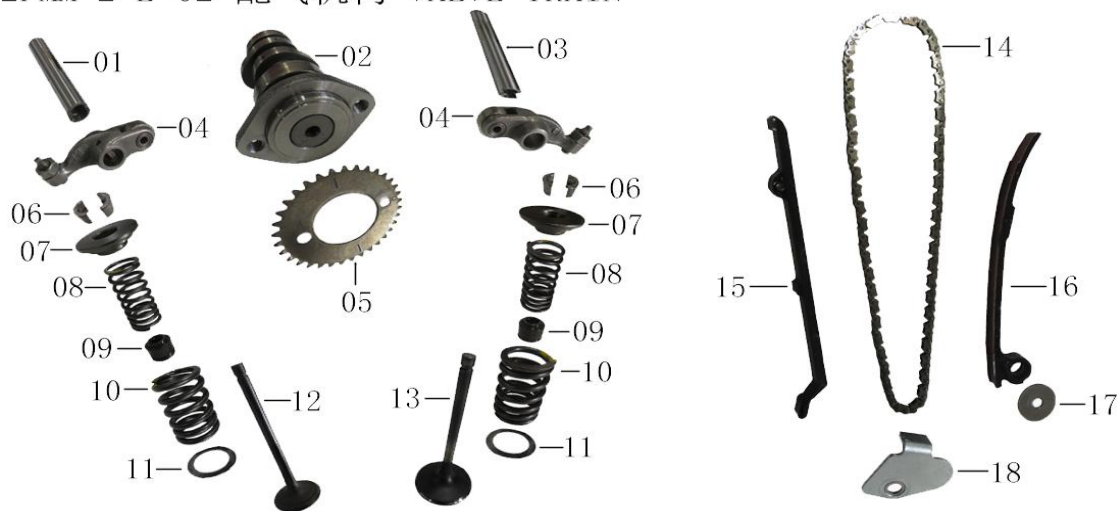

Part code	Description	QTY	Unit	Remark
172FMME02-01	Shaft II, rocker arm	1	PC	
172FMME02-02	Camshaft Assy.	1	PC	
172FMME02-03	Shaft, rocker arm	1	PC	
172FMME02-04	Arm Assy., rocker	2	PC	
172FMME02-05	Sprocket, timing driven	1	PC	
172FMME02-06	Clamp, valve	4	PC	
172FMME02-07	Upper seat, spring, valve	2	PC	
172FMME02-08	Spring, valve, inner	2	PC	
172FMME02-09	Oil seal, valve stem	2	PC	
172FMME02-10	Spring, valve, outer	2	PC	
172FMME02-11	Lower seat, spring, valve	2	PC	
172FMME02-12	Valve, exhaust	1	PC	
172FMME02-13	Valve, intake	1	PC	
172FMME02-14	Chain, timing	1	PC	
172FMME02-15	Plate, guPart codee	1	PC	
172FMME02-16	Tensioning plate	1	PC	
172FMME02-17	Washer, tensioning plate	1	PC	
172FMME02-18	Plate, timing chain limit	1	PC	

# 172FMM-2P E-03 右曲轴箱盖 RIGHT CRANKCASE COVER

## E-03 右曲轴箱盖 RIGHT CRANKCASE COVER



Part code	Description	QTY	Unit	Remark
172FMME03-01	Clutch Lever Comp.	1	PC	
172FMME03-02	Oil seal, crankcase cover, RH	1	PC	
172FMME03-03	Spring, clutch lever	1	PC	
172FMME03-04	Pin, clutch lever	1	PC	
172FMME03-05	Cover, oil filter	1	PC	
172FMME03-06	O-ring, oil filter cover	2	PC	
172FMME03-07	Oil filter	1	PC	
172FMME03-08	Dipstick	1	PC	
172FMME03-09	O-ring, dipstick	1	PC	
172FMME03-10	Dowel pin $\Phi 8 \times 14$	2	PC	
172FMME03-11	Stay, clutch cable adjusting	1	PC	
172FMME03-12	Gasket, Oil duct cover plate, crankcase cover, RH	1	PC	
172FMME03-13	Oil duct cover plate, crankcase cover, RH	1	PC	
172FMME03-14	Gasket, crankcase cover, RH	1	PC	
172FMME03-15	Gasket II, Oil duct cover plate, crankcase cover, RH	1	PC	
172FMME03-16	Oil duct cover plate II, crankcase cover, RH	1	PC	
172FMME03-17	Crankcase cover, RH	1	PC	

172FMM-2P E-04 曲轴箱 CRANKCASE

E-04 曲轴箱 CRANKCASE

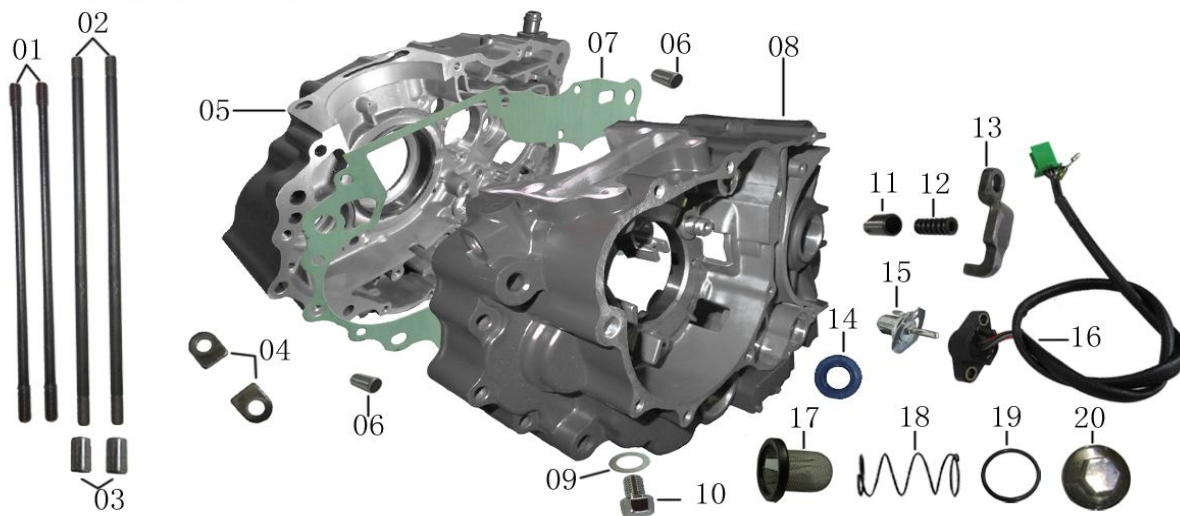

Part code	Description	QTY	Unit	Remark
172FMME04-01	Stud B (M8×228)	2	PC	
172FMME04-02	Stud A (M8×255)	2	PC	
172FMME04-03	Dowel pin, crankcase (Φ 10×14)	2	PC	
172FMME04-04	Plate, bearing press	2	PC	
172FMME04-05	Crankcase comp., RH	1	PC	
172FMME04-06	Dowel pin, cylinder head (Φ 8×14)	2	PC	
172FMME04-07	Gasket, crankcase	1	PC	
172FMME04-08	Crankcase, LH	1	PC	
172FMME04-09	Washer, oil drain plug	1	PC	
172FMME04-10	Drain plug, crankcase	1	PC	
172FMME04-11	Pin, pressing	1	PC	
172FMME04-12	Spring, pin	1	PC	
172FMME04-13	Plate, spring press	1	PC	
172FMME04-14	Oil seal, gearshift shaft (Φ 14×Φ 28×7)	1	PC	
172FMME04-15	Contacter, Gear indication	1	PC	
172FMME04-16	Indicator, gear	1	PC	
172FMME04-17	Gauze set, oil filter	1	PC	
172FMME04-18	Spring, gauze	1	PC	
172FMME04-19	O-ring, valve cover (Φ 35×Φ 3)	1	PC	
172FMME04-20	Cover, oil filter gauze	1	PC	







172FMM-2P E-07 离合器、机油泵 CLUTCH & OIL PUMP

E-07 离合器、机油泵 CLUTCH & OIL PUMP

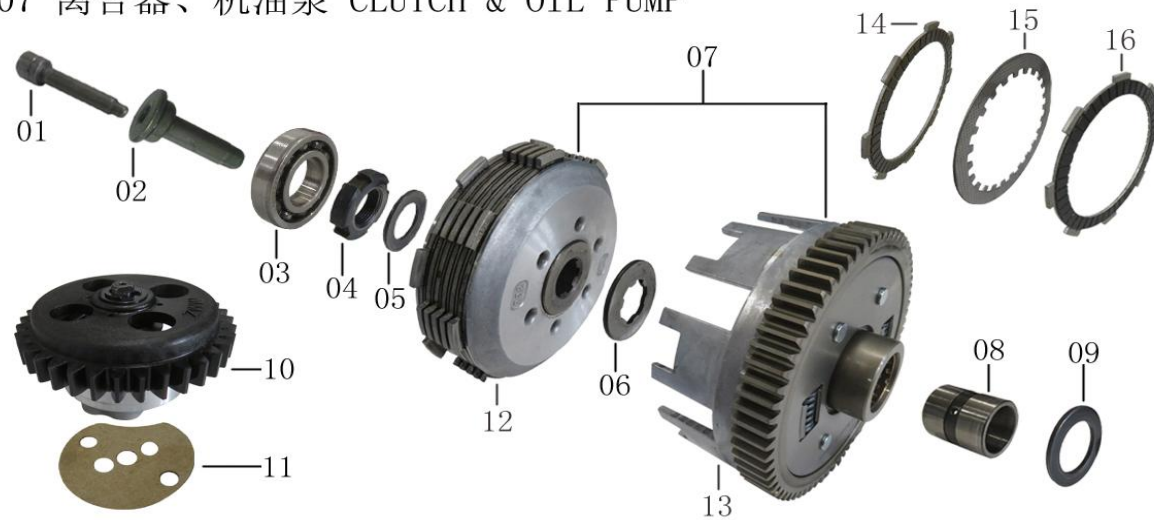

Part code	Description	QTY	Unit	Remark
172FMME07-01	Lifter, clutch	1	PC	
172FMME07-02	Rod, push	1	PC	
172FMME07-03	Bearing, plain, 16003	1	PC	
172FMME07-04	Locknut, primary drive gear	1	PC	
172FMME07-05	Lock washer, primary drive gear	1	PC	
172FMME07-06	Washer, spline, clutch	1	PC	
172FMME07-07	Main body, clutch	1	PC	
172FMME07-08	Bush, clutch	1	PC	
172FMME07-09	Collar, clutch	1	PC	
172FMME07-10	Oil Pump Assy.	1	PC	
172FMME07-11	Gasket, oil pump	1	PC	
172FMME07-12	Driven Disc Comp., Clutch	1	PC	
172FMME07-13	Drive Disc Comp., Clutch	1	PC	
172FMME07-14	Drive Plate, clutch	4	PC	
172FMME07-15	Driven Plate, clutch	5	PC	
172FMME07-16	Drive Plate, clutch II	2	PC	

# 172FMM-2P E-08 曲轴、活塞 CRANKSHAFT & PISTON

## E-08 曲轴、活塞 CRANKSHAFT & PISTON



Part code	Description	QTY	Unit	Remark
172FMME08-01	Connecting rod, crank	1	PC	
172FMME08-02	Piston	1	PC	
172FMME08-03	Circlip, piston pin	2	PC	
172FMME08-04	Pin, piston	1	PC	
172FMME08-05	Ring set, piston	1	SET	
172FMME08-06	Bearing, plain, 6302/FJK	1	PC	
172FMME08-07	Shaft, balance	1	PC	
172FMME08-08	Bearing, plain, 6204/FJK	1	PC	
172FMME08-09	Gear, balance shaft driven	1	PC	
172FMME08-10	block, balanced	1	PC	
172FMME08-11	Washer, fastening nut $\Phi 14 \times \Phi 28.2 \times 3$	1	PC	
172FMME08-12	Nut, magneto fastening	1	PC	
172FMME08-13	Bearing, plain, $28 \times 72 \times 18$	1	PC	
172FMME08-14	Washer, balance shaft drive gear	1	PC	
172FMME08-15	Gear comp., balance shaft drive	1	PC	
172FMME08-16	Washer II, balance shaft drive gear	1	PC	
172FMME08-17	Gear comp., primary drive	1	PC	
172FMME08-18	Collar, clutch	1	PC	
172FMME08-19	Washer, primary drive gear spring	1	PC	
172FMME08-20	Nut, primary drive gear fastening	1	PC	
172FMME08-21	Oil seal, crankshaft, RH $10 \times 18 \times 6$	1	PC	





