

LIFAN KPM 200 CAFE RACER PARTS CATALOG



165ML-E E-01 气缸、气缸头 CYLINDER BLOCK & CYLINDER HEAD

E-01 气缸、气缸头 CYLINDER BLOCK & CYLINDER HEAD



Part No.	Description		Unit
165MLSE01-01	Cap nut M8		PC
165MLSE01-02	Copper washer, bolt, cylinder $\Phi 10.5 \times \Phi 20 \times 2$		PC
165MLSE01-03	Spark plug		PC
165MLSE01-04	Thermostat Cover		PC
165MLSE01-05	Block unit, cylinder		PC
165MLSE01-06	Cover, cylinder head, LH		PC
165MLSE01-07	Bolt, M8×45		PC
165MLSE01-08	Gasket, cover, cylinder head, LH		PC
165MLSE01-09	Head unit, cylinder		PC
165MLSE01-10	Retainer, distributing camshaft		PC
165MLSE01-11	Cover, valve		PC
165MLSE01-12	Valve Cover O-Ring		SET
165MLSE01-13	Gasket, cylinder head		PC
165MLSE01-14	Gasket, cylinder block		PC
165MLSE01-15	Dowel pin, cylinder head $\Phi 10 \times 20$		PC
165MLSE01-16	Washer, Tensioner		PC
165MLSE01-17	Tensioner Assy		PC
165MLSE01-18	Coolant temperature sensor		PC
165MLSE01-19	Valve, thermostat		PC

165ML-E E-02 配气机构 VALVE TRAIN

E-02 配气机构 VALVE TRAIN

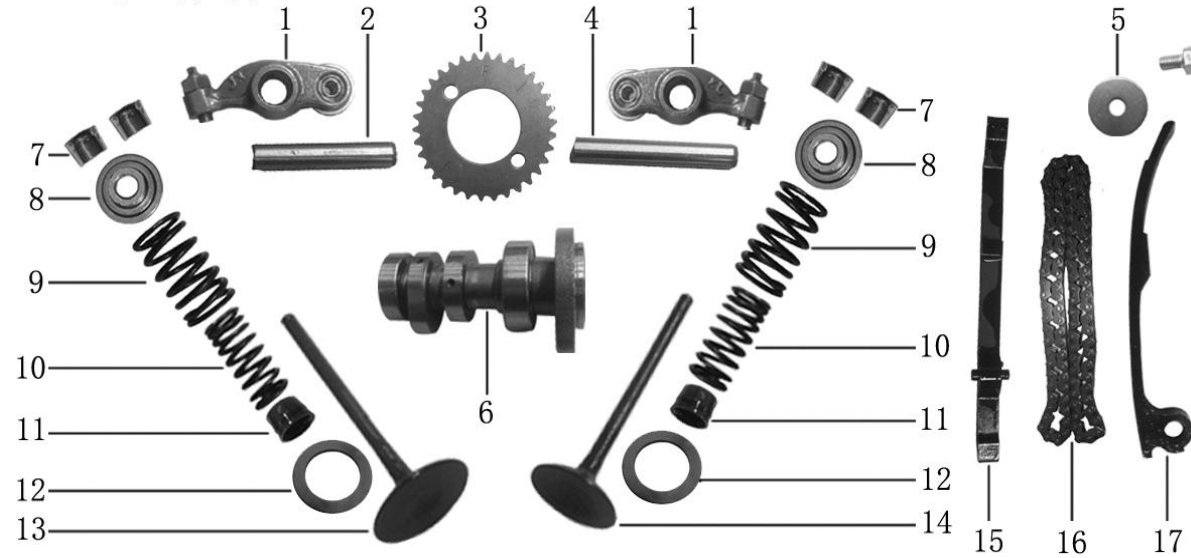

Part No.	Description		Unit
165MLSE02-01	Rocker arm Assy,		PC
165MLSE02-02	Shaft, rocker arm II		PC
165MLSE02-03	Sprocket, timing driven		PC
165MLSE02-04	Shaft, rocker arm I		PC
165MLSE02-05	Washer, tensioning plate		PC
165MLSE02-06	Camshaft Assy I		PC
165MLSE02-07	Split cone, valve		PC
165MLSE02-08	Seat, spring, upper		PC
165MLSE02-09	Spring, valve, outer		PC
165MLSE02-10	Spring, valve, inner		PC
165MLSE02-11	Oil seal, valve stem		PC
165MLSE02-12	Valve Outer Spring Seat		PC
165MLSE02-13	Valve, intake		PC
165MLSE02-14	Valve, exhaust		PC
165MLSE02-15	Guiding plate		PC
165MLSE02-16	Chain, timing		PC
165MLSE02-17	Tensioner		PC

165ML-E E-03 右曲轴箱盖、水泵组件 RIGHT CRANKCASE COVER & WATER PUMP ASSY



Part No.	Description		Unit
165MLSE03-01	Dipstick Assy		PC
165MLSE03-02	O-ring		PC
165MLSE03-03	Cover unit, crankcase, RH		PC
165MLSE03-04	Pump Cover		PC
165MLSE03-05	Dowel Pin $\Phi 8 \times 10$		PC
165MLSE03-06	Pump Hermetical Circle		PC
165MLSE03-07	Clutch Controlling Rod		PC
165MLSE03-08	Clutch Lever Oil Seal		PC
165MLSE03-09	Clutch Lever Spring		PC
165MLSE03-10	Spring, operating shaft, clutch		PC
165MLSE03-11	Dowel Pin $\Phi 8 \times 14$		PC
165MLSE03-12	Sight Glass		PC
165MLSE03-13	Crankcase Cover Gasket, RH		PC
165MLSE03-14	Overflow Pipe		PC
165MLSE03-15	Overflow Pipe Clamp		PC
165MLSE03-16	Cover, oil element		PC
165MLSE03-17	O-ring, oil element cover		PC
165MLSE03-18	Element Assy., oil		PC
165MLSE03-19	Gear comp., water pump driven		PC
165MLSE03-20	Pump Assy., water		PC

165ML-E E-04 曲轴箱 CRANKCASE

E-04 曲轴箱 CRANKCASE

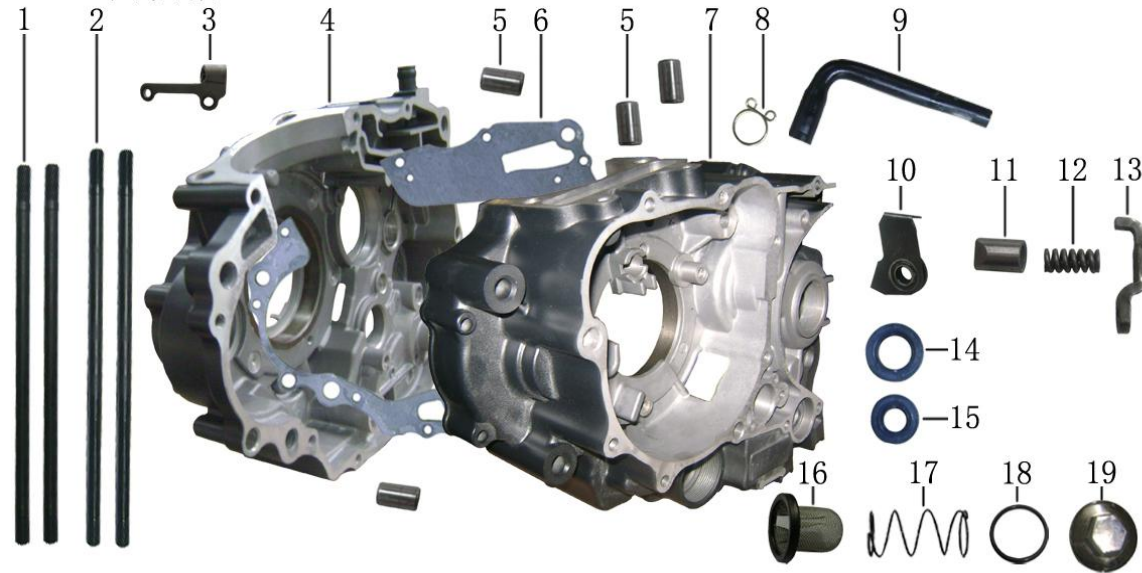

Part No.	Description		Unit
165MLSE04-01	Stud B (M8×196.5)		PC
165MLSE04-02	Stud A (M8×205)		PC
165MLSE04-03	Adjusting support, clutch cable		PC
165MLSE04-04	Crankcase, RH		PC
165MLSE04-05	Dowel pin (Φ10×14)		PC
165MLSE04-06	Gasket, crankcase		PC
165MLSE04-07	Crankcase, LH		PC
165MLSE04-08	Clip, exhaust pipe		PC
165MLSE04-09	Pipe, exhaust		PC
165MLSE04-10	Timing Chain Limited Plate		PC
165MLSE04-11	Pin-Keeping		PC
165MLSE04-12	Pin-Keeping Spring		PC
165MLSE04-13	Pin-Keeping Spring Plate		PC
165MLSE04-14	Oil seal, 20×34×7		PC
165MLSE04-15	Oil seal, gearshift shaft		PC
165MLSE04-16	Gauze filter		PC
165MLSE04-17	Spring		PC
165MLSE04-18	O-ring, cover gauze(Φ35×Φ3)		PC
165MLSE04-19	Cover, gauze filter		PC

165ML-E E-06 磁电机 MAGNETO

E-06 磁电机 MAGNETO



Part No.	Description		Unit
165MLSE06-01	Stator set, magneto		PC
165MLSE06-02	Flywheel clutch Assy		PC
165MLSE06-03	Rotor set, magneto		PC
165MLSE06-04	Starting clutch Assy		PC
165MLSE06-05	Plug, watch hole		PC
165MLSE06-06	O-ring, watch hole plug		PC
165MLSE06-07	Cover, crankcase, LH		PC
165MLSE06-08	O-ring, $\Phi 63 \times \Phi 3$		PC
165MLSE06-09	Cover, upper		PC
165MLSE06-10	Clip, magneto wire		PC
165MLSE06-11	Stopper, magneto wiring harness		PC
165MLSE06-12	Bolt, M10×45		PC
165MLSE06-13	Thrust washer		PC
165MLSE06-14	Gasket, crankcase cover, LH		PC
165MLSE06-15	Dowel pin, crankcase		PC
165MLSE06-16	Cover, LH		PC
165MLSE06-17	O-ring, plug,		PC
165MLSE06-18	Rear cover, LH		PC

165ML-E E-07 离合器 CLUTCH

E-07 离合器 CLUTCH

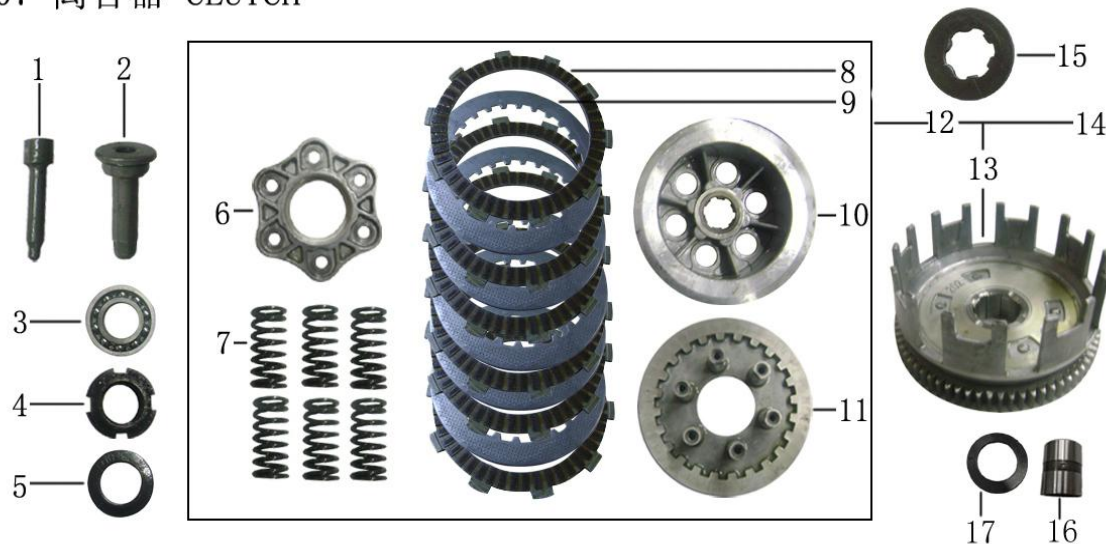

Part No.	Description		Unit
165MLSE07-01	Clutch Mandrel		PC
165MLSE07-02	Clutch Pusher		PC
165MLSE07-03	Bearing, 16003		PC
165MLSE07-04	Lock nut		PC
165MLSE07-05	Thrust washer		PC
165MLSE07-06	Plate, clutch lifter		PC
165MLSE07-07	Spring, Clutch		SET
165MLSE07-08	Disc set, clutch friction		SET
165MLSE07-09	Plate, clutch		SET
165MLSE07-10	Plate, clutch pressure		PC
165MLSE07-11	Center comp., clutch		PC
165MLSE07-12	Clutch Assy		PC
165MLSE07-13	Outer comp., clutch		PC
165MLSE07-14	Body, clutch		PC
165MLSE07-15	Spline washer		PC
165MLSE07-16	Bush, clutch		PC
165MLSE07-17	Collar, clutch		PC

165ML-E E-08 曲轴、活塞 CRANKSHAFT & PISTON

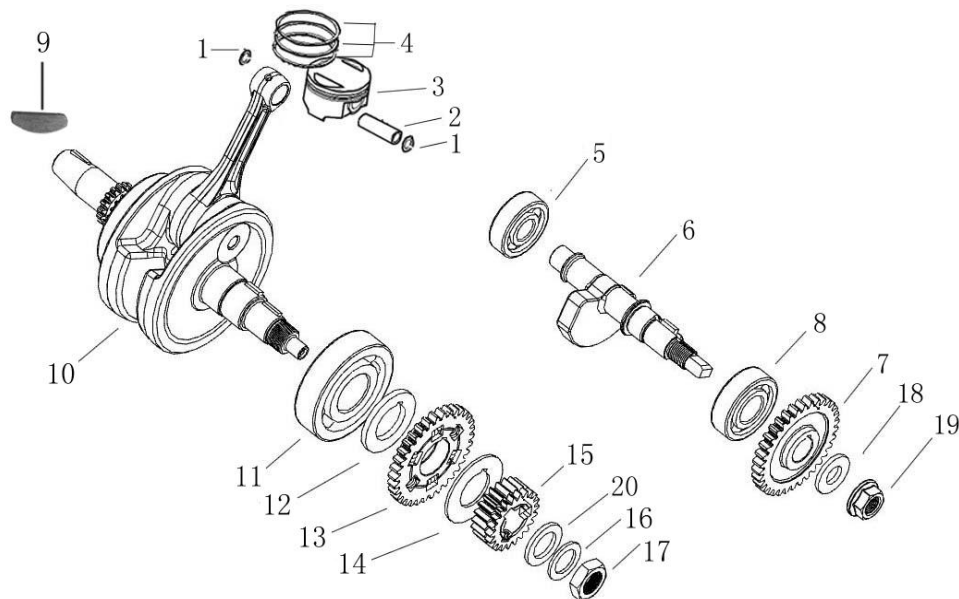

Part No.	Description		Unit
165MLSE08-01	Circlip, piston pin		PC
165MLSE08-02	Pin, piston		PC
165MLSE08-03	Piston		PC
165MLSE08-04	Ring set, piston		PC
165MLSE08-05	Bearing, 6302/CJB		PC
165MLSE08-06	balance shaft		PC
165MLSE08-07	Gear, balance shaft driven		PC
165MLSE08-08	Bearing, 6204/P6/FJK		PC
165MLSE08-09	Key, woodruff		PC
165MLSE08-10	Crankshaft & connecting rod		PC
165MLSE08-11	Bearing, crankshaft, RH		PC
165MLSE08-12	Washer, balance shaft drive gear		PC
165MLSE08-13	Gear comp., balance shaft drive		PC
165MLSE08-14	Washer II, balance shaft drive gear		PC
165MLSE08-15	Gear comp., primary drive		PC
165MLSE08-16	Washer, primary drive gear spring		PC
165MLSE08-17	Nut, primary drive gear fastening		PC
165MLSE08-18	Washer, balance shaft		PC
165MLSE08-19	Nut, balance shaft		PC
165MLSE08-20	Collar, clutch		PC

165ML-E E-10 变档机构 GEARSHIFT DEVICE

E-10 变档机构 GEARSHIFT DEVICE

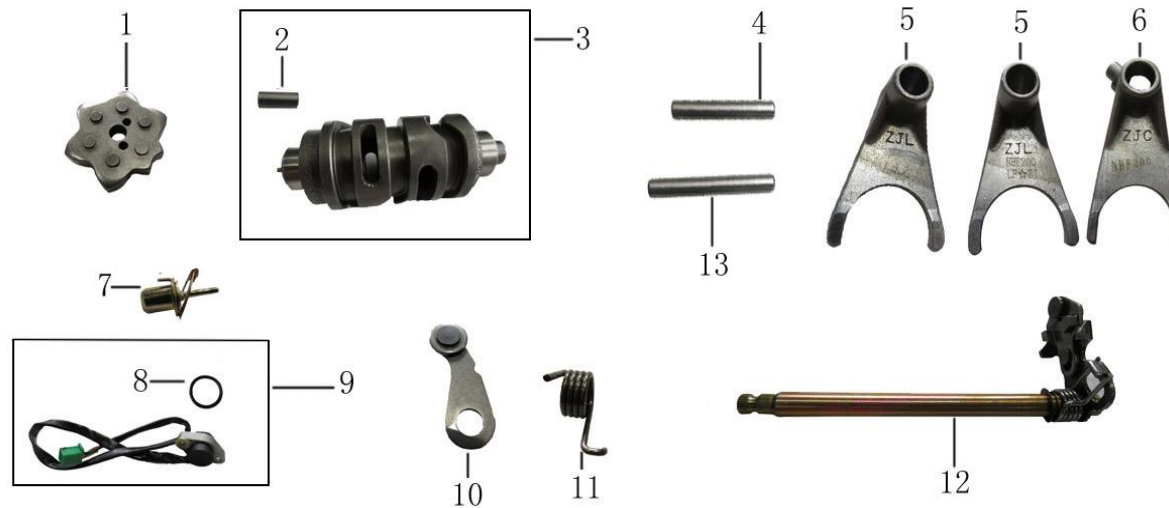

Part No.	Description		Unit
165MLSE10-01	Shaft comp., gearshift		PC
165MLSE10-02	Set pin, 4×10		PC
165MLSE10-03	Drum		PC
165MLSE10-04	Shaft, fork		PC
165MLSE10-05	Fork (I)		PC
165MLSE10-06	Fork (II)		PC
165MLSE10-07	Gear Indicator Contact Point Comp		PC
165MLSE10-08	O-ring, gear indicator		PC
165MLSE10-09	Gear Indicating Wire Harness		PC
165MLSE10-10	Limit plate		PC
165MLSE10-11	Spring, locating plate torsion		PC
165MLSE10-12	Gearshift shaft Assy		PC
165MLSE10-13	Shaft, fork II		PC

165ML-E E-12 电器 ELECTRIC ELEMENTS

E-12 电器 ELECTRIC ELEMENTS

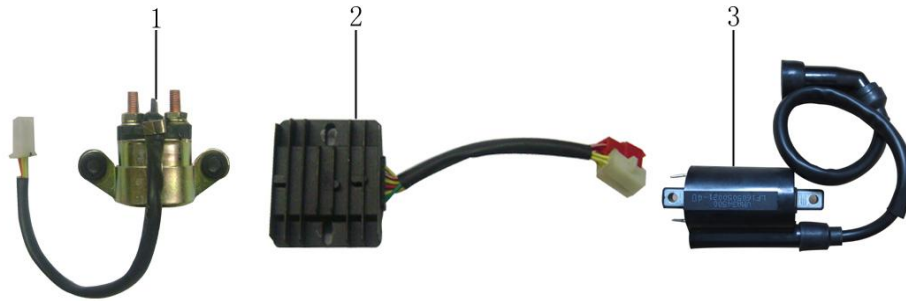

Part No.	Description		Unit
165MLSE12-01	Start Relay		PC
165MLSE12-02	Voltage Regulator		PC
165MLSE12-03	Ignition Coil		PC

LF200-3B F-01 灯具 LIGHTS

F-01 灯具 LIGHTS

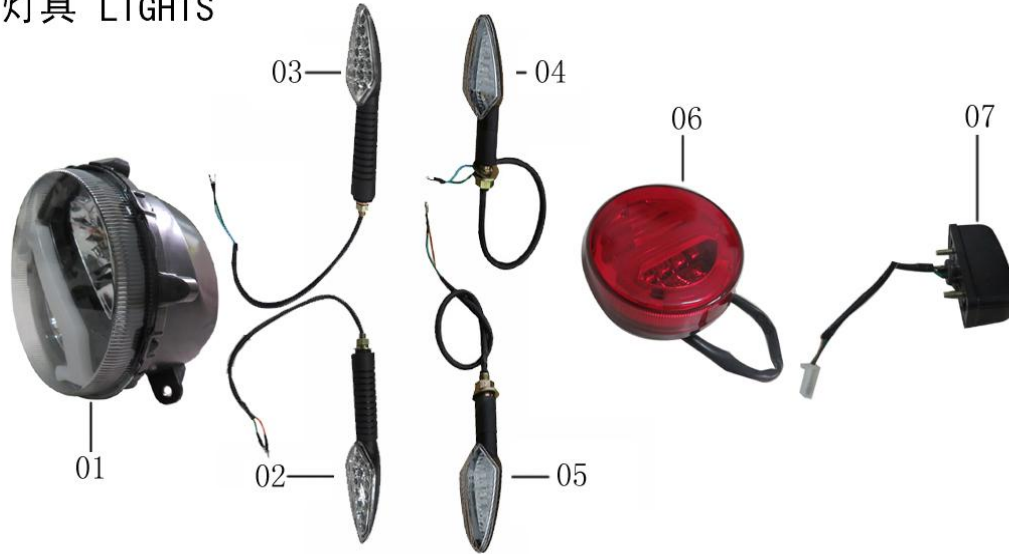

Parts No.	Description		Unit
KPMF01-01	Headlight Assy		PC
KPMF01-02	Winker, front, LH		PC
KPMF01-03	Winker, front, RH		PC
KPMF01-04	Winker, rear, RH		PC
KPMF01-05	Winker, rear, LH		PC
KPMF01-06	Taillight Assy		PC
KPMF01-07	Light comp., license plate		PC

LF200-3B F-03 握把 开关 GRIP & SWITCH

F-03 握把 开关 GRIP & SWITCH



Parts No.	Description		Unit
KPMF03-01	Cable comp., throttle		PC
KPMF03-02	Cable, clutch		PC
KPMF03-03	Bridge, upper		PC
KPMF03-04	Grip comp., throttle		PC
KPMF03-05	Grip, LH		PC
KPMF03-06	Switch, handlebar, RH		PC
KPMF03-07	Switch, handlebar, LH		PC
KPMF03-08	Mirror, rearview, RH		PC
KPMF03-09	Mirror, rearview, LH		PC
KPMF03-10	Lever set, clutch		PC

LF200-3B F-04 方向柱 STEERING STEM

F-04 方向柱 STEERING STEM



Parts No.	Description	Unit
KPMF04-01	Stem set, steering	SET
KPMF04-02	Steering Stem Bearing Set	PC
KPMF04-03	Pipe set, steering bar	PC
KPMF04-04	Lug, speed sensor	PC
KPMF04-05	Pipe set, steering bar	PC
KPMF04-06	Stay set, ignition switch	PC
KPMF04-07	Bridge set, steering stem top	PC
KPMF04-08	Cushion Cover, Steering Stem	PC
KPMF04-09	Clamp, steering bar, RH	PC
KPMF04-10	Clamp, steering bar, LH	PC
KPMF04-11	Holder set, steering bar pipe	PC
KPMF04-12	Upper Cushion, Steering Stem	PC

LF200-3B F-05 前挡泥板 减震器 FRONT FENDER & SHOCK ABSORBER

F-05 前挡泥板 减震器 FRONT FENDER & SHOCK ABSORBER

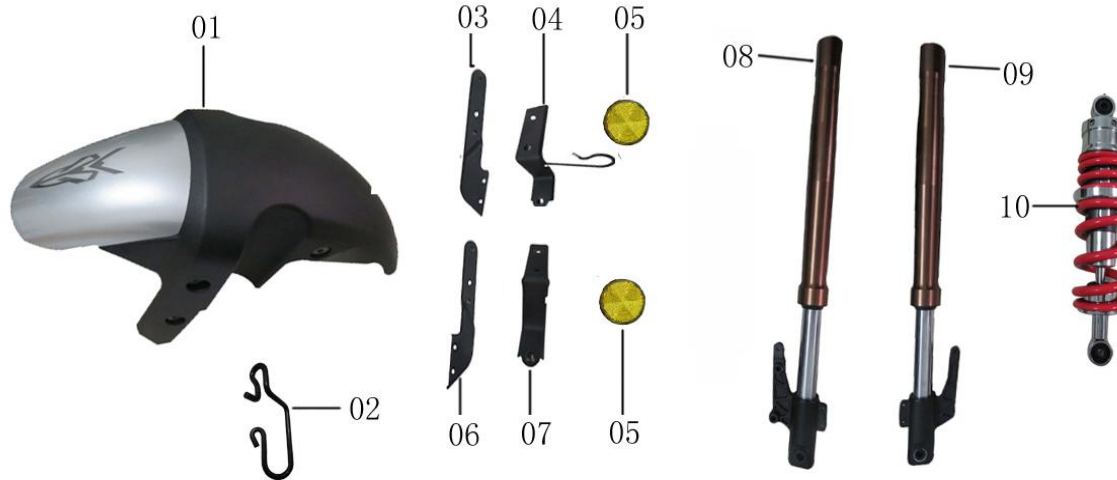

Parts No.	Description		Unit
KPMF05-01	Front Fender		PC
KPMF05-02	Wire Holder (Front Brake)		PC
KPMF05-03	front right fender braketa comp.		PC
KPMF05-04	side reflector braketa comp. RH		PC
KPMF05-05	Reflector, front		PC
KPMF05-06	front left fender braketa comp.		PC
KPMF05-07	side reflector braketa comp. LH		PC
KPMF05-08	Shock absorber, front, RH		PC
KPMF05-09	Shock absorber, front, LH		PC
KPMF05-10	Shock absorber Assy, rear		PC

LF200-3B F-06 散热器护板 FUEL TANK GUARD

F-06 散热器护板 FUEL TANK GUARD



Parts No.	Description		Unit
KPMF06-01	Hood, radiator		PC
KPMF06-02	Ornament II, fuel tank, LH		PC
KPMF06-03	Ornament II, fuel tank, LH		PC
KPMF06-04	Ornament, fuel tank inner, RH		PC
KPMF06-05	Ornament, fuel tank inner, LH		PC
KPMF06-06	Ornament, fuel tank, RH		PC
KPMF06-07	Ornament, fuel tank, LH		PC

LF200-3B F-07 油箱 FUEL TANK

F-07 油箱 FUEL TANK



Parts No.	Description	Unit
KPMF07-01	Cushion, fuel tank front	PC
KPMF07-02	Ornament, fuel tank upper	PC
KPMF07-03	Sensor, fuel	PC
KPMF07-04	Pump, oil	PC
KPMF07-05	Tank comp., fuel	PC
KPMF07-06	Right Strip, fuel Tank	PC
KPMF07-07	Plate, fuel tank front	PC
KPMF07-08	Left Strip, fuel Tank	PC
KPMF07-09	Plate, fuel tank front II	PC
KPMF07-10	Cushion, rear fuel tank	PC
KPMF07-11	Hose	PC

LF200-3B F-10 后叉 REAE FORK

F-10 后叉 REAE FORK

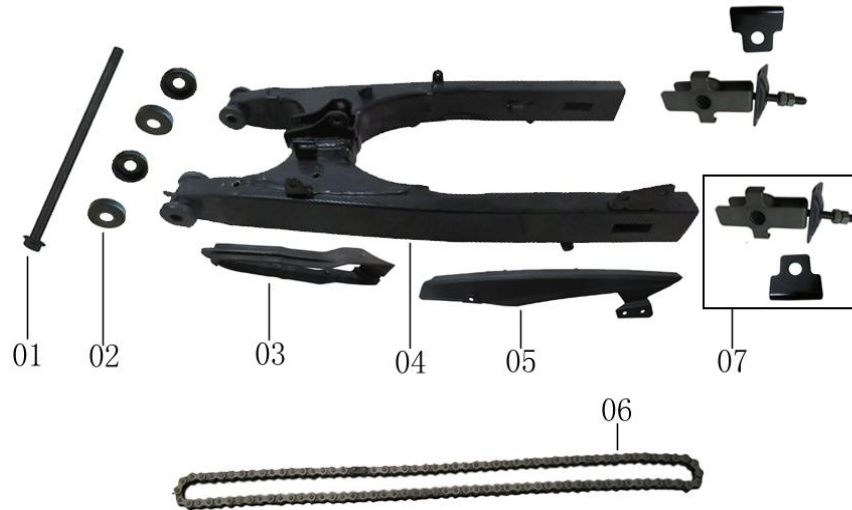

Parts No.	Description		Unit
KPMF10-01	Shaft, rear fork		PC
KPMF10-02	Dust cover, rear fork shaft		PC
KPMF10-03	Guide, chain		PC
KPMF10-04	Fork comp., rear		PC
KPMF10-05	Chaincase		PC
KPMF10-06	Chain, 428MH×128		PC
KPMF10-07	Adjuster set, chain		PC

LF200-3B F-11 后轮 REAR WHEEL

F-11 后轮 REAR WHEEL

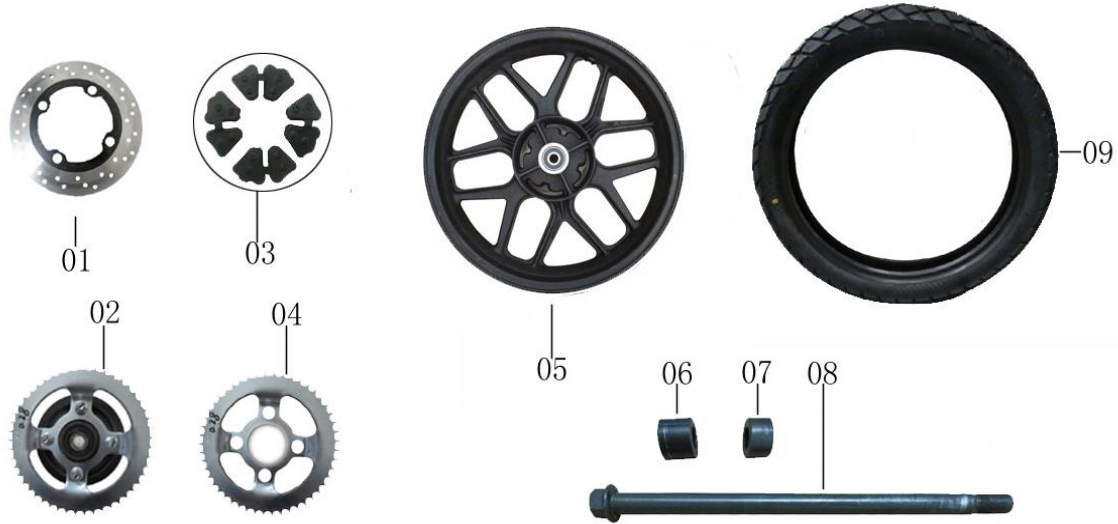

Parts No.	Description		Unit
KPMF11-01	Disc, rear brake		PC
KPMF11-02	Hub Assy, sprocket		PC
KPMF11-03	Buffer, rear wheel		PC
KPMF11-04	Sprocket		PC
KPMF11-05	Rim, rear wheel		PC
KPMF11-06	Rear Wheel Bush, LH		PC
KPMF11-07	Rear Wheel Bush, RH		PC
KPMF11-08	Axle, rear		PC
KPMF11-09	Tyre, rear		PC

LF200-3B F-12 后挡泥板 SEAT & REAR FENDER

F-12 坐垫 后挡泥板 SEAT & REAR FENDER



Parts No.	Description		Unit
KPMF12-01	Flap, rear mud		PC
KPMF12-02	Head, rear fender		PC
KPMF12-03	Body, rear fender mid		PC
KPMF12-04	Plate set, seat rear connecting		PC
KPMF12-05	Tail, rear fender		PC
KPMF12-06	Reflector, rear		PC
KPMF12-07	Seat Assy		PC
KPMF12-08	Ornament, rear fender rear		PC

LF200-3B F-13 空滤器 排气消声器 AIR CLEANER & EXHAUST MUFFLER

F-13 空滤器 排气消声器 AIR CLEANER & EXHAUST MUFFLER

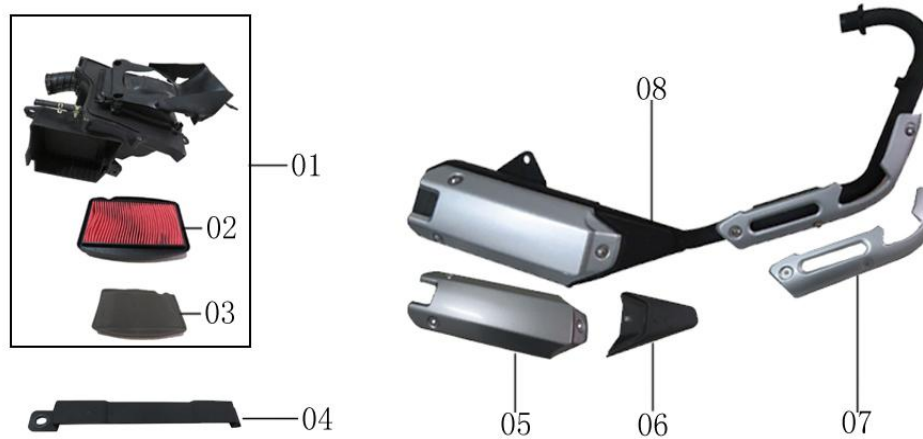

Parts No.	Description		Unit
KPMF13-01	Cleaner Assy, air		PC
KPMF13-02	Element, air cleaner		PC
KPMF13-03	Element II, air cleaner		PC
KPMF13-04	Plate set, battery pressing		PC
KPMF13-05	Mantle, muffler		PC
KPMF13-06	Ornament set, muffler		PC
KPMF13-07	Hood, exhaust pipe		PC
KPMF13-08	Exhaust muffler Assy		PC

LF200-3B F-14 前后制动器 FRONT & REAR BRAKE

F-14 前后制动器 FRONT&REAR BRAKE

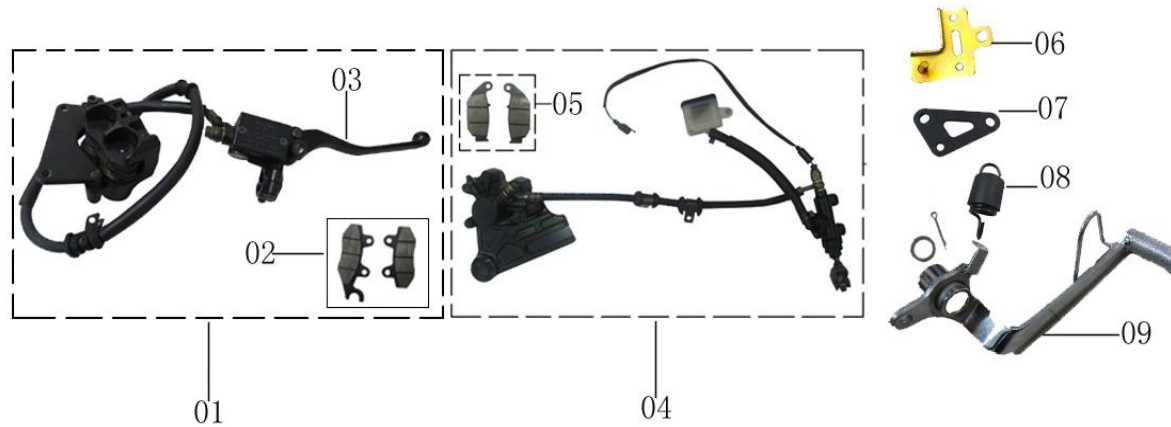

Parts No.	Description		Unit
KPMF14-01	Brake comp., front hydraulic		PC
KPMF14-02	Front Brake Shoe Set		PC
KPMF14-03	Front Brake Lever		PC
KPMF14-04	Rear Hydraulic Disc Brake		PC
KPMF14-05	Rear Brake Shoe Set		PC
KPMF14-06	Bracket set, rear brake reservoir		PC
KPMF14-07	Hanging Plate, Rear Brake Spring		PC
KPMF14-08	Spring set, rear brake pedal		PC
KPMF14-09	Pedal, rear brake		PC

LF200-3B F-16 车架总成 FRAME BODY

F-16 车架总成 FRAME BODY



Parts No.	Description		Unit
KPMF16-01	Body weldment, frame		PC
KPMF16-02	Plate set, engine front connecting		PC
KPMF16-03	Stand, side		PC
KPMF16-04	Handrail, RH		PC
KPMF16-05	Handrail, LH		PC
KPMF16-06	Bracket, rear fender front body front		PC
KPMF16-07	Lock Assy		PC

LF200-3B F-17 散热器总成 RADIATOR

F-17 散热器总成 RADIATOR

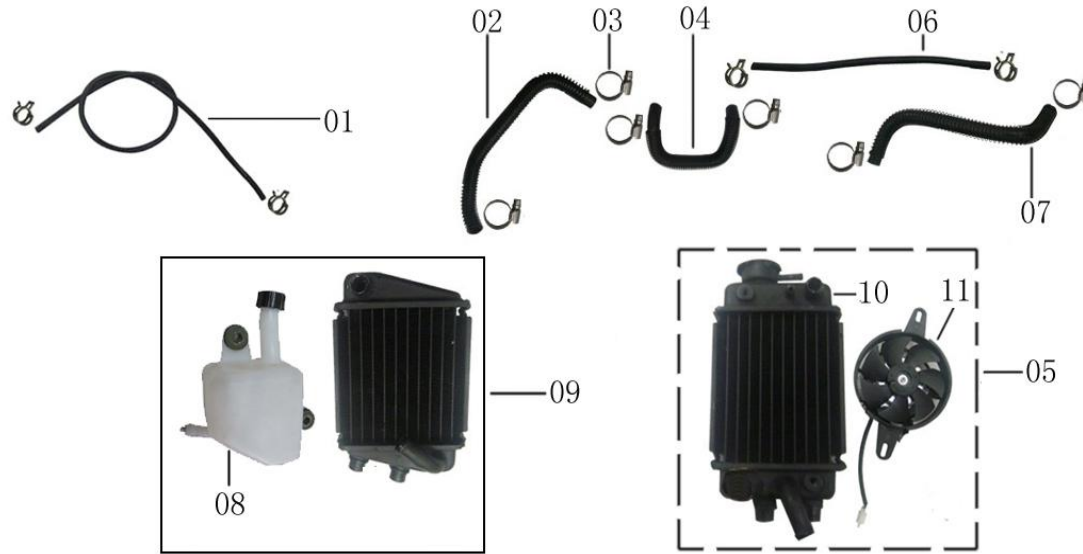

Parts No.	Description		Unit
KPMF17-01	Pipe, small		PC
KPMF17-02	Hose, radiator inlet		PC
KPMF17-03	Clamp, 25		PC
KPMF17-04	Pipe., connecting		PC
KPMF17-05	Radiator set II.		PC
KPMF17-06	Pipe, storage reservoir outlet		PC
KPMF17-07	Hose, radiator outlet		PC
KPMF17-08	Reservoir, storage		PC
KPMF17-09	Radiator set		PC
KPMF17-10	Radiator		PC
KPMF17-11	Fan Assy		PC

LF200-3B F-19 燃油蒸发系统 FUEL EVAPORATING SYSTEM

F-19 燃油蒸发系统 FUEL EVAPORATING SYSTEM

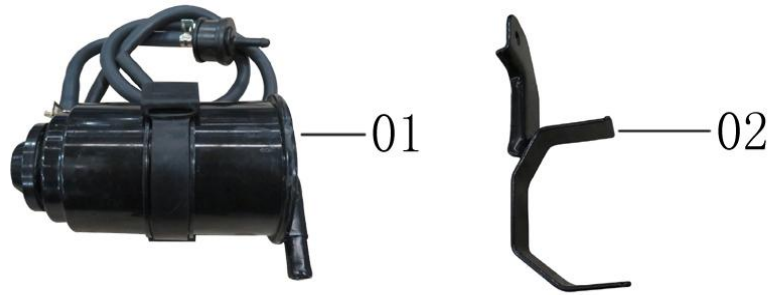

Parts No.	Description		Unit
KPMF19-01	Fuel Evaporating System		PC
KPMF19-02	Stay, Canister, active carbon		PC

LF200-3B F-20 电喷系统 ELECTRONIC FUEL INJECTION SYSTEM

F-20 电喷系统 ELECTRONIC FUEL INJECTION SYSTEM



Parts No.	Description		Unit
KPMF20-01	Efi controller		PC
KPMF20-02	Oxygen sensor		PC
KPMF20-03	Rail, fuel		PC
KPMF20-04	Throttle body		PC
KPMF20-05	Idle valve (carbon canister)		PC
KPMF20-06	Air temperature sensor		PC
KPMF20-07	Intake manifold comp		PC
KPMF20-08	Injector		PC
KPMF20-09	Intake pressure sensor		PC
KPMF20-10	Pipe, idling gulp valve inlet		PC
KPMF20-11	Lug, intake air pressure sensor		PC
KPMF20-12	Pipe, pressure collecting		PC
KPMF20-13	Pipe, idling gulp		PC