

ULTRASONIC CLEANER

CD-2820

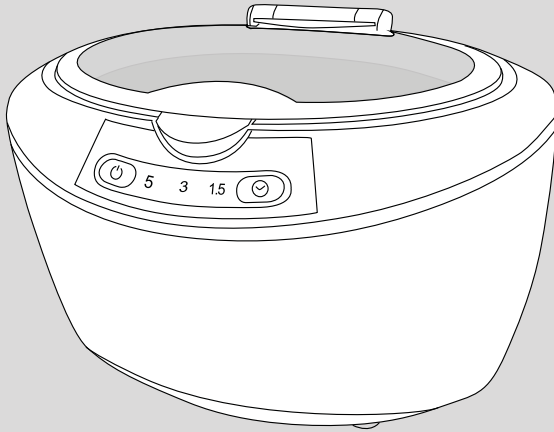

USER GUIDE

FEATURES:

- 1*** Cleaning with tap water;
- 2*** Upper cover auto opened slowly ;
- 3*** Ultrasonic frequency: 42,000Hz;
- 4*** 3 section timer setting choosing freely;
- 5*** Lengthen stainless steel tank;
- 6*** Quiet, solid state circuitry.

INTRODUCTION

Thank you for buying this Ultrasonic Cleaner.

Ultrasonic cleaning is a unique phenomenon, item cleaning with tap water only. Millions of tiny bubbles are created when ultrasonic sound is passed through liquid. These tiny bubbles combined with a huge pressure that created incredible cleaning results.

READ THE USER GUIDE

The Ultrasonic Cleaners are very easy to use, although to get the best from your new purchase, we recommend you read this User Guide before getting down to any cleaning. It also contains important safety information as well as practical hints.

INDEX

1	IMPORTANT SAFEGUARDS-----	1/2
2	WHAT CAN NOT BE CLEANED-----	2
3	DIRT ELIMINATION PROCESSES-----	3
4	SUGGESTED APPLICATIONS-----	3
5	FIGURES AND ACCESSORIES-----	4
6	THREE DIFFERENT WAYS OF CLEANING-----	5
7	USAGE OF OPTIONAL ACCESSORIES-----	6
8	REGARDING 3 TIMES CHOOSING-----	6/7
9	OPERATION INSTRUCTIONS-----	7/8
10	MAINTENANCE AND STORAGE-----	8/9
11	SPECIFICATION-----	10

IMPORTANT SAFEGUARDS

When using electrical products, especially when children are present, basic safety precautions should always be followed, including the following.

SAFETY INSTRUCTIONS

⊘ WARNING-To reduce the risk of burn, fire or injury to persons

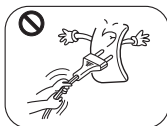

The unit should never be left unattended when plugged in.



Close supervision is used by, on, or near children or invalids.

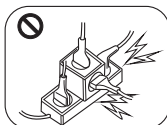

Use the unit in right way as per its user guide. Do not use attachment not recommended by the manufacture.

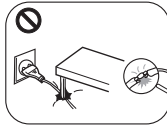

Never operate this unit if plug or cord is damaged. Please refer to a service center for examination and repair.

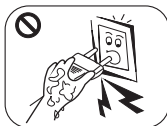

To avoid electric shock, never touch the power cord or socket with wet hands.



Keep the unit unplugged before filling. Do not fill water exceed "MAX" line of tank.



Keep the cord away from heated surfaces.



Do not fill the tank with abrasive or corrosive chemicals.



Uplug this product before filling. Fill with water only unless otherwise specified by manufacturer. Do not overfill.

This appliance has a polarized plug (one blade is wider than the other). As a safety feature, this plug will fit in a polarized outlet only one way. If the plug does not fit fully in the outlet, reverse the plug. If it still does not fit, contact a qualified electrician. Do not attempt to defeat this safety feature.

Children should be supervised to ensure that they do not play with the appliance.

SAFETY INSTRUCTIONS

! **DANGER-** To reduce the risk of shock:

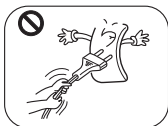

Always unplug this product immediately after using.



Do not use while bathing.

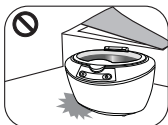

Do not place or store product where it can fall or be pulled into a tub or sink.



Do not place in or drop into water or other liquid.



Do not reach for a product that has fallen into water. Unplug immediately.



The product may be off or can't be switched off when it is subjected to electromagnetic interference like Fast Transients or Surge voltage, but it can recover after being re-plugged in the socket, and then just follow the instruction described in this manual to set the function again for normal operation.

This appliance is not intended for used by persons (including children) with reduced physical, sensory or mental capabilities, or lack of experience and knowledge, unless they have been given supervision or instruction concerning use of the appliances by a person responsible for their safety.



WHAT CAN NOT BE CLEANED!

BIJOUTERIE

Hawkbill, Pearl, Emerald, Ivory, Coral, Agate.

Maybe the less rigidity of hawkbill or coral will be scrubbed, color changed or brightness lost caused by the rubbing of one object or surface against another.

PRECIOUS METAL

Soldering metal, Eletro Plating metal, Bindings

Be broken off will be happened to the unsolid point of the soldering and binding items by ultrasonic cleaning. The cracked electro plating will be enlarged after cleaning

WATCH

Watch, Pocket watch
(Except the waterproof watch under 30m or more)

The water will be in the watch movement of little waterproof function for the ultrasonic strong osmosis occasionally.

OTHERS

Wood, Glass, Contact lens, Ceramic, Camera colored filter.

Maybe rift of ceramic, wooden items, or laminated glasses will be enlarged by ultrasonic cleaning. (It won't be happened for the item in perfect condition).

DIRT ELIMINATION PROCESSES

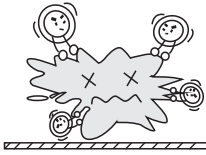

Many tiny bubbles are created when ultrasonic sound is passed through liquid.

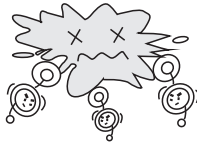

Bubble are imploded constantly under the ultrasonic.

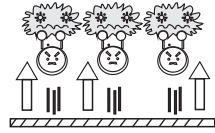

The dirt splits into tinys and separate from the item to create cleaning result

SUGGESTED APPLICATIONS

JEWELLERY	GLASSES & TIMEPIECES	DAILY COMMODITIES
Necklaces, Rings, Earrings, Bracelets etc.	Glasses, Sun glasses, Water proof watches, Watch chains etc.	Electric shaver heads, Dentures, Combs, Infantile articles etc.
STATIONERY	METAL ARTICLES	TABLEWARE
Pen-heads, Printer-heads, Seals etc.	Watch parts, Badges, Valves, Machine nozzles etc.	Metal tableware, Forks, Knives, Spoons etc.

FIGURES AND ACCESSORIES

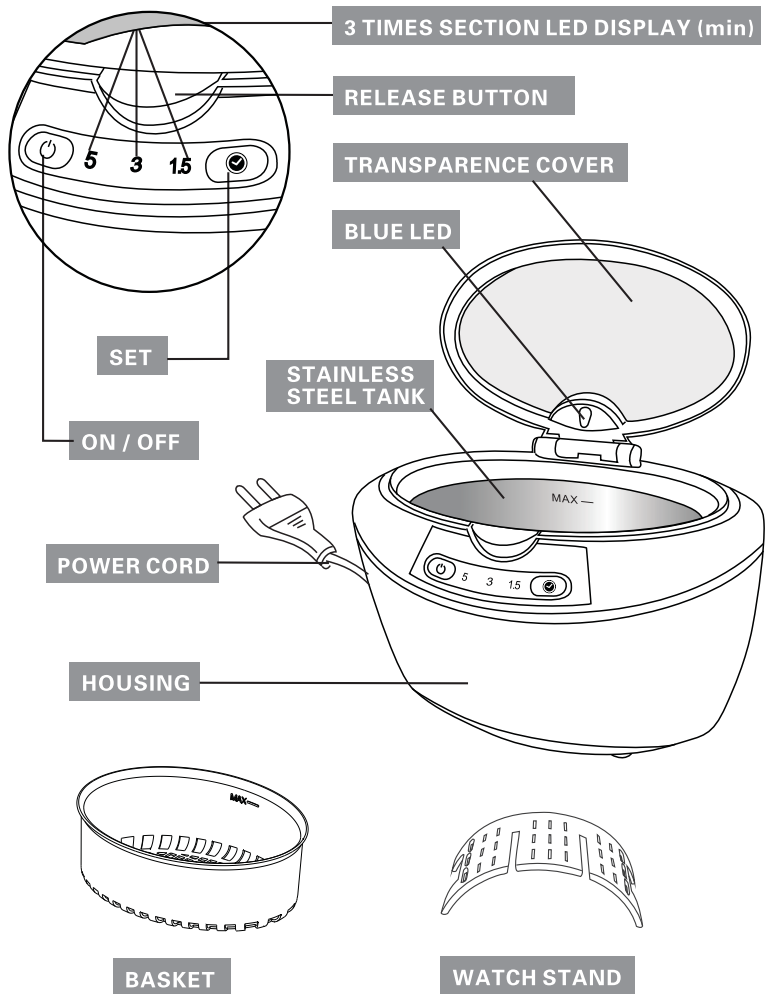

THREE DIFFERENT WAYS OF CLEANING

GENERAL CLEANING

Only using normal tap water

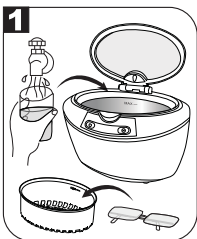

Put items into tank directly or place the items on basket then put them into tank together, then fill with tap water. Ensure the items are immersed in the water but do not exceed the "MAX-" mark. Press the "⏻" button to start on working.

Note: on the cleaning, the dirt appeared from the item. It looks like "smoking", meanwhile the clean water is becoming dirty until "smoking" disappeared, the item is cleaned. (Usually 3 min is enough)

PUT A LITTLE LIQUID WASH SOAP TO ENHANCED CLEANING



Use for cleaning the items with too much oiled dirt.

Put items into tank directly or place the items on basket then put them into tank together and fill with tap water, ensure the water cover the items but do not exceed the "MAX-" mark.

If the item with too much oiled dirt, can use about 1 spoon liquid soap (about 4 ml).

Press "⊙" button, choose 5 minutes, then press "⏻" button, the unit start to work.



As using liquid soap, so need to wash the item again with clean water, or using clean water go on cleaning 1.5minutes, in order to clear away the liquid soap.

Note: The liquid soap is neutral liquid and very normal for home dishware using, it is "soft" chemical liquid. Using a little in ultrasonic cleaning, can soft the oiled dirt, to make the oiled dirt can't condense again on the surface of the item, to enhance result of cleaning.



CLEANING BY PARTS

Used to longer items

Although tank size of the unit has lengthened, some of items are not able to put it in competely. Such as knife, fork, spoon etc it can be clean by sections: the part one of end by another as the picture shown.

USAGE OF OPTIONAL ACCESSORIES

BASKET



When small item is to be cleaned, put the item into basket, then put them together into the tank. In this way, frictions between the items and the tank can be reduced.

Note: the basket is only used for cleaning small items, because it absorbs about 30% of ultrasonic energy, and reduces the cleaning result. In this case, when using the basket, please refer to the instruction of "Enhanced Cleaning" in this manual.

WATCH STAND

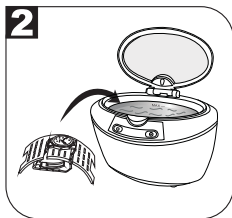

The permeability of ultrasonic is very strong, do not put watch (of water proofing capability less than 30 metres) into the tank directly, because water may penetrate into the watch and cause severe damages. It is recommended to use the watch stand for watch band cleaning by simply immersing the watch band into the water while keeping the watch case on top of water.

Note: Similar to Basket, the Watch Stand also absorbs ultrasonic energy. When the watch stand is used, use "Enhanced Cleaning" for effective cleaning result.

REGARDING 3 TIMES CHOOSING

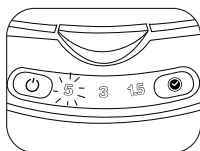

The unit power on, timer will be set in 5min cleaning auto meanwhile it's indicator turn on 5min.

It usually use for items first time cleaning, the dirt staying on the product is long, so it needs more time to clean.

If items with much oiled dirt. It can use company with "enhance cleaning", for better effect result.

It has finished 5 min cleaning the unit will be stopped automatically. Press "●", time cycles: $\rightarrow 1.5\text{min} \rightarrow 3\text{min} \rightarrow 5\text{min}$ will be displayed accordingly meantime it's indicator will be on.

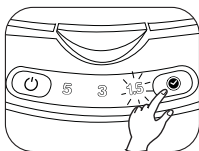

There is still "smoke" comes out when it closes to finish the 3 or 5 min cleaning, Using this step.

After using "Enhance Cleaning", replace clean tap water to rid of the soap liquid by using this step.



Long time cleaning may cause the original unfirmed screw on the product, the original unfirmed inlaid product become loosen.

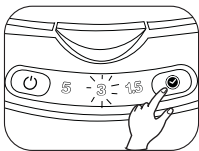

It is the most common time for general cleaning .

OPERATION INSTRUCTIONS

1

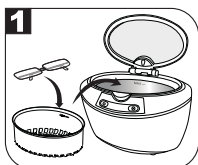

Open the lid.

Press release button, the lid will be opened slowly auto. Place items into tank directly or put the items on the basket then place them into tank.



To avoid the scratch and friction of the products, to keep glasses up, never lay items over!

2

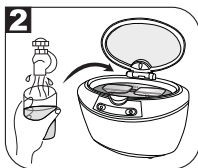

Place item into water.

Fill the tap water into stainless steel tank, the water should cover the surface of the items but do not exceed the "MAX-" mark.

3

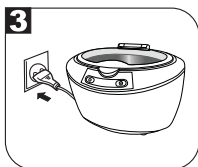

Close the lid and plug in.

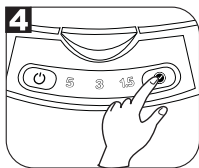

Press "1.5" button to choose working cycles freely.

When the unit is electrified, 5min is displayed automatically. Every time when press "1.5" button, the 3 optional working cycles [1.5min → 3min → 5min] will be displayed on the screen. Users can choose working cycle freely according to the quantity and situation of the item. (Details please refer to "Regarding 3 times choosing".)

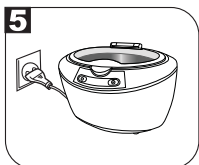

Press "ON" button to start cleaning, blue LED light is on. When 5 min cleaning has finished, it will be stopped auto meanwhile blue LED is off.

During cleaning, you can hear the "BUZZ" voice, it means the unit is working.

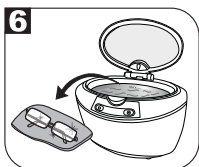

If next cleaning is needed, just repeat the above steps. During cleaning, when you want to stop, just press "OFF" button (pressing last over 3sec change to off). If press "OFF" button again, the unit will continue do the cleaning. You can also press "1.5" button to renew the working cycle.

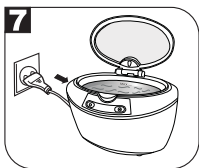

When the cleaning is finished, unplug it and open the lid, then take out the item. At last, pour the water from stainless steel tank and wipe it up.

MAINTENANCE AND STORAGE

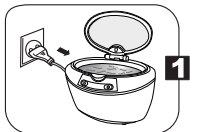

Unplug and empty the unit after using.

 Do not keep water in the tank for a long time.



If unit has been working 3 cycles, it's better to stop over 10 minutes, in order to prolong the using life.



Wipe the tank and unit with dry towel.



Do not water the complete unit to avoid the risk of electric shock.

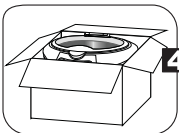

Keep in cool and dry place.

SPECIFICATION

NAME MODEL:	Ultrasonic Cleaner
ITEM NO.:	CD-2820
TIMER SETTINGS:	->5min->3min->1.5min->
RATING VOLTAGE & FREQUENCY	AC100-120V 50/60Hz, 35W
CONSUMPTION POWER (MAX watte)	AC220-240V 50Hz, 50W
ULTRASONIC FREQUENCY	42,000Hz
MATERIAL OF TANK	Stainless teel SUS304
DIMENSIONS (L x W x H):	222 x 153 x 142 mm
TANK CAPACITY :	750 ml (MAX- : 600 ml)
POWER CORD LENGTH (About):	1.5 m
NET WEIGHT (N.W.):	1.0 KGS
GROSS WEIGHT (G.W.):	1.36 KGS