

ZH-680BH

Tennis Pitch Machine Manual

●Parts Description

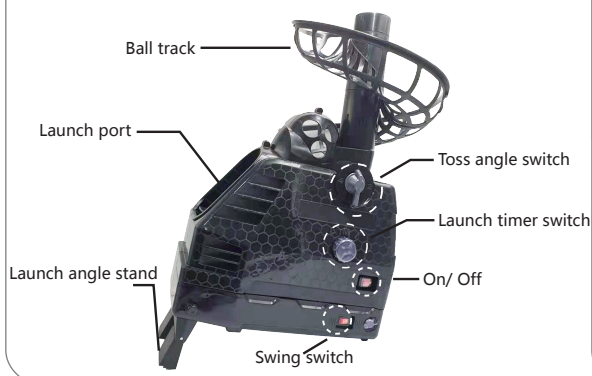

●Package content

Please make sure all accessories are intact before assemble.
Batteries need to be purchased separately.
PS. Please use Alkaline battery



●Assemble instruction

- 1 Connecting tracks with machine (show as image A), make sure concave and convex connected together and put B part in right position. (show as step 1)
- 2 Assemble tracks one and the other ((show as image C) and put D part in right position. (show as step 2)
- 3 After putting the top track (show as image E), connect concave and convex and put F part in right position. (show as step 3)

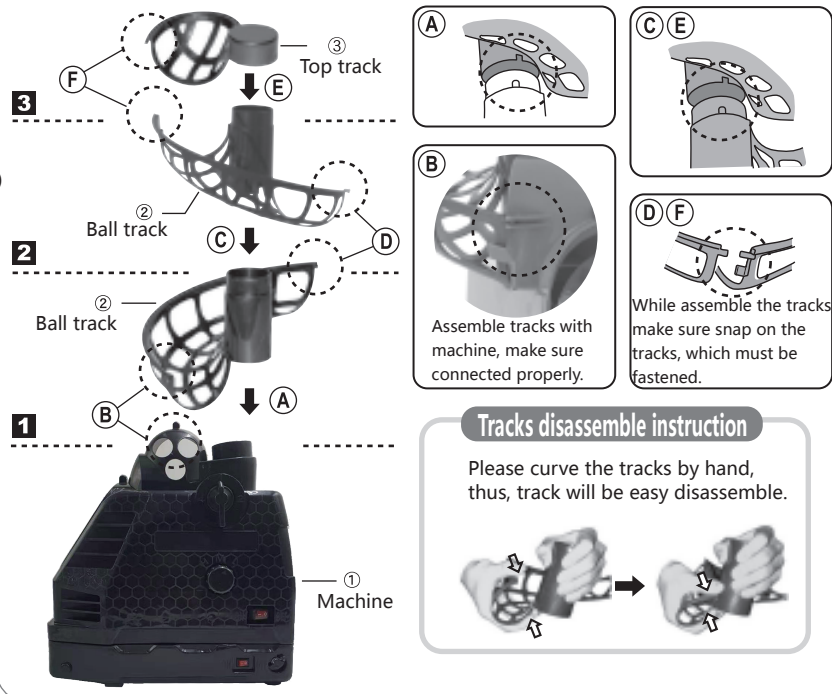

●Machine instruction

▲ 3 adjustable stand



●Swing function

▲ Auto- Swing by turn on the switch



● **Dry batteries assemble instruction** --The battery box is at the bottom of the machine.
※Please turn off the machine before putting the batteries.



⚠ Precautions for assemble dry batteries

- Please use alkaline battery or dedicated cable.
- The battery installation must operated by an adult.
- Please install batteries correctly follow "+" and "-"
- Do not mix new and old batteries.
- When the machine not in used, remove the batteries.
- Keep the batteries dry.

If batteries install incorrectly, it may cause short circuit or leakage.



It might cause below issue when the batter in low level

- Take long time to launch the ball
- Nosies motor
- Launch distance might be affected.



Precautions

- Please do not use this product on rainy day.
- Do not let the machine and battery box get wet.
- Do not use this product near water.
- The installation of the machine needs to be operated by an adult.
- Please use it in a wide field without other people.
- Please spervise by adult when the children use it.
- Please use dedicated ball only.
- Do not put your head or hand near the launch port When the machine is operating.
- Do not press heavily or hit the machine with force.
- Please do not use this product for other purposes.
- Do not disassemble this product, it may cause malfunction.
- Keep this product away from high temperature area(car or fire).
- After use, wipe off the moisture and dirt from surface and store in dry place.

MADE IN CHINA