

Baseball and PU ball Toss Machine

ZH-6801BH

Installation and User manual

Parts list

Kindly be sure all parts fine before assembling

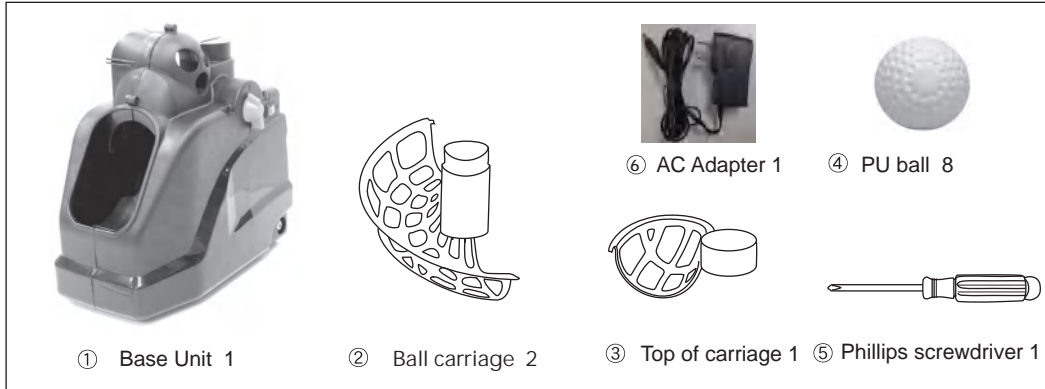

Assembly shown

Parts detail

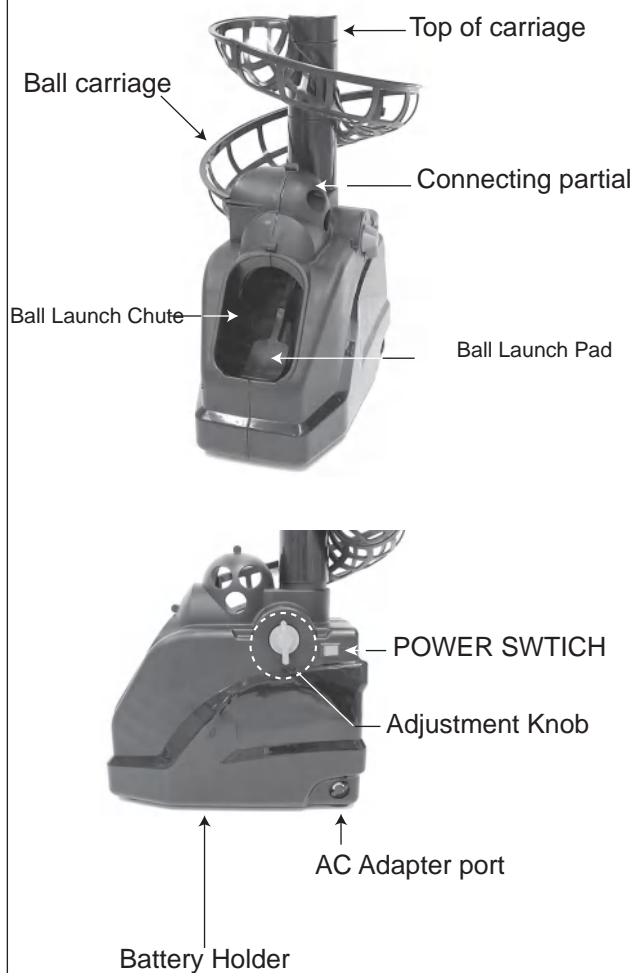

User instruction

- Adjust to tier 1 while using poly ball. 4 tier adjustment available.
- Tier 2 recommended while using PU ball.

Assembly instruction Adult assembly and Supervision required.

- 1** Assemble the two sections of the ball carriage by inserting one carriage column into the other.
- 2** Insert the tabs from ball carriage onto top of carriage then press firmly down onto the connecting partial.

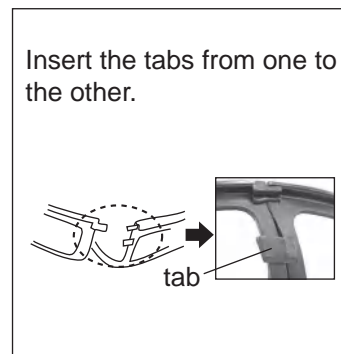
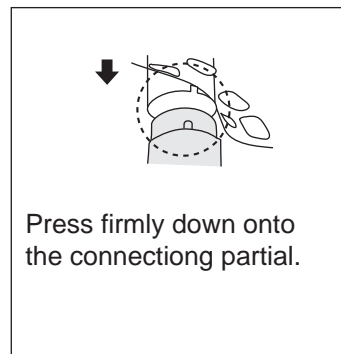
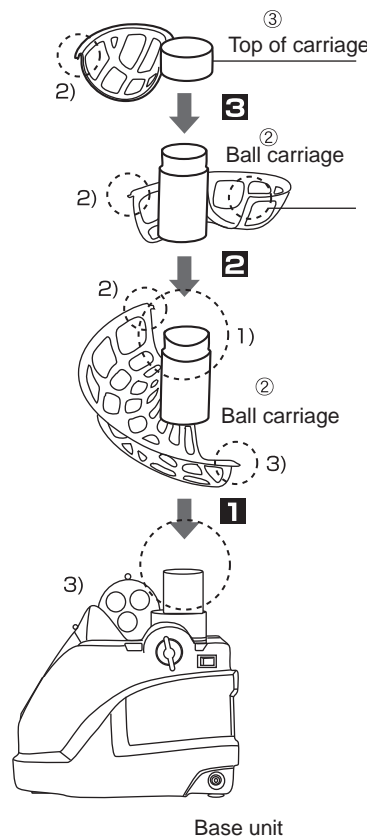

■ Battery Holder
bottom of unit.

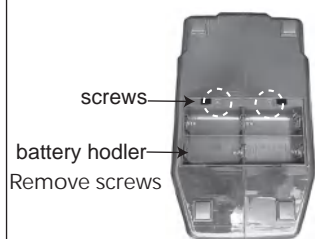

Carriage shapes adjustment

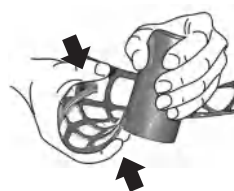

Please squeeze ball carriage once out of shape.

■ Do not switch ON if ball on Launch Pad.

- Make sure empty the Pad Before Power ON.



■ Battery installation(not included)

- Beware positive and negative installation. 4"D" size batteries required.

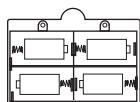

- Once finished installation. Please slide door to close.

⚠ NOTE

- Adult assembly and Supervision required. Beware positive and negative installation.
- Do not mix alkaline, standard, etc.
- Take off batteries once it's in storage
- Keep product and batteries dry.

■ Add-On

20PU balls per package
ZH-3801BH-3



- This first ball may not toss at full speed and distance due to location of lever when machine is turned on. Second ball will be best to gauge location relative batter.
- Differ capacities of batteries cause various distance and height

Item Dimensions LxWxH: 17.3 x 9.8 x 13 inches

weight: 1.3 Kilograms

Material: Unit and carriage:Plastic
Ball:PU

⚠ NOTE

- Please don't use product on raining days.
- Please keep it dry.
- Do not use it on wet surface.
- Adult assembly and supervision required.
- All person(s) not batting should stand behind the pitching machine.
- Do not use the product for any other purpose or with any other object.
- If the product jams, turn machine to "OFF" position.
- Keep product away from high temperature or any fire place.
- Please clean product once training session finished.