



YOUR BEST SHOT !

802 EASI STORE UNIT ASSEMBLY INSTRUCTIONS

WARNING !!!

To be assembled and dismantled by an adult
must always be used in presence of an adult
do not leave in the open in windy conditions.



PART LIST



P1-38cmx19mm
QTY.- 1 Nos.



P2-12 LOOPS
QTY.- 1 Nos.



P3- 3"x2.5"
QTY.- 1 Nos.



P4- 2.5"x2.5"
QTY.- 3 Nos.



P5-76cmx57cmx4.5cm
QTY.- 1 Nos.



P6- 6cm
QTY.- 4 Nos.



P7-30.5cmx56mm
QTY.- 1 Nos.



P8-112cmx48mm
QTY.- 1 Nos.



P9-112cmx48mm
QTY.- 1 Nos.



P10-102cmx45mm
QTY.- 1 Nos.

STEP-1



Attach small pipe (P7) with base (P5) by rotating

STEP-2

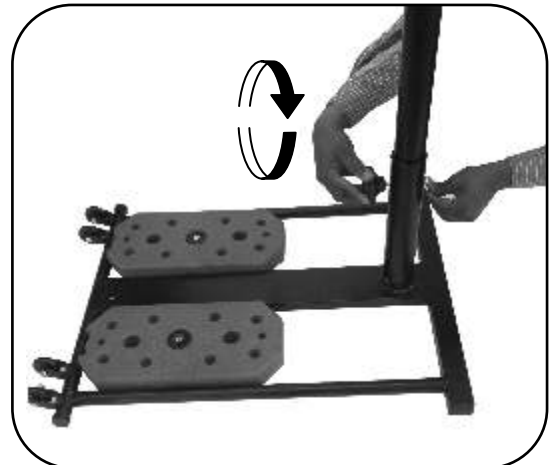
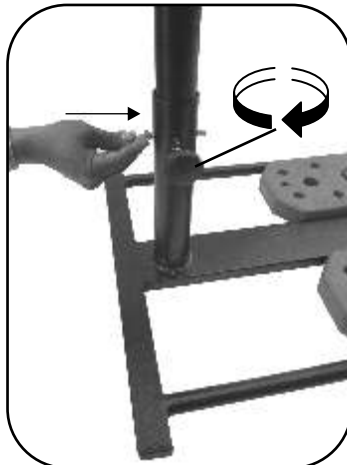
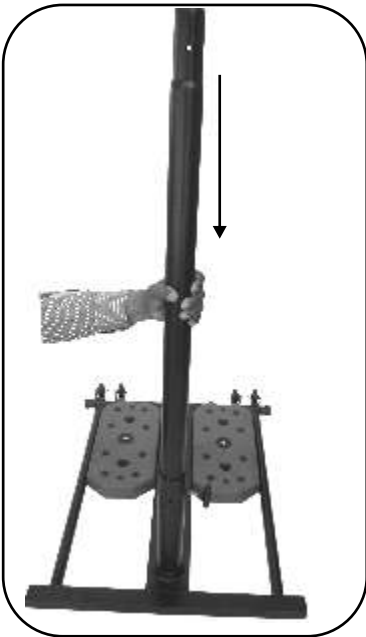

Attach pipe (P8) with pipe (P7) attached with base (P5) using bolt (P3) and tighten it with the tightening screw (P6). At the same time tight tightening screw attached with pipe (P7).

STEP-3

Attach pipe (P9) with pipe (P10) using bolt (P4) and tighten the tightening screw (P6)

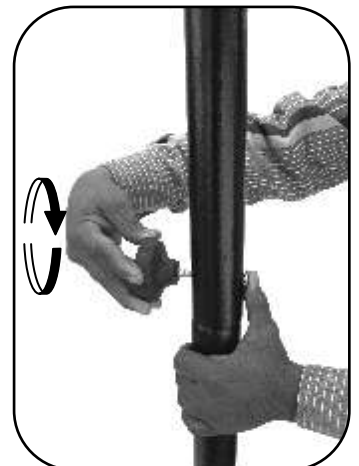

STEP-4

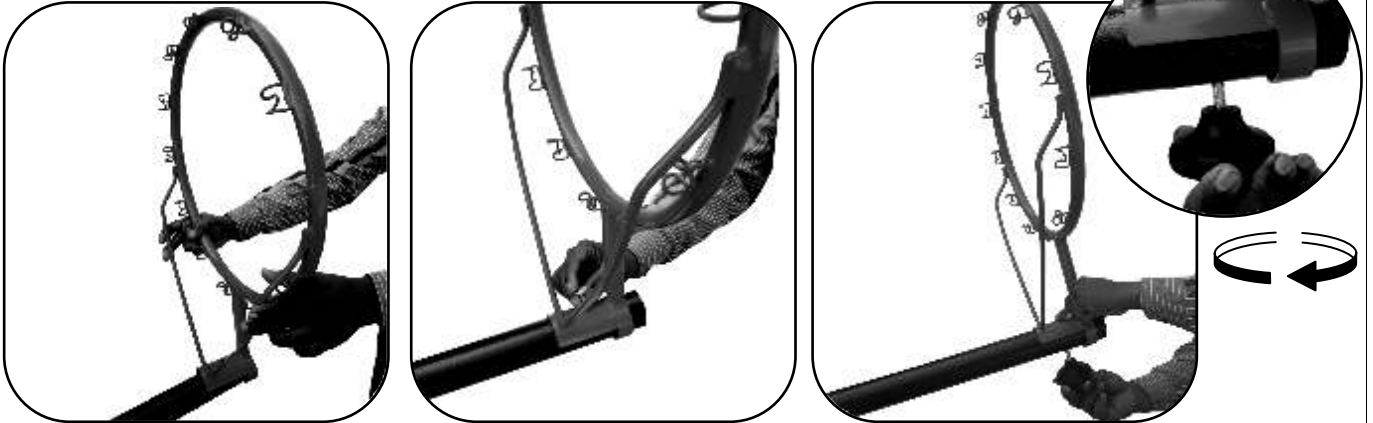

Attach ring (P1) with pole (P10) attached with pole (P9) using bolt (P4) and tighten it with the help of tightening screw (P6)

STEP-5

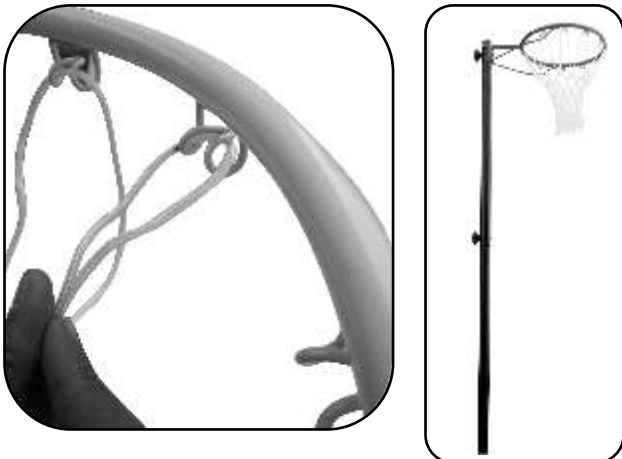

Attach Net (P2) loops with ring (P1)

STEP-6

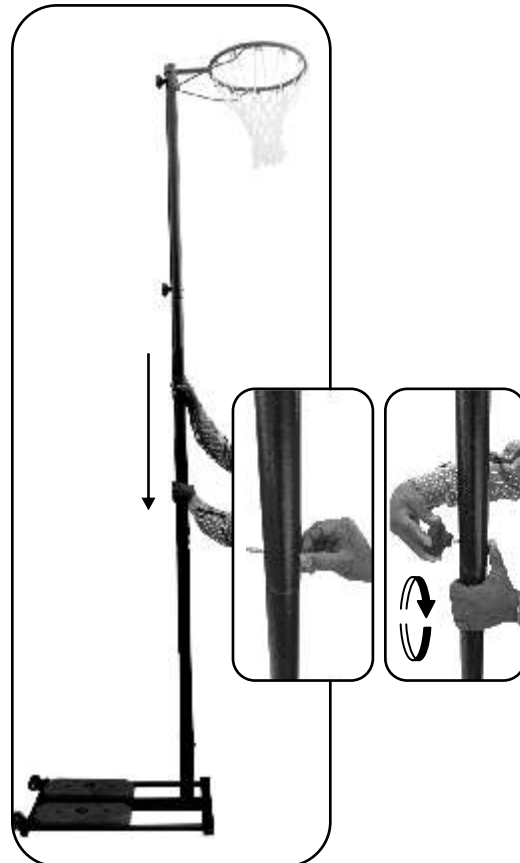

Attach pipe (P9) & (P10) attached with each other and also with ring (P1) and net (P2) with pipe (P8) attached with base (P5).