

# TEMPTU **one**

## Quick Start Guide



**FROM THE AIRBRUSH AUTHORITY**

Simple, One-Touch Airbrush Perfection

## POWER UP

1. Charge before first use.
2. Hold down the power button for two seconds to turn the TEMPTU One on and off.
3. The light will blink when the One needs to be recharged, which takes 2-4 hours to complete.

Connect the One micro USB charging cord to a compatible micro USB charging source that is UL Listed/CSA certified:

- Car Phone Chargers
- Wall Phone Chargers
- USB AC Power Adapters
- Desktop Computers
- Laptop USB Ports
- USB Charging Stations

Connects to TEMPTU One USB Charging Port



Connect to USB Power Adapter (sold separately)

## 2 WAYS TO APPLY: AIRPOD VS. AIRPOD PRO

Know which type of Airpod you are using before getting started.

### Pre-filled Airpod

Airbrush cartridge pre-filled with makeup or other formula ready to use after prepping the Airpod. No cleaning necessary. **SOLD SEPARATELY**



### Airpod Pro

Patented, reusable open top airbrush cartridge for use with bottle formula for custom blending shades. Requires spray-through cleaning. **SOLD SEPARATELY**



## GET STARTED

Scan to watch our videos on how to airbrush with the One and pre-filled Airpods or Airpod Pro.

Using Pre-filled Airpods



Using Airpod Pro



## PREP YOUR PRE-FILLED AIRPOD

Shake Airpod well before each use. Remove tamper seal and cap.

Firmly pull back on the clear loop to prime Airpod before first use only.

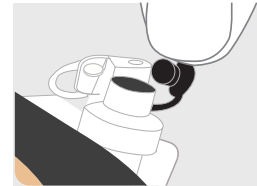
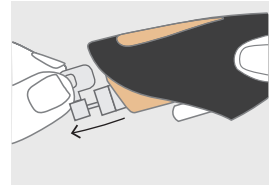

Gently open the plug before attaching Airpod to the TEMPTU One.

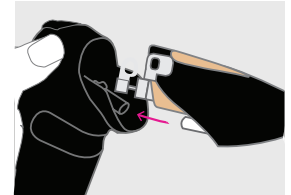

Line up the Airpod, window-side up, with the TEMPTU One. Slide and push until it clicks into place.

## PREP YOUR AIRPOD PRO

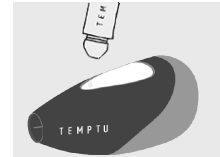

Remove tamper seal and cap. Prime first time only by putting 1-2 drops of S/B Cleaner over the needle in the well.

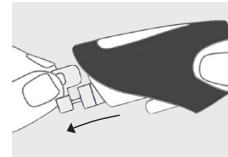

Pull gently on the clear loop once to prime Airpod Pro.

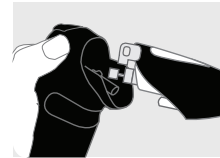

Line up Airpod Pro with the TEMPTU One and slide it into place until it clicks.



Power on and spray S/B Cleaner through.

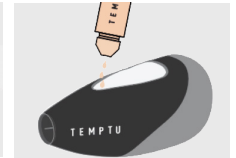

Drop makeup into inner well until the needle is covered. Mix with a brush if custom blending.

## FOR BEST RESULTS

- Apply well cap for spill-free application
- Use one Airpod Pro per formula (one for foundation, one for highlighter, etc.)
- Clean between colors and formulas
- Only use TEMPTU airbrush formulas in Airpod Pro (other formulas may not be compatible)

## FOR BEST RESULTS

The SoftTouch Control button regulates the amount of makeup released from the Airpod or Airpod Pro. Use pointer finger to pull SoftTouch Control back slowly to build coverage to the desired amount. LESS IS MORE.



STANDBY  
Device on,  
no air flowing



ACTIVATED  
Air flowing



For optimal results and to avoid over-spraying, **pull SoftTouch Control halfway** down between light and heavy. Practice on your hand first to get a feel for the application.

## MASTERING A FLAWLESS FINISH

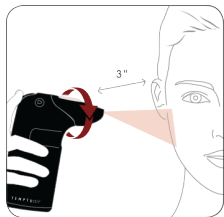

### 1-2 passes

for sheer coverage

### 2-3 passes

for medium coverage

### 3-4 passes

for full coverage

1. Hold the TEMPTU One about four fingers from the face.
2. Always keep the One moving in small, circular motions for a seamless, even finish.
3. Use a light touch with the SoftTouch Control when applying makeup to the face. TEMPTU makeup is weightless and buildable - a little goes a long way.
4. Stop and look between passes until reaching the desired level of coverage. Build coverage in layers.

## TIPS TO AVOID A WET, HEAVY OR UNEVEN FINISH:

- Do not hold One too close to skin
- Do not move in a back-and-forth motion
- Do not press too hard on the SoftTouch Control

## LEARN TO AIRBRUSH LIKE A PRO

Scan to watch "How To" videos on highlighter, contouring and more.

New to  
Airbrush?



Licensed Pro  
MUA?



## CARING FOR THE ONE

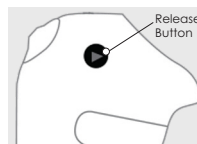

**REMOVING AIRPODS:** Use the release button to detach the Airpod or Airpod Pro, while pulling downward to remove it from the TEMPTU One.

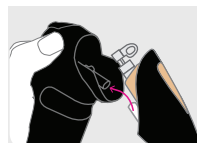

**CLEANING:** Never pour water on the One or submerge it in water. The TEMPTU One can be wiped down with a cloth or paper towel dampened with water or glass cleaner.

## CARING FOR PRE-FILLED AIRPODS

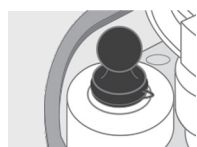

**PRO TIP:** Pre-filled airpods may require cleaning of the tip with the TEMPTU Brush occasionally to maintain optimal spray

**FOR AIRPOD ONLY:** Be sure to close the plug on the Airpod when not in use.

## CLEANING AND CARING FOR THE AIRPOD PRO

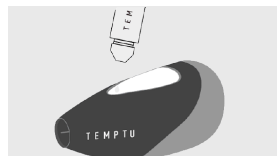

Clean with S/B Cleaner after using TEMPTU makeup or in between colors.



Use TEMPTU Brush to clean around and under the needle.

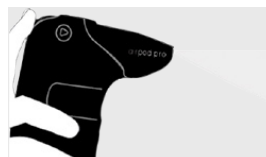

Spray through completely to clean.

- Airpod Pro is designed for up to 90-120 uses when cared for properly.
- Never store makeup in the Airpod Pro when not in use.
- Never soak the Airpod Pro in alcohol.

## GET MORE CARE AND TROUBLESHOOTING TIPS

Pre-filled  
Airpods



Airpod  
Pro



# SHOP TEMPTU AIRBRUSH FAN FAVORITES

## AWARD-WINNING ROOT TOUCH-UP AND HAIR COLOR

CONCEAL ROOTS AND COVER GRAYS  
FLAWLESSLY IN SECONDS.

Long-lasting, Natural-looking, Leaves hair looking healthy and shiny. Available in Airpods or bottles to use with Airpod Pro.



## 4-IN-1 SKIN PREP

EXFOLIATE | TONE | HYDRATE | BRIGHTEN

Prep your skin for perfection with the pure, natural goodness of our no-rinse BHA exfoliator that moisturizes, smooths rough patches and preps skin for makeup, tanner or other skincare.



SAVE 15% OFF  
YOUR NEXT PURCHASE

USE CODE: THANKYOU15

\*Use one-time code "THANKYOU15" at checkout for 15% off. Applicable purchase amount does not include the purchase of shipping, handling, or sales tax and may not be combined with other offers or discounts. Ongoing offers are subject to change without notice. Only available online at TEMPTU.com and TEMPTU.com/prc.

## INFINITE SUMMER AIRBRUSH SELF-TANNER

For a Flawless And Natural-Looking Self-Tan.  
Easy. Mess-Free. No Streaks or Smells.



BEFORE AFTER



## CORE 7

ANTI-AGING HYDRATION SERUM

One Mighty, Multi-tasking Serum.  
7 Core Benefits.



Hydrates

Fights Wrinkles  
and Skin Damage

Boosts Natural  
Collagen

Fight Fine Lines  
and Smooths Skin

Soothes and Fights  
Skin Damage

Brightens

### READ ALL INSTRUCTIONS BEFORE USING

**CHARGING:** Charge the TEMPTU One before first use, which should take between 2-4 hours to complete. Always close the cover to the USB Charging Port after charging is complete. Keep the USB Charging Port free of any water or other material. The indicator will flash repeatedly when the device is low on battery and while it is charging. Keep the charging cord away from small children.

Recharge only with the charging cord specified by the manufacturer and use with compatible micro USB charging block and UL/CSA certified power source. Note, using a charger that is suitable for one type of battery pack may create a risk of fire when used with another battery pack.

**MAINTENANCE AND SAFETY:** Do not use abrasive cleansers or chemicals to clean the TEMPTU One. The TEMPTU One can be wiped down with a damp cloth or paper towel and standard glass cleaner. Do not put any part of the TEMPTU One in water or in a dishwasher. Never attempt to open any part of the TEMPTU One. Never put liquid cleansers inside the USB Charging Port or any other part of the TEMPTU One. Read all instructions before use. When using electrical products, especially when children are present, basic safety precautions should always be followed, including but not limited to the following:

**DANGER:** To reduce the risk of electrocution: Do not use the TEMPTU One while bathing. Do not place or store the One where it can fall or be pulled into a tub or sink full of water. Do not place or drop the One into water or another liquid. Do not reach for the One that has fallen into water. If plugged in, unplug immediately. Keep the One and the charging cord away from heated surfaces. Do not expose a battery pack or appliance to fire or excessive temperature. Exposure to fire or temperature above 130°C (265°F) may cause explosion. When storing this device ensure the temperature does not go below -10°C (14°F) and should not exceed 45°C (113°F). When charging this device the temperature should not go below 0°C (32°F) and should not exceed 45°C (113°F).

**WARNING:** To reduce the risk of burns, electrocution, fire or injury to persons: close supervision is necessary when the One is used by, or on near children or people with disabilities. Use the TEMPTU One only for intended use as described in this User Guide. Do not use attachments not recommended by the manufacturer. Never operate the One if it is damaged, if it has a damaged charging cord or with a damaged plug, if it is not working properly, if it has been dropped, or dropped into water, contact TEMPTU at customercare@temptu.com so we can arrange for examination. Do not use where oxygen is being administered. The One is believed to be safe for use with many common pacemakers. If you have any questions about usage with a pacemaker, consult with your physician or manufacturer of the pacemaker prior to use.

This appliance can be used by children aged from 8 years and above and persons with reduced physical, sensory or mental capabilities or lack of experience and knowledge if they have been given supervision or instruction concerning use of the appliance in a safe way and understand the hazards involved. Children shall not play with the appliance. Cleaning and user maintenance shall not be made by children without supervision.

Under abusive conditions, liquid may be ejected from the battery; avoid contact. If contact accidentally occurs, flush with water. If liquid contacts eyes, additionally seek medical help. Liquid ejected from the battery may cause irritation or burns.

**AIRPOD AND AIRPOD PRO WARNING: FOR EXTERNAL USE ONLY. AVOID SPRAYING IN EYES AND DISCONTINUE USE IF IRRITATION OCCURS.**

**CAUTION: DO NOT TOUCH POINTED PIN INSIDE AIRPOD TIP AREA. KEEP AWAY FROM SMALL CHILDREN.**

**DISPOSAL INFORMATION:** The crossed-out dustbin symbol indicates that this device should not be treated as household waste, but rather be brought to the appropriate collection point for recycling of electrical and electronic equipment. This device complies with Part 15 of the FCC Rules. Operation is subject to the following two conditions: (1) this device may not cause harmful interference, and (2) this device must accept any interference received, including interference that may cause undesired operation.

**WARRANTY:** At TEMPTU, Inc. ("TEMPTU") we believe very strongly in our product quality and in our quality assurance processes. Every unit is subjected to rigorous inspection and test procedures to ensure it meets our exacting specifications. Defective products are extremely rare. We do, however, examine returned products to help us identify product and/or process improvements. Temptu hereby warrants to the original purchaser of this product that the product shall be free from defects in materials and workmanship and shall be merchantable and fit for its intended purpose under normal personal consumer use and service for a period of one (1) year after the date of original purchase; provided, however, that such warranty shall not apply: (i) if the product has been modified, changed or altered; (ii) if the failure to perform is caused by the consumer, its agents or employees; (iii) the product used in a commercial (non-consumer) application; (iv) service has been performed on the product by any party other than a service provider expressly authorized by TEMPTU; (v) the product is damaged, worn or otherwise rendered inoperable through the action of the consumer. If, within one (1) year after the date of the original purchase, consumer notifies TEMPTU, in writing, that the product purchased by consumer has not performed in accordance with this warranty, and consumer returns the non-performing Product to TEMPTU, postage prepaid, TEMPTU shall, at no additional charge to consumer, and as consumer's sole and exclusive remedy, replace the non-performing product or refund the purchase price for the non-performing product. TEMPTU, Inc., reserves the right to use reconditioned/refurbished parts to repair or replace a product.

**WARRANTY LIMITATIONS:** EXCEPT AS SPECIFICALLY SET FORTH ABOVE, THERE ARE NO WARRANTIES OF ANY KIND, EXPRESS OR IMPLIED WITH RESPECT TO THE PRODUCT, AND TEMPTU SPECIFICALLY DISCLAIMS ANY SUCH WARRANTIES. THE IMPLIED WARRANTIES GRANTED HEREUNDER, INCLUDING THE IMPLIED WARRANTIES OF MERCHANTABILITY AND FITNESS FOR A PARTICULAR PURPOSE, ARE LIMITED TO THE FIRST ONE (1) YEAR IMMEDIATELY FOLLOWING THE ORIGINAL DATE OF PURCHASE. THE REPAIR, REPLACEMENT, OR REFUND AS PROVIDED UNDER THIS EXPRESS LIMITED WARRANTY IS THE EXCLUSIVE REMEDY OF THE CONSUMER AND IS PROVIDED IN LIEU OF ALL OTHER REMEDIES AND WARRANTIES, EXPRESS OR IMPLIED. IN NO EVENT SHALL TEMPTU BE LIABLE, WHETHER IN CONTRACT OR TORT (INCLUDING NEGLIGENCE), FOR DAMAGES IN EXCESS OF THE PURCHASE PRICE OF THE PRODUCT THAT IS FOUND TO BE DEFECTIVE, OR FOR ANY INDIRECT, INCIDENTAL, SPECIAL OR CONSEQUENTIAL DAMAGES OF ANY KIND OR LOSS TO THE FULL EXTENT THAT THESE DAMAGES MAY BE DISCLAIMED BY LAW.

Some states do not allow the limitation or exclusion of incidental or consequential damages, or limitation on the length of an implied warranty so the above limitations or exclusions may not apply to you. This limited warranty gives you specific legal rights that vary from state to state. To obtain warranty services or information please contact our customer service department. You will receive instructions on how to ship the product, at your expense, back to TEMPTU. To obtain service you must have registered online or by mail with TEMPTU or you must include a copy of your receipt and your name, phone number and mailing address inside your package.

# TEMPTU

At TEMPTU we are committed to offering our customers the best experience possible. Our Customer Care Team is made up of TEMPTU Airbrush experts who have the answers to all of your question. Please refer to the list below to contact us:



We are here to help! If you have questions, please email [customercare@temptu.com](mailto:customercare@temptu.com) and we will respond to you as quickly as we can.



We are now available via SMS! Text us any inquiries or concerns at [1-646-846-9466](tel:1-646-846-9466). Our Customer Care Team is available Mon - Fri 9:30-6:00pm EST

---

**Please visit [TEMPTU.com](https://www.temptu.com) and [TEMPTU.com/Pro](https://www.temptu.com/pro) for a monthly schedule of professional airbrush workshops and online education.**

---

Visit [TEMPTU.com](https://www.temptu.com) for makeup tutorials, tips and tricks to best achieve the results of a professional makeup session at home.

- 
- Correct imperfections with Airpod Foundation
  - Create a sun-kissed bronze to an all-over glow with Airpod Bronzer
  - Contour and define natural features with Airpod Highlighter
  - And many more advanced techniques!



@TEMPTU



@TEMPTUAIRBRUSHMAKEUP



@TEMPTU



@TEMPTUAIRBRUSHMAKEUP



@temptuofficial

TEMPTU.COM, TEMPTU.COM/PRO