



## HD 4/9 P 110V

Tough, highly portable professional cold-water pressure washer with upright or lie-flat operation. With 110V power supply for safe site use.



0-1 h



EASY!Force



1 x 360°

EASY!Lock



AUTO SHUTDOWN



1



2



3



4

### 1 Save energy and time: EASY!Force high-pressure guns and EASY!Lock quick-release locks.

- At last – work without getting tired: the EASY!Force high-pressure gun.
- EASY!Lock quick-release locks: durable and robust. And five times faster than screws.

### 2 First-class mobility

- The integrated carrying handle on the front of the machine enable easy loading and convenient transport.
- Compact design and low weight.

### 3 Flexibility

- Vertical and horizontal operation possible.
- Separate parking and transport position for the spray unit.

### 4 Quality

- The automatic pressure relief protects the components and extends the service life.
- High-quality brass cylinder head.



## HD 4/9 P 110V

- Automatic pressure relief
- For horizontal and vertical operation
- Save energy and time: EASY!Force high-pressure guns and EASY!Lock quick-release locks.

### Technical data

<b>Order no.</b>	1.520-965.0	
<b>EAN code</b>	4054278147161	
<b>Current type</b>	<b>Ph / V / Hz</b>	1 / 110 / 50
<b>Flow Rate</b>	<b>l/h</b>	390
<b>Water feed temperature</b>	<b>°C</b>	max. 60
<b>Operating pressure</b>	<b>bar / MPa</b>	90 / 9
<b>Max. Pressure</b>	<b>bar / MPa</b>	120 / 12
<b>number of simultaneous users</b>	1	
<b>Mobility</b>	hand held	
<b>Power rating</b>	<b>KW</b>	1,4
<b>Weight without accessories</b>	<b>kg</b>	15,9
<b>Dimensions (L × W × H)</b>	<b>mm</b>	351 × 312 × 904

### Equipment

<b>Trigger gun</b>	EASY!Force	
<b>High-pressure hose</b>	<b>m</b>	10 / DN 6, 250 bar
<b>Spray lance</b>	<b>mm</b>	840
<b>ANTI!Twist</b>	-	
<b>Pressure switch control</b>	■	
<b>Servo Control</b>	-	

■ Included in delivery.

# HD 4/9 P 110V 1.520-965.0

**KÄRCHER**

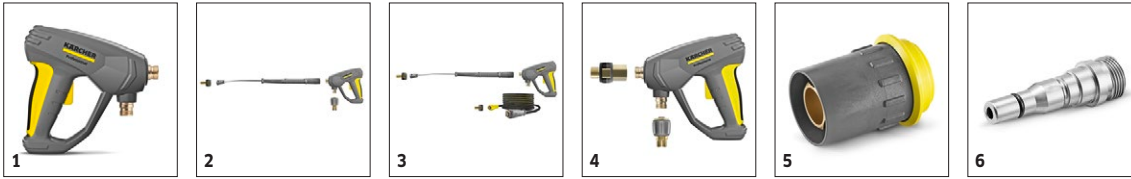

		Order no.	Flow Rate					Price	Description	
<b>Trigger guns</b>										
EASY!Force Advanced	1	4.118-005.0							Effortless, not energy-sapping: the EASY!Force high-pressure gun uses the recoil force of the high-pressure jet to reduce the holding force for the operator to zero.	■
Conversion kit 1 from high pressure hose	2	4.111-050.0							A conversion kit which enables secure connection from an M22 hose onto our innovative EASY!Force trigger gun. The kit includes the EASY!Force Trigger gun, adaptors and lance.	□
Conversion kit 2 from device	3	4.111-051.0							Provides all the parts required to utilise our EASY!Force technology even on our non-Easy!Force machines. Including adaptors, lance, Easy!Force trigger gun and hose.	□
Conversion kit 3 only EASY!Force	4	4.111-052.0							A conversion kit for the EASY!Force gun, which includes the correct adaptors to connect to the M22 style lance and hose.	□
<b>Quick connect</b>										
Quick-fitting pipe union coupler trapezo	5	2.115-000.0							For fast changes between different spray lances/accessories. Perfect for Kärcher spray unit, suitable for trigger gun/spray lance interface. With M 22 x 1.5 internal thread.	□
Quick-fitting pipe union plug nipple tra	6	2.115-001.0							Hardened stainless steel male coupling for quick coupling 2.115-000. With M 22 x 1.5 external thread.	□

■ Included in delivery. □ Available accessories.

# HD 4/9 P 110V 1.520-965.0

**KÄRCHER**

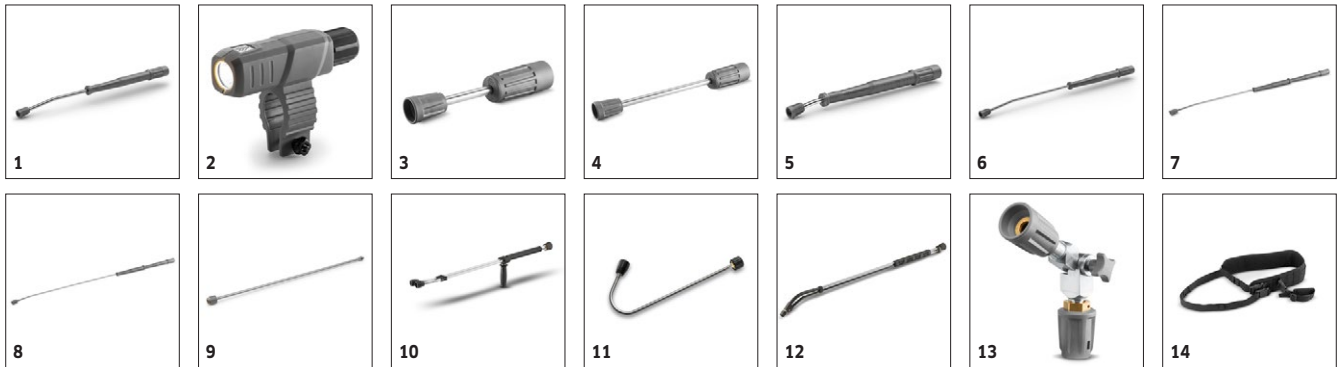

		Order no.	Max. working pressure	Length		Price	Description	
<b>Rotating spray lances</b>								
Spray lance	1	4.112-006.0	300 bar	840 mm			850 mm stainless steel lance (manual coupling) with ergonomic handle for ease of use and protection. Rotatable 360° under pressure.	■
LED nozzle light	2	2.680-002.0					LED work light for assembly on EASY!Force spray lances, providing a clear view in poor lighting conditions ensuring controlled cleaning results.	□
Spray lance	3	4.112-027.0	300 bar	250 mm			250 mm stainless steel lance (manual coupling) with ergonomic handle for ease of use and protection. Rotatable 360° under pressure.	□
	4	4.112-024.0	300 bar	400 mm			400 mm stainless steel lance (manual coupling) with ergonomic handle for ease of use and protection. Rotatable 360° under pressure.	□
	5	4.112-007.0	300 bar	600 mm			600 mm stainless steel lance (manual coupling) with ergonomic handle for ease of use and protection. Rotatable 360° under pressure.	□
	6	4.112-000.0	300 bar	1050 mm			1050 mm stainless steel lance (manual coupling) with ergonomic handle for ease of use and protection. Rotatable 360° under pressure.	□
	7	4.112-018.0	300 bar	1550 mm			1550 mm stainless steel lance (manual coupling) with ergonomic handle for ease of use and protection. Rotatable 360° under pressure.	□
	8	4.112-021.0	300 bar	2050 mm			2050 mm stainless steel lance (manual coupling) with ergonomic handle for ease of use and protection. Rotatable 360° under pressure.	□
Spray lance extender	9	4.112-048.0	300 bar	1000 mm			Spray lance extension with EASY!Lock connection. Length 1000 mm.	□
<b>Double lance</b>								
Double lance	10	2.112-016.0	310 bar	960 mm			960 mm double lance for variable pressure adjustment on handle at full water flow rate. Suitable for agricultural use ( e.g. stable cleaning).	□
<b>Angular spray lance</b>								
WC and gutter lance	11	4.112-029.0					Stainless steel lance WC and gutter with nozzle insert. Specially shaped for effective and hygienic cleaning of gutters and toilets.	□
<b>Flexible spray lance</b>								
Flexible lance	12	4.112-035.0	210 bar	1050 mm			1050 mm flexible lance with variable bend from 20° to 140°, ideal for cleaning difficult to reach areas, e.g. gutters.	□
High pressure articulated joint	13	4.112-057.0	300 bar				For hard-to-reach areas: High-pressure articulated joint with infinite angle adjustment up to 120°. Simply attach directly to the spray lance of the pressure washer.	□
<b>Inaktiv</b>								
Restraint belt for telescopic jet pipe	14	6.373-987.0					Convenient strap for relief when working with the telescopic spray lance (6.394-690). The burden is optimally distributed on the body and longer periods of use are possible.	□
<b>Gutter cleaner</b>								
Gutter cleaning lance	15	2.112-015.0		960 mm			The lance is suited for cleaning of gutter systems. Because of the shape of the lance and the special nozzle the gutter can be cleaned without removing the cover plates.	□
<b>Undercarriage spray lance</b>								
Underbody lance	16	4.112-032.0		700 mm			Stainless steel lance for effective and easy underbody and wheel arch cleaning. Without high-pressure nozzle.	□

■ Included in delivery. □ Available accessories.

# HD 4/9 P 110V 1.520-965.0



		Order no.	Max. working pressure	Length		Price	Description	
<b>Additional handle</b>								
Additional handle for EASY!Lock spray lances	17	4.321-380.0					Comfortable in every situation - the additional handle is easy to attach to the spray lance of our new EASY!Lock generation and makes work easier by allowing you to adjust your posture to suit the particular task.	<input type="checkbox"/>
<b>PowerControl spray lance</b>								
PowerControl spray lance 034	18	4.112-045.0					The cleaning performance can be adapted to the respective task in an instant. The low pressure mode for the application of the cleaning agent and the adjustment of the jet level round off the product.	<input type="checkbox"/>

■ Included in delivery. □ Available accessories.

# HD 4/9 P 110V 1.520-965.0



1-4

		Order no.	Nozzle size				Price	Description	
<b>Power nozzle spray angle 15°</b>									
Power Nozzle	1	2.113-062.0	30					Flat stream for stubborn dirt.	■
<b>HP nozzle spray angle 0°</b>									
Power Nozzle	2	2.113-001.0	40					High-pressure nozzle with powerful jet for extremely stubborn dirt.	□
<b>Power nozzle spray angle 25°</b>									
Power Nozzle	3	2.113-063.0	33					Fan jet nozzle for large-area coverage and stubborn dirt and stains.	□
<b>Power nozzle spray angle 40°</b>									
Power Nozzle	4	2.113-003.0	40					Power nozzle with a 40° spray angle and fan jet, suitable for large areas and sensitive surfaces.	□

■ Included in delivery. □ Available accessories.

# HD 4/9 P 110V 1.520-965.0

**KÄRCHER**



		Order no.	ID	Max. working pressure	Length	Price	Description	
<b>Standard with unions on both sides</b>								
High-pressure hose	1	6.110-034.0	DN 6	250 bar	10 m		10 m high-pressure hose (M 22 x 1.5) with kink protection. With patented rotating AVS trigger gun connector and manual coupling. Further data: DN 6/155°C/250 bar.	<input checked="" type="checkbox"/>
	2	6.110-035.0	DN 6	250 bar	10 m			<input type="checkbox"/>
	3	6.110-056.0	DN 6	300 bar	10 m		With patented AVS connection in the trigger gun (pivot-mounted) and hand screw union. M 22 x 1.5 with anti-kink protection. NW 6/155°C/300 bar	<input type="checkbox"/>
	4	6.110-031.0	DN 8	315 bar	10 m		10 m high-pressure hose (M 22 x 1.5) with kink protection. With patented rotating AVS trigger gun connector and manual coupling. Further data: DN 8/155°C/315 bar.	<input type="checkbox"/>
	5	6.110-030.0	DN 8	315 bar	15 m		15 m high-pressure hose (M 22 x 1.5) with kink protection. With patented rotating AVS trigger gun connector and manual coupling. Further data: DN 8/155°C/315 bar.	<input type="checkbox"/>
	6	6.110-032.0	DN 8	315 bar	20 m		20 m high-pressure hose (M 22 x 1.5) with kink protection. With patented rotating AVS trigger gun connector and manual coupling. Further data: DN 8/155°C/315 bar.	<input type="checkbox"/>
	7	6.110-014.0	DN 8	315 bar	30 m		With rotary coupling, 2 x M 22 x 1.5	<input type="checkbox"/>
	8	6.110-042.0	DN 10	220 bar	15 m		15 m high-pressure hose (M 22 x 1.5) with kink protection and threaded couplings at both ends. Further data: DN 10/155°C/220 bar.	<input type="checkbox"/>
	9	6.110-043.0	DN 10	220 bar	20 m		with union on both sides, M 22 x 1.5 with anti-kink protection. NW 10/155°C/220 bar	<input type="checkbox"/>
	10	6.110-044.0	DN 10	220 bar	25 m			<input type="checkbox"/>
	11	6.110-045.0	DN 10	220 bar	40 m			<input type="checkbox"/>
	12	6.110-059.0	DN 12	210 bar	15 m		High-pressure hose for water volumes greater than 1,800 l/h. With union on both sides. 2x M 22 x 1.5 with anti-kink protection.	<input type="checkbox"/>
	13	6.110-060.0	DN 12	210 bar	40 m			<input type="checkbox"/>
	14	6.110-041.0	DN 10	220 bar	10 m			<input type="checkbox"/>
<b>Longlife 400 with unions on both sides</b>								
High-pressure hose Longlife	15	6.110-024.0	DN 8	400 bar	1,5 m		1,5 m high-pressure hose (DN 8, M 22 x 1.5) with kink protection and connectors at both ends. For connecting to hose reels with appropriate connector (M 22 x 1.5).	<input type="checkbox"/>
	16	6.110-069.0	DN 8	400 bar	1,5 m		High-pressure hose (ID 8) with double steel reinforcement. 1,5 m long, suitable for up to 400 bar pressure. Connectors: M 22 x 1.5, quick and convenient EASY!Lock hand screw connection.	<input type="checkbox"/>
	17	6.110-038.0	DN 8	400 bar	10 m		Durable, 10 m long high-pressure hose (ID 8) with double steel reinforcement and EASY!Lock hand screw connection at both ends and ANTI!Twist. Approved for 400 bar pressure.	<input type="checkbox"/>
	18	6.110-023.0	DN 8	400 bar	30 m		With rotary coupling, 2 x M 22 x 1.5	<input type="checkbox"/>
	19	6.110-027.0	DN 8	400 bar	20 m		with rotary coupling, 2 x M 22 x 1.5	<input type="checkbox"/>
	20	6.110-029.0	DN 8	400 bar	15 m		With rotary coupling, 2 x M 22 x 1.5	<input type="checkbox"/>
<b>Food industry version with unions on both sides</b>								
High-pressure hose food grade	21	6.110-063.0	DN 6	250 bar	15 m		15 m high-pressure hose (DN 6) with patented (rotating) AVS trigger gun connector. Non-discolouring outer layer for use in the food industry. DN 6/155°C/250 bar.	<input type="checkbox"/>
	22	6.110-051.0	DN 8	250 bar	10 m		10 m high-pressure hose (DN 8) with patented (rotating) AVS trigger gun connector. Non-discolouring outer layer for use in the food industry. M 22 x 1.5 with anti-kink sleeve.	<input type="checkbox"/>
	23	6.110-052.0	DN 8	250 bar	20 m		20 m high-pressure hose (DN 8) with swivel coupling. Non-discolouring outer layer for use in the food industry. Connectors at both ends, M 22 x 1.5, with kink protection. NW 8/155°C/250 bar.	<input type="checkbox"/>

■ Included in delivery. □ Available accessories.

# HD 4/9 P 110V 1.520-965.0



		Order no.	ID	Max. working pressure	Length	Price	Description	
<b>Longlife food industry version with unions on both sides</b>								
High-pressure hose food grade Longlife	24	6.110-053.0	DN 8	400 bar	10 m		Longlife HP hose for use in the food industry. Außendecke## animal-grease-resistant, non-colour-bleeding material. With rotary coupling, 2 x M 22 x 1,5	<input type="checkbox"/>
	25	6.110-054.0	DN 8	400 bar	20 m		Longlife HP hose for use in the food industry. Außendecke## animal-grease-resistant, non-colour-bleeding material. With patented AVS connection in the pistol (pivot mounted)	<input type="checkbox"/>

■ Included in delivery.    □ Available accessories.



# HD 4/9 P 110V 1.520-965.0

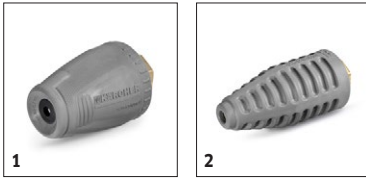

		Order no.	Max. working pressure	Nozzle size		Price	Description	
<b>Dirt Blaster, small</b>								
Dirt Blaster Nozzle	1	4.114-019.0	180 bar	35			The new performance dirt blaster (nozzle size 035) with rotating point jet makes a big difference: up to 50% higher cleaning and area performance than its predecessor.	<input type="checkbox"/>
<b>Dirt blaster, large</b>								
Dirt Blaster Nozzle	2	4.114-040.0	300 bar	35			The dirt blaster with rotating pencil jet offers 10 times better cleaning performance. Ceramic nozzle and bearing ring for a long service life. Further data: Max. 300 bar, 30 MPa, 85°C.	<input type="checkbox"/>

■ Included in delivery. □ Available accessories.

# HD 4/9 P 110V 1.520-965.0

**KÄRCHER**



		Order no.					Price	Description	
<b>Nozzle union</b>									
Nozzle screws	1	4.112-011.0						Nozzle screws with protectors for high-pressure and power nozzles	<input type="checkbox"/>
<b>HP detergent injector</b>									
Detergent injector for high and low pressure (without nozzles)	2	4.637-032.0						Detergent injector for independent high and low pressure dosage. Maximum dosage about 15%.	<input type="checkbox"/>
Detergent injector for high pressure	3	4.637-033.0						Cleaning agent dosage at high pressure 3 - 5 %	<input type="checkbox"/>
<b>Machine-specific nozzle kit with order no. 3.637-170</b>									
Nozzle insert trapezoidal thread HD-GER.	4	4.769-005.0						For HD 500 - 700 l/h. Consists of nozzle insert + HP power nozzle + union	<input type="checkbox"/>
<b>Nozzle insert with order no. 3.637-001</b>									
Nozzle insert for Order No. 3.637-001, high-pressure for machines up to 1100 l/h.	5	4.769-003.0						Nozzle insert for detergent injector 3.637-001 for high-pressure detergent application. For high-pressure cleaners with a water flow rate up to 1100 l/h.	<input type="checkbox"/>
Low pressure for units rated up to 1100 l/h	6	4.769-001.0						For low pressure with machines up to 1.100 l/h	<input type="checkbox"/>
<b>Rotary coupling</b>									
Rotary coupling	7	4.111-021.0						Kärcher rotary coupling prevents twisting and kinking of high-pressure hoses for ease of use. Connector Easy!Lock. With grip protection.	<input type="checkbox"/>
<b>Connector</b>									
Nozzle connector/screw connector	8	4.111-022.0						Nozzle connector/screw connector for connecting high-pressure nozzles and accessories to the high-pressure trigger gun (with nozzle connector). Connectors: 1x M 22 x 1.5 and 1x M 18 x 1.5.	<input type="checkbox"/>
Y distributor	9	4.111-024.0						Offers the option to connect two spray units to the machine. Installation on the high pressure outlet.	<input type="checkbox"/>
Short spray unit	10	4.111-038.0						For attaching high-pressure nozzles and accessory parts to HP trigger gun (with nozzle screws). Not compatible with triple nozzles.	<input type="checkbox"/>
<b>Adapter EASY!Lock</b>									
Adapter 1 M22AG-TR22AG	11	4.111-029.0						Adapter 1 to connect the old hose with the new hose	<input type="checkbox"/>
Adapter 2 M22IG-TR22AG	12	4.111-030.0						Adapter 2 to connect the old device with the new hose and the old gun with the new hose	<input type="checkbox"/>
Adapter 3 M22IG-TR22AG	13	4.111-031.0						Adapter 3 to connect the old gun with the new spray lance and new servo regulator	<input type="checkbox"/>
Adapter M22 - Swivel	14	4.111-032.0						M22 x 1,5female and swivel connection. For extension of high-pressure hoses with AVS connection or for usage of the telescopic lance with a high-pressure hose with AVS connection.	<input type="checkbox"/>
Adapter 5 TR22IG-M22AG	15	4.111-033.0						Adapter 5 to connect the new gun with the old spray lance and new servo regulator with the old spray lance	<input type="checkbox"/>
Adapter 6 TR22IG-M22AG	16	4.111-034.0						Adapter 6 to connect the new device with the old hose and the old hose with the new gun	<input type="checkbox"/>
Adapter 7 M18IG-TR20AG	17	4.111-035.0						Adapter 7 to connect the old spray lance with the new nozzle	<input type="checkbox"/>
Adapter 8 TR20IG-M18AG	18	4.111-036.0						Adapter 8 to connect the new spray lance with the old nozzle	<input type="checkbox"/>
Coupler -2xM22x1,5	19	4.111-037.0						Brass double connector for connecting and extending high-pressure hoses. With rubber protection. Connector: 2x M 22 x 1.5 m.	<input type="checkbox"/>

■ Included in delivery. □ Available accessories.

# HD 4/9 P 110V 1.520-965.0



		<b>Order no.</b>					<b>Price</b>	<b>Description</b>	
ADAPTER for replacement TR22IG-M22AG Er	20	4.111-046.0						Rotatable adapter for connecting EASY!Force high-pressure gun and high-pressure hoses with M 22x1.5 connection	<input type="checkbox"/>

■ Included in delivery.    □ Available accessories.

# HD 4/9 P 110V 1.520-965.0

**KÄRCHER**



		Order no.	Max. working pressure	Nozzle size	Diame-ter	Price	Description	
<b>Pipe cleaning hose, ID 6</b>								
Hose assembly TR pipe cleaning DN6 14MPa	1	6.110-048.0	140 bar				10 m flexible high-pressure hose (DN 6) for cleaning pipes (threaded connection for R 1/8 nozzle).	<input type="checkbox"/>
Pipe cleaning hose	2	6.110-049.0	140 bar				20 m flexible high-pressure hose (DN 6) for cleaning pipes (threaded connection for R 1/8 nozzle).	<input type="checkbox"/>
Pipe cleaning hose, DN 6, 30 m	3	6.110-050.0	140 bar				30 m flexible high-pressure hose (DN 6) for cleaning pipes (threaded connection for R 1/8 nozzle).	<input type="checkbox"/>
<b>Pipe cleaning nozzle</b>								
Dirt blaster pipe cleaning D21/040	4	4.765-001.0		40	21 mm		The forward-tilted rotating pencil jet removes the most stubborn dirt. The three backwards-tilted jets ensure the necessary forward movement, as well as convenient handling.	<input type="checkbox"/>
Dirt blaster pipe cleaning D30/040	5	4.765-004.0		40	30 mm			<input type="checkbox"/>
Pipe cleaning nozzle	6	5.763-015.0		55	16 mm		16 mm pipe cleaning nozzle with internal thread. Various jet directions for environmentally-friendly cleaning of blocked drains and pipes.	<input type="checkbox"/>
	7	5.763-020.0		65	16 mm			<input type="checkbox"/>
	8	5.763-017.0		50	30 mm			30 mm pipe cleaning nozzle with internal thread. Various jet directions for environmentally-friendly cleaning of blocked drains and pipes.
Rotating pipe cleaning nozzle	9	6.415-428.0		50	16 mm		Rotating pipe cleaning nozzle with internal thread and four rotating jets for environmentally-friendly cleaning of blocked drains and pipes.	<input type="checkbox"/>
<b>Drum and tank cleaning</b>								
Add-on kit mud sucker	10	2.641-798.0						<input type="checkbox"/>

■ Included in delivery. □ Available accessories.

# HD 4/9 P 110V 1.520-965.0

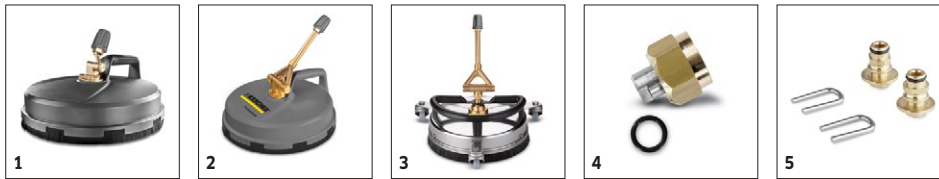

		Order no.	Flow Rate	Nozzle size	Diame- ter	Price	Description	
<b>Hard surface cleaner FR Classic</b>								
FR Classic surface cleaner	1	2.111-016.0			300 mm		The ideal entry-level model in the Kärcher surface cleaner range for cleaning surfaces indoors and outdoors. With splash guard and up to 150 bar working pressure.	<input type="checkbox"/>
<b>Hard surface cleaner FR 30</b>								
FR 30 Surface Cleaner	2	2.111-011.0			300 mm		Up to 10 times greater area coverage compared with the conventional high pressure jet.	<input type="checkbox"/>
<b>Hard surface cleaner FR 30 ME</b>								
FR 30 ME surface cleaner	3	2.111-013.0			300 mm		Hot water resistant stainless steel surface cleaner with double ceramic bearings, non-marking swivel castors and suction hose connection. Ideal for indoor cleaning, e.g. food industry.	<input type="checkbox"/>
<b>Machine-specific nozzle kit for FR</b>								
Nozzle kit for FR	4	2.640-482.0	450 - 500 l/h				Nozzle kit includes power nozzles and unions. For Kärcher surface cleaners (450 to 500 l/h).	<input type="checkbox"/>
<b>Machine-specific nozzle kits for FR Classic</b>								
Nozzle kit for FR Classic	5	2.885-312.0		40			Nozzle kit specifically for FR Classic surface cleaner.	<input type="checkbox"/>

■ Included in delivery. □ Available accessories.

# HD 4/9 P 110V 1.520-965.0

**KÄRCHER**



		Order no.	Flow Rate				Price	Description		
<b>Cup foam lance</b>										
Cup foam lance Basic 1	1	4.112-053.0	350 - 600 l/h					For high-pressure cleaners with a flow rate of 350-600 l/h: new, robust and very high-quality foam cup lance with outstanding foam quality while consuming half as much cleaning agent.	<input type="checkbox"/>	
1-litre cleaning agent container for cup foam lance basic	2	5.071-414.0							<input type="checkbox"/>	
Cup foam lance Advanced	3	2.112-018.0						Short, handy foam lance with adjustable spray angle with 1 litre detergent tank. Ideal for cleaning cars due to its compact design.	<input type="checkbox"/>	
1-litre cleaning agent container for cup foam lance advanced	4	6.414-050.0						Additional 1-litre cleaning agent container for quick replacement of the cleaning agent (for foam lance 2.112-017.0 and 2.112-018.0).	<input type="checkbox"/>	
Cup foam lance Advanced 1	5	4.112-063.0	400 - 600 l/h						<input type="checkbox"/>	
Cup foam lance DUO Advanced 1	6	4.112-067.0	400 - 600 l/h						<input type="checkbox"/>	
<b>Inno Foam Set</b>										
Inno foam kit with detergent injector	7	2.112-000.0						High-pressure foam system with double lance (foam nozzle and high-pressure jet for rinsing). For use with mobile and stationary high-pressure and HDS pressure cleaners for cleaning or disinfection.	<input type="checkbox"/>	
<b>Easy Foam Set</b>										
Easy Foam Set with RM injector	8	2.112-010.0						HP foam system for use with HD/HDS units for cleaning and disinfecting. Foam nozzle for connection to lance and HP chemical injector with precision 0-5% metering valve. The machine specific nozzle kit has to be ordered separately.	<input type="checkbox"/>	
<b>Nozzle kits for Inno/Easy Foam Set</b>										
Nozzle kit 055 z. Inno/Easy Set 500 - 600 l/h	9	2.111-009.0	500 - 600 l/h					Optimal adaptation to different machine outputs for economic use.	<input type="checkbox"/>	
<b>Foam nozzle mounting kit</b>										
Foam nozzle kit	10	2.112-013.0						Foaming agent kit. The foam nozzle is ideal for use in sanitary areas and the food industry and wherever long application times are necessary.	<input type="checkbox"/>	

■ Included in delivery. □ Available accessories.

# HD 4/9 P 110V 1.520-965.0



	Order no.	Length				Price	Description	
<b>Automatic, self-winding hose reels</b>								
Automatic plastic hose reel incl. high-pressure hose	1	2.639-257.0	15 m					<input type="checkbox"/>
Automatic hose reel, powder-coated steel / plastic	2	6.392-074.0	20 m				Automatic hose reel for 20 m high-pressure hose. The console is made from powder-coated steel, the drum is made from plastic.	<input type="checkbox"/>
Automatic stainless steel / synthetic material hose drum	3	6.392-083.0	20 m				Automatic hose reel for 20 m high-pressure hose. The console consists of stainless steel, the drum is made from plastic.	<input type="checkbox"/>
Automatic hose reel, coated	4	6.392-106.0	20 m				Automatic hose reel of durable plastic. Painted steel bracket. Suitable for 20 m high-pressure hose.	<input type="checkbox"/>
Hose reel, automatic, basalt grey-coated	5	6.392-105.0	20 m				Automatic hose reels provide the highest level of safety and convenience for winding and unwinding HP hoses.	<input type="checkbox"/>
Automatic hose reel, stainless steel, includes swivel holder	6	6.392-076.0	20 m				Automatic stainless steel hose reel. With swivel holder. Suitable for 20 m high-pressure hose.	<input type="checkbox"/>
Automatic stainless steel hose reel	7	6.392-122.0	20 m				High-grade, automatic steel hose reel. Especially suitable for use in the food industry. The material and finish provide for a corrosion-resistant, watertight capsuled sprong drive. Connection for HP hoses with nipple.	<input type="checkbox"/>
	8	6.392-442.0	40 m				Automatic hose reels provide the highest level of safety and convenience for winding and unwinding HP hoses. Compatible high-pressure hose, e.g. order no. 6.110-076.0 (ID 8, 40 m, 400 bar, 1x hose reel connection attachment kit).	<input type="checkbox"/>
Powder-coated swivel holder	9	2.639-931.0					Swivel holder for automatic hose reel wall mounting. For maximum action radius and flexibility of high-pressure hose. Rotatable 120°. Galvanised steel.	<input type="checkbox"/>
Stainless steel swivel holder	10	2.641-867.0					Swivelling wall bracket made of high-grade steel (for 2.641-866). This makes maximum flexibility and convenience possible when working with the HP hose.	<input type="checkbox"/>

■ Included in delivery. □ Available accessories.

# HD 4/9 P 110V 1.520-965.0

		Order no.	Flow Rate	Length of the product	Length	Price	De- scripti- on	
<b>Telescopic</b>								

■ Included in delivery. □ Available accessories.



# HD 4/9 P 110V 1.520-965.0

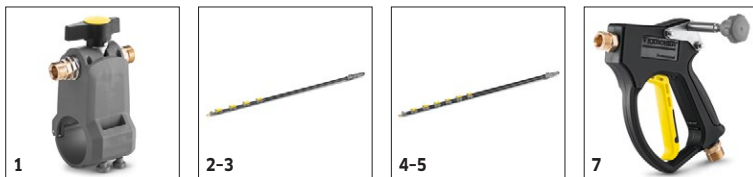

# HD 4/9 P 110V 1.520-965.0



		Order no.	Nozzle size				Price	Description	
<b>Wet blasting attachment (without nozzle)</b>									
Wet blasting attachment with flow control (without nozzles)	1	4.115-000.0						Paint, rust and scale removal made easy: Kärcher wet blasting attachment with flow control for adding blasting abrasive to the high-pressure jet.	<input type="checkbox"/>
Wet blasting attachment without flow control (nozzles not included)	2	4.115-006.0						Paint, rust and scale removal made easy: Kärcher wet blasting attachment with flow control for adding blasting abrasive to the high-pressure jet. Without flow control.	<input type="checkbox"/>
<b>Nozzle pack for wet blasting attachment</b>									
Nozzle pack TR wet jet set 0035	3	2.112-021.0	35					Nozzle kit with wet blasting nozzle and nozzle insert (type specific). For optimal Kärcher wet blasting attachment performance. Only in combination with wet blasting attachment 4.115-000.0   4.115-006.0.	<input type="checkbox"/>
<b>Boron carbide nozzle</b>									
Boron carbide nozzle, for machines as of 1000 l/h	4	6.415-084.0	6 mm					In addition to nozzle packs. Very wear-resistant nozzle with boron carbide chuck for continuous-duty operation.	<input type="checkbox"/>

■ Included in delivery. □ Available accessories.



# HD 4/9 P 110V 1.520-965.0



		Order no.	Flow Rate				Price	Description	
<b>Push-on washing brush</b>									
Push-on wash brush, M 18 x 1.5	1	4.113-001.0						Push-on wash brush for universal use. Simply push on to lance. Connector: M 18 x 1.6.	<input type="checkbox"/>
<b>Rotating washing brush</b>									
Rotating wash brush for < 800 l/h machines, nylon bristles	2	4.113-004.0	500 - 800 l/h					The rotating wash brush gently removes fine dust and traffic film from all surfaces. Temperature resistant up to 60°C. (M 18 x 1.5, replaceable brush insert).	<input type="checkbox"/>
Rotating wash brush for < 800 l/h machines, natural bristles	3	4.113-003.0	500 - 800 l/h					Driven by water stream. Gently removes fine dust and traffic film from any surface. Temperature resistant up to 60°C, M 18 x 1.5 (replaceable brush insert).	<input type="checkbox"/>

■ Included in delivery. □ Available accessories.