

Waterproof Multicolor Strip Light

User Manual

01 / WARNING

PLEASE READ AND UNDERSTAND THIS ENTIRE MANUAL BEFORE INSTALLATION.

WARNING: Do not pierce or damage the rope light at any time during mounting.

WARNING. When using outdoor use portable lighting products, basic safety precautions should always be followed to reduce the risk of fire, electric shock, and personal injury, including the following:

READ AND FOLLOW ALL SAFETY INSTRUCTIONS

1. Ground Fault Circuit Interrupter (GFCI) protection should be provided on the circuits or outlet to be used for the outdoor use flexible lighting product. Receptacles are available having built in GFCI protection for this measure of safety.
2. Use only outdoor extension cords, such as type SW, SOW, STW, STOW, SJW, SJOW, SJTW OR SJTOW. This designation is marked on the wire of the extension cord.
3. All units must be unplugged before adding additional segment.
4. Use the power cord only supplied with the product.
5. Do not cover this product as the covering may cause the flexible light to overheat and melt or ignite.
6. The rated voltage for this product is 120VAC, 60Hz, 1.38A. ONLY use on 120V AC.
7. Ensure all connections and the end cap on the last segment are tightly secured to preclude the entry of water.
8. Do not operate with the flexible light tightly coiled.
9. Do not puncture, cut, shorten, or splice the flexible lighting.
10. Do not route the cord or flexible light cable through walls, doors, windows or any like part of the building structure.
11. Do not use if there is any damage to the light or cord insulation. Inspect periodically.
12. Do not submerge flexible light in liquids, or use the product in the vicinity of standing water or other liquids.
13. Secure this flexible light using only the hangers or clips provided. Do not secure this product or its cord with staples, nails, or like means that may damage the insulation.
14. Do not subject flexible lighting to continuous flexing.
15. Do not Exceed The Maximum Length in Feet Permitted By The Marking. The Max extension length for this strip is 100ft.
16. Do not mount or place near gas or electrical heaters, fireplaces, candles or similar sources of heat.
17. Do not install the flexible lighting within 16 feet of a pool or spa.
18. This product has a polarized plug (one blade is wider than the other) as a feature to reduce the risk of electric shock. This plug will fit in a polarized outlet only one way. If the plug does not fit fully in the outlet, reverse the plug. If it still does not fit, contact a qualified electrician. Never use with an extension cord unless plug can be fully inserted. Do not alter the plug.
19. Avoid contact with flammable products.
20. This is an electrical device - NOT A TOY! Keep out of reach of children.
21. Please carefully remove the plastic film.
22. Please gently unravel the rope light from the roller circle.
23. DO NOT stretch or twist the LED rope light as this will damage it.
24. DO NOT power the LED rope light while it is on the roller as it will overheat.
25. DO NOT use the light in water.
26. This is a rope light, not a cable, so treat it like one. DO NOT puncture, cut or shorten the light.
27. Wash your hands after use. Handling this product may expose you to chemicals.
28. This product can expose you to chemicals including Lead, which is known to the State of California to cause cancer. For more information go to www.P65Warnings.ca.gov
29. Please align the pins correctly when connecting the strip lights and tighten the waterproof wire nuts before use.
30. LED tapes are bendable. Minimum bend radius is 1.57inch.

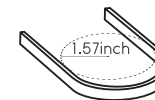

SAVE THESE INSTRUCTIONS

02 / PACKAGE CONTENT

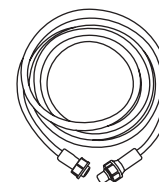

A. Waterproof multicolor strip light × 1

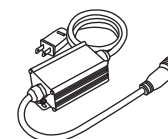

B. Power cord × 1

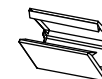

C. Plastic clips × 45



D. Mounting screws × 90



E. Waterproof plug × 1
(Attached at the end of the light strip)



F. 24-key remote controller × 1

03 / INSTALLATION

CAUTION: These products may represent a possible shock or fire hazard if improperly installed or attached in any way. Products should be installed in accordance with these instructions, current electrical codes and/or the current National Electric Code (NEC). Only use this strip light with the plug-in power cord that is supplied with the strip light. Any other power cord or feed may damage the strip light.

LIGHT STRIP MOUNTING

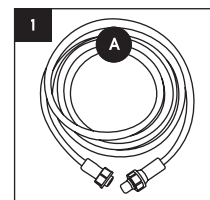

1. Carefully remove the Strip Light (A) from the package and uncoil it. Be careful not to cut it.

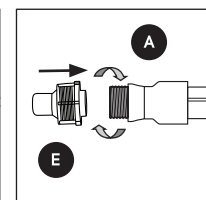
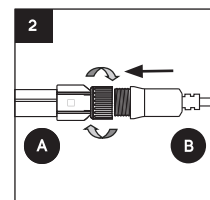

2. Ensure that the Power Cord (B) and the Waterproof Plug (E) are securely fastened to both ends of the Strip Light (A) in order to prevent water from entering.

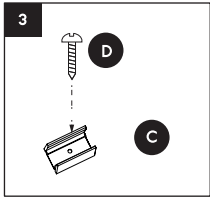

3. Attach Plastic Clips (C) with Mounting Screws (D) to the wall's surface.

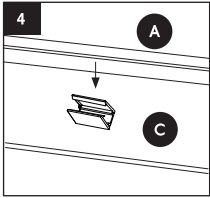

4. Snap the Strip Light (A) into the Plastic Clips (C). Installation is now finished.

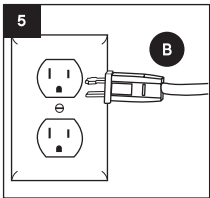

5. Plug the Power Cord (B) into the outlet and turn the light strip on.
 Note: If installed outdoors, please use a Ground Fault Circuit Interrupting (GFCI) outlet for safe operation.

EXTENSION MOUNTING

NOTE: The max extension length for this strip light is 100ft. Do not exceed 100ft when linking extension segments together.

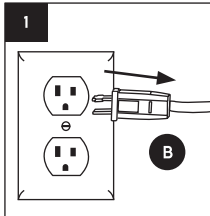

1. Ensure that all Strip Lights are unplugged before adding any additional Strip Lights to the series.

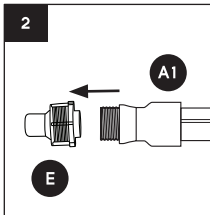

2. Remove the Waterproof Plug (E) from the end of the Strip Light (A1).

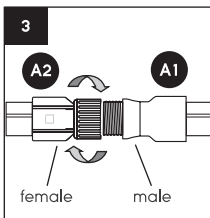

3. Connect the end of the Strip Light (A1) to the head of the other Strip Light (A2). Ensure that the connection is secured tightly to prevent water from entering.

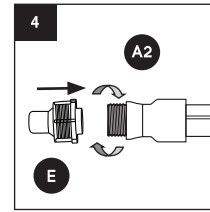

4. Ensure that the Waterproof Plug (E) is securely fastened to the end of the last Strip Light in order to prevent water from entering.

REPLACE THE FUSE

NOTE: Disconnect power before replacing the fuses. Grasp plug and remove from the receptacle or other outlet devices. Do not unplug by pulling on the cord.

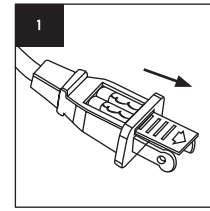

1. Open the fuse cover by sliding it over the attached plug towards the blades.

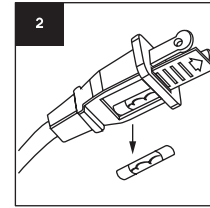

2. One spare fuse is in the plug. Turn the fuse holder over to remove the spare fuse.

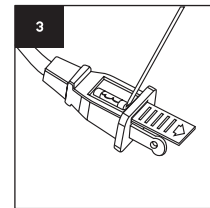

3. Turn the fuse holder back over. Gently pry the end of the fuse nearest the plug with a small blade screwdriver (not included) to remove the old fuse.

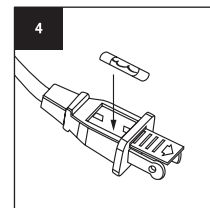

4. Replace the old fuse with the spare fuse.

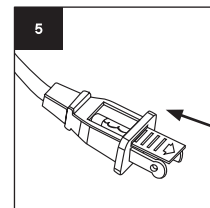

5. Slide the fuse cover to the original position to close.

04 / HOW TO USE

Use ON and OFF buttons for power control and refer to the chart below for button functions and mode options. There are 24 keys on the control panel for this RF remote controller.

RF			
ON	Static RED		Static ORANGE
OFF	Static GREEN		Static YELLOW
SPEED+	Static BLUE		Static CYAN
SPEED-	Static WHITE		Static PURPLE
Brightness 100%	Brightness 80%	Brightness 50%	Brightness 30%
3 colors jump	3 colors fade	1 color shines	START/SET
7 colors jump	7 colors fade	3 colors shine	PAUSE

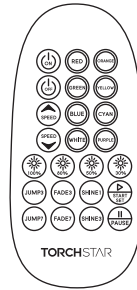

NOTE:

- When it is in "Static" mode, Brightness 100% / Brightness 80% / Brightness 50% / Brightness 30% mean different brightness of light modes.
- When it is in "Dynamic" mode, "SPEED+" means increasing the speed, and "SPEED-" means decreasing the speed.
- It can memorize the last setting before power off.
- 3 colors jump: The strip light shines in 3 RGB colors (red, green & blue). 7 colors jump: The strip light shines in 7 colors.
- 3 colors fade: 3 RGB colors (red, green & blue) will be slowly changed, from one color shade to another, without flashing. 7 colors fade: 7 colors will be slowly changed, from one color shade to another, without flashing.
- 1 color shines: The strip light flashes in a specified color.
- If there are several RF transmitters and receivers in a small range, they may affect each other because 433M RF remote control's distance is long. So a specific identification code has been added to this new version remote control to prevent the interference.

PAIR & UNPAIR OPERATIONS

Each strip light has been paired with a remote control before leaving the factory, so you can use the strip light directly without any extra operation. But you may need to pair the remote control again when it cannot control your strip light correctly. **NOTE:** Unpair the remote control before pair it again.

HOW TO UNPAIR THE RF REMOTE CONTROL

NOTE: The valid time of unpairing is 1 minute. Please complete unpairing the RF remote control in 1 minute.

- Turn off the strip light if it's on and disconnect the strip light from the power supply. Then wait at least 10 seconds before turning on the strip light.
- Turn the strip light on. Put the remote control close to the controller in the power cord. Hold the "PAUSE" button on the remote control for 3-5 seconds. If the strip light flashes in blue and purple, then the unpairing is successful. The unpairing is now complete. Other remote controls can also control this strip light now.

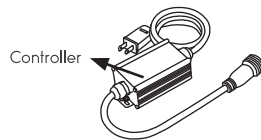

HOW TO PAIR THE RF REMOTE CONTROL

NOTE: The valid time of pairing is 1 minute. Please complete pairing the RF remote control in 1 minute.

- Turn off the strip light if it's on and disconnect the strip light from the power supply. Then wait at least 10 seconds before turning on the strip light.
- Turn the strip light on. Put the remote control close to the controller in the power cord. To pair the remote control, press and hold the "START/SET" button on the remote control for 3-5 seconds. If the strip light flashes in red and green, then the pairing is successful. The controller now only receives control instruction from this remote control, regardless of interference from other remote controls and products.

05 / SPECIFICATION

Light Strip	Input voltage	AC 120V
	Material	PVC
	Waterproof rating	IP67
	Working location	Indoor & outdoor
	Length	50ft
	Lifespan	50,000hrs
	Working temp	-31°F-113°F
LED Chip	Quantity	80pcs
	Size	5050
RF Remote Control	Working temp	-4°F-140°F
	Output signal	RGB
	Control mode	433M RF control remote
	Attended mode	Common anode
	Weight	150g
	Dimensions	3.94inch (L) × 1.85inch (W) × 1.50 inch (H)

06 / MAINTENANCE

- DO NOT use chemical solvents or harsh abrasives to clean the fixture. Use a soft dry cloth to clean if needed.
- The working temperature for the remote control is -20°C-60°C(-4°F-140°F).

07 / TROUBLESHOOTING

- The light does not come on at all:
Make sure the wall switch and circuit breaker are both on.
- Fuse blows when the light turns on:
Shorten the total extended length to 100ft or less and replace the fuse in the plug.

08 / WARRANTY

TORCHSTAR warrants that this product is free from defects in materials and workmanship for a period of 12 months from the day of purchase. If the product has been misused, damaged by accident or in any other way of improper use, this warranty becomes void.

09 / MANUFACTURER CONTACT INFO

Website: www.torchstar.us
E-mail Address: info@torchstar.us
Phone Number: 800-990-7688