

COLOR	PT# SUFFIX
BLACK	-BK
WHITE	-WH
GREY	-GY

NO.	DWG/SUPPLIER	CFG/SUPPLIER NO.	DESCRIPTION	QTY
1	156201	RACK (21) x 12	SIDE, LIGHT DUTY	2
2	1503024132	Default	TOP/BOTTOM LIGHT FRAME ASSEM. (19) x 12	2
3	TECHNI-VIS	*.250	FLAT WASHER 1/4"	8
4	FASTENAL	*0.250-20 x 0.625	HEX BOLT	8
5	FASTENAL	*0.500-13 x 1.250	HEX BOLT 1/2-13 x 1 1/4	4
6	1540	Default	NYLON BUSHING	4
7	1305023466	Default	FRAME (19 x 21)	1

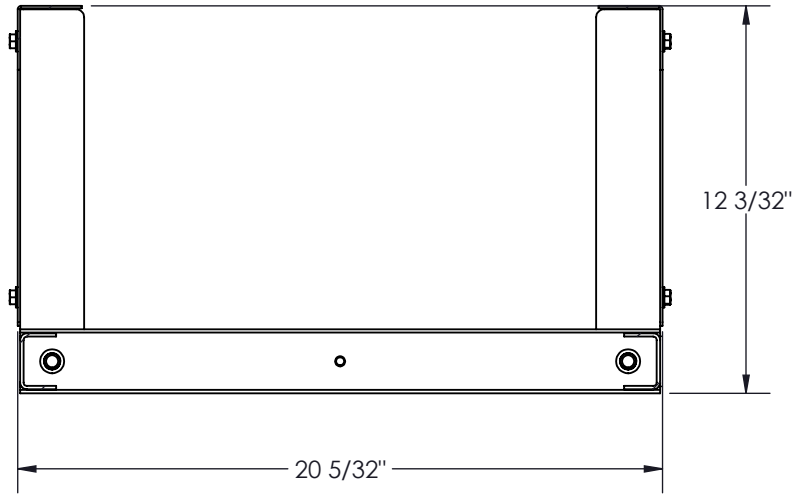

SECTION B-B

NOTES:

- 1 - APPROX. WEIGHT: 0.0 LBS
- 2 - FINISH: TEXTURED POWDER COATING
- 3 - MATERIAL:
 - 1 - FRAME: STEEL CRS GAUGE 12 (0.105")
 - 2 - LIGHT FRAME: STEEL CRS GAUGE 14 (0.075")
 - 3 - TOP/BOTTOM: STEEL CRS GAUGE 14 (0.075")
- 4 - CONSTRUCT: FRAME FULLY WELDED
- 5 - INCLUDES: ASSEMBLY HARDWARE

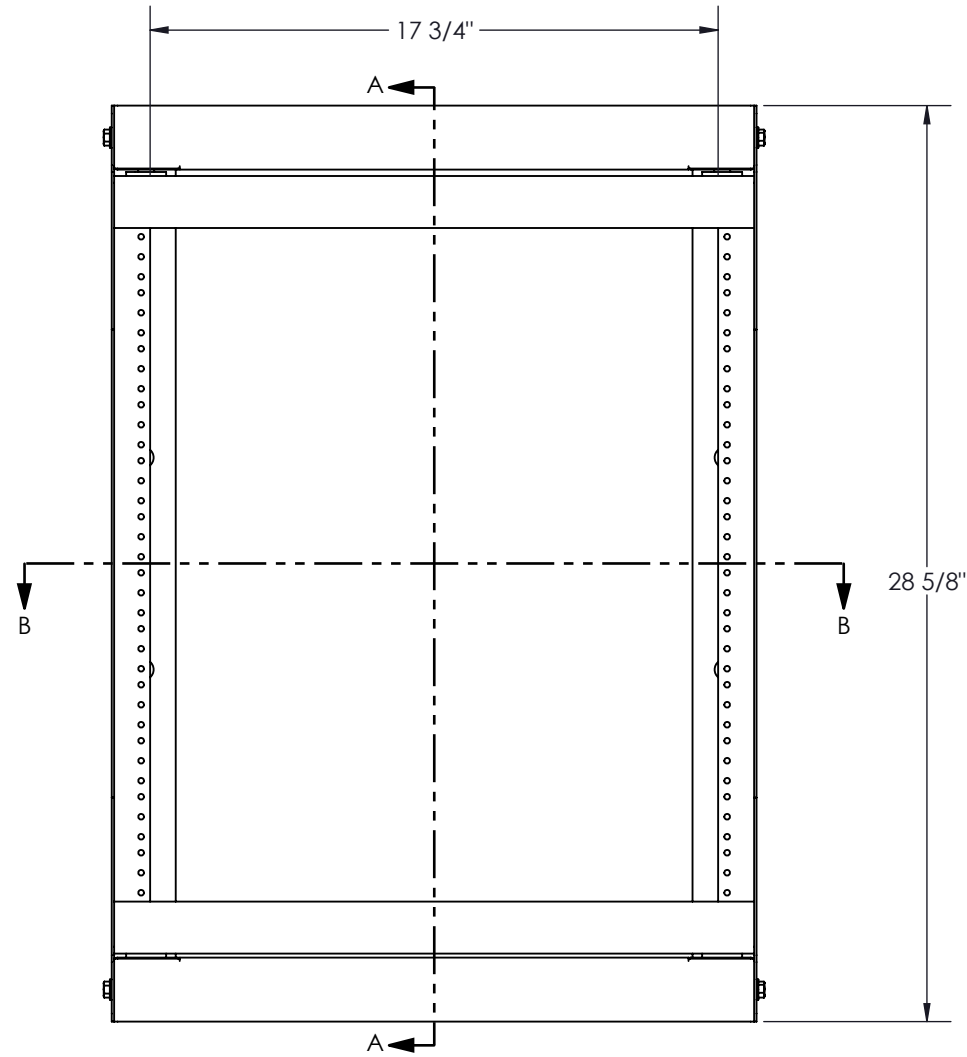

SECTION A-A

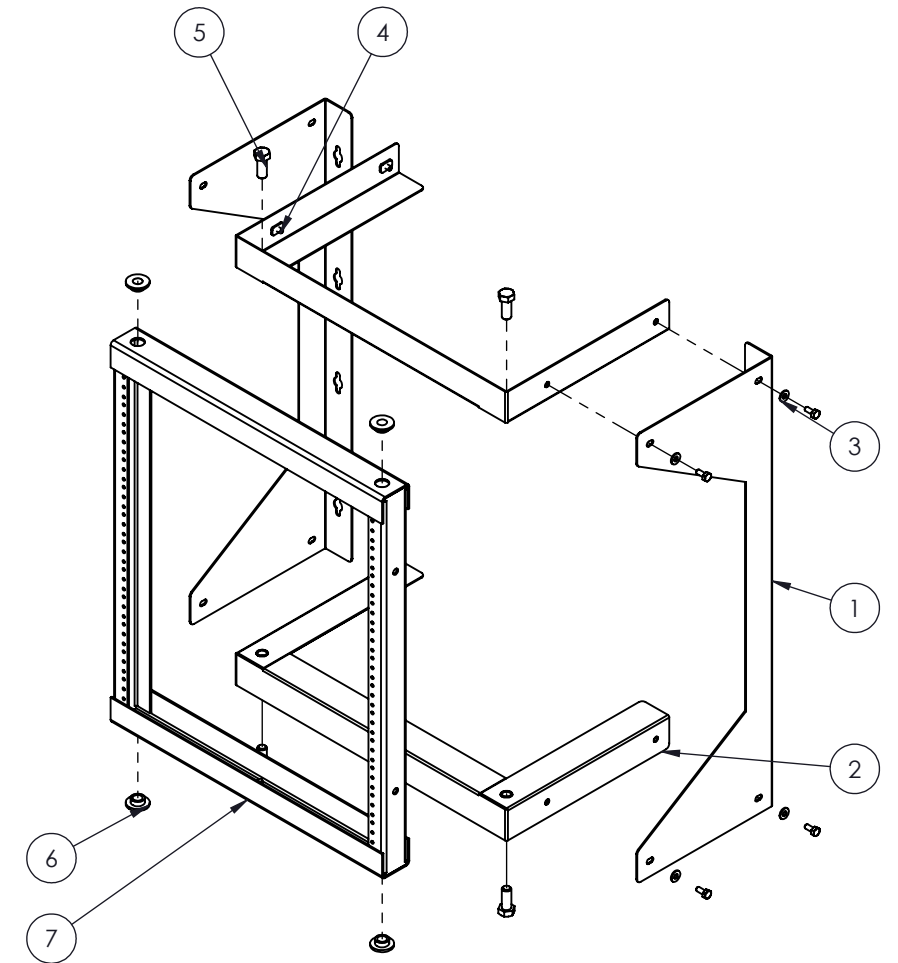
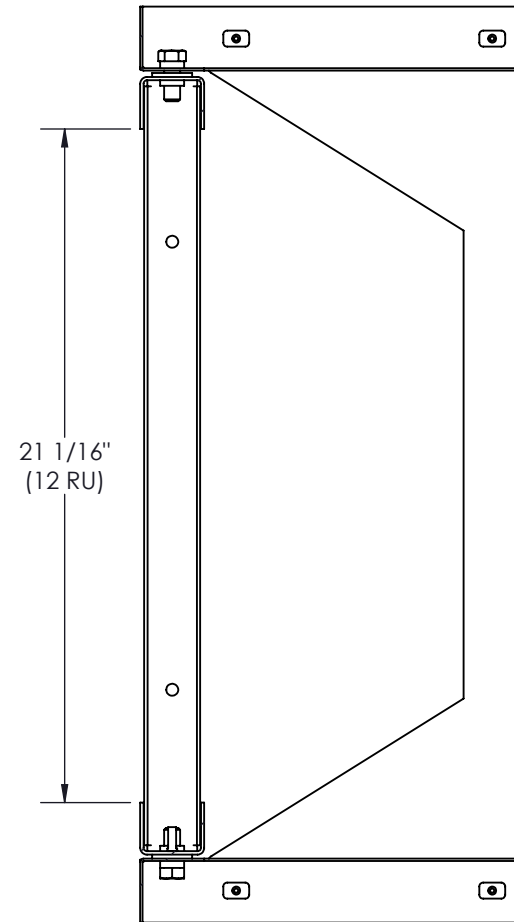

<p>PROUDLY MANUFACTURED IN CANADA</p>	DRAWN BY: E. DUCHESNEAU	TITLE: LIGHT PIVOTING RACK 12RU (19 x 21) x 12			
	CHECKED BY: J.L. PAVAO				
CONFIDENTIAL THE INFORMATION CONTAINED IN THIS DRAWING IS THE SOLE PROPERTY OF ELECTRON METAL A.I.G. INC. ANY REPRODUCTION IN PART OR AS A WHOLE WITHOUT THE WRITTEN PERMISSION OF A.I.G. ELECTRON METAL INC IS PROHIBITED.		FILE: Leger19x21x12_1562_Eng			
APPROVED BY:	PART NO.: WRSSLD-191212	DWG NO.: 1562	REV.: A	SCALE: 1:6	DATE: 2007-03-13
				SHEET: 1 / 1	

G:\SWDwgs\WallMount\Racks\Swing_Out\ 1