

COLOR	PT# SUFFIX
BLACK	-BK
WHITE	-WH
GREY	-GY

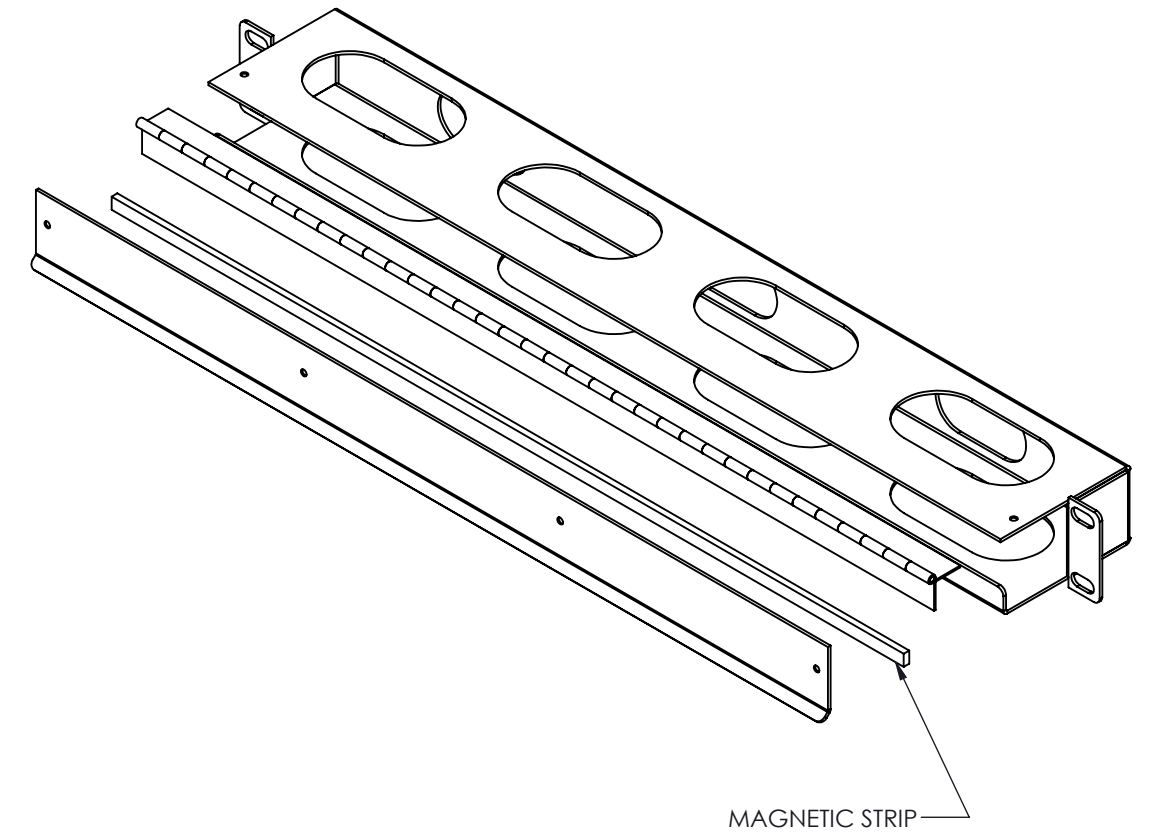
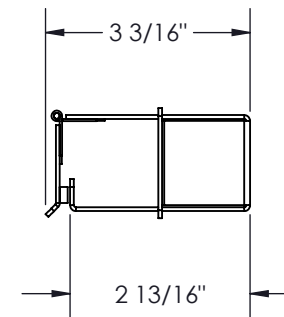
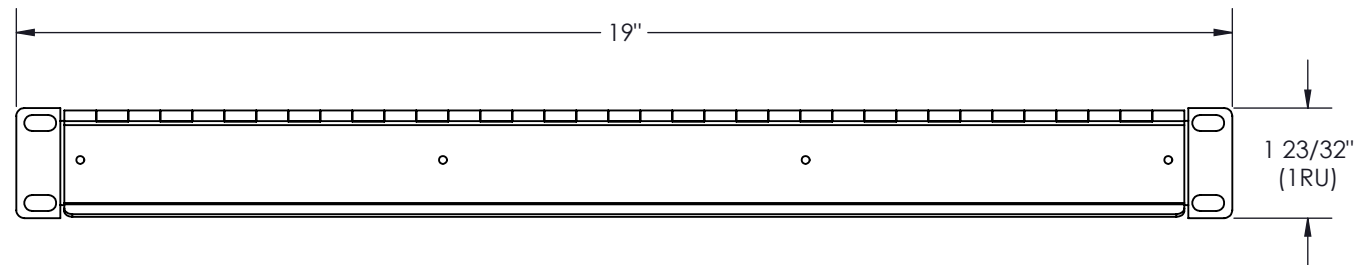
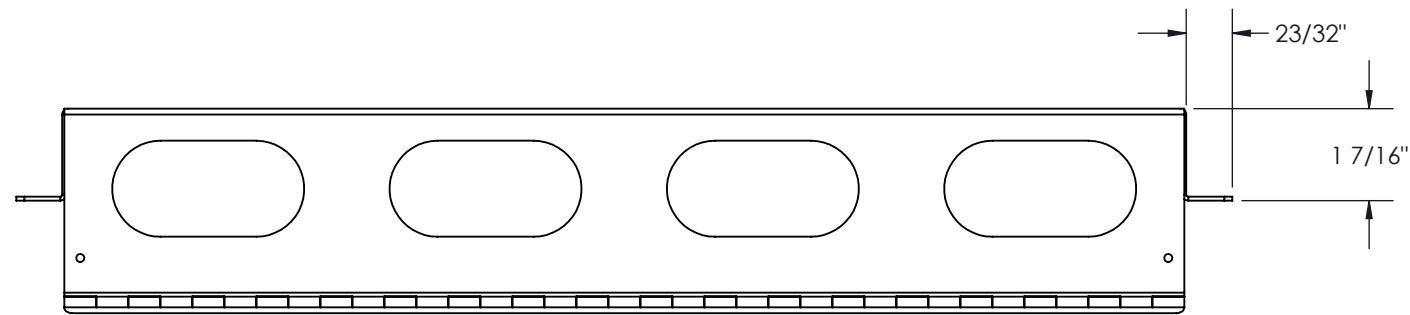

NOTES:

- 1 - APPROX. WEIGHT: 2.3 LBS.
- 2 - FINISH: TEXTURE POWDER COAT
- 3 - SHIPS WITH (4) SETS OF BOLTS 10-32 X 5/8"
- 4 - MAT'L'L: 16GA (0.60") CRS
- 5 - CONSTRUCTION: FULLY WELDED

REV.	DESCRIPTION	DATE	APPR.	STOCK
REVISIONS				

<p><b>Electron METAL</b> PROUDLY MANUFACTURED IN CANADA</p> <p><b>CONFIDENTIAL</b> THE INFORMATION CONTAINED IN THIS DRAWING IS THE SOLE PROPERTY OF ELECTRON METAL A.I.G. INC. ANY REPRODUCTION IN PART OR AS A WHOLE WITHOUT THE WRITTEN PERMISSION OF A.I.G. ELECTRON METAL INC IS PROHIBITED.</p>	DRAWN BY: E. D.	TITLE: HORIZ. CABLE MGT. 19 x 1.75 x 3			
	CHECKED BY: TOM	PROJECT: G:\SWDwgs\CableMgt\Rackmnt\HCMR_V2\		FILE: HCMRAssy19x1p75_1305023655_Eng	
	PART NO.: HCMREC-190103	DWG NO.: 1305023655	REV.: -	SCALE: 1:3	DATE: 2006-09-21

APPROVED BY: \_\_\_\_\_