

COLOR	PT# SUFFIX
BLACK	-BK
WHITE	-WH
GREY	-GY

D  
B  
A

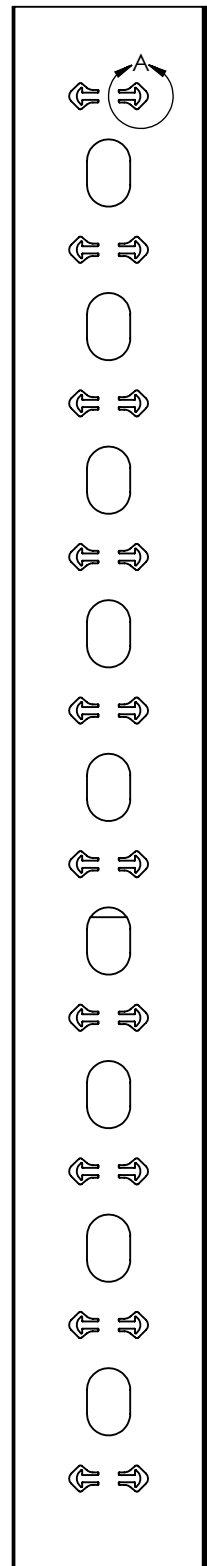

REAR VIEW

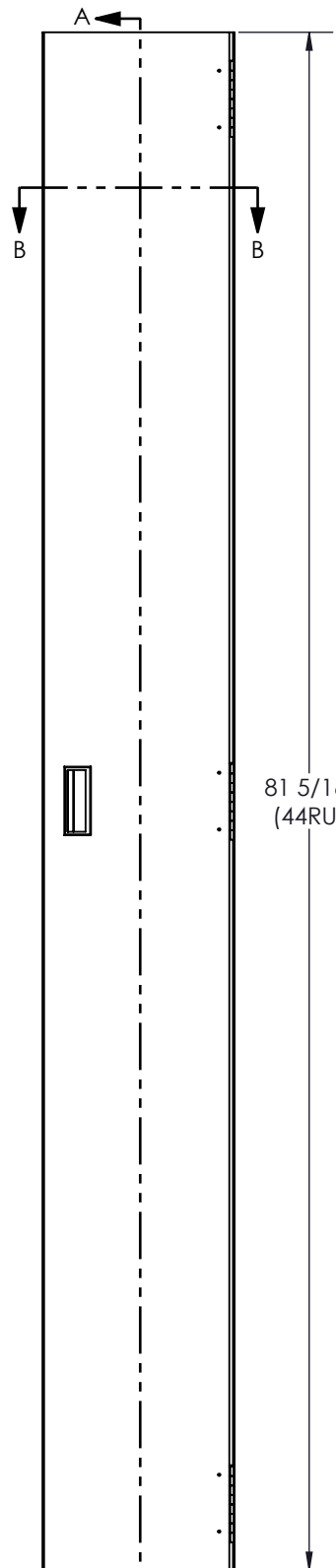

FRONT VIEW

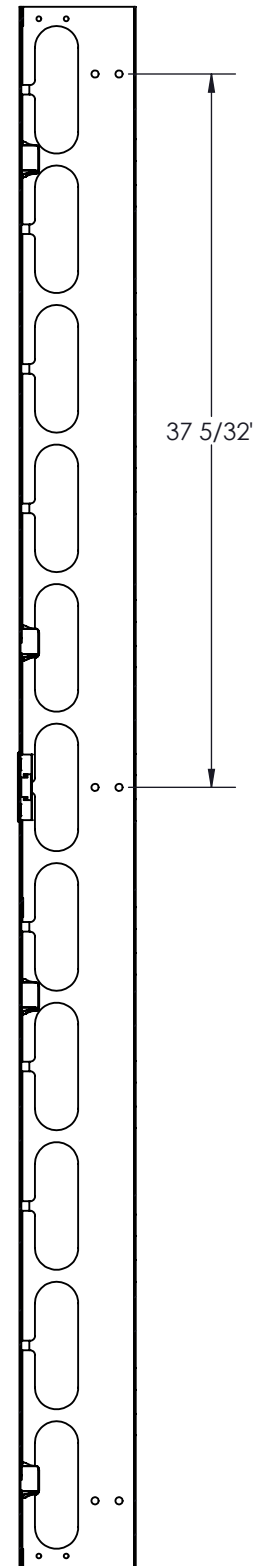

SECTION A-A

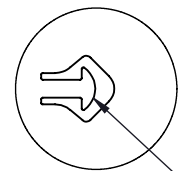

DETAIL A  
SCALE 1 : 4

CABLE HOOKS

SLOTS FACILITATE  
CABLE ROUTING

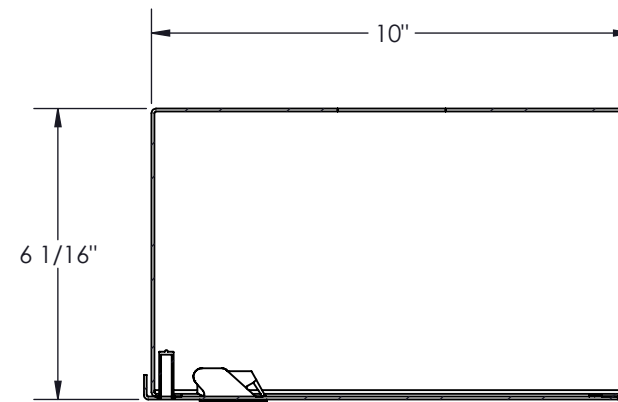
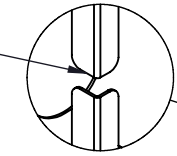

SECTION B-B  
SCALE 1 : 4

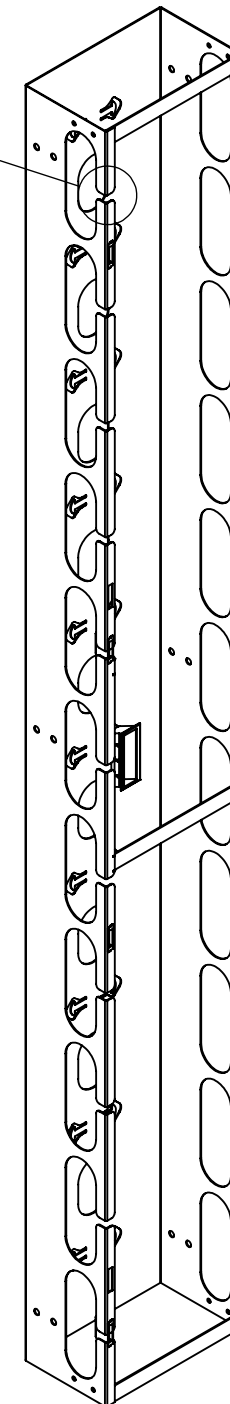

DOOR NOT SHOWN

D  
C  
B

NOTES:

- 1 - APPROX. WEIGHT: 39.6 LBS.
- 2 - FINISH: TEXTURE POWDER COAT
- 3 - SHIPS WITH (12) SETS OF BOLTS 1/4"-20 X 3/4"
- 4 - MAT'L: 16GA (0.60") CRS
- 5 - CONSTRUCTION: FULLY WELDED
- 6 - CABLE MANAGEMENT IS REVERSIBLE LH OR RH OPENING

<p><b>Electron METAL</b> PROUDLY MANUFACTURED IN CANADA</p> <p>CONFIDENTIAL THE INFORMATION CONTAINED IN THIS DRAWING IS THE SOLE PROPERTY OF ELECTRON METAL A.I.G. INC. ANY REPRODUCTION IN PART OR AS A WHOLE WITHOUT THE WRITTEN PERMISSION OF A.I.G. ELECTRON METAL INC IS PROHIBITED.</p>	DRAWN BY: E.D.	TITLE: VERTICAL CABLE MGT 44RU 10 x (77) x 6			
	CHECKED BY: E.D.	PROJECT: G:\SWDwgs\CableMgt\CableMgt_Racks\VertCableMgt\		FILE: VertCableMgtAssy10x6x77_1305024810_Eng	
APPROVED BY: T.M.	PART NO.: CMRSTD-104406	DWG NO.: 1305024810	REV.: 1:10	DATE: 2007-12-21	SHEET: 1 / 1

8  
7  
6  
5  
4  
3  
2  
1