

NO.	NOTE	DESCRIPTION	QTY
1	2300-002 - 12 x 9	BODY 48RU (84)	1
2	1305020805 - 7.75"	SPOOL BRACKET	8
3	2301-002	2 WAY BEVELLED DOOR 48RU 12 x (84)	1
4	1305020804 - 3.5"	SPOOL END PLATE	8
5	1305020806 - 7.75"	SPOOL	8
6	1305038739 - 3.5"	PLASTIC CABLE MGT FINGERS	2
7	1305038739 - 8.75"	PLASTIC CABLE MGT FINGERS	18

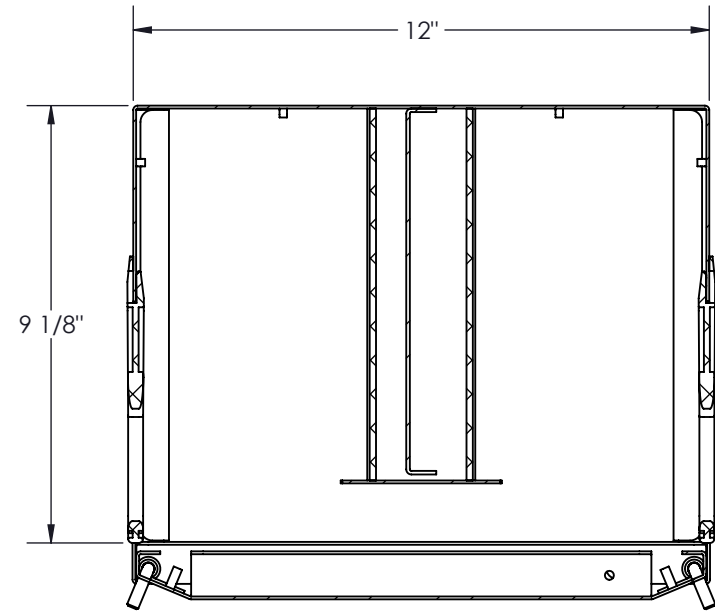

SECTION B-B
SCALE 1 : 4

RÉV.	DESCRIPTION	DATE	APPR.	INV.
RÉVISIONS				



PROPRIETARY AND CONFIDENTIAL
 THE INFORMATION CONTAINED IN THIS DRAWING IS THE SOLE PROPERTY OF A.I.G. ELECTRON METAL INC. ANY REPRODUCTION IN PART OR AS A WHOLE WITHOUT THE WRITTEN PERMISSION OF A.I.G. ELECTRON METAL INC IS PROHIBITED.

DRAWN BY: E.D.	Title: HIGH DENSITY CABLE MGT 12 x (84) x 9 WITH DOOR					
CHECKED BY: E.D.	PROJECT: G:\SWDwgs\Racks\Zone4_4PostRack\GestionsCables\Simple\Ensembles\		FILE: GestHD12x84x9AvecPorte_2301-001_Eng			
APPROVED BY: 5	PART NO: CMRHZD-124809	DRAWING NO: 2301-001	REV.: -	SCALE: 1:16	DATE: 2018-05-14	SHEET: 1 / 1