

NO.	NOTE	DESCRIPTION	QTY
1	1305037525	AV FRAME 24 x 35.75 x 24	1
2	1305037511	COVER	4
3	1305037512	BASE COVER	5
4	1305037526	SIDE PANEL (31.5) x 24	2
5	MAT-03PO20IB8106YY	2" SWIVEL CASTER - 250 LBS	4
6	1305038003	CASTER SUPPORT 24"	2
7	1305037528 - 18RU	MOUNTING RAIL TAPPING 10 - 32	4
8	1305037529	SOLID DOOR (19 x 31.5)	1
9	1305037531	PLEXIGLAS DOOR (19 x 31.5)	1
10	2143-001	FRONT MOUNT VENTED SHELF 2RU (3.5") LIP DOWN	3
11	134502 - (19 x 3.5)	FORMED STEEL BLANK PANEL	3
12	1515	4" FAN CUTOUT COVER PLATE	1
13	8 - 32 x 1/4	THREAD-ROLLING SCREWS	22
14	OHIO NUT & BOLT FH3339	LEVELLER, STEEL BASE 3/8-16	4
15	1305021224	50CFM FAN WITH GRILL & 3' CORD	1
16	1/4 - 20 x 1.25	SCREW PAN HEAD - PHILLIPS	8
17	1/4"	LOCK WASHER	8
18	OHIO N&B - LC1062	Leveler Base Component	4

NOTE
1 - 24 TRUSS HEAD MACHINE SCREW QUADREX 10 - 32 x 1/2 (BLACK) SHIPPED LOOSE

A	FAN, SHELF & LEVELER BASE	2017-12-20	TOM
REV.	DESCRIPTION	DATE	APPR.
REVISIONS			

Electron METAL
PROPRIETARY AND CONFIDENTIAL
 THE INFORMATION CONTAINED IN THIS DRAWING IS THE SOLE PROPERTY OF A.I.G. ELECTRON METAL INC. ANY REPRODUCTION IN PART OR AS A WHOLE WITHOUT THE WRITTEN PERMISSION OF A.I.G. ELECTRON METAL INC IS PROHIBITED.

DRAWN BY: R.B	Title: AV CABINET 18RU (19 x 31.5) x 24		
CHECKED BY: R.B	PROJECT: Cabinets\AV\Ensembles	FILE: CabAudio19x31.5x24_1305037498_Eng	
PART NO.: CBAKIT-191824	DRAWING NO.: 1305037498	REV.: A	SCALE: 1:32
		DATE: 2016-04-26	SHEET: 1 / 2

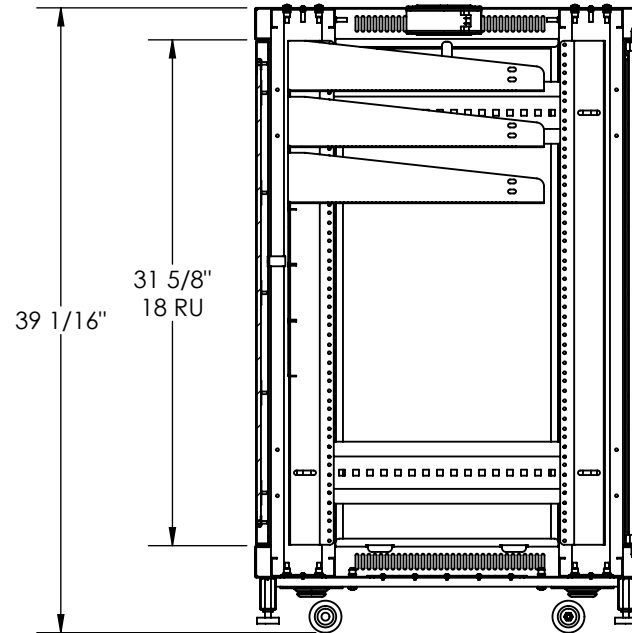
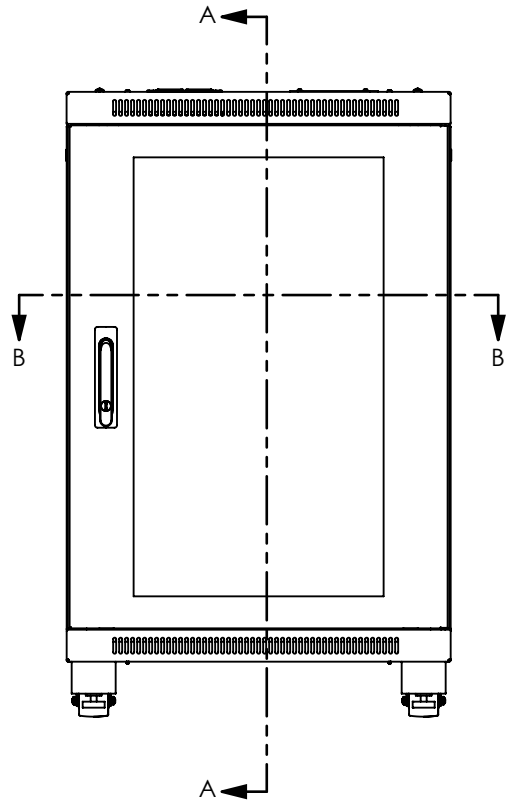

SECTION A-A
SCALE 1 : 12

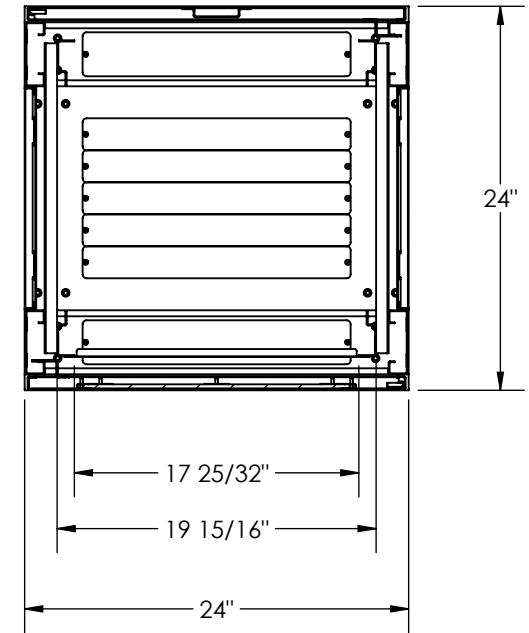

SECTION B-B
SCALE 1 : 12



PROPRIETARY AND CONFIDENTIAL
THE INFORMATION CONTAINED IN THIS DRAWING IS THE SOLE PROPERTY OF A.I.G. ELECTRON METAL INC. ANY REPRODUCTION IN PART OR AS A WHOLE WITHOUT THE WRITTEN PERMISSION OF A.I.G. ELECTRON METAL INC IS PROHIBITED.

DRAWN BY:
R.B
CHECKED BY:
R.B

Title:
AV CABINET 18RU (19 x 31.5) x 24

PROJECT:
Cabinets\AV\Ensembles

FILE:
CabAudio19x31.5x24_1305037498_Eng

PART NO.:
CBAKIT-191824

DRAWING NO.:
1305037498

REV.:
A

SCALE:
1:32

DATE:
2016-04-26

SHEET:
2 / 2