

COLOR	PT# SUFFIX
BLACK	-BK
WHITE	-WH
GREY	-GY

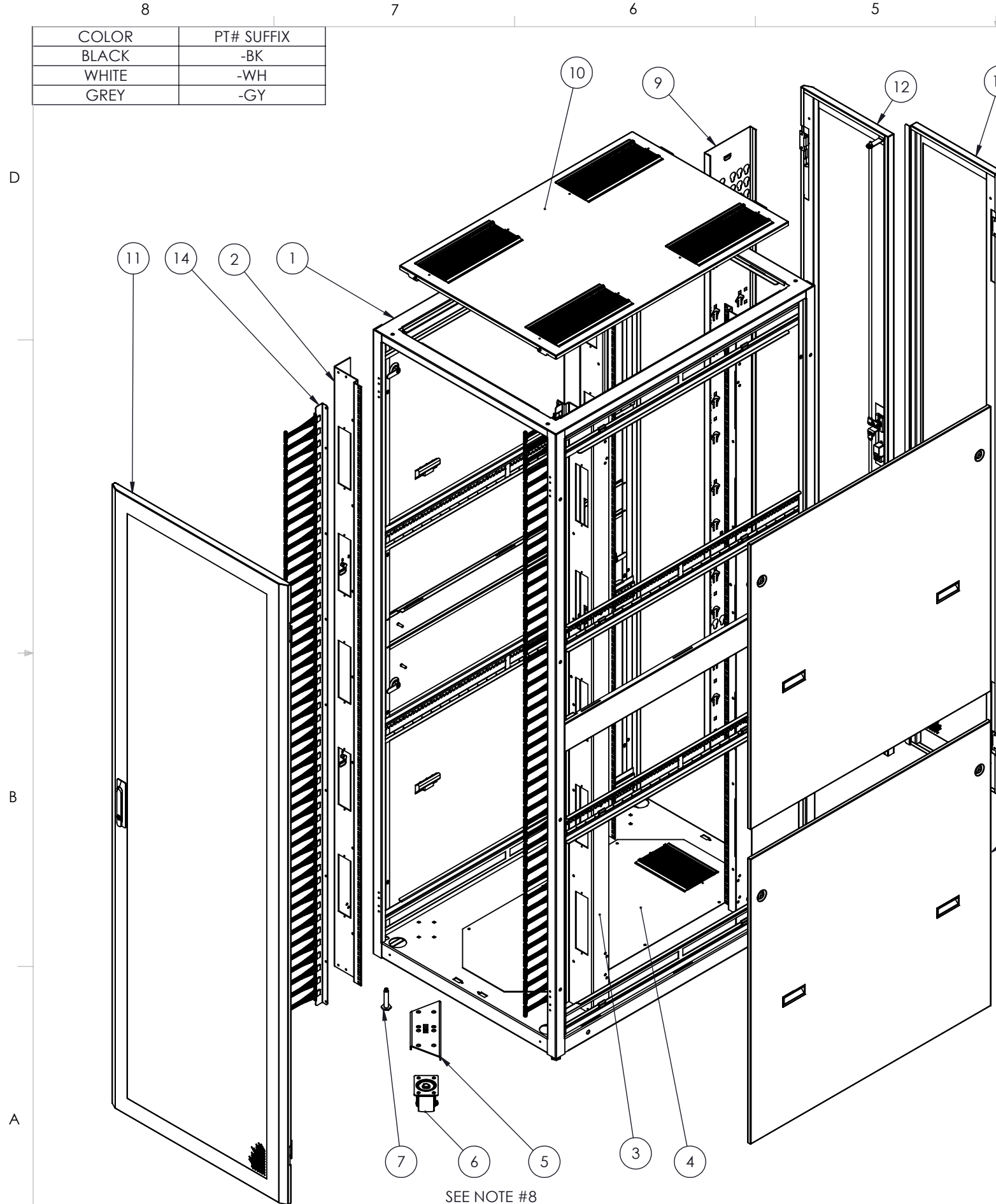

NO.	DWG/SUPPLIER	CFG/SUPPLIER NO.	DESCRIPTION	QTY
1	3222-017	Default	A5000 FRAME 48RU (27 x 84) x 42	1
2	3189-008	Default	MTG RAIL 5.063 x (84) ASS'Y RH	2
3	3189-010	Default	MTG RAIL 5.063 x (84) ASS'Y LH	2
4	2114-005	Default	BOTTOM COVER WITH DBL BRUSH 4 x 8 - 42D	1
5	3236-001	Default	A5000 CASTER PLATE	4
6	03PO201B8106YY	Default	2" SWIVEL CASTER - 250 LBS	4
7	OHIO NUT & BOLT	FHP 4441	LEVELLER, STEEL BASE 1/2-13, HEX. END	4
8	2368-018	Default	SPLIT SIDE PANEL (84) x 42 LOCKS	2
9	3191-017	Default	A5000 U.A.C. 42RU (84) x 7.5 ASS'Y	1
10	3639-005	Default	TOP COVER (21) x 42 WITH BRUSH	1
11	3180-009	Default	A5000 PERFORATED DOOR (27 x 84)	1
12	3183-014	Default	A5000 SPLIT DOOR PERFORATED RH (27 x 84)	1
13	3183-015	Default	A5000 SPLIT DOOR PERFORATED L.H. (27 x 84)	1
14	2187-001	Default	HIGH DENSITY RAIL CABLE MGT 48RU (84)	2

NOTES:

- 1 - RU DECALS ON HORIZONTAL RAILS.
- 2 - RU MARKINGS PRINTED ON VERTICAL RAILS.
- 3 - 100 CAGE-NUTS HEAVY DUTY (TINNERMAN)
- 4 - 100 SCREWS 10-32 x 5/8 BLACK
- 5 - 4 GANGING PLATES
- 6 - ESTIMATED WEIGHT: 413.95 LB
- 7 - FINISH: TEXTURED POWDER COAT
- 8 - FASTEN CASTERS USING:
  - 1/4-20 x 3/4 ELEVATOR BOLTS
  - 1/4" FLAT WASHERS
  - 1/4-20 K-LOC NUTS

REV.	DESCRIPTION	DATE	APPR.	STOCK
REVISIONS				

<p>FABRIQUÉ AVEC FIERTÉ AU QUÉBEC.</p> <p>CONFIDENTIEL L'INFORMATION CONTENUE DANS CE DESSIN EST L'ENTIÈRE PROPRIÉTÉ D'ELECTRON METAL A.I.G. INC. TOUTE REPRODUCTION PARTIELLE OU EXHAUSTIVE SANS PERMISSION ÉCRITE D'ELECTRON METAL A.I.G. INC. EST INTERDITE.</p>	DESSINÉ PAR/DRAWN BY: M.W.	TITRE/TITLE:
	VÉRIFIÉ PAR/CHECKED BY: NOT CHECKED	A5000 48RU (27 x 84) x 42 OVERALL DIMS: 29.625 x 87.5 x 44.355
FICHER/FILE: A5000_27x84x42_3221-011	NO. DE PIÈCE/PART NO.: CB5KNW-274842	NO. DESSIN/DWG NO.: 3221-011
APPROUVÉ PAR: E.D.	REV./REV.: A	ÉCHELLE/SCALE: 1:14
	DATE: 2024/04/05	PAGE/SHEET: 1 / 2

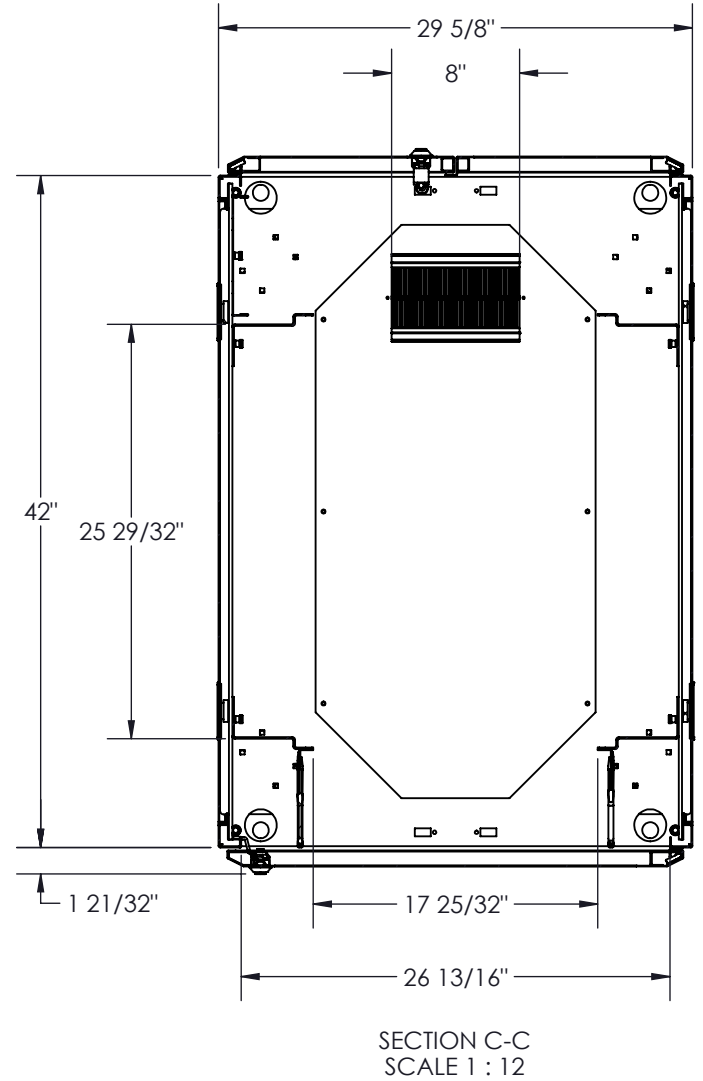
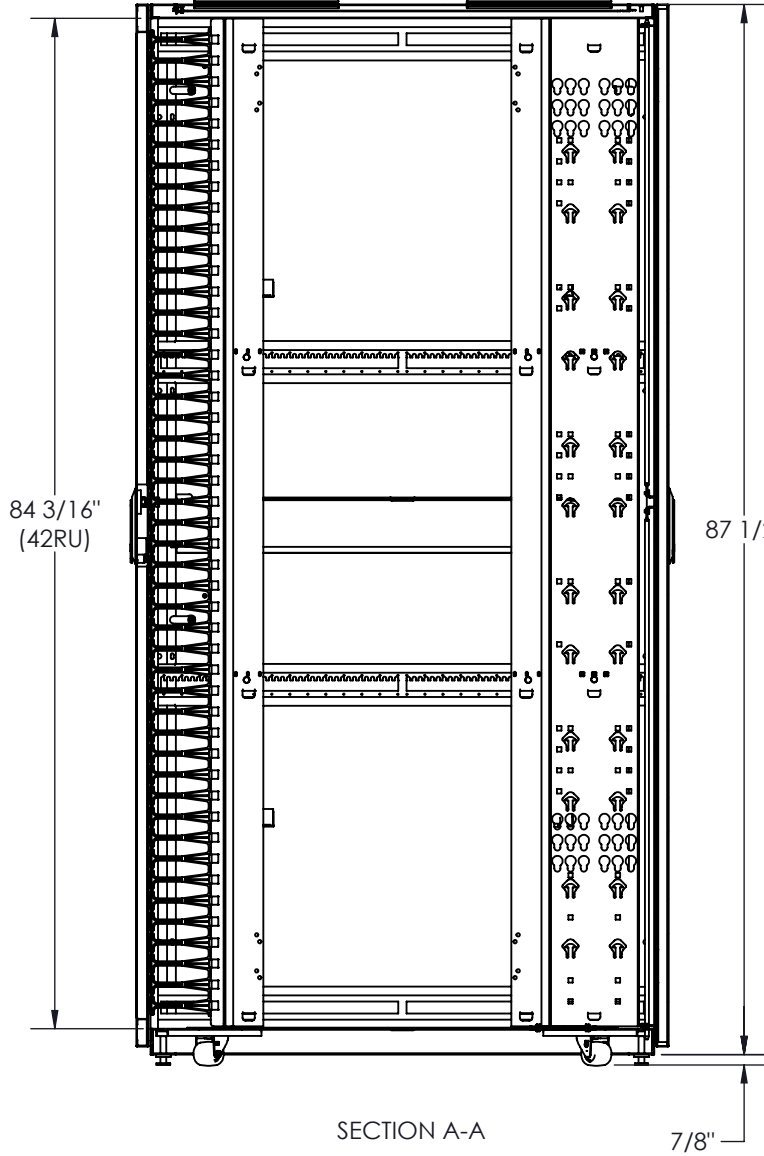
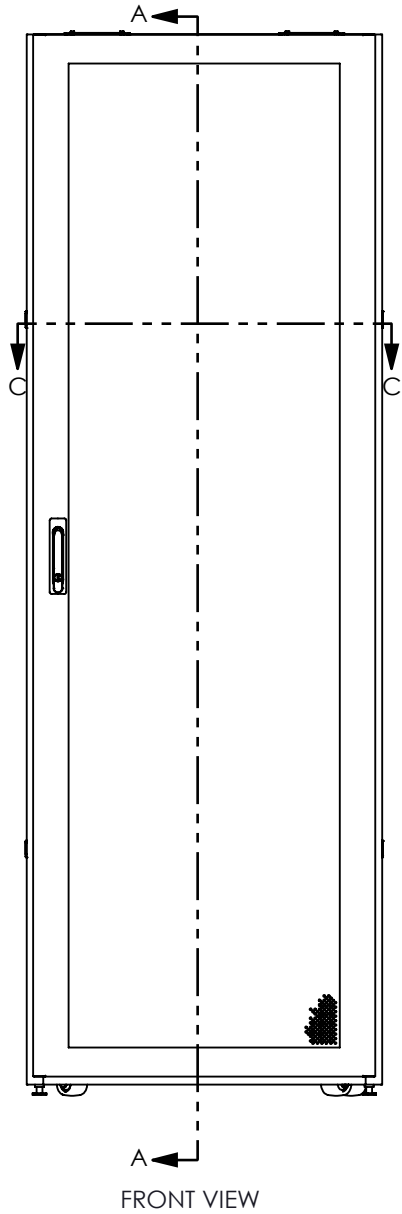

**Electron** PROUDLY MANUFACTURED IN CANADA.  
METAL

PROPRIETARY AND CONFIDENTIAL  
THE INFORMATION CONTAINED IN THIS DRAWING IS THE SOLE PROPERTY OF ELECTRON METAL A.I.G. INC. ANY REPRODUCTION IN PART OR AS A WHOLE WITHOUT THE WRITTEN PERMISSION OF A.I.G. ELECTRON METAL INC IS PROHIBITED.

APPROVED BY:  
E.D.

DRAWN BY:  
M.W

CHECKED BY:  
NOT CHECKED

FILE:  
A5000\_27x84x42\_3221-011

PART NO.:  
CB5KNW-274842

Title:  
A5000 48RU (27 x 84) x 42  
OVERALL DIMS: 29.625 x 87.5 x 44.355

DRAWING NO.:  
3221-011

REV.:  
A

SCALE:  
1:16

DATE:  
2024/04/05

SHEET:  
2 / 2