

BOUNDARY

Moto Mount Instructions



MOTO MOUNT ASSEMBLY INSTRUCTIONS

THE FOLLOWING PARTS ARE NEEDED FOR THE NEXT STEPS

Moto Mount

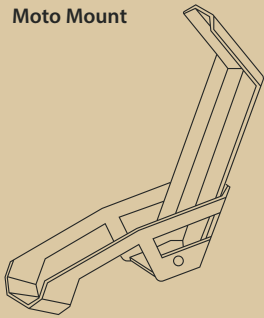

2x 3-Hole T-Nut



6x Flat Washer



2x 1-Hole T-Nut



4x 1/4-20 x 5/8"
Button Head Screw



2x 1/4-20 x 1/2"
Button Head Screw



2x Anchor Ring

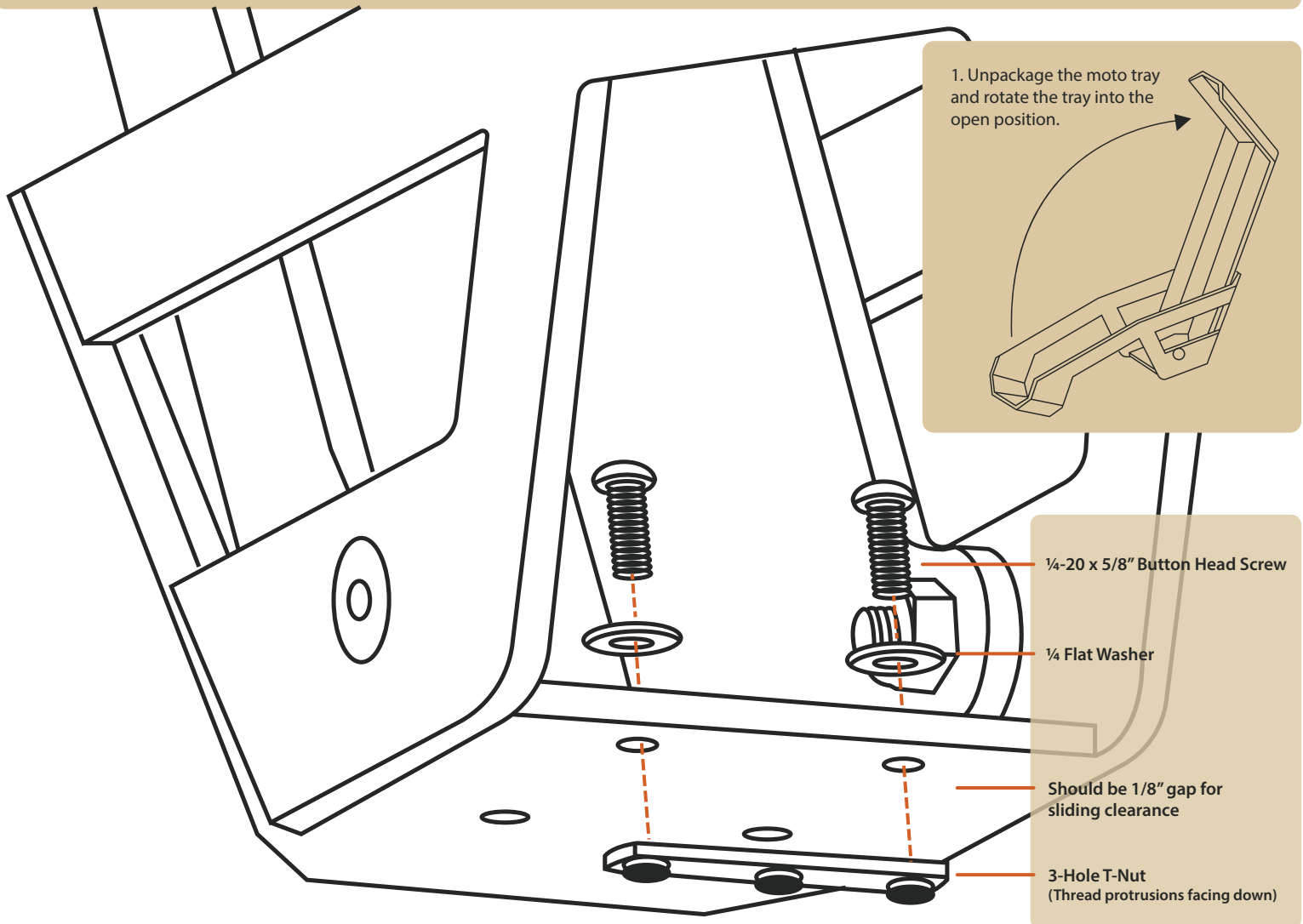

2. Loosely thread on the moto tray hardware, maintaining a 1/8" gap for sliding clearance with the upper cross beam on the truck bed rack.

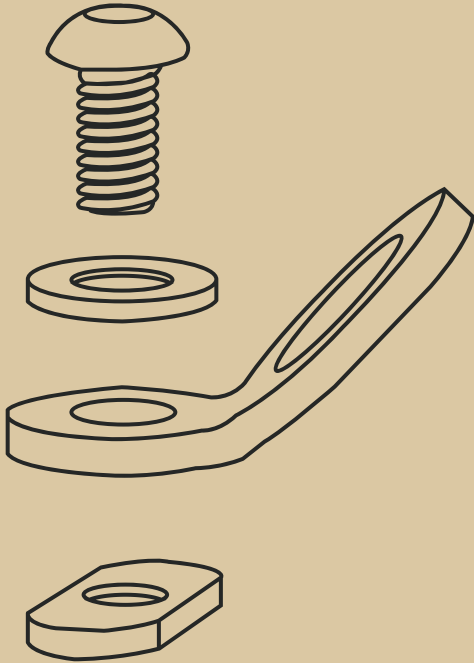

3. Loosely thread on the anchor ring mounting hardware onto both anchor rings, maintaining 1/8" gap for sliding clearance.

4. Slide moto tray and anchor rings into the t slot rails on the upper cross beam, and fully tighten bolts into the desired location, maintaining 12" of spacing between anchor rings and moto mount.

5. Using a moto truck ramp, get your moto into the bed of the truck. With a helper, get the front wheel of your moto into the tray by lifting on the front wheel / forks. Lift with your legs, save your back!

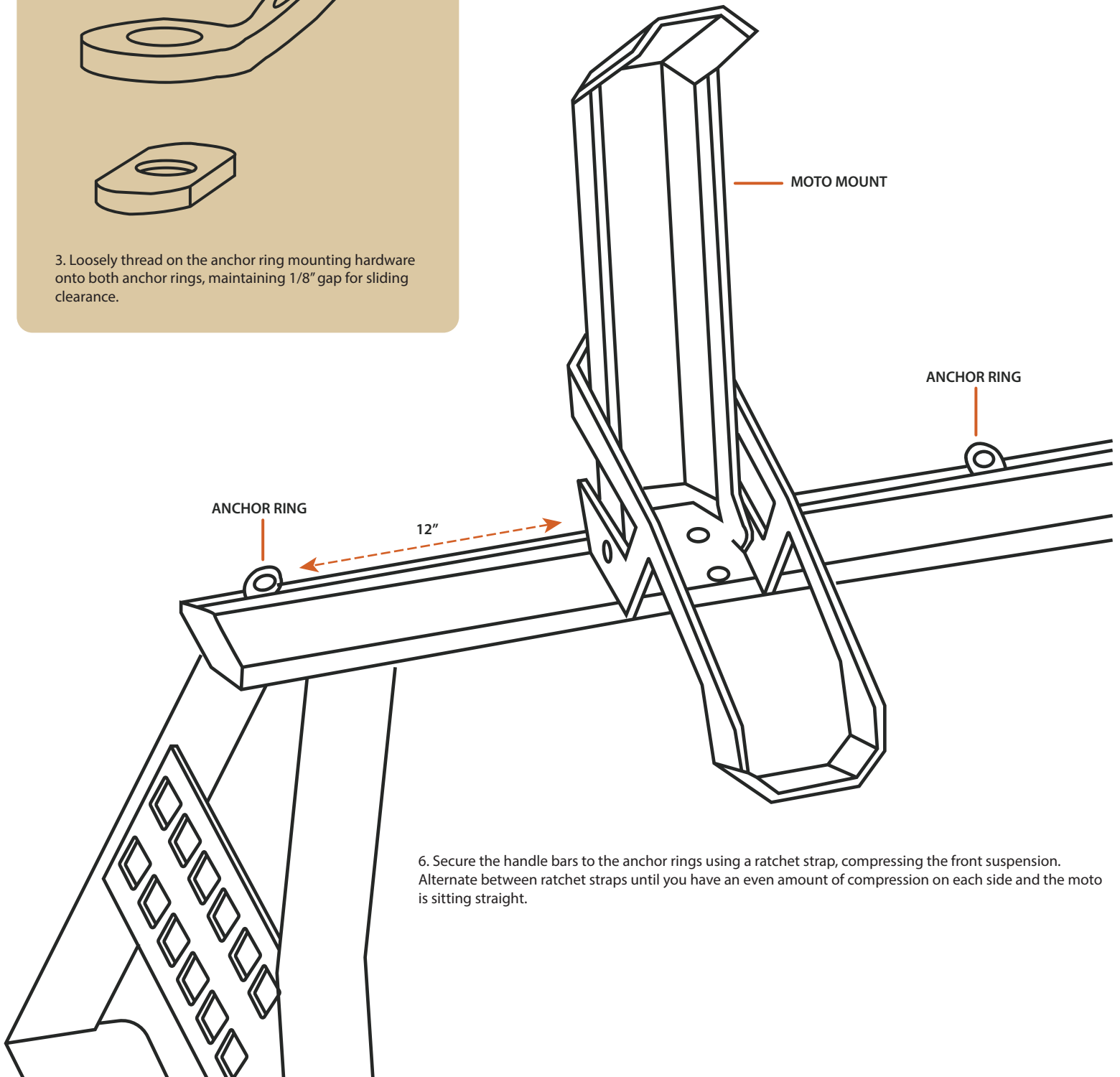

6. Secure the handle bars to the anchor rings using a ratchet strap, compressing the front suspension. Alternate between ratchet straps until you have an even amount of compression on each side and the moto is sitting straight.