



# SWAG KIT

textile cord set | user guide



UIMAGE



## WITH LOVE FROM COPENHAGEN

At UIMAGE, our designers take inspiration from the distinct nature of the Nordic landscape to create unique designs related to the way we live in an urban setting. Influenced by the design language, colours and materials found around us in Scandinavia, we create a collection that is rooted in our home but designed for everyone.

## **SAFETY PROCEDURES**

**Read and keep these instructions for future reference**

- **This product is NOT a children's toy and should NOT be used in any other manner than described throughout this user guide.**
- **Always turn electrical power off at the electrical service panel of the household before handling electrical wires. Keep electrical power turned off throughout the entire installation procedure.**
- **NEVER touch the light bulb immediately after the light has been turned off. Beware of possible scalding! Let the light bulb cool off sufficiently before changing the bulb.**

- **ONLY** use this product where the same official electrical and technical parameters, as described, exists!
- This product is for indoor use **ONLY**, excluding any wet areas.
- Do **NOT** install this product near flammable or heat-sensitive objects.
- Do **NOT** try to repair the product if any of the electrical or mechanical components are in any way broken, not as expected, or malfunctioning. Please contact a qualified electrician.

## **WARNING**

**Ignoring any of the Safety Instructions, or deviating from any of the steps in either the Installation-, the Maintenance- or the Suitable Lamp Shade section may result in a risk of fire or electric shock. You are advised to contact a qualified electrician for these procedures.**

## **INSTALLATION**

- 1. 1x A – Swag kit  
2x B – Ceiling hook  
2x C – Cord holder bracket**
- 2. Screw ceiling hooks into ceiling, making sure the thread is completely inside the ceiling. Use proper ceiling anchors, if needed (anchors not included). Different types of ceilings require different types of anchors.**

**NOTE: Ensure the ceiling hook is placed close enough to the wall outlet to avoid tension on the cord. Likewise, make sure the ceiling hooks are close enough to each other to avoid tension on the cord. Take the cord holder bracket and guide the cord through it as shown (1).**

**Confirm the cord is properly secured inside the bracket before hanging it onto the ceiling hook. The height of the lamp holder can be adjusted by repositioning the cord on the cord holder brackets.**

- 3. If desired, fasten a suitable lamp shade (not included) onto the lamp holder by unscrewing the ring from the lamp holder. Mount the lamp shade onto the lamp holder, then screw the ring back onto the lamp holder until the lamp shade is completely fastened (2).**

**NOTE: Always refer to the lamp shade manual when installing a lamp shade. See last section of the user guide for suitable lamp shade requirements.**

**Install the appropriate bulb as indicated on the label on the lamp holder for maximum wattage. Never put your fingers into a live lamp holder.**

- 4. When the lamp shade and light bulb are properly installed, turn the power on.**



## **MAINTENANCE**

- **Always turn electrical power off before cleaning the product or changing the bulb.**
- **Cleaning should be done with dry cloth. Avoid using any form of moisture, solvents and chemicals. when cleaning the product.**
- **NEVER touch the light bulb immediately after the light has been turned off. Beware of possible scalding! Let the light bulb cool off sufficiently before changing the bulb.**
- **Avoid tension on the textile cord while handling the product.**

## SUITABLE LAMP SHADES

- **The diameter of the lamp shade should NOT exceed 15.75 in (400 mm).**
- **The lamp shade should have openings in both top and bottom to facilitate heat dissipation.**
- **The minimum diameter of open area of both top and bottom of the lamp shade should NOT be less than 4 in (100 mm); The open area in both top and bottom of the lamp shade is at least 3 in<sup>2</sup> (19.3 cm<sup>2</sup>).**
- **The weight of the lamp shade should NOT exceed 5 lb (2.3 kg).**

Model no.: 4009 or 4010

Rating parameter: 120V, 60HZ, AC ONLY

Lamp holder: E26 / TYPE A

# ASSEMBLY GUIDE

Ⓐ x 1 pc.

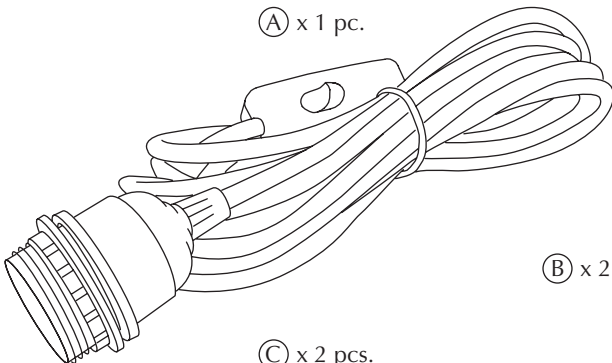

Ⓑ x 2 pcs.

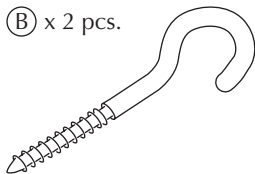

Ⓒ x 2 pcs.

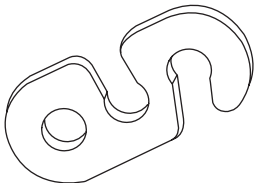

Find assembly videos by using the QR code or by going online at our website  
**[umage.com/instructions](http://umage.com/instructions)**

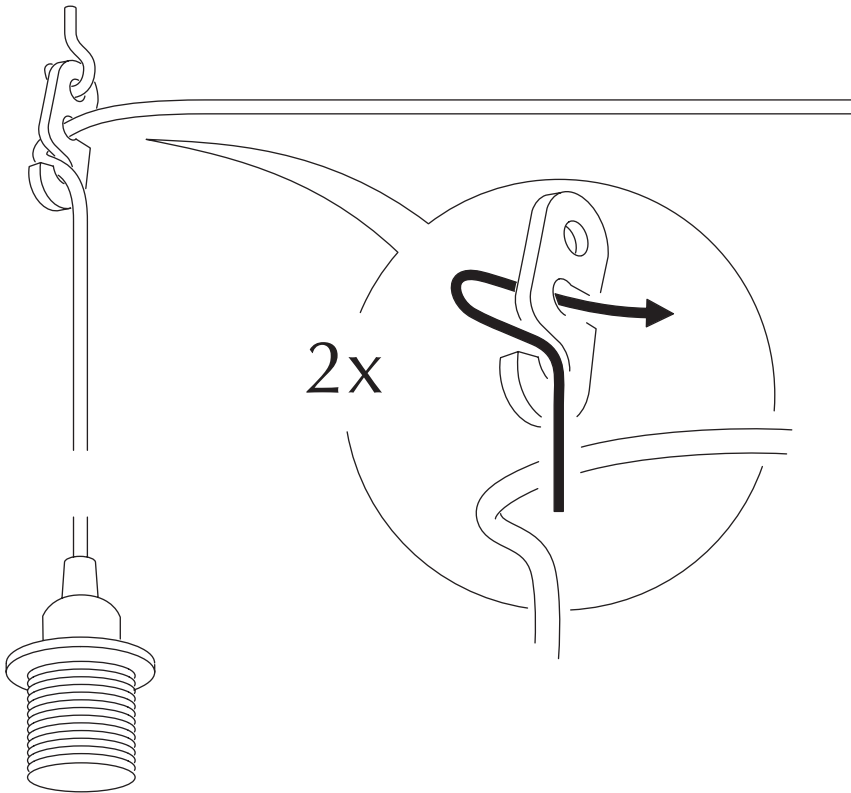

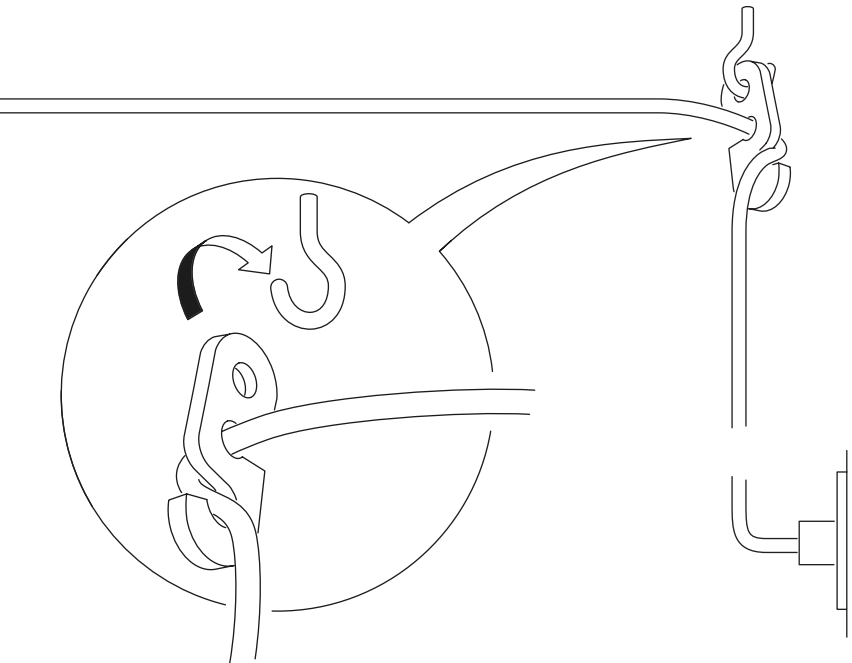

ACORN

black | polished brass



# UMAGE UNFOLD AT HOME

GET THE FREE UIMAGE APP

Preview our entire collection in your own home – before you buy

Imagine an UIMAGE lamp or furniture piece in your home. Is it the right design, size and colour? We made it easier for you to find the perfect UIMAGE design. Just download our free **UMAGE Unfold at Home** app from the App Store or Play Store, and see how our designs will look in your home!



FOLLOW US ON SOCIAL MEDIA



@umagedesign | #umagedesign | [umage.com](http://umage.com)



  
UMAGE