

# Ledger Tall Cabinet

## ASSEMBLY INSTRUCTIONS

**KEEP ALL PACKAGING MATERIALS UNTIL YOU HAVE VERIFIED ALL COMPONENTS AND PARTS**

### Preventative Measures: Wood

The Ledger Series is constructed with a combination of solid and engineered wood, each with its own distinct grain pattern and coloring. These variations make each piece natural and unique. We recommend cleaning all wood components with a damp, soft cloth. Do not put any extremely hot or cold food items/beverages in direct contact with the wood surface as this may cause marking or damage to the finish. Spills must be cleaned immediately or this may cause discoloration and /or swelling to the wood and may cause permanent damage. Do not apply oils or other stains to refinish the surface. Take care when opening and closing doors to keep the tambour doors functioning correctly.

1. Carefully place the unit on its back on a clean, flat surface.
2. Bolt the legs to the corners of the skirt by lining up the holes and using hardware **(A)** provided. Tighten with the provided Allen wrench **(D)**.
3. Stick the felt pads on each leg **(C)**
4. Install post **(F)** on each leg as shown using a Phillips screw driver.
5. Install the lower shelf on the legs by lowering the shelf onto posts **(F)** until they are nested into each fitting, then tighten with a Phillips screw driver.
6. Apply paraffin **(B)** to the groove of the tambour door and move the doors back and forth ~15x
7. Remove transport clamps from shelves
8. Install the anti-tip hardware **(E)** to secure the unit to an adjacent wall.

**To improve stability it may be necessary to periodically tighten all the fasteners. Do not use abrasive cleaning products.**

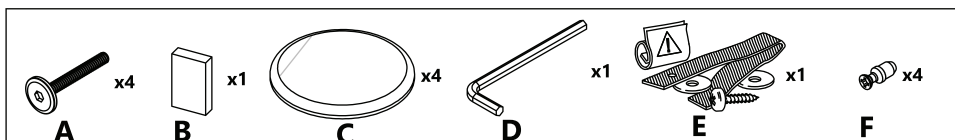
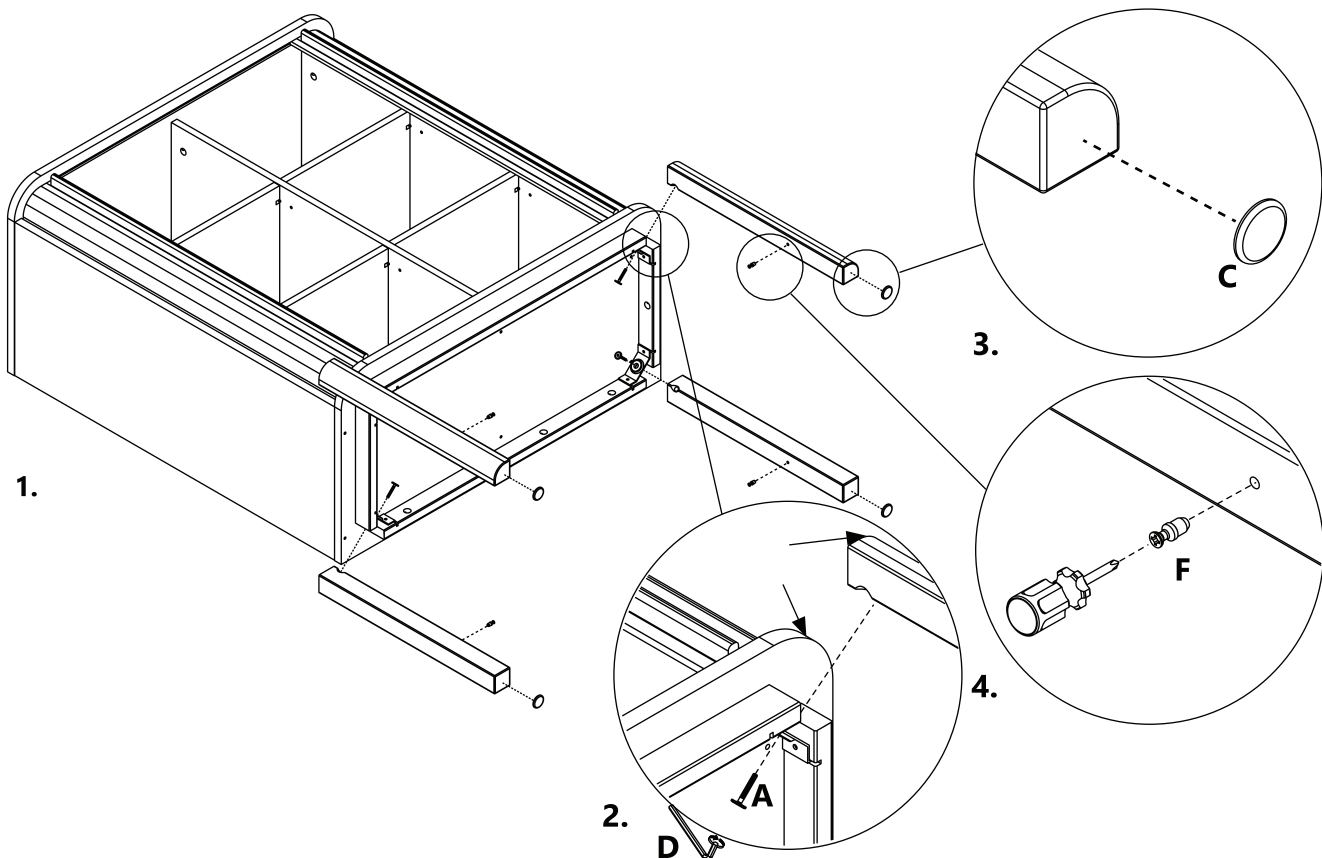

Modern  
furniture  
made  
simple.

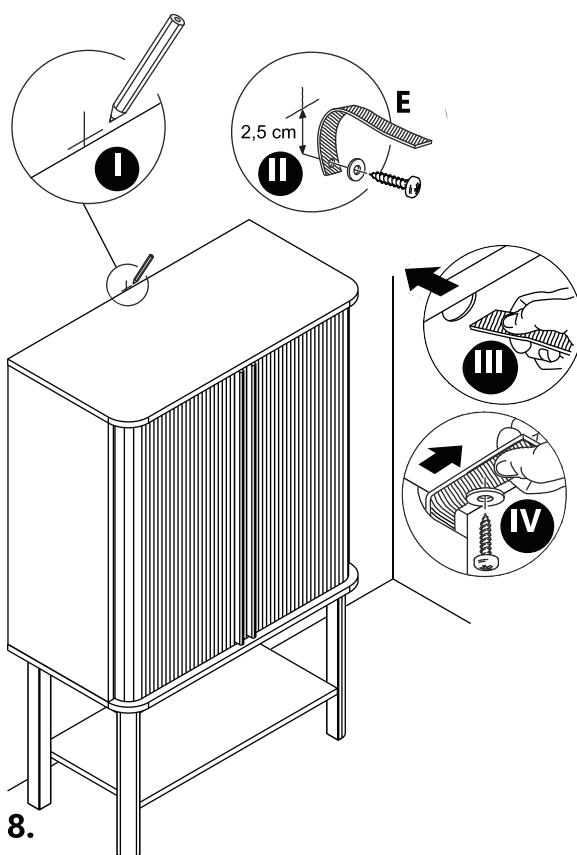
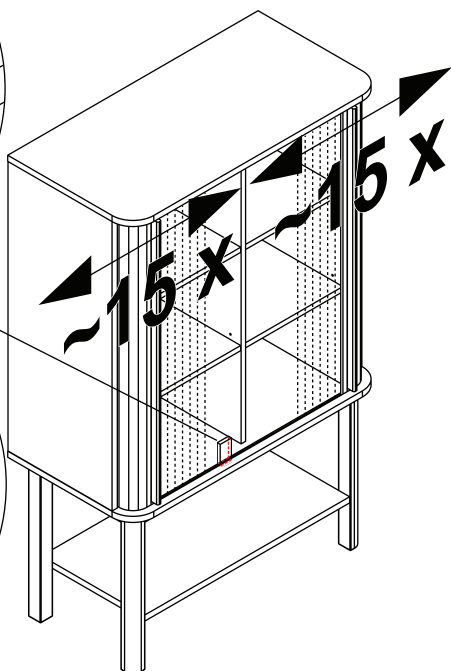
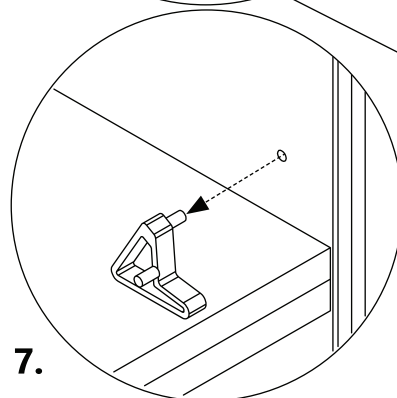
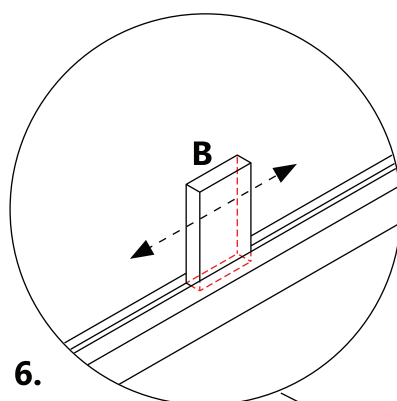
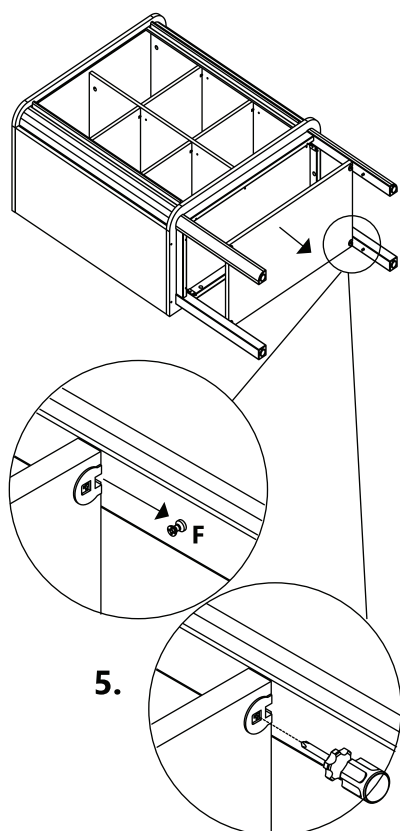

Modern  
furniture  
made  
simple.