

**SPECIFICATIONS:**

**DIMENSIONS:** 25"H X 72" W X 25" D (PER CABINET)  
**MOTOR:** 3HP, 230/460/3/60, 8.6/4.3 FLA  
**CFM:** 3HP - 4,500 CFM @ .85" W.G.

**CONSTRUCTION** 12 & 14 GA POWDER COATED STEEL FRAME.  
 3/16 POLYETHYLENE PANELS. FULL CARBON STEEL CONSTRUCTION AVAILABLE.  
 4-WAY ALUMINUM EXHAUST GRILLE

**ELECTRICAL** WIRED TO JUNCTION BOX

**BLOWER:** 10 X 10 FORWARD CURVED BLOWER BELT DRIVE

**FILTERS:** 4" PLEATED PREFILTERS, 22.3 SF EA.  
 (2) 95% BAG FILTER, 80 SF EACH  
 (2) 65% BAG FILTER, 80 SF EA (OPT.)  
 2" CARBON TRAY (OPT.)

**OPTIONS:** EYEBOLTS (INSTALLED)  
 SILENCER  
 MAGNAHELIC PRESSURE GAUGE

**WEIGHT:** 199 LBS.

**NOISE:** 3 HP - 72.0 dBA

**SINGLE CABINET DIMENSIONS**

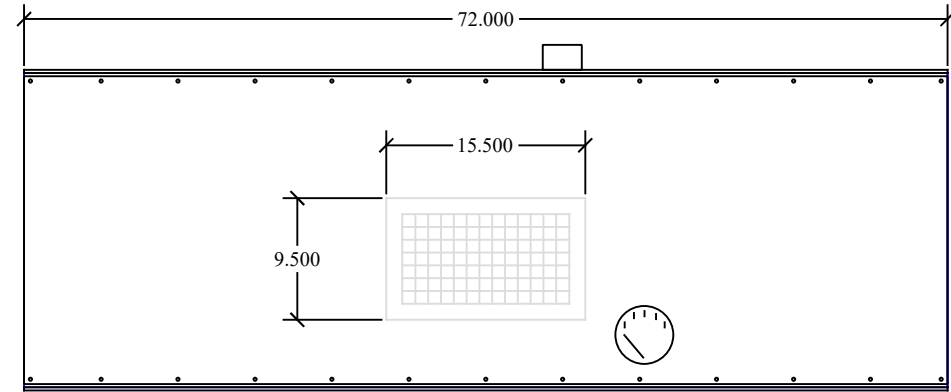
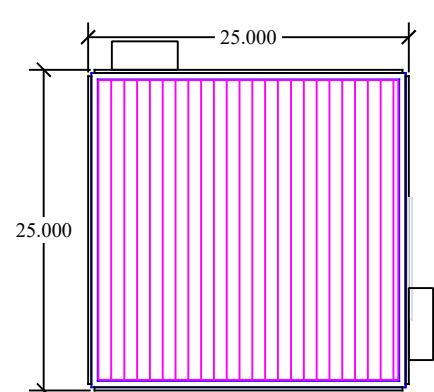

**INDUSTRIAL MAID**

**INDUSTRIAL MAID LLC**  
 351 S. 12TH RD.  
 CORTLAND, NE 68331  
 Ph. (402) 798-7116  
 Fax (402) 798-7117  
 www.industrial-maid.com

**COPYRIGHT:** This document and the information contained may not be reproduced or distributed without express written consent of INDUSTRIAL MAID. Unauthorized reproduction, disclosure, or manufacturing use are prohibited by copyright law.