

STATIC PRESSURE, W.G.

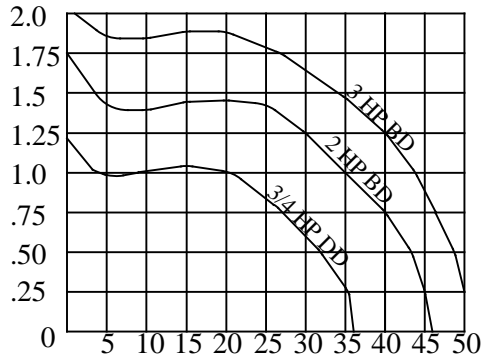

CFM X's 100

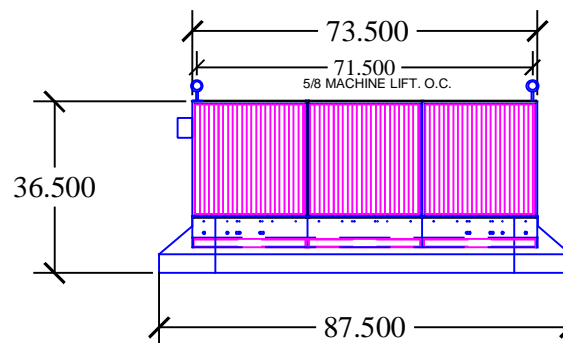
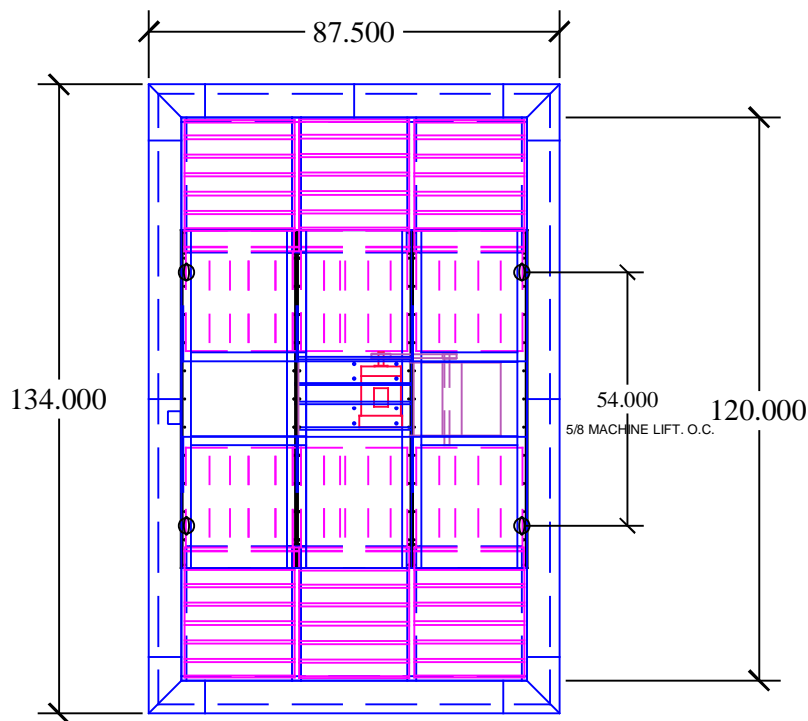
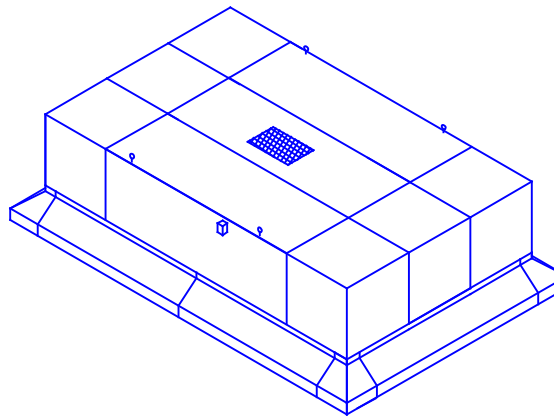

SHEET TITLE : AZTech RH35-3		
DRWG. NO.:	RH33-0518	DRAWN BY: TAA
DATE:	05/10/18	SCALE: NTS

SPECIFICATIONS:

DIMENSIONS:	RH35-3 36.5"H X 87.5" W X 134" D
MOTOR:	2 HP 208-230/460/3/60 TEFC 6.0-5.8/2.9 FLA 3 HP 230/460/3/60 TEFC 8.6/4.3 FLA
CFM:	2 HP - 3500 CFM @ 1.0" W.G. 3 HP - 4450 CFM @ 1.0" W.G.
CONSTRUCTION	11,14, & 16 GA POWDER COATED ST. FRAME. 16 GA. STEEL PANELS (2) DUST PROOF LED LIGHT KITS 4-WAY ALUMINUM EXHAUST GRILLE
ELECTRICAL	WIRED TO JCT. BOX OPT. MOTOR STARTER AVAILABLE
BLOWER:	10 X 10 FORWARD CURVED BLOWER
FILTERS:	2" ALUMINUM BAFFLE PREFILTER OPT. 2" ALUMINUM MESH 4" PLEATED PREFILTER 95% FIBERGLASS BAG FILTER
OPTIONS:	HEPA AFTER FILTER SILENCER MAGNAHELIC PRESSURE GAUGE CURTAIN ENCLOSURE THERMAL SENSOR/ POWER CUT OFF FILTER ACCESS DOORS, EA. END
WEIGHT:	RH35-3 1298 lbs.
NOISE:	2 HP - 71.5 dBA 3 HP - 72.0 dBA



INDUSTRIAL MAID
MFG. BY:

INDUSTRIAL MAID LLC
351 S. 12TH RD.
CORTLAND, NE 68331
Ph. (402) 798-7116
Fax (402) 798-7117
www.industrial-maid.com

distributed by:

COPYRIGHT: This document and the information contained may not be reproduced or distributed without express written consent of INDUSTRIAL MAID. Unauthorized reproduction, disclosure, or manufacturing use are prohibited by copyright law.

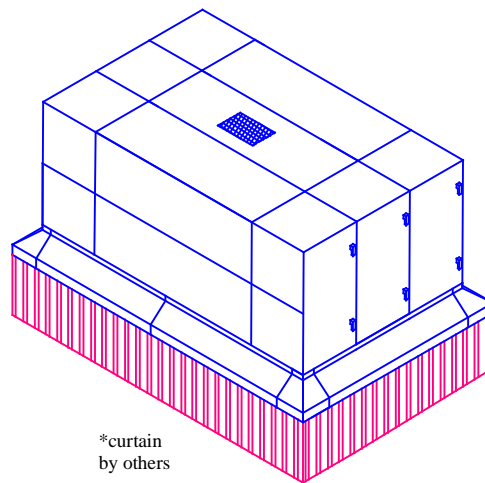
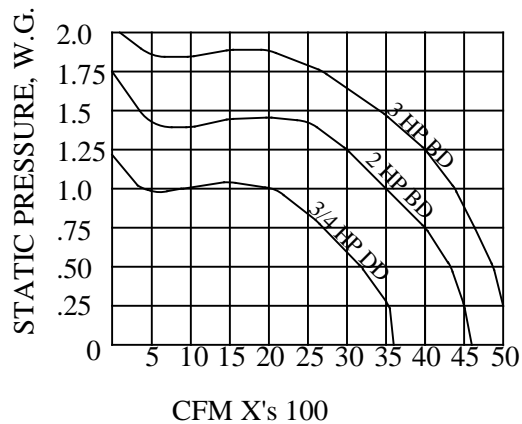

SHEET TITLE : **AZTech 3500 RH-3X2**

DRWG. NO.: **RH332-0518** DRAWN BY: **TAA**

DATE: **05/08/18** SCALE: **NTS**

SPECIFICATIONS:

DIMENSIONS: RH35-3X2 61"H X 87.5" W X 134" D

MOTOR: 2 HP 208-230/460/3/60 TEFC
6.0-5.8/2.9 FLA
3 HP 230/460/3/60 TEFC
8.6/4.3 FLA

CFM: 2 HP - 3500 CFM @ 1.0" W.G.
3 HP - 4450 CFM @ 1.0" W.G.

CONSTRUCTION: 11,14, & 16 GA POWDER COATED ST. FRAME.
16 GA. STEEL PANELS
(2) DUST PROOF LED LIGHT KITS
4-WAY ALUMINUM EXHAUST GRILLE

ELECTRICAL: WIRED TO JCT. BOX
OPT. MOTOR STARTER AVAILABLE
BLOWER: 10 X 10 FORWARD CURVED BLOWER
FILTERS: 2" ALUMINUM BAFFLE PREFILTER
OPT. 2" ALUMINUM MESH
4" PLEATED PREFILTER
95% FIBERGLASS BAG FILTER

OPTIONS: HEPA AFTER FILTER
SILENCER
MAGNAHELIC PRESSURE GAUGE
CURTAIN ENCLOSURE
FILTER ACCESS DOORS, EA. END
THERMAL SENSOR/ POWER CUT OFF

WEIGHT: 2398 LBS

NOISE: 2 HP - 71.5 dBA
3 HP - 72.0 dBA

CONFIDENTIAL

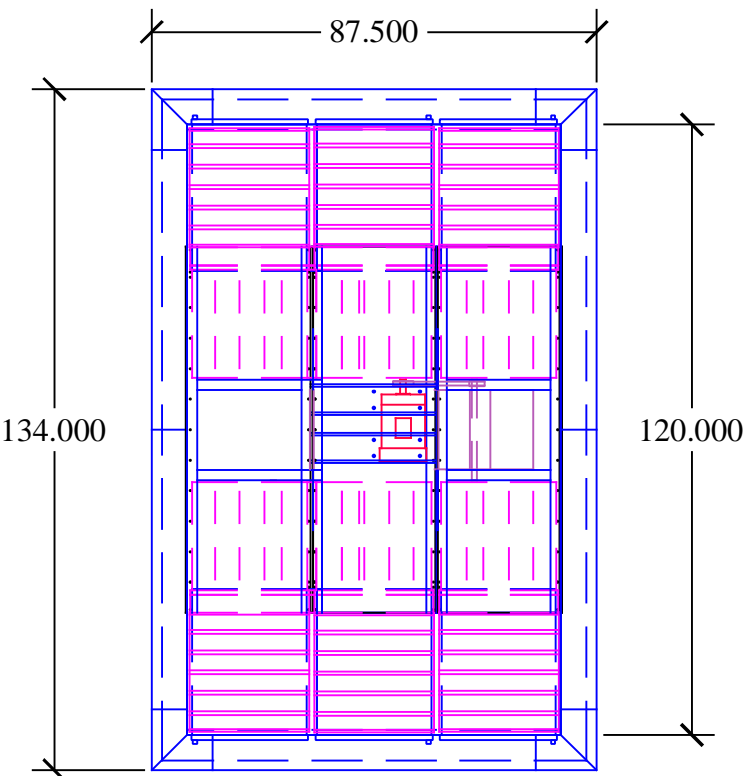
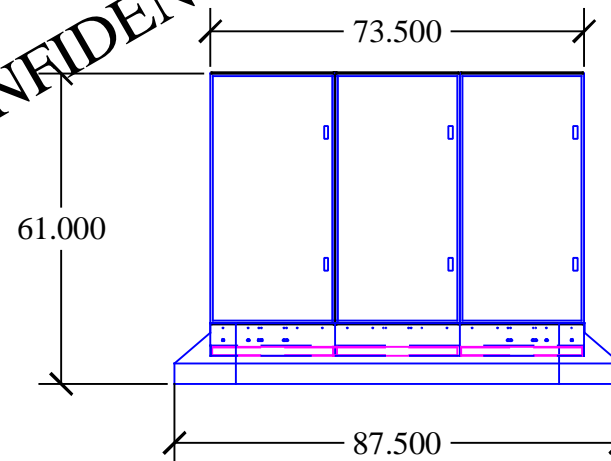

distributed by:

COPYRIGHT: This document and the information contained may not be reproduced or distributed without express written consent of INDUSTRIAL MAID. Unauthorized reproduction, disclosure, or manufacturing use are prohibited by copyright law.



INDUSTRIAL MAID

MFG. BY:

INDUSTRIAL MAID LLC
351 S. 12TH RD.
CORTLAND, NE 68331
Ph. (402) 798-7116
Fax (402) 798-7117
www.industrial-maid.com