

SHEET TITLE : **AZTech OM36X4V -5HPDD**
 DRWG. NO.: **OM36V45-0514** | DRAWN BY: **TAA**
 DATE: **05/06/14** | SCALE: **NTS**

SPECIFICATIONS:

- DIMENSIONS: 132"H X 52" W X 48" D
- MOTOR: 10 HP 230/460/3/60, 23.6/11.8 FLA
- CFM: 3,500 CFM @ 6" W.G.
- ELECTRICAL: WIRED TO JCT. BOX
- BLOWER: DIRECT DRIVE AIR FOIL WHEEL
3450 RPM
- CONSTRUCTION: 12 & 14 GA POWDER COATED STEEL FRAME. (2) 16 GA STEEL DOORS. 3/16 POLYETHYLENE PANELS. ADJ. COMPRESSION HINGES AVAILABLE. 1-1/2 NPT DRAIN 4-WAY ALUMINUM EXHAUST GRILLE CAM DOOR AND FILTER LATCHES
- STD. FILTERS: (4) 2" BAFFLE FILTER
(4) 2" MIST ELIMINATORS
(4) 95% BAG FILTER
- OPTIONAL FILTERS: (4) 2" ALUMINUM MESH FILTERS
(4) 26 LB CARBON MODULES
(4) 4" PLEATED FILTERS
(2) 2" POLY PADS
(4) 4" MIST ELIMINATORS
(4) 99.97% HEPA AFTERFILTERS
- OPTIONS: 24" FLOOR STAND
SILENCER
MAGNAHELIC PRESSURE GAUGE
DUCTED OUTLET (SHOWN)
SOURCE CAPTURE PLENUM
SIDE DOORS
8-18" COLLARS
- WEIGHT: 1227 LBS. - LESS STAND



MFG. BY:
INDUSTRIAL MAID LLC
 351 S. 12TH RD.
 CORTLAND, NE 68331
 Ph. (402) 798-7116
 Fax (402) 798-7117
 www.industrial-maid.com

DISTRIBUTED BY:

COPYRIGHT: This document and the information contained may not be reproduced or distributed without express written consent of INDUSTRIAL MAID. Unauthorized reproduction, disclosure, or manufacturing use are prohibited by copyright law.

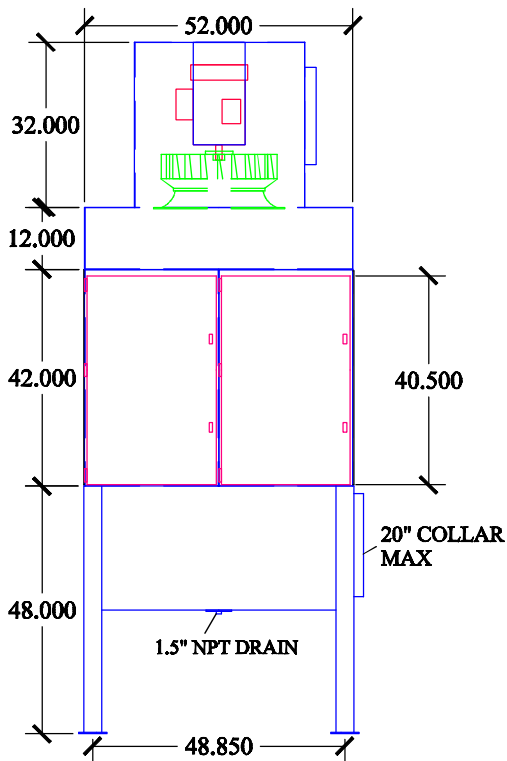
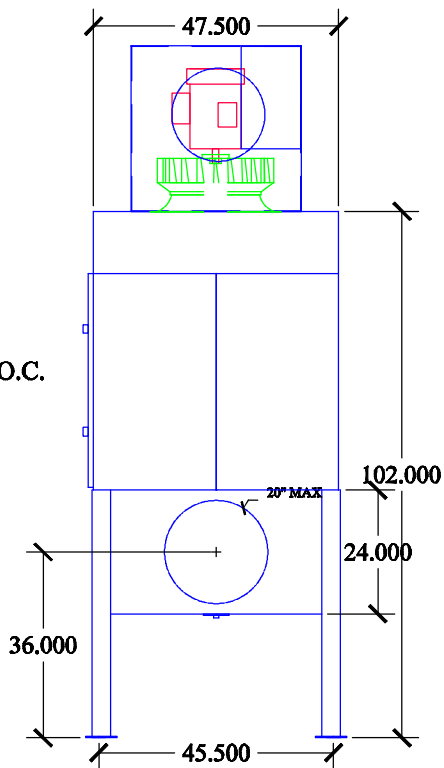
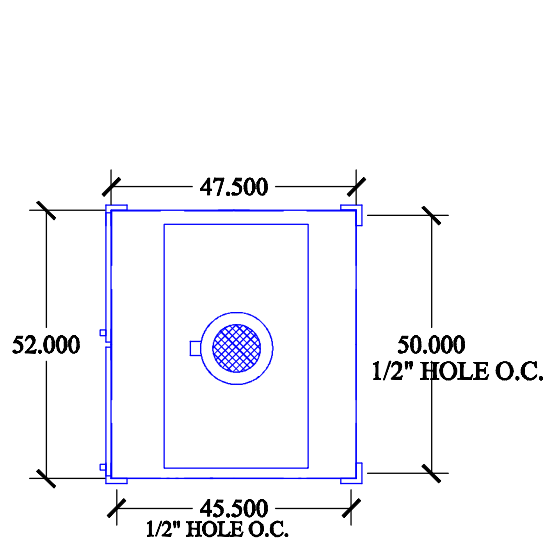
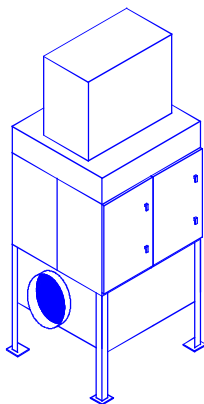
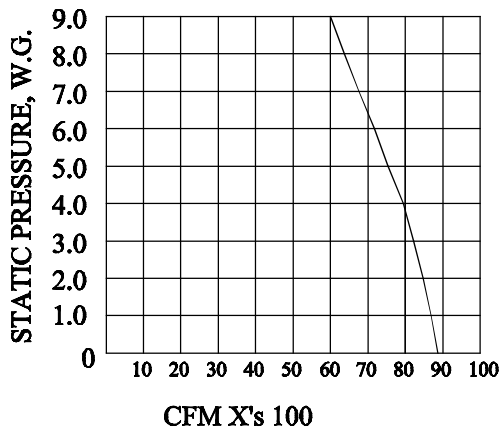

SHEET TITLE : AZTech OM36X4V -15HPDD

DRWG. NO.: OM36V415HPDD013008 DRAWN BY: TAA

DATE: 01/30/08

SCALE: NTS

SPECIFICATIONS:

DIMENSIONS: 130"H X 52" W X 48" D

MOTOR: 15 HP 230/460/3/60, 36.0/18.0 FLA

CFM: 7,500 CFM @ 5.0" W.G.

ELECTRICAL WIRED TO JCT. BOX

BLOWER: DIRECT DRIVE AIR FOIL WHEEL
3450 RPM

CONSTRUCTION 12 & 14 GA POWDER COATED STEEL FRAME, (2) 16 GA STEEL DOORS, 3/16 POLYETHYLENE PANELS, ADJ. COMPRESSION HINGES AVAILABLE, 1-1/2 NPT DRAIN 4-WAY ALUMINUM EXHAUST GRILLE CAM DOOR AND FILTER LATCHES

STD. FILTERS: (4) 2" BAFFLE FILTER
(4) 2" MIST ELIMINATORS
(4) 95% BAG FILTER

OPTIONAL FILTERS: (4) 2" ALUMINUM MESH FILTERS
(4) 26 LB CARBON MODULES
(4) 4" PLEATED FILTERS
(4) 2" POLY PADS
(4) 4" MIST ELIMINATORS
(4) 99.97% HEPA AFTERFILTERS

OPTIONS: 24" FLOOR STAND
SILENCER
MAGNETIC PRESSURE GAUGE
DUCTED OUTLET (SHOWN)
SOURCE CAPTURE PLENUM
SIDE DOORS
8-18" COLLARS

WEIGHT: 1227 LBS. - LESS STAND

DISTRIBUTED BY:

COPYRIGHT: This document and the information contained may not be reproduced or distributed without express written consent of INDUSTRIAL MAID. Unauthorized reproduction, disclosure, or manufacturing use are prohibited by copyright law.



INDUSTRIAL MAID

MFG. BY:

INDUSTRIAL MAID LLC
351 S. 12TH RD.
CORTLAND, NE 68331
Ph. (402) 798-7116
Fax (402) 798-7117
www.industrial-maid.com

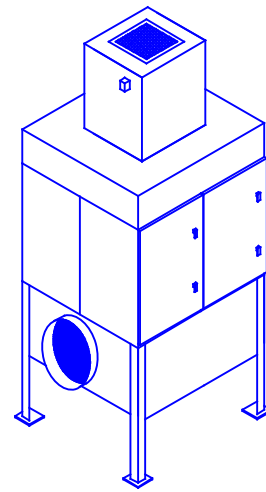
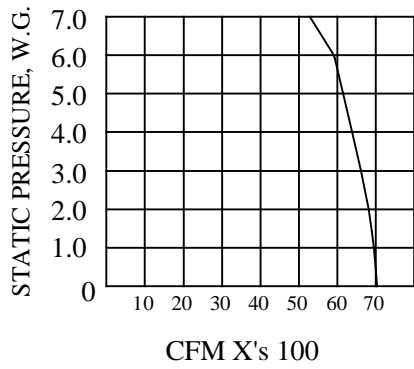

SHEET TITLE : AZTech OM36X4V - 10HPDDV
 DRWG. NO.: OM36V47-0518 DRAWN BY: TAA
 DATE: 05/06/18 SCALE: NTS

SPECIFICATIONS:

- DIMENSIONS: 132"H X 52" W X 48" D
- MOTOR: 10 HP 230/460/3/60, 23.6/11.8 FLA
- CFM: 6,000 CFM @ 5.5" W.G.
- ELECTRICAL: WIRED TO JCT. BOX
- BLOWER: DIRECT DRIVE AIR FOIL WHEEL 3450 RPM
- CONSTRUCTION: 12 & 14 GA POWDER COATED STEEL FRAME. (2) 16 GA STEEL DOORS. 3/16 POLYETHYLENE PANELS. ADJ. COMPRESSION HINGES AVAILABLE. 1-1/2 NPT DRAIN 4-WAY ALUMINUM EXHAUST GRILLE CAM DOOR AND FILTER LATCHES
- STD. FILTERS: (4) 2" BAFFLE FILTER (4) 2" MIST ELIMINATORS (4) 95% BAG FILTER
- OPTIONAL FILTERS: (4) 2" ALUMINUM MESH FILTERS (4) 26 LB CARBON MODULES (4) 4" PLEATED FILTERS (4) 2" POLY PADS (4) 4" MIST ELIMINATORS (4) 99.97% HEPA AFTERFILTERS
- OPTIONS: 24" FLOOR STAND SILENCER MAGNAHELIC PRESSURE GAUGE DUCTED OUTLET (SHOWN) SOURCE CAPTURE PLENUM SIDE DOORS 8-20" COLLARS

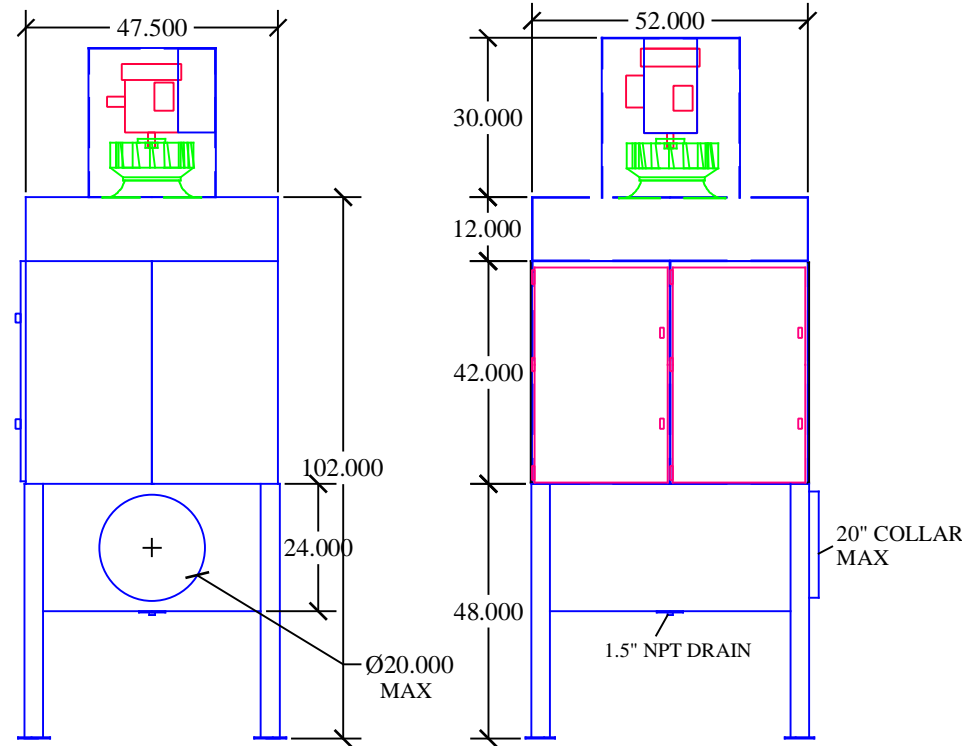
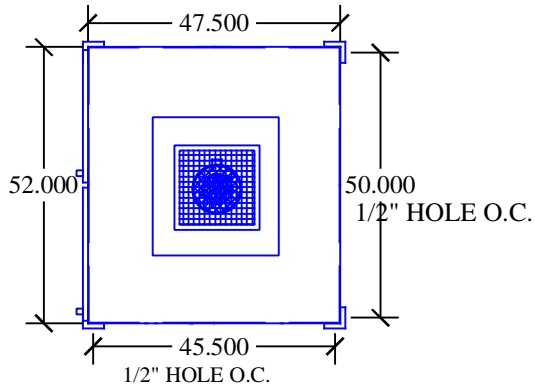

WEIGHT: 1589 LBS. - LESS STAND



INDUSTRIAL MAID LLC
 351 S. 12TH RD.
 CORTLAND, NE 68331
 Ph. (402) 798-7116
 Fax (402) 798-7117
 www.industrial-maid.com

DISTRIBUTED BY:

COPYRIGHT: This document and the information contained may not be reproduced or distributed without express written consent of INDUSTRIAL MAID. Unauthorized reproduction, disclosure, or manufacturing use are prohibited by copyright law.

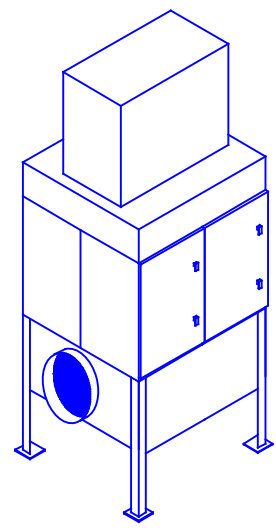
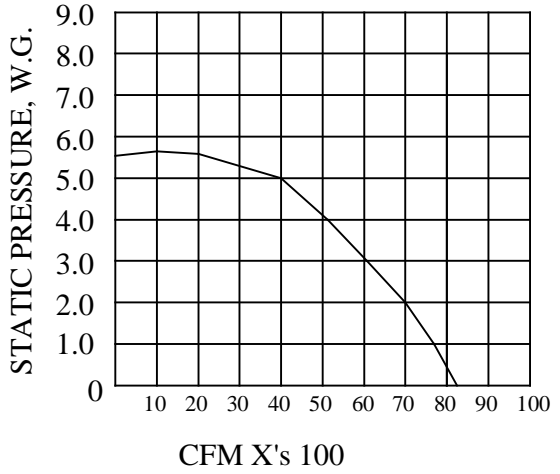

SHEET TITLE : **AZTech OM36X4V -5HPDD**
 DRWG. NO.: OM36V45HPDD-0418 DRAWN BY: TAA
 DATE: 04/03/18 SCALE: NTS

SPECIFICATIONS:

- DIMENSIONS: 130"H X 52" W X 48" D
- MOTOR: 5 HP 208-230/460/3/60, 13.6-14.4/6.2 FLA
- CFM: 5,200 CFM @ 4.0" W.G.
- ELECTRICAL: WIRED TO JCT. BOX
- BLOWER: DIRECT DRIVE AIR FOIL WHEEL
1750 RPM
- CONSTRUCTION: 12 & 14 GA POWDER COATED STEEL FRAME. (2) 16 GA STEEL DOORS. 3/16 POLYETHYLENE PANELS. ADJ. COMPRESSION HINGES AVAILABLE. 1-1/2 NPT DRAIN 4-WAY ALUMINUM EXHAUST GRILLE CAM DOOR AND FILTER LATCHES
- STD. FILTERS: (4) 2" BAFFLE FILTER
(4) 2" MIST ELIMINATORS
(4) 95% BAG FILTER
- OPTIONAL FILTERS: (4) 2" ALUMINUM MESH FILTERS
(4) 26 LB CARBON MODULES
(4) 4" PLEATED FILTERS
(4) 2" POLY PADS
(4) 4" MIST ELIMINATORS
(4) 99.97% HEPA AFTERFILTERS
- SOUND: 77 dBA - STANDARD
- OPTIONS: 24" FLOOR STAND
SILENCER - UPBLAST 76 dBA
MAGNAHELIC PRESSURE GUAGE
MANOMETER
SOURCE CAPTURE PLENUM
SIDE DOORS
8-20" COLLARS
- WEIGHT: 1421 LBS. - LESS STAND

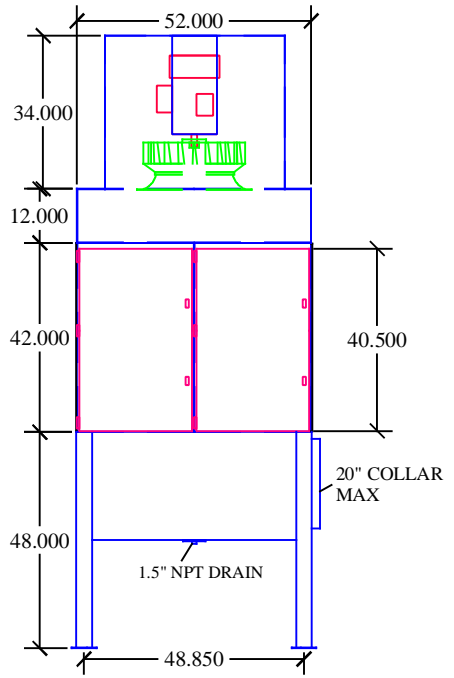
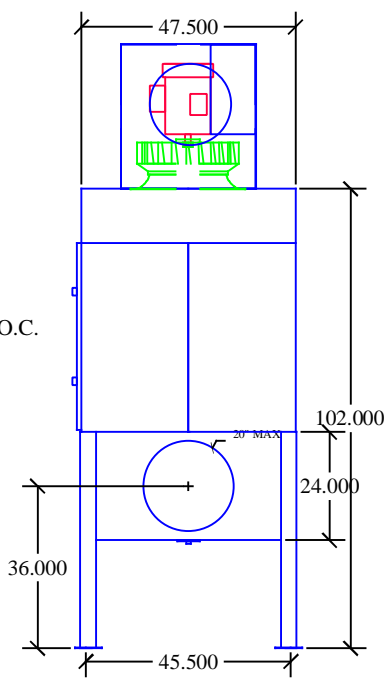
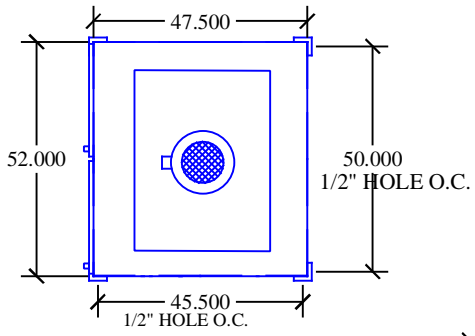

DISTRIBUTED BY:

COPYRIGHT: This document and the information contained may not be reproduced or distributed without express written consent of INDUSTRIAL MAID. Unauthorized reproduction, disclosure, or manufacturing use are prohibited by copyright law.

INDUSTRIAL MAID
 MFG. BY:
INDUSTRIAL MAID LLC
 351 S. 12TH RD.
 CORTLAND, NE 68331
 Ph. (402) 798-7116
 Fax (402) 798-7117
 www.industrial-maid.com