

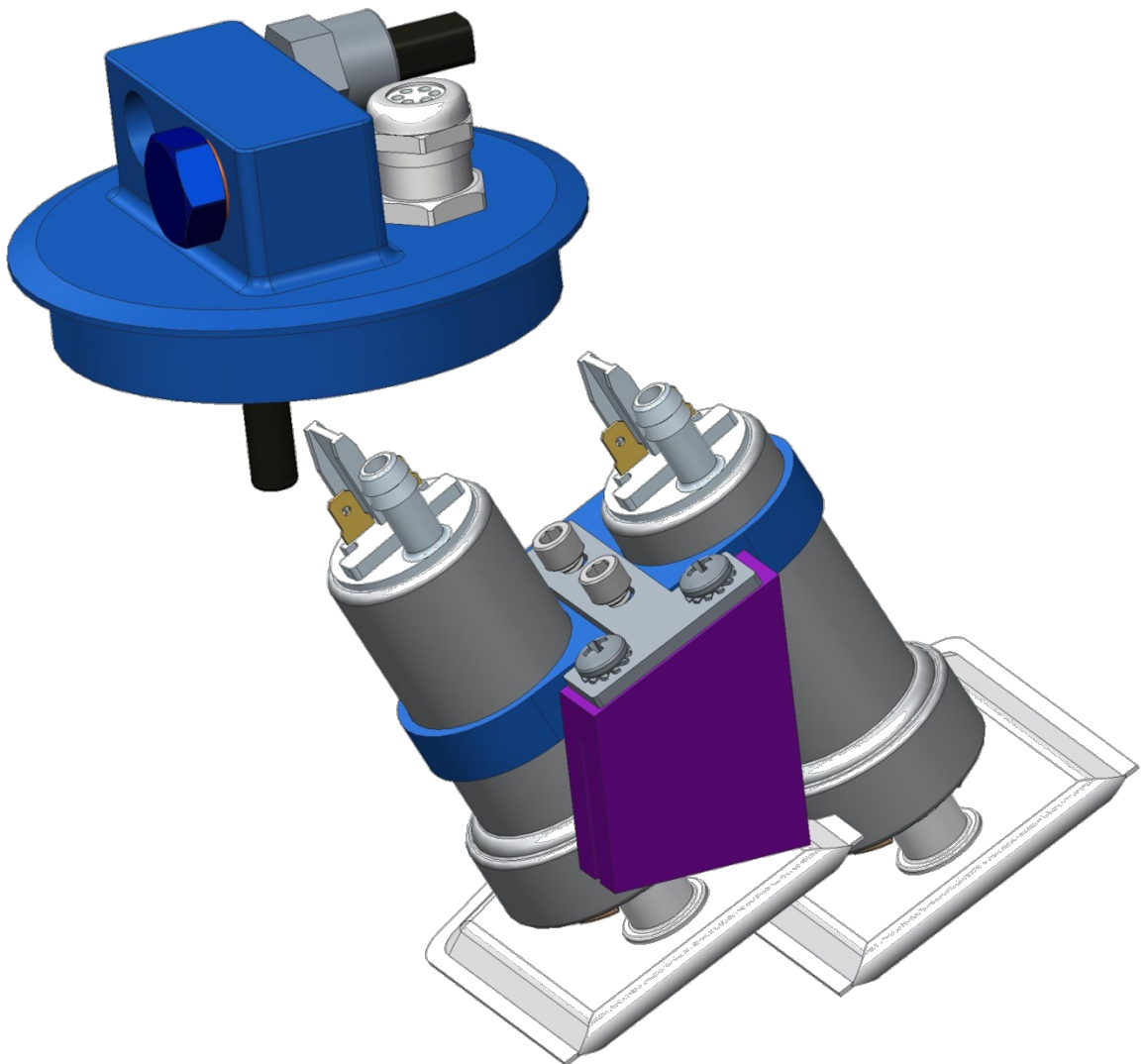

# RALLYROAD.NET E36 DUAL FUEL PUMP HANGER

## Installation Instructions



# Pre-installation positioning of pumps in the dual bracket.

Place the pumps at staggered heights as shown in the picture. This will ensure the pump pickups are sitting at the bottom of the sump when attached to the sump bracket.

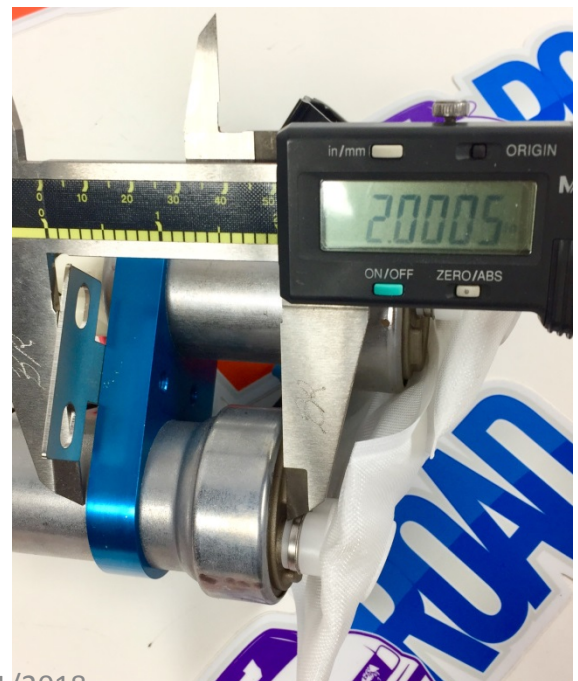
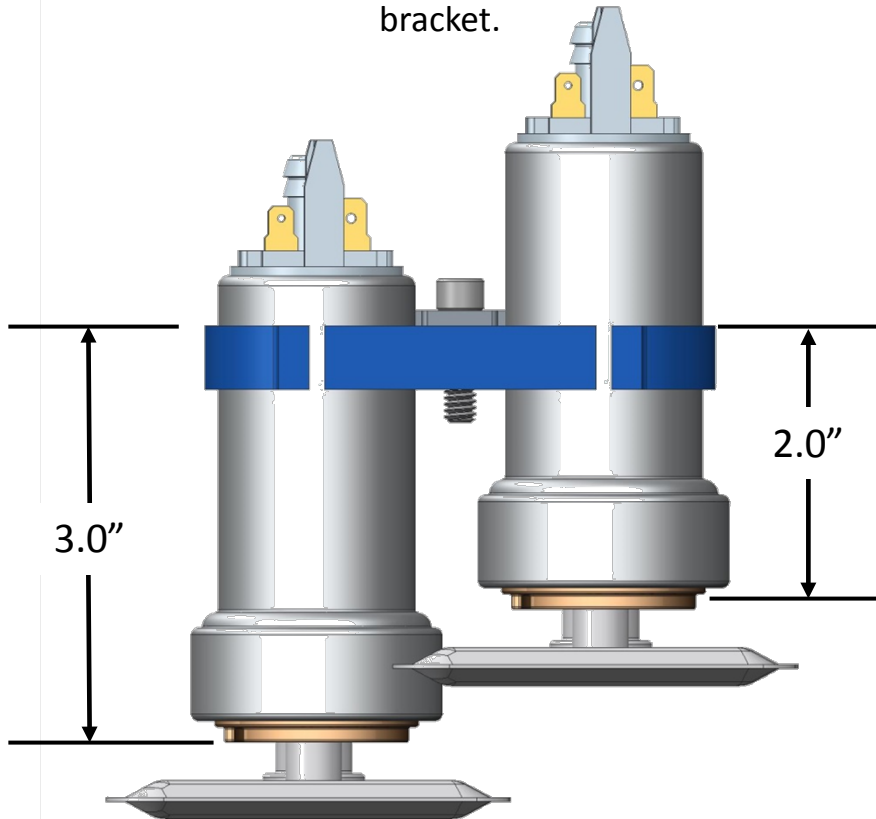

## Installing the pump-to-sump bracket.

Place the purple aluminum sump bracket onto the side wall of the fuel sump. Cut a piece of cardboard to 1.3" in width. Use the cardboard piece to accurately locate the bracket as shown in the picture.



Using the provided 1/8" hex key wrench, tighten the two set screws until they bite into the plastic fuel sump. There are 4 holes for the set screws, but only 2 are needed to keep the sump secure.

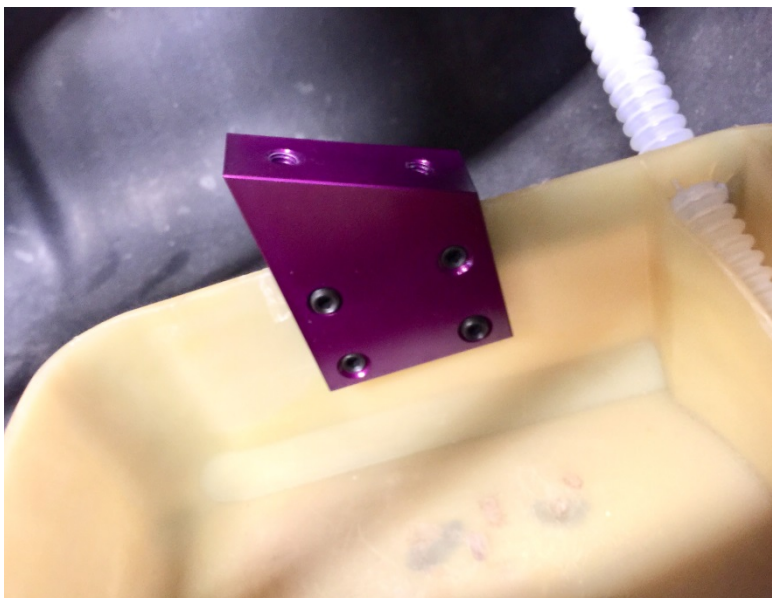

## Securing the pump assembly to the sump bracket.

Attach the corrugated hoses to the Walbro 485 pumps and secure with the clamps that were provided with your pump installation kits. Insert the pumps into the sump and loop the quick connect end of the hose assembly. Use the two M6 screws you previously removed from the pump to sump bracket and reinstall.

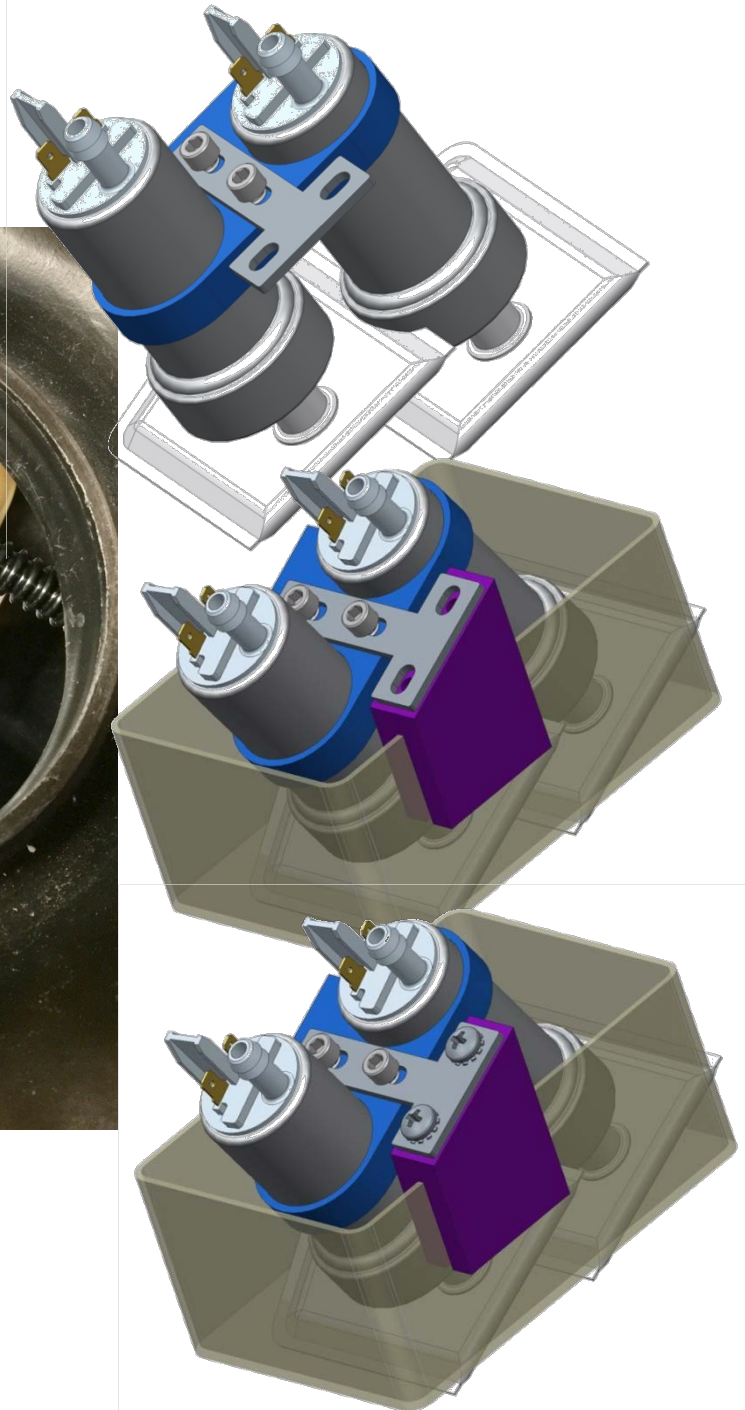

## Internal routing of the fuel supply hose.

Loop the quick connect end of the hose assembly and let it sit outside the tank as shown. Make sure power wire connections are made with enough slack to move the lid, but take care to not interfere with the fuel level sender location.



## Connect fuel supply hose to lid.

Once the fuel line is looped under and up, connect it to the quick connect fitting on the pump lid. It will be a close fit to the fuel level sender assembly. Use the factory rubber lid sealing gasket that was on your original pump (not shown).

After the lid is in place and the factory securing nut is tightened, install the 90 degree swivel O-ring fitting. Hold the fitting in position and tighten the swivel base until the O-ring is seated and fitting is snug. The head of the fitting will still be able to rotate.

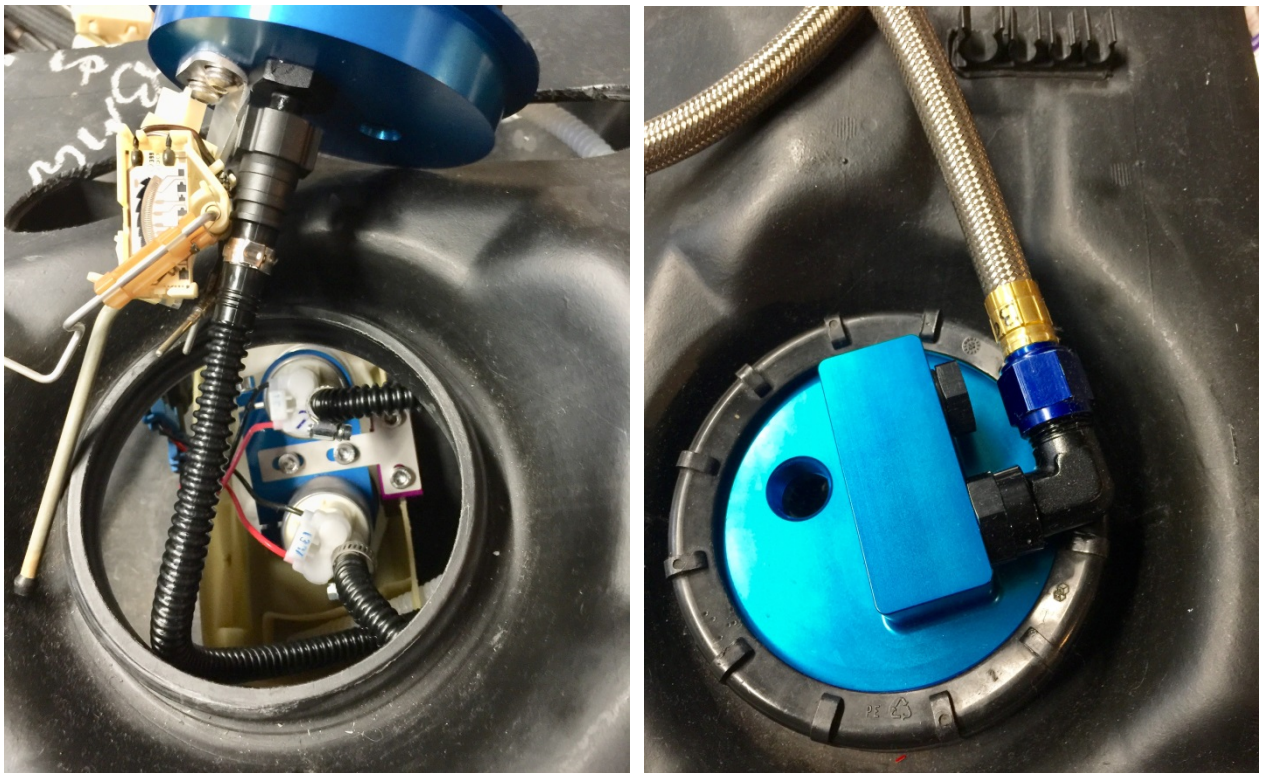

Check to make sure the other fittings are tightened. Connect your -8AN fuel line to the supply fitting. You have now completed the fueling supply portion of the dual pump hanger installation.