

ASSEMBLY PROCESS:

STEP 1



Attach pieces 9 and 10

STEP 2



Attach 8 to the step 1

STEP 3



Attach pieces 1 and 7

STEP 4



Attach 3 to 7 as the picture shows

STEP 5

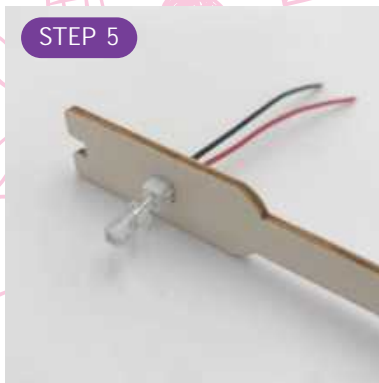

Put the longer wire of the light into the hole connected to the red wire and put the shorter wire into the hole for the black wire.

STEP 6



Assemble 2 to 1

STEP 7

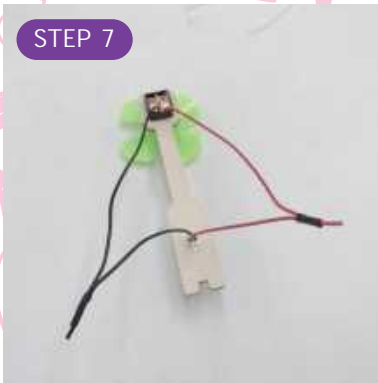

Connect the wires as in the picture. Wrap the bare wire with 5 with the wire cap.

STEP 8



Fasten the wire with 6

STEP 9



Completed

NOTE:

1. When assembling the wood accessories ensure to press them together slowly and firmly.
2. You can also stick the wood pieces together with glue for more stability

WIND POWER GENERATOR

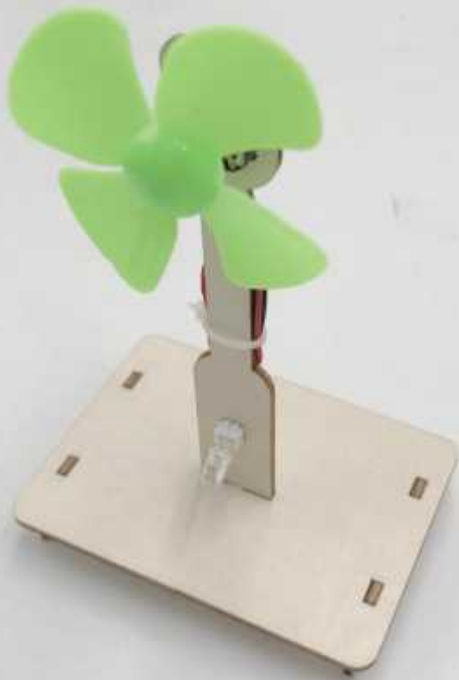

Experimental principle:

Using wind power rather than electrical power to produce an energy current. When the fan is spinning quickly the wind power converts to electric power and provides power for the light to illuminate. Similar day-to-day examples of this principle are, an electric fan, an air conditioner, a kitchen ventilator, a wind power electric generator and a steamship.

Warning: Recommended for ages 6+. Adult supervision is required. Due to small parts please ensure to be accompanied by a parent during assembly. Do not put any parts of this kit in the mouth.

