

# RESILIENT GATE VALVE OS&Y FM/UL DN80 - DN300 MODEL: RSGV3299-300-F



## FEATURES

- Valves comply with AWWA C515
- Working pressure 300PSI
- Working temperature 0.6°C to 52°C
- FM/UL Approved
- Optional ISO 5211 Mounting Pad
- Other flange drillings available on request

## CONSTRUCTION

- The Hand Wheel is attached to the yoke by a heavier nut
- Stem is sealed by high quality graphite
- One brass plug screwed on body
- Fusion bonded epoxy coated interior and exterior



ITEM	COMPONENT	MATERIAL	GRADE
1	Body	Ductile Iron	ASTM A536 65-45-12
2	Wedge	Ductile Iron with EPDM Coated	
3	Wedge Nut	Stainless Steel	ASTM A276 304
4	Pin	Stainless Steel	ASTM A276 304
5	O-Rings	NBR	
6	Gasket	EPDM	
7	Stem	Stainless Steel	ASTM A276 304
8	Bonnet	Ductile Iron	ASTM A536 65-45-12
9	Packing	Graphite	
10	Gland	Ductile Iron	ASTM A536 65-45-12
11	Yoke Nut	Bronze	ASTM B148 C95200
12	Washer	Brass	
13	Hand Wheel Nut	Ductile Iron	ASTM A536 65-45-12
14	Hand Wheel	Ductile Iron	ASTM A536 65-45-12
15	Bolts	Stainless Steel	AISI 304
16	Nuts	Stainless Steel	AISI 304
17	Washers	Stainless Steel	AISI 304
18	Bonnet Bolts	Stainless Steel	AISI 304
19	Plug	Stainless Steel	AISI 304

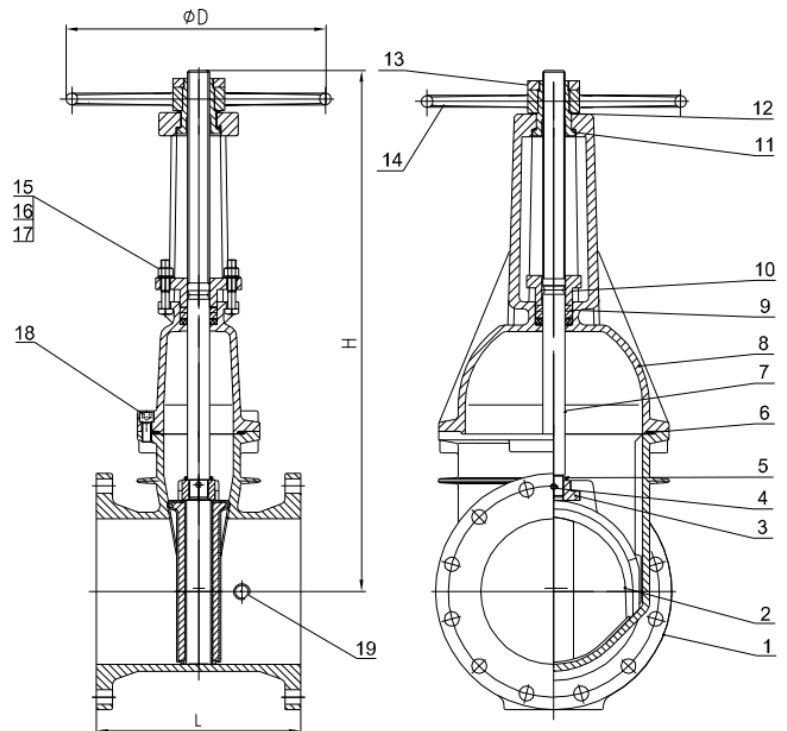

DIMENSIONS											
Size	L	H (Open)	H (Close)	D	Flange Drilling				Number of Turns	Torque (NM)	Weight (kgs)
					AS2129 T/E (PCD)	n-Ød	ANSI #125(PCD)	n-Ød			
DN80	203	480	400	254	146	4 x 18	152	4 x 18	10	70	28
DN100	229	550	450	254	178	8 x 18	191	8 x 18	13.5	100	30
DN125	254	655	530	305	210	8 x 22	216	8 x 22	16	145	46
DN150	267	740	590	305	235	8 x 22	241	8 x 22	19.5	150	53
DN200	292	930	730	356	292	8 x 22	299	8 x 22	26	205	75
DN250	330	1130	880	445	356	12 x 22	362	12 x 24	32	252	125
DN300	356	1320	1020	445	406	12 x 26	432	12 x 24	38.5	306	175

