

LED Emergency Exit Sign

TYPE: CR-7037R;CR-7037G

LED Emergency Exit Sign accord with US STANDARD - Injection-molded, flame-retardant and high impact thermoplastic housing.This exit sign with design is great for placing on doorways, isles, restaurant, office building and warehouses.



CR-7037R



CR-7037G

Standard:Double-Face free parts in package



| SPECIFICATION | |
|---------------------|-----------------------------------|
| TYPE | CR-7037R / CR-7037G |
| WORKING VOLTAGE | 120V / 277V 50Hz/60Hz |
| EFFICACY | 0.86 |
| POWER CONSUMPTION | 4 W |
| INPUT CURRENT | 100mA |
| RECHARGE TIME | 24 Hours |
| OUTPUT WATTAGE | 1W |
| EMERGENCY DURATION | ≥90 Mins |
| BATTERY | 1.2V |
| FACTORY SETTING | Double-Face free parts in package |
| ENVIRONMENT | DAMP |
| WORKING TEMPERATURE | 0°C ~ 40°C |
| CERTIFICATION | UL |
| CABLE | Input Connect, No cable |
| WARRANTY | 2 year limited |

DIMENSION:

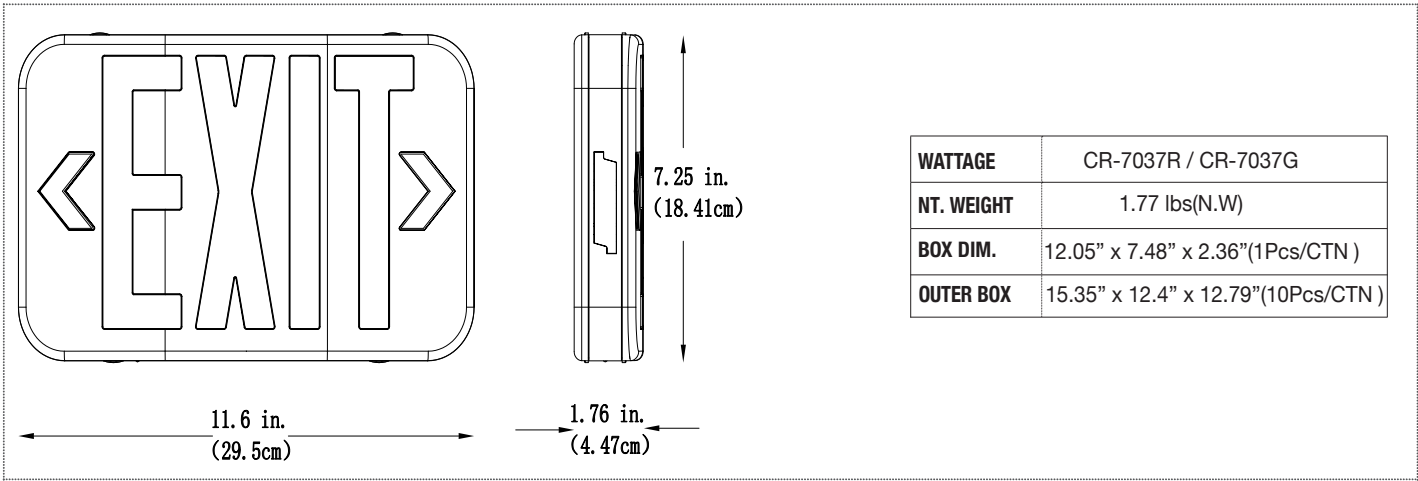

LED Emergency Exit Sign

TYPE: CR-7037R;CR-7037G

ORDERING INFORMATION

EXAMPLE:

CR-7037R / CR-7037G

| CR | 7037 | R |
|---------|----------------------|--------------------|
| CODE | CODE | FINISH |
| WSD LED | 7037 Product Code | G(Green) R(Red) |

ACCESSORIES (Standard)



CR-7037R / CR-7037G



Blank panel

WIRING DIAGRAM:

CR-7037R / CR-7037G

Make the proper supply wire connections.
If using 120VAC, connect the black and White wires to the building utility.
If using 277VAC, connect the Orange and White wires to the building utility.

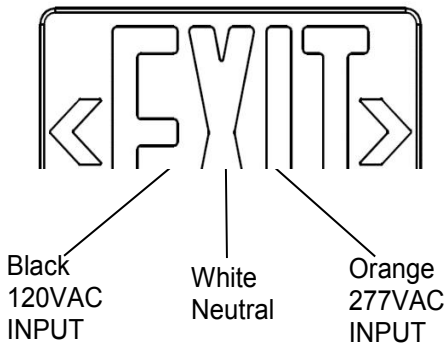

LED Emergency Exit Sign

TYPE: CR-7037R;CR-7037G

Mounting Instructions

NOTE: First turn off electricity.

1.Remove mounting plate from fixture.



2.Knockout in back of mounting plate and push wires through the hole.

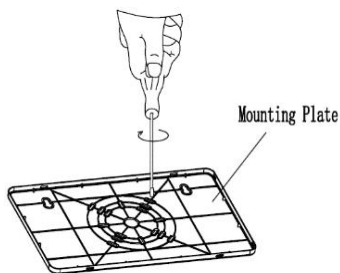

3.Securely attach mounting plate to J-box (not provided).

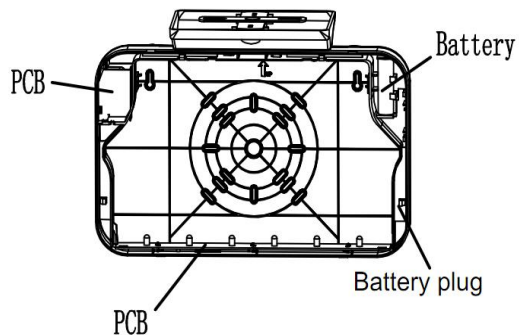
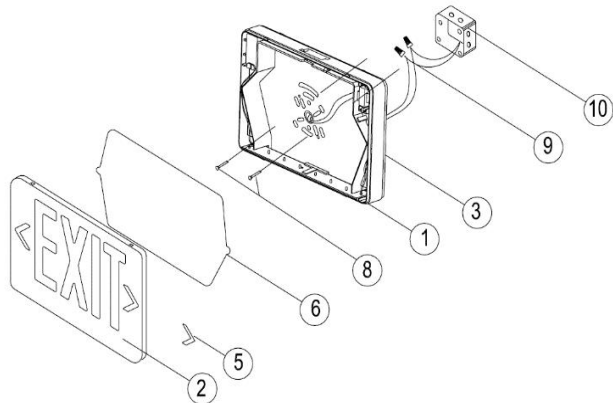

4.ELECTRICAL CONNECTIONS

Make the proper supply wire connections.

If using 120VAC, connect the black and White wires to the building utility.

If using 277VAC, connect the Orange and White wires to the building utility.

