

Proprietary part
designed by and
intellectual property
of Allied Stainless



DEBURR ALL EDGES
ROUTER SUPERCEDES PRINT
UNLESS OTHERWISE SPECIFIED:
DIMENSIONS ARE IN INCHES
ALL ANGLES ARE 90°

TOLERANCES
DECIMALS ANGULAR
X ± .100 x.x ± 0.5°
.XX ± .020 x. ± 1.0°
XXX ± .005

UNLESS OTHERWISE SPECIFIED:
ALL BEND DIMENSIONS ± .020
DO NOT SCALE DRAWING

MATL 304ss
FINISH #4 polish
DATE 9/21/2021
DRAWN BY: Dustin
APPROVED: -
SHEET 1 OF 4

PART NAME SB-ICE-BIN-19278
Drawing NO. :
REV. |

File Name (no extension)	Quantity	Gage	Material
SB-ICE-BIN-19278 45LB ICE BIN TOP FLANGE-10	1	16 gage	Stainless steel, 304

File Name (no extension)	Quantity	Gage	Material
SB-ICE-BIN-19278 45LB ICE BIN body-12	1	16 gage	16ga Stainless Steel, 304

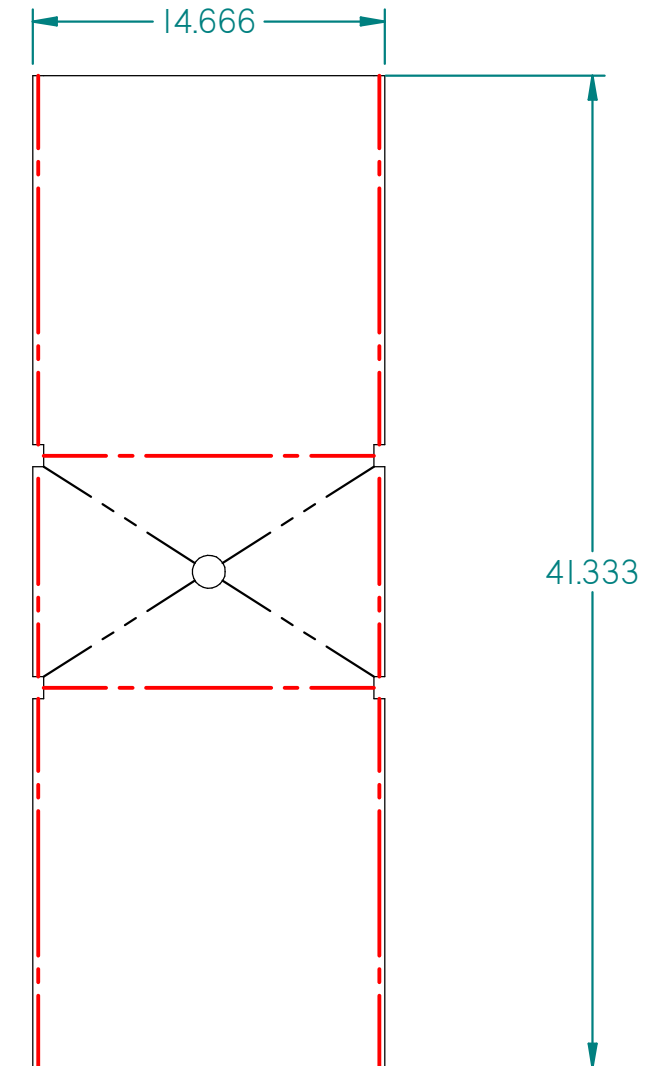
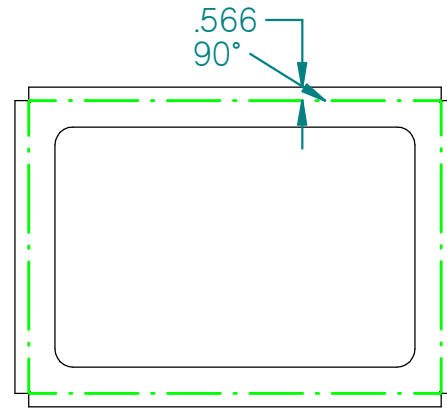

File Name (no extension)	Quantity	Gage	Material
SB-ICE-BIN-19278 45LB ICE BIN ends-12	2	16 gage	Stainless steel, 304

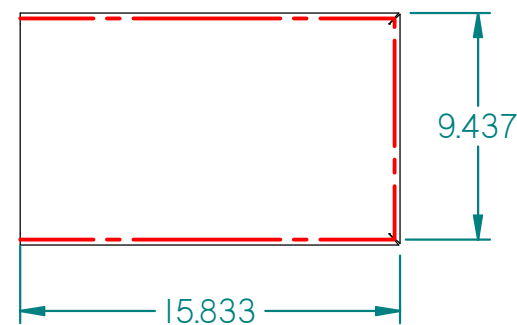

Proprietary part
designed by and
intellectual property
of Allied Stainless



DEBURR ALL EDGES
ROUTER SUPERCEDES PRINT
UNLESS OTHERWISE SPECIFIED:
DIMENSIONS ARE IN INCHES
ALL ANGLES ARE 90°

TOLERANCES
DECIMALS ANGULAR
X ± .100 x.x ± 0.5°
.XX ± .020 x. ± 1.0°
.XXX ± .005

UNLESS OTHERWISE SPECIFIED:
ALL BEND DIMENSIONS ± .020
DO NOT SCALE DRAWING

MATL 304ss
FINISH #4 polish
DATE 9/21/2021
DRAWN BY: Dustin
APPROVED: -
SHEET 2 OF 4

PART NAME SB-ICE-BIN-19278
Drawing NO. :
REV. 1

File Name (no extension)	Quantity	Gage	Material
SB-ICE-BIN-19278 45LB ICE BIN COVER FRAME-10	1	16 gage	Stainless steel, 304

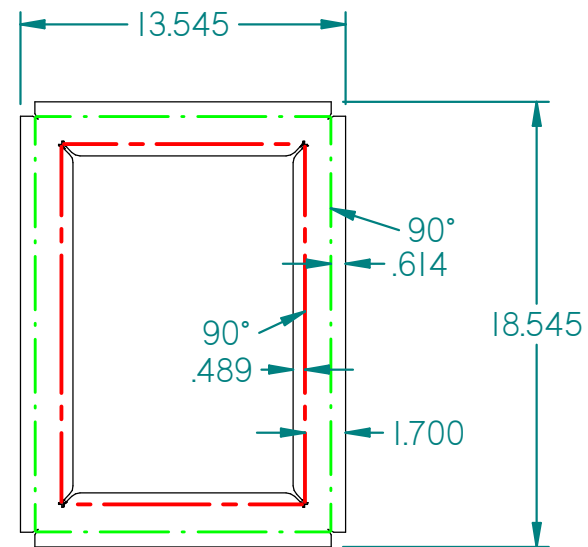

File Name (no extension)	Quantity	Gage	Material
SB-ICE-BIN-19278 45LB ICE BIN JACKET END-10	2	18 gage	Stainless steel, 304

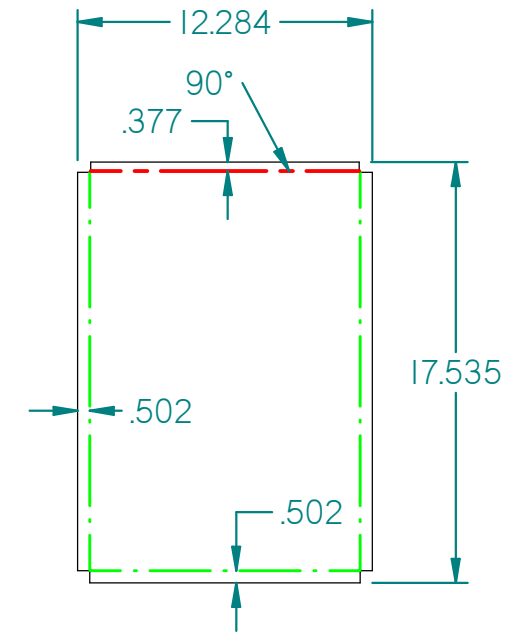

File Name (no extension)	Quantity	Gage	Material
SB-ICE-BIN-19278 45LB ICE BIN JACKET BODY-10	1	18 gage	Stainless steel, 304

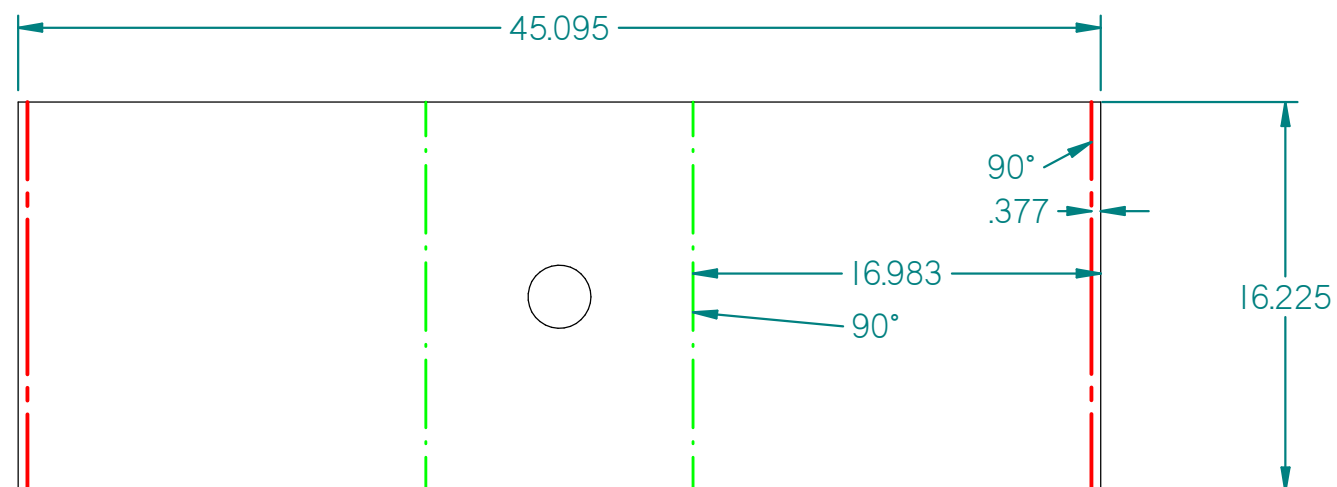

Proprietary part
designed by and
intellectual property
of Allied Stainless



DEBURR ALL EDGES
ROUTER SUPERCEDES PRINT
UNLESS OTHERWISE SPECIFIED:
DIMENSIONS ARE IN INCHES
ALL ANGLES ARE 90°

TOLERANCES
DECIMALS ANGULAR
X ± .100 X.X ± 0.5°
.XX ± .020 x. ± 1.0°
XXX ± .005

UNLESS OTHERWISE SPECIFIED:
ALL BEND DIMENSIONS ± .020
DO NOT SCALE DRAWING

MATL 304ss
FINISH #4 polish
DATE 9/21/2021
DRAWN BY: Dustin
APPROVED: -
SHEET 3 OF 4

PART NAME
SB-ICE-BIN-19278
Drawing NO. :
REV. : 1

File Name (no extension)	Quantity	Gage	Material
SB-ICE-BIN-19278 45LB ICE BIN FRONT LID-10	1	18 gage	Stainless steel, 304

File Name (no extension)	Quantity	Gage	Material
SB-ICE-BIN-19278 45LB ICE BIN REAR LID-10	1	18 gage	Stainless steel, 304

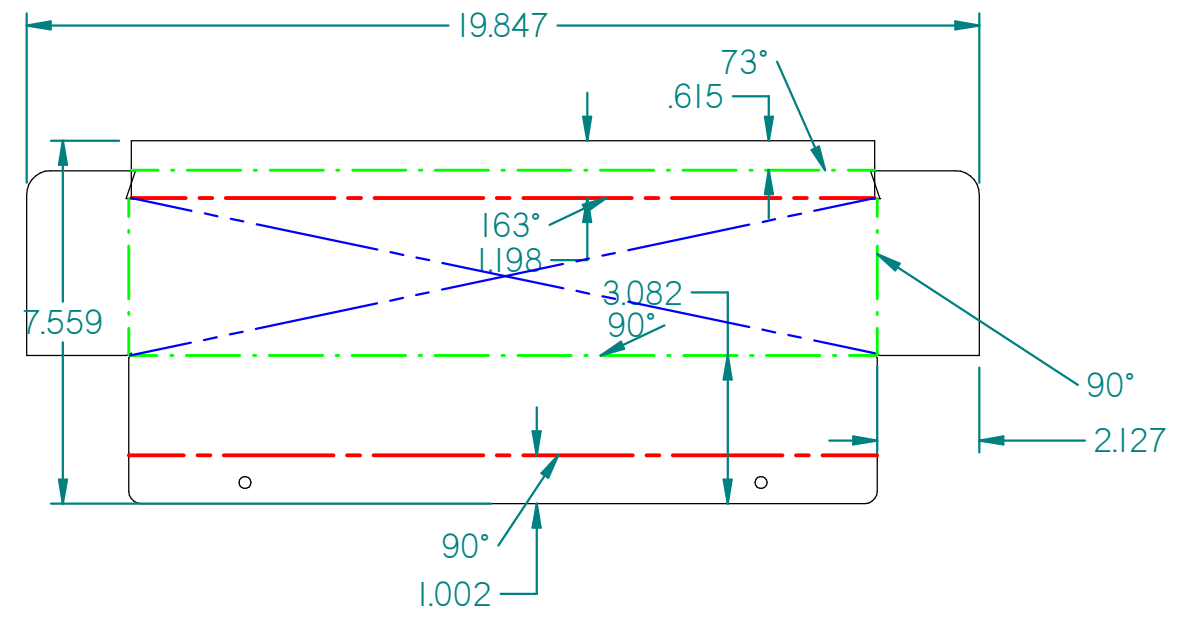
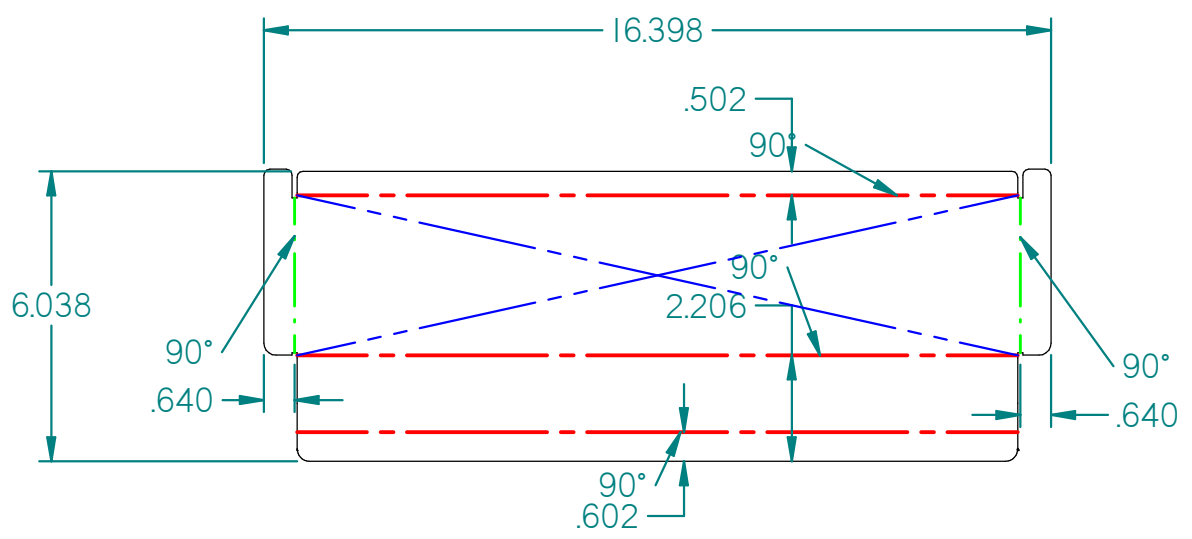

BLUE LINES ARE
BUMP CREASES
UPWARD

File Name (no extension)	Quantity	Gage	Material
SB-ICE-BIN-19278 45LB ICE BIN MID LID-10	1	18 gage	Stainless steel, 304

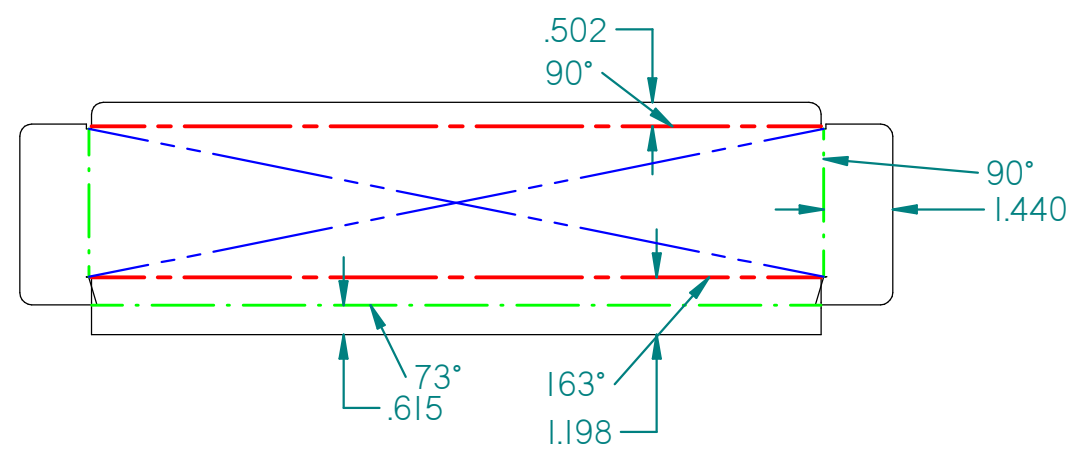

.750 RADIUS

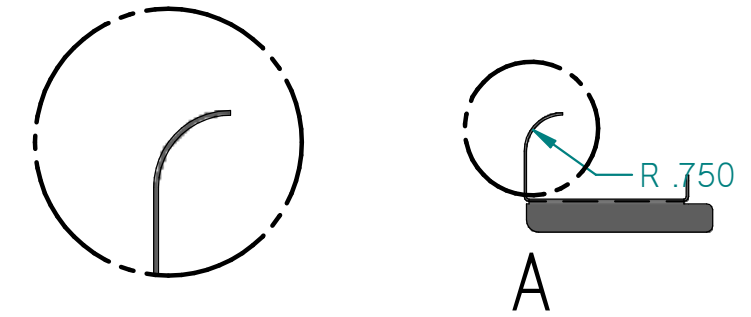

DETAIL A

Proprietary part
designed by and
intellectual property
of Allied Stainless



DEBURR ALL EDGES
ROUTER SUPERCEDES PRINT
UNLESS OTHERWISE SPECIFIED:
DIMENSIONS ARE IN INCHES
ALL ANGLES ARE 90°

TOLERANCES
DECIMALS ANGULAR
X ± .100 X.X ± 0.5°
.XX ± .020 x. ± 1.0°
XXX ± .005

UNLESS OTHERWISE SPECIFIED:
ALL BEND DIMENSIONS ± .020
DO NOT SCALE DRAWING

MATL 304ss
FINISH #4 polish
DATE 9/21/2021
DRAWN BY: Dustin
APPROVED: -
SHEET 4 OF 4

PART NAME
SB-ICE-BIN-19278

Drawing NO. REV. 1