



# SMRT-WALL-OCC-VAC-PIR-DIM

PASSIVE INFRARED (PIR) MOTION SENSOR  
WALL MOUNT, 0-10V DIMMING  
OCCUPANCY OR VACANCY, DAYLIGHT HARVESTING



## SPECIFICATIONS

Rating..... 120 -277 V~ 50 / 60 Hz, 800W Electronic fluorescent ballast or LED driver

## DESCRIPTION

The PIR Dimming Wall Switch works by detecting the difference between heat emitted from the human body in motion and the background space. The PIR Sensor Switch can turn a load on and hold it as long as the switch detects occupancy. After no motion is detected for the set time delay, the load turns off automatically. The PIR Sensor Switch is to turn ON/OFF and control the brightness level of the connected lighting load.

### Coverage Area

The coverage range of the PIR Sensor Switch is specified and illustrated in Figure 1. Large objects and some transparent barriers such as glass windows will obstruct the switch's view and prevent detection, causing the light to turn off even though the detection area is occupied.

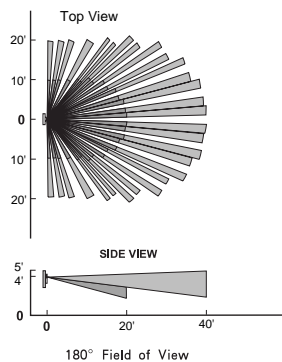

Best: 320 sq.ft.  
Regular: 800 sq.ft.  
Maximum: 1200 sq.ft.

Figure 1

# INSTALLATION INSTRUCTIONS

**WARNING:** Turn off the circuit breaker before installation.  
Indoor use only.  
Do not exceed electrical ratings.

## INSTALLATION

1. Make sure that the power has been turned OFF at the circuit breaker.
2. Connect the SMRT-WALL-OCC-VAC-PIR-DIM as shown in the WIRING DIAGRAM (see Figure 2).

### Wiring Diagram

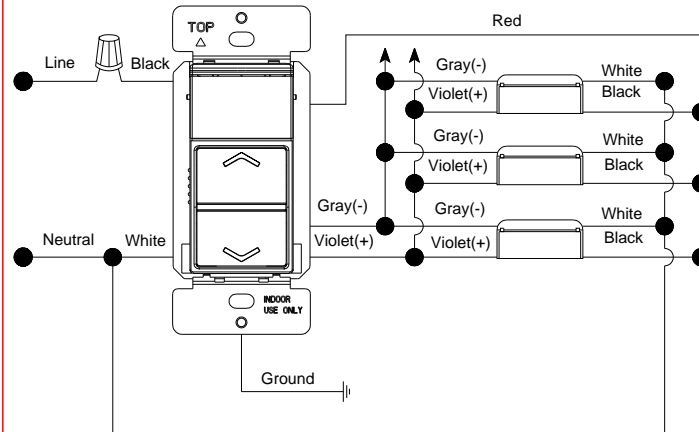

Figure 2

3. Check connections to be sure they are tight and that there are no bare conductors exposed.
4. Insert the SMRT Sensor into the wall box carefully.
5. Make sure the SMRT Sensor is mounted to the box using the supplied screws.
6. Attach the wall plate.
7. Restore power at the circuit breaker, Installation is complete.

### Open The Panel Cover

Gently remove the panel cover using a flat blade screwdriver. Find the slots at the bottom left or right of the panel cover and pry the panel cover loose. See Figure 3.

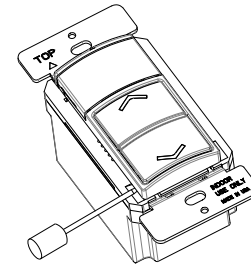

Figure 3

## ADJUSTMENT

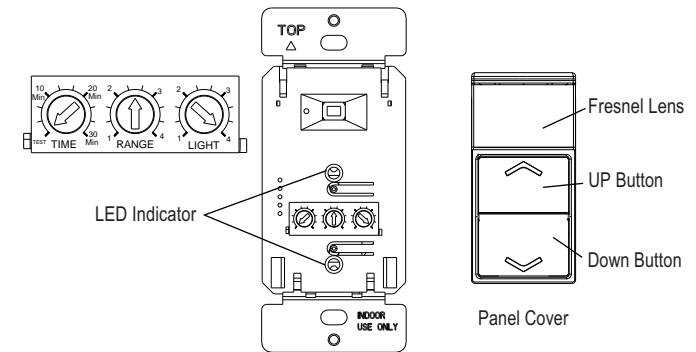

Figure 4

### Time Delay Knob

Default position: 15 Seconds (Test mode)  
Adjustable: from 15 Seconds to 30 Minutes (clockwise)

### Sensor Sensitivity Range Knob

Default position: Center at 65%  
Adjustable: 30% (Position 1) to 100% (Position 4)

Note: Turn toward right for greater room space.  
Turn toward left to avoid false alert in smaller room and near the door way or heat source.

### Ambient Light Level Knob

Default position: Daylight (100% at position 4)  
Adjustable: Daylight to 30Lux (Counter clockwise)  
Note: to avoid wasting energy by turning the light in daylight.

# INSTALLATION INSTRUCTIONS

## ◆ OPERATION

### Operating Modes

#### (Occupancy Mode) Auto On/Automatic Off Lights. ---Default Mode

The Light will automatically turn ON by PIR. Auto OFF by time delay.

- Tap the UP button to turn ON, lights turn ON and then turn OFF by preset time delay.
- Tap the DOWN button to turn OFF, lights turn off completely. After 15 seconds, PIR resets and lights turn ON if motion is detected.

#### (Vacancy Mode) Manual On/Automatic Off Lights.

Tap the UP button to turn the Lights ON and Lights turn OFF automatically after preset time delay.

- If motion is detected (within 30 seconds) of the lights turning off, the Lights turn ON.
- Tap the DOWN button to turn OFF, lights turn off completely.

#### Switch Back And Forth Between VAC And AUTO Mode.

LED Indicator : BI-Color (red or white LED)

Press and hold both UP and DOWN buttons for 3 seconds, the white led flashes twice, it allows users to switch to VAC MODE. Press and hold both UP and DOWN buttons again for 3 seconds, it allows users to switch to AUTO MODE.

### Manual Control--Dimming

Turn ON/OFF and control the brightness level of the connected lighting.

- To turn the connected lighting ON: Tap the UP button of the switch.
- To turn the connected lighting OFF: Tap the DOWN button of the switch.
- To brighten the connected lighting: Press and hold the UP button of the switch , release when desired level is achieved.
- To dim the connected lighting: Press and hold the DOWN button of the switch , release when desired level is achieved.

## ◆ TROUBLESHOOTING

### The Load turns On when not desired

1. Switch from OCC to VAC mode.
2. Mask the Sensor Dimmer Switch's lens to eliminate unwanted coverage area.
3. Turn the Sensitivity Level knob toward left to avoid false alert in smaller room and near the door way.

### The Load does not turn Off

1. Check if there is any significant heat source mounted within six feet (two meters) that may cause false detection such as high wattage light bulb.
2. Check the wiring connections.

## ◆ WARRANTY INFORMATION

SMRT Commercial Lighting Controls offers a Limited Lifetime Warranty on products that are deemed defective, and are not defective as a result of installation errors, such as but not limited to incorrect wiring, voltages etc. Contact your local Representative or the factor for details.

[www.installsmrtcontrols.com](http://www.installsmrtcontrols.com)

2023 SMRT Commercial Lighting Controls, a division of KPAL Ventures LLC.  
All rights reserved. Subject to change without notice.