

Orthodontic Products

Catalog

IMD



NEW COMING: CRYSTAL 3D | MEMAlloy | Beta titanium | Cu-Alloy | Ophro | Act MIM |

CONTACT INFORMATION

IMD International Sales Team

Perry Haque

Director Global Sales

USA Address: 6065 Parkway North Dr.
Ste. #600 Cumming, GA 30040

Cell USA : +1 858 999 4208

Email: perry.haque@imdmedical.com

Rolland Liu

International Sales Coordinator Manager
(Asia)

Email: rolland@imdmedical.com

Tel: 86-21-59156556-118

Fax:86-21-59156686 Cell:0086-13816971261

William Shen

Middle East / Europe

Email: william.shen@imdmedical.com

Tel: 86-21-59156556-116

Fax:86-21-59156686 Cell:0086-18217700953

Ryan Zhou

South America / Canada

Email: Ryan.zhou@imdmedical.com

Tel: 86-21-59156556-117

Fax:86-21-59156686 Cell:0086-18121339446

Superior Orthodontic Products

Providing high quality products,
service and innovative ideas at
a competitive price.

Sino-American joint venture company

Add: Building#5, NO. 615 Fengdeng Rd.,
Jiading District, Shanghai 201801, China.
<http://en.imdmedical.com/>

World Wide Distributor



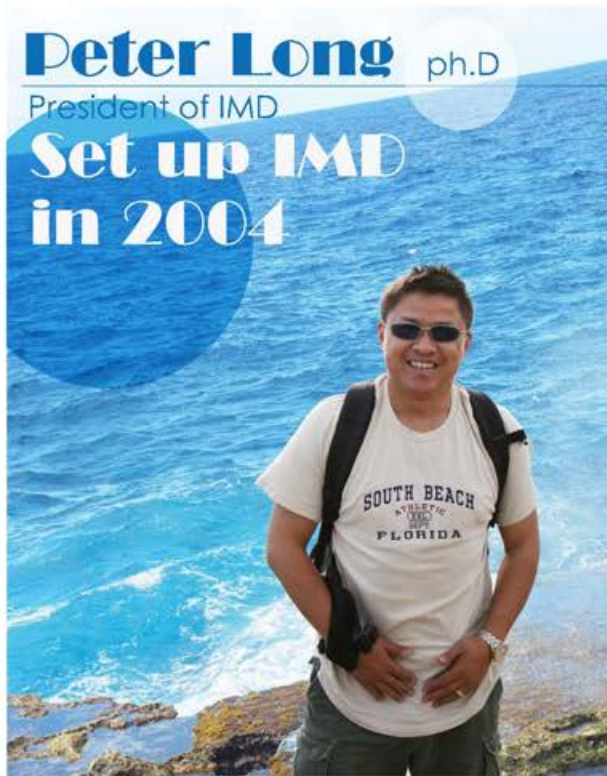

Dear Doctors:

We at Innovative Material and Devices, Inc.(IMD) are excited to present you with the new edition of our catalog! As you can see, the catalog has expanded in size as our product line has continued to grow over these years.

The key to our rapid success has been a strong emphasis on strict quality control. We've aimed to take every process of production, service and manage it in-house with our modern facilities and advanced concept. From the brackets manufacturing technology to archwires polishing process, from the product package to marketing literature, we control each step, ensuring the high quality in the whole process. This type of internal control ensures every single manufacturing step of IMD products is under extremely strict control at our quality standard, which made us qualified for ISO 9001, ISO 13485, CE mark medical device and FDA registration.

Founded in 2004, IMD was from a small beginning. Over the past 11 years, we grew quickly and became a public company since 2014. Our team of over 200 staff members shares one common goal utilize the combination of our highly trained workforce and the latest high-tech equipment including lasers, metal injection molding, to produce the finest quality, complete line of orthodontic technology products available.

Today, our orthodontics' products are used by orthodontists in over 80 countries worldwide. Our distributors are orthodontics experts and have represented us for many years, providing the best service to orthodontists around the world.

Meanwhile, we're dedicated to excellent customer service by providing the fastest delivery time in the industry and the value-added services. The vast majority of standard orders are shipped within two working days. In effort to facilitate the value-added services, we have built a 600 m² training center in the heart of our manufacturing headquarters, right here in Shanghai. Over 10 international experts came here to make lectures and shared the advanced orthodontic concept, which was well received in Chinese orthodontists.

Everyone at IMD would like to thank you for your continuous support on our product and innovation. We will continue to make every effort to improve our products and services. Your success is our success, and we look forward to building a bright future together!



TABLE OF CONTENTS

BRACKET SYSTEMS 04

ProMIM Passive Self-ligating Brackets 06

ActMIM Active Self-ligating Brackets 13

CRYSTAL 3D Aesthetic Self Ligating Brackets 16

Amora Ceramic Brackets 20

Atua Brackets 24

Copolla Brackets 27

Ophro Brackets 34

Helio Brackets 36

Smile Brackets 42

BUCCAL TUBE 48

Buccal Tube Information 50

Buccal Tube Prescription Reference Chart 51

BANDS & ATTACHMENTS 54

Bands & Attachments Information 56

Competitive Upgrade Chart 57

Bands Prescription Reference Chart 58

Weldable & Bondable Attachments 60

ARCHWIRES & SPRINGS

62

Archwire Forms

64

MEMAlloy Niti Arch Wires

68

BIO MEMAlloy Arch Wires

69

Cu-Alloy Niti Arch Wires

70

Beta Titanium Orthodontic Wires

71

Stainless Steel Arch wires

72

Niti Super Elastic Arch wires

74

Niti Thermal Active Arch wires

76

Springs

78

ELASTOMERICS

80

Hestia Power Chain

82

Hestia O-ring

82

Hestia Ligature

83

Hestia Separators

83

INSTRUMENTS & ACCESSORIES

84

Instruments

84

Photographic Mirrors & Retractor

87

Accessories

88

BRACKET SYS



SYSTEMS **ProMIM**

ProMIM Passive Self-ligating Brackets



BRACKET SYSTEMS

ProMIM Passive Self-ligating Brackets

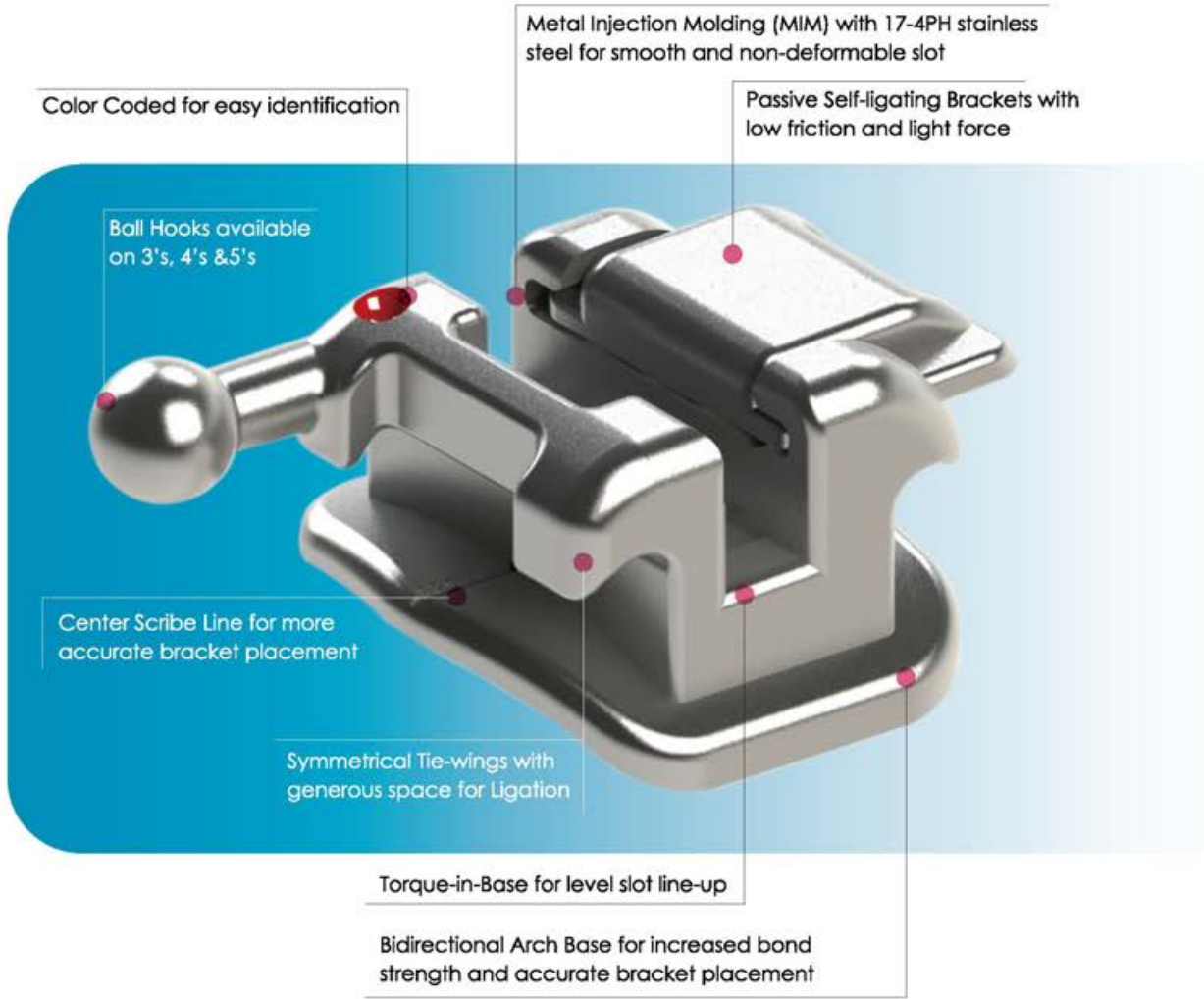

BRACKET SYSTEMS

ProMIM Passive Self-ligating Brackets

ProMIM™



Easy opening clip

Easy opening clip and slot blocker design allows for quick, easy and time saving wire changes when compared to conventional brackets- simply open the clip with an opening instrument, engage the wire, and then slide the clip closed with your fingertip- it's that simple!



Opening Instrument

Reference Number

05-101-01

Single layer MIM construction

Single layer MIM construction combines strength and precision into a single layer construction, enabling easy achievement of desired torques and angulations.



BRACKET SYSTEMS

ProMIM Passive Self-ligating Brackets



BRACKET I.D. CHART

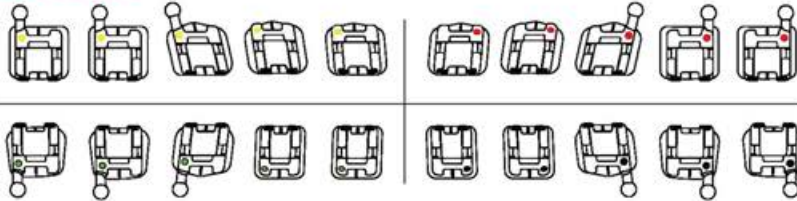

ProMIM series Roth* standard bracket kits

	.018 in.	.022 in.
U/L 5x5	KIT21-211-00	KIT21-221-00
U/L 5x5 Hook on 3	KIT21-211-00CHK	KIT21-221-00CHK
U/L 5x5 Hook on 3- 4 & 5	KIT21-211-00CBCHK	KIT21-221-00CBCHK

MAXILLARY

Tooth	Torque	Angle	Offset	M/D in mm	R/L	Color Code	Hook	Item Number	
								.018	.022
Central (U1)	+12°	+5°	0°	3	UR	●	-	21-211-11	21-221-11
					UL	●	-	21-211-21	21-221-21
Lateral (U2)	+8°	+9°	0°	2.8	UR	●	-	21-211-12	21-221-12
					UL	●	-	21-211-22	21-221-22
Cuspid (U3)	-2°	+13°	4°M	3	UR	●	-	21-211-13	21-221-13
					UL	●	-	21-211-23	21-221-23
					UR	●	D	21-211-13HK	21-221-13HK
					UL	●	D	21-211-23HK	21-221-23HK
Bicuspid (U4)	-7°	0°	2°D	3	UR	●	-	21-211-14	21-221-14
					UL	●	-	21-211-24	21-221-24
					UR	●	D	21-211-14HK	21-221-14HK
					UL	●	D	21-211-24HK	21-221-24HK
Bicuspid (U5)	-7°	0°	2°D	3	UR	●	-	21-211-15	21-221-15
					UL	●	-	21-211-25	21-221-25
					UR	●	D	21-211-15HK	21-221-15HK
					UL	●	D	21-211-25HK	21-221-25HK

MANDIBULAR

Tooth	Torque	Angle	Offset	M/D in mm	R/L	Color Code	Hook	Item Number	
								.018	.022
Anteriors (L1)	-1°	+2°	0°	2.6	LR	●	-	21-211-41	21-221-41
					LL	●	-	21-211-31	21-221-31
Anteriors (L2)	-1°	+2°	0°	2.6	LR	●	-	21-211-42	21-221-42
					LL	●	-	21-211-32	21-221-32
Cuspid (L3)	-11°	+7°	2°M	3	LR	●	-	21-211-43	21-221-43
					LL	●	-	21-211-33	21-221-33
					LR	●	D	21-211-43HK	21-221-43HK
					LL	●	D	21-211-33HK	21-221-33HK
1st Bicuspid (L4)	-17°	-1°	4°D	3	LR	●	-	21-211-44	21-221-44
					LL	●	-	21-211-34	21-221-34
					LR	●	D	21-211-44HK	21-221-44HK
2nd Bicuspid (L5)	-22°	-1°	4°D	3	LL	●	-	21-211-34HK	21-221-34HK
					LR	●	-	21-211-45	21-221-45
					LL	●	-	21-211-35	21-221-35
					LR	●	D	21-211-45HK	21-221-45HK
					LL	●	D	21-211-35HK	21-221-35HK

* Our version of the Roth Rx is not implied to be an exact version of any other system, nor do we claim any endorsement of Dr. Roth. Our version of the McLaughlin, Bennett, and Trevisi system is not implied to be an exact version of any other system, nor do we claim any endorsement of doctors McLaughlin, Bennett, and Trevisi.

BRACKET SYSTEMS

ProMIM Passive Self-ligating Brackets

ProMIM Passive Self-Ligating Brackets Sequence for Cu-Alloy Archwire

Steps	Recommended Wires and Sequence	Periods	Purpose
Step-1	.014 Cu-Alloy (U/L)	2~4 months	Level and align Resolve rotation
Step-2	.014 x .025 Cu-Alloy (U/L)	2~4 months	Complete leveling and aligning. Begin torque control Resolve remaining rotations.
Step-3	.018 x .025 Cu-Alloy (U)	2~3 months	Additional torque control Anterior space consolidation Arch development.
Step-4	.019 x .025 Stainless steel (U/L)	5~7 months	Consolidate posterior space. Arch coordination
Step-5	.019 x .025 Stainless steel (U/L) .021 x .025 Stainless steel (U/L)	4~5 months	Complete root movement
Step-6	.021 x .025 Stainless steel (U/L)	1~2 months	Final detailing

ProMIM Passive Self-Ligating Brackets Sequence for MEMAlloy and BIO MEMAlloy Archwire

Steps	Recommended Wires and Sequence	Periods	Purpose
Step-1	.014 MEMAlloy (U/L) .018 MEMAlloy (U/L)	2~3 months	Level and align Resolve rotation
Step-2	.018 x .018 Bio MEMAlloy (U/L) .020 x .020 Bio MEMAlloy (U/L)	3~4 months	Complete leveling and aligning Begin torque control
Step-3	.019 x .025 Stainless steel (U/L)	5~7 months	Close extraction space
Step-4	.019 x .025 Stainless steel (U/L) .021 x .025 Stainless steel (U/L)	4~5 months	Complete root movement
Step-5	.021 x .025 Stainless steel (U/L)	1~2 months	Final detailing

Remarks:

1. The wires sequence is recommended by IMD, the specific use of the wire and its sequence are determined by dentists
2. The treatment time will be referred to the actual status of the cases
3. Above recommended wires are in pieces, dentists can make the decision of the wires' quantity according to different situations.

BRACKET SYSTEMS

ProMIM Passive Self-ligating Brackets



Case Study 1

16 years-old female with Class II Malocclusion.(Non-extraction)
Treatment time 11 months.

-Case Treated by Dr. Jina Linton Lee.





Case Study 2

19 years-old male with Class III Malocclusion. (Non-extraction)

Treatment time 10 months.

-Case Treated by Dr. Jina Linton Lee.



Before treatment



4 Months



10 Months



Before treatment



Bracketing



BRACKET SYSTEMS

ProMIM Passive Self-ligating Brackets



1.5 months



3 months



4 months



10 months

BRACKET SYSTEMS

ActMIM Active Self-ligating Brackets

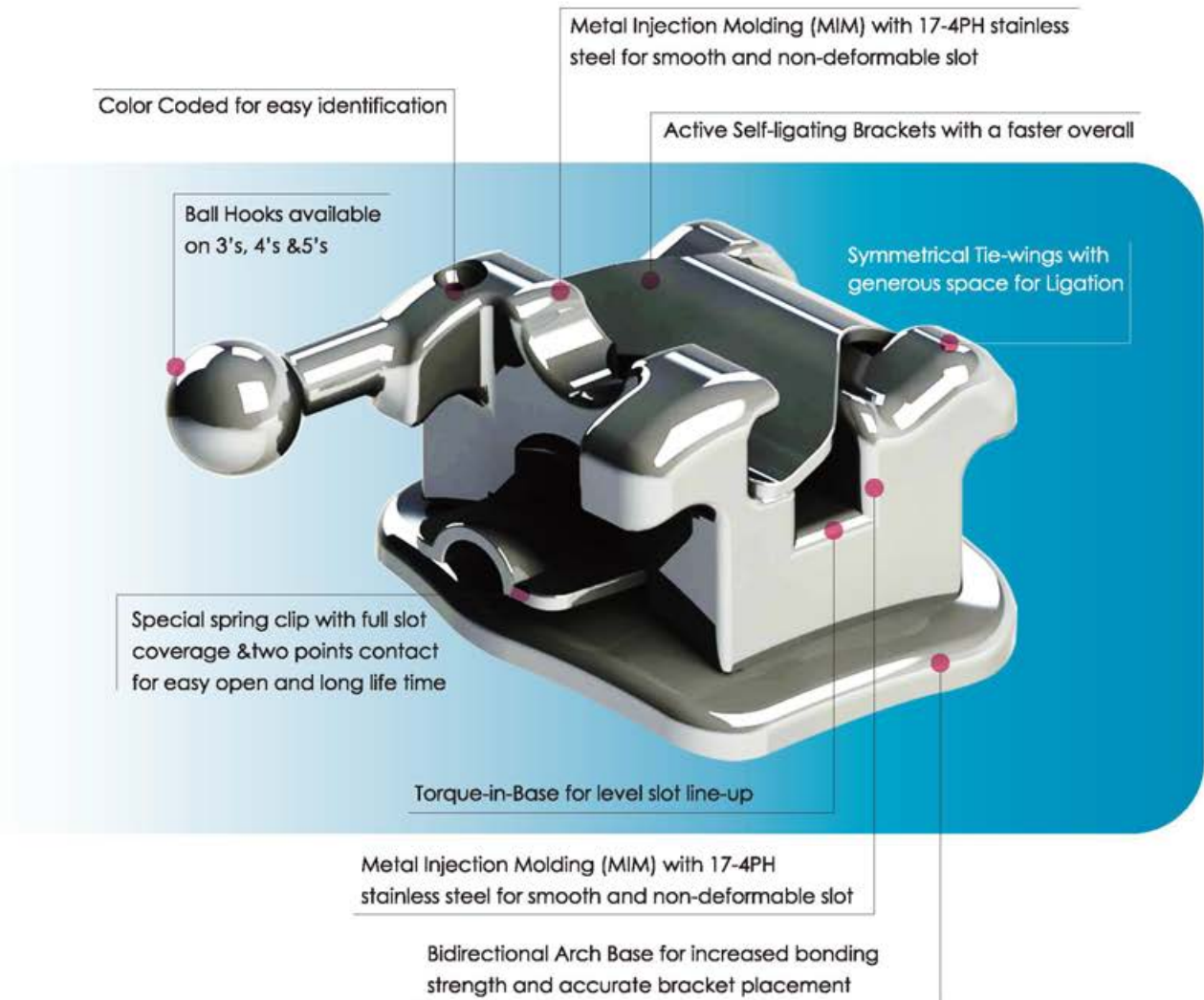

Single layer MIM construction

Single layer MIM construction combines strength and precision into a single layer construction, enabling easy achievement of desired torques and angulations.



BRACKET SYSTEMS

ActMIM Active Self-ligating Brackets

Easy Open Clip

Opening the clip of ActMIM bracket is a snap! Place the opening instrument to the v-notched clip at the gingival side of the bracket and the clip will open easily once pressure is applied occlusally to the clip.

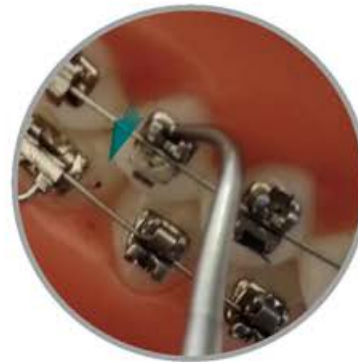
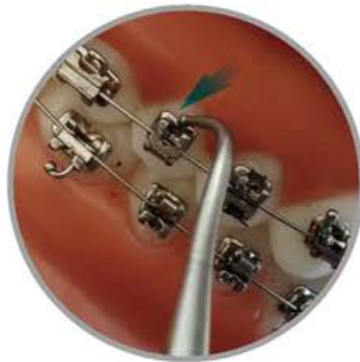

Closing Technique

Closing the clip is even easier. Using a tweezer, or even your own fingertip, gently apply pressure to the occlusal side of the clip to slide closed.



Opening Instrument

Reference Number

05-101-01

MEMAlloy and BIO MEMAlloy Archwire Sequence for ActMIM Active Self-Ligating Brackets

Steps	Recommended Wires and Sequence	Periods	Purpose
Step-1	.014 MEMAlloy (U/L) .018 MEMAlloy (U/L)	2-3 months	Level and align Resolve rotation
Step-2	.018 x .018 Bio MEMAlloy (U/L) .020 x .020 Bio MEMAlloy (U/L)	2-4 months	Complete leveling and aligning Begin torque control
Step-3	.019 x .025 Stainless steel (U/L)	5-8 months	Close extraction space
Step-4	.019 x .025 Stainless steel (U/L) .021 x .025 Stainless steel (U/L)	3-4 months	Complete root movement
Step-5	.021 x .025 Stainless steel (U/L)	1-2 months	Final detailing

Remarks:

1. The wires sequence is recommended by IMD, the specific use of the wire and its sequence are determined by dentists
2. The treatment time will be referred to the actual status of the cases
3. Above recommended wires are in pieces, dentists can make the decision of the wires' quantity according to different situations.

BRACKET SYSTEMS

ActMIM Active Self-ligating Brackets

ActMIM

BRACKET I.D. CHART

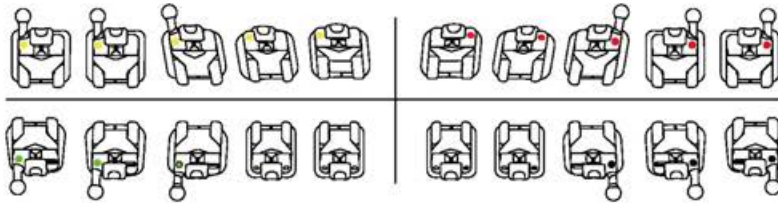

MAXILLARY

Tooth	Torque	Angle	Offset	M/D in mm	R/L	Color Code	Hook	Item Number .018	Item Number .022
Central _(U1)	+12°	+5°	0°	3	UR UL	● ●	-	-	-
Central _(U1) Low torque	+7°	+5°	0°	3	UR UL	● ●	-	-	-
Lateral _(U2)	+10°	+9°	0°	2.8	UR UL	● ●	-	-	-
Lateral _(U2) Low torque	+3°	+9°	0°	2.8	UR UL	● ●	-	-	-
Cuspid _(U3)	-7°	+10°	2°M	3	UR UL UR UL	● ● ● ●	- - D -	- - - -	- - - -
Cuspid Low torque	0°	+10°	2°M	3	UR UL	● ●	- -	- -	- -
Bicuspid _(U4)	-9°	0°	0°	3	UR UL UR UL	● ● ● ●	- - D -	- - - -	- - - -
Bicuspid _(U5)	-9°	0°	0°	3	UR UL UR UL	● ● ● ●	- - D -	- - - -	- - - -

MANDIBULAR

Tooth	Torque	Angle	Offset	M/D in mm	R/L	Color Code	Hook	Item Number .018	Item Number .022
Anteriors _(L1,1,2)	-6°	0°	0°	2.6	LR LL	● ●	- -	- -	- -
Anteriors _(L1,1,2) High torque	-1°	0°	0°	2.6	LR LL	● ●	- -	- -	- -
Cuspid _(L3)	-8°	+3°	0°	3	LR LL LR LL	● ● ● ●	- - D -	- - - -	- - - -
1st Bicuspid _(L4)	-12°	+2°	0°	3	LR LL LR LL	● ● ● ●	- - D -	- - - -	- - - -
2nd Bicuspid _(L5)	-17°	-1°	0°	3	LR LL LR LL	● ● ● ●	- - D -	- - - -	- - - -

ActMIM active self-ligating brackets will be released in March, 2016

BRACKET SYSTEMS

CRYSTAL 3D Aesthetic Self Ligating Brackets

CRYSTAL
3D SMILES®

Invisible and Fast



The Only One Aesthetic Self Ligating Bracket developed from Clinical and Tomographic Evidence

Several thousands of cases treated successfully.



Aesthetic Comparison



Aesthetic Comparison Bracket



The same patient with CRYATAL 3D



Aesthetic Self Ligating Bracket



The same patient with CRYATAL 3D



Metallic Conventional Bracket



The same patient with CRYATAL 3D

BRACKET SYSTEMS

CRYSTAL 3D Aesthetic Self Ligating Brackets

CRYSTAL
3D SMILES®

Easy Opening and Closing

Opening:

TURN gently the instrument that comes with the kit

Closing:

Easy to close and with security lock

*All the doors open onto incisal/occlusal,
avoiding any damage to the soft tissue

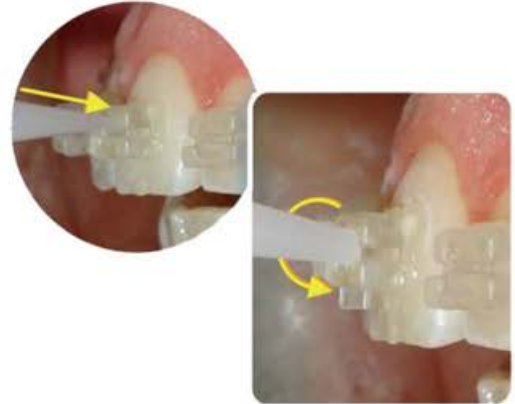

Removal of markings brackets with roller moistened
cotton alcohol



Removal bracket with pliers cutting ligature,
with simple shift at the junction bracket x resin.



BRACKET SYSTEMS

CRYSTAL 3D Aesthetic Self Ligating Brackets

CRYSTAL 3D SMILES®

Initial



0.014"

12 months treatment



0.014x0.025"

The 8 Clinical Principles of Maxillary Transverse Bioadaptation Philosophy (MTB)

- 1st: Clinical analysis of the upper second molar
- 2nd: Initiate with a 0.014" thermoactivated arch wire
- 3rd: Understand the importance of the STOP positions
- 4th: Upper Second molar composite Build up's
- 5th: Bonding of the Lower archu after Transverse Bioadaptation
- 6th: Light elastic used at night only
- 7th: Final arch definition with 0.014x0.025" thermoactivated
- 8th: Maximum of 0.018"ss or 0.014x0.025"ss for sliding mechanics

Aesthetic Self Ligating Brackets Kit



- Kit 7x7 100% aesthetic, 01 (ONE) instrumental-Opening and Closing
- 4 Aesthetic Thermoactivated Arch Wire (0.014" and 0.014x0.025")
- 8 Aesthetic Wins
- Double Sputinik

BRACKET SYSTEMS

CRYSTAL 3D Aesthetic Self Ligating Brackets

CRYSTAL
3D SMILES®

Several thousands of cases treated successfully.



Initial



6 months



12 months

Bonding



7 months

Bonding



12 months

BRACKET SYSTEMS

Amora Ceramic brackets

AMORA

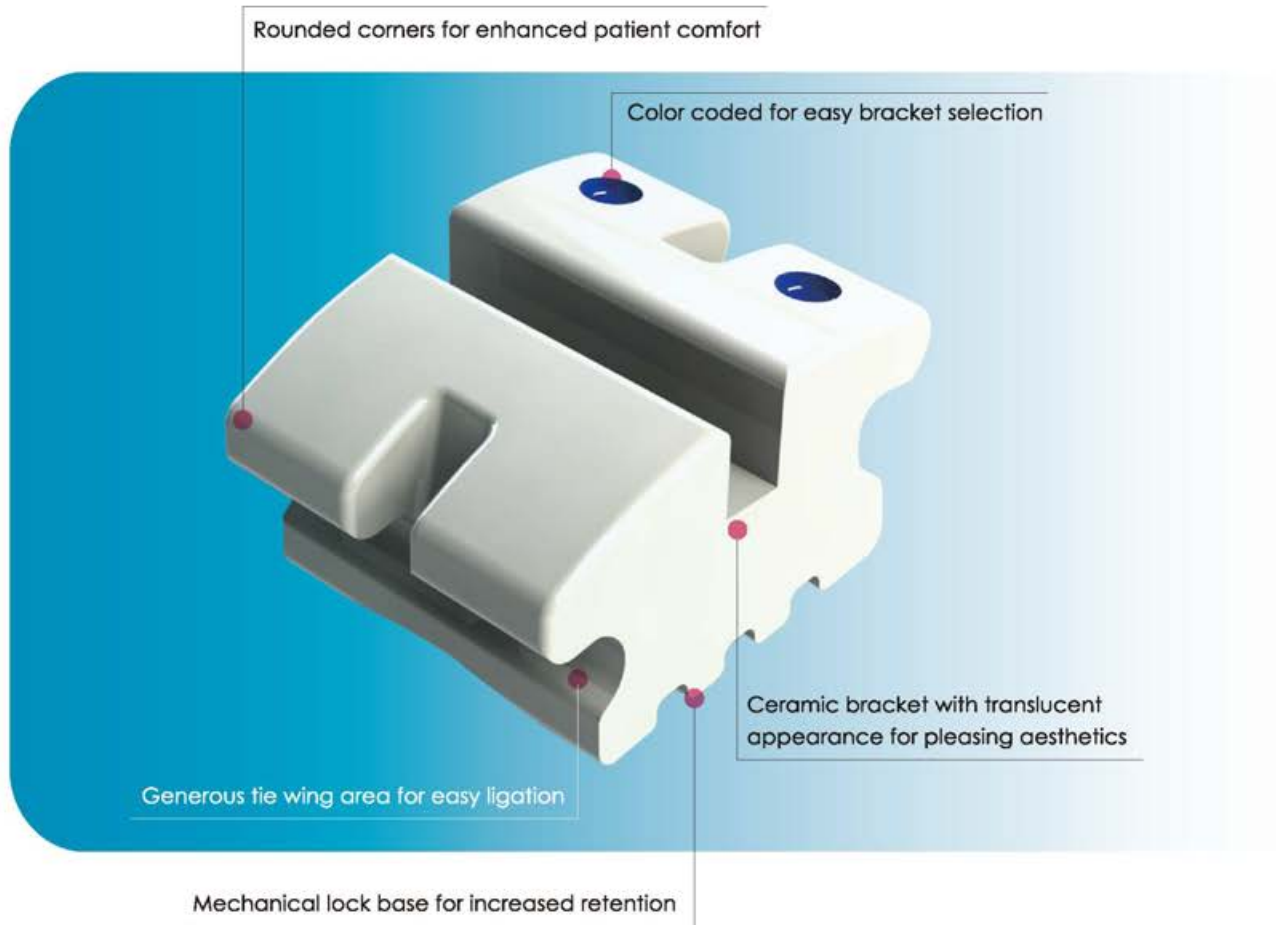

Amora aesthetic brackets applied to a demonstration model

BRACKET SYSTEMS

Amora Ceramic brackets



BRACKET I.D. CHART

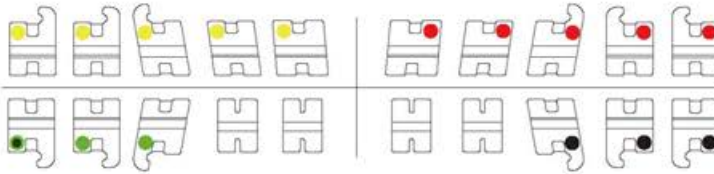

Amora series Edgewise bracket kits

	.018 in.	.022 in.
U/L 5×5	KIT31-111-00	KIT31-121-00
U/L 5×5 Hook on 3	KIT31-111-00CHK	KIT31-121-00CHK
U/L 5×5 Hook on 3, 4 & 5	KIT31-111-00CBCHK	KIT31-121-00CBCHK

MAXILLARY

Edgewise Bracket

Tooth	Torque	Angle	Offset	M/D in mm	R/L	Color Code	Hook	Item Number	
								.018	.022
Central (U1)	0°	0°	0°	3.6	UR	●	-	31-111-11	31-121-11
								31-111-21	31-121-21
Lateral (U2)	0°	0°	0°	3	UR	●	-	31-111-12	31-121-12
								31-111-22	31-121-22
Cuspid (U3)	0°	0°	0°	3.2	UR	●	-	31-111-13	31-121-13
								31-111-23	31-121-23
					UR	●	D	31-111-13HK	31-121-13HK
								31-111-23HK	31-121-23HK
Bicuspid (U4)	0°	0°	0°	3.2	UR	●	-	31-111-14	31-121-14
								31-111-24	31-121-24
					UR	●	M	31-111-14HK	31-121-14HK
								31-111-24HK	31-121-24HK
Bicuspid (U5)	0°	0°	0°	3.2	UR	●	-	31-111-15	31-121-15
								31-111-25	31-121-25
					UR	●	M	31-111-15HK	31-121-15HK
								31-111-25HK	31-121-25HK

MANDIBULAR

Tooth	Torque	Angle	Offset	M/D in mm	R/L	Color Code	Hook	Item Number	
								.018	.022
Anteriors (L1)	0°	0°	0°	2.6	LR	●	-	31-111-41	31-121-41
								31-111-31	31-121-31
Anteriors (L2)	0°	0°	0°	2.6	LR	●	-	31-111-42	31-121-42
								31-111-32	31-121-32
Cuspid (L3)	0°	0°	0°	3.2	LR	●	-	31-111-43	31-121-43
								31-111-33	31-121-33
					LR	●	D	31-111-43HK	31-121-43HK
								31-111-33HK	31-121-33HK
1st Bicuspid (L4)	0°	0°	0°	3.2	LR	●	-	31-111-44	31-121-44
								31-111-34	31-121-34
					LR	●	M	31-111-44HK	31-121-44HK
								31-111-34HK	31-121-34HK
2nd Bicuspid (L5)	0°	0°	0°	3.2	LR	●	-	31-111-45	31-121-45
								31-111-35	31-121-35
					LR	●	M	31-111-45HK	31-121-45HK
								31-111-35HK	31-121-35HK

BRACKET SYSTEMS

Amora Ceramic brackets



BRACKET I.D. CHART

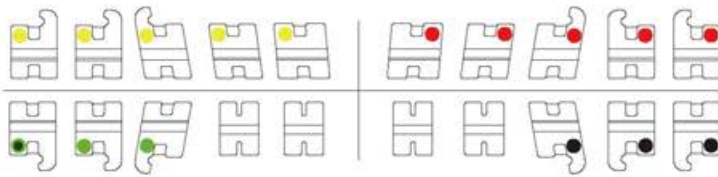

Amora series Roth* bracket kits

	.018 in.	.022 in.
U/L 5x5	KIT31-211-00	KIT31-221-00
U/L 5x5 Hook on 3	KIT31-211-00CHK	KIT31-221-00CHK
U/L 5x5 Hook on 3, 4 & 5	KIT31-211-00CBCHK	KIT31-221-00CBCHK

MAXILLARY

Roth* Bracket

Tooth	Torque	Angle	Offset	M/D in mm	R/L	Color Code	Hook	Item Number	
								.018	.022
Central (U1)	+12°	+5°	0°	3.6	UR	●	-	31-211-11	31-221-11
								31-211-21	31-221-21
Lateral (U2)	+8°	+9°	0°	3	UR	●	-	31-211-12	31-221-12
								31-211-22	31-221-22
Cuspid (U3)	-2°	+13°	0°	3.2	UR	●	-	31-211-13	31-221-13
								31-211-23	31-221-23
					UR	●	D	31-211-13HK	31-221-13HK
								31-211-23HK	31-221-23HK
Bicuspid (U4)	-7°	0°	0°	3.2	UR	●	-	31-211-14	31-221-14
								31-211-24	31-221-24
					UR	●	M	31-211-14HK	31-221-14HK
								31-211-24HK	31-221-24HK
Bicuspid (U5)	-7°	0°	0°	3.2	UR	●	-	31-211-15	31-221-15
								31-211-25	31-221-25
					UR	●	M	31-211-15HK	31-221-15HK
								31-211-22HK	31-221-25HK

MANDIBULAR

Tooth	Torque	Angle	Offset	M/D in mm	R/L	Color Code	Hook	Item Number	
								.018	.022
Anteriors (L1)	-1°	+2°	0°	2.6	LR	●	-	31-211-41	31-221-41
								31-211-31	31-221-31
Anteriors (L2)	-1°	+2°	0°	2.6	LR	●	-	31-211-42	31-221-42
								31-211-32	31-221-32
Cuspid (L3)	-11°	+7°	0°	3.2	LR	●	-	31-211-43	31-221-43
								31-211-33	31-221-33
					LR	●	D	31-211-43HK	31-221-43HK
								31-211-33HK	31-221-33HK
1st Bicuspid (L4)	-17°	-1°	0°	3.2	LR	●	-	31-211-44	31-221-44
								31-211-34	31-221-34
					LR	●	M	31-211-44HK	31-221-44HK
								31-211-34HK	31-221-34HK
2nd Bicuspid (L5)	-22°	-1°	0°	3.2	LR	●	-	31-211-45	31-221-45
								31-211-35	31-221-35
					LR	●	M	31-211-45HK	31-221-45HK
								31-211-35HK	31-221-35HK

BRACKET SYSTEMS

Amora Ceramic brackets



BRACKET I.D. CHART

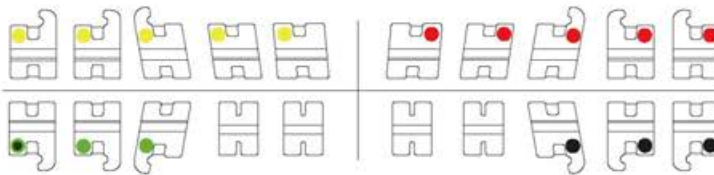

Amora series McBeTr* bracket kits

	.018 in.	.022 in.
U/L 5x5	KIT31-311-00	KIT31-321-00
U/L 5x5 Hook on 3	KIT31-311-00CHK	KIT31-321-00CHK
U/L 5x5 Hook on 3, 4 & 5	KIT31-311-00CBCHK	KIT31-321-00CBCHK

MAXILLARY

Tooth	Torque	Angle	Offset	M/D in mm	R/L	Color Code	Hook	McBeTr* Bracket	
								.018	.022
Central (U1)	+17°	+4°	0°	3.4	UR	●	-	31-311-11	31-321-11
								31-311-21	31-321-21
Lateral (U2)	+10°	+8°	0°	3	UR	●	-	31-311-12	31-321-12
								31-311-22	31-321-22
Cuspid (U3)	-7°	+8°	0°	3	UR	●	-	31-311-13	31-321-13
								31-311-23	31-321-23
					UR	●	D	31-311-13HK	31-321-13HK
								31-311-23HK	31-321-23HK
Bicuspid (U4)	-7°	0°	0°	3	UR	●	-	31-311-14	31-321-14
								31-311-24	31-321-24
					UR	●	M	31-311-14HK	31-321-14HK
								31-311-24HK	31-321-24HK
Bicuspid (U5)	-7°	0°	0°	3	UR	●	-	31-311-15	31-321-15
								31-311-25	31-321-25
					UR	●	M	31-311-15HK	31-321-15HK
								31-311-25HK	31-321-25HK

MANDIBULAR

Tooth	Torque	Angle	Offset	M/D in mm	R/L	Color Code	Hook	Item Number	
								.018	.022
Anteriors (L1)	-6°	0°	0°	2.4	LR	●	-	31-311-41	31-321-41
								31-311-31	31-321-31
Anteriors (L2)	-6°	0°	0°	2.4	LR	●	-	31-311-42	31-321-42
								31-311-32	31-321-32
Cuspid (L3)	-6°	+3°	0°	3	LR	●	-	31-311-43	31-321-43
								31-311-33	31-321-33
					LR	●	D	31-311-43HK	31-321-43HK
								31-311-33HK	31-321-33HK
1st Bicuspid (L4)	-12°	+2°	0°	3	LR	●	-	31-311-44	31-321-44
								31-311-34	31-321-34
					LR	●	M	31-311-44HK	31-321-44HK
								31-311-34HK	31-321-34HK
2nd Bicuspid (L5)	-17°	+2°	0°	3	LR	●	-	31-311-45	31-321-45
								31-311-35	31-321-35
					LR	●	M	31-311-45HK	31-321-45HK
								31-311-35HK	31-321-35HK

* Our version of the Roth Rx is not implied to be an exact version of any other system, nor do we claim any endorsement of Dr. Roth. Our version of the McLaughlin, Bennett, and Trevisi system is not implied to be an exact version of any other system, nor do we claim any endorsement of doctors McLaughlin, Bennett, and Trevisi.

BRACKET SYSTEMS

Atua Brackets

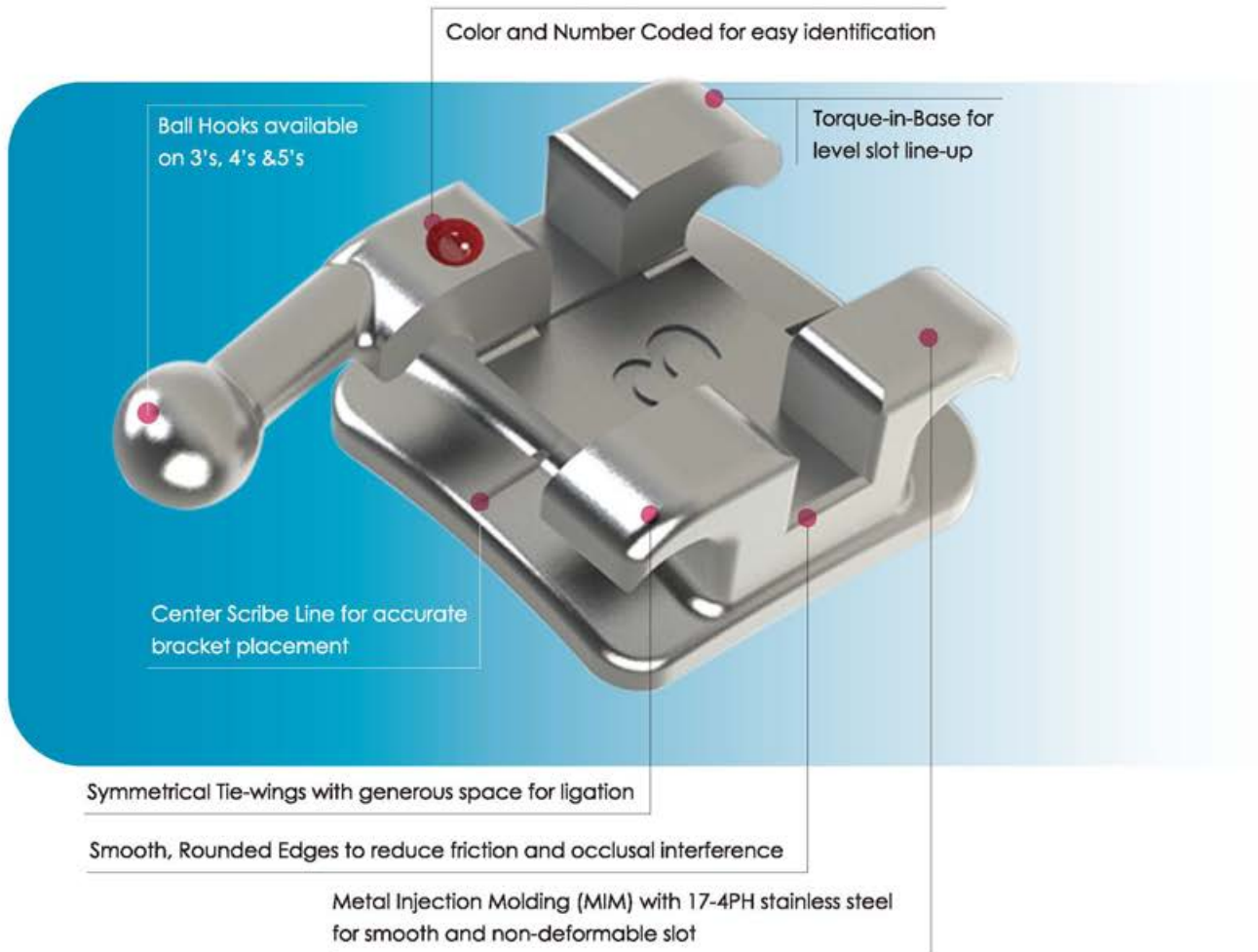

Atua brackets applied to a demonstration model



Full Control

Ensuring full control, torque is built into the base of each bracket for accurate placement on each tooth. This must be accompanied by the bidirectional arch base or it will not work properly. It allows the slot point, the base point (middle of the base) and the reference point on the tooth to be on the same plane, a necessity for proper tooth positioning and level slot alignment.

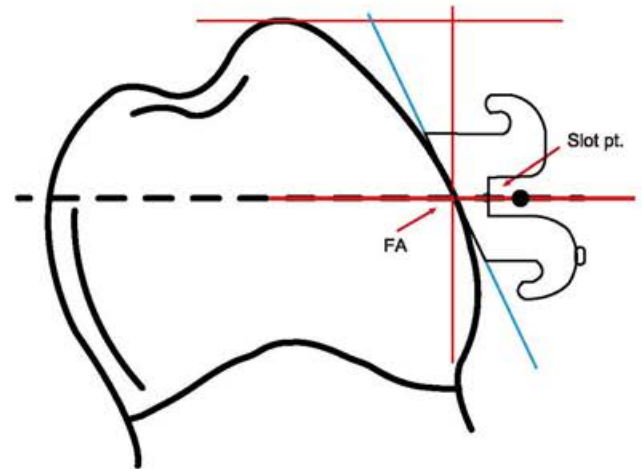

Precise position

Atua brackets are bidirectional arch base, which mirror the mesio-distal and occlusal-gingival curvature of the crown of each tooth type. The base curvature is the same or slightly more curved than the tooth surface so that the bracket stem and slot are precisely positioned.



Consistent Bond

Sandblasted base and bidirectional arch base match the anatomy of the tooth for maximum contact and a strong, consistent bond. One piece metal injection molding eliminates all bracket-to-pad separations.



BRACKET SYSTEMS

Atua Brackets



BRACKET I.D. CHART

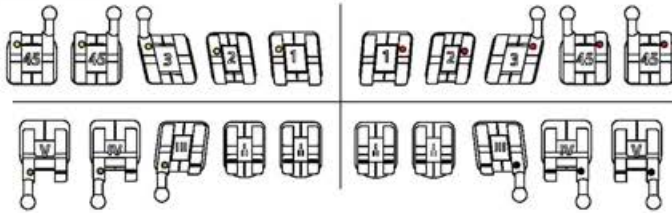

Atua series Roth* standard bracket kits

	.018 in.	.022 in.
U/L 5x5	KIT11-212-00	KIT11-222-00
U/L 5x5 Hook on 3	KIT11-212-00CHK	KIT11-222-00CHK
U/L 5x5 Hook on 3, 4 & 5	KIT11-212-00CBCHK	KIT11-222-00CBCHK

MAXILLARY

Tooth	Torque	Angle	Offset	M/D in mm	R/L	Color Code	Hook	Item Number	
								.018	.022
Central (U1)	+12°	+5°	0°	3.2	UR	●	-	11-212-11	11-222-11
								11-212-21	11-222-21
Lateral (U2)	+8°	+9°	0°	2.8	UR	●	-	11-212-12	11-222-12
								11-212-22	11-222-22
Cuspid (U3)	-2°	+13°	0°	3.2	UR	●	-	11-212-13	11-222-13
								11-212-23	11-222-23
					UR	●	D	11-212-13HK	11-222-13HK
								11-212-23HK	11-222-23HK
UL	●	-	11-212-14	11-222-14					
			11-212-24	11-222-24					
Bicuspid (U4)	-7°	0°	0°	3	UR	●	M	11-212-14HK	11-222-14HK
								11-212-24HK	11-222-24HK
					UR	●	-	11-212-15	11-222-15
								11-212-25	11-222-25
UL	●	M	11-212-15HK	11-222-15HK					
			11-212-25HK	11-222-25HK					

MANDIBULAR

Tooth	Torque	Angle	Offset	M/D in mm	R/L	Color Code	Hook	Item Number	
								.018	.022
Anteriors (L1)	-1°	0°	0°	2.5	LR	●	-	11-212-41	11-222-41
								11-212-31	11-222-31
Anteriors (L2)	-1°	0°	0°	2.5	LR	●	-	11-212-42	11-222-42
								11-212-32	11-222-32
Cuspid (L3)	-11°	+7°	0°	3	LR	●	-	11-212-43	11-222-43
								11-212-33	11-222-33
					LR	●	D	11-212-43HK	11-222-43HK
								11-212-33HK	11-222-33HK
LL	●	-	11-212-44	11-222-44					
			11-212-34	11-222-34					
1st Bicuspid (L4)	-17°	0°	0°	3	LR	●	D	11-212-44HK	11-222-44HK
								11-212-34HK	11-222-34HK
					LR	●	-	11-212-45	11-222-45
								11-212-35	11-222-35
LL	●	D	11-212-45HK	11-222-45HK					
			11-212-35HK	11-222-35HK					

* Our version of the Roth Rx is not implied to be an exact version of any other system, nor do we claim any endorsement of Dr. Roth. Our version of the McLaughlin, Bennett, and Trevisi system is not implied to be an exact version of any other system, nor do we claim any endorsement of doctors McLaughlin, Bennett, and Trevisi.

COPOLLA

Smaller hemi hooks ensure attachment of auxiliaries, providing maximum comfort

Special polishing process to ensure smooth slot for easier wire insertion

Color coded for easy identification



Milling technology with stainless steel for non-deformable slot

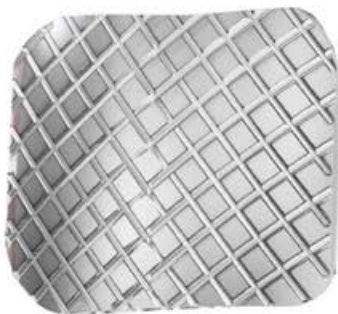

An 80 gauge mesh forming a superior surface area of interlocking retention



Bidirectional Arch Base for increased bond strength and accurate bracket placement

BRACKET SYSTEMS

Copolla Brackets

COPOLLA BRACKET I.D. CHART

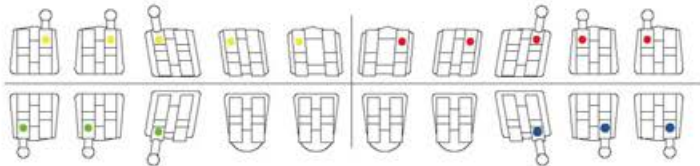

Copolla series Edgewise Mini bracket kits

.018 in.

.022 in.

U/L 5×5	KIT13-112-00	KIT13-122-00
U/L 5×5 Hook on 3	KIT13-112-00CHK	KIT13-122-00CHK
U/L 5×5 Hook on 3, 4 & 5	KIT13-112-00CBCHK	KIT13-122-00CBCHK

MAXILLARY

Edgewise Mini

Tooth	Torque	Angle	Offset	M/D in mm	R/L	Color Code	Hook	Item Number	
								.018	.022
Central (U1)	0°	0°	0°	3	UR	●	-	13-112-11	13-122-11
								13-112-21	13-122-21
Lateral (U2)	0°	0°	0°	2.6	UR	●	-	13-112-12	13-122-12
								13-112-22	13-122-22
Cuspid (U3)	0°	0°	0°	2.6	UR	●	-	13-112-13	13-122-13
								13-112-23	13-122-23
					UR	●	D	13-112-13HK	13-122-13HK
								13-112-23HK	13-122-23HK
Bicuspid (U4)	0°	0°	0°	2.6	UR	●	-	13-112-14	13-122-14
								13-112-24	13-122-24
					UR	●	M	13-112-14HK	13-122-14HK
								13-112-24HK	13-122-24HK
Bicuspid (U5)	0°	0°	0°	2.6	UR	●	-	13-112-15	13-122-15
								13-112-25	13-122-25
					UR	●	M	13-112-15HK	13-122-15HK
								13-112-25HK	13-122-25HK

MANDIBULAR

Tooth	Torque	Angle	Offset	M/D in mm	R/L	Color Code	Hook	Item Number	
								.018	.022
Anteriors (L1)	0°	0°	0°	2.4	LR	●	-	13-112-41	13-122-41
								13-112-31	13-122-31
Anteriors (L2)	0°	0°	0°	2.4	LR	●	-	13-112-42	13-122-42
								13-112-32	13-122-32
Cuspid (L3)	0°	0°	0°	2.6	LR	●	-	13-112-43	13-122-43
								13-112-33	13-122-33
					LR	●	D	13-112-43HK	13-122-43HK
								13-112-33HK	13-122-33HK
1st Bicuspid (L4)	0°	0°	0°	2.6	LR	●	-	13-112-44	13-122-44
								13-112-34	13-122-34
					LR	●	D	13-112-44HK	13-122-44HK
								13-112-34HK	13-122-34HK
2nd Bicuspid (L5)	0°	0°	0°	2.6	LR	●	-	13-112-45	13-122-45
								13-112-35	13-122-35
					LR	●	D	13-112-45HK	13-122-45HK
								13-112-35HK	13-122-35HK

BRACKET SYSTEMS

Copolla Brackets



BRACKET I.D. CHART

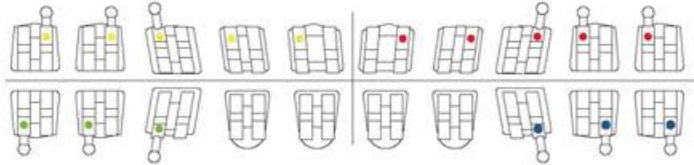

Copolla series Roth* Mini bracket kits

	.018 in.	.022 in.
U/L 5x5	KIT13-212-00	KIT13-222-00
U/L 5x5 Hook on 3	KIT13-212-00CHK	KIT13-222-00CHK
U/L 5x5 Hook on 3, 4 & 5	KIT13-212-00CBCHK	KIT13-222-00CBCHK

MAXILLARY

Roth* Mini

Tooth	Torque	Angle	Offset	M/D in mm	R/L	Color Code	Hook	Item Number	
								.018	.022
Central (U1)	+12°	+5°	0°	3	UR	●	-	13-212-11	13-222-11
								13-212-21	13-222-21
Lateral (U2)	+8°	+9°	0°	2.6	UR	●	-	13-212-12	13-222-12
								13-212-22	13-222-22
Cuspid (U3)	-2°	+13°	0°	2.8	UR	●	-	13-212-13	13-222-13
								13-212-23	13-222-23
					UR	●	D	13-212-13HK	13-222-13HK
								13-212-23HK	13-222-23HK
Bicuspid (U4)	-7°	0°	0°	2.6	UR	●	-	13-212-14	13-222-14
								13-212-24	13-222-24
					UR	●	M	13-212-14HK	13-222-14HK
								13-212-24HK	13-222-24HK
Bicuspid (U5)	-7°	0°	0°	2.6	UR	●	-	13-212-15	13-222-15
								13-212-25	13-222-25
					UR	●	M	13-212-15HK	13-222-15HK
								13-212-25HK	13-222-25HK

MANDIBULAR

Tooth	Torque	Angle	Offset	M/D in mm	R/L	Color Code	Hook	Item Number	
								.018	.022
Anteriors (L1)	-1°	0°	0°	2.4	LR	●	-	13-212-41	13-222-41
								13-212-31	13-222-31
Anteriors (L2)	-1°	0°	0°	2.4	LR	●	-	13-212-42	13-222-42
								13-212-32	13-222-32
Cuspid (L3)	-11°	+7°	0°	2.8	LR	●	-	13-212-43	13-222-43
								13-212-33	13-222-33
					LR	●	D	13-212-43HK	13-222-43HK
								13-212-33HK	13-222-33HK
1st Bicuspid (L4)	-17°	0°	0°	2.6	LR	●	-	13-212-44	13-222-44
								13-212-34	13-222-34
					LR	●	D	13-212-44HK	13-222-44HK
								13-212-34HK	13-222-34HK
2nd Bicuspid (L5)	-22°	0°	0°	2.6	LR	●	-	13-212-45	13-222-45
								13-212-35	13-222-35
					LR	●	D	13-212-45HK	13-222-45HK
								13-212-35HK	13-222-35HK

* Our version of the Roth Rx is not implied to be an exact version of any other system, nor do we claim any endorsement of Dr. Roth. Our version of the McLaughlin, Bennett, and Trevisi system is not implied to be an exact version of any other system, nor do we claim any endorsement of doctors McLaughlin, Bennett, and Trevisi.

BRACKET SYSTEMS

Copolla Brackets

COPOLLA BRACKET I.D. CHART

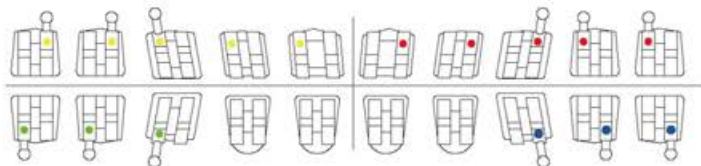

Copolla series McBeTr* Mini bracket kits

	.018 in.	.022 in.
U/L 5x5	KIT13-312-00	KIT13-322-00
U/L 5x5 Hook on 3	KIT13-312-00CHK	KIT13-322-00CHK
U/L 5x5 Hook on 3, 4 & 5	KIT13-312-00CBCHK	KIT13-322-00CBCHK

MAXILLARY

McBeTr* Mini

Tooth	Torque	Angle	Offset	M/D in mm	R/L	Color Code	Hook	Item Number	
								.018	.022
Central (U1)	+17°	+4°	0°	3.4	UR	●	-	13-312-11	13-322-11
								13-312-21	13-322-21
Lateral (U2)	+10°	+8°	0°	2.8	UR	●	-	13-312-12	13-322-12
								13-312-22	13-322-22
Cuspid (U3)	-7°	+8°	0°	3	UR	●	-	13-312-13	13-322-13
								13-312-23	13-322-23
					UR	●	D	13-312-13HK	13-322-13HK
								13-312-23HK	13-322-23HK
Bicuspid (U4)	-7°	0°	0°	2.8	UR	●	-	13-312-14	13-322-14
								13-312-24	13-322-24
					UR	●	M	13-312-14HK	13-322-14HK
								13-312-24HK	13-322-24HK
Bicuspid (U5)	-7°	0°	0°	2.8	UR	●	-	13-312-15	13-322-15
								13-312-25	13-322-25
					UR	●	M	13-312-15HK	13-322-15HK
								13-312-25HK	13-322-25HK

MANDIBULAR

Tooth	Torque	Angle	Offset	M/D in mm	R/L	Color Code	Hook	Item Number	
								.018	.022
Anteriors (L1)	-6°	0°	0°	2.4	LR	●	-	13-312-41	13-322-41
								13-312-31	13-322-31
Anteriors (L2)	-6°	0°	0°	2.4	LR	●	-	13-312-42	13-322-42
								13-312-32	13-322-32
Cuspid (L3)	-6°	+3°	0°	3	LR	●	-	13-312-43	13-322-43
								13-312-33	13-322-33
					LR	●	D	13-312-43HK	13-322-43HK
								13-312-33HK	13-322-33HK
1st Bicuspid (L4)	-12°	0°	0°	2.8	LR	●	-	13-312-44	13-322-44
								13-312-34	13-322-34
					LR	●	D	13-312-44HK	13-322-44HK
								13-312-34HK	13-322-34HK
2nd Bicuspid (L5)	-17°	0°	0°	2.8	LR	●	-	13-312-45	13-322-45
								13-312-35	13-322-35
					LR	●	D	13-312-45HK	13-322-45HK
								13-312-35HK	13-322-35HK

BRACKET SYSTEMS

Copolla Brackets



BRACKET I.D. CHART

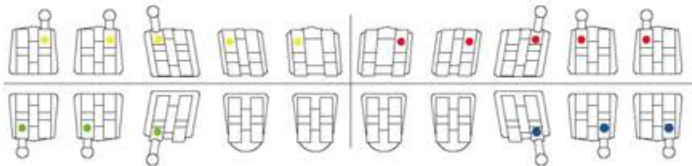

Copolla series Edgewise standard bracket kits

	.018 in.	.022 in.
U/L 5x5	KIT13-111-00	KIT13-121-00
U/L 5x5 Hook on 3	KIT13-111-00CHK	KIT13-121-00CHK
U/L 5x5 Hook on 3, 4 & 5	KIT13-111-00CBCHK	KIT13-121-00CBCHK

MAXILLARY

Edgewise Standard

Tooth	Torque	Angle	Offset	M/D in mm	R/L	Color Code	Hook	Item Number	
								.018	.022
Central (U1)	0°	0°	0°	3.2	UR	●	-	13-111-11	13-121-11
								13-111-21	13-121-21
Lateral (U2)	0°	0°	0°	2.8	UR	●	-	13-111-12	13-121-12
								13-111-22	13-121-22
Cuspid (U3)	0°	0°	0°	2.8	UR	●	-	13-111-13	13-121-13
								13-111-23	13-121-23
					UR	●	D	13-111-13HK	13-121-13HK
								13-111-23HK	13-121-23HK
Bicuspid (U4)	0°	0°	0°	2.8	UR	●	-	13-111-14	13-121-14
								13-111-24	13-121-24
					UR	●	M	13-111-14HK	13-121-14HK
								13-111-24HK	13-121-24HK
Bicuspid (U5)	0°	0°	0°	2.8	UR	●	-	13-111-15	13-121-15
								13-111-25	13-121-25
					UR	●	M	13-111-15HK	13-121-15HK
								13-111-25HK	13-121-25HK

MANDIBULAR

Tooth	Torque	Angle	Offset	M/D in mm	R/L	Color Code	Hook	Item Number	
								.018	.022
Anteriors (L1)	0°	0°	0°	2.4	LR	●	-	13-111-41	13-121-41
								13-111-31	13-121-31
Anteriors (L2)	0°	0°	0°	2.4	LR	●	-	13-111-42	13-121-42
								13-111-32	13-121-32
Cuspid (L3)	0°	0°	0°	2.8	LR	●	-	13-111-43	13-121-43
								13-111-33	13-121-33
					LR	●	D	13-111-43HK	13-121-43HK
								13-111-33HK	13-121-33HK
1st Bicuspid (L4)	0°	0°	0°	2.8	LR	●	-	13-111-44	13-121-44
								13-111-34	13-121-34
					LR	●	D	13-111-44HK	13-121-44HK
								13-111-34HK	13-121-34HK
2nd Bicuspid (L5)	0°	0°	0°	2.8	LR	●	-	13-111-45	13-121-45
								13-111-35	13-121-35
					LR	●	D	13-111-45HK	13-121-45HK
								13-111-35HK	13-121-35HK

BRACKET SYSTEMS

Copolla Brackets

COPOLLA BRACKET I.D. CHART

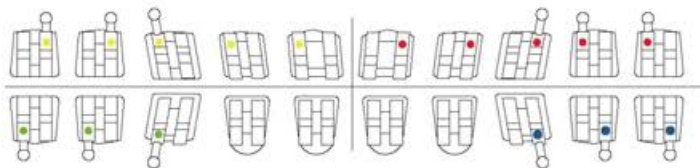

Copolla series Roth* standard bracket kits

	.018 in.	.022 in.
U/L 5x5	KIT13-211-00	KIT13-221-00
U/L 5x5 Hook on 3	KIT13-211-00CHK	KIT13-221-00CHK
U/L 5x5 Hook on 3, 4 & 5	KIT13-211-00CBCHK	KIT13-221-00CBCHK

MAXILLARY

Roth Standard

Tooth	Torque	Angle	Offset	M/D in mm	R/L	Color Code	Hook	Item Number		
								.018	.022	
Central (U1)	+12°	+5°	0°	3.3	UR	●	-	13-211-11	13-221-11	
					UL	●		13-211-21	13-221-21	
Lateral (U2)	+8°	+9°	0°	2.8	UR	●	-	13-211-12	13-221-12	
					UL	●		13-211-22	13-221-22	
Cuspid (U3)	-2°	+13°	0°	3	UR	●	-	13-211-13	13-221-13	
					UL	●		13-211-23	13-221-23	
					UR	●		D	13-211-13HK	13-221-13HK
					UL	●		D	13-211-23HK	13-221-23HK
Bicuspid (U4)	-7°	0°	0°	2.8	UR	●	-	13-211-14	13-221-14	
					UL	●		13-211-24	13-221-24	
					UR	●		M	13-211-14HK	13-221-14HK
					UL	●		M	13-211-24HK	13-221-24HK
Bicuspid (U5)	-7°	0°	0°	2.8	UR	●	-	13-211-15	13-221-15	
					UL	●		13-211-25	13-221-25	
					UR	●		M	13-211-15HK	13-221-15HK
					UL	●		M	13-211-25HK	13-221-25HK

MANDIBULAR

Tooth	Torque	Angle	Offset	M/D in mm	R/L	Color Code	Hook	Item Number		
								.018	.022	
Anteriors (L1)	-1°	0°	0°	2.4	LR	●	-	13-211-41	13-221-41	
					LL	●		13-211-31	13-221-31	
Anteriors (L2)	-1°	0°	0°	2.4	LR	●	-	13-211-42	13-221-42	
					LL	●		13-211-32	13-221-32	
Cuspid (L3)	-11°	+7°	0°	3	LR	●	-	13-211-43	13-221-43	
					LL	●		13-211-33	13-221-33	
					LR	●		D	13-211-43HK	13-221-43HK
					LL	●		D	13-211-33HK	13-221-33HK
1st Bicuspid (L4)	-17°	0°	0°	2.8	LR	●	-	13-211-44	13-221-44	
					LL	●		13-211-34	13-221-34	
					LR	●		D	13-211-44HK	13-221-44HK
					LL	●		D	13-211-34HK	13-221-34HK
2nd Bicuspid (L5)	-22°	0°	0°	2.8	LR	●	-	13-211-45	13-221-45	
					LL	●		13-211-35	13-221-35	
					LR	●		D	13-211-45HK	13-221-45HK
					LL	●		D	13-211-35HK	13-221-35HK

BRACKET SYSTEMS

Copolla Brackets



BRACKET I.D. CHART

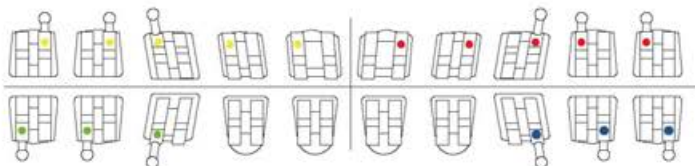

Copolla series McBeTr* standard bracket kits

	.018 in.	.022 in.
U/L 5x5	KIT13-311-00	KIT13-321-00
U/L 5x5 Hook on 3	KIT13-311-00CHK	KIT13-321-00CHK
U/L 5x5 Hook on 3, 4 & 5	KIT13-311-00CBCHK	KIT13-321-00CBCHK

MAXILLARY

McBeTr* Standard

Tooth	Torque	Angle	Offset	M/D in mm	R/L	Color Code	Hook	Item Number	
								.018	.022
Central (U1)	+17°	+4°	0°	3.6	UR	●	-	13-311-11	13-321-11
					UL	●	-	13-311-21	13-321-21
Lateral (U2)	+10°	+8°	0°	3	UR	●	-	13-311-12	13-321-12
					UL	●	-	13-311-22	13-321-22
Cuspid (U3)	-7°	+8°	0°	3	UR	●	-	13-311-13	13-321-13
					UL	●	-	13-311-23	13-321-23
					UR	●	D	13-311-13HK	13-321-13HK
					UL	●	D	13-311-23HK	13-321-23HK
Bicuspid (U4)	-7°	0°	0°	3	UR	●	-	13-311-14	13-321-14
					UL	●	-	13-311-24	13-321-24
					UR	●	M	13-311-14HK	13-321-14HK
					UL	●	M	13-311-24HK	13-321-24HK
Bicuspid (U5)	-7°	0°	0°	3	UR	●	-	13-311-15	13-321-15
					UL	●	-	13-311-25	13-321-25
					UR	●	M	13-311-15HK	13-321-15HK
					UL	●	M	13-311-25HK	13-321-25HK

MANDIBULAR

Tooth	Torque	Angle	Offset	M/D in mm	R/L	Color Code	Hook	Item Number	
								.018	.022
Anteriors (L1)	-6°	0°	0°	2.6	LR	●	-	13-311-41	13-321-41
					LL	●	-	13-311-31	13-321-31
Anteriors (L2)	-6°	0°	0°	2.6	LR	●	-	13-311-42	13-321-42
					LL	●	-	13-311-32	13-321-32
Cuspid (L3)	-6°	+3°	0°	3	LR	●	-	13-311-43	13-321-43
					LL	●	-	13-311-33	13-321-33
					LR	●	D	13-311-43HK	13-321-43HK
					LL	●	D	13-311-33HK	13-321-33HK
1st Bicuspid (L4)	-12°	0°	0°	3	LR	●	-	13-311-44	13-321-44
					LL	●	-	13-311-34	13-321-34
					LR	●	D	13-311-44HK	13-321-44HK
					LL	●	D	13-311-34HK	13-321-34HK
2nd Bicuspid (L5)	-17°	0°	0°	3	LR	●	-	13-311-45	13-321-45
					LL	●	-	13-311-35	13-321-35
					LR	●	D	13-311-45HK	13-321-45HK
					LL	●	D	13-311-35HK	13-321-35HK

* Our version of the Roth Rx is not implied to be an exact version of any other system, nor do we claim any endorsement of Dr. Roth. Our version of the McLaughlin, Bennett, and Trevis system is not implied to be an exact version of any other system, nor do we claim any endorsement of doctors McLaughlin, Bennett, and Trevis.

BRACKET SYSTEMS

Ophro Brackets

OPHRO

Metal Injection Molding (MIM) with 17-4PH stainless steel for easier wire insertion, eliminates sharp edges, increases patient comfort, and improves overall treatment

Round facial contours and mini-size make the brackets less noticeable and enhance patient comfort

Computer Aided Design ensures the brackets design around the idea and bringing them both closer to the teeth

Center Scribe Line for more accurate bracket placement

Bidirectional Arch Base for increased bond strength and accurate bracket placement

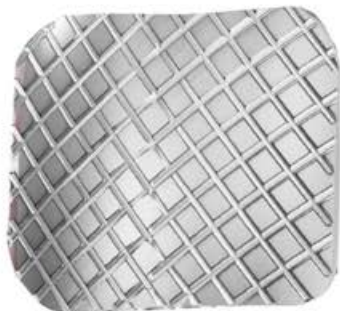

An 80 gauge mesh forming a superior surface area of interlocking retention



Low profile adds to the bracket's aesthetics and comfort while expressing precise programming for effective mechanics

BRACKET SYSTEMS

Ophro Brackets



BRACKET I.D. CHART

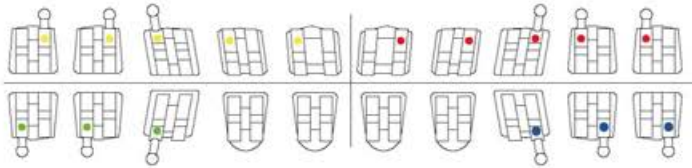

Ophro series McBeTr® standard bracket kits

	.018 in.	.022 in.
U/L 5×5	KIT12-311-00	KIT12-321-00
U/L 5×5 Hook on 3	KIT12-311-00CHK	KIT12-321-00CHK
U/L 5×5 Hook on 3, 4 & 5	KIT12-311-00CBCHK	KIT12-321-00CBCHK

MAXILLARY

McBeTr® Standard

Tooth	Torque	Angle	Offset	M/D in mm	R/L	Color Code	Hook	Item Number	
								.018	.022
Central (U1)	+17°	+4°	0°	3.4	UR	●	-	12-311-11	12-321-11
								12-311-21	12-321-21
Lateral (U2)	+10°	+8°	0°	2.65	UR	●	-	12-311-12	12-321-12
								12-311-22	12-321-22
Cuspid (U3)	-7°	+8°	0°	2.8	UR	●	-	12-311-13	12-321-13
								12-311-23	12-321-23
					UR	●	D	12-311-13HK	12-321-13HK
								12-311-23HK	12-321-23HK
Bicuspid (U4)	-7°	0°	0°	3	UR	●	-	12-311-14	12-321-14
								12-311-24	12-321-24
UR	●	M	12-311-14HK	12-321-14HK					
			12-311-24HK	12-321-24HK					
Bicuspid (U5)	-7°	0°	0°	3	UR	●	-	12-311-15	12-321-15
								12-311-25	12-321-25
					UR	●	M	12-311-15HK	12-321-15HK
								12-311-25HK	12-321-25HK

MANDIBULAR

Tooth	Torque	Angle	Offset	M/D in mm	R/L	Color Code	Hook	Item Number	
								.018	.022
Anteriors (L1)	-6°	0°	0°	2.35	LR	●	-	12-311-41	12-321-41
								12-311-31	12-321-31
Anteriors (L2)	-6°	0°	0°	2.35	LR	●	-	12-311-42	12-321-42
								12-311-32	12-321-32
Cuspid (L3)	-6°	3°	0°	3	LR	●	-	12-311-43	12-321-43
								12-311-33	12-321-33
					LR	●	D	12-311-43HK	12-321-43HK
								12-311-33HK	12-321-33HK
1st Bicuspid (L4)	-12°	2°	0°	3	LR	●	-	12-311-44	12-321-44
								12-311-34	12-321-34
LR	●	D	12-311-44HK	12-321-44HK					
			12-311-34HK	12-321-34HK					
2nd Bicuspid (L5)	-17°	2°	0°	3	LR	●	-	12-311-45	12-321-45
								12-311-35	12-321-35
					LR	●	D	12-311-45HK	12-321-45HK
								12-311-35HK	12-321-35HK

* Our version of the Roth Rx is not implied to be an exact version of any other system, nor do we claim any endorsement of Dr. Roth. Our version of the McLaughlin, Bennett, and Trevisi system is not implied to be an exact version of any other system, nor do we claim any endorsement of doctors McLaughlin, Bennett, and Trevisi.

BRACKET SYSTEMS

Helio Brackets



BRACKET I.D. CHART

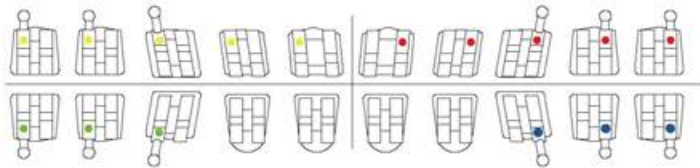

- Metal Injection Molding (MIM) for smooth and non-deformable slot
- A 80 gauge mesh

Helio series Edgewise standard bracket kits

	.018 in.	.022 in.
U/L 5x5	KIT14-111-00	KIT14-121-00
U/L 5x5 Hook on 3	KIT14-111-00CHK	KIT14-121-00CHK
U/L 5x5 Hook on 3, 4 & 5	KIT14-111-00CBCHK	KIT14-121-00CBCHK

MAXILLARY

Edgewise Standard

Tooth	Torque	Angle	Offset	M/D in mm	R/L	Color Code	Hook	Item Number	
								.018	.022
Central (U1)	0°	0°	0°	3.2	UR	●	-	14-111-11	14-121-11
					UL	●	-	14-111-21	14-121-21
Lateral (U2)	0°	0°	0°	2.8	UR	●	-	14-111-12	14-121-12
					UL	●	-	14-111-22	14-121-22
Cuspid (U3)	0°	0°	0°	2.8	UR	●	-	14-111-13	14-121-13
					UL	●	-	14-111-23	14-121-23
					UR	●	D	14-111-13HK	14-121-13HK
					UL	●	D	14-111-23HK	14-121-23HK
Bicuspid (U4)	0°	0°	0°	2.8	UR	●	-	14-111-14	14-121-14
					UL	●	-	14-111-24	14-121-24
					UR	●	D	14-111-14HK	14-121-14HK
					UL	●	D	14-111-24HK	14-121-24HK
Bicuspid (U5)	0°	0°	0°	2.8	UR	●	-	14-111-15	14-121-15
					UL	●	-	14-111-25	14-121-25
					UR	●	D	14-111-15HK	14-121-15HK
					UL	●	D	14-111-25HK	14-121-25HK

MANDIBULAR

Tooth	Torque	Angle	Offset	M/D in mm	R/L	Color Code	Hook	Item Number	
								.018	.022
Anteriors (L1)	0°	0°	0°	2.4	LR	●	-	14-111-41	14-121-41
					LL	●	-	14-111-31	14-121-31
Anteriors (L2)	0°	0°	0°	2.4	LR	●	-	14-111-42	14-121-42
					LL	●	-	14-111-32	14-121-32
Cuspid (L3)	0°	0°	0°	2.8	LR	●	-	14-111-43	14-121-43
					LL	●	-	14-111-33	14-121-33
					LR	●	D	14-111-43HK	14-121-43HK
					LL	●	D	14-111-33HK	14-121-33HK
1st Bicuspid (L4)	0°	0°	0°	2.8	LR	●	-	14-111-44	14-121-44
					LL	●	-	14-111-34	14-121-34
					LR	●	D	14-111-44HK	14-121-44HK
					LL	●	D	14-111-34HK	14-121-34HK
2nd Bicuspid (L5)	0°	0°	0°	2.8	LR	●	-	14-111-45	14-121-45
					LL	●	-	14-111-35	14-121-35
					LR	●	D	14-111-45HK	14-121-45HK
					LL	●	D	14-111-35HK	14-121-35HK



BRACKET I.D. CHART

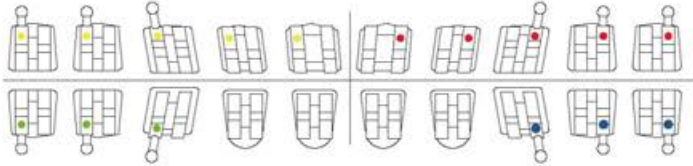

Helio series Edgewise mini bracket kits

	.018 in.	.022 in.
U/L 5×5	KIT14-112-00	KIT14-122-00
U/L 5×5 Hook on 3	KIT14-112-00CHK	KIT14-122-00CHK
U/L 5×5 Hook on 3, 4 & 5	KIT14-112-00CBCHK	KIT14-122-00CBCHK

MAXILLARY

Edgewise Mini

Tooth	Torque	Angle	Offset	M/D in mm	R/L	Color Code	Hook	Item Number	
								.018	.022
Central (U1)	0°	0°	0°	3	UR	●	-	14-112-11	14-122-11
								14-112-21	14-122-21
Lateral (U2)	0°	0°	0°	3	UR	●	-	14-112-12	14-122-12
								14-112-22	14-122-22
Cuspid (U3)	0°	0°	0°	2.6	UR	●	-	14-112-13	14-122-13
								14-112-23	14-122-23
					UR	●	D	14-112-13HK	14-122-13HK
								14-112-23HK	14-122-23HK
Bicuspid (U4)	0°	0°	0°	2.6	UR	●	-	14-112-14	14-122-14
								14-112-24	14-122-24
					UR	●	D	14-112-14HK	14-122-14HK
								14-112-24HK	14-122-24HK
Bicuspid (U5)	0°	0°	0°	2.6	UR	●	-	14-112-15	14-122-15
								14-112-25	14-122-25
					UR	●	D	14-112-15HK	14-122-15HK
								14-112-25HK	14-122-25HK

MANDIBULAR

Tooth	Torque	Angle	Offset	M/D in mm	R/L	Color Code	Hook	Item Number	
								.018	.022
Anteriors (L1)	0°	0°	0°	2.4	LR	●	-	14-112-41	14-122-41
								14-112-31	14-122-31
Anteriors (L2)	0°	0°	0°	2.4	LR	●	-	14-112-42	14-122-42
								14-112-32	14-122-32
Cuspid (L3)	0°	0°	0°	2.6	LR	●	-	14-112-43	14-122-43
								14-112-33	14-122-33
					LR	●	D	14-112-43HK	14-122-43HK
								14-112-33HK	14-122-33HK
1st Bicuspid (L4)	0°	0°	0°	2.6	LR	●	-	14-112-44	14-122-44
								14-112-34	14-122-34
					LR	●	D	14-112-44HK	14-122-44HK
								14-112-34HK	14-122-34HK
2nd Bicuspid (L5)	0°	0°	0°	2.6	LR	●	-	14-112-45	14-122-45
								14-112-35	14-122-35
					LR	●	D	14-112-45HK	14-122-45HK
								14-112-35HK	14-122-35HK

BRACKET SYSTEMS

Helio Brackets



BRACKET I.D. CHART

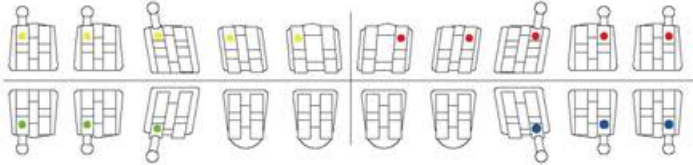

Helio series Roth* standard bracket kits

	.018 in.	.022 in.
U/L 5x5	KIT14-211-00	KIT14-221-00
U/L 5x5 Hook on 3	KIT14-211-00CHK	KIT14-221-00CHK
U/L 5x5 Hook on 3, 4 & 5	KIT14-211-00CBCHK	KIT14-221-00CBCHK

MAXILLARY

Roth* Standard

Tooth	Torque	Angle	Offset	M/D in mm	R/L	Color Code	Hook	Item Number	
								.018	.022
Central (U1)	+12°	+5°	0°	3.3	UR	●	-	14-211-11	14-221-11
								14-211-21	14-221-21
Lateral (U2)	+8°	+9°	0°	2.8	UR	●	-	14-211-12	14-221-12
								14-211-22	14-221-22
Cuspid (U3)	-2°	+13°	0°	3	UR	●	-	14-211-13	14-221-13
								14-211-23	14-221-23
					UR	●	D	14-211-13HK	14-221-13HK
								14-211-23HK	14-221-23HK
Bicuspid (U4)	-7°	0°	0°	2.8	UR	●	-	14-211-14	14-221-14
								14-211-24	14-221-24
					UR	●	D	14-211-14HK	14-221-14HK
								14-211-24HK	14-221-24HK
Bicuspid (U5)	-7°	0°	0°	2.8	UR	●	-	14-211-15	14-221-15
								14-211-25	14-221-25
					UR	●	D	14-211-15HK	14-221-15HK
								14-211-25HK	14-221-25HK

MANDIBULAR

Tooth	Torque	Angle	Offset	M/D in mm	R/L	Color Code	Hook	Item Number	
								.018	.022
Anteriors (L1)	-1°	+2°	0°	2.4	LR	●	-	14-211-41	14-221-41
								14-211-31	14-221-31
Anteriors (L2)	-1°	+2°	0°	2.4	LR	●	-	14-211-42	14-221-42
								14-211-32	14-221-32
Cuspid (L3)	-11°	+7°	0°	3	LR	●	-	14-211-43	14-221-43
								14-211-33	14-221-33
					LR	●	D	14-211-43HK	14-221-43HK
								14-211-33HK	14-221-33HK
1st Bicuspid (L4)	-17°	-1°	0°	2.8	LR	●	-	14-211-44	14-221-44
								14-211-34	14-221-34
					LR	●	D	14-211-44HK	14-221-44HK
								14-211-34HK	14-221-34HK
2nd Bicuspid (L5)	-22°	-1°	0°	2.8	LR	●	-	14-211-45	14-221-45
								14-211-35	14-221-35
					LR	●	D	14-211-45HK	14-221-45HK
								14-211-35HK	14-221-35HK



BRACKET I.D. CHART

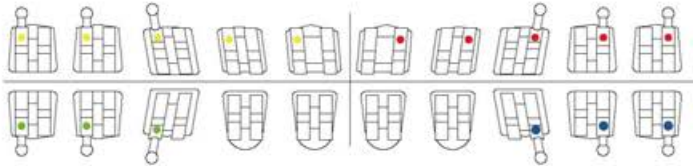

Helio series Roth* mini bracket kits

	.018 in.	.022 in.
U/L 5x5	KIT14-212-00	KIT14-222-00
U/L 5x5 Hook on 3	KIT14-212-00CHK	KIT14-222-00CHK
U/L 5x5 Hook on 3, 4 & 5	KIT14-212-00CBCHK	KIT14-222-00CBCHK

MAXILLARY

Roth* Mini

Tooth	Torque	Angle	Offset	M/D in mm	R/L	Color Code	Hook	Item Number	
								.018	.022
Central (U1)	+12°	+5°	0°	3	UR	●	-	14-212-11	14-222-11
					UL	●	-	14-212-21	14-222-21
Lateral (U2)	+8°	+9°	0°	2.8	UR	●	-	14-212-12	14-222-12
					UL	●	-	14-212-22	14-222-22
Cuspid (U3)	-2°	+13°	0°	2.8	UR	●	-	14-212-13	14-222-13
					UL	●	-	14-212-23	14-222-23
					UR	●	D	14-212-13HK	14-222-13HK
					UL	●	D	14-212-23HK	14-222-23HK
Bicuspid (U4)	-7°	0°	0°	2.6	UR	●	-	14-212-14	14-222-14
					UL	●	-	14-212-24	14-222-24
					UR	●	D	14-212-14HK	14-222-14HK
					UL	●	D	14-212-24HK	14-222-24HK
Bicuspid (U5)	-7°	0°	0°	2.6	UR	●	-	14-212-15	14-222-15
					UL	●	-	14-212-25	14-222-25
					UR	●	D	14-212-15HK	14-222-15HK
					UL	●	D	14-212-25HK	14-222-25HK

MANDIBULAR

Tooth	Torque	Angle	Offset	M/D in mm	R/L	Color Code	Hook	Item Number	
								.018	.022
Anteriors (L1)	-1°	+2°	0°	2.4	LR	●	-	14-212-41	14-222-41
					LL	●	-	14-212-31	14-222-31
Anteriors (L2)	-1°	+2°	0°	2.4	LR	●	-	14-212-42	14-222-42
					LL	●	-	14-212-32	14-222-32
Cuspid (L3)	-11°	+7°	0°	2.8	LR	●	-	14-212-43	14-222-43
					LL	●	-	14-212-33	14-222-33
					LR	●	D	14-212-43HK	14-222-43HK
					LL	●	D	14-212-33HK	14-222-33HK
1st Bicuspid (L4)	-17°	-1°	0°	2.6	LR	●	-	14-212-44	14-222-44
					LL	●	-	14-212-34	14-222-34
					LR	●	D	14-212-44HK	14-222-44HK
					LL	●	D	14-212-34HK	14-222-34HK
2nd Bicuspid (L5)	-22°	-1°	0°	2.6	LR	●	-	14-212-45	14-222-45
					LL	●	-	14-212-35	14-222-35
					LR	●	D	14-212-45HK	14-222-45HK
					LL	●	D	14-212-35HK	14-222-35HK

BRACKET SYSTEMS

Helio Brackets



BRACKET I.D. CHART

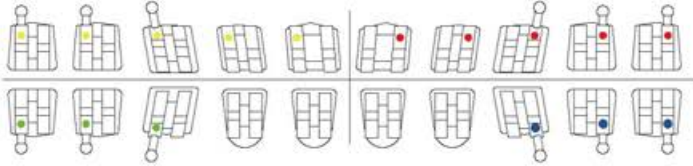

Helio series McBeTr* standard bracket kits

	.018 in.	.022 in.
U/L 5x5	KIT14-311-00	KIT14-321-00
U/L 5x5 Hook on 3	KIT14-311-00CHK	KIT14-321-00CHK
U/L 5x5 Hook on 3, 4 & 5	KIT14-311-00CBCHK	KIT14-321-00CBCHK

MAXILLARY

McBeTr* Standard

Tooth	Torque	Angle	Offset	M/D in mm	R/L	Color Code	Hook	Item Number	
								.018	.022
Central (U1)	+17°	+4°	0°	3.4	UR	●	-	14-311-11	14-321-11
					UL	●	-	14-311-21	14-321-21
Lateral (U2)	+10°	+8°	0°	3	UR	●	-	14-311-12	14-321-12
					UL	●	-	14-311-22	14-321-22
Cuspid (U3)	-7°	+8°	0°	3	UR	●	-	14-311-13	14-321-13
					UL	●	-	14-311-23	14-321-23
					UR	●	D	14-311-13HK	14-321-13HK
					UL	●	D	14-311-23HK	14-321-23HK
Bicuspid (U4)	-7°	0°	0°	3	UR	●	-	14-311-14	14-321-14
					UL	●	-	14-311-24	14-321-24
					UR	●	D	14-311-14HK	14-321-14HK
					UL	●	D	14-311-24HK	14-321-24HK
Bicuspid (U5)	-7°	0°	0°	3	UR	●	-	14-311-15	14-321-15
					UL	●	-	14-311-25	14-321-25
					UR	●	D	14-311-15HK	14-321-15HK
					UL	●	D	14-311-25HK	14-321-25HK

MANDIBULAR

Tooth	Torque	Angle	Offset	M/D in mm	R/L	Color Code	Hook	Item Number	
								.018	.022
Anteriors (L1)	-6°	0°	0°	2.4	LR	●	-	14-311-41	14-321-41
					LL	●	-	14-311-31	14-321-31
Anteriors (L2)	-6°	0°	0°	2.4	LR	●	-	14-311-42	14-321-42
					LL	●	-	14-311-32	14-321-32
Cuspid (L3)	-6°	+3°	0°	3	LR	●	-	14-311-43	14-321-43
					LL	●	-	14-311-33	14-321-33
					LR	●	D	14-311-43HK	14-321-43HK
					LL	●	D	14-311-33HK	14-321-33HK
1st Bicuspid (L4)	-12°	+2°	0°	3	LR	●	-	14-311-44	14-321-44
					LL	●	-	14-311-34	14-321-34
					LR	●	D	14-311-44HK	14-321-44HK
					LL	●	D	14-311-34HK	14-321-34HK
2nd Bicuspid (L5)	-17°	+2°	0°	3	LR	●	-	14-311-45	14-321-45
					LL	●	-	14-311-35	14-321-35
					LR	●	D	14-311-45HK	14-321-45HK
					LL	●	D	14-311-35HK	14-321-35HK



BRACKET I.D. CHART

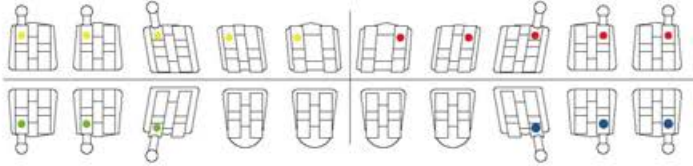

Helio series McBeTr* mini bracket kits

	.018 in.	.022 in.
U/L 5x5	KIT14-312-00	KIT14-322-00
U/L 5x5 Hook on 3	KIT14-312-00CHK	KIT14-322-00CHK
U/L 5x5 Hook on 3, 4 & 5	KIT14-312-00CBCHK	KIT14-322-00CBCHK

MAXILLARY

McBeTr* Mini

Tooth	Torque	Angle	Offset	M/D in mm	R/L	Color Code	Hook	Item Number	
								.018	.022
Central (U1)	+17°	+4°	0°	3.4	UR	●	-	14-312-11	14-322-11
					UL	●	-	14-312-21	14-322-21
Lateral (U2)	+10°	+8°	0°	3	UR	●	-	14-312-12	14-322-12
					UL	●	-	14-312-22	14-322-22
Cuspid (U3)	-7°	+8°	0°	3	UR	●	-	14-312-13	14-322-13
					UL	●	-	14-312-23	14-322-23
					UR	●	D	14-312-13HK	14-322-13HK
					UL	●	D	14-312-23HK	14-322-23HK
Bicuspid (U4)	-7°	0°	0°	3	UR	●	-	14-312-14	14-322-14
					UL	●	-	14-312-24	14-322-24
					UR	●	D	14-312-14HK	14-322-14HK
					UL	●	D	14-312-24HK	14-322-24HK
Bicuspid (U5)	-7°	0°	0°	3	UR	●	-	14-312-15	14-322-15
					UL	●	-	14-312-25	14-322-25
					UR	●	D	14-312-15HK	14-322-15HK
					UL	●	D	14-312-25HK	14-322-25HK

MANDIBULAR

Tooth	Torque	Angle	Offset	M/D in mm	R/L	Color Code	Hook	Item Number	
								.018	.022
Anteriors (L1)	-6°	0°	0°	2.4	LR	●	-	14-312-41	14-322-41
					LL	●	-	14-312-31	14-322-31
Anteriors (L2)	-6°	0°	0°	2.4	LR	●	-	14-312-42	14-322-42
					LL	●	-	14-312-32	14-322-32
Cuspid (L3)	-6°	+3°	0°	3	LR	●	-	14-312-43	14-322-43
					LL	●	-	14-312-33	14-322-33
					LR	●	D	14-312-43HK	14-322-43HK
					LL	●	D	14-312-33HK	14-322-33HK
1st Bicuspid (L4)	-12°	+2°	0°	3	LR	●	-	14-312-44	14-322-44
					LL	●	-	14-312-34	14-322-34
					LR	●	D	14-312-44HK	14-322-44HK
					LL	●	D	14-312-34HK	14-322-34HK
2nd Bicuspid (L5)	-17°	+2°	0°	3	LR	●	-	14-312-45	14-322-45
					LL	●	-	14-312-35	14-322-35
					LR	●	D	14-312-45HK	14-322-45HK
					LL	●	D	14-312-35HK	14-322-35HK

BRACKET SYSTEMS

Smile Brackets



BRACKET I.D. CHART

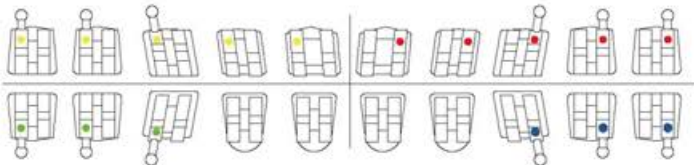

- Milling technology with stainless steel for non-deformable slot
- Traditional one piece bracket with good stiffness and amazing bonding strength

Smile series Edgewise standard bracket kits

	.018 in.	.022 in.
U/L 5x5	KIT15-111-00	KIT15-121-00
U/L 5x5 Hook on 3	KIT15-111-00CHK	KIT15-121-00CHK
U/L 5x5 Hook on 3, 4 & 5	KIT15-111-00CBCHK	KIT15-121-00CBCHK

MAXILLARY								Edgewise Standard		
Tooth	Torque	Angle	Offset	M/D in mm	R/L	Color Code	Hook	Item Number		
								.018	.022	
Central (U1)	0°	0°	0°	3	UR	●	-	15-111-11	15-121-11	
					UL	●	-	15-111-21	15-121-21	
Lateral (U2)	0°	0°	0°	2.7	UR	●	-	15-111-12	15-121-12	
					UL	●	-	15-111-22	15-121-22	
Cuspid (U3)	0°	0°	0°	2.3	UR	●	-	15-111-13	15-121-13	
					UL	●	-	15-111-23	15-121-23	
					UR	●	D	15-111-13HK	15-121-13HK	
					UL	●	D	15-111-23HK	15-121-23HK	
Bicuspid (U4)	0°	0°	0°	3	UR	●	-	15-111-14	15-121-14	
					UL	●	-	15-111-24	15-121-24	
					UR	●	D	15-111-14HK	15-121-14HK	
					UL	●	D	15-111-24HK	15-121-24HK	
Bicuspid (U5)	0°	0°	0°	2.7	UR	●	-	15-111-15	15-121-15	
					UL	●	-	15-111-25	15-121-25	
					UR	●	D	15-111-15HK	15-121-15HK	
					UL	●	D	15-111-25HK	15-121-25HK	

MANDIBULAR									
Tooth	Torque	Angle	Offset	M/D in mm	R/L	Color Code	Hook	Item Number	
								.018	.022
Anteriors (L1)	0°	0°	0°	3	LR	●	-	15-111-41	15-121-41
					LL	●	-	15-111-31	15-121-31
Anteriors (L2)	0°	0°	0°	2.7	LR	●	-	15-111-42	15-121-42
					LL	●	-	15-111-32	15-121-32
Cuspid (L3)	0°	0°	0°	2.3	LR	●	-	15-111-43	15-121-43
					LL	●	-	15-111-33	15-121-33
					LR	●	D	15-111-43HK	15-121-43HK
					LL	●	D	15-111-33HK	15-121-33HK
1st Bicuspid (L4)	0°	0°	0°	3	LR	●	-	15-111-44	15-121-44
					LL	●	-	15-111-34	15-121-34
					LR	●	D	15-111-44HK	15-121-44HK
					LL	●	D	15-111-34HK	15-121-34HK
2nd Bicuspid (L5)	0°	0°	0°	2.7	LR	●	-	15-111-45	15-121-45
					LL	●	-	15-111-35	15-121-35
					LR	●	D	15-111-45HK	15-121-45HK
					LL	●	D	15-111-35HK	15-121-35HK

BRACKET SYSTEMS

Smile Brackets



BRACKET I.D. CHART

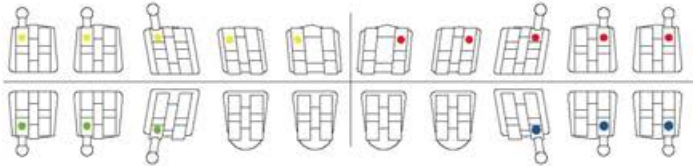

Smile series Edgewise mini bracket kits

	.018 in.	.022 in.
U/L 5x5	KIT15-112-00	KIT15-122-00
U/L 5x5 Hook on 3	KIT15-112-00CHK	KIT15-122-00CHK
U/L 5x5 Hook on 3, 4 & 5	KIT15-112-00CBCHK	KIT15-122-00CBCHK

Sandblasted base to provide safe and consistent bonding

MAXILLARY

Tooth	Torque	Angle	Offset	M/D in mm	R/L	Color Code	Hook	Edgewise Mini Item Number	
								.018	.022
Central (U1)	0°	0°	0°	3	UR	●	-	15-112-11	15-122-11
								15-112-21	15-122-21
Lateral (U2)	0°	0°	0°	2.7	UR	●	-	15-112-12	15-122-12
								15-112-22	15-122-22
Cuspid (U3)	0°	0°	0°	2.3	UR	●	-	15-112-13	15-122-13
								15-112-23	15-122-23
					UR	●	D	15-112-13HK	15-122-13HK
								15-112-23HK	15-122-23HK
Bicuspid (U4)	0°	0°	0°	3	UR	●	-	15-112-14	15-122-14
								15-112-24	15-122-24
					UR	●	D	15-112-14HK	15-122-14HK
								15-112-24HK	15-122-24HK
Bicuspid (U5)	0°	0°	0°	2.7	UR	●	-	15-112-15	15-122-15
								15-112-25	15-122-25
					UR	●	D	15-112-15HK	15-122-15HK
								15-112-25HK	15-122-25HK

MANDIBULAR

Tooth	Torque	Angle	Offset	M/D in mm	R/L	Color Code	Hook	Edgewise Mini Item Number	
								.018	.022
Anteriors (L1)	0°	0°	0°	3	LR	●	-	15-112-41	15-122-41
								15-112-31	15-122-31
Anteriors (L2)	0°	0°	0°	2.6	LR	●	-	15-112-42	15-122-42
								15-112-32	15-122-32
Cuspid (L3)	0°	0°	0°	2.6	LR	●	-	15-112-43	15-122-43
								15-112-33	15-122-33
					LR	●	D	15-112-43HK	15-122-43HK
								15-112-33HK	15-122-33HK
1st Bicuspid (L4)	0°	0°	0°	2.6	LR	●	-	15-112-44	15-122-44
								15-112-34	15-122-34
					LR	●	D	15-112-44HK	15-122-44HK
								15-112-34HK	15-122-34HK
2nd Bicuspid (L5)	0°	0°	0°	2.6	LR	●	-	15-112-45	15-122-45
								15-112-35	15-122-35
					LR	●	D	15-112-45HK	15-122-45HK
								15-112-35HK	15-122-35HK

BRACKET SYSTEMS

Smile Brackets



BRACKET I.D. CHART

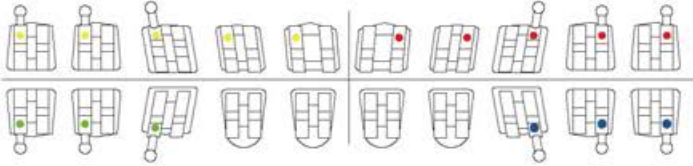

Smile series Roth* standard bracket kits

	.018 in.	.022 in.
U/L 5x5	KIT15-211-00	KIT15-221-00
U/L 5x5 Hook on 3	KIT15-211-00CHK	KIT15-221-00CHK
U/L 5x5 Hook on 3, 4 & 5	KIT15-211-00CBCHK	KIT15-221-00CBCHK

MAXILLARY

Roth* Standard

Tooth	Torque	Angle	Offset	M/D in mm	R/L	Color Code	Hook	Item Number	
								.018	.022
Central (U1)	+12°	+5°	0°	3.2	UR	●	-	15-211-11	15-221-11
					UL	●	-	15-211-21	15-221-21
Lateral (U2)	+8°	+9°	0°	2.8	UR	●	-	15-211-12	15-221-12
					UL	●	-	15-211-22	15-221-22
Cuspid (U3)	-2°	+13°	0°	3.2	UR	●	-	15-211-13	15-221-13
					UL	●	-	15-211-23	15-221-23
					UR	●	D	15-211-13HK	15-221-13HK
					UL	●	D	15-211-23HK	15-221-23HK
Bicuspid (U4)	-7°	0°	0°	3	UR	●	-	15-211-14	15-221-14
					UL	●	-	15-211-24	15-221-24
					UR	●	D	15-211-14HK	15-221-14HK
					UL	●	D	15-211-24HK	15-221-24HK
Bicuspid (U5)	-7°	0°	0°	3	UR	●	-	15-211-15	15-221-15
					UL	●	-	15-211-25	15-221-25
					UR	●	D	15-211-15HK	15-221-15HK
					UL	●	D	15-211-25HK	15-221-25HK

MANDIBULAR

Tooth	Torque	Angle	Offset	M/D in mm	R/L	Color Code	Hook	Item Number	
								.018	.022
Anteriors (L1)	-1°	+2°	0°	2.4	LR	●	-	15-211-41	15-221-41
					LL	●	-	15-211-31	15-221-31
Anteriors (L2)	-1°	+2°	0°	2.4	LR	●	-	15-211-42	15-221-42
					LL	●	-	15-211-32	15-221-32
Cuspid (L3)	-11°	+7°	0°	3.2	LR	●	-	15-211-43	15-221-43
					LL	●	-	15-211-33	15-221-33
					LR	●	D	15-211-43HK	15-221-43HK
					LL	●	D	15-211-33HK	15-221-33HK
1st Bicuspid (L4)	-17°	-1°	0°	3	LR	●	-	15-211-44	15-221-44
					LL	●	-	15-211-34	15-221-34
					LR	●	D	15-211-44HK	15-221-44HK
					LL	●	D	15-211-34HK	15-221-34HK
2nd Bicuspid (L5)	-22°	-1°	0°	3	LR	●	-	15-211-45	15-221-45
					LL	●	-	15-211-35	15-221-35
					LR	●	D	15-211-45HK	15-221-45HK
					LL	●	D	15-211-35HK	15-221-35HK

* Our version of the Roth Rx is not implied to be an exact version of any other system, nor do we claim any endorsement of Dr. Roth. Our version of the McLaughlin, Bennett, and Trevisi system is not implied to be an exact version of any other system, nor do we claim any endorsement of doctors McLaughlin, Bennett, and Trevisi.

BRACKET SYSTEMS

Smile Brackets



BRACKET I.D. CHART

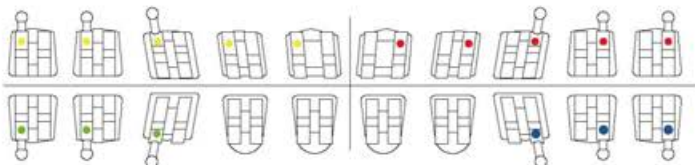

Smile series Roth* mini bracket kits

	.018 in.	.022 in.
U/L 5x5	KIT15-212-00	KIT15-222-00
U/L 5x5 Hook on 3	KIT15-212-00CHK	KIT15-222-00CHK
U/L 5x5 Hook on 3, 4 & 5	KIT15-212-00CBCHK	KIT15-222-00CBCHK

MAXILLARY

Roth* Mini

Tooth	Torque	Angle	Offset	M/D in mm	R/L	Color Code	Hook	Item Number	
								.018	.022
Central (U1)	+12°	+5°	0°	3	UR	●	-	15-212-11	15-222-11
					UL	●	-	15-212-21	15-222-21
Lateral (U2)	+8°	+9°	0°	2.6	UR	●	-	15-212-12	15-222-12
					UL	●	-	15-212-22	15-222-22
Cuspid (U3)	-2°	+13°	0°	2.8	UR	●	-	15-212-13	15-222-13
					UL	●	-	15-212-23	15-222-23
					UR	●	D	15-212-13HK	15-222-13HK
					UL	●	D	15-212-23HK	15-222-23HK
Bicuspid (U4)	-7°	0°	0°	2.6	UR	●	-	15-212-14	15-222-14
					UL	●	-	15-212-24	15-222-24
					UR	●	D	15-212-14HK	15-222-14HK
					UL	●	D	15-212-24HK	15-222-24HK
Bicuspid (U5)	-7°	0°	0°	2.6	UR	●	-	15-212-15	15-222-15
					UL	●	-	15-212-25	15-222-25
					UR	●	D	15-212-15HK	15-222-15HK
					UL	●	D	15-212-25HK	15-222-25HK

MANDIBULAR

Tooth	Torque	Angle	Offset	M/D in mm	R/L	Color Code	Hook	Item Number	
								.018	.022
Anteriors (L1)	-1°	+2°	0°	2.4	LR	●	-	15-212-41	15-222-41
					LL	●	-	15-212-31	15-222-31
Anteriors (L2)	-1°	+2°	0°	2.4	LR	●	-	15-212-42	15-222-42
					LL	●	-	15-212-32	15-222-32
Cuspid (L3)	-11°	+7°	0°	2.8	LR	●	-	15-212-43	15-222-43
					LL	●	-	15-212-33	15-222-33
					LR	●	D	15-212-43HK	15-222-43HK
					LL	●	D	15-212-33HK	15-222-33HK
1st Bicuspid (L4)	-17°	-1°	0°	2.6	LR	●	-	15-212-44	15-222-44
					LL	●	-	15-212-34	15-222-34
					LR	●	D	15-212-44HK	15-222-44HK
					LL	●	D	15-212-34HK	15-222-34HK
2nd Bicuspid (L5)	-22°	-1°	0°	2.6	LR	●	-	15-212-45	15-222-45
					LL	●	-	15-212-35	15-222-35
					LR	●	D	15-212-45HK	15-222-45HK
					LL	●	D	15-212-35HK	15-222-35HK

* Our version of the Roth Rx is not implied to be an exact version of any other system, nor do we claim any endorsement of Dr. Roth. Our version of the McLaughlin, Bennett, and Trevisi system is not implied to be an exact version of any other system, nor do we claim any endorsement of doctors McLaughlin, Bennett, and Trevisi.

BRACKET SYSTEMS

Smile Brackets



BRACKET I.D. CHART

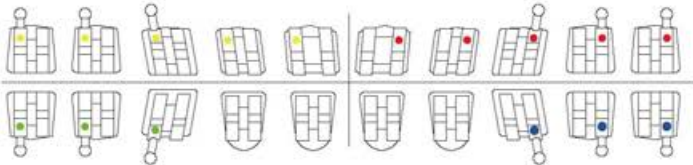

Smile series McBeTr* standard bracket kits

	.018 in.	.022 in.
U/L 5x5	KIT15-311-00	KIT15-321-00
U/L 5x5 Hook on 3	KIT15-311-00CHK	KIT15-321-00CHK
U/L 5x5 Hook on 3, 4 & 5	KIT15-311-00CBCHK	KIT15-321-00CBCHK

MAXILLARY

McBeTr* Bracket

Tooth	Torque	Angle	Offset	M/D in mm	R/L	Color Code	Hook	Item Number	
								.018	.022
Central (U1)	+17°	+4°	0°	3.6	UR	●	-	15-311-11	15-321-11
					UL	●	-	15-311-21	15-321-21
Lateral (U2)	+10°	+8°	0°	3	UR	●	-	15-311-12	15-321-12
					UL	●	-	15-311-22	15-321-22
Cuspid (U3)	-7°	+8°	0°	3	UR	●	-	15-311-13	15-321-13
					UL	●	-	15-311-23	15-321-23
					UR	●	D	15-311-13HK	15-321-13HK
					UL	●	D	15-311-23HK	15-321-23HK
Bicuspid (U4)	-7°	0°	0°	3	UR	●	-	15-311-14	15-321-14
					UL	●	-	15-311-24	15-321-24
					UR	●	D	15-311-14HK	15-321-14HK
					UL	●	D	15-311-24HK	15-321-24HK
Bicuspid (U5)	-7°	0°	0°	3	UR	●	-	15-311-15	15-321-15
					UL	●	-	15-311-25	15-321-25
					UR	●	D	15-311-15HK	15-321-15HK
					UL	●	D	15-311-25HK	15-321-25HK

MANDIBULAR

Tooth	Torque	Angle	Offset	M/D in mm	R/L	Color Code	Hook	Item Number	
								.018	.022
Anteriors (L1)	-6°	0°	0°	2.6	LR	●	-	15-311-41	15-321-41
					LL	●	-	15-311-31	15-321-31
Anteriors (L2)	-6°	0°	0°	2.6	LR	●	-	15-311-42	15-321-42
					LL	●	-	15-311-32	15-321-32
Cuspid (L3)	-6°	+3°	0°	3	LR	●	-	15-311-43	15-321-43
					LL	●	-	15-311-33	15-321-33
					LR	●	D	15-311-43HK	15-321-43HK
					LL	●	D	15-311-33HK	15-321-33HK
1st Bicuspid (L4)	-12°	+2°	0°	3	LR	●	-	15-311-44	15-321-44
					LL	●	-	15-311-34	15-321-34
					LR	●	D	15-311-44HK	15-321-44HK
					LL	●	D	15-311-34HK	15-321-34HK
2nd Bicuspid (L5)	-17°	+2°	0°	3	LR	●	-	15-311-45	15-321-45
					LL	●	-	15-311-35	15-321-35
					LR	●	D	15-311-45HK	15-321-45HK
					LL	●	D	15-311-35HK	15-321-35HK

BRACKET SYSTEMS

Smile Brackets



BRACKET I.D. CHART

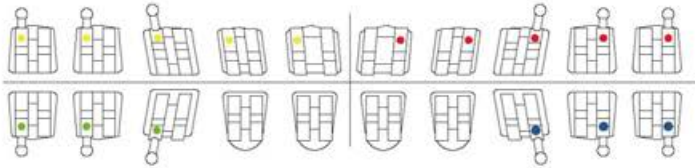

Smile series McBeTr* mini bracket kits

	.018 in.	.022 in.
U/L 5x5	KIT15-312-00	KIT15-322-00
U/L 5x5 Hook on 3	KIT15-312-00CHK	KIT15-322-00CHK
U/L 5x5 Hook on 3, 4 & 5	KIT15-312-00CBCHK	KIT15-322-00CBCHK

MAXILLARY

McBeTr* Mini

Tooth	Torque	Angle	Offset	M/D in mm	R/L	Color Code	Hook	Item Number	
								.018	.022
Central (U1)	+17°	+4°	0°	3.4	UR	●	-	15-312-11	15-322-11
					UL	●	-	15-312-21	15-322-21
Lateral (U2)	+10°	+8°	0°	2.8	UR	●	-	15-312-12	15-322-12
					UL	●	-	15-312-22	15-322-22
Cuspid (U3)	-7°	+8°	0°	3	UR	●	-	15-312-13	15-322-13
					UL	●	-	15-312-23	15-322-23
					UR	●	D	15-312-13HK	15-322-13HK
					UL	●	D	15-312-23HK	15-322-23HK
Bicuspid (U4)	-7°	0°	0°	2.8	UR	●	-	15-312-14	15-322-14
					UL	●	-	15-312-24	15-322-24
					UR	●	D	15-312-14HK	15-322-14HK
					UL	●	D	15-312-24HK	15-322-24HK
Bicuspid (U5)	-7°	0°	0°	2.8	UR	●	-	15-312-15	15-322-15
					UL	●	-	15-312-25	15-322-25
					UR	●	D	15-312-15HK	15-322-15HK
					UL	●	D	15-312-25HK	15-322-25HK

MANDIBULAR

Tooth	Torque	Angle	Offset	M/D in mm	R/L	Color Code	Hook	Item Number	
								.018	.022
Anteriors (L1)	-6°	0°	0°	2.4	LR	●	-	15-312-41	15-322-41
					LL	●	-	15-312-31	15-322-31
Anteriors (L2)	-6°	0°	0°	2.4	LR	●	-	15-312-42	15-322-42
					LL	●	-	15-312-32	15-322-32
Cuspid (L3)	-6°	+3°	0°	3	LR	●	-	15-312-43	15-322-43
					LL	●	-	15-312-33	15-322-33
					LR	●	D	15-312-43HK	15-322-43HK
					LL	●	D	15-312-33HK	15-322-33HK
1st Bicuspid (L4)	-12°	+2°	0°	2.8	LR	●	-	15-312-44	15-322-44
					LL	●	-	15-312-34	15-322-34
					LR	●	D	15-312-44HK	15-322-44HK
					LL	●	D	15-312-34HK	15-322-34HK
2nd Bicuspid (L5)	-17°	+2°	0°	2.8	LR	●	-	15-312-45	15-322-45
					LL	●	-	15-312-35	15-322-35
					LR	●	D	15-312-45HK	15-322-45HK
					LL	●	D	15-312-35HK	15-322-35HK

* Our version of the Roth Rx is not implied to be an exact version of any other system, nor do we claim any endorsement of Dr. Roth. Our version of the McLaughlin, Bennett, and Trevisi system is not implied to be an exact version of any other system, nor do we claim any endorsement of doctors McLaughlin, Bennett, and Trevisi.

BUCCA



EAL TUBE



PLUTO

BUCCAL TUBE

Buccal Tube information

PLUTO

Ball hook enhances patient comfort and avoids gingival impingement

Rounded edges for patient comfort

An 80 gauge mesh forming a superior surface area of interlocking retention



Compound contour base anatomically conforms to the tooth and provides proper fit and torque expression



- Funnelled access for easy wire insertion
- Wires are guided easily and gently into expansive entrance, simplifying arch wire adjustments and saving valuable chair time



- Low profile to avoid occlusal interference
- Metal injection molding(MIM) with stainless steel for smooth contours
- Can be direct bonded or pre-welded

BUCCAL TUBE

Buccal Tube Prescription Reference Chart



MAXILLARY								
	System	Slot Torque	Distal Offset	Slot Size	Bondable		Weldable	
					Right	Left	Right	Left
1st molar single non-convertible 	Edgewise	0°	0°	0.18	71-611-11	71-611-21	73-611-11	73-611-21
		0°	0°	0.22	71-612-11	71-612-21	73-612-11	73-612-21
	Roth*	-14°	10°	0.18	71-621-11	71-621-21	73-621-11	73-621-21
		-14°	10°	0.22	71-622-11	71-622-21	73-622-11	73-622-21
	McBeTr*	-14°	10°	0.18	71-631-11	71-631-21	73-631-11	73-631-21
		-14°	10°	0.22	71-632-11	71-632-21	73-632-11	73-632-21
1st molar single convertible 	Edgewise	0°	0°	0.18	72-611-11	72-611-21	74-611-11	74-611-21
		0°	0°	0.22	72-612-11	72-612-21	74-612-11	74-612-21
	Roth*	-14°	10°	0.18	72-621-11	72-621-21	74-621-11	74-621-21
		-14°	10°	0.22	72-622-11	72-622-21	74-622-11	74-622-21
	McBeTr*	-14°	10°	0.18	72-631-11	72-631-21	74-631-11	74-631-21
		-14°	10°	0.22	72-632-11	72-632-21	74-632-11	74-632-21
1st molar double non-convertible 	Edgewise	0°	6°	0.18	71-611-12	71-611-22	73-611-12	73-611-22
		0°	6°	0.22	71-612-12	71-612-22	73-612-12	73-612-22
	Roth*	-14°	10°	0.18	71-621-12	71-621-22	73-621-12	73-621-22
		-14°	10°	0.22	71-622-12	71-622-22	73-622-12	73-622-22
	McBeTr*	-14°	10°	0.18	71-631-12	71-631-22	73-631-12	73-631-22
		-14°	10°	0.22	71-632-12	71-632-22	73-632-12	73-632-22
1st molar double convertible 	Edgewise	0°	6°	0.18	72-611-12	72-611-22	74-611-12	74-611-22
		0°	6°	0.22	72-612-12	72-612-22	74-612-12	74-612-22
	Roth*	-14°	10°	0.18	72-621-12	72-621-22	74-621-12	74-621-22
		-14°	10°	0.22	72-622-12	72-622-22	74-622-12	74-622-22
	McBeTr*	-14°	10°	0.18	72-631-12	72-631-22	74-631-12	74-631-22
		-14°	10°	0.22	72-632-12	72-632-22	74-632-12	74-632-22

* Our version of the Roth Rx is not implied to be an exact version of any other system, nor do we claim any endorsement of Dr. Roth. Our version of the McLaughlin, Bennett, and Trevisi system is not implied to be an exact version of any other system, nor do we claim any endorsement of doctors McLaughlin, Bennett, and Trevisi.

BUCCAL TUBE

Buccal Tube Prescription Reference Chart

PLUTO

MAXILLARY								
	System	Slot Torque	Distal Offset	Slot Size	Bondable		Weldable	
					Right	Left	Right	Left
1st molar triple non-convertible 	Edgewise	0°	6°	0.18	-	-	-	-
		0°	6°	0.22	-	-	-	-
	Roth*	-14°	10°	0.18	71-621-13	71-621-23	73-621-13	73-621-23
		-14°	10°	0.22	71-622-13	71-622-23	73-622-13	73-622-23
	McBeTr*	-14°	10°	0.18	71-631-13	71-631-23	73-631-13	73-631-23
		-14°	10°	0.22	71-632-13	71-632-23	73-632-13	73-632-23
1st molar triple convertible 	Edgewise	0°	6°	0.18	-	-	-	-
		0°	6°	0.22	-	-	-	-
	Roth*	-14°	10°	0.18	72-621-13	72-621-23	74-621-13	74-621-23
		-14°	10°	0.22	72-622-13	72-622-23	74-622-13	74-622-23
	McBeTr*	-14°	10°	0.18	72-631-13	72-631-23	74-631-13	74-631-23
		-14°	10°	0.22	72-632-13	72-632-23	74-632-13	74-632-23
2nd molar single non-convertible 	Edgewise	0°	0°	0.18	71-711-11	71-711-21	73-711-21	73-711-21
		0°	0°	0.22	71-712-11	71-712-21	73-712-21	73-712-21
	Roth*	-14°	10°	0.18	71-721-11	71-721-21	73-721-21	73-721-21
		-14°	10°	0.22	71-722-11	71-722-21	73-722-21	73-722-21
	McBeTr*	-14°	10°	0.18	71-731-11	71-731-21	73-731-21	73-731-21
		-14°	10°	0.22	71-732-11	71-732-21	73-732-21	73-732-21

BUCCAL TUBE

Buccal Tube Prescription Reference Chart



MANDIBULAR								
	System	Slot Torque	Distal Offset	Slot Size	Bondable		Weldable	
					Right	Left	Right	Left
1st molar single non-convertible 	Edgewise	0°	0°	0.18	71-611-41	71-611-31	73-611-41	73-611-31
		0°	0°	0.22	71-612-41	71-612-31	73-612-41	73-612-31
	Roth*	-25°	4°	0.18	71-621-41	71-621-31	73-621-41	73-621-31
		-25°	4°	0.22	71-622-41	71-622-31	73-622-41	73-622-31
	McBeTr*	-20°	0°	0.18	71-631-41	71-631-31	73-631-41	73-631-31
		-20°	0°	0.22	71-632-41	71-632-31	73-632-41	73-632-31
1st molar single convertible 	Edgewise	0°	0°	0.18	72-611-41	72-611-31	74-611-41	74-611-31
		0°	0°	0.22	72-612-41	72-612-31	74-612-41	74-612-31
	Roth*	-25°	4°	0.18	72-621-41	72-621-31	74-621-41	74-621-31
		-25°	4°	0.22	72-622-41	72-622-31	74-622-41	74-622-31
	McBeTr*	-20°	0°	0.18	72-631-41	72-631-31	74-631-41	74-631-31
		-20°	0°	0.22	72-632-41	72-632-31	74-632-41	74-632-31
1st molar double non-convertible 	Edgewise	0°	0°	0.18	-	-	-	-
		0°	0°	0.22	-	-	-	-
	Roth*	-25°	4°	0.18	71-621-42	71-621-32	73-621-42	73-621-32
		-25°	4°	0.22	71-622-42	71-622-32	73-622-42	73-622-32
	McBeTr*	-20°	0°	0.18	71-631-42	71-631-32	73-631-42	73-631-32
		-20°	0°	0.22	71-632-42	71-632-32	73-632-42	73-632-32
1st molar double convertible 	Edgewise	0°	0°	0.18	72-611-42	72-611-32	74-611-42	74-611-32
		0°	0°	0.22	72-612-42	72-612-32	74-612-42	74-612-32
	Roth*	-25°	4°	0.18	72-621-42	72-621-32	74-621-42	74-621-32
		-25°	4°	0.22	72-622-42	72-622-32	74-622-42	74-622-32
	McBeTr*	-20°	0°	0.18	72-631-42	72-631-32	74-631-42	74-631-32
		-20°	0°	0.22	72-632-42	72-632-32	74-632-42	74-632-32
2nd molar single non-convertible 	Edgewise	0°	0°	0.18	71-711-41	71-711-31	73-711-41	73-711-31
		0°	0°	0.22	71-712-41	71-712-31	73-712-41	73-712-31
	Roth*	-25°	4°	0.18	71-721-41	71-721-31	73-721-41	73-721-31
		-25°	4°	0.22	71-722-41	71-722-31	73-722-41	73-722-31
	McBeTr*	-10°	0°	0.18	71-731-41	71-731-31	73-731-41	73-731-31
		-10°	0°	0.22	71-732-41	71-732-31	73-732-41	73-732-31

*Our version of the Roth Rx is not implied to be an exact version of any other system, nor do we claim any endorsement of Dr. Roth. Our version of the McLaughlin, Bennett, and Trevisi system is not implied to be an exact version of any other system, nor do we claim any endorsement of doctors McLaughlin, Bennett, and Trevisi.



BANDS

ATTACH



MENTS



BANDS & ATTACHMENTS

Bands & Attachment information

BANDS

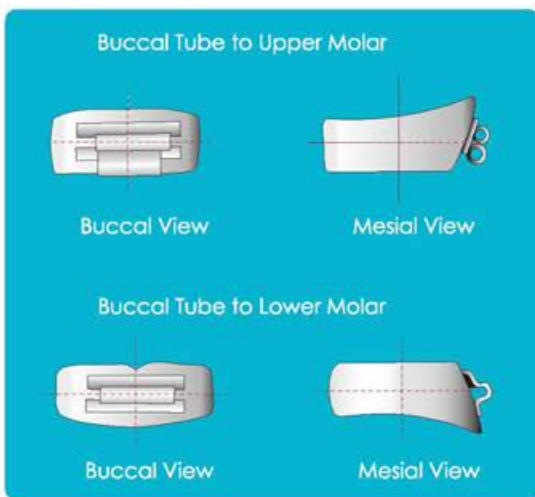
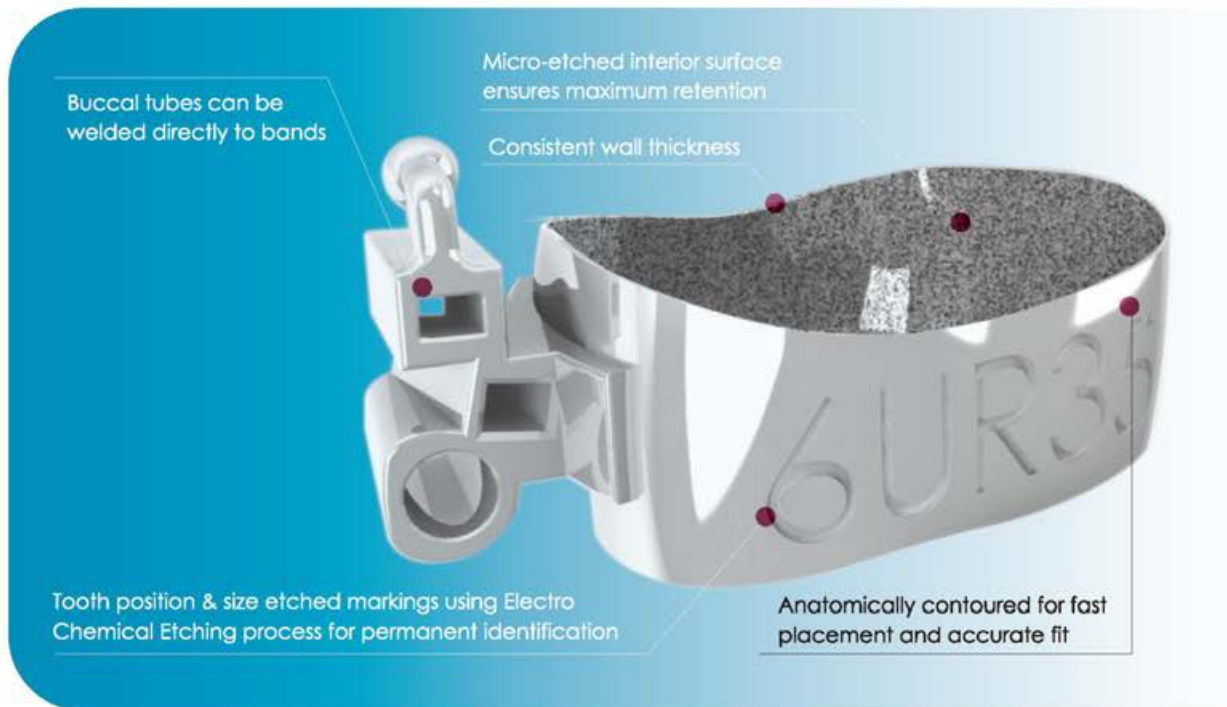

- Buccal tube will be centered mesial to distal, and occlusal to gingival with 0° angulation
- Slot will be parallel to occlusal edge of band



- Plastic band organizer with lid
- Plastic band organizers are designed for proper band storage and will fit most band cabinets, including kit purchase

BANDS&ATTACHMENTS

Competitive Upgrade Chart



BANDS

IMD Easy Fit	Ortho Technology	"A" Company	GAC Snapfit	Lancer Supra	Ormco Washbon	TP	Unitek Victory Std.	Ortho Org. Temptra
29	29		2				29	29
29.5	29.5						29.5	29.5
		1	3		1			
						00		
30	30	2		30	2		30	30
30.5	30.5	3	4	30.5		0	30.5	30.5
		4			3			
31	31	5		31	4	1	31	31
		6	5		5	2		
31.5	31.5			31.5			31.5	31.5
32	32	7		32	6	3	32	32
32.5	32.5	8	6	32.5		5	32.5	32.5
33	33	9		33	8	6	33	33
					9	7		
33.5	33.5	10	7	33.5	10	8	33.5	33.5
34	34			34		9	34	34
		11				10		
34.5	34.5	12	8	34.5	11	11	34.5	34.5
		13			12	12		
35	35	14	9	35	13	13	35	35
35.5	35.5	15	10	35.5	14	14	35.5	35.5
			11		15	15		
36	36	16	12	36		16	36	36
		17				17		
			13		17	18		
36.5	36.5	18	14	36.5		19	36.5	36.5
37	37			37	18	20	37	37
		19	15			21		
37.5	37.5		16	37.5	19	22	37.5	37.5
		20				23		
38	38	21	17	38	20	23	38	38
		22	18		21	24		
					22	25		
38.5	38.5	23		38.5		26	38.5	38.5
39	39	24		39	24	27	39	39
39.5	39.5	25		39.5	26	29	39.5	39.5
					27	30		
		26				31		
40	40			40	28		40	40
40.5	40.5	27		40.5		32	40.5	40.5
		29			29			
41	41			41	30	33	41	41
41.5	41.5	30		41.5	31	34	41.5	41.5
42	42			42			42	42
42.5	42.5			42.5	32	35	42.5	42.5
43	43			43		36	43	43
43.5	43.5			43.5			43.5	43.5
44	44			44			44	44

BANDS&ATTACHMENTS

Bands Prescription Reference Chart

BANDS



Perimeter MM	Maxillary 1st Molar Right	Maxillary 1st Molar Left	Maxillary 2nd Molar Right	Maxillary 2nd Molar Left	Mandibular 1st Molar Right	Mandibular 1st Molar Left	Mandibular 2nd Molar Right	Mandibular 2nd Molar Left
29	81-612-290	81-622-290	81-712-290	81-722-290	81-642-290	81-632-290	81-742-290	81-732-290
29.5	81-612-295	81-622-295	81-712-295	81-722-295	81-642-295	81-632-295	81-742-295	81-732-295
30	81-612-300	81-622-300	81-712-300	81-722-300	81-642-300	81-632-300	81-742-300	81-732-300
30.5	81-612-305	81-622-305	81-712-305	81-722-305	81-642-305	81-632-305	81-742-305	81-732-305
31	81-612-310	81-622-310	81-712-310	81-722-310	81-642-310	81-632-310	81-742-310	81-732-310
31.5	81-612-315	81-622-315	81-712-315	81-722-315	81-642-315	81-632-315	81-742-315	81-732-315
32	81-612-320	81-622-320	81-712-320	81-722-320	81-642-320	81-632-320	81-742-320	81-732-320
32.5	81-612-325	81-622-325	81-712-325	81-722-325	81-642-325	81-632-325	81-742-325	81-732-325
33	81-612-330	81-622-330	81-712-330	81-722-330	81-642-330	81-632-330	81-742-330	81-732-330
33.5	81-612-335	81-622-335	81-712-335	81-722-335	81-642-335	81-632-335	81-742-335	81-732-335
34	81-612-340	81-622-340	81-712-340	81-722-340	81-642-340	81-632-340	81-742-340	81-732-340
34.5	81-612-345	81-622-345	81-712-345	81-722-345	81-642-345	81-632-345	81-742-345	81-732-345
35	81-612-350	81-622-350	81-712-350	81-722-350	81-642-350	81-632-350	81-742-350	81-732-350
35.5	81-612-355	81-622-355	81-712-355	81-722-355	81-642-355	81-632-355	81-742-355	81-732-355
36	81-612-360	81-622-360	81-712-360	81-722-360	81-642-360	81-632-360	81-742-360	81-732-360
36.5	81-612-365	81-622-365	81-712-365	81-722-365	81-642-365	81-632-365	81-742-365	81-732-365
37	81-612-370	81-622-370	81-712-370	81-722-370	81-642-370	81-632-370	81-742-370	81-732-370
37.5	81-612-375	81-622-375	81-712-375	81-722-375	81-642-375	81-632-375	81-742-375	81-732-375
38	81-612-380	81-622-380	81-712-380	81-722-380	81-642-380	81-632-380	81-742-380	81-732-380
38.5	81-612-385	81-622-385	81-712-385	81-722-385	81-642-385	81-632-385	81-742-385	81-732-385
39	81-612-390	81-622-390	81-712-390	81-722-390	81-642-390	81-632-390	81-742-390	81-732-390
39.5	81-612-395	81-622-395	81-712-395	81-722-395	81-642-395	81-632-395	81-742-395	81-732-395
40	81-612-400	81-622-400	81-712-400	81-722-400	81-642-400	81-632-400	81-742-400	81-732-400
40.5	81-612-405	81-622-405	81-712-405	81-722-405	81-642-405	81-632-405	81-742-405	81-732-405
41	81-612-410	81-622-410	81-712-410	81-722-410	81-642-410	81-632-410	81-742-410	81-732-410
41.5	81-612-415	81-622-415	81-712-415	81-722-415	81-642-415	81-632-415	81-742-415	81-732-415
42	81-612-420	81-622-420	81-712-420	81-722-420	81-642-420	81-632-420	81-742-420	81-732-420
42.5	81-612-425	81-622-425	81-712-425	81-722-425	81-642-425	81-632-425	81-742-425	81-732-425
43	81-612-430	81-622-430	81-712-430	81-722-430	81-642-430	81-632-430	81-742-430	81-732-430
43.5	81-612-435	81-622-435	81-712-435	81-722-435	81-642-435	81-632-435	81-742-435	81-732-435
44	81-612-440	81-622-440	81-712-440	81-722-440	81-642-440	81-632-440	81-742-440	81-732-440
44.5	81-612-445	81-622-445	81-712-445	81-722-445	81-642-445	81-632-445	81-742-445	81-732-445



Choose from three kit assortments

- o Trial Kit containing 50 bands
- o Intro Kit containing 100 bands
- o Pro Kit containing 200 bands

1st Molar Bands

Kit Type/No	31	31.5	32	32.5	33	33.5	34	34.5	35	35.5	36	36.5	37	37.5	38	38.5	39	39.5	40	40.5	41	41.5	42	42.5	43	43.5	44
01/Trial	0	0	0	0	0	0	0	0	2	2	2	2	2	2	2	2	2	4	4	4	4	4	4	2	2	2	2
02/Intro	1	1	1	1	1	1	1	1	2	2	2	3	5	5	5	5	5	7	7	7	7	7	7	4	4	4	4
03/Pro	5	6	6	6	6	6	6	6	6	6	6	6	7	7	7	7	7	11	11	11	11	11	11	7	7	7	7

Reference Number

- KIT 81-612-XX
- KIT 81-622-XX
- KIT 81-632-XX
- KIT 81-642-XX
- XX: 01/02/03



2nd Molar Bands

Kit Type/No	31	31.5	32	32.5	33	33.5	34	34.5	35	35.5	36	36.5	37	37.5	38	38.5	39	39.5	40	40.5	41	41.5	42
01/Trial	1	1	1	1	2	2	2	2	4	4	4	4	4	4	2	2	2	2	2	1	1	1	1
02/Intro	1	1	2	3	3	3	3	3	10	10	10	10	10	10	3	3	3	3	3	3	1	1	1

Reference Number

- KIT 81-712-XX
- KIT 81-722-XX
- KIT 81-732-XX
- KIT 81-742-XX
- XX: 01/02



FREE! PREWELDING SERVICE

Ordering bands with attachments can be a time consuming process, not to mention the time and expertise required to weld the attachment. IMD offers complimentary welding with all of our bands and attachments.

When we receive an order, the weld specifications are kept on file so recorders utilizing the same bands and weld attachments can be simplified by asking us to duplicate your last order.



BANDS&ATTACHMENTS

WELDABLE & BONDABLE ATTACHMENTS

BANDS

Bondable/weldable lingual buttons 10 PACK

No.	Description	Reference NO.
(A)	Weldable round base	93-001-01
(B)	Weldable rectangular base	93-001-02
(C)	Bondable round base	93-002-01
(D)	Bondable rectangular base	93-002-02

Our bondable and weldable lingual buttons are perfect for all your patients. Formed for patient comfort, our lingual buttons easily bond to any tooth. Weldable lingual buttons can be welded to bands.



Weldable/Bondable Lingual Cleats 10 PACK

No.	Description	Reference NO.
(A)	Weldable slim sheet	93-003-01
(B)	Weldable round base	93-003-02
(C)	Bondable slim sheet	93-004-01
(D)	Bondable round base	93-004-02



Lingual Sheath 10 PACK

No.	Description	Reference NO.
(A)	Lingual sheath with hook	93-021-01 L 93-021-01 R
(B)	Lingual sheath without hook	93-021-02



Applied together with palatal bars and expansion springs, capable of inserting 2 pieces of 0.9mm wires

BANDS&ATTACHMENTS

WELDABLE & BONDABLE ATTACHMENTS

BANDS

10 PACK		
Twin Slot Lingual Sheath		
No.	Description	Reference NO.
(A)	Twin Slot Lingual Sheath	93-022-01

Applied together with vertical palatal bars, capable of inserting 1 piece of 0.9mm wire



(A)

10 PACK		
Vertical Palatal Bars		
No.	Description	Reference NO.
(B)	Vertical Palatal Bars	93-022-02

Applied together with twin slot lingual sheath, made of 0.9mm SS wires



(B)

10 PACK		
Movable Crimple Hooks		
No.	Description	Reference NO.
(C)	Sliding along the arch wires, easy to use	92-002-02



(C)

10 PACK		
Long Crimple Hooks		
No.	Description	Reference NO.
(D)	Fixed on the wires inserted instructure, easy to use	92-001-03



(D)

10 PACK		
Crimple Hooks		
No.	Description	Reference NO.
(E)	Fixed on the wires inserted instructure, easy to use	92-001-02



(E)

10 PACK		
Long Curved Crimple Hooks		
No.	Description	Reference NO.
(F)	Fixed on the archwire	
	Left	92-001-04 L
	Right	92-001-14 R



(F)



ARCHWIRES &



Beta

Cu-Alloy

MEM Alloy

BIO MEM Alloy

WIRING SPRINGS

Arch Form

© Copy Right Protected

Maxillary

Mandibular

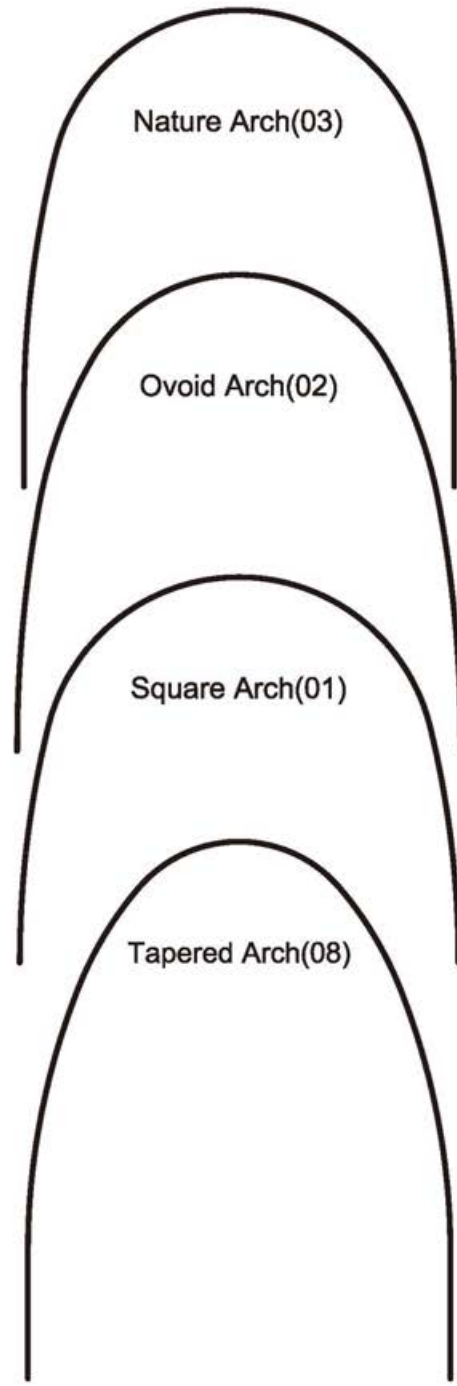
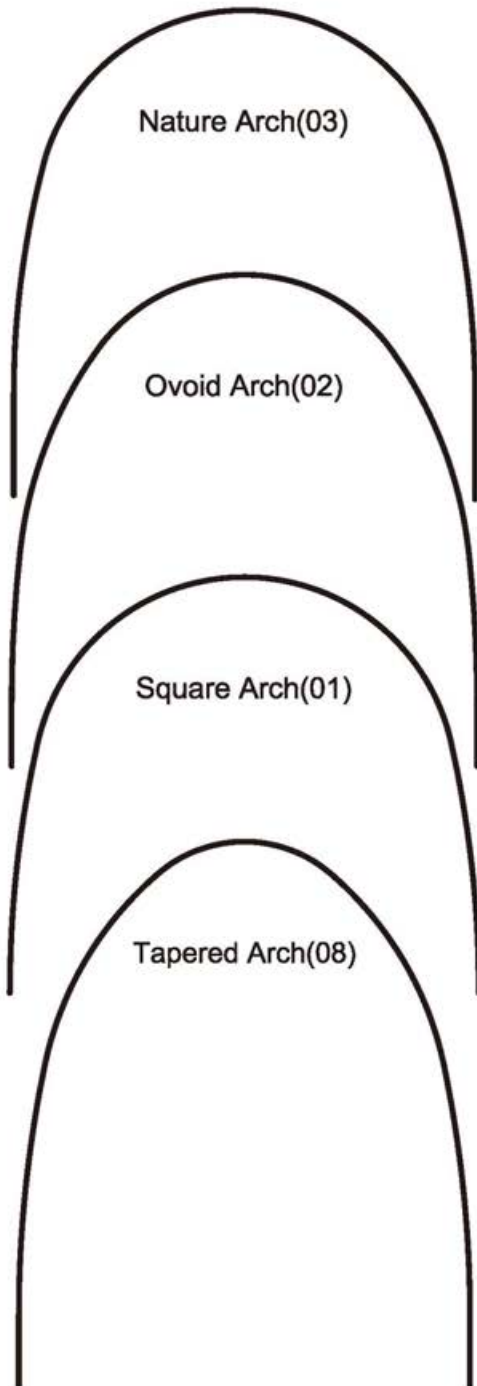

Roth Arch(10)

© Copy Right Protected

Maxillary

Mandibular

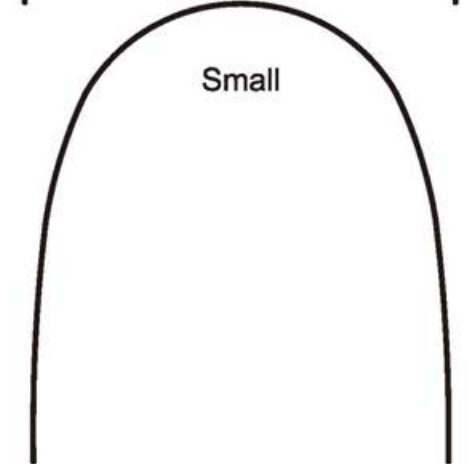
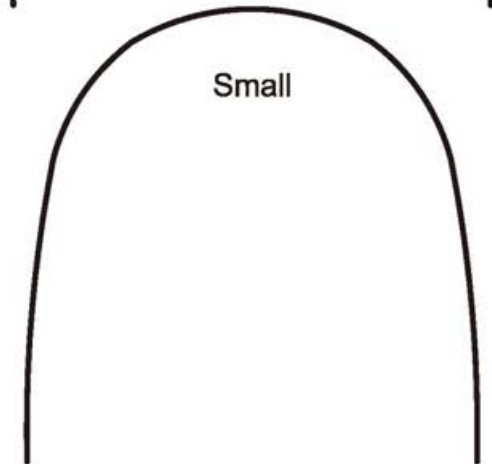
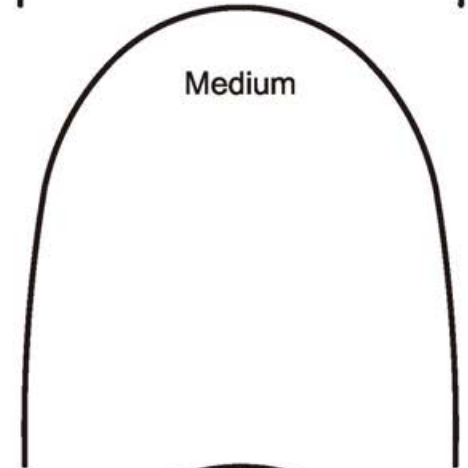
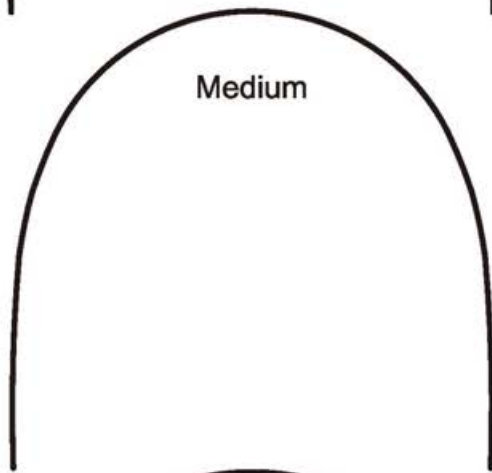
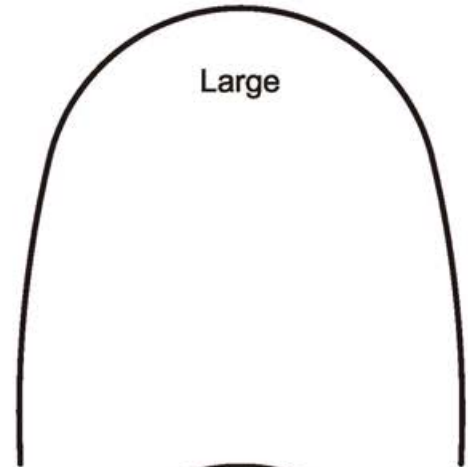
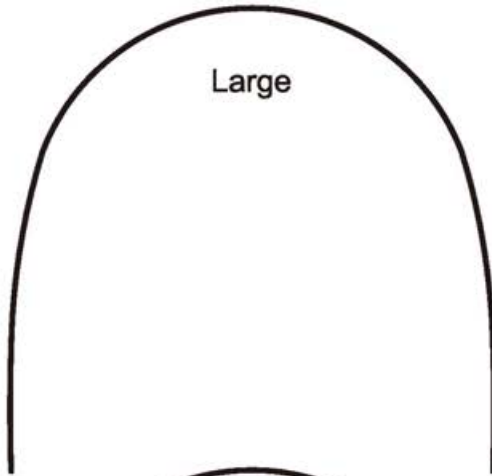

ARCHWIRES & SPRINGS

Archwire Forms

ZZ Arch(06)

© Copy Right Protected

Maxillary

Mandibular

Large

Large

Medium

Medium

Small

Small

Lingual Arch(07)

© Copy Right Protected

Maxillary

Mandibular

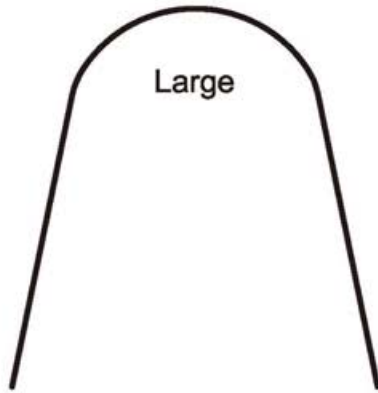

Large

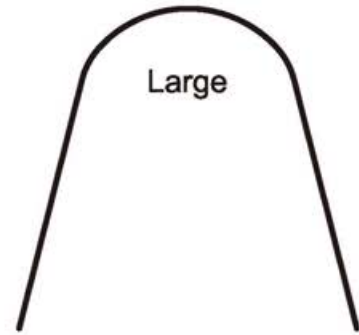

Large

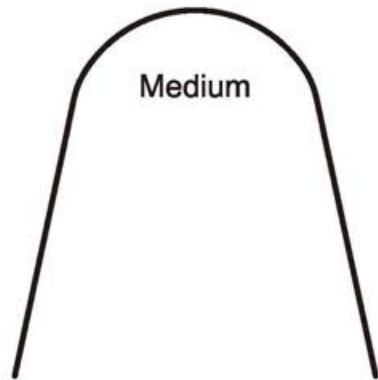

Medium

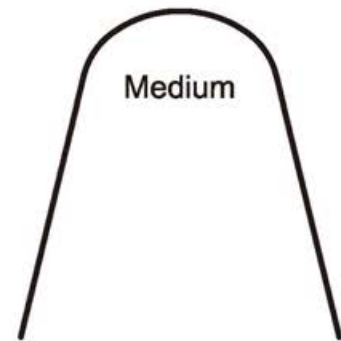

Medium

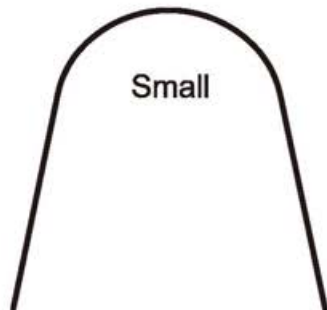

Small

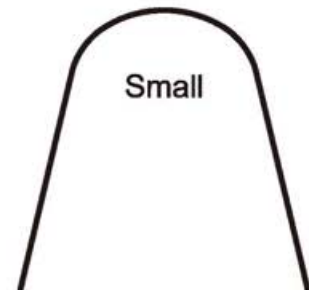

Small

ARCHWIRES & SPRINGS

MEMAlloy Niti Arch Wires



MEMAlloy Niti arch wires are a low-force alternative to the traditional thermal active arch wires. They hold all the same properties of thermal active arch wires but deliver a gentle, light continuous forces for optimum tooth movement, moving teeth without dissipation of force and periodontal stress. It is round and owns superelasticity than traditional thermal active arch wires.



Ovoid



Natural



Damon*

Size	Maxillary	Mandibular	Maxillary	Mandibular	Maxillary	Mandibular
0.012"	ME021201	ME021202	ME031201	ME031202	ME091201	ME091202
0.014"	ME021401	ME021402	ME031401	ME031402	ME091401	ME091402
0.016"	ME021601	ME021602	ME031601	ME031602	ME091601	ME091602
0.018"	ME021801	ME021802	ME031801	ME031802	ME091801	ME091802
0.020"	ME022001	ME022002	ME032001	ME032002	ME092001	ME092002

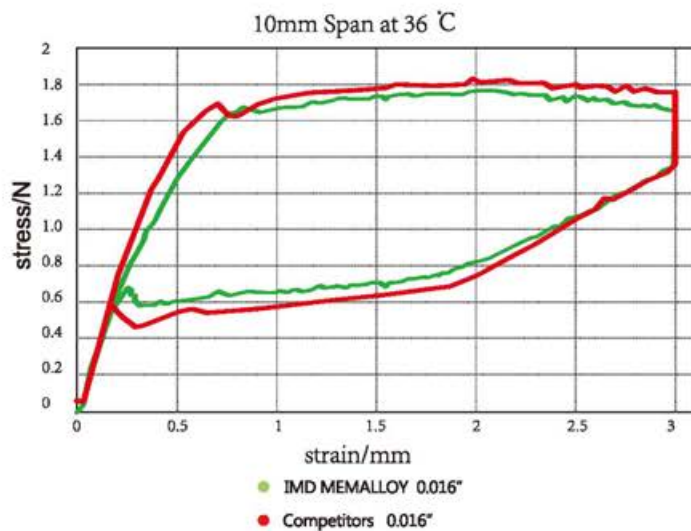

10 PACK

ARCHWIRES & SPRINGS

BIO MEMAlloy Niti Arch Wires

BIO MEMAlloy

MEMAlloy Niti arch wires are a low-force alternative to the traditional thermal active arch wires. They hold all the same properties of thermal active arch wires but deliver a gentle, light continuous forces for optimum tooth movement, moving teeth without dissipation of force and periodontal stress. It is rectangular and owns superelasticity than traditional thermal active arch wires.



Ovoid



Natural



Damon*

Size	Maxillary		Mandibular		Maxillary		Mandibular	
0.017"x0.025"	BM02172501	BM02172502	BM03172501	BM03172502	BM09172501	BM09172502	BM09172501	BM09172502
0.018"x0.018"	BM02181801	BM02181802	BM03181801	BM03181802	BM09181801	BM09181802	BM09181801	BM09181802
0.018"x0.025"	BM02182501	BM02182502	BM03182501	BM03182502	BM09182501	BM09182502	BM09182501	BM09182502
0.019"x0.025"	BM02192501	BM02192502	BM03192501	BM03192502	BM09192501	BM09192502	BM09192501	BM09192502
0.020"x0.020"	BM02202001	BM02202002	BM03202001	BM03202002	BM09202001	BM09202002	BM09202001	BM09202002
0.021"x0.028"	BM02212801	BM02212802	BM03212801	BM03212802	BM09212801	BM09212802	BM09212801	BM09212802

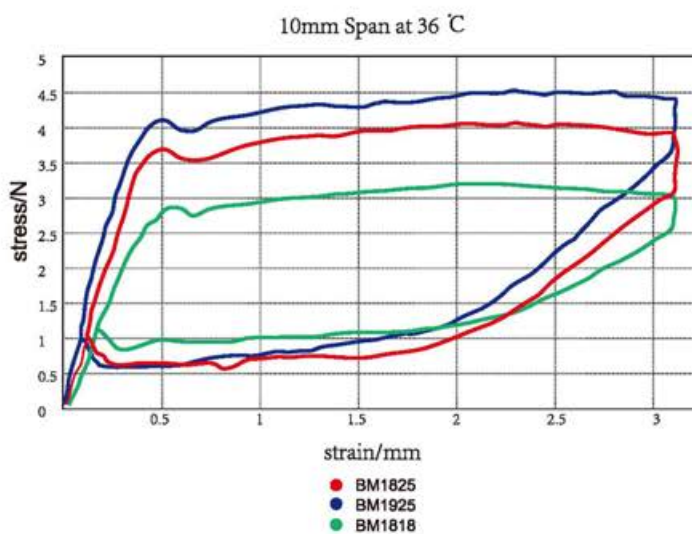

10 PACK

ARCHWIRES & SPRINGS

Cu-Alloy Niti Arch Wires

Cu-Alloy

Cu-Alloy Niti arch wires consist of nickel, titanium, copper and chromium. The addition of copper to the alloy enhances the thermal-reactive properties of the wire. The wires with the unique thermal-reactive property and mechanics that IMD offers provide a wide range of choice for different cases. And it is especially calibrated for use with the SLB system and its smooth surface to reduce the sliding friction. The wires' activated temperature is close to mouth temperature and is soft in room temperature to facilitate engagement. It falls within a very efficient force range when used with the large round or rectangle sizes.



Ovoid



Natural



Damon*

Size	Maxillary	Mandibular	Maxillary	Mandibular	Maxillary	Mandibular
0.013"	CU021301	CU021302	CU031301	CU031302	CU091301	CU091302
0.014"	CU021401	CU021402	CU031401	CU031402	CU091401	CU091402
0.016"	CU021601	CU021602	CU031601	CU031602	CU091601	CU091602
0.018"	CU021801	CU021802	CU031801	CU031802	CU091801	CU091802
0.014"x0.025"	CU02142501	CU02142502	CU03142501	CU03142502	CU09142501	CU09142502
0.016"x0.025"	CU02162501	CU02162502	CU03162501	CU03162502	CU09162501	CU09162502
0.018"x0.025"	CU02182501	CU02182502	CU03182501	CU03182502	CU09182501	CU09182502

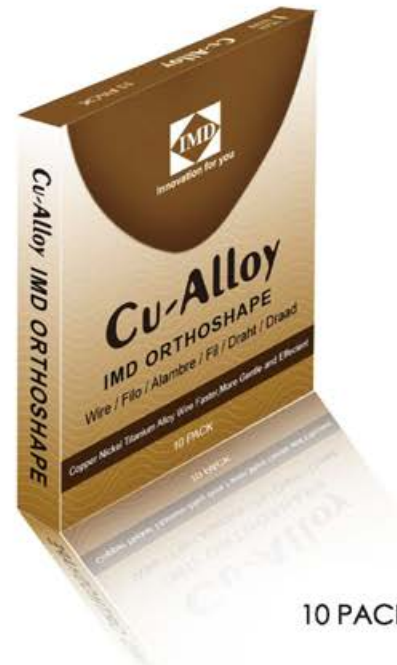
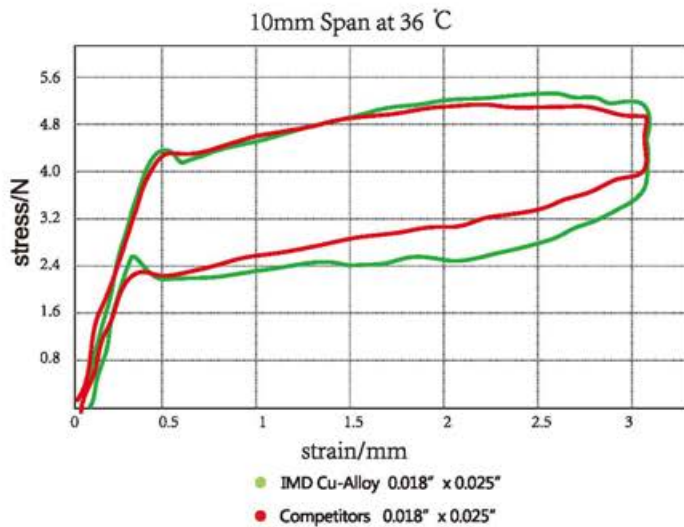

10 PACK

ARCHWIRES & SPRINGS

Beta Titanium Orthodontic Arch Wires

Beta

Beta Titanium Arch wires provide memory properties similar to nickel titanium while providing high-forces and low deflections similar to stainless steel. Our Beta titanium arch wires provide force levels that are 42% less than those of equivalent stainless steel arch wires. It is a great nickel-free alternative with a variety of application possibilities. It can be used at any stage of treatment, but it is especially effective where moderate forces are necessary for early torque control and final detailing.



Ovoid



Natural

Size	Maxillary	Mandibular	Maxillary	Mandibular
0.016"	A-W-ST021601	A-W-ST021602	A-W-ST031601	A-W-ST031602
0.018"	A-W-ST021801	A-W-ST021802	A-W-ST031801	A-W-ST031802
0.020"	A-W-ST022001	A-W-ST022002	A-W-ST032001	A-W-ST032002
0.016"x0.016"	A-W-ST02161601	A-W-ST02161602	A-W-ST03161601	A-W-ST03161602
0.016"x0.022"	A-W-ST02162201	A-W-ST02162202	A-W-ST03162201	A-W-ST03162202
0.017"x0.022"	A-W-ST02172201	A-W-ST02172202	A-W-ST03172201	A-W-ST03172202
0.017"x0.025"	A-W-ST02172501	A-W-ST02172502	A-W-ST03172501	A-W-ST03172502
0.018"x0.018"	A-W-ST02181801	A-W-ST02181802	A-W-ST03181801	A-W-ST03181802
0.018"x0.025"	A-W-ST02182501	A-W-ST02182502	A-W-ST03182501	A-W-ST03182502
0.019"x0.025"	A-W-ST02192501	A-W-ST02192502	A-W-ST03192501	A-W-ST03192502
0.021"x0.025"	A-W-ST02212501	A-W-ST02212502	A-W-ST03212501	A-W-ST03212502

Features

- 1.Safe for nickel-allergy patients.
- 2.Moderate springback and flexibility
- 3.Moderate stiffness
- 4.Excellent formability
- 5.Better bend performance than stainless steel
- 6.Gentle force delivery with larger archwire sizes
- 7.Fill bracket slots earlier and correct torque



10 PACK

ARCHWIRES & SPRINGS

Stainless Steel Archwires

Stainless steel arch wires are excellent for detailing and finishing. It uses only 304 medical grade stainless steel wire in forming these wires. By acquiring our wire from the finest stainless steel processing houses, we can assure its customers a product high in quality and consistent in performance. In addition, we use state of the special forming equipment which ensures product integrity, consistent performance characteristics and precise arch forms. With years of wire forming experience, IMD understands the intricacies and nature of arch wire production and takes great pride in craftsmanship.

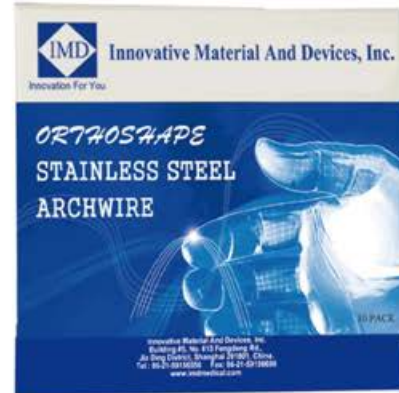

Square



Ovoid



Natural

Wire Size	Upper	Lower	Upper	Lower	Upper	Lower
0.012"	SS011201	SS011202	SS021201	SS021202	SS031201	SS031202
0.014"	SS011401	SS011402	SS021401	SS021402	SS031401	SS031402
0.016"	SS011601	SS011602	SS021601	SS021602	SS031601	SS031602
0.018"	SS011801	SS011802	SS021801	SS021802	SS031801	SS031802
0.020"	SS012001	SS012002	SS022001	SS022002	SS032001	SS032002
0.016"x0.016"	SS01161601	SS01161602	SS02161601	SS02161602	SS03161601	SS03161602
0.016"x0.022"	SS01162201	SS01162202	SS02162201	SS02162202	SS03162201	SS03162202
0.017"x0.022"	SS01172201	SS01172202	SS02172201	SS02172202	SS03172201	SS03172202
0.017"x0.025"	SS01172501	SS01172502	SS02172501	SS02172502	SS03172501	SS03172502
0.018"x0.022"	SS01182201	SS01182202	SS02182201	SS02182202	SS03182201	SS03182202
0.018"x0.025"	SS01182501	SS01182502	SS02182501	SS02182502	SS03182501	SS03182502
0.019"x0.025"	SS01192501	SS01192502	SS02192501	SS02192502	SS03192501	SS03192502
0.021"x0.025"	SS01212501	SS01212502	SS02212501	SS02212502	SS03212501	SS03212502

10 PACK

ARCHWIRES & SPRINGS

Stainless Steel Archwires



Zz Small



Zz Medium



Lingual Medium

Wire Size	Zz Small		Zz Medium		Lingual Medium	
	Upper	Lower	Upper	Lower	Upper	Lower
0.012"	SS06S1201	SS06S1202	SS06M1201	SS06M1202	SS07M1201	SS07M1202
0.014"	SS06S1401	SS06S1402	SS06M1401	SS06M1402	SS07M1401	SS07M1402
0.016"	SS06S1601	SS06S1602	SS06M1601	SS06M1602	SS07M1601	SS07M1602
0.018"	SS06S1801	SS06S1802	SS06M1801	SS06M1802	SS07M1801	SS07M1802
0.020"	SS06S2001	SS06S2002	SS06M2001	SS06M2002	SS07M2001	SS07M2002
0.016"x0.016"	SS06S161601	SS06S161602	SS06M161601	SS06M161602	SS07M161601	SS07M161602
0.016"x0.022"	SS06S162201	SS06S162202	SS06M162201	SS06M162202	SS07M162201	SS07M162202
0.017"x0.022"	SS06S172201	SS06S172202	SS06M172201	SS06M172202	SS07M172201	SS07M172202
0.017"x0.025"	SS06S172501	SS06S172502	SS06M172501	SS06M172502	SS07M172501	SS07M172502
0.018"x0.022"	SS06S182201	SS06S182202	SS06M182201	SS06M182202	SS07M182201	SS07M182202
0.018"x0.025"	SS06S182501	SS06S182502	SS06M182501	SS06M182502	SS07M182501	SS07M182502
0.019"x0.025"	SS06S192501	SS06S192502	SS06M192501	SS06M192502	SS07M192501	SS07M192502
0.021"x0.025"	SS06S212501	SS06S212502	SS06M212501	SS06M212502	SS07M212501	SS07M212502



Tapered



Damon*

Wire Size	Tapered		Damon*	
	Upper	Lower	Upper	Lower
0.012"	SS081201	SS081202	SS091201	SS091202
0.014"	SS081401	SS081402	SS091401	SS091402
0.016"	SS081601	SS081602	SS091601	SS091602
0.018"	SS081801	SS081802	SS091801	SS091802
0.020"	SS082001	SS082002	SS092001	SS092002
0.016"x0.016"	SS08161601	SS08161602	SS09161601	SS09161602
0.016"x0.022"	SS08162201	SS08162202	SS09162201	SS09162202
0.017"x0.022"	SS08172201	SS08172202	SS09172201	SS09172202
0.017"x0.025"	SS08172501	SS08172502	SS09172501	SS09172502
0.018"x0.022"	SS08182201	SS08182202	SS09182201	SS09182202
0.018"x0.025"	SS08182501	SS08182502	SS09182501	SS09182502
0.019"x0.025"	SS08192501	SS08192502	SS09192501	SS09192502
0.021"x0.025"	SS08212501	SS08212502	SS09212501	SS09212502

* Our version of the Roth arch--shape is not implied to be an exact version of any other system, nor do we claim any endorsement of Dr. Roth. Our version of the Damon archform is not implied to be an exact version of any other system, nor do we claim any endorsement of Dr Damon.

ARCHWIRES & SPRINGS

Niti Super Elastic Arch Wires

Niti super elastic arch wires reduce the number of arch wire changes by remaining continuously active. It is completely austenitic at room temperature and delivers constant force for more efficient tooth movement through its advanced metallurgical composition. It's extremely smooth and reduces friction, allowing teeth to move easily along the arch wire. This wire allows alteration for custom bends or loops.

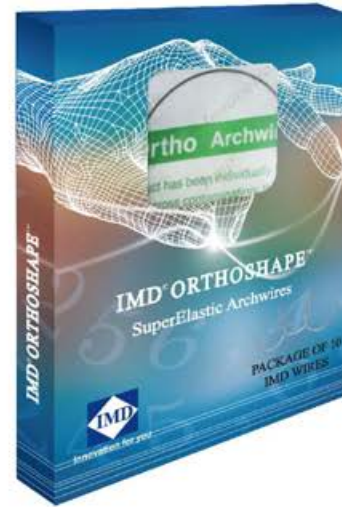

Square



Ovoid



Natural

Wire Size	Upper	Lower	Upper	Lower	Upper	Lower
0.012"	SE011201	SE011202	SE021201	SE021202	SE031201	SE031202
0.014"	SE011401	SE011402	SE021401	SE021402	SE031401	SE031402
0.016"	SE011601	SE011602	SE021601	SE021602	SE031601	SE031602
0.018"	SE011801	SE011802	SE021801	SE021802	SE031801	SE031802
0.020"	SE012001	SE012002	SE022001	SE022002	SE032001	SE032002
0.016"x0.016"	SE01161601	SE01161602	SE02161601	SE02161602	SE03161601	SE03161602
0.016"x0.022"	SE01162201	SE01162202	SE02162201	SE02162202	SE03162201	SE03162202
0.017"x0.022"	SE01172201	SE01172202	SE02172201	SE02172202	SE03172201	SE03172202
0.017"x0.025"	SE01172501	SE01172502	SE02172501	SE02172502	SE03172501	SE03172502
0.018"x0.022"	SE01182201	SE01182202	SE02182201	SE02182202	SE03182201	SE03182202
0.018"x0.025"	SE01182501	SE01182502	SE02182501	SE02182502	SE03182501	SE03182502
0.019"x0.025"	SE01192501	SE01192502	SE02192501	SE02192502	SE03192501	SE03192502
0.021"x0.025"	SE01212501	SE01212502	SE02212501	SE02212502	SE03212501	SE03212502

10 PACK

ARCHWIRES & SPRINGS

Niti Super Elastic Arch Wires



Zz Small



Zz Medium



Lingual Medium

Wire Size	Zz Small		Zz Medium		Lingual Medium	
	Upper	Lower	Upper	Lower	Upper	Lower
0.012"	SE06S1201	SE06S1202	SE06M1201	SE06M1202	SE07M1201	SE07M1202
0.014"	SE06S1401	SE06S1402	SE06M1401	SE06M1402	SE07M1401	SE07M1402
0.016"	SE06S1601	SE06S1602	SE06M1601	SE06M1602	SE07M1601	SE07M1602
0.018"	SE06S1801	SE06S1802	SE06M1801	SE06M1802	SE07M1801	SE07M1802
0.020"	SE06S2001	SE06S2002	SE06M2001	SE06M2002	SE07M2001	SE07M2002
0.016"x0.016"	SE06S161601	SE06S161602	SE06M161601	SE06M161602	SE07M161601	SE07M161602
0.016"x0.022"	SE06S162201	SE06S162202	SE06M162201	SE06M162202	SE07M162201	SE07M162202
0.017"x0.022"	SE06S172201	SE06S172202	SE06M172201	SE06M172202	SE07M172201	SE07M172202
0.017"x0.025"	SE06S172501	SE06S172502	SE06M172501	SE06M172502	SE07M172501	SE07M172502
0.018"x0.022"	SE06S182201	SE06S182202	SE06M182201	SE06M182202	SE07M182201	SE07M182202
0.018"x0.025"	SE06S182501	SE06S182502	SE06M182501	SE06M182502	SE07M182501	SE07M182502
0.019"x0.025"	SE06S192501	SE06S192502	SE06M192501	SE06M192502	SE07M192501	SE07M192502
0.021"x0.025"	SE06S212501	SE06S212502	SE06M212501	SE06M212502	SE07M212501	SE07M212502



Tapered



Damon*

RCS

Wire Size	Tapered		Damon*		RCS	
	Upper	Lower	Upper	Lower	Upper	Lower
0.012"	SE081201	SE081202	SE091201	SE091202	SE041201	SE041202
0.014"	SE081401	SE081402	SE091401	SE091402	SE041401	SE041402
0.016"	SE081601	SE081602	SE091601	SE091602	SE041601	SE041602
0.018"	SE081801	SE081802	SE091801	SE091802	SE041801	SE041802
0.020"	SE082001	SE082002	SE092001	SE092002	SE042001	SE042002
0.016"x0.016"	SE08161601	SE08161602	SE09161601	SE09161602	SE04161601	SE04161602
0.016"x0.022"	SE08162201	SE08162202	SE09162201	SE09162202	SE04162201	SE04162202
0.017"x0.022"	SE08172201	SE08172202	SE09172201	SE09172202	SE04172201	SE04172202
0.017"x0.025"	SE08172501	SE08172502	SE09172501	SE09172502	SE04172501	SE04172502
0.018"x0.022"	SE08182201	SE08182202	SE09182201	SE09182202	SE04182201	SE04182202
0.018"x0.025"	SE08182501	SE08182502	SE09182501	SE09182502	SE04182501	SE04182502
0.019"x0.025"	SE08192501	SE08192502	SE09192501	SE09192502	SE04192501	SE04192502
0.021"x0.025"	SE08212501	SE08212502	SE09212501	SE09212502	SE04212501	SE04212502

* Our version of the Roth arch-shape is not implied to be an exact version of any other system, nor do we claim any endorsement of Dr. Roth. Our version of the Damon archform is not implied to be an exact version of any other system, nor do we claim any endorsement of Dr. Damon.

ARCHWIRES & SPRINGS

Niti Thermal Active Arch Wires

Niti thermal active arch wires react to heat in a unique way: cold temperature make the arch wire extremely malleable and able to create unique bends in the arch wire without kinking. Once the wire begins to heat up, it restores its original form, putting the wire to work as soon as it's engaged.



Square



Ovoid



Natural

Wire Size	Square		Ovoid		Natural	
	Upper	Lower	Upper	Lower	Upper	Lower
0.012"	SM011201	SM011202	SM021201	SM021202	SM031201	SM031202
0.014"	SM011401	SM011402	SM021401	SM021402	SM031401	SM031402
0.016"	SM011601	SM011602	SM021601	SM021602	SM031601	SM031602
0.018"	SM011801	SM011802	SM021801	SM021802	SM031801	SM031802
0.020"	SM012001	SM012002	SM022001	SM022002	SM032001	SM032002
0.016"x0.016"	SM01161601	SM01161602	SM02161601	SM02161602	SM03161601	SM03161602
0.016"x0.022"	SM01162201	SM01162202	SM02162201	SM02162202	SM03162201	SM03162202
0.017"x0.022"	SM01172201	SM01172202	SM02172201	SM02172202	SM03172201	SM03172202
0.017"x0.025"	SM01172501	SM01172502	SM02172501	SM02172502	SM03172501	SM03172502
0.018"x0.022"	SM01182201	SM01182202	SM02182201	SM02182202	SM03182201	SM03182202
0.018"x0.025"	SM01182501	SM01182502	SM02182501	SM02182502	SM03182501	SM03182502
0.019"x0.025"	SM01192501	SM01192502	SM02192501	SM02192502	SM03192501	SM03192502
0.021"x0.025"	SM01212501	SM01212502	SM02212501	SM02212502	SM03212501	SM03212502

10 PACK

ARCHWIRES & SPRINGS

Niti Thermal Active Arch Wires



Zz Medium



Lingual Medium

Wire Size	Upper	Lower	Upper	Lower
0.012"	SM06M1201	SM06M1202	SM07M1201	SM07M1202
0.014"	SM06M1401	SM06M1402	SM07M1401	SM07M1402
0.016"	SM06M1601	SM06M1602	SM07M1601	SM07M1602
0.018"	SM06M1801	SM06M1802	SM07M1801	SM07M1802
0.020"	SM06M2001	SM06M2002	SM07M2001	SM07M2002
0.016"x0.016"	SM06M161601	SM06M161602	SM07M161601	SM07M161602
0.016"x0.022"	SM06M162201	SM06M162202	SM07M162201	SM07M162202
0.017"x0.022"	SM06M172201	SM06M172202	SM07M172201	SM07M172202
0.017"x0.025"	SM06M172501	SM06M172502	SM07M172501	SM07M172502
0.018"x0.022"	SM06M182201	SM06M182202	SM07M182201	SM07M182202
0.018"x0.025"	SM06M182501	SM06M182502	SM07M182501	SM07M182502
0.019"x0.025"	SM06M192501	SM06M192502	SM07M192501	SM07M192502
0.021"x0.025"	SM06M212501	SM06M212502	SM07M212501	SM07M212502



Tapered



Damon*

Wire Size	Upper	Lower	Upper	Lower
0.012"	SM081201	SM081202	SM091201	SM091202
0.014"	SM081401	SM081402	SM091401	SM091402
0.016"	SM081601	SM081602	SM091601	SM091602
0.018"	SM081801	SM081802	SM091801	SM091802
0.020"	SM082001	SM082002	SM092001	SM092002
0.016"x0.016"	SM08161601	SM08161602	SM09161601	SM09161602
0.016"x0.022"	SM08162201	SM08162202	SM09162201	SM09162202
0.017"x0.022"	SM08172201	SM08172202	SM09172201	SM09172202
0.017"x0.025"	SM08172501	SM08172502	SM09172501	SM09172502
0.018"x0.022"	SM08182201	SM08182202	SM09182201	SM09182202
0.018"x0.025"	SM08182501	SM08182502	SM09182501	SM09182502
0.019"x0.025"	SM08192501	SM08192502	SM09192501	SM09192502
0.021"x0.025"	SM08212501	SM08212502	SM09212501	SM09212502

* Our version of the Roth arch-shape is not implied to be an exact version of any other system, nor do we claim any endorsement of Dr. Roth. Our version of the Damon archform is not implied to be an exact version of any other system, nor do we claim any endorsement of Dr. Damon.

ARCHWIRES & SPRINGS

Springs

The unique nickel titanium alloy is precision formed into close springs. The springs provide consistent force and remain active until the space is closed. Consistent force values and full recovery are both achieved routinely with NiTi close springs. Our close springs are available in 2 lengths and three types (No eye-let, two small eye-lets and 1 small eye-let and 1 big eye-let).

NiTi Close Spring with No Eye-let

Length	.010 inch.	.012 inch.
6mm	CS1006	CS1206
9mm	CS1009	CS1209



NiTi Close Spring with 2 Small Eye-let

Length	.010 inch.	.012 inch.
6mm	CS1006B	CS1206B
9mm	CS1009B	CS1209B



NiTi Close Spring with 1 Small Eye-let and 1 Big Eye-let

Length	.010 inch.	.012 inch.
6mm	CS1006D	CS1206D
9mm	CS1009D	CS1209D



Niti Open Springs

Open and maintain space gently and efficiently in a length of 178mm.

Length	.010 inch.	.012 inch.
178mm	OS1018	OS1218



Ligature Wires(30g/roll)

Annealed stainless steel

0.2 mm	SS-601-20
0.25 mm	SS-601-25
0.3 mm	SS-601-30



Kobayashi Ligature Wires(10 pieces/pack)

Ligature wire with hooks for elastics

	Long	Short
0.3 mm	SS61230	SS-612-30

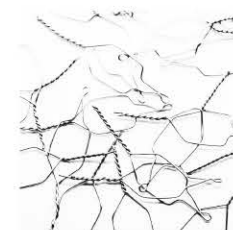



IMD
埃蒙迪

IMD Orthodontic Kit



ELAST

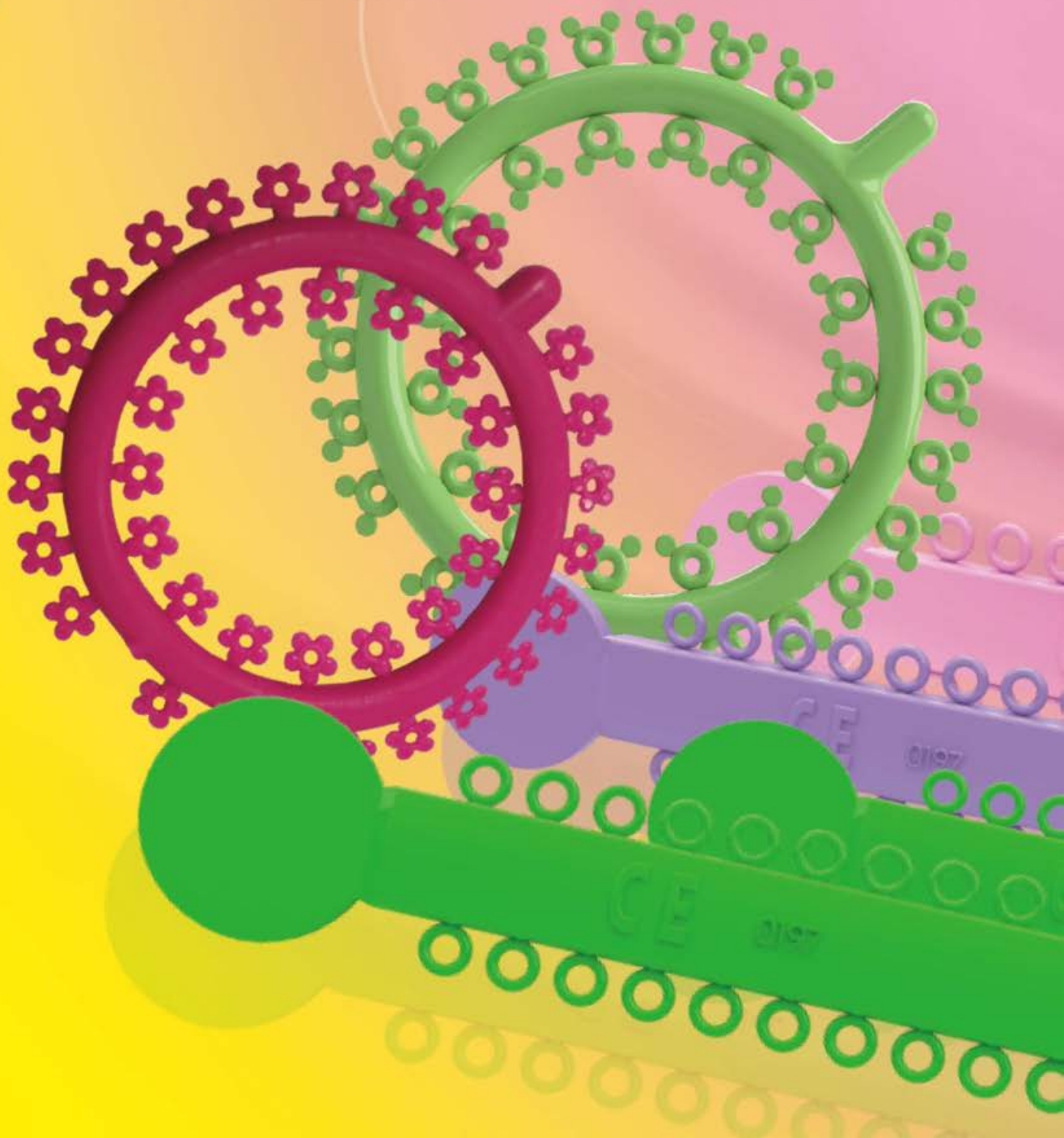

MERICS

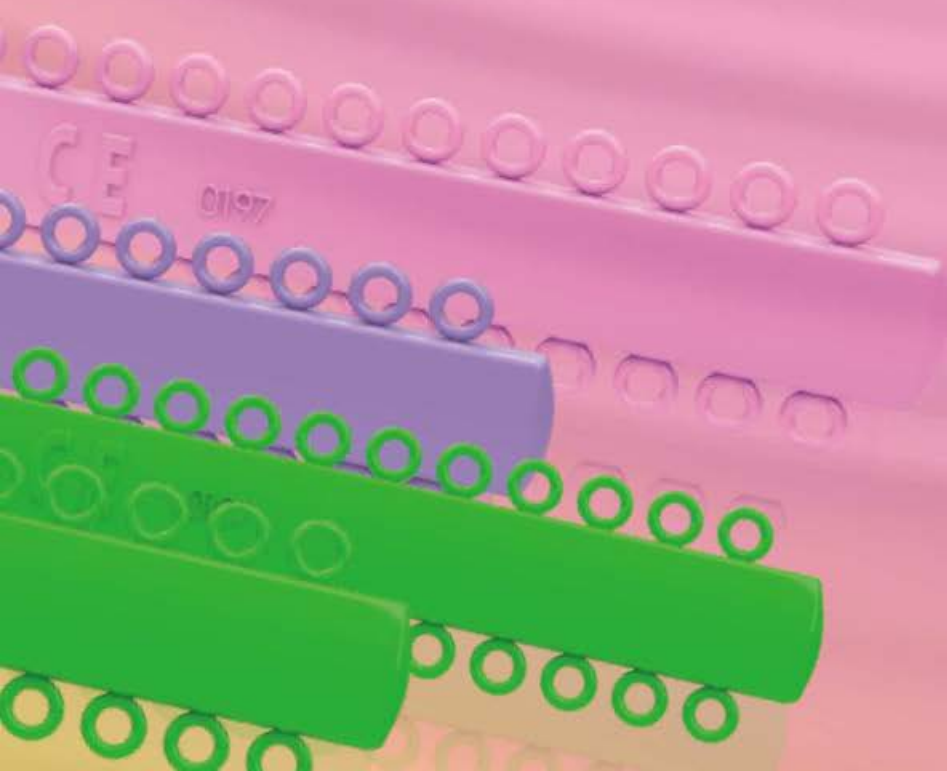

ELASTOMERICS

ELASTOMERICS

- Superior elasticity and rebound
- Extremely high resistance to breakage and tearing
- Quicker placement and reducing chair time
- Moisture resistant
- Work well with bracket systems
- Available in different colors



Long



Medium



Short



Closed

Hestia Power Chain

			Long	Medium	Short	Closed
01		Clear	52-001-01	52-002-01	52-003-01	52-004-01
02		Silver	52-001-02	52-002-02	52-003-02	52-004-02
03		Light Pink	52-001-03	52-002-03	52-003-03	52-004-03
04		Black	52-001-04	52-002-04	52-003-04	52-004-04
05		Light Purple	52-001-05	52-002-05	52-003-05	52-004-05
06		Lime	52-001-06	52-002-06	52-003-06	52-004-06
07		Shamrock	52-001-07	52-002-07	52-003-07	52-004-07
08		Teal	52-001-08	52-002-08	52-003-08	52-004-08
09		Green	52-001-09	52-002-09	52-003-09	52-004-09
10		Red	-	-	-	-
11		Burgundy	52-001-11	52-002-11	52-003-11	52-004-11
12		Fire Red	52-001-12	52-002-12	52-003-12	52-004-12
13		Bubble Gum	52-001-13	52-002-13	52-003-13	52-004-13
14		Light Blue	-	-	-	-
15		Metallic Blue	52-001-15	52-002-15	52-003-15	52-004-15
16		Navy	52-001-16	52-002-16	52-003-16	52-004-16
17		Aqua	52-001-17	52-002-17	52-003-17	52-004-17
18		Purple	52-001-18	52-002-18	52-003-18	52-004-18
19		White	52-001-19	52-002-19	52-003-19	52-004-19
20		Ice Blue	-	-	-	-
21		Jade	52-001-21	52-002-21	52-003-21	52-004-21
22		Gold Rush	52-001-22	52-002-22	52-003-22	52-004-22
23		Dark Orange	52-001-23	52-002-23	52-003-23	52-004-23
24		Orange	52-001-24	52-002-24	52-003-24	52-004-24
25		Pink	52-001-25	52-002-25	52-003-25	52-004-25
26		Rose	52-001-26	52-002-26	52-003-26	52-004-26
27		Dark Blue	52-001-27	52-002-27	52-003-27	52-004-27
28		Blue	52-001-28	52-002-28	52-003-28	52-004-28
29		Metallic Purple	-	-	-	-
30		Yellow	52-001-30	52-002-30	52-003-30	52-004-30
31		Nature	-	-	-	-
32		Carolina Blue	52-001-32	52-002-32	52-003-32	52-004-32

Hestia O-ring

50X100 /PACK

- Silicon Material

Force		1/8" 3.2mm	3/16" 4.8mm	1/4" 6.4mm	5/16" 8mm	3/8" 9.5mm
Light	2.5 oz 71g	53-001-32	53-001-48	53-001-64	53-001-80	53-001-95
Medium	3.5 oz 99g	53-002-32	53-002-48	53-002-64	53-002-80	53-002-95
Heavy	4.5 oz 128g	53-003-32	53-003-48	53-003-64	53-003-80	53-003-95

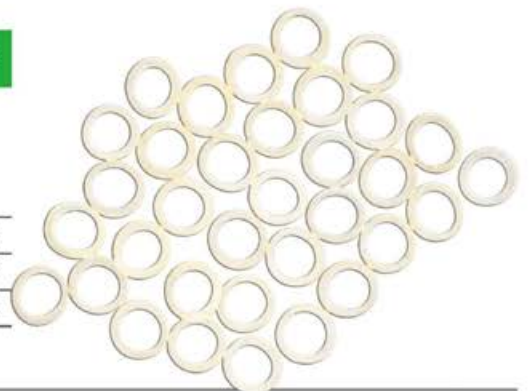

HESTIA LIGATURE

- Excellent retention and rebound
- Optimum size ties- 0.012 diameter
- Available in four types (Round, Flower, Mickey and Kitty)
- 1040PCS/PACK (round) 1000PCS/PACK (Flower, Mickey and Kitty)



Hestia Ligature		Round	Floewr	Mickey	Kitty
		0.22"	0.22"	0.22"	0.22"
00	Mixed	51-201-00	51-202-00	51-203-00	51-204-00
01	Clear	51-201-01	51-202-01	-	51-204-01
02	Silver	51-201-02	51-202-02	51-203-02	51-204-02
03	Light Pink	51-201-03	51-202-03	51-203-03	51-204-03
04	Black	51-201-04	51-202-04	51-203-04	51-204-04
05	Light Purple	51-201-05	51-202-05	51-203-05	51-204-05
06	Lime	51-201-06	51-202-06	51-203-06	51-204-06
07	Shamrock	51-201-07	51-202-07	51-203-07	51-204-07
08	Teal	51-201-08	51-202-08	51-203-08	51-204-08
09	Green	51-201-09	51-202-09	51-203-09	51-204-09
10	Red	51-201-10	51-202-10	51-203-10	51-204-10
11	Burgundy	51-201-11	51-202-11	51-203-11	51-204-11
12	Fire Red	51-201-12	51-202-12	51-203-12	51-204-12
13	Bubble Gum	51-201-13	-	51-203-13	-
14	Light Blue	51-201-14	51-202-14	51-203-14	51-204-14
15	Metallic Blue	51-201-15	51-202-15	51-203-15	51-204-15
16	Navy	51-201-16	51-202-16	51-203-16	51-204-16
17	Aqua	51-201-17	51-202-17	51-203-17	51-204-17
18	Purple	51-201-18	-	-	-
19	White	51-201-19	51-202-19	51-203-19	51-204-19
20	Ice Blue	51-201-20	-	-	-
21	Jade	51-201-21	-	-	-
22	Gold Rush	51-201-22	51-202-22	51-203-22	51-204-22
23	Dark Orange	51-201-23	51-202-23	51-203-23	51-204-23
24	Orange	51-201-24	51-202-24	51-203-24	51-204-24
25	Pink	51-201-25	51-202-25	51-203-25	51-204-25
26	Rose	51-201-26	51-202-26	51-203-26	51-204-26
27	Dark Blue	51-201-27	-	-	-
28	Blue	51-201-28	-	-	-
29	Metallic Purple	51-201-29	51-202-29	51-203-29	51-204-29
30	Yellow	51-201-30	51-202-30	51-203-30	51-204-30
31	Nature	51-201-31	51-202-31	-	-
32	Carolina Blue	51-201-32	51-202-32	51-203-32	-

Hestia Separators

1000PCS/ PACK

- Rapidly and efficiently separate tooth
- Consistent elasticity without deterioration
- Easily identified on x-ray
- Absorption-free

Bule 54-044-01



INSTRUMENTS&ACCESSORIES

Instruments

Torque Plier



For applying torque to edgewise wires

04-101-01

Kim Pliers



For applying multi loop edgewise wires with cutter

04-101-06

Band Remover Plier



Replaceable plastic tips removing band and bonding accessories

04-101-02

Nance Loop Bending Plier



For producing loops of different sizes

04-101-07

Loop Bending Pliers



Universal Pliers for different size loop:1.3mm, 3mm, 4.2mm

04-101-03

Posterior Brackets Remover Plier



For producing loops of different sizes

04-101-08

How's Pliers



Universal Pliers for the multi-band technique,also used to clip arch wires

04-101-04

Weingart Plier



For producing the arch and bending

04-101-09

Brackets Remover Pliers



Removing brackets and adhesive residue

04-101-05

Bondage Remover Plier



For removing bonding adhesives

04-101-10

Crimple Hook Plier



For applying and fixing crimple hooks on the arch wires

04-101-11

Three Jaw Plier



For bending wires V arches

04-101-12

Omega Loop Bending Plier



For bending omega loops

04-101-13

Universal Plier



Universal Plier for bending,plating,cutting

04-101-14

Ligature Cutter Plier



Cutting slot ligature wires up to 0.3mm and elastics,inserted hard metal alloy

04-102-01

Light Wire Plier



For bending fine wires,inserting hard metal alloy

04-102-02

Light Wire Plier with Cutter



For bending fine wires with cutter,inserting hard metal alloy

04-102-03

Distal End Cutter



Cutting archwires up to 0.5mm in diameter, inserting hard metal alloy

04-102-04

Tweed Loop Plier



For bending fine loops, stop loops and Omega loops

04-102-05

Heavy Cutter Plier



Cutting wires up to 0.6mm in diameter

04-102-06

Elastics Plier



For expanding elastics separating rings before positioning

04-103-01

Cap Remover Plier



For removing removable cap of convertible tubes

04-103-02

INSTRUMENTS&ACCESSORIES

Instruments

Bracket Positioning Gauge



01-010-01 Crossed

- 3.5 mm
- 4.0 mm
- 4.5 mm
- 5.0 mm



01-011-00 Shaft with replacement tip 4pcs/set

01-011-01

- 2.0 mm
- 2.5 mm

01-011-02

- 3.0 mm
- 3.5 mm

01-011-03

- 4.0 mm
- 4.5 mm

01-011-04

- 5.0 mm
- 5.5 mm

Bracket Tweezer



01-021-02

Force Gauge



02-012-01 0-450g or 0-160OZ Laser mark

Band Pusher



03-021-01



03-021-02

Ligature Instrument

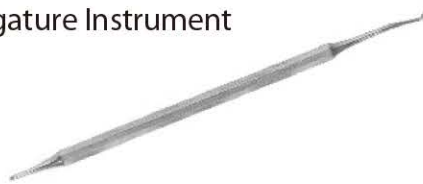

03-022-01



03-022-02

Buccal Tube Positioning



03-023-01

INSTRUMENTS&ACCESSORIES

Photographic Mirrors & Retractor

97-001-10 Glass mirror with hard plating 5pcs/kit



97-001-11 Adult Lingual Narrow



97-001-12 Adult Lingual Wide



97-001-13 Buccal



97-001-14 Adult Occlusal



97-001-15 Child Occlusal

97-002-10 Stainless Steel Mirror 3pcs/kit



97-002-11 Large



97-002-12 Lateral



97-002-13 Small

97-011-10 Cheek Retractor 3pcs/kit



97-011-11 Lateral



97-011-12 Large



97-011-13 Small



97-012-11 Lip Retractor Small



97-012-12 Lip Retractor Medium



97-012-13 Lip Retractor Large

INSTRUMENTS&ACCESSORIES

Accessories

Lingual Retainer Upper 2-2 Lateral to Lateral (2pcs/bag)

Direct bonding,suitable thickness and hardness

Size	14mm	16mm	18mm
REF	93-031-14	93-031-16	93-031-18



Retainer Lower 3-3 Cuspid to Cuspid (2pcs/bag)

Direct bonding,suitable thickness and hardness

Size	22mm	24mm	26mm	28mm
REF	93-032-22	93-032-24	93-032-26	93-032-28



Lingual Retainer (2pcs/bag)

Direct bonding,suitable thickness and hardness

Size	32mm	34mm	36mm	38mm	40mm
REF	93-034-32	93-034-34	93-034-36	93-034-38	93-034-40



Lower 3-3 Cuspid to Cuspid

Size	29mm	31mm	33mm	35mm	37mm
REF	93-035-29	93-035-31	93-035-33	93-035-35	93-035-37



Universal Lingual Retainer (2pcs/bag)

Size	2mm	1.2mm
REF	93-033-20	93-033-12



Palatal Bars

0.9 medical stainless steel, elastic to resist molar rotation and enhance anchorage

Size	37mm	39mm	41mm	43mm
Distal	93-011-37	93-011-39	93-011-41	93-011-43
Mesial	93-012-37	93-012-39	93-012-41	93-012-43

Size	47mm	49mm	51mm	53mm
Distal	93-011-47	93-011-49	93-011-51	93-011-53
Mesial	93-012-47	93-012-49	93-012-51	93-012-53



Universal Face Bow(solo pack)

Applied with headgear to provide extra oral anchorage

94-011-01



Asymmetry Face Bow(solo pack)

Applied with headgear to provide extra oral anchorage

94-012-01



J Hooks without Tubes (2pcs/bag)

94-012-01



J Hooks with Tubes (2pcs/bag)

94-022-01



INSTRUMENTS&ACCESSORIES

Accessories

Face Masks

0.9 medical stainless steel, elastic to resist molar rotation and enhance anchorage

Size	White	Red	Blue	Green	Yellow
S	95-012-01	95-012-02	95-012-03	95-012-04	95-012-05
L	95-011-01	95-011-02	95-011-03	95-011-04	95-011-05



Headgears (solo pack)

For mounting elastics and face bow or J hooks
High Pull System

- 95-021-01 • Large
- 95-021-02 • Small



Universal, adjustable with elastics and chin cup
Combination System

- 95-021-03 • Large
- 95-021-06 • Medium
- 95-021-07 • Small



With elastics and chin cup
Mandibular Pull System

95-021-04



For mounting elastics and face bows or J hooks
Horizontal Pull System

95-021-05



Headgear Pouch (10 pieces/pack)

To placement headgear or neck pad

95-023-01



Safety Module (10 pieces/pack)

For neck pad and pull headgear

- 95-023-02 • Heavy (yellow)
- 95-023-03 • Light (blue)



Safety Cervical Pad (10 pieces/pack)

With Module Short

95-022-01



Without Module Short

95-022-03

With Module Long

95-022-02

Without Module Long

95-022-04



Orthodontic Training Typondont Set (1 set/box)

99-800-00



- Including:
- Orthodontic training typondont
 - Resin teeth
 - Steel teeth
 - Wax model forms angle I
 - Wax model angle II

Light and compact
 Perfectly functional similar to articulate
 Recommended in most orthodontic courses

Orthodontic Training Typondont (1 pcs/box)

99-811-11



Resin Teeth (28 pcs/set)

99-822-00



Steel Teeth (28 pcs/set)

99-821-00



Wax Model Forms Angle Class I (1 set/box)

99-831-00



Wax Model Angle Class II/1 (1 set/box)

99-831-21



INSTRUMENTS&ACCESSORIES

Accessories

Orthodontic Wax (10 pieces/pack)

Orange	96-021-01
Grape	96-021-02
Apple	96-021-03
Stawberry	96-021-04
Blue strawerry	96-021-05



Arch Turret

Torque	Torque	Slots	Size
98-011-07	0°	5	0.016
			0.017
			0.018
			0.019
			0.020
			0.021
			0.022
98-011-06	5°	6	0.017
			0.018
	7°	6	0.019
			0.017
			0.018
			0.019





Innovation for you

INNOVATIVE MATERIAL AND DEVICES, INC.

Add: Building#5, NO. 615 Fengdeng Rd.,
Jiading District, Shanghai 201801, China.
<http://en.imdmedical.com/>

Sino-American joint venture company