

# ALLURE 1500

## Freestanding Bathtub

### MODEL NUMBER: ALLURE 1500

Contemporary, ergonomic and comfortable, the Freestanding Bathtub with Built-in Drain System features harmonious clean lines and bathing well for pure pleasure.

### DESCRIPTION

- One piece freestanding bathtub
- 100% Lucite acrylic material made bathtub, smooth and glossy surface
- High thermal water heat retention
- Built-in overflow and pop-up drain system, brass material prevent pipe leaking
- Six of level adjustment feet, solid and stable



### SPECS

<b>Overall Size:</b>	59"W x 24"H x 30"D
<b>Product Weight</b>	43.09kg
<b>Drain Placement</b>	Centre
<b>Capacity</b>	60 gallons
<b>Rough-in Included</b>	Not Included

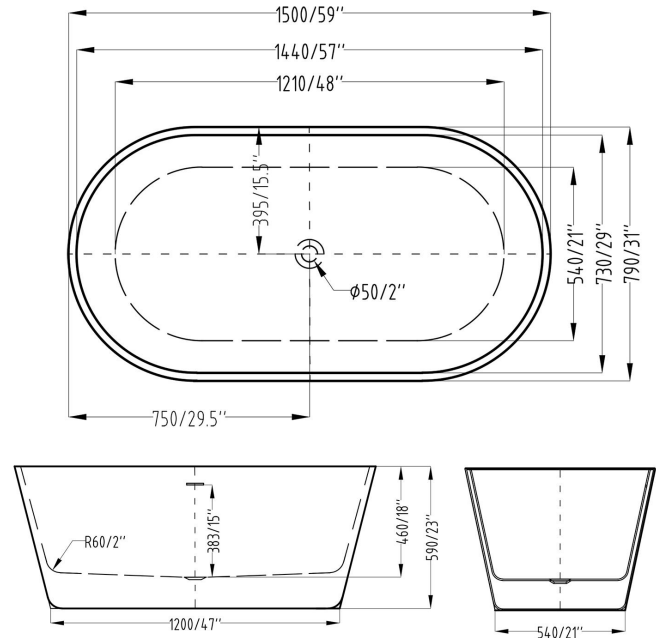

### CERTIFICATES & WARRANTY

- cUPC compliant
- Limited Five Years Warranty

## ALLURE 1700 Freestanding Bathtub

### MODEL NUMBER: ALLURE 1700

Contemporary, ergonomic and comfortable, the Freestanding Bathtub with Built-in Drain System features harmonious clean lines and bathing well for pure pleasure.

### DESCRIPTION

- One piece freestanding bathtub
- 100% Lucite acrylic material made bathtub, smooth and glossy surface
- High thermal water heat retention
- Built-in overflow and pop-up drain system, brass material prevent pipe leaking
- Six of level adjustment feet, solid and stable



### SPECS

<b>Overall Size:</b>	67"W x 24"H x 32"D
<b>Product Weight</b>	47kg
<b>Drain Placement</b>	Centre
<b>Capacity</b>	70 gallons
<b>Rough-in Included</b>	Not Included

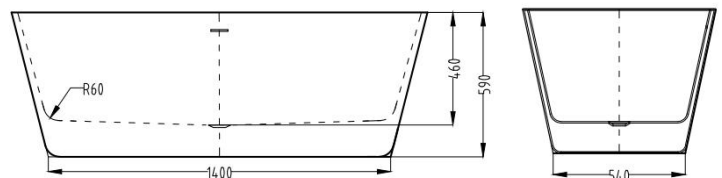
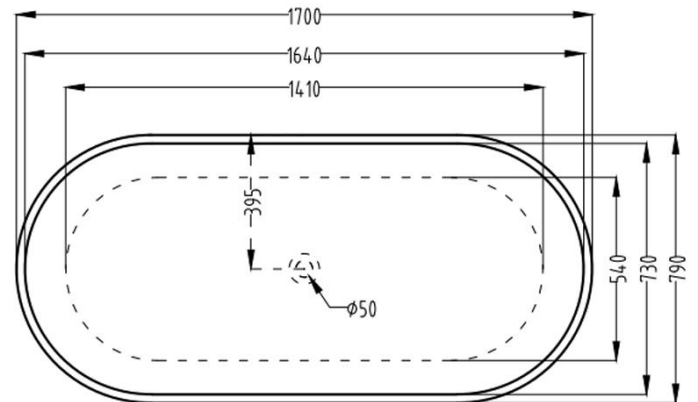

### CERTIFICATES & WARRANTY

- cUPC compliant
- Limited Five Years Warranty