

Jumbo Wide Retractor

5': 261080, 261081, 190314
6': 261082, 261083, 190315
8': 261018, 261019, 190296

Product Parts

- 1 - Base
- 2 - Banner Rail
- 3 - Shock cord Pole (x2)
- 4 - Pin

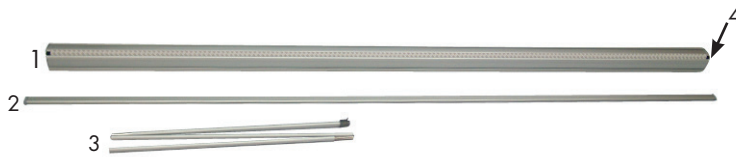

***Do Not Pull Pin Until Directed**

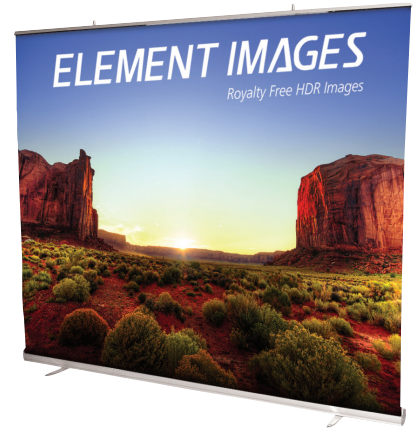

Banner Install

Step 1

Remove all of the product parts from the bag and place, along with the banner, on a clean flat surface. Remove both End Caps (A) from the Banner Rail and snap the Banner Rail (2) open. Fully insert the top edge of the Banner into the groove of the Banner Rail (2) and snap the rail shut (B).

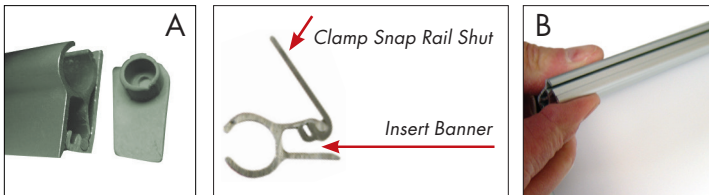

Step 2

Lay the banner flat, printed side up. Align the bottom of the banner to the adhesive strip on your leader. Remove the protective paper from the adhesive and firmly press the bottom of the banner onto the adhesive, and be sure to smooth out any bubbles or wrinkles.

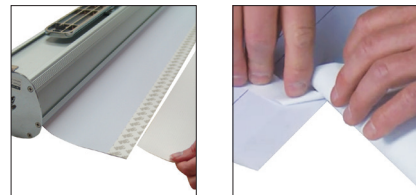

Step 4

Maintain tension on the banner while slowly removing the Pin (4). Allow the banner to gently roll into the canister.



****Keep the Pin for future graphic changes.**

Step 5

Once the banner has been fully retracted into the Base, simply place the display in the carrying case until you are ready for display set-up.

Display Set-Up

Step 1

Remove the display from the carrying case and place at your desired location



Step 2

Flip the Base (1) upside down and rotate the feet to sit perpendicular to the Base.



Step 3

Insert the Shock Cord Poles (3) into the receptacles on the base (1). Ensure the poles are seated completely into the bottom half circle cutout.



Step 4

***** To ensure that the display does not twist, it is recommended that two people extend the banner from the base and hook the snap rail to the poles.**

In tandem with another person, stand facing the back of the Base and gently pull the Banner Rail (2) upwards. Clip both Hooks into the openings located on the Poles.



Storage

Place all product parts into Carry Case and store in a cool dry location.



Care

To clean, wipe with damp cloth.

Replacement Graphic

What you will need before you start

- 1 - Graphic
- 2 - Two-Sided Banner Tape
- 3 - Tension Pin

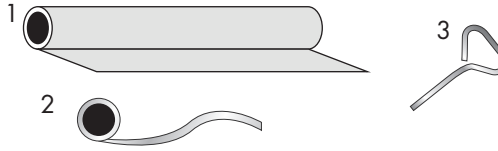

* For ease of graphic replacement, the use of a competent partner is recommended but not required.



Prep Instructions

Step 1

Locate the Tension pin on your retractor. It is usually found on the bottom of the base. A two inch finishing nail can substitute for the pin. Hold the base firmly and have your partner carefully pull the banner completely out of the base exposing the leader beyond the original graphic. This is best done laying the unit on its backside.

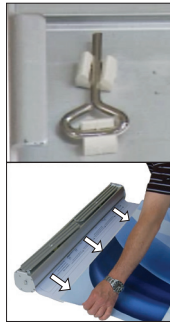

Step 2

With the leader exposed and tension on the banner, fully insert the tension pin into the hole on the side of the unit preventing the axle from retracting the banner back inside. This may take your partner moving the banner slightly in or out to line the pin in its slot. If done correctly there will not be any tension on the banner and you can begin the graphic change out procedure.

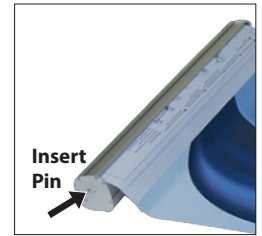

Graphic Replacement

Step 1

Carefully peel the graphic from the leader. You don't want to damage or tear the leader.

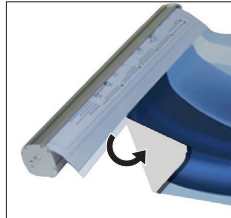

Step 2

Remove the plastic end caps from the ends of the snap rail. Snap the rail open. Note how the banner was installed in the rail so you can replicate that with the new graphic.

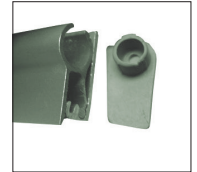

Step 3

Install the snap rail on the top of the banner. Make sure the banner is all the way inserted in the snap rail. Snap the rail shut and replace the end caps.

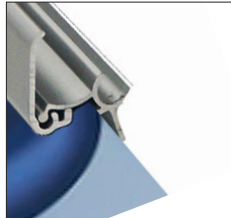

Step 4

Adhere the provided banner tape to the end of the leader. Remove backer from the tape and adhere the banner to the leader making sure it's completely straight. You can add a strip of packing tape for added precaution.

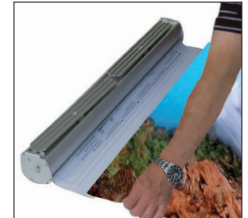

Step 5

Have your partner hold the top of the banner taut and then gently pull the tension pin out. Retract the new banner slowly into the base.

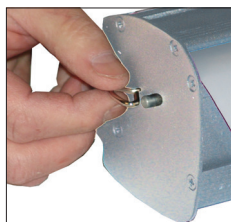

NOTE:

End Caps, Snap Rails, Tension Pins and other hardware may vary from your product, however the concept is the same.