

GG-1010-PRTU Instructions

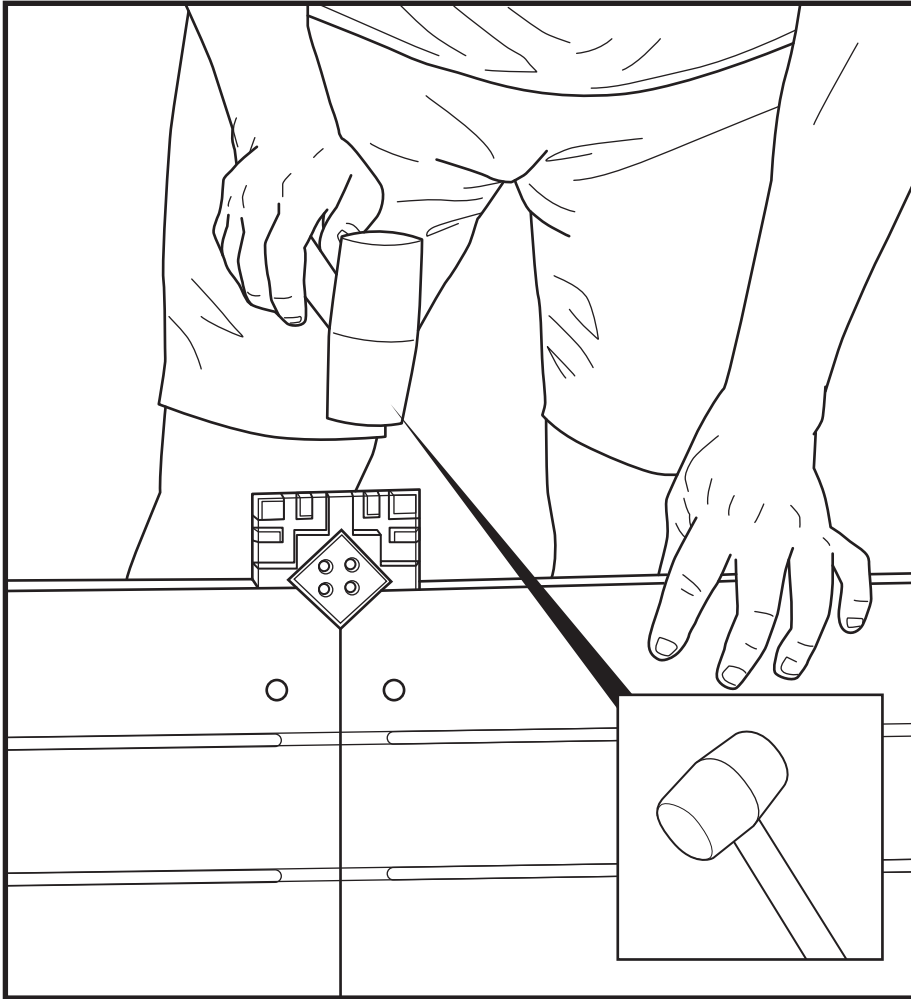

Note on Attaching Connector fittings:

The connector fittings are tight and typically loosen with use.



Use the supplied rubber mallet to tap the connectors into place.

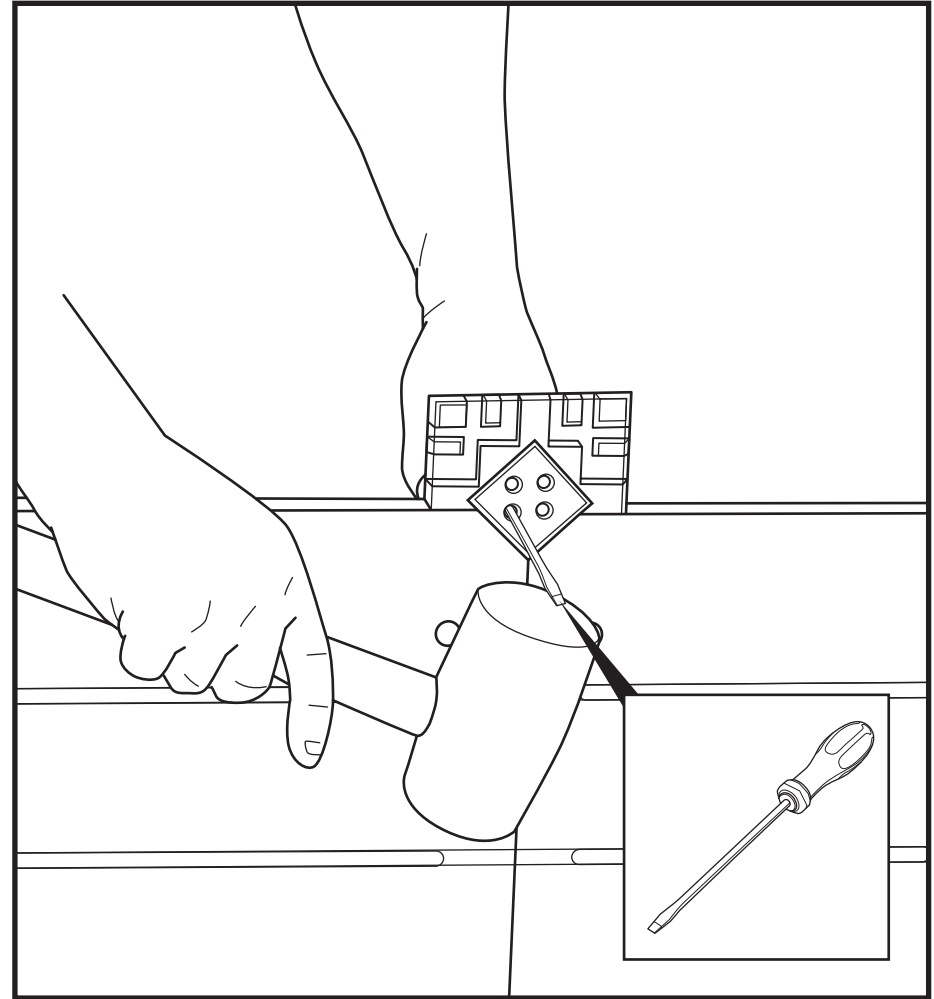

Put the supplied screwdriver through one of the holes in the connectors and use the mallet to tap upwards on the screwdriver to remove the connectors from the panels. The corner connectors can be left in the corner panels.

Parts Overview

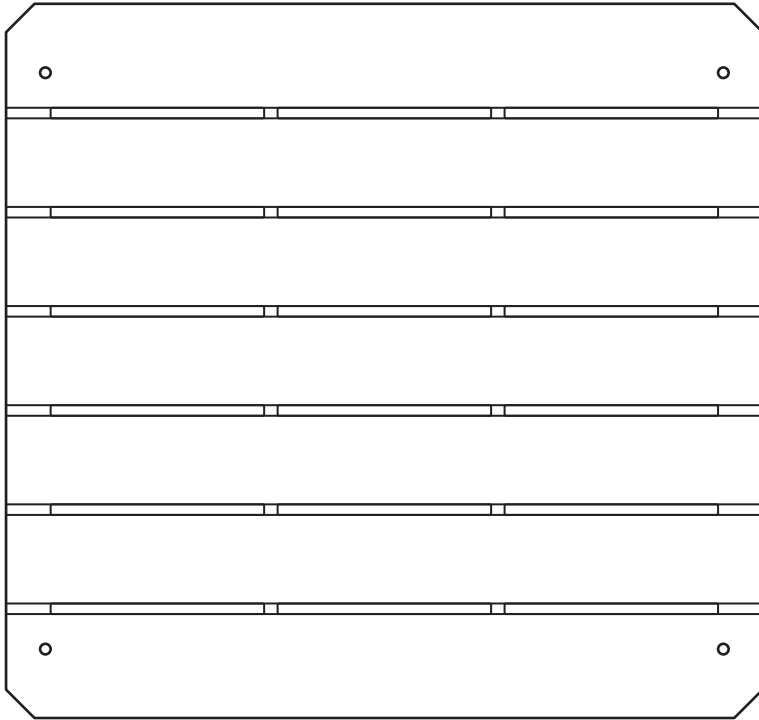

Plastic Panel (Slat side)

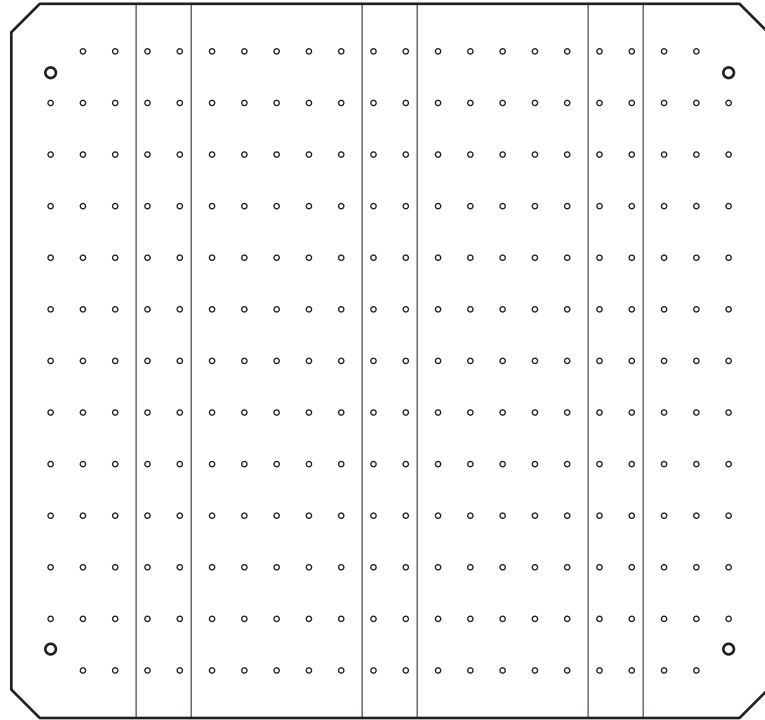

Plastic Panel (Peg Side)



GG1-B
Corner Piece

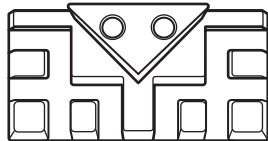

GG2-B
Two Panel Connector
Not Hinging

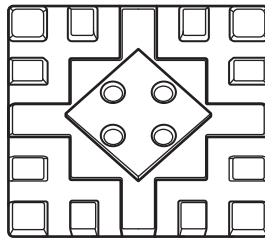

GGS1-B
Four Panel Connector
Not Hinging

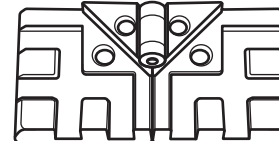

GGH2-B
Two Panel Connector
Hinging

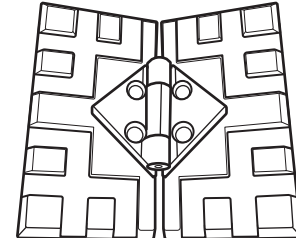

GGH1-B
Four Panel Connector
Hinging

See the attached diagram:

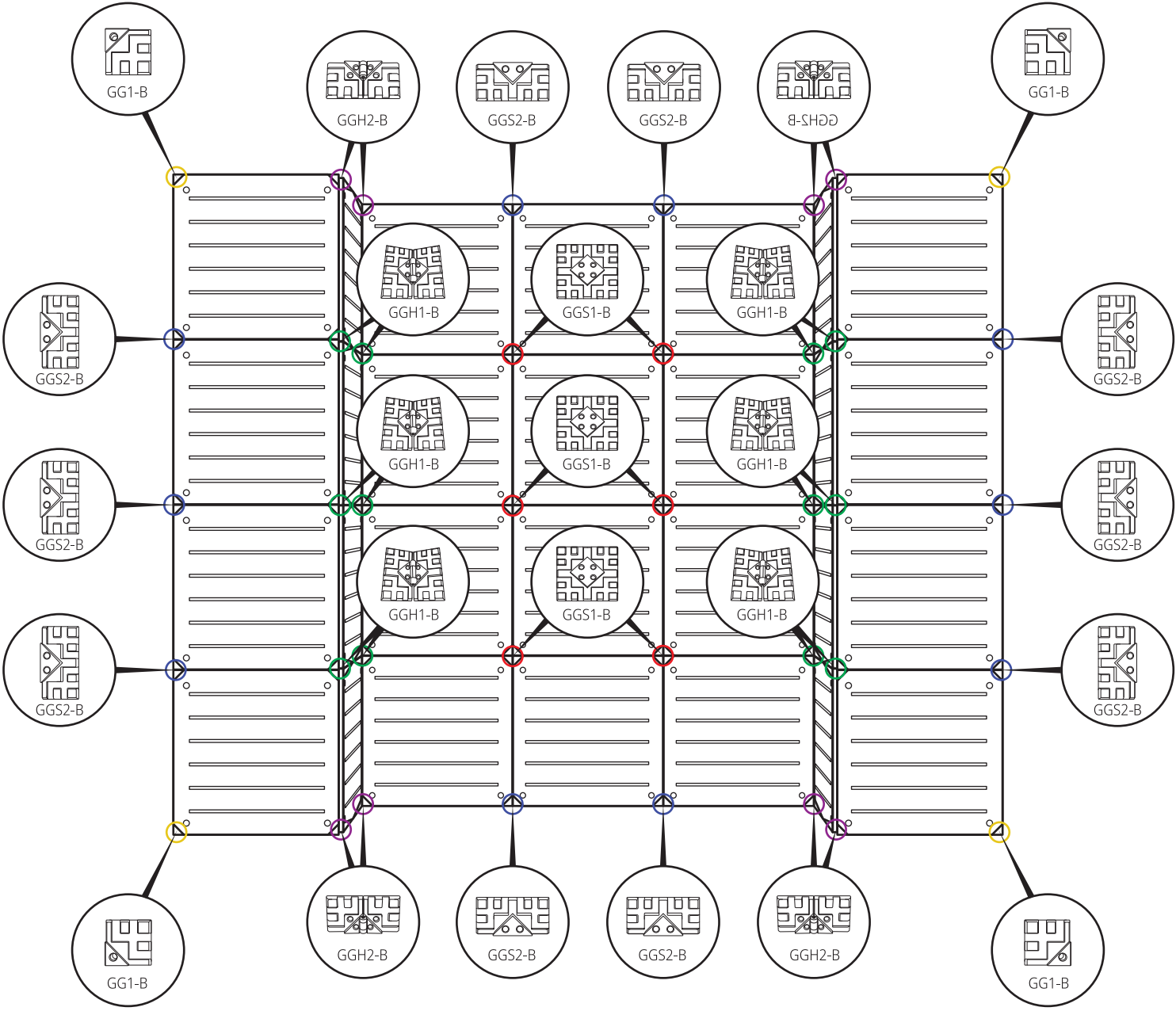

- Blue - GGS2-B
- Purple - GGH2-B
- Red - GGS1-B
- Green - GGH1-B
- Yellow - GG1-B

Optional Graphic Panel

Align graphic panel to plastic panel and connect using small rubber plugs.

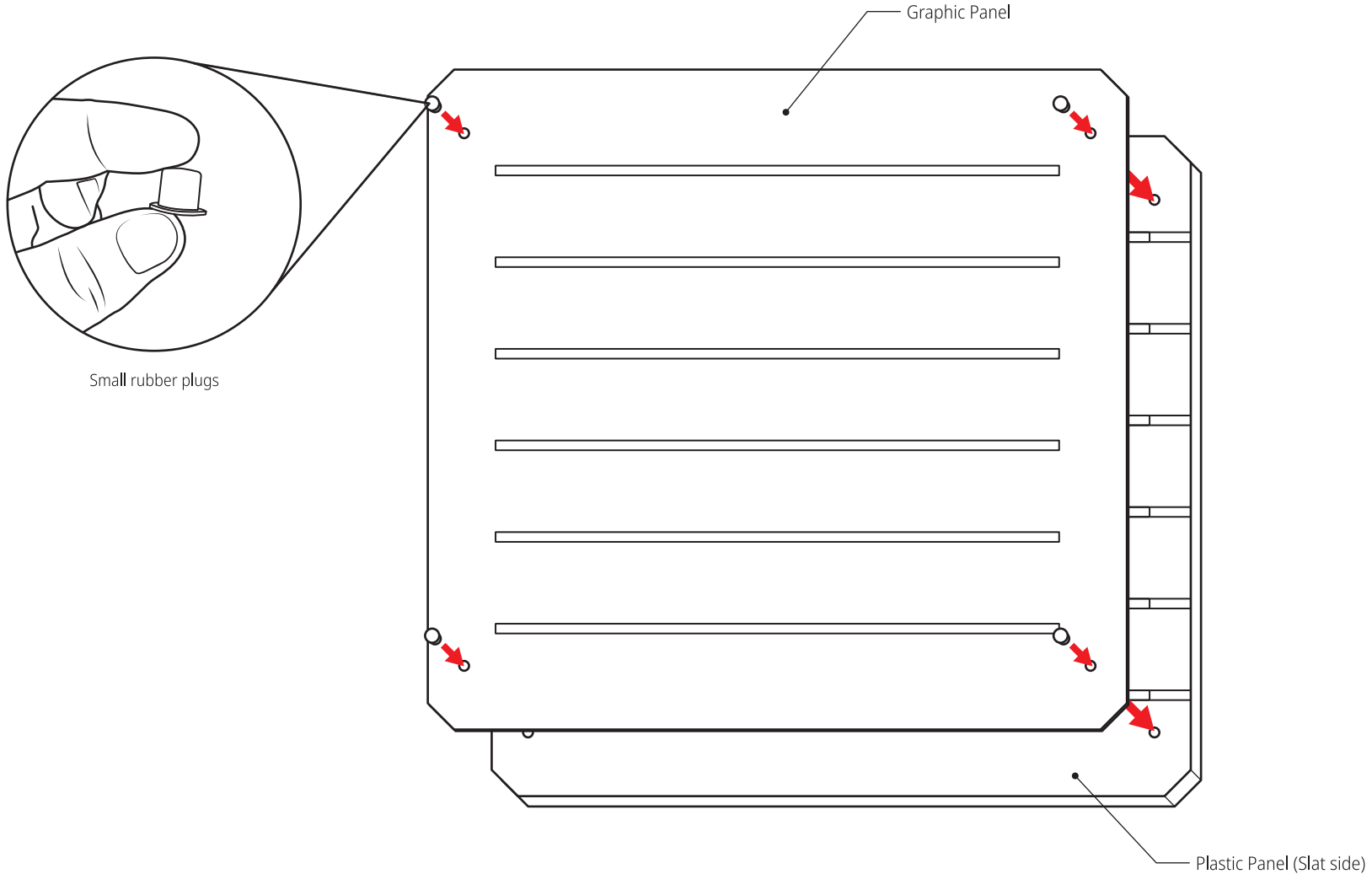

*Graphic panel can be white or printed graphics.