

Fabric Banner Stand, 2FT, 3FT, 4FT, and 5FT

SETUP INSTRUCTIONS

2FT

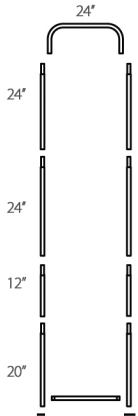

24"x90"

3FT

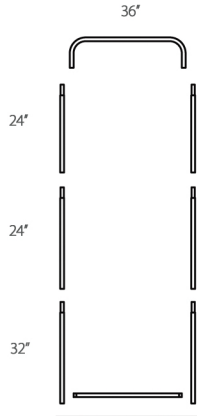

36"x90"

4FT

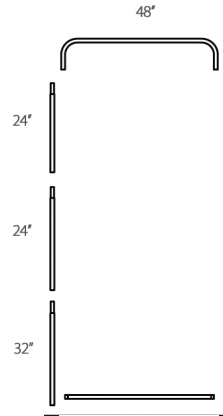

48"x90"

5FT

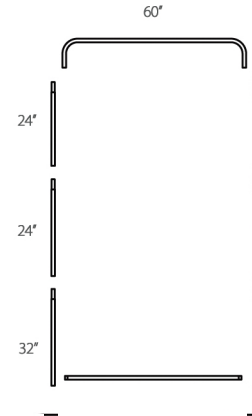

60"x90"

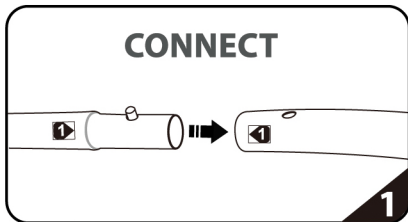

Connect numbered tubes together.

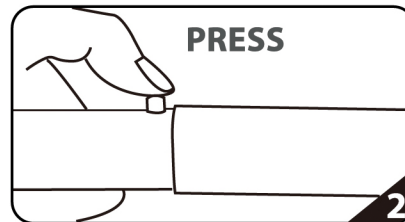

Snap tubes together.

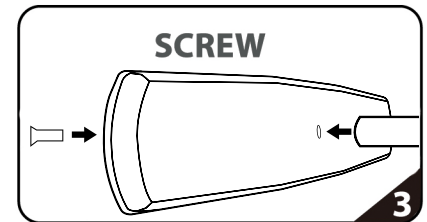

Screw foot to tube with threaded bottom.

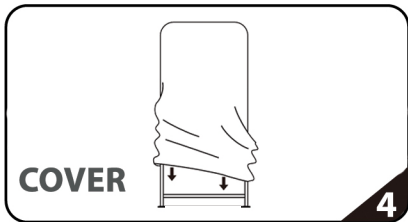

Cover frame with fabric graphic.

To assemble, secure the longest vertical poles onto the pair of feet using the included allen wrench. Add the bottom horizontal support pole and secure. Snap on the remaining vertical poles, then top frame with the curved bar to complete. Tilt or lay down EZSTAND to swiftly drape with the pillowcase graphic. Using the industrial-sized zipper, zip underneath the bottom support pole, maximizing fabric tension.

