

# nuwave®

**300**  
SQ.FT.

---

**OXPURE HEPA AIR PURIFIER**



**Owner's Manual**

**Model 47501 / 47502**

**Questions or Concerns?**

Toll Free: 1-877-689-2838 • [help@nuwavenow.com](mailto:help@nuwavenow.com)  
(Mon–Fri 7:30am–4:30pm CST)

# THANK YOU

for purchasing the NuWave OxyPure HEPA 300 Air Purifier



## REGISTER YOUR PURCHASE

1. [nuwavenow.com/QR](http://nuwavenow.com/QR)

2. Scan the QR code using your mobile device.

## RECORD THIS INFORMATION

Model Number: \_\_\_\_\_

Serial Number: \_\_\_\_\_

Date of Purchase: \_\_\_\_\_  
(Keep receipt)

Store of Purchase: \_\_\_\_\_

## TECHNICAL SPECIFICATIONS

Voltage: DC12V/1.0A

Wattage: 12W

**TIP:** You can locate the model and serial numbers, as well as the QR code, on the label on the back of the unit.

## CUSTOMER SERVICE

Phone: 1-877-689-2838 (Mon–Fri 7:30am–4:30pm CST)

Email: [help@nuwavenow.com](mailto:help@nuwavenow.com).

### Trademark & Copyright Notice

NuWave, NuWaveNow, and OxyPure are registered trademarks of NuWave, LLC. All Rights Reserved.

## Welcome to the NuWave® Family!

Congratulations on getting your new NuWave OxyPure HEPA 300 Air Purifier! We are incredibly excited for you to enjoy pure, clean air in your home and want to make sure you get the most out of your OxyPure® experience.

That's what this manual is all about. In it, we have provided detailed operating and care instructions covering every aspect of your new air purifier to make sure the OxyPure is meeting your needs.

Here at NuWave, the relationship we have with our customers only begins with the purchase. We are with you every step of the way because we are dedicated to making your experience as easy and rewarding as possible. So, if you have any questions, comments, or concerns, please don't hesitate to contact Customer Service by calling 1-877-689-2838 (Mon–Fri 7:30am–4:30pm CST) or emailing us at [help@nuwavenow.com](mailto:help@nuwavenow.com).

We're glad you're with us, and we know that you will be, too!

Connect with Us!



#nuwavenow

Visit [nuwavenow.com](http://nuwavenow.com) to see other great products and accessories.



# CONTENTS

Important Safeguards ..... 4–5

Electrical Information ..... 5

Parts & Accessories ..... 6

Assembly ..... 7

Operating the OxyPure ..... 8

Maintaining the OxyPure ..... 9

OxyPure Efficiency ..... 10

Pollutant Removal ..... 11–12

Limited Warranty ..... 13–15

Para la versión en español de este manual, visita [www.nuwavenow.com](http://www.nuwavenow.com)

Meets California ozone emissions limit.  
CARB certified



# IMPORTANT SAFEGUARDS

HOUSEHOLD USE ONLY • READ ALL INSTRUCTIONS BEFORE USE

**ALWAYS KEEP THIS MANUAL HANDY FOR FUTURE REFERENCE.**

**READ ALL INSTRUCTIONS and WARNINGS:** The failure to follow any of the important safeguards, warnings, or instructions for safe use is a misuse of the OxyPure that can void your warranty and create the risk of serious injury. When using the OxyPure, basic safety precautions should always be followed.

1. ONLY use the OxyPure for its intended purpose.
2. To protect against the risk of electrical shock, **DO NOT** immerse the cord, plug, or any part of the OxyPure in water or any other liquid.
3. Close supervision is necessary when the OxyPure is used by or near children. The OxyPure is not intended for use by children, persons with reduced physical, sensory, or mental capabilities, or those who lack expertise or knowledge of this device.
4. **DO NOT** operate the OxyPure with a damaged cord, plug, after any malfunction, or if the unit has been dropped or damaged in any way. Contact Customer Service at 1-877-689-2838 or email [help@nuwavenow.com](mailto:help@nuwavenow.com) for more information.
5. Discard the protective plastic covering the power plug before use.
6. **DO NOT** run the cord under carpeting. **DO NOT** cover the cord with throw rugs, runners, or other coverings.
7. **DO NOT** route the cord under furniture or appliances. Arrange the cord away from high-traffic areas where it will not be tripped over.
8. **DO NOT** plug the OxyPure into an outlet or power strip that is being used by other appliances.
9. Remove any dust or water from the plug, if needed.
10. ALWAYS set up the OxyPure on a flat, stable surface.
11. **DO NOT** set up the OxyPure where it could be pushed, kicked, or tripped over.
12. Leave at least 2-3 feet of space between the OxyPure's vents and any walls.
13. **DO NOT** install the OxyPure near a heating device, flammable or combustible gases or vapors, or in areas exposed to moisture or water.
14. **DO NOT** operate the OxyPure on its side.
15. **DO NOT** place objects on top of the OxyPure.
16. **DO NOT** sit or stand on, or lean against, the OxyPure.
17. Alteration or modification of any part of the OxyPure, or the use of attachments not recommended by the manufacturer, may cause fire, injury, or damage to property.
18. As with most electrical units, electrical parts are live even when the OxyPure is off. Be sure the OxyPure is unplugged when assembling.

# IMPORTANT SAFEGUARDS

## HOUSEHOLD USE ONLY • READ ALL INSTRUCTIONS BEFORE USE

- 19. DO NOT** use the OxyPure in a factory or industrial setting where machine oil may be present in the air.
20. Turn the power OFF on the OxyPure before unplugging the OxyPure.
21. Unplug the OxyPure from the outlet when the unit is not in use or will be left unattended for an extended period of time; before putting on or taking off parts; when removing or replacing the filter; and before cleaning.
- 22. DO NOT** operate the OxyPure if abnormal sounds or motion is detected.
23. If any foreign object comes into contact with the fan, do not operate. Turn off and unplug the OxyPure.
24. Inspect the OxyPure for any loose or missing parts before and after each use. If parts are loose, damaged, or missing, contact Customer Service at 1-877-689-2838 or email [help@nuwavenow.com](mailto:help@nuwavenow.com).
- 25. DO NOT** pull, lift, drag, or carry the OxyPure by its cord.
- 26. DO NOT** block the air inlet or outlet vents.
- 27. DO NOT** operate the OxyPure without the filter.

### FILTER CHANGING PRECAUTIONS

- 1. DO NOT** try to clean the HEPA/Carbon filter. Doing so will release dust and other pollutants back into the air.
2. ALWAYS wear a mask and rubber gloves when handling a dirty filter.
3. When removing a dirty filter, ALWAYS do so outside or in a well ventilated area.
4. ALWAYS replace your filter with a NuWave filter made for your model of air purifier.

### ELECTRICAL INFORMATION

These servicing instructions are for use by qualified personnel only. To reduce the risk of electric shock, do not perform any servicing other than that contained in the operating instructions unless you are qualified to do so.

#### Power-Supply Cords

A short, detachable power-supply cord is provided to reduce the risk of becoming entangled in, or tripping over a longer cord. Longer detachable power-supply cords or extension cords are available and may be used if care is exercised in their use. If a longer, detachable power-supply cord or extension cord is used:

1. The marked electrical rating of the extension cord should be at least as great as the electrical rating of the appliance.
2. The longer cord should be arranged so that it will not drape over any countertop or tabletop where it could be pulled on or tripped over unintentionally.
3. The OxyPure should be operated on a separate electrical outlet from other operating appliances due to wattage limitations.

# PARTS & ACCESSORIES



## Ordering Parts

Keeping your OxyPure up and running with new filters is a breeze.

1. Locate the part number on the above images, then
2. Call NuWave Customer Service at **877-689-2838** Monday–Friday, 7:30am to 4:30pm CST, or order online at [www.nuwavenow.com](http://www.nuwavenow.com).

### Remember...

**ALWAYS** remove the plastic wrapping from the new filter **BEFORE** using it in the OxyPure. Failing to do so may damage the motor and other parts of the OxyPure and may void your warranty.

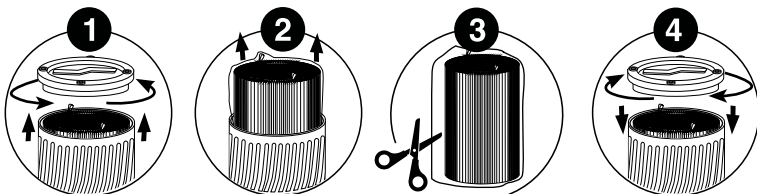
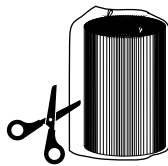

# ASSEMBLY

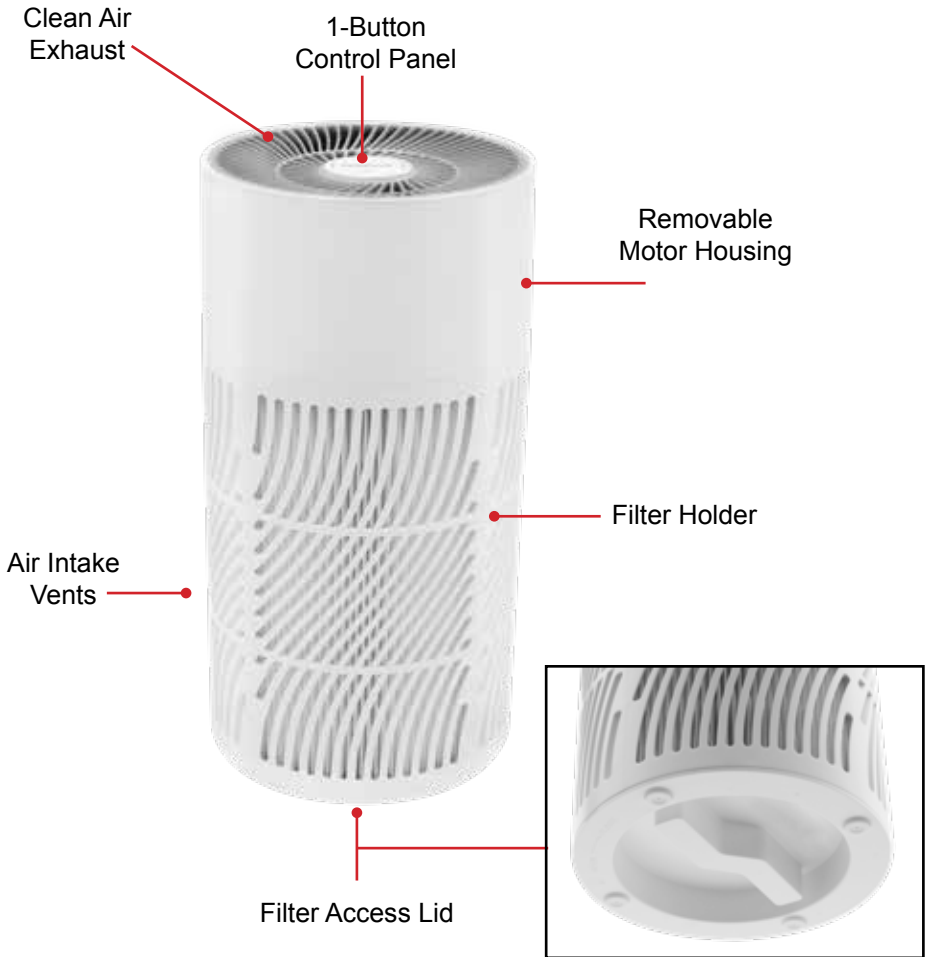

## Assembling the OxyPure

Before using your OxyPure, you need to make sure that the filter is properly installed. With the OxyPure unplugged:

1. Turn the Filter Access Lid at the bottom of the OxyPure to open it.
2. Remove the new HEPA/Carbon Filter.\*
3. Remove the plastic wrapping from the new filter.
4. Fully insert the new HEPA/Carbon Filter into the Filter Holder.
5. Replace the Filter Access Lid, turning it to lock it back into place.
6. Attach the Power-Supply cord and plug in the OxyPure.

\*When using the OxyPure for the first time.

# OPERATING THE OXYPURE

## CLEAN AIR AT THE TOUCH OF A BUTTON

### One Button Does it All

Simplicity. That is the secret of the OxyPure HEPA 300 Air Purifier. With only one button, it is simple to operate. With its revolutionary HEPA/Carbon filter, it is as easy to relax knowing that your air is as clean as the unit is simple to maintain. With its lightweight design and construction, it is easy to take almost anywhere. Simplicity and peace of mind at the touch of a button.

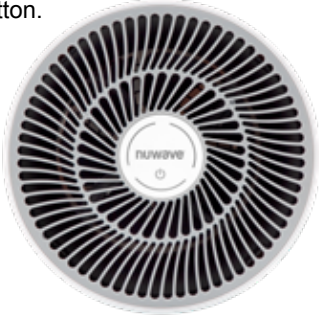

Fan Speed 1  
Low Speed



Fan Speed 2  
Medium Speed



Fan Speed 3  
High Speed

1. Plug the Power Supply cord into the jack at the back of the OxyPure, and then plug it into a suitable electrical outlet. The unit will beep once.
2. Press the Power icon. The unit will activate at the lowest fan speed. It will beep once and the upper-right LED will light.
3. Press the Power icon again to increase the fan speed to medium. The unit will beep and the second LED will light.
4. Press the Power icon again to increase the fan speed to high. The unit will beep and the third LED will light.
5. Press the Power icon a fourth time and the OxyPure will turn off. The unit will beep and the LEDs will go dark.

Number of Presses	Fan Speed Level	Bars on Panel	Fan Speed (RPM)
1	1	1	400
2	2	2	800
3	3	3	2450
4	OFF	0	OFF

### EnergySTAR Certification

The U.S. Environmental Protection Agency (EPA) has published specifications for energy efficiency using a Clean Air Delivery Rate (CADR) to Watt ratio. The unit being tested must produce a CADR of at least 50 for smoke. Minimum performance is 2.0 CADR/Watt with 2.0 Watts standby power. The OxyPure passed the test handily.

Criteria	Standard	Measured
Smoke CADR (ft <sup>3</sup> /min.)	>50	84
Total Energy Consumed (Watts)	--	13.3
Smoke CADR/Watt (ft <sup>3</sup> /min./W)	>2.9	6.3
Standby Power (Watts)	<1	0.55

### Electrical Safety

Along with energy efficiency comes safety. The California Air Resources Board (CARB) ensures that every air purifier sold in California meets certain standards for electrical safety and performance.

The OxyPure was tested for electrical safety against the ANSI/UL507 electrical safety standard, and was found to be fully compliant.

Test	Standard	Measured
Electrical Safety	ANSI/UL507	Compliant



# MAINTAINING THE OXPURE

## Changing the HEPA/Carbon Filter

It is important to change the HEPA/Carbon Filter regularly. The Replace Filter light, which is the Fan Speed 1 light, will glow yellow after 6 months, letting you know that you SHOULD change the filter. When it turns red after a year, you MUST change the filter.



With in 6 Months    After 6 Months    After 12 Months

1. Turn the OxyPure off and unplug it.
2. Take the OxyPure outside or into a well ventilated area.
3. Wearing a disposable mask and rubber gloves, open the Filter Access Lid and remove the old HEPA/Carbon Filter, placing it in a plastic garbage bag along with the gloves for disposal.
4. Unwrap the new HEPA/Carbon Filter and insert it into the Filter Holder.
5. Securely close the Filter Access Lid.
6. Place the unit where you wish, plug it in and turn it on.
7. To reset the Replace Filter light, press and hold Power. There will be 2 short beeps and the Fan Speed 1 light will turn white.

## Cleaning the OxyPure

Depending on the environment, you may need to clean the OxyPure more often to maintain the finish and function of the unit.

- Remove the dirty HEPA/Carbon Filter and place it in a garbage bag.
- Wash the vented body of the unit with warm, soapy water, and dry thoroughly before inserting a clean HEPA/Carbon Filter. You can use a gentle, non-abrasive cleaner, but apply it to the cloth, not to the unit.
- Make sure the vents are free of any obstruction.

- Clean the Motor housing on all side-sides, using the brush attachment for your vacuum cleaner or a damp cloth or sponge. Dry it thoroughly before reassembly.
- **DO NOT** immerse this component in water.
- Reassemble the OxyPure.

## TROUBLESHOOTING GUIDE

### The OxyPure Does Not Turn On.

1. The unit is not plugged-in. Plug the unit into an appropriate wall outlet.
2. **POWER** on the control panel is OFF. Press **POWER**.

### The Fan Speed Doesn't Change.

There may be an issue with the control panel button. Contact Customer Service for assistance.

### Airflow From the Top Vent is Weak.

The HEPA/Carbon filter is dirty. Change the filter.

### The Unit Produces Smoke or Odor.

The HEPA/Carbon filter is dirty. Change the filter.

If any of these problems persist, contact NuWave's friendly and knowledgeable Customer Service Team at **1-877-689-2838**, Monday through Friday from 7:30am to 4:30pm,(CST) or via email at [help@nuwavenow.com](mailto:help@nuwavenow.com).

### TURN UNIT UPSIDE DOWN OPEN THE LID TO CHANGE THE FILTER



# OXYPURE EFFICIENCY

## Allergies and Sleep

When you react to any allergen, it is your body's immune system working to clear away the harmful or irritating substance by generating antibodies to hunt down the intruder while releasing histamine and other substances that cause the typical symptoms of an allergic reaction.

The OxyPure can help with allergens such as pollen, dust, dustmites, mold spores, wood and coal ash, and any other particle that might be floating around in your home's air, eliminating them so that you breathe easier day and night.

## Sleep is Important



Allergies can do more than just make you itch and sneeze. They can keep you up, or keep your spouse up as you snore and choke your way

through the night, robbing you of rest and leaving you dragging through the day and even leading to things like weight gain, headaches, and even cognitive changes and confusion. It could even be a sign of something even more dangerous, sleep apnea.

If allergies are your problem, instead of relying entirely on pills that can make things worse (never just stop any prescription medication without your doctor's advice), do something about the allergens in your air with a good air purifier with a high CADR and good HEPA/Carbon filters like the OxyPure. The cleaner the air, the less your allergies will bother you. It's that simple with OxyPure.

## Clean Air Delivery Rate and Removal Efficiency

An air purifier's Clean Air Delivery Rate (CADR) measures clean air flow out of the unit against different air pollutants, in this case smoke, dust and pollen.

There are a number of factors that go into CADR from particle size and composition to fan speed to filter cleanliness. You can see this in the following chart:

Particulate Matter (Size in microns)	CADR (Ft <sup>3</sup> /Min.)	Removal Efficiency
Smoke (0.1µm-1µm)	84	100% in 100 minutes
Dust (0.1µm-1µm)	104	100% in 100 minutes
Pollen (0.1µm-1µm)	114	100% in 30 minutes

Notice that while the particle size for each is the same, the CADR for each kind of particle is markedly different, with dust having the lowest CADR while pollen has the highest by a wide margin.

Smoke, dust and pollen are not the only particle pollutants that can find in your home. The table on page 12 will introduce you to some of them and put their size into perspective for you.

### ***Did you know...***

When you cough, you expell enough air to fill a 1.5 liter container in a plume that extends several feet and carries some 3,000 droplets of mucus, saliva and other material at speeds up to 50 miles per hour! When you sneeze, as many as 40,000 droplets are expelled at speeds over 200 miles per hour. They can travel over 8 feet and up to 20 feet into the air, high enough to get into ventilation systems.

This is why a good air purifier is so important, especially during cold and flu season. Clean air is the first step to good health, and with the OxyPure, you will know your air is pure and healthy.

[www.livescience.com/3686-gross-science-cough-sneeze.html](http://www.livescience.com/3686-gross-science-cough-sneeze.html)  
[www.self.com/story/germs-sneezing-coughing](http://www.self.com/story/germs-sneezing-coughing)

# POLLUTANT REMOVAL

## Volatile Organic Compounds

Formaldehyde is a colorless, strong-smelling gas that belongs to a family of chemicals called Volatile Organic Compounds (VOCs). Most people think of it as a preservative for medical specimens and mortuary work, but it is also used in a variety of other ways, such as making particleboard, plywood, and fiberboard; glues and adhesives; permanent-press fabrics; paper product coatings; and some insulation materials. It is also used to make other chemicals and as a preservative in certain foods, antiseptics, medicines, and cosmetics.

The main way people are exposed to formaldehyde is by inhaling it. In liquid form it can be absorbed through the skin. People can also be exposed to small amounts by eating foods or drinking liquids containing formaldehyde.

Exposure to relatively high amounts of formaldehyde in medical and workplace settings has been linked to some types of cancer in humans, but the effect of exposure to small amounts is less clear. Studies of exposure to formaldehyde in the workplace have also found a possible link to cancer of the nasal sinuses.

At present, the limit is at 0.70 parts per million (ppm) on average over an 8 hour workday. The highest concentration that a worker can be exposed to is 2 ppm, and that can only occur over 15 minutes.

A carbon filter that absorbs the VOC molecules, such as the one on the OxyPure, is the preferred way to deal with VOCs.

<https://www.cancer.org/cancer/cancer-causes/formaldehyde.html>

## Airborne Virus Elimination Rate

Viruses can stay in the air on floating particles or droplets from coughs and sneezes, or carried in from outside. The OxyPure easily removes these pathogens, helping to protect you and your family.

Influenza A H3N2 is a variant of the 2009 H1N1 pandemic virus. It was first identified in pigs in 2010 and then in people in July 2011. Also known as swine influenza, outbreaks occur during the late fall and winter months with symptoms such as fever/chills, cough, sore throat, runny or stuffy nose, muscle/body aches, headaches, fatigue, and vomiting and diarrhea (primarily in children).

<https://www.cdc.gov/flu/swineflu/variant-flu-in-humans.htm>

Test Parameters	Test Number	Removal Rate
Pathogen: H3N2 Influenza A Host Cell: MDCK Action Time: 1 Hour Chamber: 10m <sup>2</sup>	1	>99.99%
	2	>99.99%
	3	>99.99%

## Airborne Bacteria and Mold Elimination Rates

Bacteria can stay in the air on floating particles or droplets from coughs and sneezes, or carried in from outside. The OxyPure easily removes these pathogens, helping to protect you and your family.

*Staphylococcus epidermidis* (*S. epidermidis*), is a round-shaped, bacteria primarily found on the skin, where it can cause skin conditions such as Acne Vulgaris. However, it is also a major cause of medical implant infections, especially in peripheral and central intravenous catheters, inflammation of the chest cavity (Mediastinitis) and bacterial blood infections (Bacteremia).

<https://www.ncbi.nlm.nih.gov/pmc/articles/PMC4184040/>

# POLLUTANT REMOVAL

*Staphylococcus aureus* (*S. aureus*) is a round-shaped bacteria frequently found on the skin and in the throat, nose, and sinuses. It spreads through human-to-human contact, as well as on mucus ejected by sneezing or coughing. It remains viable on surfaces for weeks, making it a common cause of infection. Such infections range from sinusitis and acne to pneumonia, meningitis, osteomyelitis, endocarditis, toxic shock syndrome, bacteremia, sepsis and MRSA in hospitals.

(<https://www.ncbi.nlm.nih.gov/pmc/articles/PMC4451395/>)

*Escherichia coli* (*E. coli*) is a rod-shaped coliform bacterium normally found in the lower intestines of people and animals. While most strains of *E. coli* are harmless, some cause food poisoning and diarrhea, urinary tract and respiratory infections, and other illnesses.

(<https://www.cdc.gov/ecoli/general/index.html>)

*Aspergillus niger* (*A. niger*) is one of fifteen black-spored strains of the Aspergillus mold. Indoors it is often mistaken for the very harmful *Stachybotrys*. The spores can become airborne, where they can be inhaled. For those with compromised immune systems, this can cause sinus and lung infections called Aspergillosis, with symptoms including fever, wheezing, shortness of breath, and cough.

(<https://www.cdc.gov/fungal/diseases/aspergillosis/symptoms.html>)

Test Parameters	Action Time (hours)	Sterilization Rate
Pathogen: <i>Staphylococcus aureus</i> # of Tests: 3 Chamber: 30m <sup>3</sup>	2	>99.98%
Pathogen: <i>Staphylococcus albus</i> # of Tests: 3 Chamber: 30m <sup>3</sup>	2	>99.98%
Pathogen: <i>Escherichia coli</i> # of Tests: 3 Chamber: 30m <sup>3</sup>	2	>99.98%
Pathogen: <i>Aspergillus niger</i> # of Tests: 3 Chamber: 30m <sup>3</sup>	2	>99.98%

All tests were performed by Intertek Labs. For full test reports, visit [nuwavenow.com/tests](http://nuwavenow.com/tests).

## Pollutants in the Air

The air you breathe can be carrying more than dust motes dancing in sunbeams and Uncle Al's cigar smoke. Take a look:

Size (µm)	Particles and Pathogens
10	Fertilizer, Pollen, Plant and Flower Allergens, Mold Spores, and Dust Mites
4	Iron Dust, Textile Dust, Fiberglass Installation, and Tobacco Smoke
3	Cement Dust, Burning Wood, and Mold Spores
2.5	Combustion Related, Motor Vehicles, and Industrial Emissions
2	Lead Dust, Carbon Black Dust, Spores, and Asbestos
1	Fiber Glass, Coal Dust, Anthrax, and Auto and Car Emissions
0.5	Talcum Dust and Copier Toner
0.2	Bacteria, Carbon Black Dust, Insecticide Dust, Burning Wood Smoke, and Coal Flue Gas
0.1	Paint Pigments, Clay, Lead and Radioactive Fallout
0.09	Viruses and Atmospheric Dust

## Gases, VOCs, and Fumes

Pollutant	Examples
ODORS	Household Fumes, Smoke, and Cooking Odors
VOCS	Formaldehyde and Benzene from Carpets, Flooring, Furniture, Glues, and Cleansers.
FUMES	Nitrogen Dioxide from Gas Stoves and Car Exhausts
OZONE	Pollutants Emitted by Power Plants, Oil Refineries, and Chemical Plants

### Questions about your OxyPure?

Contact our friendly customer service staff from 7:30am to 4:30pm, CST Monday through Friday at 877-689-2838 or reach us via email anytime at [help@nuwavenow.com](mailto:help@nuwavenow.com).

# LIMITED WARRANTY

## THE MANUFACTURER WARRANTIES

The OxyPure HEPA 300 Air Purifier, including the motor, filter access lid, filter holder, non-skid feet, are to be free from manufacturer defects for 1 year from the date of purchase, under normal household use, and when operated in accordance with the Manufacturer's written instructions. The Limited Warranty covers the Original Purchaser only. The Manufacturer will provide the necessary parts and labor to repair any part of the OxyPure HEPA 300 Air Purifier at the NuWave LLC Service Department. After the expiration of the warranty, the cost of the labor and parts will be the responsibility of the owner.

## THE WARRANTY DOES NOT COVER

The Limited Warranty is voided if repairs are made by an unauthorized dealer, or the serial number data plate is removed or defaced. Normal deterioration of finish due to use or exposure is not covered by this Warranty. This Limited Warranty does not cover failure, damages, or inadequate performance due to accident, acts of God (such as lightning), fluctuations in electric power, alterations, abuse, misuse, misapplications, corrosive-type atmospheres, improper installation, failure to operate in accordance with the Manufacturer's written instructions, abnormal use, commercial or rental uses, or resold units. NuWave LLC reserves the right to void the Limited Warranty, where allowable by law, for products purchased from an unauthorized dealer.

## TO OBTAIN SERVICE

The owner shall have the obligation and responsibility to pay for all services and parts not covered by the warranty; prepay the freight to and from Service Department for any part or system returned under this warranty; and carefully package the product using adequate padding material to prevent damage in transit. The original container is ideal for this purpose. Include in the package the owner's name, address, daytime telephone number, a detailed description of the problem, and your Return Goods Authorization (RGA) number. Call 1-877-689-2838 or email [help@nuwavenow.com](mailto:help@nuwavenow.com) to obtain the RGA number. Provide the cooking system model & serial number and proof of date of purchase (a copy of the receipt) when making claims under this warranty.

## MANUFACTURER'S OBLIGATION

The Manufacturer's obligation under this Limited Warranty is limited, to the extent allowable by law, to repairing or replacing any part covered by this Limited Warranty which upon examination is found to be defective under normal use. The Limited Warranty is applicable only within the continental United States and only to the original purchaser of the manufacturer's authorized channels of distribution. **THE LIMITED WARRANTY MAY NOT BE ALTERED, VARIED OR EXTENDED EXCEPT BY A WRITTEN INSTRUMENT EXECUTED BY THE MANUFACTURER. THE REMEDY OF REPAIR OR REPLACEMENT AS PROVIDED UNDER THIS LIMITED WARRANTY IS EXCLUSIVE. IN NO EVENT SHALL THE MANUFACTURER BE LIABLE FOR ANY CONSEQUENTIAL OR INCIDENTAL DAMAGES TO ANY PERSON, WHETHER OR NOT OCCASIONED BY NEGLIGENCE OF THE MANUFACTURER, INCLUDING WITHOUT LIMITATION, DAMAGES FOR LOSS OF USE, COSTS OF SUBSTITUTION, PROPERTY DAMAGE, OR OTHER MONEY LOSS.**

# LIMITED WARRANTY

Some states do not allow the exclusion or limitation of incidental or consequential damages, so the above limitation exclusions may not apply. This Limited Warranty gives specific legal rights, and there may also be other rights which vary from state to state. **EXCEPT AS OTHERWISE EXPRESSLY PROVIDED ABOVE, THE MANUFACTURER MAKES NO WARRANTIES EXPRESSED OR IMPLIED ARISING BY LAW OR OTHERWISE, INCLUDING WITHOUT LIMITATION, THE IMPLIED WARRANTIES OF MERCHANTABILITY AND FITNESS FOR A PARTICULAR PURPOSE TO ANY OTHER PERSON. READ YOUR OWNER'S MANUAL. IF YOU STILL HAVE ANY QUESTIONS ABOUT OPERATION OR WARRANTY OF THE PRODUCT, PLEASE CONTACT NUWAVE LLC.**

## DISPUTE RESOLUTION PROCEDURE

For disputes relating to use of the website or use or purchase of a NuWave product or service (collectively "Disputes"), you agree to first contact NuWave LLC at (877) 689-2838, or [legal@nuwavenow.com](mailto:legal@nuwavenow.com). If we cannot resolve your dispute informally, any and all disputes shall be submitted to final and binding arbitration. You may start the arbitration process by submitting in writing a demand to the American Arbitration Association ("AAA") and sending a copy to NuWave. NuWave will pay all filing costs. A single arbitrator of the AAA will conduct the arbitration in a location convenient to you or by phone. The arbitrator's award will be binding and may be entered as a judgment in a court of competent jurisdiction. The arbitration will be conducted in accordance with the provisions of AAA's Commercial Arbitration Rules and Mediation Procedures in effect at the time of submission of your demand for arbitration. See [https://www.adr.org/sites/default/files/CommercialRules\\_Web.pdf](https://www.adr.org/sites/default/files/CommercialRules_Web.pdf). Except as may be required by law as determined by an arbitrator, no party or arbitrator may disclose the existence, content, or results of any arbitration hereunder without prior written consent of both parties.

**A. WAIVER OF RIGHT TO SUE.** By agreeing to arbitration, you understand that, to the maximum extent permitted by law, you are agreeing to waive your right to file suit in any court, to a court hearing, a judge trial, or a jury trial.

**B. CLASS ACTION WAIVER.** To the maximum extent permitted by law, you expressly agree to refrain from bringing or joining any claims in any representative or class-wide capacity, including but not limited to, bringing or joining any claims in any class action or class-wide arbitration.

**C. OPT OUT PROCEDURE.** To request to opt out of arbitration you must contact NuWave LLC at 1-877-689-2838 (Mon–Fri 7:30am–4:30pm CST), or email [help@nuwavenow.com](mailto:help@nuwavenow.com). You will have 30 days from the date of product delivery to opt out of arbitration with respect to any dispute arising out of or relating to use or purchase of any NuWave product. If more than 30 days have passed, you are not eligible to opt out of arbitration and will have waived your right to sue or participate in a class action with respect to the dispute arising out of your purchase or use of a NuWave product. For any dispute arising out of your use of NuWave's website, you have 30 days from the date you provided information to the website to opt out of arbitration. If more than 30 days have passed, you are not eligible to opt out of arbitration and you will have waived your right to sue and participate in a class action with respect to the dispute arising out of your use of NuWave's website.

# LIMITED WARRANTY

**D. SOME MATTERS ARE NOT SUBJECT TO ARBITRATION.** Notwithstanding the foregoing, the following shall not be subject to arbitration and may be adjudicated only in the state and federal courts of Illinois: (i) any dispute, controversy, or claim relating to or contesting the validity of our intellectual property rights and proprietary rights, including without limitation, patents, trademarks, service marks, copyrights, or trade secrets; (ii) an action by a party for temporary, preliminary, or permanent injunctive relief, whether prohibitive or mandatory, or other provisional relief; or (iii) interactions with governmental and regulatory authorities. You expressly agree to refrain from bringing or joining any claims in any representative or class-wide capacity, including but not limited to, bringing or joining any claims in any class action or any class-wide arbitration.

---

## STATE OF CALIFORNIA PROPOSITION 65

### **WARNING**

This product can expose you to chemicals including lead, which is known to the State of California to cause cancer, and Bisphenol A (BPA) and lead, which are known to the State of California to cause birth defects or other reproductive harm.

For more information go to: [www.P65Warnings.ca.gov](http://www.P65Warnings.ca.gov).

### **ADVERTENCIA**

Este producto puede exponerle a químicos, incluidos el plomo, el cual es conocido en el Estado de California por causar cáncer y Bisfenol A (BPA) y plomo, los cuales son conocidos en el Estado de California por causar defectos de nacimiento u otros daños reproductivos.

Para mayor información, visite: [www.P65Warnings.ca.gov](http://www.P65Warnings.ca.gov).

## READ YOUR OWNER'S MANUAL

If you still have any questions about operation or warranty of this product, please contact NuWave LLC at 1-877-689-2838 (Mon–Fri 7:30am–4:30pm CST), or email [help@nuwavenow.com](mailto:help@nuwavenow.com).

**300**  
SQ.FT.

# nuwave®

---

## OXPURE HEPA AIR PURIFIER

**FOR HOUSEHOLD USE ONLY**

DC12V, 1.0A, 12 Watts

Model: 47501 / 47502

*Para la versión en español de este manual,  
visita [www.nuwavenow.com](http://www.nuwavenow.com).*

**For patent information please go to:**

[www.nuwavenow.com/legal/patent](http://www.nuwavenow.com/legal/patent)

**Designed & Developed in USA**

NuWave LLC

560 Bunker Ct.

Vernon Hills, IL 60061, U.S.A.

Tel: 1-877-689-2838

Mon - Fri 7:30 am to 4:30 pm (CST)

Email: [help@nuwavenow.com](mailto:help@nuwavenow.com)

Made in China

©2022 • NuWave, NuWaveNow, and OxyPure are registered  
trademarks of NuWave LLC • All Rights Reserved.

BM47501 / BM47502

Rev.01-CB

09-07-22