

nuwave®

OXPURE HEPA 300 AIR PURIFIER



Owner's Manual

**Model 47501 / 47502
Rev.1**

Questions or Concerns?

For Amazon Purchases: support@nuwavenow.com

For All Other Purchases: help@nuwavenow.com

THANK YOU!

Congratulations on your NuWave® purchase. We know there are many options available and sincerely appreciate the trust you have placed in us.

For the last 30 years, we have committed to introducing products that promote healthy living at affordable prices. By combining the highest quality designs with cutting edge technology, we have always strived to blend feature, function, and innovation into every product we make. We hope you will agree.

We would love to hear from you. Please feel free to reach out with any feedback or comments that could improve your experience. We would also enjoy hearing about your successes.

The best way to reach us is by email:

For Amazon Purchases: support@nuwavenow.com

For All Other Purchases: help@nuwavenow.com

For Amazon Purchases



support@nuwavenow.com

For All Other Purchases



help@nuwavenow.com

Scan to Register



nuwavenow.com/register

Register Today!

Protecting your investment is easy and rewarding. Simply scan the QR code or visit nuwavenow.com/register to register. When you register, simply opt in for an additional year of warranty. Don't worry. There is no catch. We are extending it absolutely FREE to show our appreciation!

Connect with Us!



#nuwavenow

Visit nuwavenow.com to see other great products and accessories.

TABLE OF CONTENTS

| | |
|------------------------------|-------|
| Important Safeguards..... | 4–5 |
| Electrical Information..... | 5 |
| Parts & Accessories..... | 6 |
| Assembly..... | 7 |
| Control Panel..... | 8 |
| Maintaining the OxyPure..... | 9-10 |
| Troubleshooting..... | 10 |
| Limited Warranty..... | 11–13 |

Para la versión en español de este manual, visita www.nuwavenow.com

Meets California ozone
emissions limit.
CARB certified



U.S. Environmental
Protection Agency



This equipment has been tested and found to comply with the limits for a Class B digital device, pursuant to part 15 of the FCC Rules. These limits are designed to provide reasonable protection against harmful interference in a residential installation. This equipment generates, uses and can radiate radio frequency energy and, if not installed and used in accordance with the instructions, may cause harmful interference to radio communications. However, there is no guarantee that interference will not occur in a particular installation. If this equipment does cause harmful interference to radio or television reception, which can be determined by turning the equipment off and on, the user is encouraged to try to correct the interference by one or more of the following measures:

- Reorient or relocate the receiving antenna.
- Increase the separation between the equipment and receiver.
- Connect the equipment into an outlet on a circuit different from that to which the receiver is connected.
- Consult the dealer or an experienced radio/TV technician for help.

IMPORTANT SAFEGUARDS

HOUSEHOLD USE ONLY • READ ALL INSTRUCTIONS BEFORE USE

ALWAYS KEEP THIS MANUAL HANDY FOR FUTURE REFERENCE.

READ ALL INSTRUCTIONS and WARNINGS: The failure to follow any of the important safeguards, warnings, or instructions for safe use is a misuse of the OxyPure that can void your warranty and create the risk of serious injury. When using the OxyPure, basic safety precautions should always be followed.

1. ONLY use the OxyPure for its intended purpose.
2. To protect against the risk of electrical shock, **DO NOT** immerse the cord, plug, or any part of the OxyPure in water or any other liquid.
3. Close supervision is necessary when the OxyPure is used by or near children. The OxyPure is not intended for use by children, persons with reduced physical, sensory, or mental capabilities, or those who lack expertise or knowledge of this device.
4. **DO NOT** operate the OxyPure with a damaged cord, plug, after any malfunction, or if the unit has been dropped or damaged in any way. Contact Customer Service.
For Amazon purchases:
support@nuwavenow.com
For All Other Purchases:
help@nuwavenow.com
5. Discard the protective plastic covering the power plug before use.
6. **DO NOT** run the cord under carpeting, throw rugs, runners or other coverings.
7. **DO NOT** route the cord under furniture or appliances. Arrange the cord away from high-traffic areas where it will not be tripped over.
8. **DO NOT** plug the OxyPure into an outlet or power strip that is being used by other appliances.
9. Remove any dust or water from the plug, if needed.
10. **ALWAYS** set up the OxyPure on a flat, stable surface.
11. **DO NOT** set up the OxyPure where it could be pushed, kicked, or tripped over.
12. Leave at least 2-3 feet of space between the OxyPure's vents and any walls.
13. **DO NOT** install the OxyPure near a heating device, flammable or combustible gases or vapors, or in areas exposed to moisture or water.
14. **DO NOT** operate the OxyPure on its side.
15. **DO NOT** place objects on top of the OxyPure.
16. **DO NOT** sit or stand on, or lean against, the OxyPure.
17. Alteration or modification of any part of the OxyPure, or the use of attachments not recommended by the manufacturer, may cause fire, injury, or damage to property.
18. As with most electrical units, electrical parts are live even when the OxyPure is off. Be sure the OxyPure is unplugged when assembling.
19. **DO NOT** use the OxyPure in a factory or industrial setting where machine oil may be present in the air.
20. Turn the power OFF on the OxyPure before unplugging the OxyPure.
21. Unplug the OxyPure from the outlet when the unit is not in use or will be left unattended for an extended period of time; before putting on or taking off

IMPORTANT SAFEGUARDS

HOUSEHOLD USE ONLY • READ ALL INSTRUCTIONS BEFORE USE

parts; when removing or replacing the filter; and before cleaning.

22. **DO NOT** operate the OxyPure if abnormal sounds or motion is detected.
23. If any foreign object comes into contact with the fan, do not operate. Turn off and unplug the OxyPure and then shake the unit to dislodge the foreign object.
24. Inspect the OxyPure for any loose or missing parts before and after each use. If parts are loose, damaged, or missing, contact Customer Service.
For Amazon Purchases:
support@nuwavenow.com
For All Other Purchases:
help@nuwavenow.com
25. **DO NOT** pull, lift, drag, or carry the OxyPure by its cord.
26. **DO NOT** block the air inlet or outlet vents.
27. **DO NOT** operate the OxyPure without the filter.

FILTER CHANGING PRECAUTIONS

1. **DO NOT** try to clean the HEPA/Carbon filter. Doing so will release dust and other pollutants back into the air.
2. **ALWAYS** wear a mask and rubber gloves when handling a dirty filter.
3. When removing a dirty filter, **ALWAYS** do so outside or in a well ventilated area.

4. **ALWAYS** replace your filter with a NuWave filter made for your model of air purifier.

ELECTRICAL INFORMATION

These servicing instructions are for use by qualified personnel only. To reduce the risk of electric shock, do not perform any servicing other than that contained in the operating instructions unless you are qualified to do so.

Power-Supply Cords

A short, detachable power-supply cord is provided to reduce the risk of becoming entangled in, or tripping over a longer cord. Longer detachable power-supply cords or extension cords are available and may be used if care is exercised in their use. If a longer, detachable power-supply cord or extension cord is used:

1. The marked electrical rating of the extension cord should be at least as great as the electrical rating of the appliance.
2. The longer cord should be arranged so that it will not drape over any counter-top or tabletop where it could be pulled on or tripped over unintentionally.
3. The OxyPure should be operated on a separate electrical outlet from other operating appliances due to wattage limitations.

SAVE THESE INSTRUCTIONS

PARTS & ACCESSORIES

- 1 OxyPure HEPA 300 Air Purifier**
Model #: 47501
- 2 Motor**
Part #: H0P4
- 3 Pre-Filter & Filter Holder**
Part #: H0P1
- 4 HEPA/Carbon Filter**
Part #: H0A1
- 5 Filter Access Lid**
Part #: H0P2
- 6 Non-Skid Feet**
Part #: H0P5
- 7 Power Supply**
Part #: H0P3



ORDERING PARTS

Keeping your OxyPure up and running with new filters is a breeze.

Ordering new parts and accessories is quick and easy. Have ready down the name and number for the part you want, then contact Customer Service by emailing:

- **For Amazon Purchases:** support@nuwavenow.com
- **For All Other Purchases:** help@nuwavenow.com

Or order directly online at: www.nuwavenow.com

ASSEMBLY



Remember...

ALWAYS remove the plastic wrapping from the new filter **BEFORE** using it in the OxyPure. Failing to do so may damage the motor and other parts of the OxyPure and may void your warranty.



CONTROL PANEL



One Button Does it All

Simplicity. That is the secret of the OxyPure HEPA 300 Air Purifier. With only one button, it is simple to operate. With its revolutionary HEPA/Carbon filter, it is as easy to relax knowing that your air is as clean as the unit is simple to maintain. With its lightweight design and construction, it is easy to take almost anywhere. Simplicity and peace of mind at the touch of a button.

Fan Speed 1
Low Speed



1. Plug the Power Supply cord into the jack at the back of the OxyPure, and then plug it into a suitable electrical outlet. The unit will beep once.

2. Press the Power icon. The unit will activate at the lowest fan speed. It will beep once and the upper-right LED will light.

Fan Speed 2
Medium Speed



3. Press the Power icon again to increase the fan speed to medium. The unit will beep and the second LED will light.

Fan Speed 3
High Speed



4. Press the Power icon again to increase the fan speed to high. The unit will beep and the third LED will light.

5. Press the Power icon a fourth time and the OxyPure will turn off. The unit will beep and the LEDs will go dark.

| Number of Presses | Fan Speed Level | Bars on Panel | Fan Speed (RPM) |
|-------------------|-----------------|---------------|-----------------|
| 1 | 1 | 1 | 400 |
| 2 | 2 | 2 | 800 |
| 3 | 3 | 3 | 2450 |
| 4 | OFF | 0 | OFF |

View OxyPure® Test and Performance Data” on our website <https://www.nuwavenow.com/shop/oxypure-hepa>

MAINTAINING THE OXYPURE

Changing the HEPA/Carbon Filter



It is important to change the HEPA/Carbon Filter regularly.

Within 6 Months



When the Fan Speed 1 light turns yellow, we suggest replacing your HEPA/Carbon Filter.

After 6 Months



When the Fan Speed 1 light turns red, the HEPA/Carbon Filter has reached the end of its lifespan and must be replaced.

After 12 Months

TURN UNIT UPSIDE DOWN

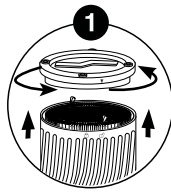

1. Unplug the unit, turn it upside down and open the Filter Access Lid.

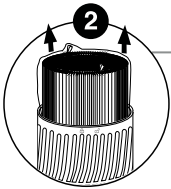

2. Remove the old filter using the attached tabs.

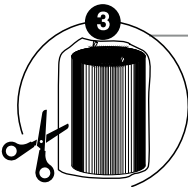

3. Remove the new filter from its packaging. The bag can be used to discard the old filter.

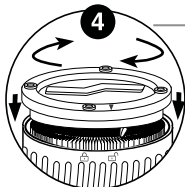

4. Insert the new filter while ensuring the tabs are facing up, then close the Filter Access Lid.

MAINTAINING THE OXYPURE

Cleaning the OxyPure

Depending on the environment, you may need to clean the OxyPure more often to maintain the finish and function of the unit.

- Remove the dirty HEPA/Carbon Filter and place it in a garbage bag.
- Wash the Pre-Filter body of the unit with warm, soapy water, and dry thoroughly before inserting a clean HEPA/Carbon Filter. Alternatively, you can apply a gentle non-abrasive cleaner to a cloth and use the cloth to clean the unit.
- Make sure the vents are free of any obstruction.
- Ensure the OxyPure body is completely dry before reassembling.
- Clean the Motor housing on all sidesides, using the brush attachment for your vacuum cleaner or a damp cloth or sponge. Dry it thoroughly before reassembly.
- **DO NOT** immerse the Motor housing in water.

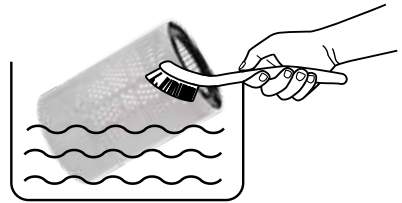

TROUBLESHOOTING GUIDE

The OxyPure Does Not Turn On.

1. The unit is not plugged-in. Plug the unit into an appropriate wall outlet.
2. **POWER** on the control panel is OFF.
Press **POWER**.

The Fan Speed Doesn't Change.

There may be an issue with the control panel button. Contact Customer Service for assistance.

Airflow From the Top Vent is Weak.

The HEPA/Carbon filter is dirty. Change the filter.

The Unit Produces Smoke or Odor.

The HEPA/Carbon filter is dirty. Change the filter.

If any of these problems persist, contact NuWave's friendly and knowledgeable Customer Service by emailing:

For Amazon Purchases: support@nuwavenow.com

For All Other Purchases: help@nuwavenow.com

LIMITED WARRANTY

THE MANUFACTURER WARRANTS

NuWave, LLC warrants that OxyPure HEPA 300 Air Purifier will be free from manufacturer defects for 1 year from the date of purchase, under normal household use, and when operated in accordance with the Manufacturer's written instructions. The Limited Warranty covers the Original Purchaser only. The Manufacturer will provide the necessary parts and labor to repair the product at the NuWave LLC Service Department. After the expiration of the warranty, the cost of the parts and labor will be the responsibility of the owner.

THE WARRANTY DOES NOT COVER

The Limited Warranty is voided if repairs are made by an unauthorized dealer, or the serial number data plate is removed or defaced. Normal deterioration of finish due to use or exposure is not covered by this Warranty. This Limited Warranty does not cover failure, damages, or inadequate performance due to accident, acts of God (such as lightning), fluctuations in electric power; alterations, abuse, misuse, misapplications, corrosive-type atmospheres, improper installation; failure to operate and maintain the unit in accordance with the Manufacturer's written instructions; failure to regularly clean and maintain the unit and reusable filters, and to replace the disposable filters in accordance with the Manufacturer's written instructions; abnormal, commercial, or rental uses; or resold units. NuWave LLC reserves the right to void the Limited Warranty, where allowable by law, for products purchased from an unauthorized dealer.

TO OBTAIN SERVICE

The owner shall have the obligation and responsibility to pay for all services and parts not covered by the warranty; prepay the freight to and from Service Department for any part or system returned under this warranty; and carefully package the product using adequate padding material to prevent damage in transit. The original container is ideal for this purpose. Include in the package the owner's name, address, daytime telephone number, a detailed description of the problem, and RGA (Return Goods authorization number). To obtain the RGA number, email us at:

For Amazon Purchases: support@nuwavenow.com

For All Other Purchases: help@nuwavenow.com

Provide the product model & serial number and proof of date of purchase (a copy of the receipt) when making claims under this warranty.

MANUFACTURER'S OBLIGATION

The Manufacturer's obligation under this Limited Warranty is limited, to the extent allowable by law, to repairing or replacing any part covered by this Limited Warranty which upon examination is found to be defective under normal use. The Limited Warranty is applicable only within the continental United States and only to the original purchaser of the manufacturer's authorized channels of distribution. **THE LIMITED WARRANTY MAY NOT BE ALTERED, VARIED OR EXTENDED EXCEPT BY A WRITTEN INSTRUMENT EXECUTED BY THE MANUFACTURER. THE REMEDY OF REPAIR OR REPLACEMENT AS PROVIDED UNDER THIS LIMITED WARRANTY IS EXCLUSIVE. IN NO EVENT SHALL THE MANUFACTURER BE LIABLE FOR ANY**

LIMITED WARRANTY

CONSEQUENTIAL OR INCIDENTAL DAMAGES TO ANY PERSON, WHETHER OR NOT OCCASIONED BY NEGLIGENCE OF THE MANUFACTURER, INCLUDING WITHOUT LIMITATION, DAMAGES FOR LOSS OF USE, COSTS OF SUBSTITUTION, PROPERTY DAMAGE, OR OTHER MONEY LOSS. WITHOUT LIMITATION, DAMAGES FOR LOSS OF USE, COSTS OF SUBSTITUTION, PROPERTY DAMAGE, OR OTHER MONEY LOSS.

Some states do not allow the exclusion or limitation of incidental or consequential damages, so the above limitation exclusions may not apply. This Limited Warranty gives specific legal rights, and there may also be other rights which vary from state to state.

EXCEPT AS OTHERWISE EXPRESSLY PROVIDED ABOVE, THE MANUFACTURER MAKES NO WARRANTIES EXPRESSED OR IMPLIED ARISING BY LAW OR OTHERWISE, INCLUDING WITHOUT LIMITATION, THE IMPLIED WARRANTIES OF MERCHANTABILITY AND FITNESS FOR A PARTICULAR PURPOSE TO ANY OTHER PERSON. READ YOUR OWNER'S MANUAL. IF YOU STILL HAVE ANY QUESTIONS ABOUT OPERATION OR WARRANTY OF THE PRODUCT, PLEASE CONTACT NUWAVE LLC.

DISPUTE RESOLUTION PROCEDURE

For disputes relating to use of the website or use or purchase of a NuWave product or service (collectively "Disputes"), you agree to first contact NuWave LLC at *legal@nuwavenow.com*. If we cannot resolve your dispute informally, any and all disputes shall be submitted to final and binding arbitration. You may start the arbitration process by submitting in writing a demand to the American Arbitration Association ("AAA") and sending a copy to NuWave. NuWave will pay all filing costs. A single arbitrator of the AAA will conduct the arbitration in a location convenient to you or by phone. The arbitrator's award will be binding and may be entered as a judgment in a court of competent jurisdiction. The arbitration will be conducted in accordance with the provisions of AAA's Commercial Arbitration Rules and Mediation Procedures in effect at the time of submission of your demand for arbitration. See https://www.adr.org/sites/default/files/CommercialRules_Web.pdf. Except as may be required by law as determined by an arbitrator, no party or arbitrator may disclose the existence, content, or results of any arbitration hereunder without prior written consent of both parties

- A. WAIVER OF RIGHT TO SUE.** By agreeing to arbitration, you understand that, to the maximum extent permitted by law, you are agreeing to waive your right to file suit in any court, to a court hearing, a judge trial, or a jury trial.
- B. CLASS ACTION WAIVER.** To the maximum extent permitted by law, you expressly agree to refrain from bringing or joining any claims in any representative or class-wide capacity, including but not limited to, bringing or joining any claims in any class action or class-wide arbitration.

LIMITED WARRANTY

C. OPT OUT PROCEDURE. To request to opt out of arbitration you must contact NuWave LLC at legal@nuwavenow.com, NuWave LLC, 560 Bunker Ct., Vernon Hills, IL 60061, U.S.A. You will have thirty (30) days from the date of product delivery to opt out of arbitration with respect to any dispute arising out of or relating to use or purchase of any NuWave product. If more than 30 days have passed, you are not eligible to opt out of arbitration and will have waived your right to sue or participate in a class action with respect to the dispute arising out of your purchase or use of a NuWave product. For any dispute arising out of your use of NuWave's website, you have thirty (30) days from the date you provided information to the website to opt out of arbitration. If more than 30 days have passed, you are not eligible to opt out of arbitration and you will have waived your right to sue and participate in a class action with respect to the dispute arising out of your use of NuWave's website.

D. SOME MATTERS ARE NOT SUBJECT TO ARBITRATION. Notwithstanding the foregoing, the following shall not be subject to arbitration and may be adjudicated only in the state and federal courts of Illinois: (i) any dispute, controversy, or claim relating to or contesting the validity of our intellectual property rights and proprietary rights, including without limitation, patents, trademarks, service marks, copyrights, or trade secrets; (ii) an action by a party for temporary, preliminary, or permanent injunctive relief, whether prohibitive or mandatory, or other provisional relief; or (iii) interactions with governmental and regulatory authorities. You expressly agree to refrain from bringing or joining any claims in any representative or class-wide capacity, including but not limited to, bringing or joining any claims in any class action or any class-wide arbitration.

STATE OF CALIFORNIA PROPOSITION 65

WARNING

This product can expose you to chemicals including lead, which is known to the State of California to cause cancer, and Bisphenol A (BPA) and lead, which are known to the State of California to cause birth defects or other reproductive harm.

For more information go to: www.P65Warnings.ca.gov.

ADVERTENCIA

Este producto puede exponerle a químicos, incluido el plomo, el cual es conocido en el Estado de California por causar cáncer y Bisphenol A (BPA) y plomo, los cuales son conocidos en el Estado de California por causar defectos de nacimiento u otros daños reproductivos.

Para mayor información, visite: www.P65Warnings.ca.gov.

READ YOUR OWNER'S MANUAL

If you still have any questions about operation or warranty of this product, please contact NuWave LLC:

For Amazon Purchases: support@nuwavenow.com

For All Other Purchases: help@nuwavenow.com

OxyPure Air Purifiers



OxyPure®
Smart Air Purifier
Model #: 47001



E1000
OxyPure® ZERO™
Air Purifier
Model #: 47251



E500
OxyPure® ZERO™
Air Purifier
Model #: 47351



OxyPure Portable HEPA 500
Air Purifier
Model #: 47401



OxyPure HEPA 300
Air Purifier
Model #: 47501

Visit www.nuwavenow.com
to see our other NuWave products and accessories.

nuwave®

OXPURE HEPA 300 AIR PURIFIER

FOR HOUSEHOLD USE ONLY

DC 12V, 1.0A, 12 WATTS

Model: 47501 / 47502

*Para la versión en español de este manual,
visita www.nuwavenow.com.*

For patent information please go to:

www.nuwavenow.com/legal/patent

Designed & Developed in USA

NuWave LLC

560 Bunker Ct.

Vernon Hills, IL 60061, U.S.A.

Email:

For Amazon Purchases: support@nuwavenow.com

For All Other Purchases: help@nuwavenow.com

Made in China

©2023 NuWave LLC • All Rights Reserved.

EPA Establishment Number: 101594-CHN-1

Item No: BM47501 / BM47502

Rev.1-V4-JD

08-08-23