



570 CHLORIDE TEST PROCEDURE

The 570 Chloride test procedure utilizes the **STANDARD STRIP METHOD** using the eExact iDip® 570 Smart Photometer System®. For tips on achieving best accuracy, and additional information regarding features of the eExact iDip® 570 photometer and the eExact iDip® app, please refer to the eExact iDip® Smart Guide. You can download a copy on our website at exactidip.com. **Test procedures can vary from test to test. Read full instructions and watch instructional video within the app.**

YOU WILL NEED

- eExact iDip® 570 photometer
- Your smartphone/tablet with the eExact iDip® app installed and 570 Chloride CH test purchased in the Store
- (1) eExact® Strip Micro Chloride (Part No. 486757)
- Water sample for rinsing and testing

1 SELECT CUSTOMER

- Select '**Customers**' from the Home screen.
- Choose customer from list
OR Tap '**Add customer from contacts**' and choose customer from your contacts list
OR Tap '+' to create a new customer
- Android users: If no address is found, tap "No addresses found"

c. Verify customer has been selected

Note: To take full advantage of the GPS and Data Storage features, each test result must be linked to a contact. Individual users may select their contact listing.

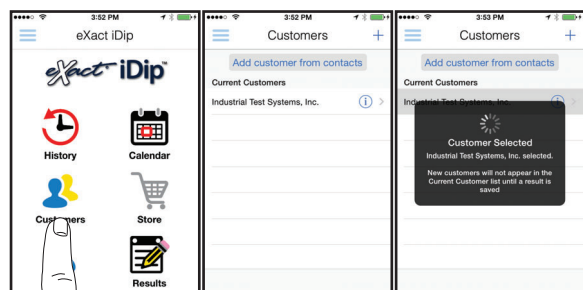

a

b

c

4 CONNECT EXACT IDIP® 570

The eExact iDip® app will automatically connect to the most recently used eExact iDip® 570 photometer. If not, select your eExact iDip® 570 from the bottom of the screen.

Note: Always connect your eExact iDip® photometer via the Bluetooth® connection within the app. If you experience an issue connecting your device, check that your smartphone/tablet's Bluetooth® is turned on and your device is compatible.

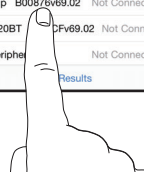
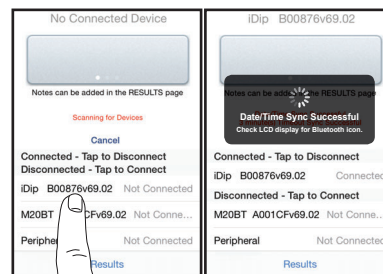

5 SELECT TEST

Tap '**SELECT** Test' at the top and select **570 Chloride CH** (if this is not visible, purchase the test from the Store). The eExact iDip® 570 photometer and eExact iDip® app will both display the test selection for Chloride.

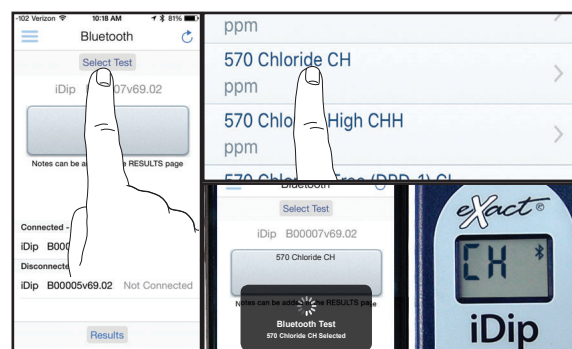

6 FILL CELL

Before testing, rinse CELL and clean with brush thoroughly. Finally, rinse the cell 3 times with the water sample to be tested, then **FILL** cell to capacity to begin test (refer to video in app).



7 CAP CELL AND ZERO METER

Place the Cell Cover onto the CELL and press **ZERO/OFF** and the eXact iDip® 570 photometer display reads 0_{PPM} indicating the meter is ready for testing.



8 REMOVE STRIP

Remove one eXact® Strip Micro Chloride (Part No. 486757) and set in a dry, convenient place. Immediately replace cap on bottle.



9 DIP STRIP

Press **READ** to initiate a 20 second countdown and simultaneously **DIP** the eXact® strip in the sample, gently touching the bottom of the cell. Use a gentle constant back and forth motion (2 strokes per second) until the timer displays "1". Remove and discard the strip.



10 CAP CELL AND READ RESULTS

Place the Cell Cover onto the CELL and **READ** result displayed as Chloride.

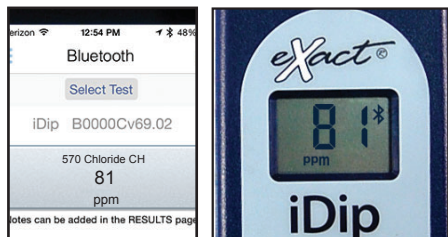

11 CLEAN CELL WITH BRUSH

After testing, rinse CELL immediately and clean with brush to remove reagents which coat the CELL wall.



TIPS

- Due to the manufacturing process, you may find one or two strips that are noticeably smaller or larger in width than the normal strips in the bottle. These should be discarded. Using these strips may give unreliable results.
- Before running test unlock 570 Chloride test by purchasing in the Store.
- If sample pH is high (>9), adjust pH to 5–6 using vinegar.
- To obtain optimal accuracy when testing in direct sunlight, use the Cell Cover when zeroing and reading the sample.
- It is recommended to use the Cell Cleaning Brush with water to clean the CELL after each test to remove reagents which coat the CELL wall.
- Be careful while dipping the strip (step 9). Do not spill the sample from the CELL.
- If result reads "HI" use Mini Dilution Kit II (Part #487202) to perform a 1:20 dilution of the sample with distilled or deionized water. Then multiply the final result by 20. Alternatively, you can unlock the 570 Chloride High test by purchasing in the Store and follow the instructions provided.

MANAGE YOUR RESULTS

Save, send, and share results instantly using the eXact iDip® app. For step-by-step instructions, refer to the eXact iDip® Smart Guide. You can download a pdf copy on-line at exactidip.com.

