

# BLK BOX

## WALL MOUNTED DOUBLE WALL BALL TARGET

21-0208-0C

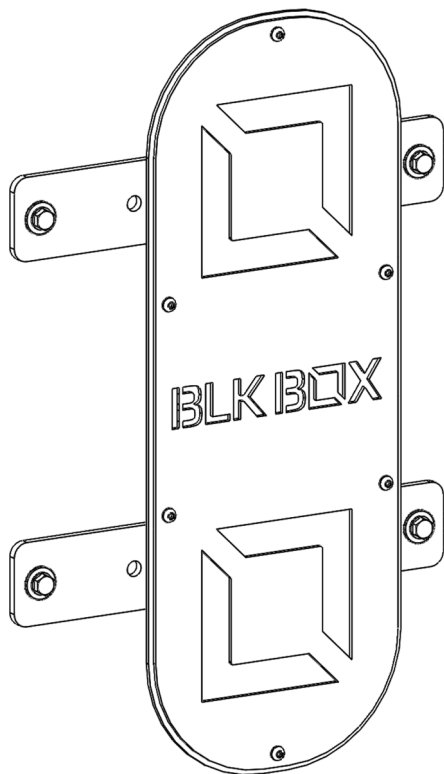

### OWNERS MANUAL & QUICK START GUIDE

NOTE : PLEASE READ ALL THE INSTRUCTIONS CAREFULLY BEFORE ASSEMBLING THIS PRODUCT.

### PRODUCT SPECIFICATION

PRODUCT WEIGHT	-	6.7kg
DIMENSIONS	-	72mm x 340mm x 540mm

# WARNING

SERIOUS OR FATAL INJURIES MAY OCCUR FROM INCORRECTLY ASSEMBLED EQUIPMENT. ALWAYS ENSURE BOLTS ARE TIGHTENED CORRECTLY AND ALL PARTS ARE LEVEL AND PLUMB. TO FURTHER REDUCE RISK OF INJURIES OR DEATH PLEASE USE OUR SUGGESTED TOOLS AND PERSONAL PROTECTIVE EQUIPMENT (PPE). WE SUGGEST THAT A MINIMUM OF THREE PEOPLE ARE INVOLVED IN THE ASSEMBLY OF THIS PRODUCT. EACH PERSON SHOULD BE EQUIPPED WITH SAFETY GLASSES, STEEL TOE CAP BOOTS AND EAR PLUGS.

THIS SYMBOL IS AN INDICATION OF THE RECOMMENDED TORQUE EACH BOLT SHOULD BE TIGHTENED TO. THIS VALUE WILL BE DEPENDENT ON THE BOLT TYPE. PLEASE HAND TIGHTEN ALL BOLTS UNTIL YOU SEE THIS SYMBOL.



## TOOLS REQUIRED

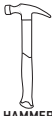

HAMMER



17MM SPANNER X2



VACUUM



TAPE MEASURE



HAMMER DRILL



10MM MASONRY DRILL BIT



STEP LADDER

No.	Name	SKU	QTY
1	WALL BALL TARGET	21-0224-0A	2
2	M10X80 SLEEVE ANCHOR	10-0031	4
3	M10 FLAT WASHER	10-0019	4

## PARTS & ATTACHMENTS

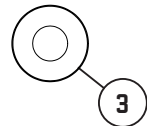
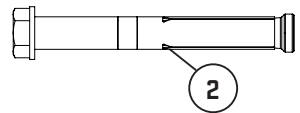
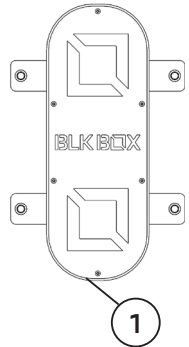

# INSTALLATION

1

MARK DRILLING LOCATIONS USING THE GUIDE BELOW. THE ADVISED HEIGHTS WILL ENSURE TARGET IS MOUNTED THAT THE TOP WALL BALL TARGET IS 10 FOOT HIGH, AND THE BOTTOM ONE IS 9 FOOT. HOLES ARE SPACED 300 MM APART.

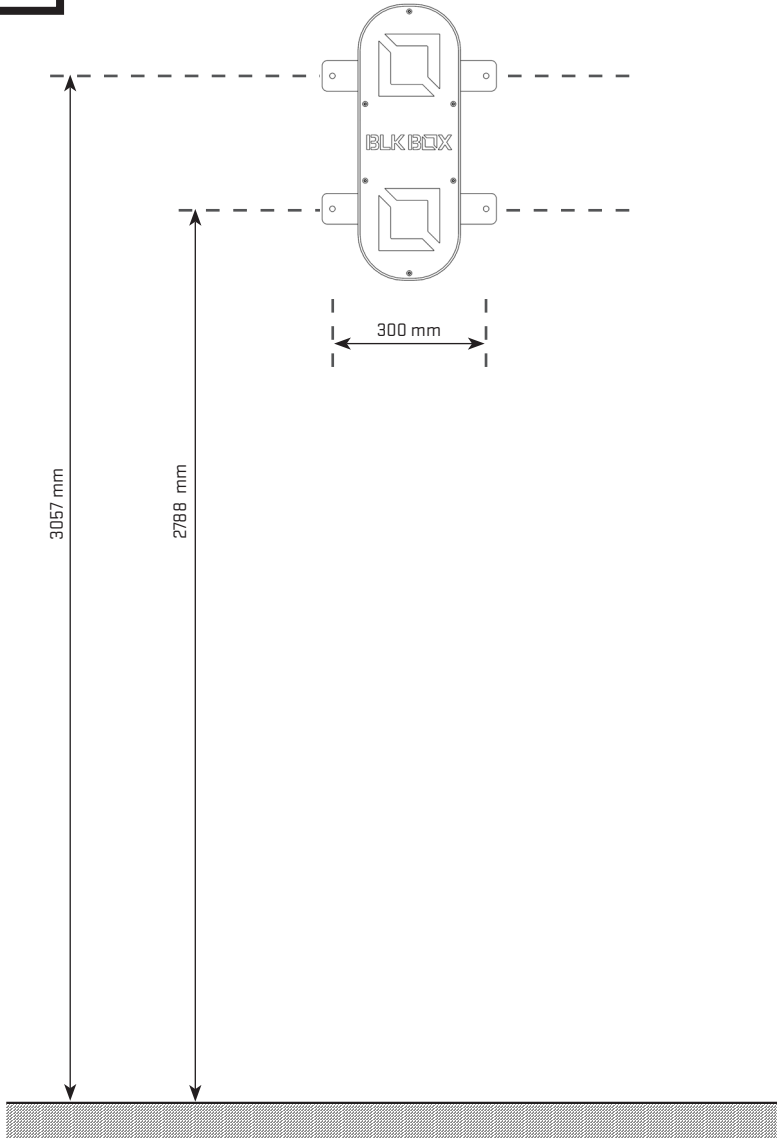

2

BOLT 10TY WALL BALL TARGET (21-0224-0A) TO THE WALL USING 4QTY SLEEVE ANCHOR BOLTS (10-0031) AND 4QTY M10 WASHERS (10-0019) DRILL HOLES AND MOUNT USING GUIDE AS SHOWN BELOW, TIGHTEN TO SPECIFIED TORQUE.

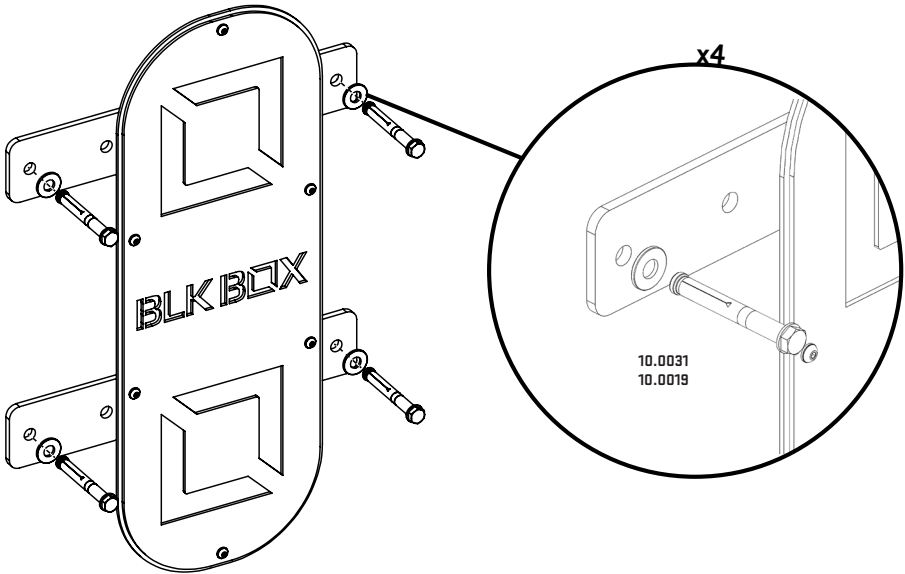

- DRILL 10MM HOLE IN WALL, 90MM DEEP USING PLATE AS A GUIDE.
- VACUUM OUT THE DUST.
- HAMMER SLEEVE ANCHOR INTO THE HOLE.
- TIGHTEN SLEEVE ANCHOR TO SPECIFIED TORQUE USING 13MM SPANNER.

SLEEVE ANCHOR BOLT FITTING

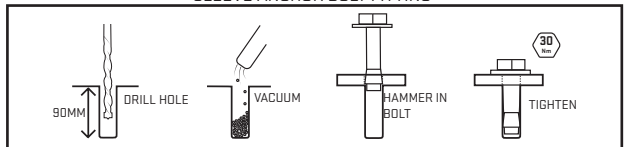

# 1:1 SCALE FASTENERS

M10x80 SLEEVE ANCHOR  
10-0031

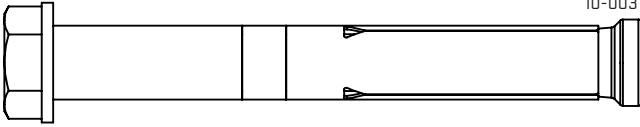

M10 FLAT WASHER  
10-0019

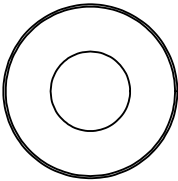

FOR TERMS AND CONDITIONS VISIT OUR WEBSITE AT  
[www.blkboxfitness.com/pages/terms-conditions](http://www.blkboxfitness.com/pages/terms-conditions)

GET IN TOUCH  
TEL: 028 9045 4123  
EMAIL: [info@blkboxfitness.com](mailto:info@blkboxfitness.com)

DISCOVER MORE AT:  
[www.blkboxfitness.com](http://www.blkboxfitness.com)