

BLK BOX

UTILITY FREE STANDING POWER RACK

21-0741

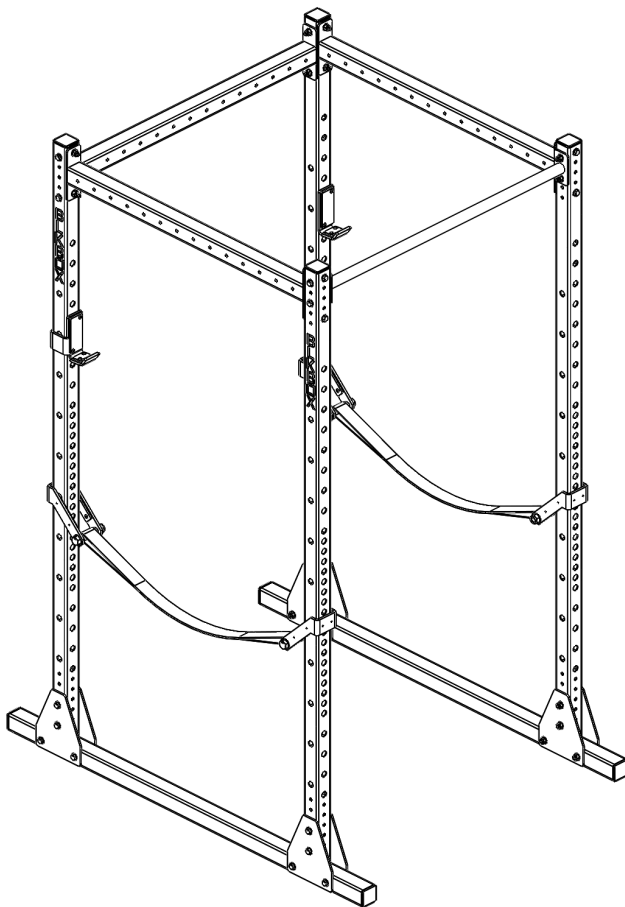

PRODUCT SPECIFICATION

| | | |
|---------------------|---|--------------------------|
| PRODUCT WEIGHT | - | 105kg |
| MAX USER WEIGHT | - | 125kg |
| MAX USER | - | 1 |
| MAX TRAINING WEIGHT | - | 300kg |
| DIMENSIONS | - | 1612mm x 2260mm x 1123mm |
| SAFE WORKING ZONE | - | 2000mm x 2400mm x 2700mm |

OWNERS MANUAL & QUICK START GUIDE

NOTE : PLEASE READ ALL THE INSTRUCTIONS CAREFULLY BEFORE ASSEMBLING THIS PRODUCT.

WARNING

SERIOUS OR FATAL INJURIES MAY OCCUR FROM INCORRECTLY ASSEMBLED EQUIPMENT. ALWAYS ENSURE BOLTS ARE TIGHTENED CORRECTLY AND ALL PARTS ARE LEVEL AND PLUMB. TO FURTHER REDUCE RISK OF INJURIES OR DEATH PLEASE USE OUR SUGGESTED TOOLS AND PERSONAL PROTECTIVE EQUIPMENT (PPE). WE SUGGEST THAT A MINIMUM OF THREE PEOPLE ARE INVOLVED IN THE ASSEMBLY OF THIS PRODUCT. EACH PERSON SHOULD BE EQUIPPED WITH SAFETY GLASSES, STEEL TOE CAP BOOTS AND EAR PLUGS.

PLEASE BE AWARE OF THIS SYMBOL AS AN INDICATION TO CHECK THAT A PART IS LEVEL OR PLUMB.



THIS SYMBOL IS AN INDICATION OF THE RECOMMENDED TORQUE EACH BOLT SHOULD BE TIGHTENED TO. THIS VALUE WILL BE DEPENDENT ON THE BOLT TYPE. PLEASE HAND TIGHTEN ALL BOLTS UNTIL YOU SEE THIS SYMBOL.



TOOLS REQUIRED



17MM SPANNER X2



STEP LADDER

PARTS & ATTACHMENTS

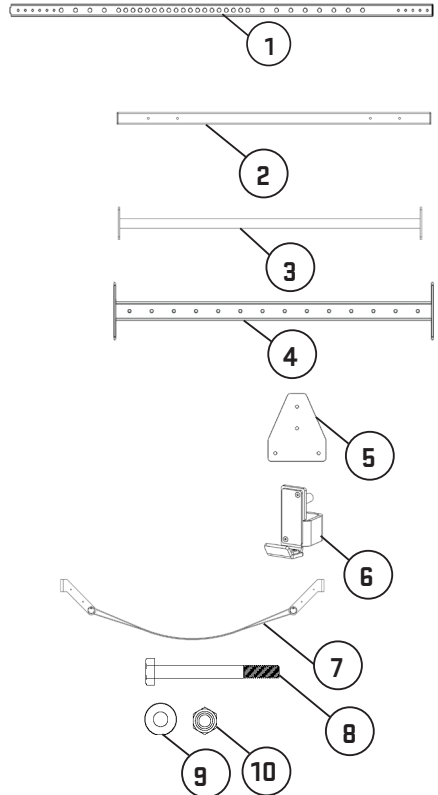

| No. | Name | SKU | QTY |
|-----|-----------------------------------|---------|-----|
| 1 | 2.2 GOLIATH FS POWER RACK UPRIGHT | 21-0740 | 4 |
| 2 | GOLIATH FS POWER RACK BASE | 21-0742 | 2 |
| 3 | 1.2 SINGLE BAR CM DNA60 | 21-0015 | 1 |
| 4 | 1.2 BOX CM DNA60 | 21-0013 | 3 |
| 5 | GOLIATH BRACE PLATE | 21-0472 | 8 |
| 6 | J-HOOK PAIR | 16-0001 | 1 |
| 7 | GOLIATH SAFETY STRAPS | 16-0258 | 1 |
| 8 | M10X90 BOLT | 10-0008 | 32 |
| 9 | M10 FLAT WASHER | 10-0019 | 64 |
| 10 | M10 NYLOCK NUT | 10-0024 | 32 |

ASSEMBLY

1

INSERT 2QTY UPRIGHT (21-0740) INTO SLOTS IN 1QTY POWER RACK BASE (21-0742) PLACE 1QTY BRACE PLATE EITHER SIDE OF EACH UPRIGHT ATTACH WITH BOLT ASSEMBLY AS SHOWN. BOLT 1QTY 1.2 BOX CM (21-0013) TO 2QTY UPRIGHT (21-0740) WITH BOLT ASSEMBLY SHOWN.
REPEAT ABOVE STEP.

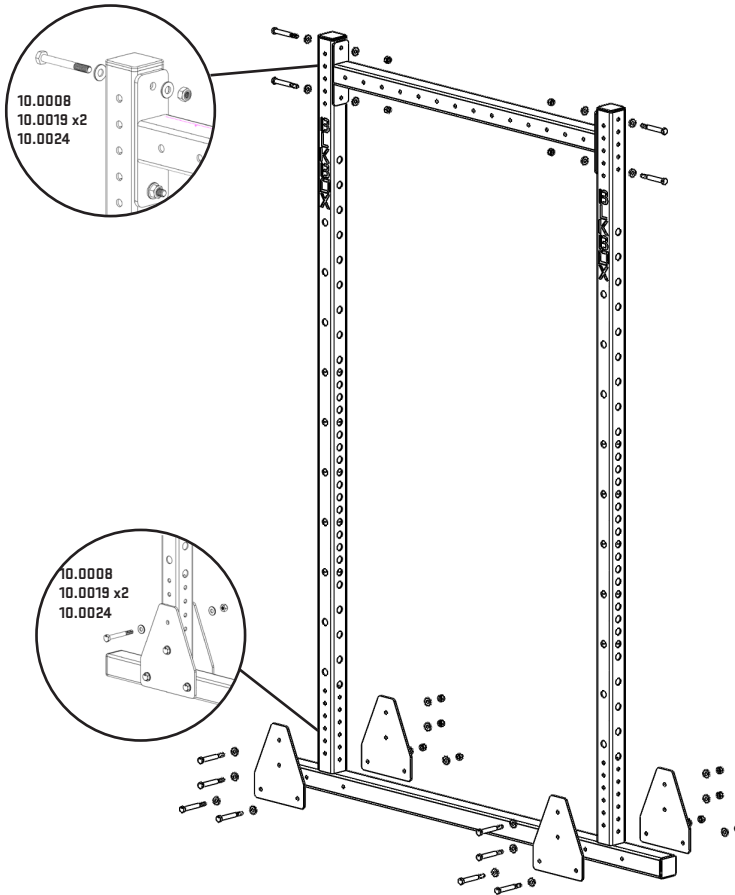

2

BOLT 1QTY 1.2 BOX CM (21-0013) TO 2QTY BACK UPRIGHT (21-0740) WITH BOLT ASSEMBLY AS SHOWN.
BOLT 1QTY 1.2 SINGLE BAR (21-0015) TO 2QTY FRONT UPRIGHT (21-0740) WITH BOLT ASSEMBLY AS SHOWN.
ENSURE THAT ALL BLK BOX LOGOS ARE FACING OUTWARDS AND BOLTS ARE FACING INWARDS.
PLACE J-HOOKS AND SAFETY STRAPS AS SUITS.

