

BLK BOX SAMSON HALF RACK

21-0155

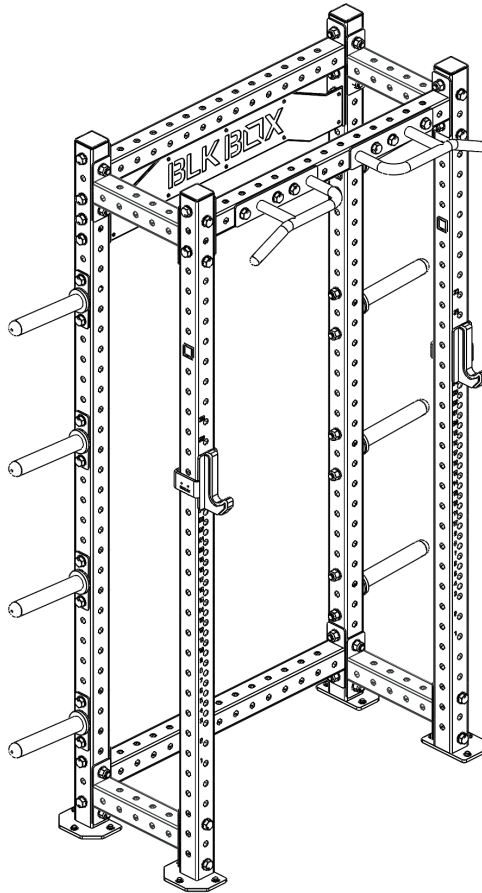

PRODUCT SPECIFICATION

PRODUCT WEIGHT	-	175kg
MAX USER WEIGHT	-	150kg
MAX TRAINING WEIGHT	-	450kg
DIMENSIONS	-	1900mm x 800mm x 2550mm
SAFE WORKING ZONE	-	2900mm x 1800mm x 3000mm

OWNERS MANUAL & QUICK START GUIDE

NOTE : PLEASE READ ALL THE INSTRUCTIONS CAREFULLY BEFORE ASSEMBLING THIS PRODUCT.

WARNING

SERIOUS OR FATAL INJURIES MAY OCCUR FROM INCORRECTLY ASSEMBLED EQUIPMENT. ALWAYS ENSURE BOLTS ARE TIGHTENED CORRECTLY AND ALL PARTS ARE LEVEL AND PLUMB. TO FURTHER REDUCE RISK OF INJURIES OR DEATH PLEASE USE OUR SUGGESTED TOOLS AND PERSONAL PROTECTIVE EQUIPMENT (PPE). WE SUGGEST THAT A MINIMUM OF THREE PEOPLE ARE INVOLVED IN THE ASSEMBLY OF THIS PRODUCT. EACH PERSON SHOULD BE EQUIPPED WITH SAFETY GLASSES, STEEL TOE CAP BOOTS AND EAR PLUGS.

PLEASE BE AWARE OF THIS SYMBOL AS AN INDICATION TO CHECK THAT A PART IS LEVEL OR PLUMB.



THIS SYMBOL IS AN INDICATION OF THE RECOMMENDED TORQUE EACH BOLT SHOULD BE TIGHTENED TO. THIS VALUE WILL BE DEPENDENT ON THE BOLT TYPE. PLEASE HAND TIGHTEN ALL BOLTS UNTIL YOU SEE THIS SYMBOL.



TOOLS REQUIRED

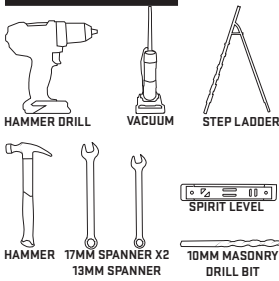

No.	Name	SKU	QTY
1	UPRIGHT WITH FEET DNA80	21-0058	2
2	WESTSIDE UPRIGHT WITH FEET DNA80	21-0059 21-0060	1 1
3	1.2 BRANDING BOX CM DNA80	21-0047	1
4	1.2 BOX CM DNA80	21-0045	2
5	0.4 BOX CM DNA80	21-0043	4
6	MULTIGRIPS DNA80	21-0165	1
7	J-HOOKS PAIR	16-0002	1
8	M20X120 BOLT	10-0010	54
9	M10X80 SLEEVE ANCHOR	10-0031	12
10	M20 FLAT WASHER	10-0023	108
11	M20 NYLOCK NUT	10-0028	54
12	UTILITY PEG DNA80	21-0234	8
13	M10 WASHER	10-0019	12

PARTS & ATTACHMENTS

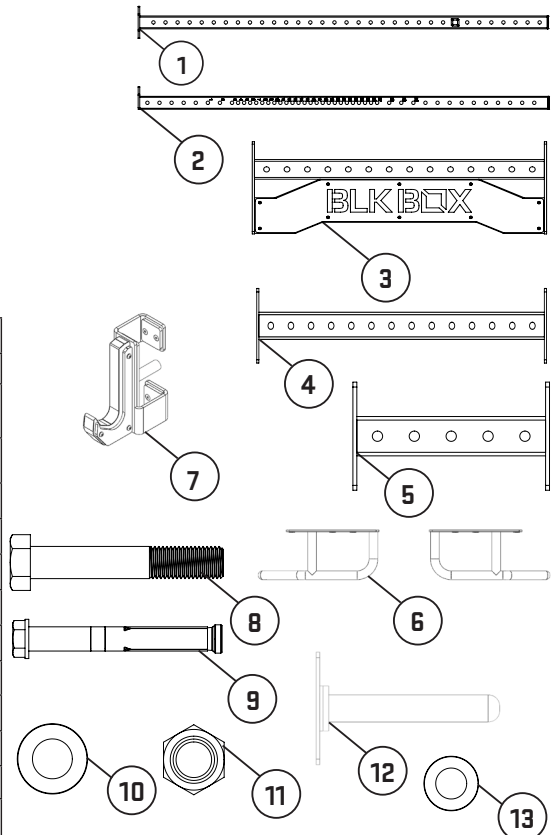

ASSEMBLY

1

BOLT 1QTY BRANDING BOX (21-0047) AND 1QTY 1.2 BOX (21-0045) BETWEEN 2QTY UPRIGHTS (21-0058) WITH BOLT ASSEMBLY AS SHOWN. ENSURE LOGO ON BRANDING BOX IS FACING FORWARD, LOGOS ON UPRIGHTS ARE FACING OUT AND ALL BOLTS FACING INWARDS.

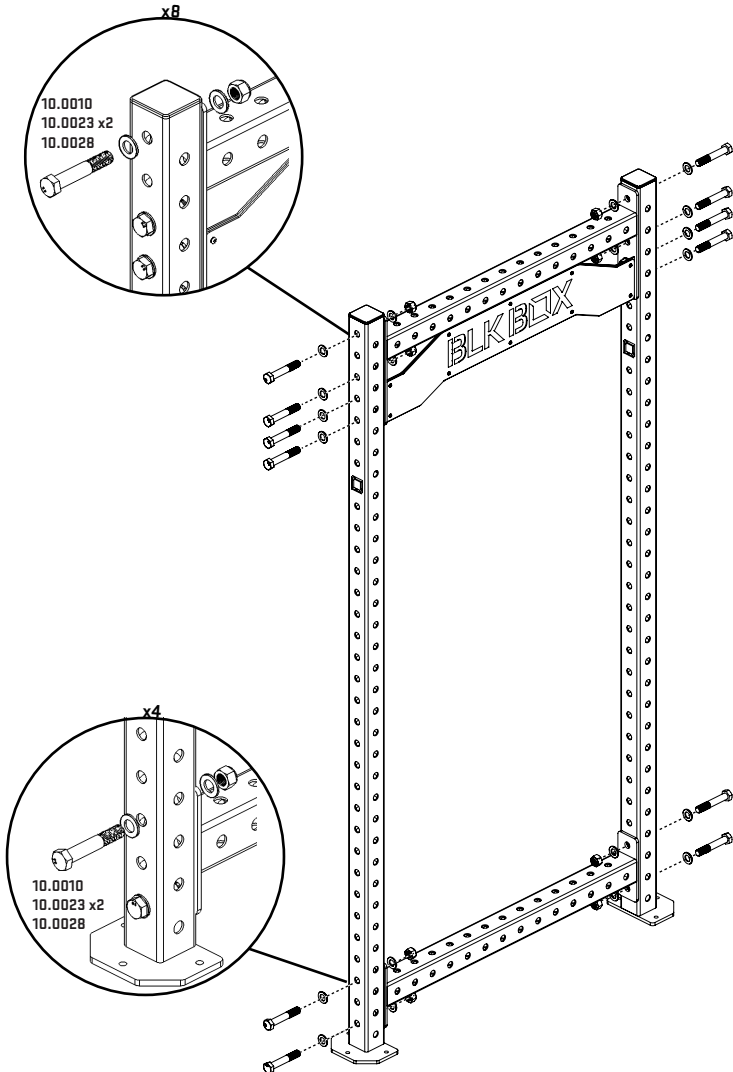

2

BOLT 10TY MULTIGRIP (21-0165) TO 10TY 1.2 BOX (21-0045) AND ATTACH BETWEEN 20TY WESTSIDE UPRIGHTS (21-0059 & 21-0060). CONNECT TO EXISTING ASSEMBLY USING 40TY 0.4 BOX (21-0043) WITH BOLT ASSEMBLY AS SHOWN. ENSURE LOGO ON UPRIGHTS ARE FACING OUT AND BOLTS ARE FACING INWARD.

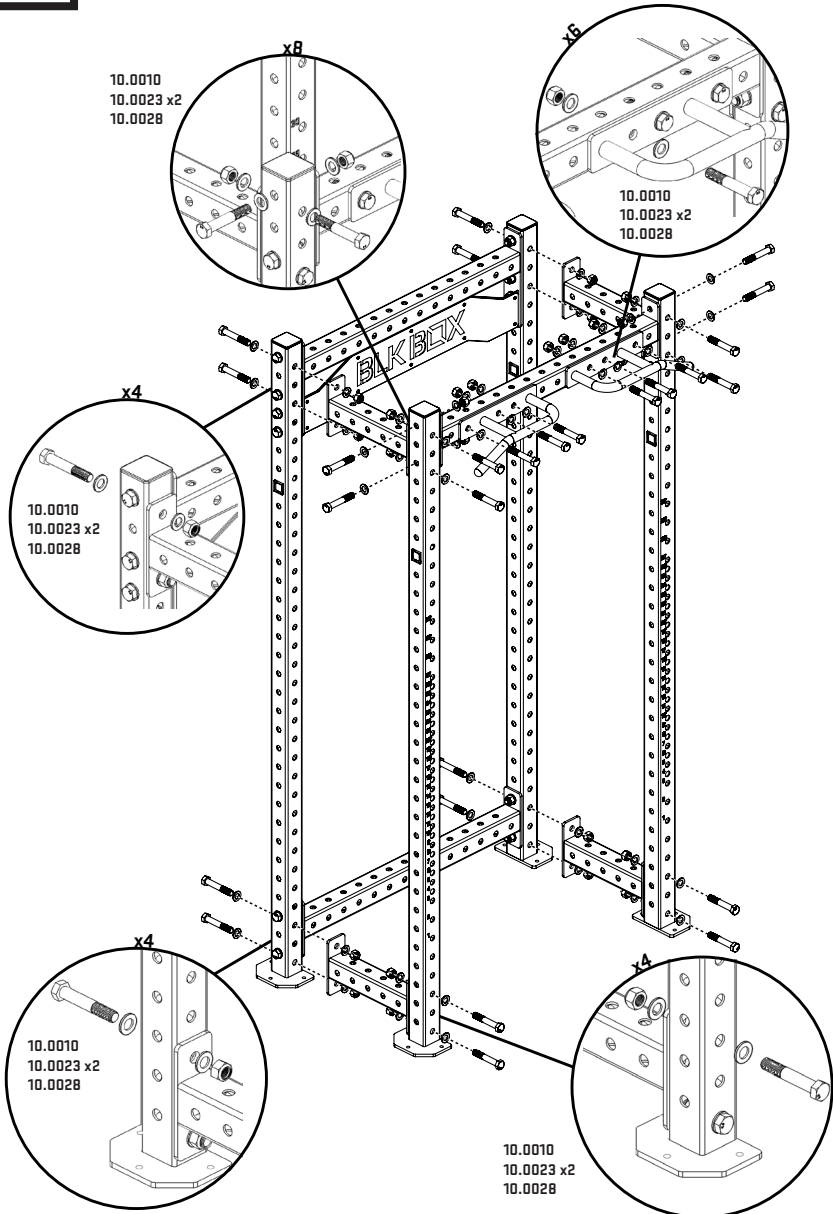

3

TIGHTEN ALL BOLT ASSEMBLIES WITHIN THE CIRCLE TO SPECIFIED TORQUE. ENSURE ALL UPRIGHTS ARE PLUMB. DRILL AND SECURE THE MIDDLE HOLE ON EACH UPRIGHT AS SHOWN IN GUIDE. REMOVE ALL BOTTOM CROSSMEMBERS, DRILL AND SECURE REMAINING HOLES ON UPRIGHTS AS SHOWN IN GUIDE. REATTACH THE BOTTOM CROSSMEMBERS.

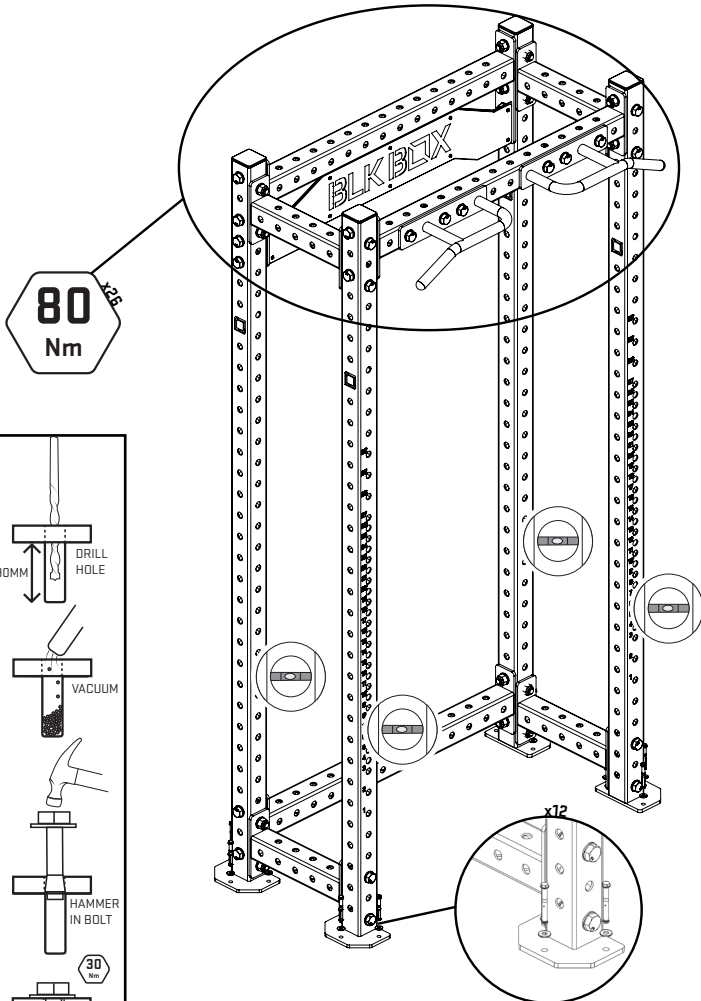

80 Nm

-DRILL 10MM HOLE THROUGH FLOOR COVERING, 90MM DEEP USING PLATE AS A GUIDE.

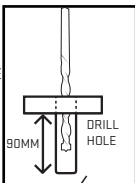

-VACUUM OUT THE DUST.

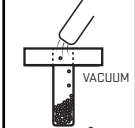

-HAMMERSLEEVE ANCHOR DOWN INTO THE HOLE.

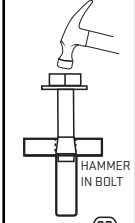

-TIGHTEN SLEEVE ANCHOR TO SPECIFIED TORQUE USING 13MM SPANNER.

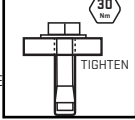

4

BOLT 8QTY UTILITY PEGS (21-0234) TO UPRIGHTS (21-0058) WITH BOLT ASSEMBLY AS SHOWN TIGHTEN TO 80Nm.

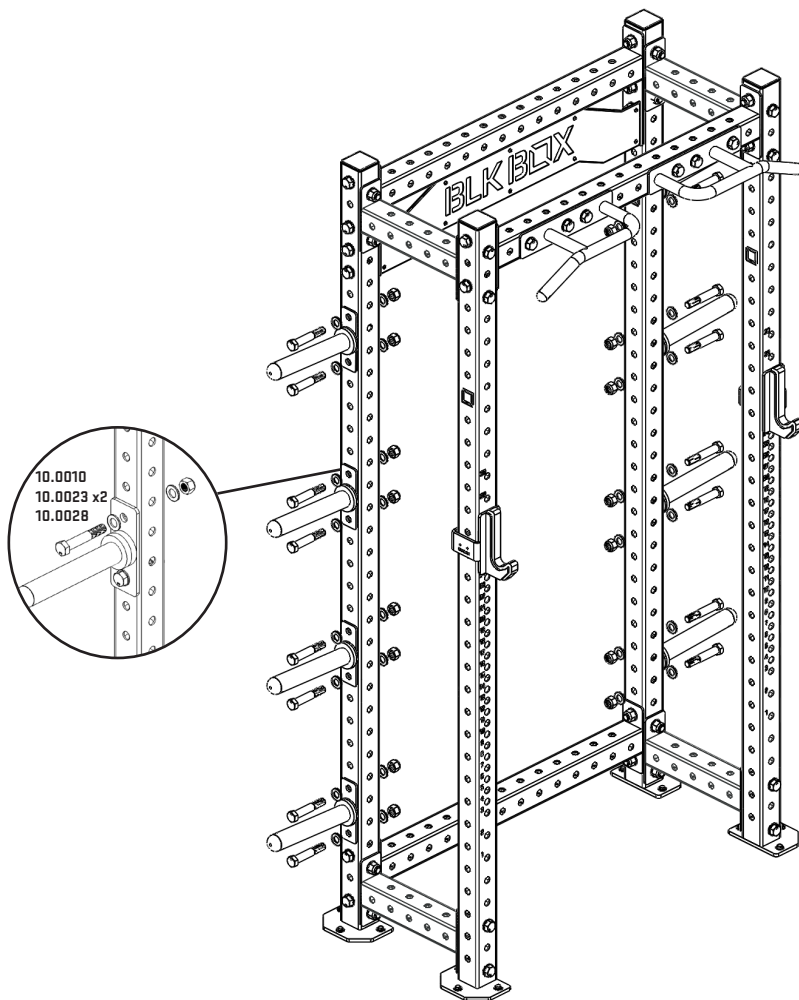

1:1 SCALE FASTENERS

M20x120 BOLT

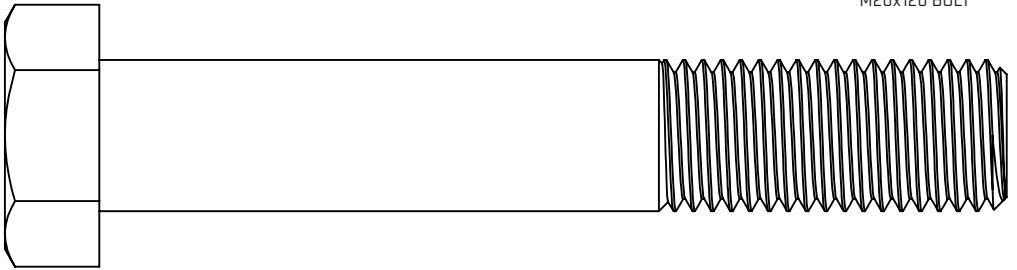

M10x80 SLEEVE ANCHOR
10-0031

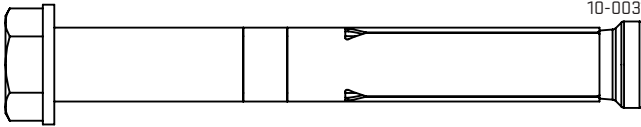

M10 FLAT WASHER
10-0019

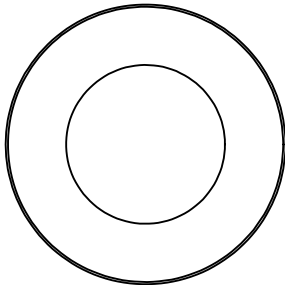

NYLOCK NUT
10-0024

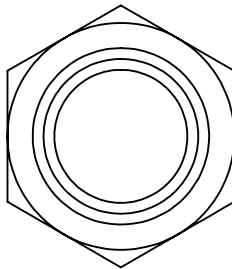

FOR TERMS AND CONDITIONS VISIT OUR WEBSITE AT
www.blkboxfitness.com/pages/terms-conditions

GET IN TOUCH
TEL: 028 9045 4123
EMAIL: info@blkboxfitness.com

DISCOVER MORE AT:
www.blkboxfitness.com