

BLK BOX SAMSON FULL RACK

21-0154

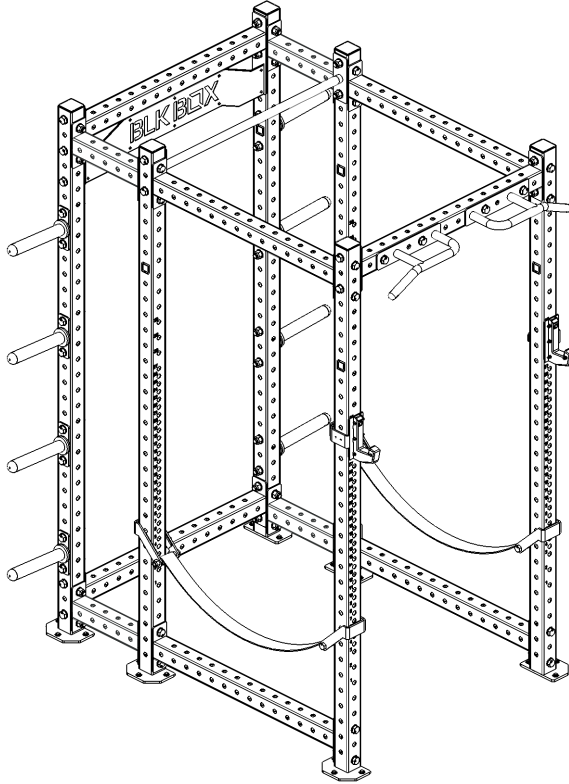

PRODUCT SPECIFICATION

PRODUCT WEIGHT	-	300kg
MAX USER WEIGHT	-	200kg
MAX TRAINING WEIGHT	-	450kg
DIMENSIONS	-	1960mm x 1360mm x 2550mm
SAFE WORKING ZONE	-	2960mm x 2360mm x 3000mm

OWNERS MANUAL & QUICK START GUIDE

NOTE : PLEASE READ ALL THE INSTRUCTIONS
CAREFULLY BEFORE ASSEMBLING THIS PRODUCT.

WARNING

SERIOUS OR FATAL INJURIES MAY OCCUR FROM INCORRECTLY ASSEMBLED EQUIPMENT. ALWAYS ENSURE BOLTS ARE TIGHTENED CORRECTLY AND ALL PARTS ARE LEVEL AND PLUMB. TO FURTHER REDUCE RISK OF INJURIES OR DEATH PLEASE USE OUR SUGGESTED TOOLS AND PERSONAL PROTECTIVE EQUIPMENT (PPE). WE SUGGEST THAT A MINIMUM OF THREE PEOPLE ARE INVOLVED IN THE ASSEMBLY OF THIS PRODUCT. EACH PERSON SHOULD BE EQUIPPED WITH SAFETY GLASSES, STEEL TOE CAP BOOTS AND EAR PLUGS.

PLEASE BE AWARE OF THIS SYMBOL AS AN INDICATION TO CHECK THAT A PART IS LEVEL OR PLUMB.



THIS SYMBOL IS AN INDICATION OF THE RECOMMENDED TORQUE EACH BOLT SHOULD BE TIGHTENED TO. THIS VALUE WILL BE DEPENDENT ON THE BOLT TYPE. PLEASE HAND TIGHTEN ALL BOLTS UNTIL YOU SEE THIS SYMBOL.



TOOLS REQUIRED

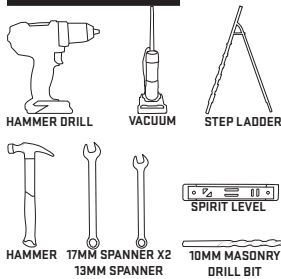

No.	Name	SKU	QTY
1	UPRIGHT WITH FEET DNA80	21-0058	2
2	WESTSIDE UPRIGHT WITH FEET DNA80	21-0059 21-0060	4
3	1.2 BRANDING BOX CM DNA80	21-0047	1
4	1.2 BOX CM DNA80	21-0045	6
5	0.4 BOX CM DNA80	21-0043	4
6	1.2 SINGLE BAR CM DNA80	21-0052	1
7	MULTIGRIPS	21-0165	1
8	M20X120 BOLT	10-0010	68
9	M10 FLAT WASHER	10-0019	18
10	M20 FLAT WASHER	10-0023	136
11	J-HOOKS PAIR	16-0002	1
12	M10X80 SLEEVE ANCHOR	10-0031	18
13	M20 NYLOCK NUT	10-0028	68
14	SAMSON SAFETY STRAPS	16-0003	1
15	UTILITY PEG	21-0234	8

PARTS & ATTACHMENTS

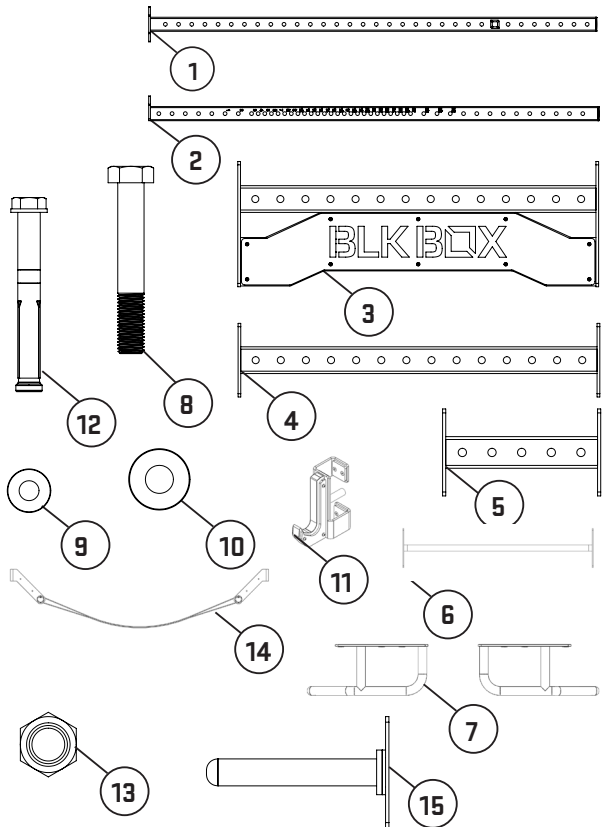

ASSEMBLY

1

BOLT 1QTY BRANDING BOX [21-0047] AND 1QTY 1.2 BOX [21-0045] BETWEEN 2QTY UP-RIGHTS [21-0058] WITH BOLTS ASSEMBLY AS SHOWN. ENSURE LOGO ON BRANDING BOX [21-0047] IS FACING FORWARD, LOGOS ON UPRIGHTS ARE FACING OUT AND ALL BOLTS FACING INWARDS.

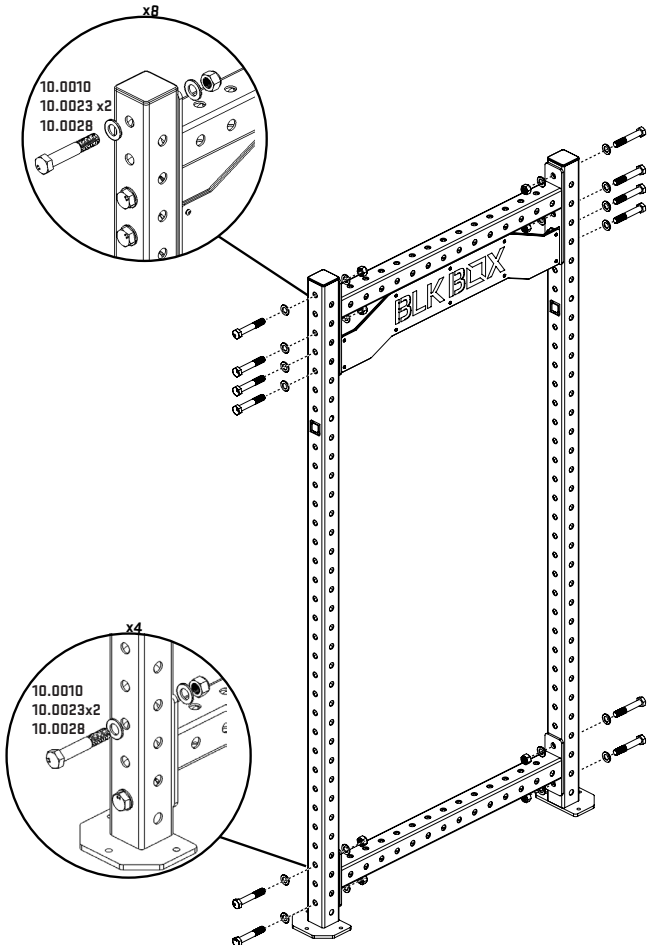

2

BOLT 10TY 1.2 SINGLE BAR (21-0052) BETWEEN 2QTY WESTSIDE UPRIGHTS (21-0059 & 21-0060) AND CONNECT TO EXISTING ASSEMBLY USING 4QTY 0.4 BOX (21-0043) WITH BOLT ASSEMBLY AS SHOWN. ENSURE LOGO ON UPRIGHTS ARE FACING OUT AND BOLTS ARE FACING INWARD.

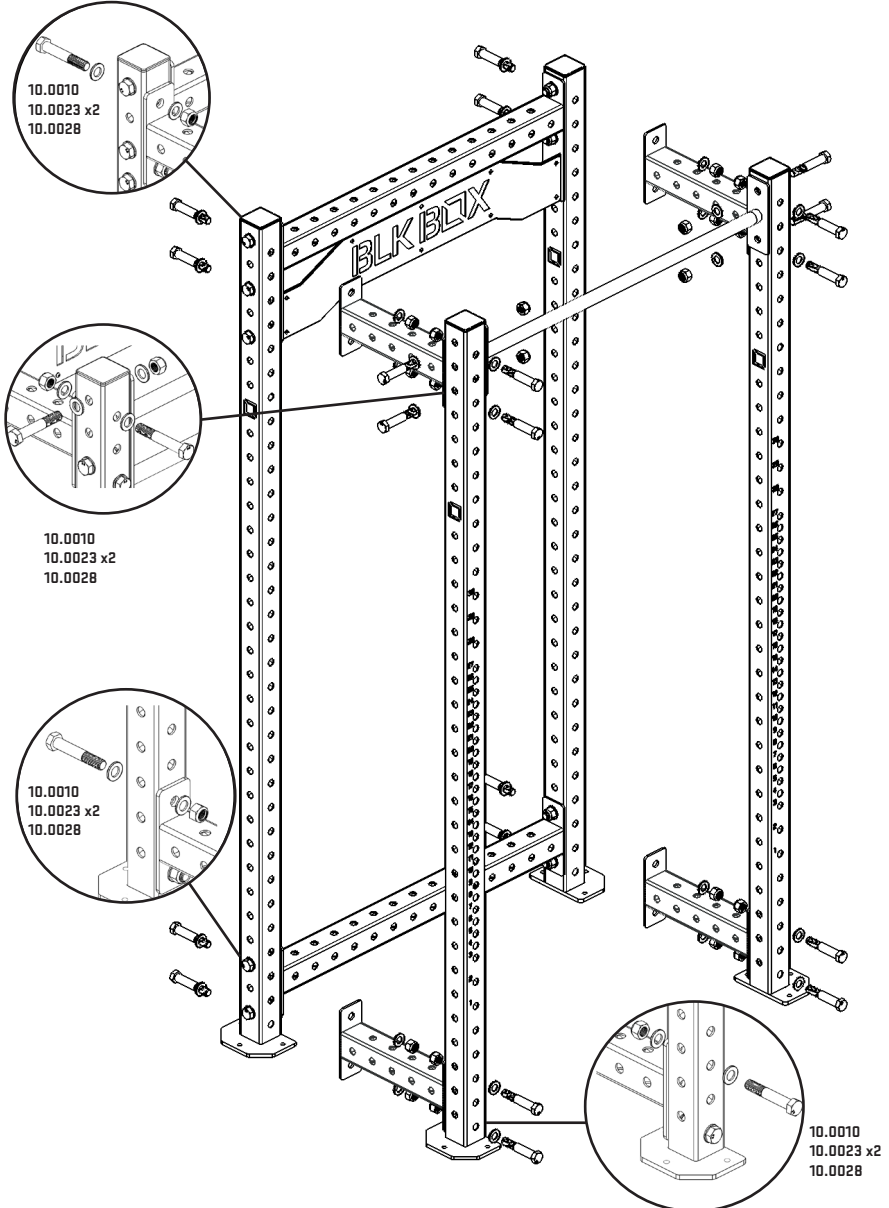

3

BOLT 1QTY 1.2 BOX (21-0045) TO 1QTY MULTIGRIPS (21-0165) AND BOLT BETWEEN 2QTY UPRIGHTS (21-0059 & 21-0060) AND CONNECT TO EXISTING ASSEMBLY USING 4QTY BOX 1.2 BOX (21-0045) WITH BOLT ASSEMBLY AS SHOWN, ENSURE LOGO ON UPRIGHTS ARE FACING OUT AND BOLTS ARE FACING INWARD.

10.0010
10.0023 x2
10.0028

10.0010
10.0023 x2
10.0028

10.0010
10.0023 x2
10.0028

10.0010
10.0023 x2
10.0028

4

TIGHTEN ALL BOLT ASSEMBLIES TO SPECIFIED TORQUE. ENSURE ALL UPRIGHTS ARE PLUMB. DRILL AND SECURE THE MIDDLE HOLE ON EACH UPRIGHT AS SHOWN IN GUIDE. REMOVE ALL BOTTOM CROSSMEMBERS, DRILL AND SECURE REMAINING HOLES ON UPRIGHTS AS SHOWN IN GUIDE. REATTACH THE BOTTOM CROSSMEMBERS.

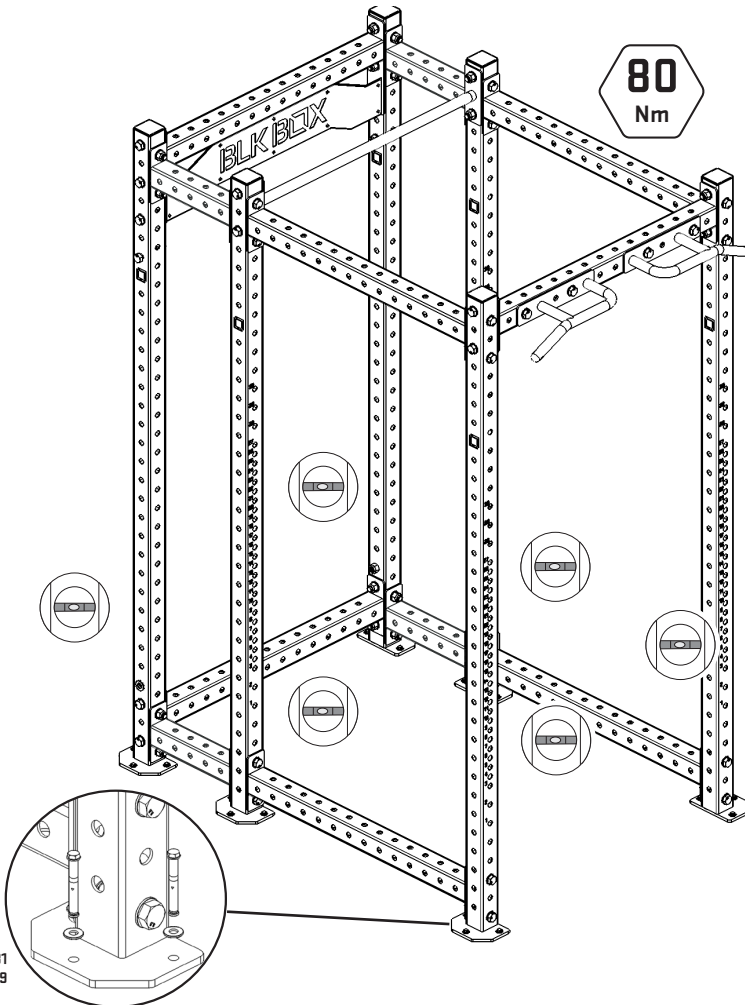

10.0031
10.0019

- DRILL 10MM HOLE THROUGH FLOOR COVERING, 90MM DEEP USING PLATE AS A GUIDE.
- VACUUM OUT THE DUST.
- HAMMER SLEEVE ANCHOR DOWN INTO THE HOLE.
- TIGHTEN SLEEVE ANCHOR TO SPECIFIED TORQUE USING 13MM SPANNER.

SLEEVE ANCHOR BOLT FITTING

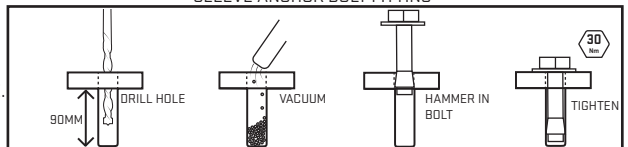

5

BOLT 8QTY UTILITY PEGS (21-0234) TO 2QTY UPRIGHTS (21-0058) WITH BOLT ASSEMBLY AS SHOWN. ENSURE THEY ARE TIGHTENED TO 80NM.

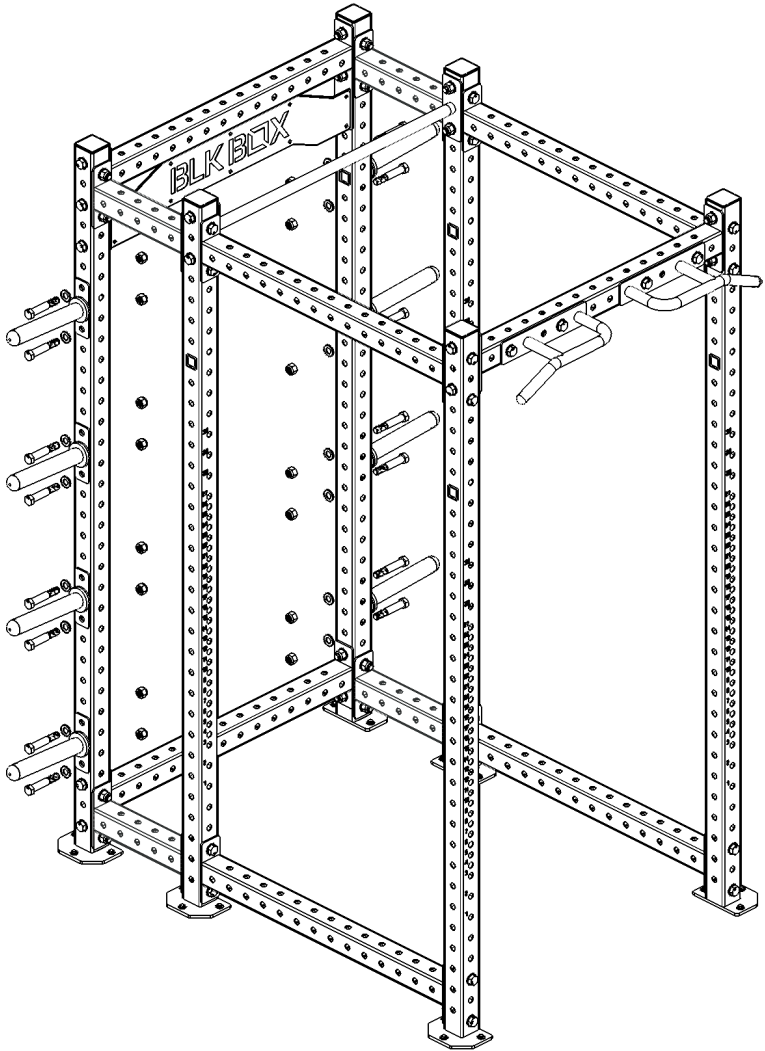

1:1 SCALE FASTENERS

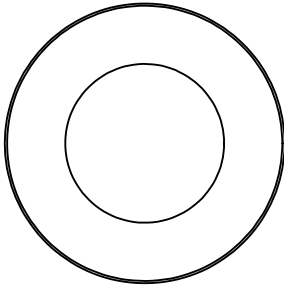

M20 FLAT WASHER

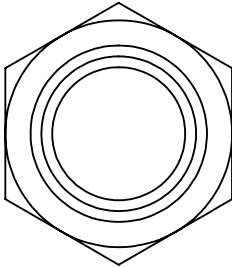

M20 NYLOCK
NUT

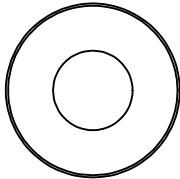

M10 FLAT WASHER

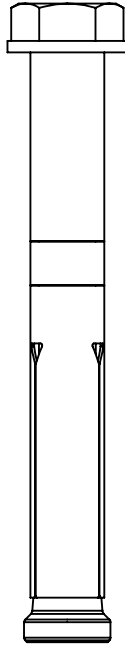

M10x80 SLEEVE ANCHOR
10-0031

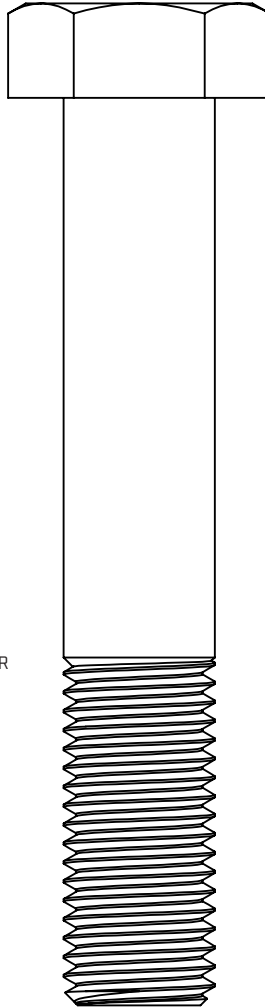

M20x120 BOLT

FOR TERMS AND CONDITIONS VISIT OUR WEBSITE AT
www.blkboxfitness.com/pages/terms-conditions

GET IN TOUCH

TEL: 028 9045 4123

EMAIL: info@blkboxfitness.com

DISCOVER MORE AT:

www.blkboxfitness.com