

BLK BOX PT POD GOLIATH

21-0600

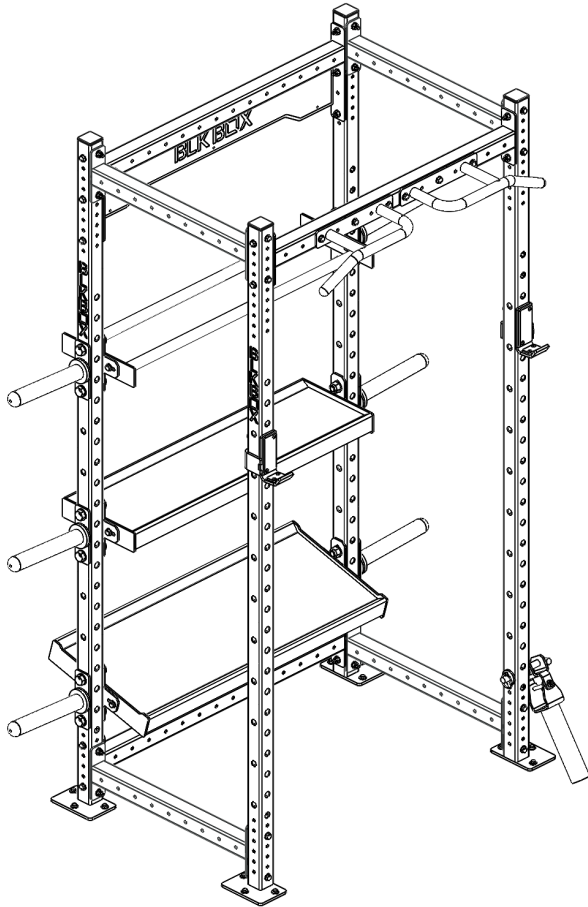

PRODUCT SPECIFICATION

PRODUCT WEIGHT	-	170kg
MAX USER WEIGHT	-	125kg
MAX USER	-	1
OWNERS MANUAL & QUICK START GUIDE	MAX TRAINING WEIGHT	- 300kg
NOTE : PLEASE READ ALL THE INSTRUCTIONS CAREFULLY BEFORE ASSEMBLING THIS PRODUCT.	DIMENSIONS	- 1200mm x 2408mm x 980mm
	SAFE WORKING ZONE	- 2700mm x 3272mm x 3580mm

WARNING

SERIOUS OR FATAL INJURIES MAY OCCUR FROM INCORRECTLY ASSEMBLED EQUIPMENT. ALWAYS ENSURE BOLTS ARE TIGHTENED CORRECTLY AND ALL PARTS ARE LEVEL AND PLUMB. TO FURTHER REDUCE RISK OF INJURIES OR DEATH PLEASE USE OUR SUGGESTED TOOLS AND PERSONAL PROTECTIVE EQUIPMENT (PPE). WE SUGGEST THAT A MINIMUM OF THREE PEOPLE ARE INVOLVED IN THE ASSEMBLY OF THIS PRODUCT. EACH PERSON SHOULD BE EQUIPPED WITH SAFETY GLASSES, STEEL TOE CAP BOOTS AND EAR PLUGS.

PLEASE BE AWARE OF THIS SYMBOL AS AN INDICATION TO CHECK THAT A PART IS LEVEL OR PLUMB.



THIS SYMBOL IS AN INDICATION OF THE RECOMMENDED TORQUE EACH BOLT SHOULD BE TIGHTENED TO. THIS VALUE WILL BE DEPENDENT ON THE BOLT TYPE. PLEASE HAND TIGHTEN ALL BOLTS UNTIL YOU SEE THIS SYMBOL.



TOOLS REQUIRED

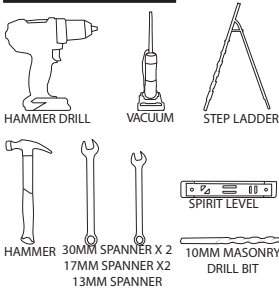

No.	Name	SKU	QTY
1	2.4 UPRIGHT DNA60 WITH FEET	21-0036-0A	4
2	1.2 BRANDING BOX CM DNA60	21-0017-0A	1
3	1.2 BOX CM DNA60	21-0013-0A	2
4	0.7 BOX CM DNA60	21-0036-0A	4
5	UTILITY PEG	21-0234-0B	6
6	MULTIGRIPS DNA60	21-0151-0A	1
7	M10X80 SLEEVE ANCHOR	16-0031	12
8	M10X90 BOLT	10-0008	46
9	M10 FLAT WASHER	10-0019	104
10	M10 NYLOCK NUT	10-0024	46
11	J-HOOK PAIR	16-0001	1
12	M20X100 BOLT	10-0134	12
13	M20 FLAT WASHER	10-0023	24
14	M20 NYLOCK NUT	10-0028	12

PARTS & ATTACHMENTS

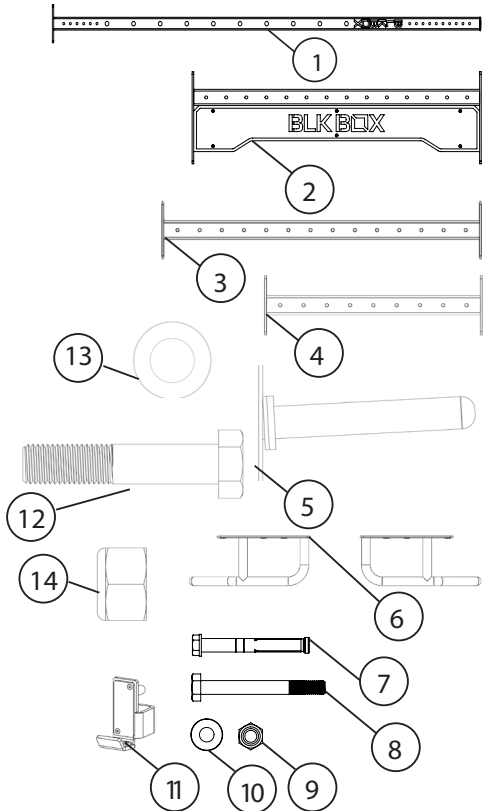

ASSEMBLY

1

BOLT 1 QTY BRANDING BOX (21-0017-0A) AND 1 QTY 1.2 BOX (21-0013-0A) BETWEEN 2 QTY UPRIGHTS (21-0036-0A) WITH BOLTS ASSEMBLY AS SHOWN. ENSURE LOGOS ON BRANDING BOX (21-0017-0A) IS FACING FORWARD, LOGOS ON UPRIGHTS ARE FACING OUTWARD AND ALL BOLTS FACING INWARDS.

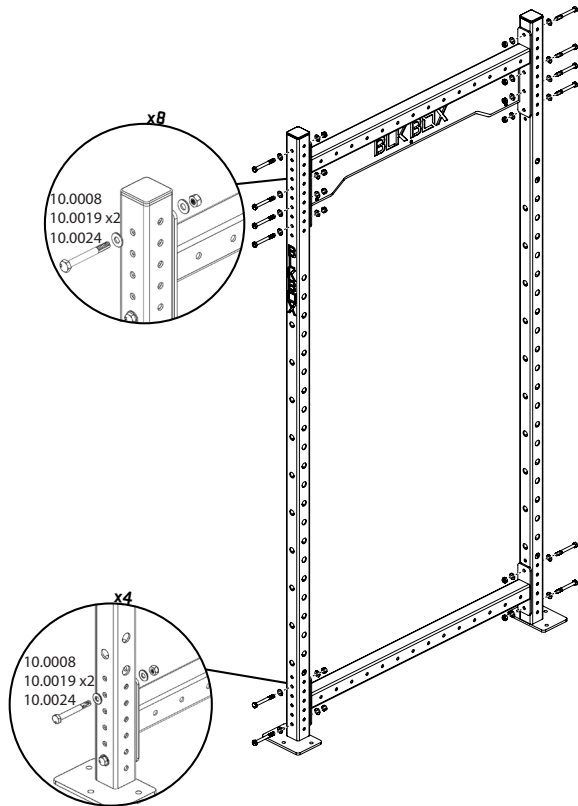

2

BOLT 6QTY UTILITY PEG (21-0234) AND 6QTY SIDE PLATES (PLATES VARY DEPENDING ON SHELF) EITHER SIDE OF 2QTY UPRIGHT (21-0036-0A) WITH BOLT ASSEMBLY AS SHOWN.

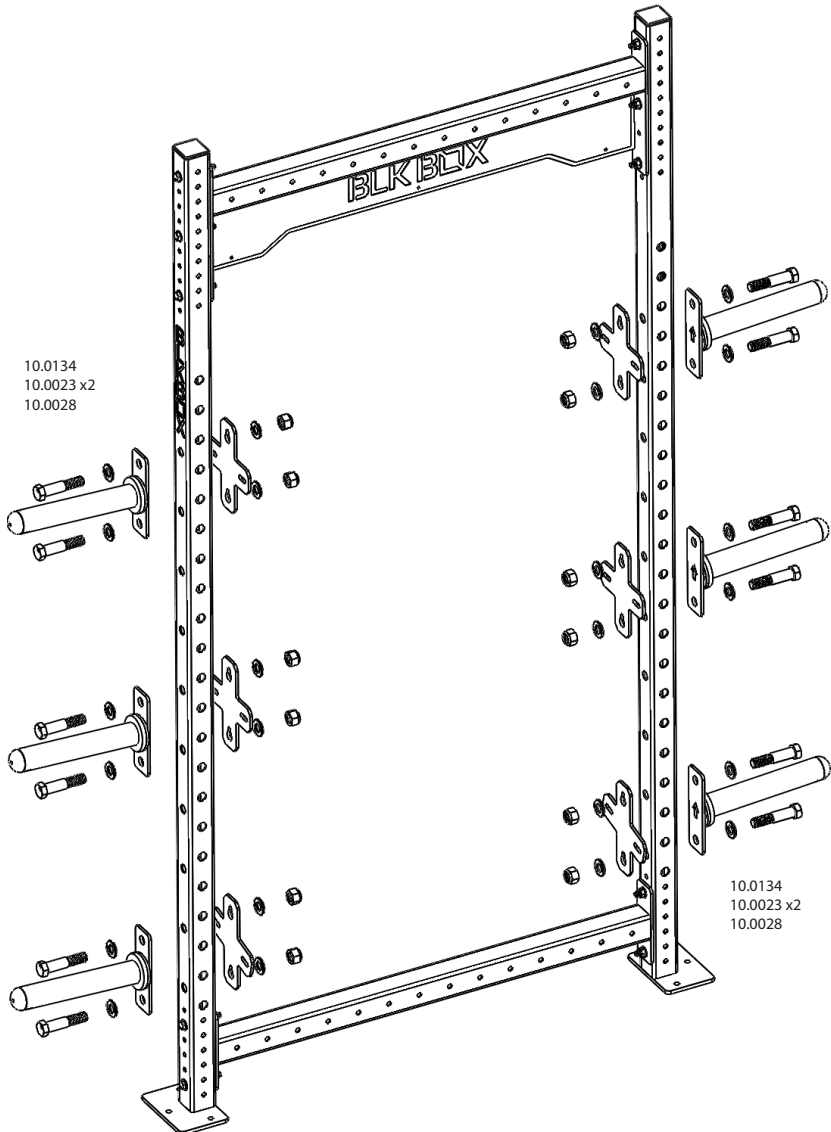

10.0134
10.0023 x2
10.0028

10.0134
10.0023 x2
10.0028

3

BOLT 3QTY SHELVES (SHELVES VARY DEPENDING ON ORDER) TO 6QTY SIDE PLATES WITH BOLT ASSEMBLY AS SHOWN.

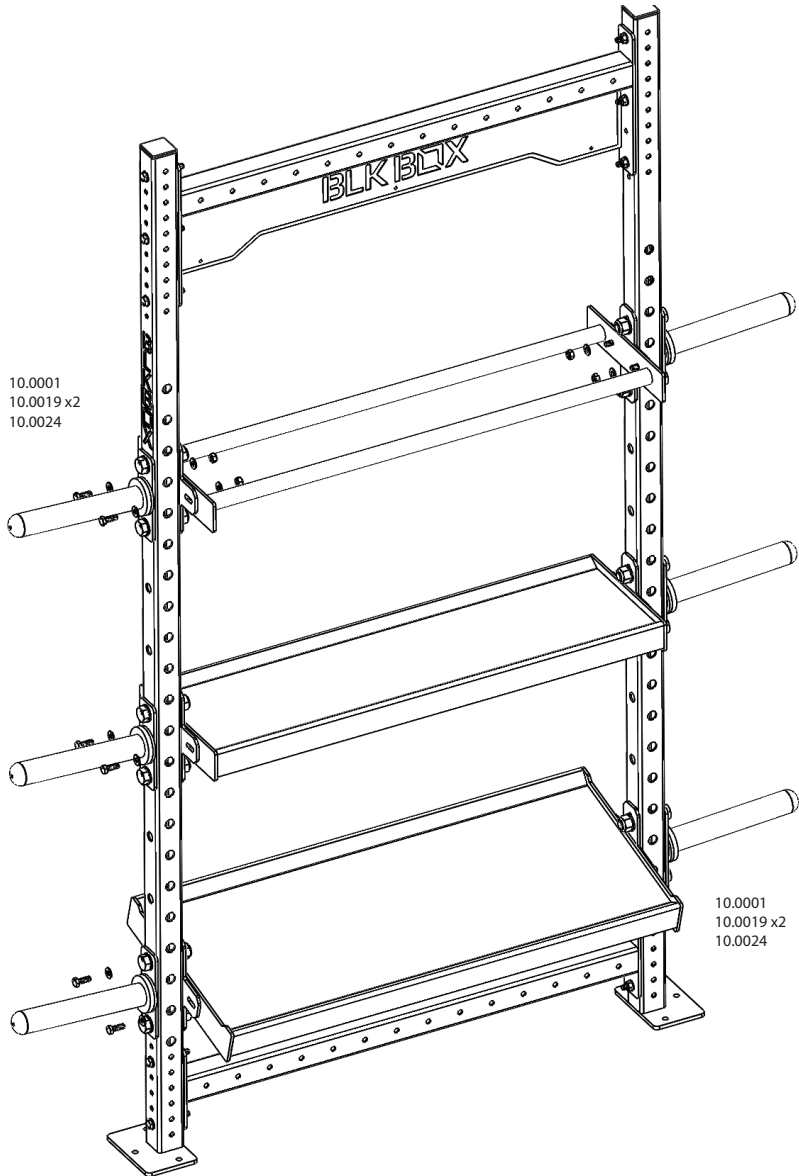

4

BOLT 1QTY 1.2 BOX (21-0013-0A) BETWEEN 2QTY UPRIGHTS (21-0036-0A) AND CONNECT TO EXISTING ASSEMBLY USING 4QTY 0.7 BOX (21-0011-0A) WITH BOLT ASSEMBLY AS SHOWN. BOLT 1QTY MULTIGRIPS (21-0151-0A) TO 1QTY 1.2 BOX (21-0013-0A) WITH BOLT ASSEMBLY AS SHOWN. ENSURE LOGO ON UPRIGHTS ARE FACING OUTWARD AND BOLTS ARE FACING INWARD.

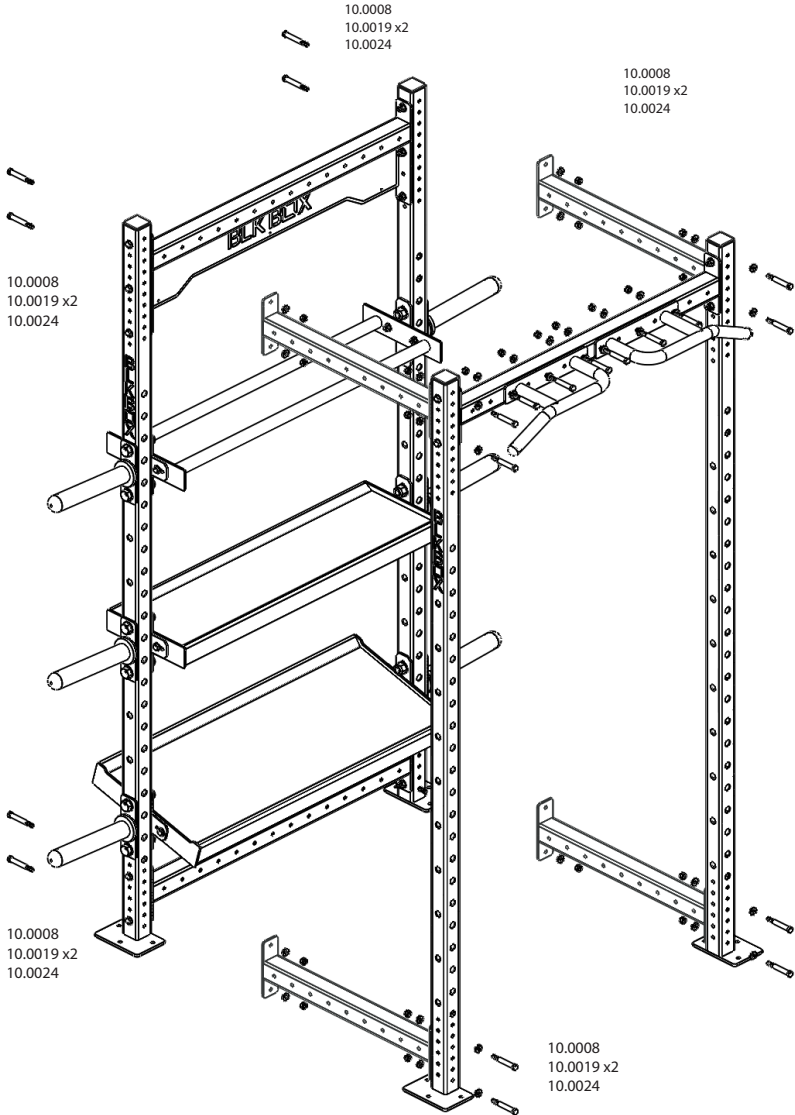

5

TIGHTEN ALL BOLT ASSEMBLIES TO 30NM TORQUE. ENSURE ALL UPRIGHTS ARE PLUMB. DRILL AND SECURE THE MIDDLE HOLE ON EACH UPRIGHT AS SHOWN IN GUIDE. REMOVE ALL BOTTOM CROSSMEMBERS, DRILL AND SECURE REMAINING HOLES ON UPRIGHTS AS SHOWN IN GUIDE. REATTACH THE BOTTOM CROSSMEMBERS. ATTACH J-HOOKS AND LANDMINE AS BELOW.

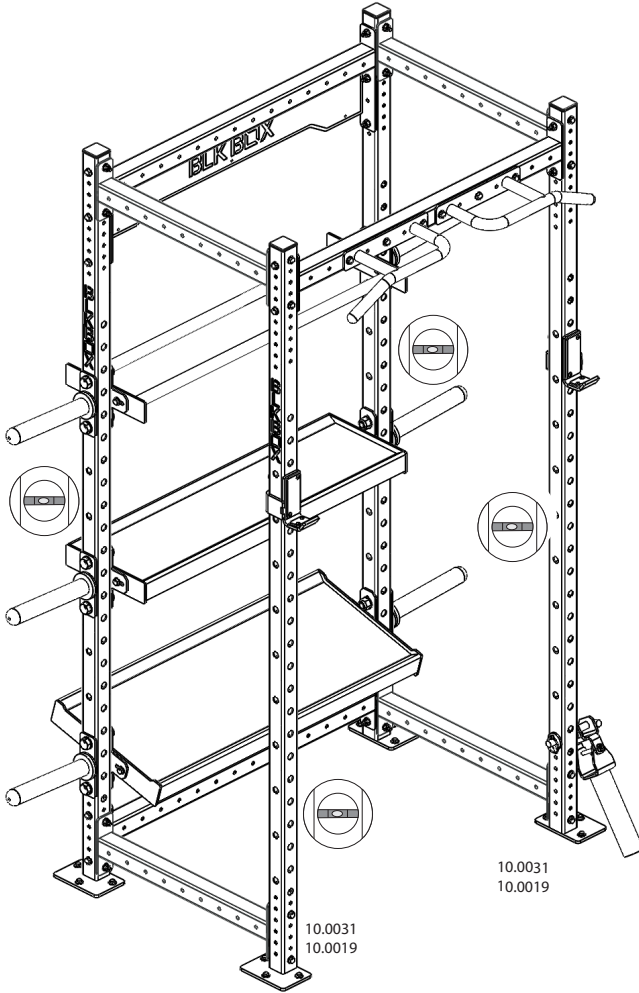

SLEEVE ANCHOR BOLT FITTING

-DRILL 10MM HOLE THROUGH FLOOR COVERING, 90MM DEEP USING PLATE AS A GUIDE.

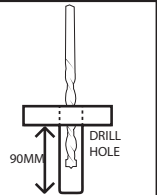

-VACUUM OUT THE DUST.

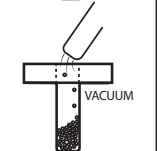

-HAMMER SLEEVE ANCHOR DOWN INTO THE HOLE.

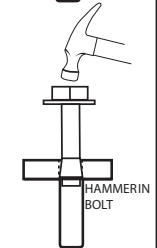

-TIGHTEN SLEEVE ANCHOR TO SPECIFIED TORQUE USING 13MM SPANNER.

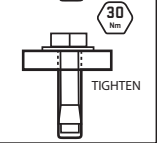

1:1 SCALE FASTENERS

M10x80 SLEEVE ANCHOR

10-0031

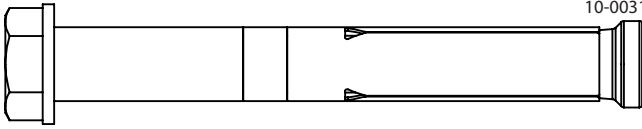

M10x90 BOLT

10-0008

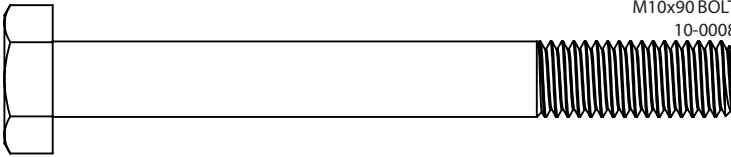

M10 FLAT WASHER

10-0019

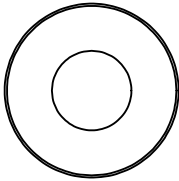

NYLOCK NUT

10-0024

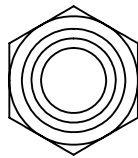

FOR TERMS AND CONDITIONS VISIT OUR WEBSITE AT
www.blkboxfitness.com/pages/terms-conditions

GET IN TOUCH

TEL: 028 9045 4123

EMAIL: info@blkboxfitness.com

DISCOVER MORE AT:

www.blkboxfitness.com

THIS IS A BLANK PAGE