

PARTS LIST

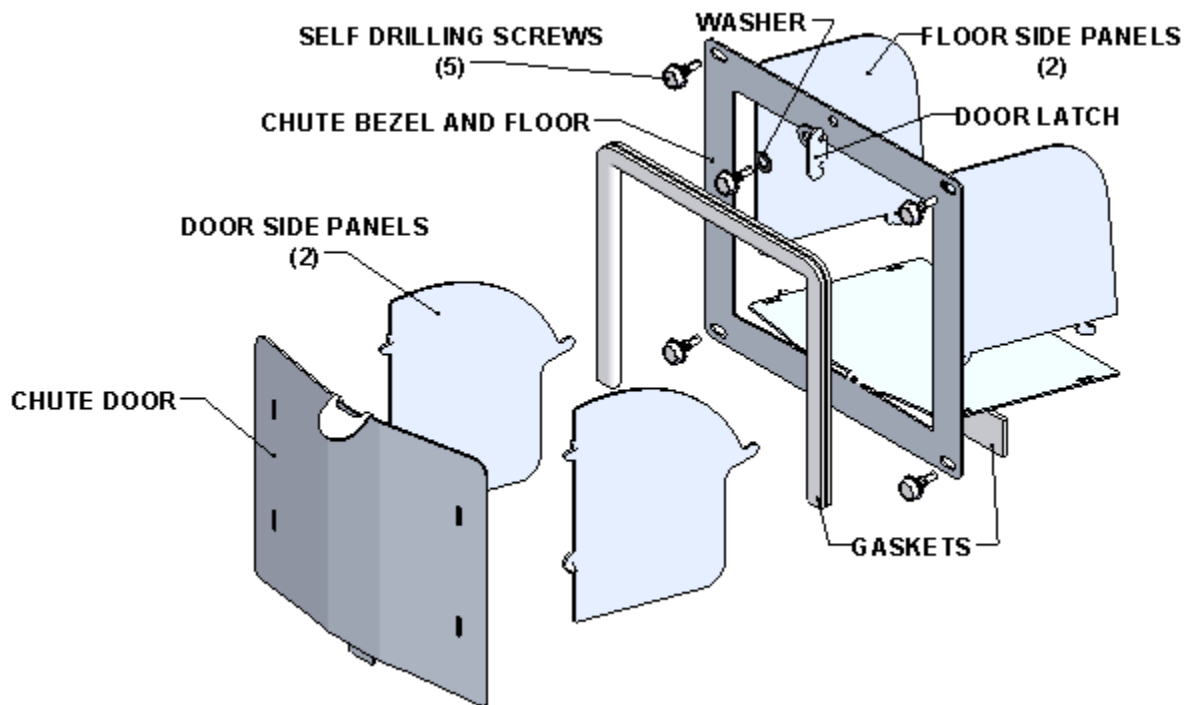

TOOLS NEEDED:

PENCIL OR MARKER

HAND DRILL

¼" TO 1" STEP DRILL

7/16" HEX DRIVE

STEEL CUTTING TOOL (TIN SNIPS, ETC.)

ADJUSTABLE WRENCH OR PLIERS

STEP 1

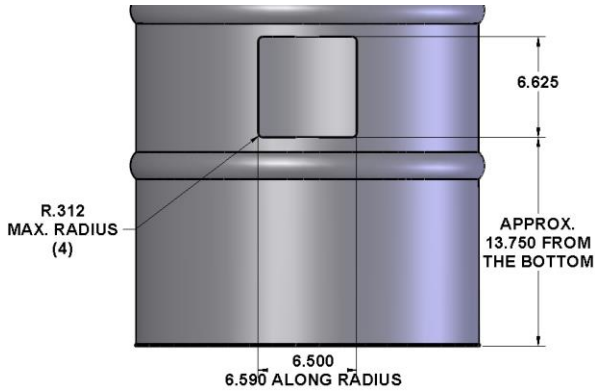

DETERMINE CUTOUT LOCATION FOR THE CHARCOAL CHUTE. LAYOUT AS SHOWN ABOVE. AND CAREFULLY CUTOUT.

STEP 2

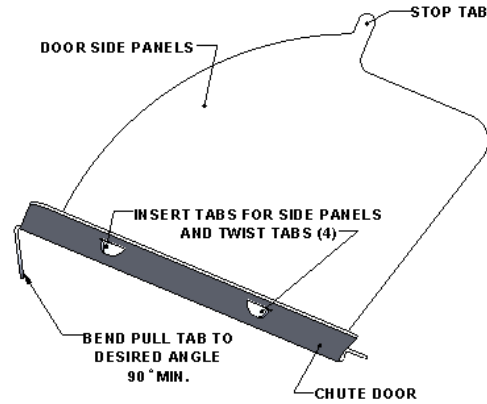

INSERT DOOR SIDE PANELS INTO CHUTE DOOR SLOTS AND TWIST TABS (4) TO ATTACH. BEND DOOR PANELS OUT, TO KEEP PANELS FROM FALLING IN ON THEMSELVES. BEND PULL TAB DOWN TO DESIRED ANGLE.

STEP 3

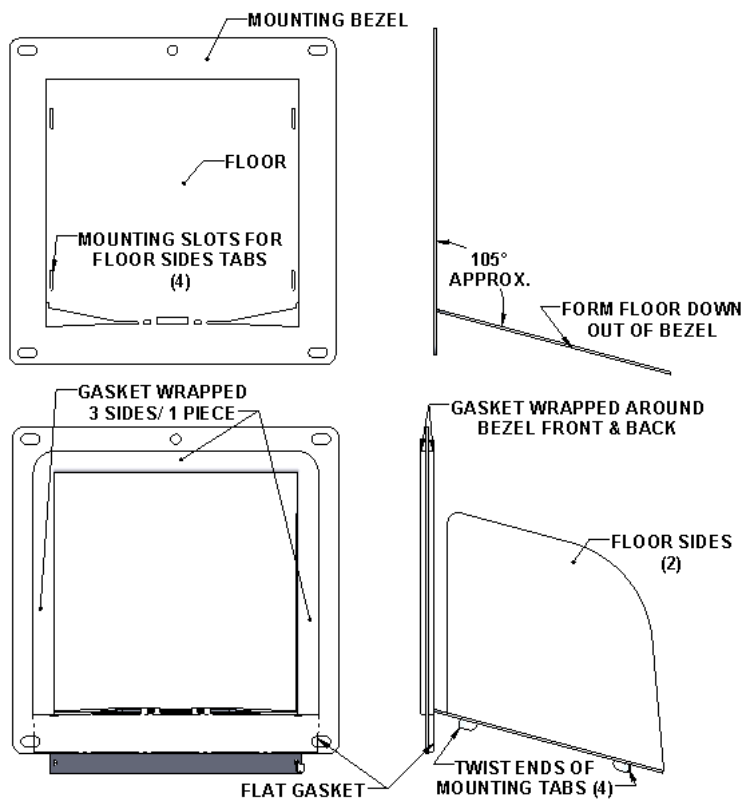

BEND FLOOR OUT OF MOUNTING BEZEL, AS SHOWN. PEEL & STICK THE GASKET AROUND 3 SIDES OF BEZEL OPENING. **(HALF OF GASKET ON FRONT SIDE, THE OTHER HALF ON BACK SIDE.)** PEEL & STICK ANOTHER FLAT GASKET ACROSS LOWER BACK SIDE OF BEZEL. INSERT FLOOR SIDE PANELS INTO SLOTS OF FLOOR AND TWIST THE TABS (4) TO ATTACH.

STEP 4

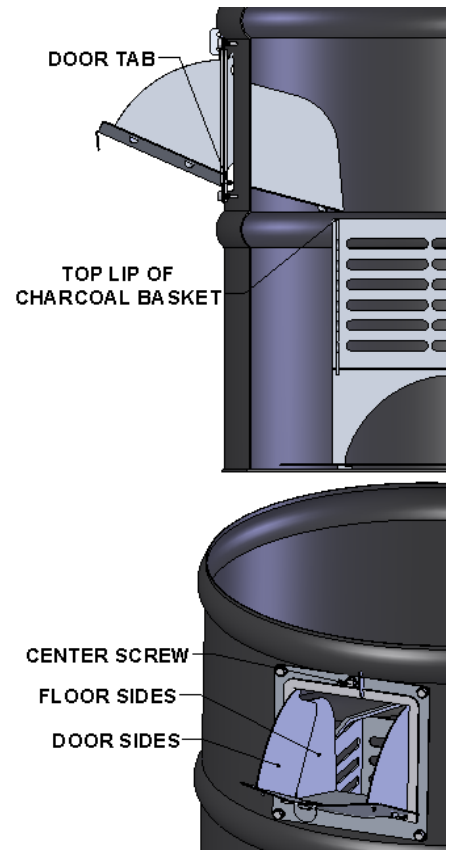

INSERT BEZEL ASSEMBLY INTO CUTOUT TOWARDS THE TOP & CENTER OF CUTOUT. INSTALL CENTER SCREW ON BEZEL. SCREW THE OTHER (4) SCREWS INTO SLOTTED HOLES. REMOVE CENTER SCREW. ADD WASHER & LATCH, THEN REATTACH SCREW. INSERT DOOR ASSEMBLY MAKING SURE DOOR PANELS ARE INBOARD OF FLOOR PANELS & STOP TABS ARE TO THE INSIDE OF BEZEL.