

# CANOPY OVER DECKING

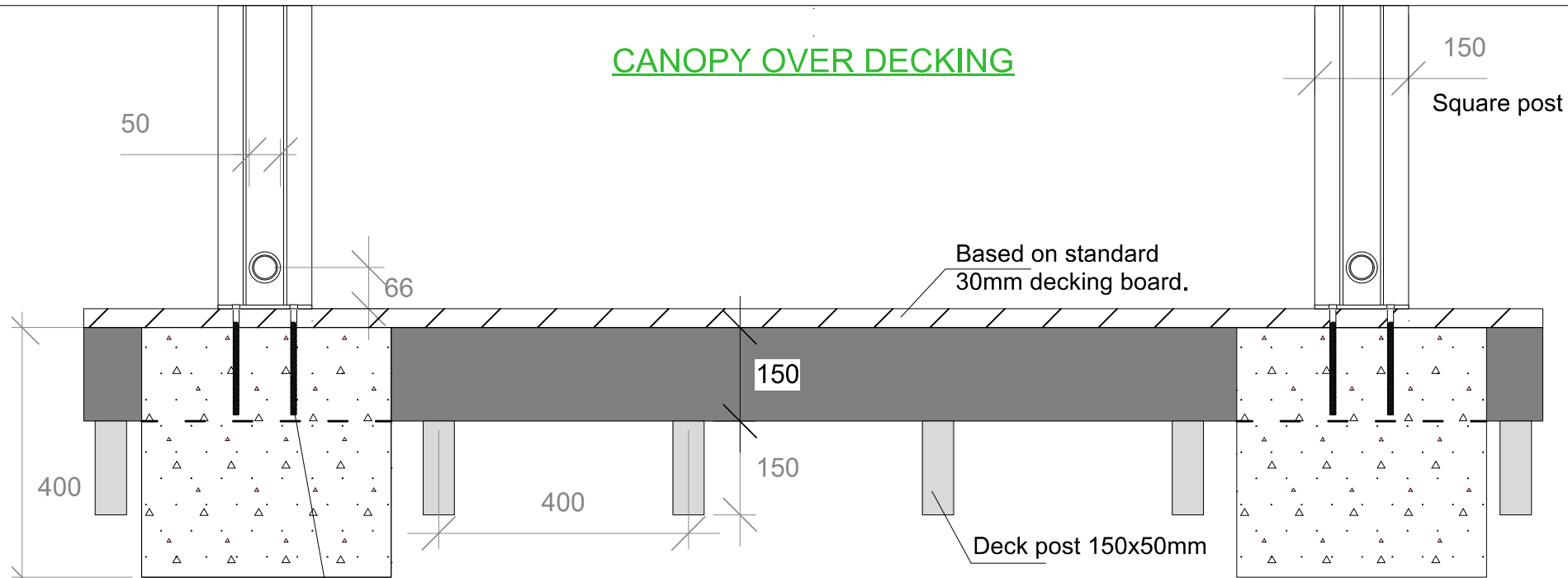

M10 studs chemfixed into position by GHD team.

Deck frame:  
 Timber 150x50mm x C24.  
 Treatment UC3, post UC4.  
 Option on aluminium, steel or plastic.

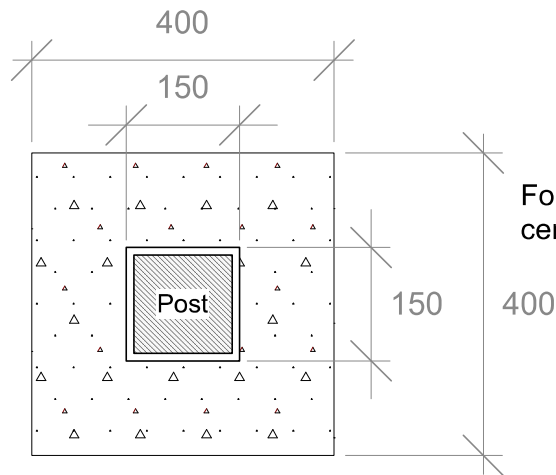
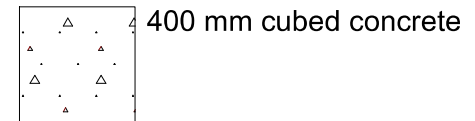

Foundations must be centered under each post.

**ALL SURFACES MUST BE FLAT AND LEVEL**

All dimensions mm  
 Drainage leading to soak away by others.  
 Sub base & support to landscapers specification