

blafili RTX

Wireless audio transmitter / receiver



Wireless Your Life!

www.blafili.com

Introduction

Congratulations for purchasing the blafili RTX! The blafili RTX consists of a 2.4GHz wireless transmitter and a receiver, which can be used to transmit stereo audio signals wirelessly to different rooms.

- Digital Wireless Audio Sender
- Wirelessly enjoy music and TV audio.
- Wirelessly send your TV's or computer's audio to your stereo system.
- Listen to the music you are playing in the living room and in other rooms (e.g. kitchen/conservatory) simultaneously.
- Digital audio transmission in HD quality via improved 2.4GHz interference-free technology.
- Multiple receivers (upto 4) can be connected to one transmitter.
- Use secured pairing to use multiple sets in the same surroundings.

With the blafili RTX you can playback TV audio or music on your sound system without the need for connecting cables between your audio source and sound system. The blafili RTX has a range of approx 100 ft and is even capable of transmitting through walls and ceilings! Particularly useful in avoiding the need for unsightly and messy cable runs, enabling you to enjoy your audio in the same or adjoining room without limitations.

Package Contents

1x blafili RTX transmitter

1x blafili RTX receiver

2x USB C cable

2x RCA cable

1x Optical cable

1x User manual

A Transmitter

FRONT VIEW

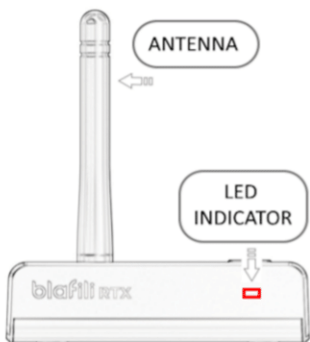

REAR VIEW

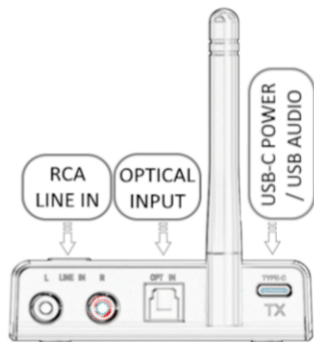

TOP VIEW

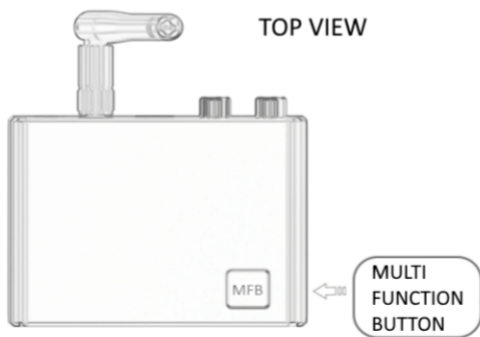

blafili RTX

B Receiver

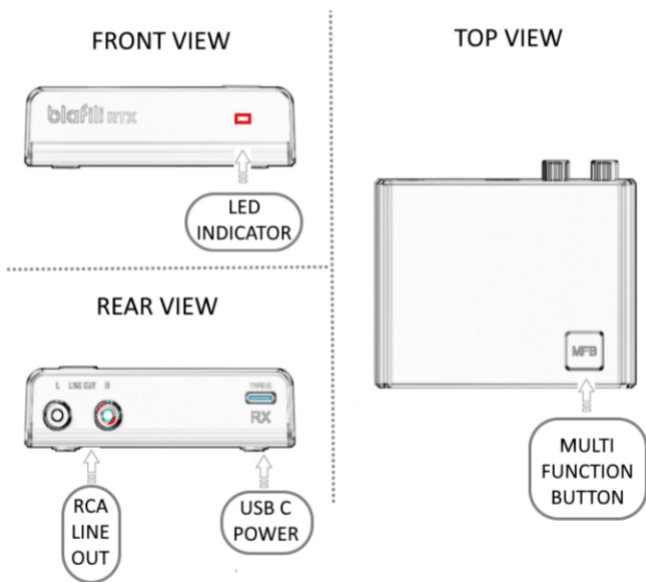

blafili RTX

Getting started

Please take the following steps before using the product:

- Installing the transmitter.
- Installing the receiver.
- Enjoy!

We will now explain this step by step.

Installing the transmitter

Any source can be connected to the transmitter such as a TV, PC or audio system.

1. Connect the RCA cable (for example) between the source (Example TV) and the RTX transmitter.
2. Connect the USB-C cable to the back of the transmitter and to a power source.
3. Allow your audio source to play sound.

Installing the receiver

1. Connect the RCA cable (for example) between the RTX receiver and your output audio device (HiFi system for example).
2. Connect the USB-C cable to the back of the receiver and to a power source.
3. Turn on the output audio device and set the volume.

Please note - The RTX receivers and transmitters come pre paired from the factory.

Upto 4 receivers can be paired to a single transmitter

Understanding the transmitter

How to turn the unit on/off?

Press and hold the MFB for 5 seconds. Please note the unit will automatically turn on when connected to a power source.

How to switch source?

Short press the MFB to switch source.

Blue light = Optical input

Red light = RCA input

Pink light = USB-C input.

How to put into pairing mode?

Double press the MFB to enter pairing mode. The LED will blink every second.

Understanding the LED indicator

Blue blink every 1 second = Pairing (Optical Input)

Red blink every 1 second = Pairing (RCA Input)

Pink blink every 1 second = Pairing (USB-C Input)

Blue blink every 3 seconds = Waiting for connection (Optical Input)

Red blink every 3 seconds = Waiting for connection (RCA Input)

Pink blink every 3 seconds = Waiting for connection (USB-C Input)

Understanding the receiver

How to turn the unit on/off?

Press and hold the MFB for 5 seconds. Please note the unit will automatically turn on when connected to a power source.

How to put into pairing mode?

Double press the MFB to enter pairing mode. The LED will blink every second.

Understanding the LED indicator

Solid blue = In connection

Blue blink every 1 second = Pairing

Blue blink every 3 seconds = Waiting for connection

Technical specifications

1. Working range:	100ft
2. Low latency:	28ms
3. Sample rate:	48kHz / 16bit (up to)
4. Frequency response:	10Hz to 22kHz
5. Trans/Rec freq:	2.4GHz
6. Harmonic Distortion:	0.05%
7. Signal to noise ratio:	> 80dB
8. Receiver output level:	1.2v RMS (MAX)
9. Dimensions:	3.15 x 2.37 x 0.87 inches

blafili RTX

www.blafili.com

michaelw@blafili.com