



QUICK SETUP - START HERE SAVE THIS MANUAL

The NEVERknead® Parts Kit

*Thank you for purchasing Genuine
3rd Gen NEVERknead Parts Kit
You are about to become a NEVERkneader!*



Easy Assembly of Your NEVERknead Parts Kit

Carefully unbox your 1/2 ton arbor press (not included) and you're ready to get started



Your 1/2 ton arbor press might vary slightly

1

Get rid of the anvil plate and O ring that came with your arbor press - don't need 'em.

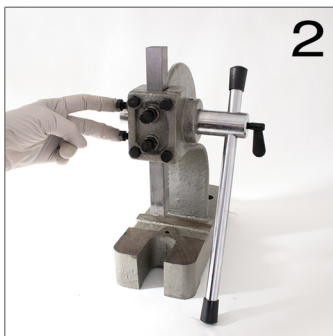

2

Remove and get rid of the 2 left side bolts, you don't need 'em.

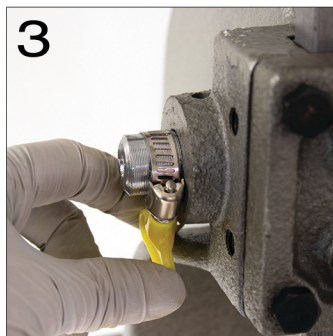

3

Insert the lever arm, the gears engage, then slide the yellow clamp and tighten. The yellow tab should be parallel with the body.

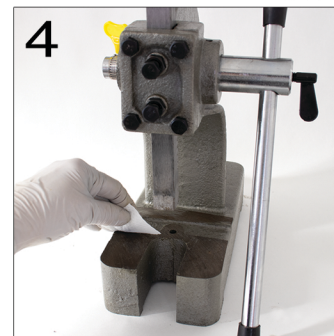

4

Wipe the platform with alcohol pad to remove oils so the adhesive will stick better.

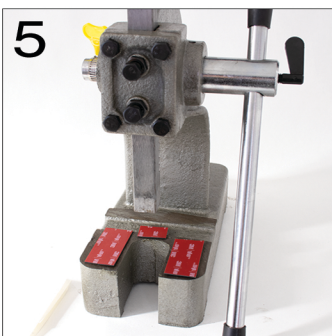

5

Let alcohol dry then affix the 3 adhesive strip tapes then peel off the red plastic covers.

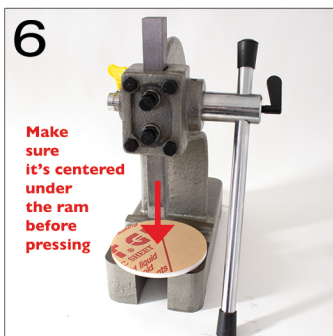

6

Make sure it's centered under the ram before pressing

Remove the brown paper from one side of the Base Plate and center it under the ram and **PRESS**.

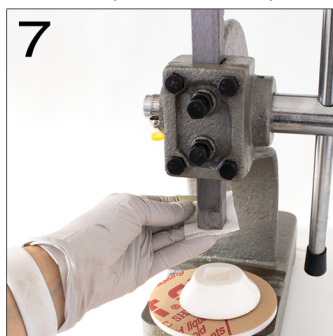

7

Use the second alcohol pad to clean the end of the ram on all sides and bottom.

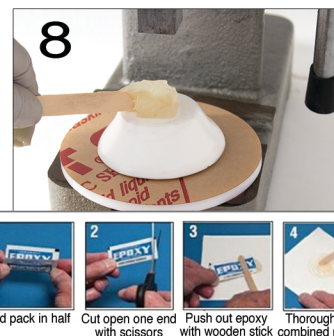

8

Mix the epoxy and scoop mixture into well of Stomper. **You have 3 - 5 minutes working time max before the epoxy starts to cure.**

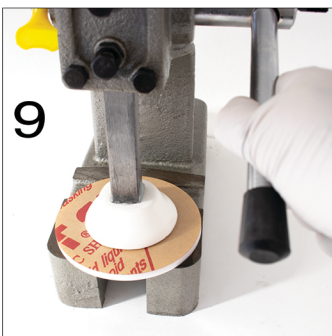

9

Use the lever arm to push the ram **FIRMLY** into the Stomper. Let it cure overnight.

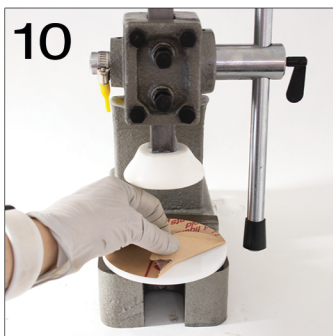

10

Lift up the Stomper with the lever arm and peel the brown paper off the Base Plate.



Affix the NEVERknead sticker onto the side. **Time to do a HappyDance!** You are now officially a **NEVERkneader!**



SCAN FOR ASSEMBLY HELP VIDEO

OK, time to BOLT! →

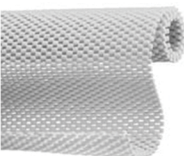

HOT TIP!

That cushy shelf liner available in rolls at stores like Target, CVS, or Dollar Stores make great non-slip surface protection under your NEVERknead (bolting is still also recommended).

Watch Assembly & Tutorial Videos: NEVERknead.com/video.html



**share the love!
#NEVERknead**



NEVERknead.com HELP neverknead@gmail.com | phone/text 323.640.0003

copyright (c) 2014-2021 NEVERknead.com - all rights reserved - NEVERknead® is a Registered Trademark & Patent Pending

FOLLOW RECOMMENDED PRECAUTIONS AND SAFE OPERATING PRACTICES PROVIDED WITH YOUR ARBOR PRESS NEVERknead assumes no responsibility for injury, damage, accidents, or misuse, and shall in no event be liable for death or injuries to persons or property, arising from the use of this product. NK 3rd GEN



The NEVERknead® Parts Kit



Bolt your NEVERknead - RECOMMENDED

1. Determine the desired location of your NEVERknead, such as a wood tabletop or workbench
2. Mark the drill holes using a pen or Sharpie inserted down through the holes in the back of the arbor press
3. Drill the two holes with 3/8 inch (.375) drill bit
4. Position arbor press over the holes and slide the bolts into the holes. A set of washers go above and below your arbor press as shown in the picture left.
5. Tighten the bolts underneath your surface and you are ready to use your NEVERknead!

- BOLTING** you'll need
- standard drill
 - 3/8" drill bit
 - pen or Sharpie to mark holes
 - drillable tabletop

Get to know your NEVERknead

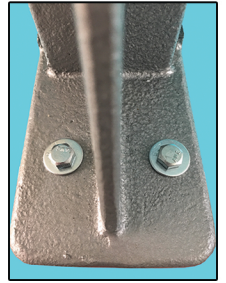
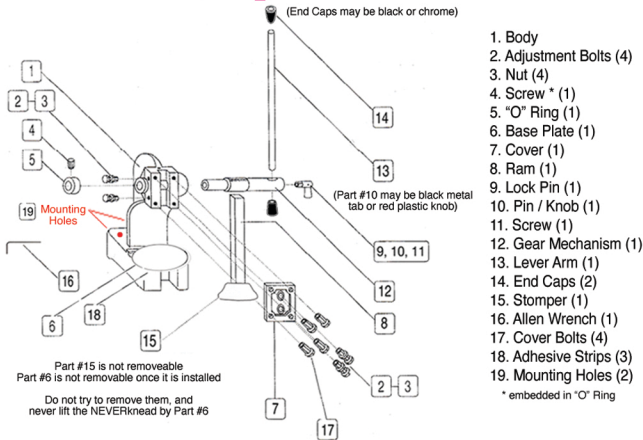

OPERATION & CARE

The NEVERknead is pretty self-explanatory, but here is the detailed low-down of everything NEVERknead

The NEVERknead makes kneading polymer clay easier and faster than hand kneading

ADJUSTMENTS

1. Determine if you will need a moderate or large amount of leverage for the clay you are working with.
2. Loosen the LOCK PIN or RED KNOB depending on the version you have (#9) by turning it. This will allow you to adjust the length of the LEVER (#13).
3. Adjust the length of the LEVER to suit your needs. If a large amount of leverage is needed (if clay is particularly hard), lock the LEVER in the extended position. If a moderate amount of leverage is needed (softer clay), position the LEVER in the middle of the Gear (#12).
4. Turn the LOCK PIN or KNOB (#9) to secure the LEVER Assembly and tighten the Lever Arm.
5. The four Adjustment Bolts (#2 & #3) can be used to increase or decrease the pressure against the Ram, to avoid it from jiggling. Overtightening can cause the Ram to not be able to move, however. I rarely use these, however.
6. As you work with the NEVERknead you will find the settings you like best for the clay you are working with, and your own personal preferences.

USING

1. Raise the RAM (#8) up by turning the LEVER (#13).
2. Place the clay you need to knead onto the BASE PLATE (#6).
3. Turn the LEVER to lower the RAM (#8) until the bottom of the STOMPER (#15) makes contact with the clay.
4. Place downward pressure on the LEVER to press (squish or knead) the clay, to about 3/4".
5. Rotate the clay and repeat until the clay is the desired conditioned consistency.
6. Raise the RAM with the LEVER, then remove the clay.

CARE

1. Clean the underside of the STOMPER (#15) and the BASE PLATE (#6) with mild cleaner and a soft cloth (or baby wipes) between clay colors. Do not use an abrasive cleansers or a scrubby! **DO NOT scratch the bottom surface of the STOMPER or the BASE PLATE.** Scratches will cause clay to get stuck in the micro grooves and cause possible color cross-contamination.
2. Use a soft damp cloth to clean the BODY (#1) of your NEVERknead when needed, then dry thoroughly with a soft dry towel.
3. There is protective oil on the RAM and GEAR parts to keep things moving smoothly - do not clean that oil off. This oil is normal and necessary.
4. Occasionally squirt a small amount of oil such as WD-40 into the RAM well and GEAR opening to keep it moving smoothly.
5. Do not submerge in water - the cast iron body could rust.

SCAN FOR VIDEO



Watch Assembly & Tutorial Videos:
NEVERknead.com/video.html



NEVERknead.com

HELP neverknead@gmail.com | phone/text 323.640.0003

copyright (c) 2014-2021 NEVERknead.com - all rights reserved - NEVERknead® is a Registered Trademark & Patent Pending

FOLLOW RECOMMENDED PRECAUTIONS AND SAFE OPERATING PRACTICES PROVIDED WITH YOUR ARBOR PRESS
NEVERknead assumes no responsibility for injury, damage, accidents, or misuse, and shall in no event be liable for death or injuries to persons or property, arising from the use of this product.